

© copyright of dem (austr) Pty Limited abn 52 085 456 844.  
 Any unauthorised use or distribution of information depicted on this document without dem (austr) Pty Limited prior consent is prohibited.  
 Any reports, drawings, advice or information included or referenced that is prepared and/or provided by any other party, including the client/partner, is the sole representation of the party who prepared the report/drawing, advice or information and does not constitute a representation by dem (austr) Pty Limited. dem (austr) Pty Limited expressly takes no responsibility for any documents, advice or other material prepared by any other party.  
 Figure dimensions to be taken in preference to scaled dimensions, verify all dimensions on the job before preparing shop drawings or commencing work.  
 Dimensions shown are computer generated and the contractor is to apply standard building tolerances.  
 Verified suitable for the use stipulated by the relevant revision/issue only if installed and checked by an authorised dem (austr) Pty Limited representative.

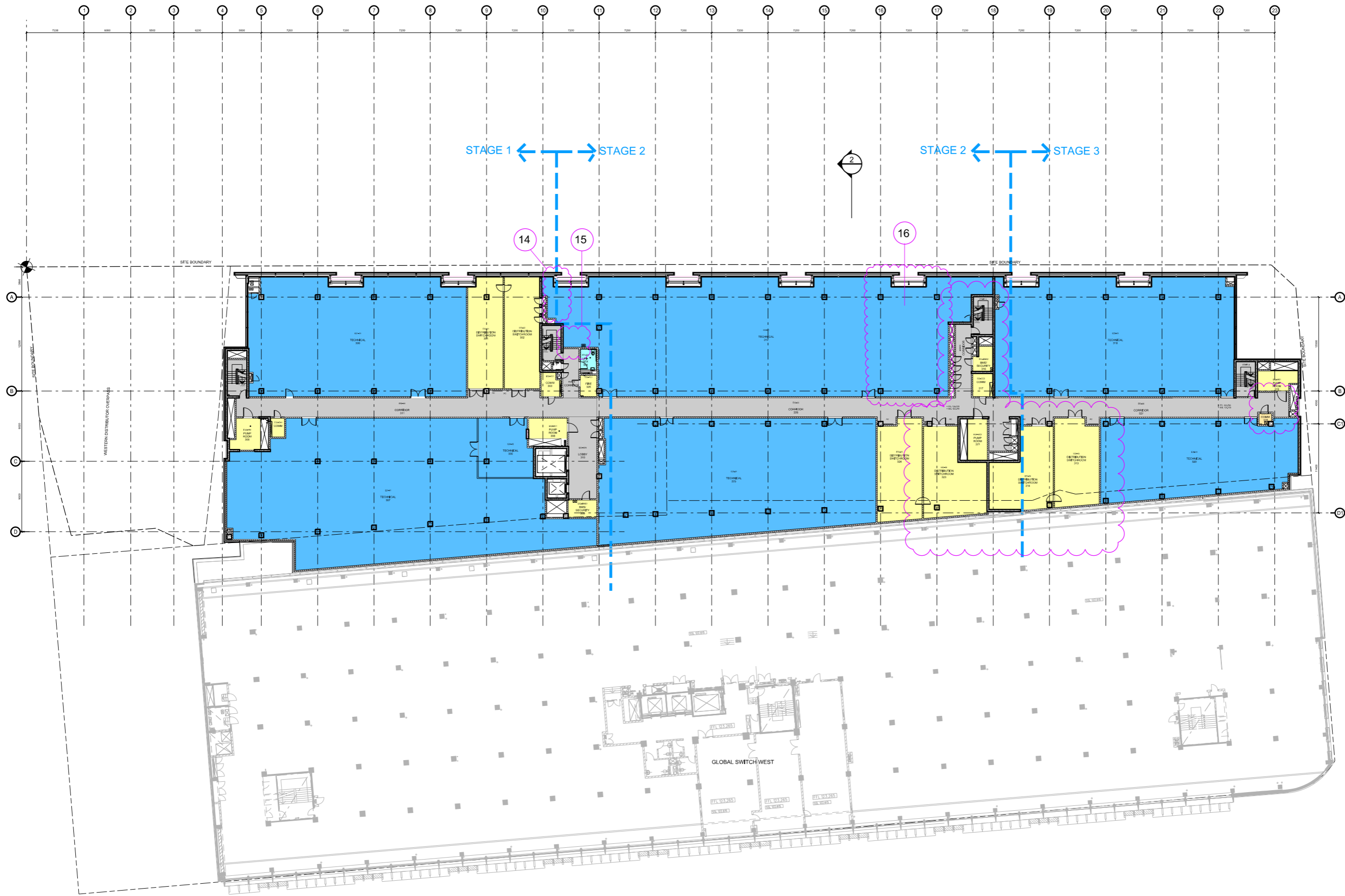

amendments		verified	
no.	date	by	chk'd
005	05-05-15	SECTION 75W SUBMISSION	KK KK SJ SJ
006-015	05-09-15	NUMBERED CLOUED AMENDMENTS	KK KK SJ SJ

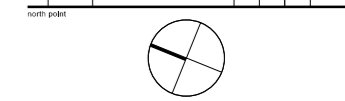

project client  
**GLOBAL SWITCH**  
 Sydney East Campus  
 273 Pyrmont Street, Ultimo NSW 2007  
 Global Switch Property (Australia)  
 400 Harris Street Ultimo NSW 2007  
 project manager  
**area3**  
 consulting | project management | design  
 suite 1203 23 Hunter Street, Sydney NSW 2000  
 t: 1 300 786 300 w: aread3.com.au  
 design & build contractor

architect  
  
 dem  
 planning, urban design, architecture,  
 landscape architecture, interior design  
 level 8, 15 help street chatswood, nsw 2067  
 pc po box 5038 west chatswood nsw 1515  
 t: 02 9969 6000 f: 02 9966 6111  
 e: info@dem.com.au  
 structural consultant

services consultant

drawing title  
**Level 3 Floor Plan**

**section 75W**

original	scale	drawn	project no.
b1	1:200	KK/MN	4277-00

drawing no. **ar-1206** rev no. **B05**