

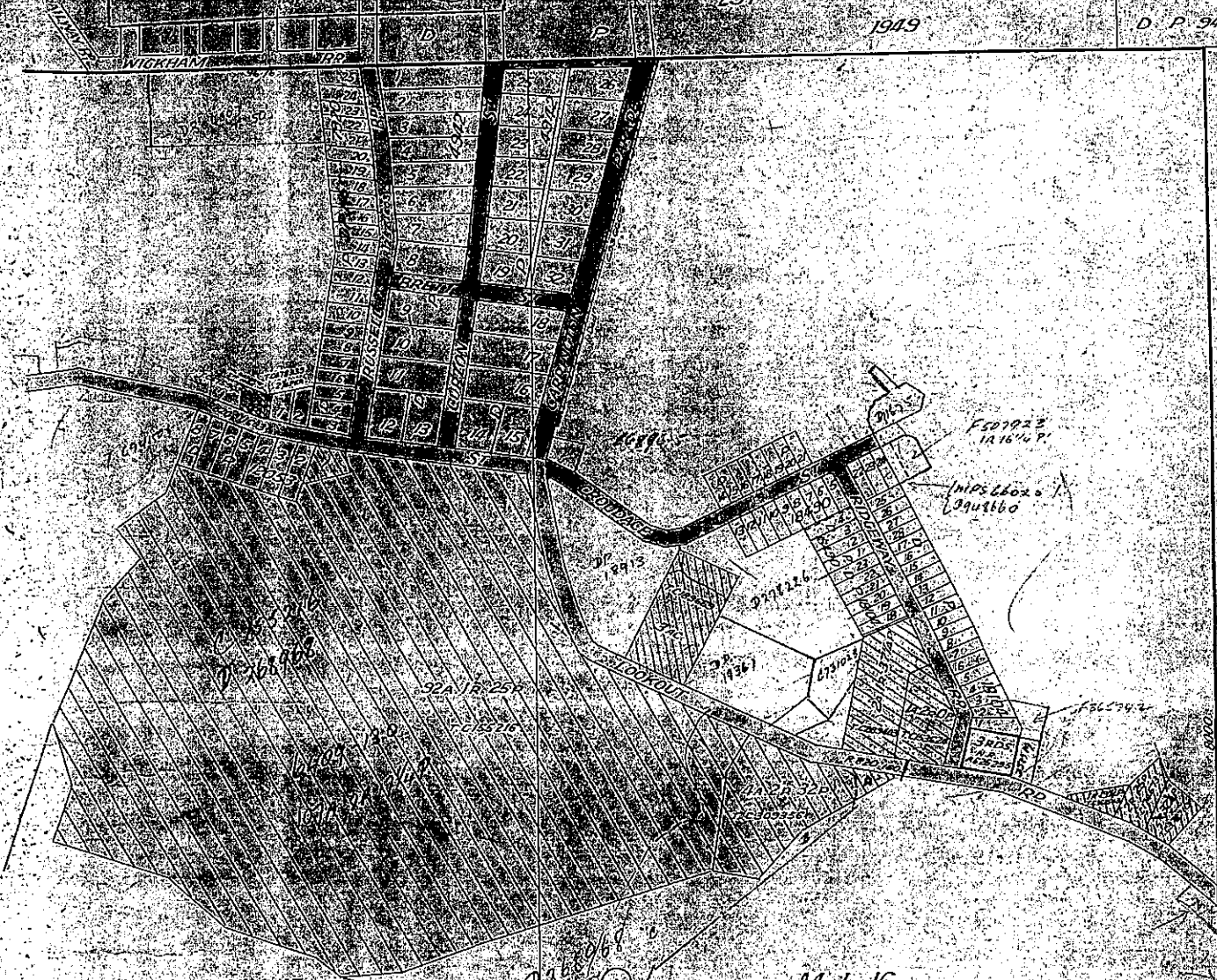

U.S. DEPARTMENT OF THE INTERIOR  
BUREAU OF LAND MANAGEMENT  
WASHINGTON, D. C.

297  
1949  
299  
D. P. 945



M. L. 15  
(Por. 167 Ph)

M. L. 16  
(Por. 171 Ph)

2987  
804  
1269-130  
220A 35P

F207923  
1A1644 P1

11056602  
1294860

172

No. 28011 TRANSFER dated 21<sup>st</sup> October 1941  
 from the said *British Overseas Airways Corporation* to *the said British Overseas Airways Corporation*  
 of the land within *Lot 10 of the land within described*  
 Produced *17<sup>th</sup> October 1941* and entered *25<sup>th</sup> December 1941*  
 at *12* o'clock in the *noon*  
 As to land in this transfer  
 this Certificate is cancelled  
 and new Certificate issued  
 Vol. *2911* Fol. *163*  
 REGISTRAR GENERAL



No. 28012 TRANSFER dated 21<sup>st</sup> October 1941  
 from the said *British Overseas Airways Corporation* to *the said British Overseas Airways Corporation*  
 of the land within *Lot 11 of the land within described*  
 Produced *17<sup>th</sup> October 1941* and entered *14<sup>th</sup> December 1941*  
 at *12* o'clock in the *noon*  
 As to land in this transfer  
 this Certificate is cancelled  
 and new Certificate issued  
 Vol. *2911* Fol. *164*  
 REGISTRAR GENERAL



No. 28013 TRANSFER dated 19<sup>th</sup> December 1941  
 from the said *British Overseas Airways Corporation* to *the said British Overseas Airways Corporation*  
 of the land within *Lot 12 of the land within described*  
 Produced *19<sup>th</sup> December 1941* and entered *19<sup>th</sup> February 1942*  
 at *12* o'clock in the *noon*  
 As to land in this transfer  
 this Certificate is cancelled  
 and new Certificate issued  
 Vol. *2911* Fol. *165*  
 REGISTRAR GENERAL



The Public Gardens and Recreation Areas shown on  
 Deposited Plans No. 19681 are subject to the provisions  
 of sections 240 (A) of the Local Government Act 1919  
 Dated 30<sup>th</sup> February 1942  
 Vide papers D. 19681  
 REGISTRAR GENERAL



No. 28014 TRANSFER dated 2<sup>nd</sup> December 1941  
 from the said *British Overseas Airways Corporation* to *the said British Overseas Airways Corporation*  
 of the land within *Lot 13 of the land within described*  
 Produced *1<sup>st</sup> January 1942* and entered *5<sup>th</sup> March 1942*  
 at *12* o'clock in the *noon*  
 As to land in this transfer  
 this Certificate is cancelled  
 and new Certificate issued  
 Vol. *2911* Fol. *15*  
 REGISTRAR GENERAL



No. 28015 TRANSFER dated 1<sup>st</sup> December 1941  
 from the said *British Overseas Airways Corporation* to *the said British Overseas Airways Corporation*  
 of the land within *Lot 14 of the land within described*  
 Produced *13<sup>th</sup> February 1942* and entered *5<sup>th</sup> March 1942*  
 at *12* o'clock in the *noon*  
 As to land in this transfer  
 this Certificate is cancelled  
 and new Certificate issued  
 Vol. *2911* Fol. *16*  
 REGISTRAR GENERAL



No. 28016 TRANSFER dated 1<sup>st</sup> December 1941  
 from the said *British Overseas Airways Corporation* to *the said British Overseas Airways Corporation*  
 of the land within *Lot 15 of the land within described*  
 Produced *13<sup>th</sup> February 1942* and entered *5<sup>th</sup> March 1942*  
 at *12* o'clock in the *noon*  
 As to land in this transfer  
 this Certificate is cancelled  
 and new Certificate issued  
 Vol. *2911* Fol. *17*  
 REGISTRAR GENERAL

No. 28017 TRANSFER dated 1<sup>st</sup> July 1942  
 from the said *British Overseas Airways Corporation* to *the said British Overseas Airways Corporation*  
 of the land within *Lot 16 of the land within described*  
 Produced *1<sup>st</sup> July 1942* and entered *10<sup>th</sup> August 1942*  
 at *12* o'clock in the *after-noon*  
 As to land in this transfer  
 this Certificate is cancelled  
 and new Certificate issued  
 Vol. *2911* Fol. *18*  
 REGISTRAR GENERAL



No. 28018 NOTICE OF RESUMPTION. An easement  
 affecting that part of the land within described shown by *blue*  
 colour in the plan hereon has become vested in the Minister for Public  
 Works as constructing authority for the purposes of the Public Works  
 Act 1912 by operation of the said Act and in pursuance of the Gazette  
 Notice in connection therewith freed and discharged from all trusts  
 obligations, estates, interests, contracts, charges, rates, rights-of-way or other  
 encumbrances.  
 Produced *5<sup>th</sup> February 1942* and entered *6<sup>th</sup> August 1942*  
 at *12* o'clock in the *noon*  
 REGISTRAR GENERAL



No. 28019 Lease dated 9<sup>th</sup> November 1942 for the  
 term of *10* years from the date hereof to *the said British Overseas Airways Corporation*  
 of the land within *Lot 17 of the land within described*  
 Produced *13<sup>th</sup> January 1943* and entered *13<sup>th</sup> January 1943*  
 at *12* o'clock in the *noon*  
 REGISTRAR GENERAL



No. 28020 TRANSFER dated 17<sup>th</sup> December 1941  
 from the said *British Overseas Airways Corporation* to *the said British Overseas Airways Corporation*  
 of the land within *Lot 18 of the land within described*  
 Produced *24<sup>th</sup> January 1942* and entered *23<sup>rd</sup> February 1942*  
 at *10* o'clock in the *fore-noon*  
 As to land in this transfer  
 this Certificate is cancelled  
 and new Certificate issued  
 Vol. *2911* Fol. *19*  
 REGISTRAR GENERAL



No. 28021 TRANSFER dated 19<sup>th</sup> December 1941  
 from the said *British Overseas Airways Corporation* to *the said British Overseas Airways Corporation*  
 of the land within *Lot 19 of the land within described*  
 Produced *23<sup>rd</sup> February 1942* and entered *23<sup>rd</sup> February 1942*  
 at *12* o'clock in the *after-noon*  
 As to land in this transfer  
 this Certificate is cancelled  
 and new Certificate issued  
 Vol. *2911* Fol. *20*  
 REGISTRAR GENERAL



No. 28022 TRANSFER dated 1<sup>st</sup> February 1942  
 from the said *British Overseas Airways Corporation* to *the said British Overseas Airways Corporation*  
 of the land within *Lot 20 of the land within described*  
 Produced *1<sup>st</sup> March 1942* and entered *27<sup>th</sup> April 1942*  
 at *12* o'clock in the *noon*  
 As to land in this transfer  
 this Certificate is cancelled  
 and new Certificate issued  
 Vol. *2911* Fol. *21*  
 REGISTRAR GENERAL





NEWCASTLE PRIVATE  
HOSPITAL

31 January 2006

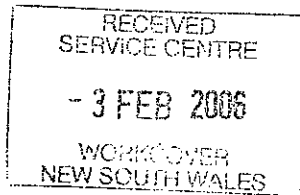

GRDA-3

John Cairns  
A/Coordinator Licence Processing  
WorkCover NSW  
Locked Bag 2906  
LISAROW 2252

Dear John

**NOTIFICATION OF DANGEROUS GOODS ON PREMISES 35/036975**

I refer to your letter dated 15 December 2005 regarding storage of dangerous goods on our premises at 14 Lookout Road, New Lambton Heights.

Please find enclosed our declaration and licence as requested.

Yours sincerely

A handwritten signature in cursive script that reads 'Sandra Parsons'.

**SANDRA PARSONS**  
Quality/Risk Manager

Encl



636975 ↑  
 (N)

HOSPITAL BUILDING

4000  
 BRICKWALL  
 COMPOUND

CARPARK AREA

FIRE  
 HYDRANT

← 240/240/240 FLL

7000

TAPPED  
 WATER

LDX  
 7000 LTR  
 VESSEL

MESH GATE

CONCRETE  
 AREA  
 Bundled by  
 Speed humps.

Depot No 1  
 class 2.2/5.1  
 Above ground tank  
 VAPOURISER

9000

DRAIN

DRAIN

ROADWAY

CARPARK

CARPARK 50M

6000

Depot (Title) Depot No 1  
 for (Quantity) 7000 L  
 of DG Class 2.2/5.1 and PG  
 as shown in this plan  
 conforms with the Dangerous Goods Act 1975  
 and Australian Standard(s) AS 1854.1:2007  
 Signature: [Signature]  
 Name (Printed) DANIS MOSEGE  
 Date: 25/10/04

NIB CONSULTING  
 BUILDING

Designed by P. WATKINS	Approved by X	NIB HOSPITAL
		VESEL LAYOUT
		Scale 1:100 Date 22/9/04
		Edition A

LG0050



Print



Close page

## Search results

---

Your search for: LGA: Newcastle City Council

Matched 38 notices relating to 17 sites.

Suburb	Address	Site Name	Notices related to this site
Hamilton	116 Tudor Street	Hamilton - former service station	1 current and 3 former
Hamilton North	Corner Clyde and Chatham Street	AGL Hamilton North	1 current
Hamilton North	56 Clyde Street	Former Black and Decker Site	1 current
Hamilton North	54 Clyde Street	Former ELMA Factory	2 current
Hexham	Lot 28 Sparke Street	Engineering Fabrication Plant	1 current
Hexham	64 Old Maitland Road	Trojay Pty Ltd	1 current
Kooragang	Cormorant Road	BHP Kooragang	1 current and 1 former
Kooragang	15 Greenleaf Road	Orica - Kooragang Island	2 current and 1 former
Mayfield	Industrial Drive	BHP Closure Site	2 current
Mayfield	Industrial Drive	BHP Supply Area	3 current
Mayfield	Woodstock Street	Koppers Coal Tar Products Mayfield	1 current
Mayfield	Industrial Drive	OneSteel Site	3 current
Mayfield	Industrial Drive	Steel River Industrial Estate	2 current
Newcastle	50 Honeysuckle Drive	Honeysuckle Development	1 former
Sandgate	Off Maitland Road	Storage Handling Facility	1 current and 7 former
Shortland	1, 2, 28 Astra Street	Astra Street Landfill	3 current
Tarro	Woodland Close	Green Acres Farm	1 current

Page 1 of 1

1 October 2008

# Groundwater Works Summary

For information on the meaning of fields please see [Glossary](#)  
Document Generated on Monday, September 15, 2008

[Print Report](#)

[Works Details](#) [Site Details](#) [Form A Licensed Construction](#) [Water Bearing Zones](#) [Drillers Log](#)

## ① Work Requested -- GW057772

### Works Details [\(top\)](#)

GROUNDWATER NUMBER GW057772  
 LIC-NUM 20BL120210  
 AUTHORISED-PURPOSES RECREATION (GROUNDWATER)  
 INTENDED-PURPOSES RECREATION (GROUNDWATER)  
 WORK-TYPE Bore  
 WORK-STATUS Supply Obtained  
 CONSTRUCTION-METHOD Rotary Air  
 OWNER-TYPE Private  
 COMMENCE-DATE  
 COMPLETION-DATE 1981-02-01  
 FINAL-DEPTH (metres) 24.00  
 DRILLED-DEPTH (metres) 24.00  
 CONTRACTOR-NAME  
 DRILLER-NAME  
 PROPERTY N/A  
 GWMA - CENTRAL WEST FRACTURED ROCKS  
 GW-ZONE - MURRAY - CALIVIL RENMARK  
 STANDING-WATER-LEVEL  
 SALINITY  
 YIELD

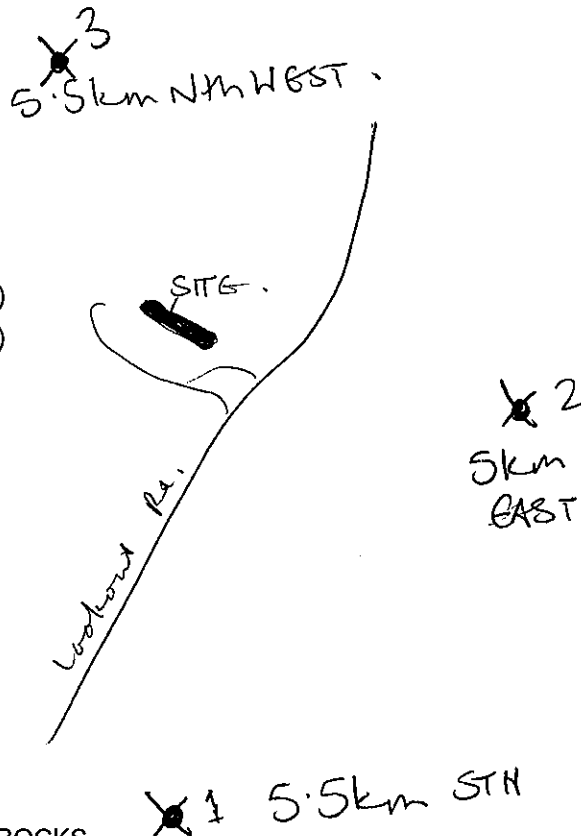

### Site Details [\(top\)](#)

REGION 20 - HUNTER  
 RIVER-BASIN 210 - HUNTER RIVER  
 AREA-DISTRICT  
 CMA-MAP 9232-3S  
 GRID-ZONE 56/1  
 SCALE 1:25,000  
 ELEVATION  
 ELEVATION-SOURCE (Unknown)  
 NORTHING 6354514.00  
 EASTING 378581.00  
 LATITUDE 32 56' 27"  
 LONGITUDE 151 42' 4"  
 GS-MAP 0053C4

AMG-ZONE 56  
 COORD-SOURCE GD.,ACC.MAP  
 REMARK

**Form-A (top)**

COUNTY NORTHUMBERLAND  
 PARISH NEWCASTLE  
 PORTION-LOT-DP 99999

**Licensed (top)**

COUNTY NORTHUMBERLAND  
 PARISH NEWCASTLE  
 PORTION-LOT-DP NOT AVAILABLE

**Construction (top)**

Negative depths indicate Above Ground Level;H-Hole;P-Pipe;OD-Outside Diameter;  
 ID-Inside Diameter;C-Cemented;SL-Slot Length;A-Aperture;GS-Grain Size;Q-Quantity

HOLE- NO	PIPE- NO	COMPONENT- CODE	COMPONENT- TYPE	DEPTH- FROM (metres)	DEPTH- TO (metres)	OD (mm)	ID (mm)	INTERVAL	DETAIL
1	1	Casing	Threaded Steel	0.00	24.00	150			Seated on Bottom
1	1	Opening	Slots - Vertical	18.00	24.00	150		1	Oxy- Acetylene Slotted; SL: 0mm; A: 6mm
1	1	Annulus	(Unknown)	20.00	24.00	212			Graded; GS: 6mm

**Water Bearing Zones (top)**

FROM- DEPTH (metres)	TO- DEPTH (metres)	THICKNESS (metres)	ROCK- CAT- DESC	S- W-L	D- D- L	YIELD	TEST- HOLE- DEPTH (metres)	DURATION	SALINITY
22.80	23.20	0.40	Fractured	3.00					(Unknown)

**Drillers Log (top)**

FROM	TO	THICKNESS	DESC	GEO-MATERIAL	COMMENT
0.00	0.30	0.30	Soil		
0.30	22.00	21.70	Clay		
22.00	24.00	2.00	Shale	Water Bearing	

Warning To Clients: This raw data has been supplied to the Department of Infrastructure, Planning and Natural Resources (DIPNR) by drillers, licensees and other sources. The DIPNR does not verify the accuracy of this data. The data is presented for

# Groundwater Works Summary

For information on the meaning of fields please see [Glossary](#)  
Document Generated on Monday, September 15, 2008

[Print Report](#)

[Works Details](#) [Site Details](#) [Form A Licensed Construction](#) [Water Bearing Zones](#) [Drillers Log](#)

## ② Work Requested -- GW060851

### Works Details [\(top\)](#)

**GROUNDWATER NUMBER** GW060851  
**LIC-NUM** 20BL132222  
**AUTHORISED-PURPOSES** DOMESTIC  
**INTENDED-PURPOSES** DOMESTIC  
**WORK-TYPE** Well  
**WORK-STATUS** Supply Obtained  
**CONSTRUCTION-METHOD** Hand Dug  
**OWNER-TYPE** Private  
**COMMENCE-DATE**  
**COMPLETION-DATE** 1985-02-01  
**FINAL-DEPTH (metres)** 4.90  
**DRILLED-DEPTH (metres)** 4.90  
**CONTRACTOR-NAME**  
**DRILLER-NAME**  
**PROPERTY** N/A  
**GWMA** - CENTRAL WEST FRACTURED ROCKS  
**GW-ZONE** - MURRAY - CALIVIL RENMARK  
**STANDING-WATER-LEVEL**  
**SALINITY**  
**YIELD**

### Site Details [\(top\)](#)

**REGION** 20 - HUNTER  
**RIVER-BASIN** 210 - HUNTER RIVER  
**AREA-DISTRICT**  
**CMA-MAP** 9232-3S  
**GRID-ZONE** 56/1  
**SCALE** 1:25,000  
**ELEVATION**  
**ELEVATION-SOURCE** (Unknown)  
**NORTHING** 6357249.00  
**EASTING** 380547.00  
**LATITUDE** 32 54' 59"  
**LONGITUDE** 151 43' 21"  
**GS-MAP** 0053C4

AMG-ZONE 56  
 COORD-SOURCE GD.,ACC.MAP  
 REMARK

**Form-A (top)**

COUNTY NORTHUMBERLAND  
 PARISH NEWCASTLE  
 PORTION-LOT-DP LF (99999)

**Licensed (top)**

COUNTY NORTHUMBERLAND  
 PARISH NEWCASTLE  
 PORTION-LOT-DP LT F WYONG RD LAMBTON

**Construction (top)**

Negative depths indicate Above Ground Level;H-Hole;P-Pipe;OD-Outside Diameter;  
 ID-Inside Diameter;C-Cemented;SL-Slot Length;A-Aperture;GS-Grain Size;Q-Quantity

HOLE- NO	PIPE- NO	COMPONENT- CODE	COMPONENT- TYPE	DEPTH- FROM (metres)	DEPTH- TO (metres)	OD (mm)	ID (mm)	INTERVAL	DETAIL
1	1	Casing	Drilled	0.00	4.90	1210			(Unknown)

**Water Bearing Zones (top)**

no details

**Drillers Log (top)**

FROM	TO	THICKNESS	DESC	GEO-MATERIAL	COMMENT
0.00	0.60	0.60	Fill		
0.60	3.60	3.00	Clay		
3.60	4.87	1.27	Clay		
3.60	4.87	1.27	Ironstone Lumps		

Warning To Clients: This raw data has been supplied to the Department of Infrastructure, Planning and Natural Resources (DIPNR) by drillers, licensees and other sources. The DIPNR does not verify the accuracy of this data. The data is presented for use by you at your own risk. You should consider verifying this data before relying on it. Professional hydrogeological advice should be sought in interpreting and using this data.

# Groundwater Works Summary

For information on the meaning of fields please see [Glossary](#)  
Document Generated on Monday, September 15, 2008

[Print Report](#)

[Works Details](#) [Site Details](#) [Form A Licensed Construction](#) [Water Bearing Zones](#) [Drillers Log](#)

## 3 Work Requested -- GW053186

### Works Details [\(top\)](#)

**GROUNDWATER NUMBER** GW053186  
**LIC-NUM** 20BL118687  
**AUTHORISED-PURPOSES** RECREATION (GROUNDWATER)  
**INTENDED-PURPOSES** RECREATION (GROUNDWATER)  
**WORK-TYPE** Bore  
**WORK-STATUS** Supply Obtained  
**CONSTRUCTION-METHOD** Rotary Air  
**OWNER-TYPE** Private  
**COMMENCE-DATE**  
**COMPLETION-DATE** 1981-01-01  
**FINAL-DEPTH (metres)** 32.00  
**DRILLED-DEPTH (metres)** 32.00  
**CONTRACTOR-NAME**  
**DRILLER-NAME**  
**PROPERTY** N/A  
**GWMA** - CENTRAL WEST FRACTURED ROCKS  
**GW-ZONE** - MURRAY - CALIVIL RENMARK  
**STANDING-WATER-LEVEL**  
**SALINITY**  
**YIELD**

### Site Details [\(top\)](#)

**REGION** 20 - HUNTER  
**RIVER-BASIN** 210 - HUNTER RIVER  
**AREA-DISTRICT**  
**CMA-MAP** 9232-3S  
**GRID-ZONE** 56/1  
**SCALE** 1:25,000  
**ELEVATION**  
**ELEVATION-SOURCE** (Unknown)  
**NORTHING** 6358935.00  
**EASTING** 377409.00  
**LATITUDE** 32 54' 3"  
**LONGITUDE** 151 41' 21"  
**GS-MAP** 0053C4

AMG-ZONE 56  
 COORD-SOURCE GD.,ACC.MAP  
 REMARK

**Form-A (top)**

COUNTY NORTHUMBERLAND  
 PARISH HEXHAM  
 PORTION-LOT-DP L101 (14)

**Licensed (top)**

COUNTY NORTHUMBERLAND  
 PARISH HEXHAM  
 PORTION-LOT-DP L101 (P+ Port 14)

**Construction (top)**

Negative depths indicate Above Ground Level;H-Hole;P-Pipe;OD-Outside Diameter;  
 ID-Inside Diameter;C-Cemented;SL-Slot Length;A-Aperture;GS-Grain Size;Q-Quantity

HOLE- NO	PIPE- NO	COMPONENT- CODE	COMPONENT- TYPE	DEPTH- FROM (metres)	DEPTH- TO (metres)	OD (mm)	ID (mm)	INTERVAL	DETAIL
1	1	Casing	P.V.C.	0.00	32.00	130			Seated on Bottom
1	1	Opening	Slots - Vertical	26.00	32.00	130		1	SL: 0mm; A: 6mm

**Water Bearing Zones (top)**

FROM- DEPTH (metres)	TO- DEPTH (metres)	THICKNESS (metres)	ROCK- CAT- DESC	S- W-L	D- D- L	YIELD	TEST- HOLE- DEPTH (metres)	DURATION	SALINITY
31.00	32.00	1.00	Fractured	2.40					(Unknown)

**Drillers Log (top)**

FROM	TO	THICKNESS	DESC	GEO-MATERIAL	COMMENT
0.00	0.15	0.15	Topsoil		
0.15	3.00	2.85	Clay		
3.00	24.38	21.38	Shale		
24.38	27.38	3.00	Coal		
27.38	32.00	4.62	Mudstone	Water Supply	

Warning To Clients: This raw data has been supplied to the Department of Infrastructure, Planning and Natural Resources (DIPNR) by drillers, licensees and other sources. The DIPNR does not verify the accuracy of this data. The data is presented for use by you at your own risk. You should consider verifying this data before relying on it. Professional hydrogeological advice

## **Appendix C**

### **Results Summary - Preliminary Environmental Site**

### **Assessment (HLA, November 2006)**

Use or disclosure of data contained on this sheet is subject to the restriction on the distribution page of this document.

*"This page has been left blank intentionally"*

Use or disclosure of data contained on this sheet is subject to the restriction on the distribution page of this document.

May 2009

Phase 1 Environmental Site Assessment

**Commercial in Confidence**

N4111701\_Phase1\_RPT\_May09.doc

Table T.1: Soil Sample Analytical Results

Sample ID	Material Type	Units	Site Auditor Guidelines		TP01 1.7m		TP02 0.5m		TP02 2m		TP03 0.5m		TP04 1.8m		
			HIL <sub>E</sub> mg/kg	PBIL mg/kg	Fill (mg/kg)	ASTM (mg/L)	TCLP (mg/L)	Fill (mg/kg)	TCLP (mg/L)	Fill (mg/kg)	ASTM (mg/L)	TCLP (mg/L)	Fill (mg/kg)	ASTM (mg/L)	
Heavy Metals	As	200	20	-	8	<0.1	<0.1	<0.1	8	<0.01	<0.1	6	<0.01	11	0.01
	Cd	40	3	<1	<0.005	<1	<0.05	<0.05	<1	<0.005	<0.05	<1	<0.005	<1	<0.005
	Cr	200	400	6	<0.01	11	<0.1	<0.1	4	<0.01	<0.1	6	<0.01	6	<0.01
	Cu	2000	400	49	0.01	21	<0.1	<0.1	10	<0.01	<0.1	17	<0.01	14	<0.01
	Pb	600	600	80	0.02	91	<0.1	<0.1	13	<0.01	<0.1	76	0.02	171	<0.01
	Ni	600	60	5	<0.01	7	<0.1	<0.1	4	<0.01	<0.1	5	<0.01	4	<0.01
	Zn	14000	200	118	0.11	117	0.7	0.7	152	0.08	0.7	96	0.31	96	0.05
	Hg	30	1	0.1	0.0001	<0.1	<0.0010	<0.0010	<0.1	<0.0001	<0.0010	<0.1	0.0001	<0.1	<0.0001
	BaP	2	-	<0.5	<0.0002	2.9	<0.0002	<0.0002	<0.5	<0.0002	<0.0002	0.6	<0.0002	<0.5	<0.0002
	Total PAH	40	-	1.5	<PQL	47.5	0.0002	<PQL	<PQL	<PQL	<PQL	7.5	<PQL	<PQL	<PQL
Organic Pollutants	TPH (C <sub>6</sub> -C <sub>9</sub> )	-	-	<2	-	-	-	-	-	-	-	<2	-	-	-
	TPH (C <sub>10</sub> -C <sub>30</sub> )	-	-	<250	-	-	-	-	-	-	-	<250	-	-	-
Phenols	17000	70	<PQL	-	-	-	-	-	-	-	-	<PQL	-	<PQL	-
	Asbestos	Zero Fibres	-	-	-	-	-	-	-	-	-	-	-	-	-

(mg/kg) = milligrams per kilogram.

(mg/L) = milligrams per litre.

< = analyte not detected above laboratory PQL

N/A = no criteria

-.: Not included in analysis suite

**Bold** denotes exceedence of HIL<sub>E</sub> or Service Station Criteria

Boxing denotes exceedence of PBIL

Table T.1: Soil Sample Analytical Results

Sample ID	Site Auditor Guidelines		NSW EPA Service Station Guidelines	TP05 2.7m			TP06 1m			TP06 3m			TP07 1m		
	HI <sub>L</sub> E mg/kg	PBIL mg/kg		Fill (mg/kg)	ASTM (mg/L)	TCLP (mg/L)	Fill (mg/kg)	TCLP (mg/L)	Fill (mg/kg)	ASTM (mg/L)	TCLP (mg/L)	Fill (mg/kg)	ASTM (mg/L)	TCLP (mg/L)	Fill (mg/kg)
Heavy Metals	As	200	-	<5	<0.01	<0.1	11	<0.1	<0.01	<0.1	22	<0.01	<0.01	<0.1	<5
	Cd	40	-	<1	<0.005	<0.05	<1	<0.05	<0.005	<0.05	<1	<0.005	<0.005	<0.05	<1
	Cr	200	-	7	<0.01	<0.1	12	<0.1	<0.01	<0.1	21	<0.01	<0.01	<0.1	4
	Cu	2000	-	27	<0.01	<0.1	16	<0.1	<0.01	<0.1	11	<0.01	<0.01	<0.1	13
	Pb	600	-	126	<0.01	<0.1	38	0.2	<0.01	<0.1	23	<0.01	<0.01	<0.1	25
	Ni	600	-	5	<0.01	<0.1	11	<0.1	<0.01	<0.1	6	<0.01	<0.01	<0.1	4
	Zn	14000	-	2.1	0.03	0.6	46	0.5	0.04	0.2	108	0.04	0.03	0.3	45
	Hg	30	-	<0.1	<0.0001	<0.0010	<0.1	<0.0010	<0.0001	<0.0010	<0.1	<0.0001	<0.0001	<0.001	<0.1
	BaP	2	-	<0.5	<0.0002	<0.0002	<0.5	<0.0002	<0.0002	<0.0002	<0.5	<0.0002	<0.0002	<0.0002	<0.5
	Total PAH	40	-	<PQL	<PQL	<PQL	<PQL	<PQL	<PQL	<PQL	<PQL	<PQL	<PQL	<PQL	<PQL
Organic Pollutants	TPH (C <sub>6</sub> -C <sub>9</sub> )	-	65	-	-	-	-	-	-	<2	-	-	-	-	
	TPH (C <sub>10</sub> -C <sub>30</sub> )	-	1000	-	-	-	-	-	-	<250	-	-	-	-	
Phenols	17000	70	-	-	-	-	-	-	-	-	-	<PQL	-	-	
	Zero Fibres	-	-	-	-	-	-	-	-	-	-	-	-	-	
Asbestos	-	-	-	-	-	-	-	-	-	-	-	-	-	-	

(mg/kg) = milligrams per kilogram.

(mg/L) = milligrams per litre.

< = analyte not detected above laboratory PQL

N/A = no criteria

-.: Not included in analysis suite

**Bold** denotes exceedence of HI<sub>L</sub>E or Service Station Criteria

**Boxing** denotes exceedence of PBIL

Table T.1: Soil Sample Analytical Results

Sample ID	Site Auditor Guidelines		NSW EPA Service Station Guidelines mg/kg	TP08_0.5m			DUP2			RPDs			TP09_3m			ASB1		ASB4		ASB5	
	HIL <sub>E</sub> mg/kg	PBIL mg/kg		ASTM (mg/L)	TCLP (mg/L)	Fill (mg/kg)	ASTM (mg/L)	TCLP (mg/L)	Fill (mg/kg)	TCLP (mg/L)	Fill (mg/kg)	ASTM (mg/L)	TCLP (mg/L)	AC Fragments	Detected	AC Fragments	Detected	AC Fragments	Detected		
Heavy Metals	As	200	-	<-0.1	<5	-	<-0.1	NC	NC	NC	<-0.1	<-0.1	-	<-0.1	-	-	-	-	-		
	Cd	40	-	<-0.05	<1	-	<-0.05	NC	NC	NC	<-0.05	<-0.05	-	<-0.05	-	-	-	-	-		
	Cr	200	400	<-0.01	<-0.1	6	<1	40%	NC	NC	<-0.01	<-0.1	-	<-0.01	-	-	-	-	-		
	Cu	2000	400	<-0.01	<-0.1	14	<1	7%	NC	NC	<-0.01	<-0.1	-	<-0.01	-	-	-	-	-		
	Pb	600	600	<-0.01	<-0.1	28	<1	11%	NC	NC	<-0.01	<-0.1	-	<-0.01	-	-	-	-	-		
	Ni	600	60	<-0.01	<-0.1	4	<1	0%	NC	NC	<-0.01	<-0.1	-	<-0.01	-	-	-	-	-		
	Zn	14000	200	0.07	0.5	56	0.5	22%	0%	0%	0.04	0.5	-	0.04	-	-	-	-	-		
Hg	30	1	<-0.0001	<-0.001	<-0.1	<-0.001	NC	NC	NC	<-0.0001	<-0.001	-	<-0.0001	-	-	-	-	-			
Total PAH	BaP	2	-	<-0.0002	<-0.5	<-0.0002	<-0.0002	NC	NC	<-0.0002	<-0.0002	-	<-0.0002	-	-	-	-	-	-		
	Total PAH	40	-	<-PQL	1.5	<-PQL	<-PQL	NC	NC	<-PQL	<-PQL	-	<-PQL	-	1.2	<-PQL	<-PQL	-	-		
Organic Pollutants	TPH (C <sub>6</sub> -C <sub>9</sub> )	-	65	-	-	-	-	-	-	-	-	-	-	<2	-	-	-	-	-		
	TPH (C <sub>10</sub> -C <sub>30</sub> )	-	1000	-	-	-	-	-	-	-	-	-	-	<250	-	-	-	-	-		
Phenols	Phenols	17000	70	-	-	-	-	-	-	-	-	-	-	<-PQL	-	-	-	-	-		
	Asbestos	Zero Fibres	-	-	-	-	-	-	-	-	-	-	-	-	-	-	-	-	-		

(mg/kg) = milligrams per kilogram.

(mg/L) = milligrams per litre.

< = analyte not detected above laboratory PQL

N/A = no criteria

-.: Not included in analysis suite

**Bold** denotes exceedence of HIL<sub>E</sub> or Service Station Criteria

**Boxing** denotes exceedence of PBIL

Table T.1: Soil Sample Analytical Results

Sample ID	Material Type	Site Auditor Guidelines		NSW EPA Service Station Guidelines	ASB Soil		
		HIL <sub>E</sub> mg/kg	PBIL mg/kg		Fill	ASB Soil Fill	
	Units			mg/kg	mg/kg	Detected	Detected
	Heavy Metals	As	20	-	-	-	-
		Cd	3	-	-	-	-
		Cr	400	-	-	-	-
		Cu	2000	-	-	-	-
		Pb	600	-	-	-	-
		Ni	60	-	-	-	-
		Zn	14000	-	-	-	-
		Hg	30	-	-	-	-
		BaP	2	-	-	-	-
	Total PAH	40	-	-	-	-	-
	TPH (C <sub>6</sub> -C <sub>9</sub> )	-	-	65	-	-	-
	TPH (C <sub>10</sub> -C <sub>30</sub> )	-	-	1000	-	-	-
	Phenols	17000	70	-	-	-	-
	Asbestos		Zero Fibres			No	Yes

(mg/kg) = milligrams per kilogram.

(mg/L) = milligrams per litre.

< = analyte not detected above laboratory PQL

N/A = no criteria

-.: Not included in analysis suite

**Bold** denotes exceedence of HIL<sub>E</sub> or Service Station Criteria

**Boxing** denotes exceedence of PBIL

Table T1: Soil Sample Waste Classification Results

Sample ID	NSW DEC (2004) Guidelines																
	Inert Waste		Solid Waste		Industrial Waste		TP01_1.7m		TP02_0.5m		TP02_2m		TP03_0.5m		TP04_1.8m		
	A	TCLP	SCC	A	TCLP	SCC	A	TCLP	SCC	Fill	TCLP	Fill	TCLP	Fill	TCLP	Fill	TCLP
(mg/kg)	(mg/L)	(mg/kg)	(mg/kg)	(mg/L)	(mg/kg)	(mg/kg)	(mg/L)	(mg/kg)	(mg/L)	(mg/kg)	(mg/L)	(mg/kg)	(mg/L)	(mg/kg)	(mg/L)	(mg/kg)	(mg/L)
As	10	0.5	500	100	5	500	400	20	2000	8	<0.1	8	<0.1	8	<0.1	8	<0.1
Cd	2	0.1	100	20	1	100	80	4	400	<1	<0.05	<1	<0.05	<1	<0.05	<1	<0.05
Cr	10*	0.5	1900	100*	5	1900	400*	20	7600	6	<0.1	6	<0.1	6	<0.1	6	<0.1
Pb	10	0.5	1500	100	5	1500	400	20	6000	80	<0.1	91	<0.1	13	<0.1	76	<0.1
Ni	4	0.2	1050	40	2	1050	160	8	4200	5	<0.1	7	<0.1	4	<0.1	5	<0.1
Hg	0.4	0.02	50	4.0	0.2	50	16	0.8	200	0.1	<0.0010	<0.1	<0.0010	<0.1	<0.0010	<0.1	<0.0010
BaP	0.08	0.004	1	0.8	0.04	10	3.2	0.16	23	<0.5	<0.002	2.9	<0.002	<0.5	<0.002	0.6	<0.002
Total PAH	-	-	200	-	-	200	-	-	800	1.5	<POL	47.5	0.0002	<POL	7.5	<POL	<POL
TPH (C <sub>6</sub> -C <sub>9</sub> )	-	-	650	-	-	650	-	-	2600	<2	-	<2	-	<2	-	<250	-
TPH (C <sub>10</sub> -C <sub>36</sub> )	-	-	5000	-	-	10000	-	-	40000	<250	-	<250	-	<250	-	<250	-
Phenols	29	1.44	518	288	14.4	518	1152	58	2073	<POL	-	<POL	-	<POL	-	<POL	-
Asbestos	Any Asbestos Fragments																

(mg/kg) = milligrams per kilogram.

(mg/L) = milligrams per litre.

< = analyte not detected above laboratory PCL.

A = Waste Disposal Classification without doing the leachate test

NA = no criteria

Concentrations above industrial levels are classified hazardous

\* = Not included in analysis suite

\* No leaching performed, as results of other samples with higher total Lead (Pb) concentrations have been used for classification of the material

< = POL increased due to matrix interference

Table T1: Soil Sample Waste Classification Results

Sample ID	NSW DEC (2004) Guidelines																		
	Inert Waste		Solid Waste			Industrial Waste		TP05_2.7m		TP06_1m		TP06_3m		TP07_1m		TP08_0.5m			
	A	TCLP	SCC	A	TCLP	SCC	A	TCLP	SCC	Fill	TCLP	Fill	TCLP	Fill	TCLP	Fill	TCLP		
(mg/kg)	(mg/L)	(mg/kg)	(mg/kg)	(mg/L)	(mg/kg)	(mg/kg)	(mg/L)	(mg/kg)	(mg/kg)	(mg/L)	(mg/kg)	(mg/L)	(mg/kg)	(mg/L)	(mg/kg)	(mg/L)	(mg/L)		
As	10	0.5	500	100	5	500	400	20	2000	<-5	<-0.1	11	<-0.1	22	<-0.1	9	<-0.1	<-0.1	
Cd	2	0.1	100	20	1	100	80	4	400	<-1	<-0.05	<-1	<-0.05	<-1	<-0.05	<-1	<-0.05	<-0.05	
Cr	10*	0.5	1900	100*	5	1900	400*	20	7600	7	<-0.1	12	<-0.1	21	<-0.1	6	<-0.1	4	<-0.1
Pb	10	0.5	1500	100	5	1500	400	20	6000	126	<-0.1	38	0.2	23	<-0.1	65	<-0.1	25	<-0.1
Ni	4	0.2	1050	40	2	1050	160	8	4200	5	<-0.1	11	<-0.1	6	<-0.1	5	<-0.1	4	<-0.1
Hg	0.4	0.02	50	4.0	0.2	50	16	0.8	200	<-0.1	<-0.0010	<-0.1	<-0.0010	<-0.1	<-0.0010	<-0.1	<-0.001	<-0.001	
BaP	0.08	0.004	1	0.8	0.04	10	3.2	0.16	23	<-0.5	<-0.0002	<-0.5	<-0.0002	<-0.5	<-0.0002	1.1	<-0.0002	<-0.5	<-0.0002
Total PAH	-	-	200	-	-	200	-	-	800	<-POL	<-POL	<-POL	<-POL	<-POL	<-POL	13.7	<-POL	0.6	<-POL
TPH (C <sub>6</sub> -C <sub>9</sub> )	-	-	650	-	-	650	-	-	2600	-	-	-	-	<-2	-	-	-	-	-
TPH (C <sub>10</sub> -C <sub>36</sub> )	-	-	5000	-	-	10000	-	-	40000	-	-	-	-	<-250	-	-	-	-	-
Phenols	29	1.44	518	288	14.4	518	1152	58	2073	-	-	-	-	-	-	-	-	-	-
Asbestos	Any Asbestos Fragments																		

(mg/kg) = milligrams per kilogram.

(mg/L) = milligrams per litre.

< = analyte not detected above laboratory PCL.

A = Waste Disposal Classification without doing the leachate test

NA = no criteria

Concentrations above industrial levels are classified hazardous

\* = Not included in analysis suite

\* = No leaching performed, as results of other samples with higher total Lead (Pb) concentrations have been used for classification c

< = PCL increased due to matrix interference

Table T1: Soil Sample Waste Classification Results

Sample ID	NSW DEC (2004) Guidelines																							
	Inert Waste		Solid Waste			Industrial Waste			DUP2		RPDs		TP09_3m		ASB1		ASB4		ASB5		ASB_Soil		ASB_Soil2	
	A	TCLP	SCC	A	TCLP	SCC	A	TCLP	SCC	Fill	TCLP	Fill	TCLP	Fill	AC	AC	AC	AC	AC	AC	AC	AC	AC	AC
(mg/kg)	(mg/L)	(mg/kg)	(mg/kg)	(mg/L)	(mg/kg)	(mg/L)	(mg/kg)	(mg/L)	(mg/kg)	(mg/L)	(mg/kg)	(mg/L)	(mg/L)	(mg/L)	(mg/L)	(mg/L)	(mg/L)	(mg/L)	(mg/L)	(mg/L)	(mg/L)	(mg/L)	(mg/L)	(mg/L)
As	10	0.5	500	100	5	500	400	20	2000	<5	<0.1	NC	NC	7	<0.1	-	-	-	-	-	-	-	-	-
Cd	2	0.1	100	20	1	100	80	4	400	<1	<0.06	NC	NC	<1	<0.06	-	-	-	-	-	-	-	-	-
Cr	10*	0.5	1900	100*	5	1900	400*	20	7600	6	<1	40%	NC	6	<0.1	-	-	-	-	-	-	-	-	-
Pb	10	0.5	1500	100	5	1500	400	20	6000	28	<1	11%	NC	85	<0.1	-	-	-	-	-	-	-	-	-
Ni	4	0.2	1050	40	2	1050	160	8	4200	4	<1	0%	NC	<2	<0.1	-	-	-	-	-	-	-	-	-
Hg	0.4	0.02	50	4.0	0.2	50	16	0.8	200	<0.1	<0.001	NC	NC	<0.1	<0.001	-	-	-	-	-	-	-	-	-
BaP	0.08	0.004	1	0.8	0.04	10	3.2	0.16	23	<0.5	<0.002	NC	NC	<0.5	<0.002	-	-	-	-	-	-	-	-	-
Total PAH	-	-	200	-	-	200	-	-	800	1.5	<POL	NC	NC	1.2	<POL	-	-	-	-	-	-	-	-	-
TPH (C <sub>6</sub> -C <sub>9</sub> )	-	-	650	-	-	650	-	-	2600	-	-	-	-	<2	-	-	-	-	-	-	-	-	-	-
TPH (C <sub>10</sub> -C <sub>38</sub> )	-	-	5000	-	-	10000	-	-	40000	-	-	-	-	<250	-	-	-	-	-	-	-	-	-	-
Phenols	29	1.44	518	288	14.4	518	1152	58	2073	-	-	-	-	<POL	-	-	-	-	-	-	-	-	-	-
Asbestos	Any Asbestos Fragments																							

(mg/kg) = milligrams per kilogram.

(mg/L) = milligrams per litre.

< = analyte not detected above laboratory PCL.

A = Waste Disposal Classification without doing the leachate test

NA = no criteria

Concentrations above industrial levels are classified hazardous

\* = Not included in analysis suite

\* No leaching performed, as results of other samples with higher total Lead (Pb) concentrations have been used for classification c

< = PCL increased due to matrix interference



## Worldwide Locations

Australia	+61-2-8484-8999
Azerbaijan	+994 12 4975881
Belgium	+32-3-540-95-86
Bolivia	+591-3-354-8564
Brazil	+55-21-3526-8160
China	+86-20-8130-3737
England	+44 1928-726006
France	+33(0)1 48 42 59 53
Germany	+49-631-341-13-62
Ireland	+353 1631 9356
Italy	+39-02-3180 77 1
Japan	+813-3541 5926
Malaysia	+603-7725-0380
Netherlands	+31 10 2120 744
Philippines	+632 910 6226
Scotland	+44 (0) 1224-624624
Singapore	+65 6295 5752
Thailand	+662 642 6161
Turkey	+90-312-428-3667
United States	+1 978-589-3200
Venezuela	+58-212-762-63 39

## Australian Locations

Adelaide  
Brisbane  
Canberra  
Darwin  
Mackay  
Melbourne  
Newcastle  
Sydney  
Singleton

[www.ensr.com.au](http://www.ensr.com.au)