

NOTES

- 1 GRADES TO EDWIN FLACK AVENUE VERGE TO FALL TOWARDS KERB.
- 2 DRAINAGE JUNCTION PITS TO BE IN ACCORDANCE WITH AUBURN COUNCIL'S STANDARD COUNCIL GULLY PIT DETAILS (APPENDIX A8 AUBURN DEVELOPMENT CONTROL PLAN 2000).
- 3 DOWNPIPE LOCATIONS TO BE CONFIRMED BY FENTON DESIGN GROUP.
- 4 DETAILS OF THE EXISTING STORMWATER DRAINAGE NETWORK HAVE BEEN OBTAINED FROM PROJECT SURVEYORS DRAWING 19395-1 AND OLYMPIC COORDINATION AUTHORITY DRAWINGS HSR3-330 REV X AND HSR3-331-REV X.
- 5 DESIGN PROVIDED IS CONCEPT ONLY AND IS SUBJECT TO CHANGE DURING DETAILED DESIGN.
- 6 DRAINAGE LAYOUT TO BE COORDINATED WITH EXISTING AND PROPOSED SERVICES DURING DETAILED DESIGN.
- 7 TRASH SCREEN AND SEDIMENT TRAP TO BE PROVIDED AT THE BOUNDARY OUTLET PITS FROM THE SITE. SEDIMENT TRAP TO BE 200mm BELOW THE INVERT LEVEL OF THE OUTGOING PIPE.
- 8 ALL STORMWATER DRAINAGE PIPES TO BE REINFORCED CONCRETE PIPES (RCP) WITH RUBBER RING JOINTS (RRJ), UNLESS NOTED OTHERWISE. MINIMUM COVER 500mm. PIPES BENEATH ROADS TO BE CLASS 3 AND CLASS 2 BENEATH PEDESTRIAN AREAS.
- 9 PIPE BEDDING, SUPPORT AND TRENCH BACKFILL SHALL SATISFY THE REQUIREMENTS OF AUBURN COUNCIL.
- 10 ALL NEW COVERS, GRATES AND FRAMES ARE TO BE IN ACCORDANCE WITH AS1998-2006, CLASS B IN FOOTWAYS AND CLASS D IN ROADWAYS (UNO) AND INSTALLED IN ACCORDANCE WITH AS 1657. GRATED SURFACE INLET PITS ARE TO BE CYCLE SAFE AND SECURED TO PERMIT ACCESS TO MAINTENANCE PERSONNEL ONLY.
- 11 ALL DRAINAGE PIPELINES TO BE LAID TO ACHIEVE AT LEAST A MINIMUM 1.0% FALL, UNO.
- 12 NO OSD HAS BEEN PROVIDED IN ACCORDANCE WITH ADVICE FROM SOPA AND AUBURN CITY COUNCIL.

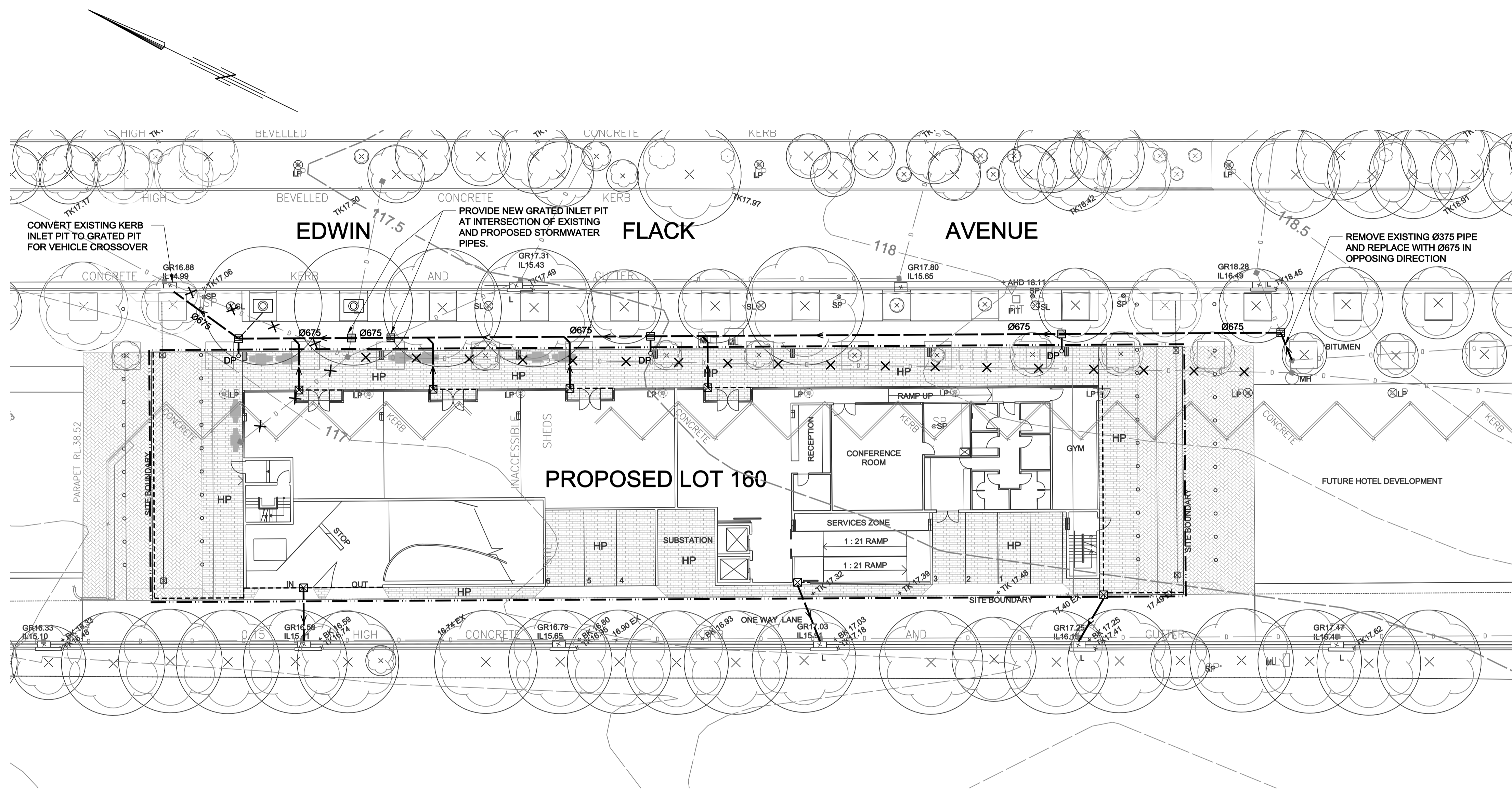

LEGEND

- DP STORMWATER DOWN PIPE
- PROPOSED CHANNEL DRAIN AND OUTLET PIT
- PROPOSED STORMWATER PIPE
- ▭ PROPOSED GRATED INLET PIT
- EXISTING STORMWATER PIPE
- ✕ EXISTING STORMWATER PIPE TO BE REMOVED

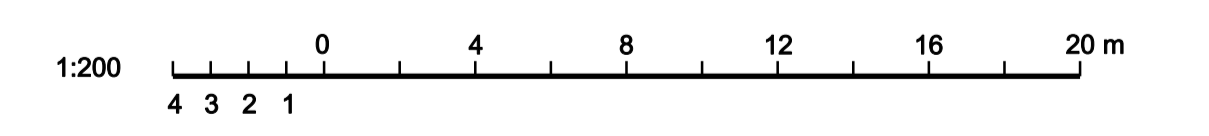

SOPPROP Pty Ltd

QUEST APARTMENTS SITE 22
SYDNEY OLYMPIC PARK

CONCEPT STORMWATER
DRAINAGE
PLAN

P01	18/12/08	CPL	LJM	RAH
ORIGINAL ISSUE				

AS SHOWN

Anup, Level 10, 201 Kent St
Sydney, NSW, 2000
Tel +61(02)9320 9320 Fax +61(02)9320 9321
www.anup.com.au

PRELIMINARY DRAWING

205940-00 C020 P01