

Notes
 The information contained in this document is copyright and may not be used or reproduced for any other project or purpose.
 Verify all dimensions and levels on site and report any discrepancies to dwp/suters for direction prior to the commencement of work.
 Drawings are to be read in conjunction with all other contract documents.
 Use figured dimensions only. Do not scale from drawings. dwp/suters cannot guarantee the accuracy of content and format for copies of drawings issued electronically.
 The completion of the Issue Details Checked and Authorised section is confirmation of the status of the drawing. The drawing shall not be used for construction unless endorsed 'For Construction' and authorised for issue.
 © dwp Australia Pty Ltd
 Registered Business Name dwp/suters ABN 37 169 328 018
 Robert Macdonald Nominated Architect NSW AIB 4699

Consultants
Planner, Heritage & Social
 URBS
Structural & Civil Engineer
 TAYLOR THOMSON WHITTING
 TTW
Structural, Mechanical & Fire Protection Engineer
 WSP/SPARSONS
 BRINCKERHOFF
Electrical, Communications & Hydraulic Engineer
 LMOW LA
BCA Consultant
 McKenzie Group
 mckenzie group

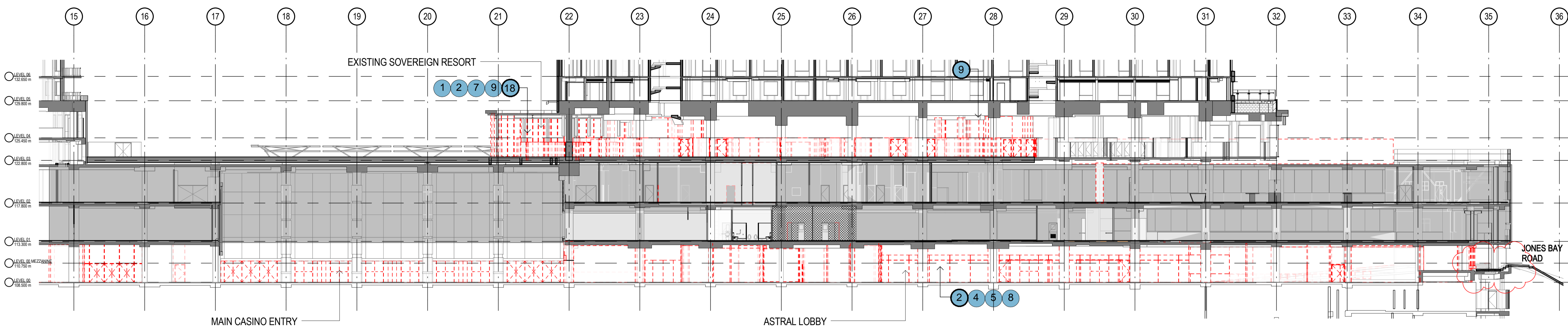

1 SECTION L - EXISTING & DEMOLITION
 1:250

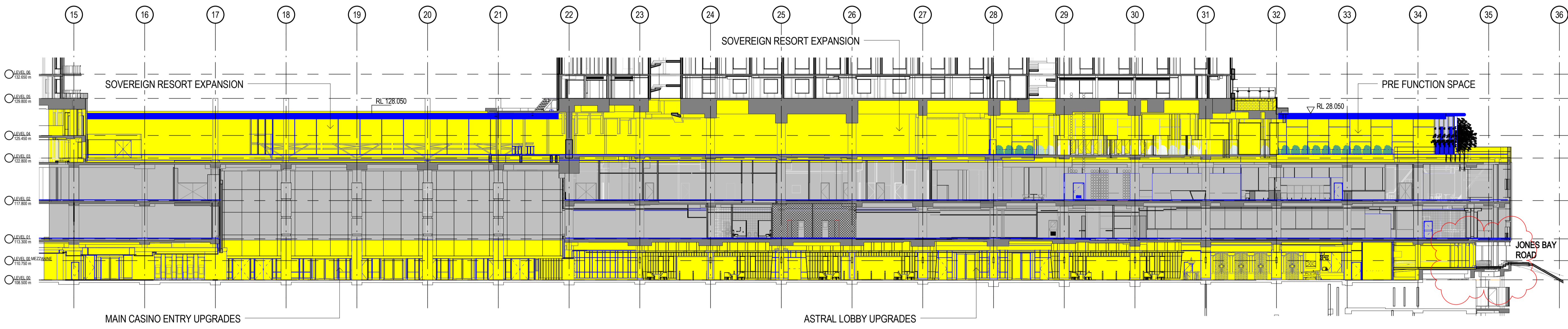

2 SECTION L - PROPOSED
 1:250

LEGEND
 [Yellow Box] PROPOSED WORKS
 [Grey Box] EXISTING
 [Red Dashed Line] DEMOLISH

North

PRELIMINARY
 NOT TO BE USED DURING CONSTRUCTION

DEMOLITION LEGEND:

- | | |
|---|---|
| 1 REMOVE EXISTING FLOOR FINISHES & DEMOLISH EXISTING SLAB TO ENTENT INDICATED | 10 DEMOLISH EXISTING PEDESTRIAN STAIRS /RAMP |
| 2 DEMOLISH EXISTING WALLS | 11 REMOVE EXISTING ESCALATOR |
| 3 REMOVE EXISTING PLANT AND CAP OFF/TERMINATE CONNECTIONS | 12 REMOVE EXISTING LIFT |
| 4 DEMOLISH LOWER PORTION OF CURTAIN WALL GLAZING | 13 DEMOLISH EXISTING GLAZED CANOPY |
| 5 DEMOLISH EXISTING KERBING | 14 DEMOLISH EXISTING PEDESTRIAN RAMP |
| 6 DEMOLISH CLADDING TO EXISTING COLUMNS | 15 REMOVE FIXED FURNITURE |
| 7 DEMOLISH EXISTING INTERNAL AMENITIES FITOUT | 16 REMOVE EXISTING GLAZED ROOF PANELS, MAINTAIN STRUCTURE |
| 8 DEMOLISH EXISTING INTERNAL RETAIL FITOUT | 17 REMOVE EXISTING BALUSTRADE |
| 9 REMOVE EXISTING FLOOR & WALL FINISHES | 18 DEMOLISH EXISTING ROOF |
| EXISTING WALLS/ COLUMNS RETAINED | 19 REMOVE EXISTING COLUMNS |
| DEMOLITION | 20 REMOVE EXISTING GLAZING & STRUCTURAL ASSEMBLY |
| AREAS NOT IN SCOPE OF WORKS | 21 REMOVE EXISTING PAVING |

Issue	Description	Date	Chk	Auth
C	REVISED MOD14 FOR APPROVAL	06.05.2017		
B	MODIFICATION 14	15-09-2016		
A	TEST OF ADEQUACY	03-08-2016		

Architect
 dwp/suters
 www.dwpsuters.com
 Project
 THE STAR - MODIFICATION 14
 Location
 80 PYRMONT STREET
 PYRMONT NSW 2009
 Client
 THE STAR ENTERTAINMENT GROUP
THE STAR
 ENTERTAINMENT GROUP
 Drawing
 BUILDING SECTIONS - SHEET 4
 Scale
 As indicated @ A1
 Date Printed
 5/12/2017 5:13:08 PM
 Project Number
 303457
 Drawing Number
 MOD14-A5013
 Issue
 C



File Name: D:\projects\REVIT\revit\303457_THE STAR_MOD14_CENTRAL_R016_Area1.rvt