

Notes
 The information contained in this document is copyright and may not be used or reproduced for any other project or purpose.
 Verify all dimensions and levels on site and report any discrepancies to dwp|suters for direction prior to the commencement of work.
 Drawings are to be read in conjunction with all other contract documents.
 Use figured dimensions only. Do not scale from drawings. dwp|suters cannot guarantee the accuracy of content and format for copies of drawings issued electronically.
 The completion of the Issue Details Checked and Authorised section is confirmation of the status of the drawing. The drawing shall not be used for construction unless endorsed 'For Construction' and authorised for issue.
 © dwp Australia Pty Ltd
 Registered Business Name dwp|suters ABN 37 169 328 018
 Robert McKenzie Nominated Architect NSW AIB 4699

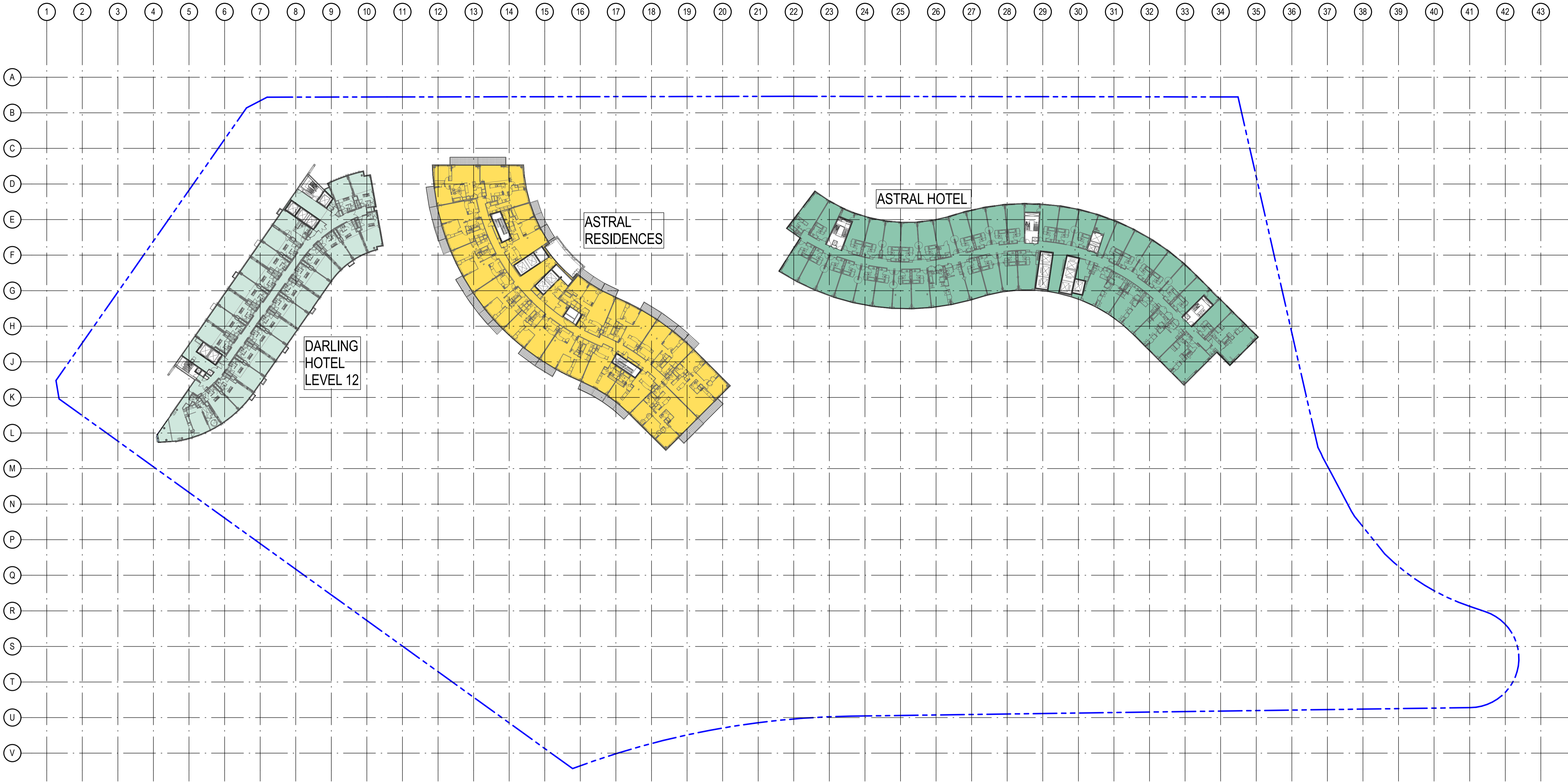

- Consultants**
- Planner, Heritage & Social URBIS
 - Structural & Civil Engineer TAYLOR THOMSON WHITTING TTW Taylor Thomson Whitting
 - Structural, Mechanical & Fire Protection Engineer WSP PARSONS BRINCKERHOFF WSP PARSONS BRINCKERHOFF
 - Electrical, Communications & Hydraulic Engineer LMOW LAI
 - BCA Consultant Mckenzie Group

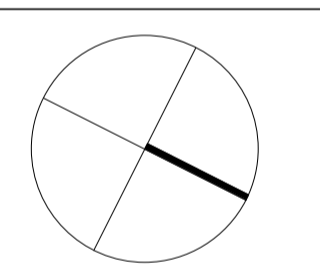

PRELIMINARY
 NOT TO BE USED DURING CONSTRUCTION

EXISTING AREA	EXISTING PATRONS PER m ²
DARLING HOTEL (1167m ²)	@ 15 m ² / PERSON = 78 PAX
ASTRAL HOTEL (2045m ²)	@ 15 m ² / PERSON = 136 PAX
ASTRAL RESIDENCES (1625m ²)	@ 15 m ² / PERSON = 108 PAX
TOTAL AREA: 4837m²	TOTAL PATRONS: 322 PAX

B	MODIFICATION 14	15-09-2016		
A	TEST OF ADEQUACY	03-06-2016		
	Issue Description	Date	Chk	Auth
Architect				
dwp suters www.dwpsuters.com				
Project				
THE STAR - MODIFICATION 14				
Location				
80 PYRMONT STREET PYRMONT NSW 2009				
Client				
THE STAR ENTERTAINMENT GROUP				
THE STAR ENTERTAINMENT GROUP				
Drawing				
EXISTING SITE PLAN & GFA DIAGRAM - LEVEL 10				
Scale				
1: 500 @ A1				
Date Printed				
9/15/2016 12:11:06 PM				
Project Number				
303457				
Drawing Number				
MOD14-A9010				
Issue				
B				



File Name: D:\dwpsuters\REV\T\303457_THE STAR_MOD14_CENTRAL_R010E.dwg

Notes
 The information contained in this document is copyright and may not be used or reproduced for any other project or purpose.
 Verify all dimensions and levels on site and report any discrepancies to dwp|suters for direction prior to the commencement of work.
 Drawings are to be read in conjunction with all other contract documents.
 Use figured dimensions only. Do not scale from drawings. dwp|suters cannot guarantee the accuracy of content and format for copies of drawings issued electronically.
 The completion of the Issue Details Checked and Authorised section is confirmation of the status of the drawing. The drawing shall not be used for construction unless endorsed 'For Construction' and authorised for issue.
 © dwp Australia Pty Ltd
 Registered Business Name dwp|suters ABN 37 169 238 018
 Robert McKenzie Nominated Architect NSW AIB 4699

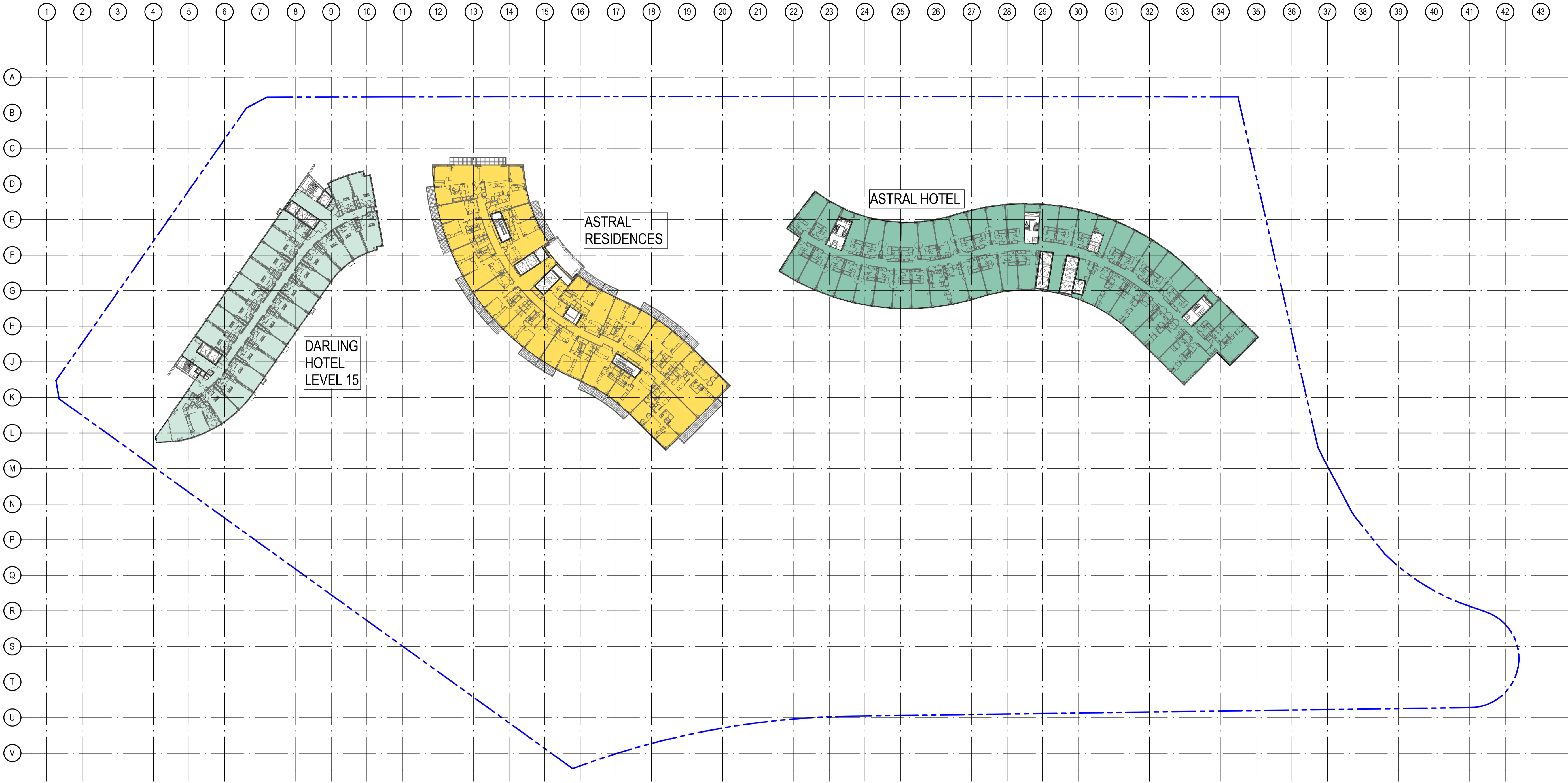

- Consultants**
- Planner, Heritage & Social URBIS
 - Structural & Civil Engineer TAYLOR THOMSON WHITTING TTW Taylor Thomson Whitting
 - Structural, Mechanical & Fire Protection Engineer WSP PARSONS BRINCKERHOFF WSP PARSONS BRINCKERHOFF
 - Electrical, Communications & Hydraulic Engineer LMOW LAI
 - BCA Consultant Mckenzie Group

North

PRELIMINARY
 NOT TO BE USED DURING CONSTRUCTION

EXISTING AREA	EXISTING PATRONS PER m ²
DARLING HOTEL (1167m ²)	@ 15 m ² / PERSON = 78 PAX
ASTRAL HOTEL (2045m ²)	@ 15 m ² / PERSON = 136 PAX
ASTRAL RESIDENCES (1625m ²)	@ 15 m ² / PERSON = 108 PAX
TOTAL AREA: 4837m²	TOTAL PATRONS: 322 PAX

B	MODIFICATION 14	15-09-2016		
A	TEST OF ADEQUACY	03-06-2016		
	Issue Description	Date	Chk	Auth
Architect				
dwp suters www.dwpsuters.com				
Project				
THE STAR - MODIFICATION 14				
Location				
80 PYRMONT STREET PYRMONT NSW 2009				
Client				
THE STAR ENTERTAINMENT GROUP				
THE STAR ENTERTAINMENT GROUP				
Drawing				
EXISTING SITE PLAN & GFA DIAGRAM - LEVEL 11				
Scale	Date Printed			
1:500 @ A1	9/15/2016 12:11:18 PM			
Project Number	Drawing Number	Issue		
303457	MOD14-A9011			B



File Name: D:\dwpsuters\REVIT\locat016\303457_THE STAR_MOD14_CENTRAL_R01E.rvt

Notes
 The information contained in this document is copyright and may not be used or reproduced for any other project or purpose.
 Verify all dimensions and levels on site and report any discrepancies to dwp|suters for direction prior to the commencement of work.
 Drawings are to be read in conjunction with all other contract documents.
 Use figured dimensions only. Do not scale from drawings. dwp|suters cannot guarantee the accuracy of content and format for copies of drawings issued electronically.
 The completion of the Issue Details Checked and Authorised section is confirmation of the status of the drawing. The drawing shall not be used for construction unless endorsed 'For Construction' and authorised for issue.
 © dwp Australia Pty Ltd
 Registered Business Name dwp|suters ABN 37 169 238 018
 Robert McKenzie Nominated Architect NSW AIB 4699

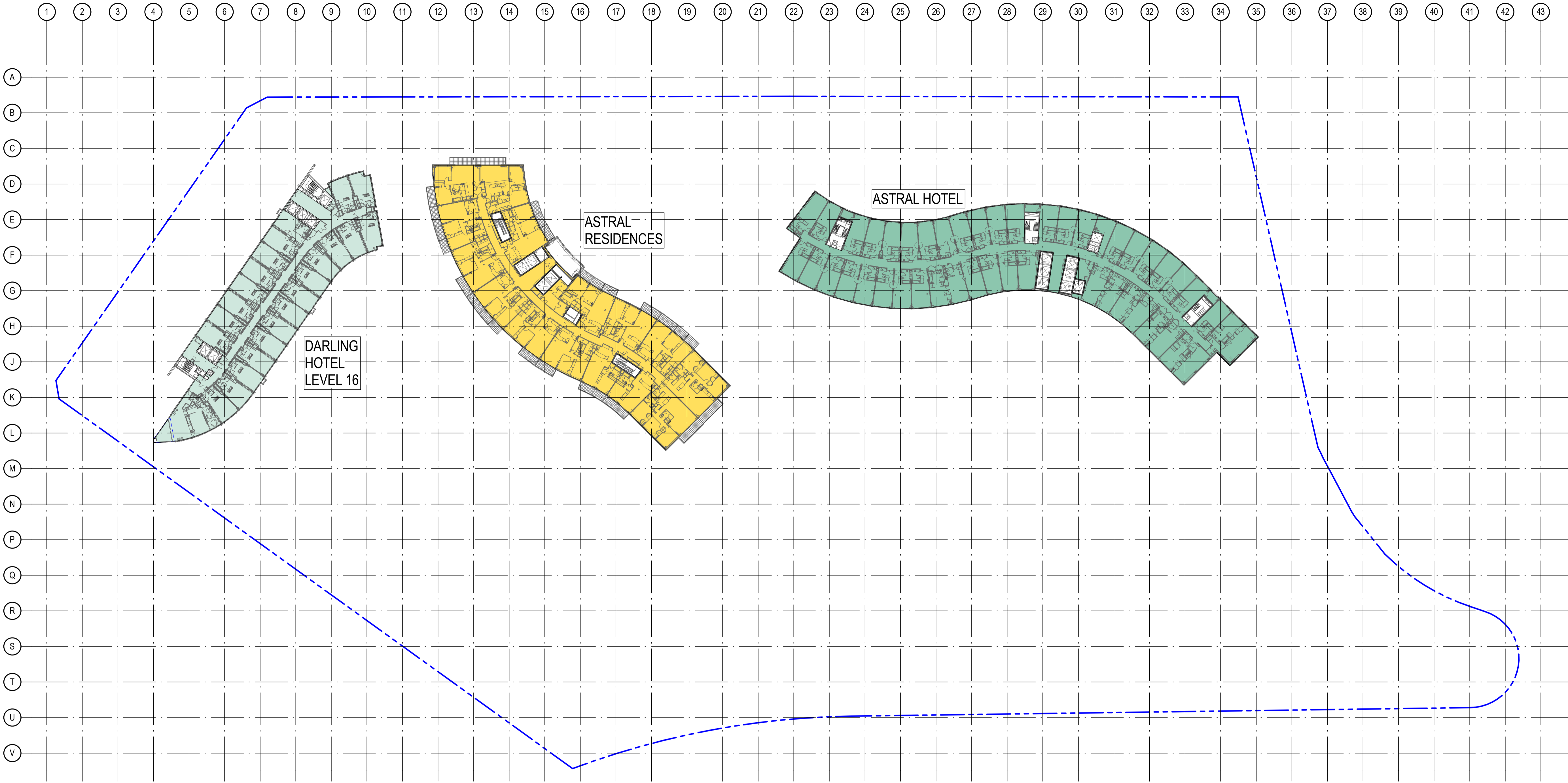

- Consultants**
- Planner, Heritage & Social URBIS
 - Structural & Civil Engineer TAYLOR THOMSON WHITTING TTW Taylor Thomson Whitting
 - Structural, Mechanical & Fire Protection Engineer WSP PARSONS BRINCKERHOFF WSP PARSONS BRINCKERHOFF
 - Electrical, Communications & Hydraulic Engineer LMOW LAI
 - BCA Consultant Mckenzie Group

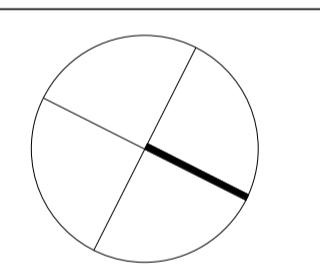

PRELIMINARY
 NOT TO BE USED DURING CONSTRUCTION

EXISTING AREA	EXISTING PATRONS PER m ²
DARLING HOTEL (1167m ²)	@ 15 m ² / PERSON = 78 PAX
ASTRAL HOTEL (2045m ²)	@ 15 m ² / PERSON = 136 PAX
ASTRAL RESIDENCES (1625m ²)	@ 15 m ² / PERSON = 108 PAX
TOTAL AREA: 4837m²	TOTAL PATRONS: 322 PAX

B MODIFICATION 14 15-09-2016
 A TEST OF ADEQUACY 03-06-2016
 Issue Description Date Chk Auth
 Architect
 dwp|suters
 www.dwpsuters.com
 Project
 THE STAR - MODIFICATION 14
 Location
 80 PYRMONT STREET
 PYRMONT NSW 2009
 Client
 THE STAR ENTERTAINMENT GROUP
THE STAR
 ENTERTAINMENT GROUP
 Drawing
 EXISTING SITE PLAN & GFA DIAGRAM - LEVEL 12
 Scale Date Printed
 1:500 @ A1 9/15/2016 12:11:30 PM
 Project Number Drawing Number Issue
 303457 MOD14-A9012 B



File Name: D:\dwpsuters\REV\T\303457_THE STAR_MOD14_CENTRAL_R016.rvt

Notes
 The information contained in this document is copyright and may not be used or reproduced for any other project or purpose.
 Verify all dimensions and levels on site and report any discrepancies to dwp|suters for direction prior to the commencement of work.
 Drawings are to be read in conjunction with all other contract documents.
 Use figured dimensions only. Do not scale from drawings. dwp|suters cannot guarantee the accuracy of content and format for copies of drawings issued electronically.
 The completion of the Issue Details Checked and Authorised section is confirmation of the status of the drawing. The drawing shall not be used for construction unless endorsed 'For Construction' and authorised for issue.
 © dwp Australia Pty Ltd
 Registered Business Name dwp|suters ABN 37 169 328 018
 Robert McKenzie Nominated Architect NSW AIB 4699

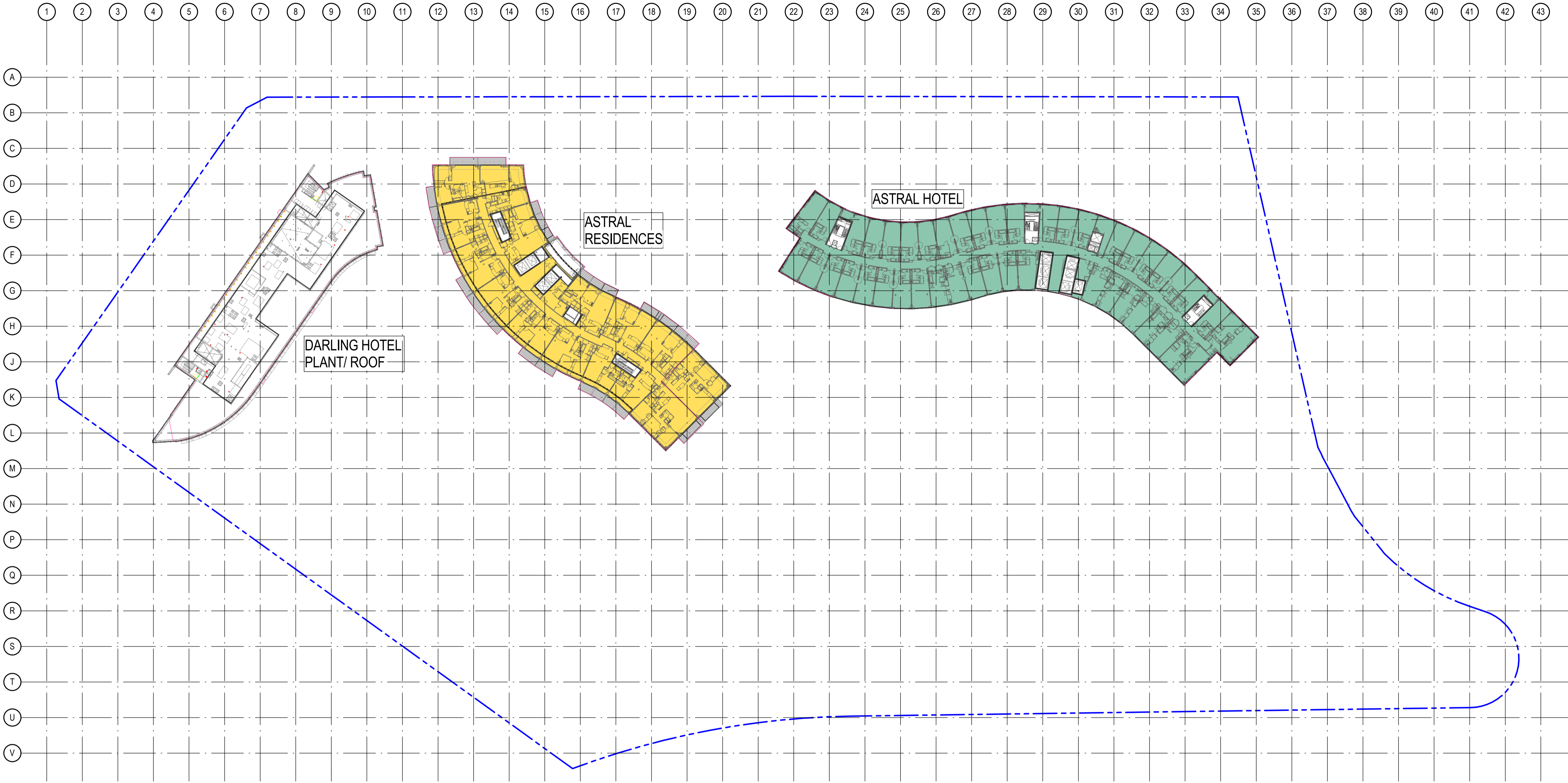

- Consultants**
- Planner, Heritage & Social URBIS
 - Structural & Civil Engineer TAYLOR THOMSON WHITTING TTW Taylor Thomson Whitting
 - Structural, Mechanical & Fire Protection Engineer WSP/ PARSONS BRINCKERHOFF WSP PARSONS BRINCKERHOFF
 - Electrical, Communications & Hydraulic Engineer LMOW LAI
 - BCA Consultant Mckenzie Group

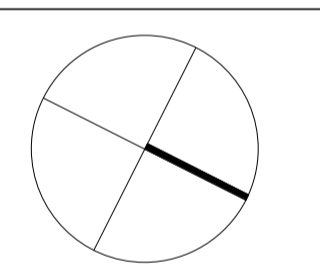

PRELIMINARY
 NOT TO BE USED DURING CONSTRUCTION

EXISTING AREA	EXISTING PATRONS PER m ²
 ASTRAL HOTEL (2045m ²)	@ 15 m ² / PERSON = 136 PAX
 ASTRAL RESIDENCES (1625m ²)	@ 15 m ² / PERSON = 108 PAX
TOTAL AREA: 3670m²	TOTAL PATRONS: 244 PAX

B MODIFICATION 14 15-09-2016
 A TEST OF ADEQUACY 03-06-2016
 Issue Description Date Chk Auth
 Architect
 dwp|suters
 www.dwpsuters.com
 Project
 THE STAR - MODIFICATION 14
 Location
 80 PYRMONT STREET
 PYRMONT NSW 2009
 Client
 THE STAR ENTERTAINMENT GROUP
THE STAR
 ENTERTAINMENT GROUP
 Drawing
 EXISTING SITE PLAN & GFA DIAGRAM - LEVEL 15
 Scale Date Printed
 1:500 @ A1 9/15/2016 12:11:43 PM
 Project Number Drawing Number Issue
 303457 MOD14-A9015 B



File Name: D:\dwpsuters\REVIT\locat016\303457_THE STAR_MOD14_CENTRAL_R015.rvt

Notes
 The information contained in this document is copyright and may not be used or reproduced for any other project or purpose.
 Verify all dimensions and levels on site and report any discrepancies to dwp|suters for direction prior to the commencement of work.
 Drawings are to be read in conjunction with all other contract documents.
 Use figured dimensions only. Do not scale from drawings. dwp|suters cannot guarantee the accuracy of content and format for copies of drawings issued electronically.
 The completion of the Issue Details Checked and Authorised section is confirmation of the status of the drawing. The drawing shall not be used for construction unless endorsed 'For Construction' and authorised for issue.
 © dwp Australia Pty Ltd
 Registered Business Name dwp|suters ABN 37 169 328 018
 Robert Macdonald Nominated Architect NSW AIB 4699

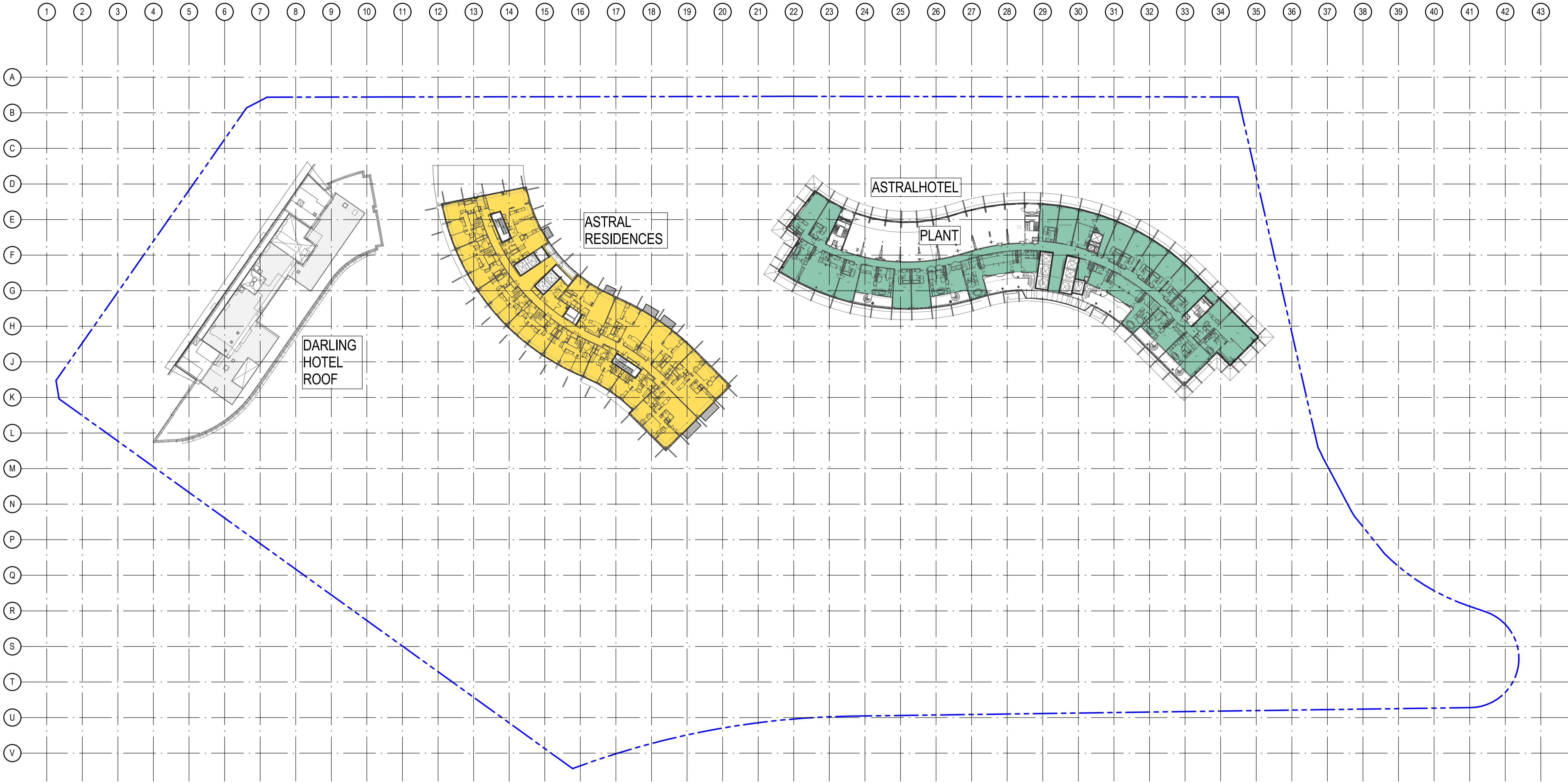

- Consultants**
- Planner, Heritage & Social
URBIS
 - Structural & Civil Engineer
TAYLOR THOMSON WHITTING **TTW** Taylor Thomson Whitting
 - Structural, Mechanical & Fire Protection Engineer
WSP/BRINCKERHOFF **WSP** BRINCKERHOFF
 - Electrical, Communications & Hydraulic Engineer
LMCW LAL **LMCW** LAL
 - BCA Consultant
Mckenzie Group **mckenzie group**

North

PRELIMINARY
 NOT TO BE USED DURING CONSTRUCTION

EXISTING AREA	EXISTING PATRONS PER m ²
ASTRAL HOTEL (1447m ²)	@ 15 m ² / PERSON = 96 PAX
ASTRAL RESIDENCES (1385m ²)	@ 15 m ² / PERSON = 92 PAX
TOTAL AREA: 2832m²	TOTAL PATRONS: 188 PAX

B	MODIFICATION 14	15-09-2016		
A	TEST OF ADEQUACY	03-06-2016		
	Issue Description	Date	Chk	Auth
Architect				
dwp suters www.dwpsuters.com				
Project				
THE STAR - MODIFICATION 14				
Location				
80 PYRMONT STREET PYRMONT NSW 2009				
Client				
THE STAR ENTERTAINMENT GROUP				
THE STAR ENTERTAINMENT GROUP				
Drawing				
EXISTING SITE PLAN & GFA DIAGRAM - LEVEL 16				
Scale	Date Printed			
1: 500 @ A1	9/15/2016 12:11:55 PM			
Project Number	Drawing Number			Issue
303457	MOD14-A9016			B



File Name: D:\dwpsuters\REVIT\locat016\303457_THE STAR_MOD14_CENTRAL_R016.rvt

Notes
 The information contained in this document is copyright and may not be used or reproduced for any other project or purpose.
 Verify all dimensions and levels on site and report any discrepancies to dwp/suters for direction prior to the commencement of work.
 Drawings are to be read in conjunction with all other contract documents.
 Use figured dimensions only. Do not scale from drawings. dwp/suters cannot guarantee the accuracy of content and format for copies of drawings issued electronically.
 The completion of the Issue Details Checked and Authorised section is confirmation of the status of the drawing. The drawing shall not be used for construction unless endorsed 'For Construction' and authorised for issue.
 © dwp Australia Pty Ltd
 Registered Business Name dwp/suters ABN 37 169 328 018
 Robert Macdonald Nominated Architect NSW AIB 4699

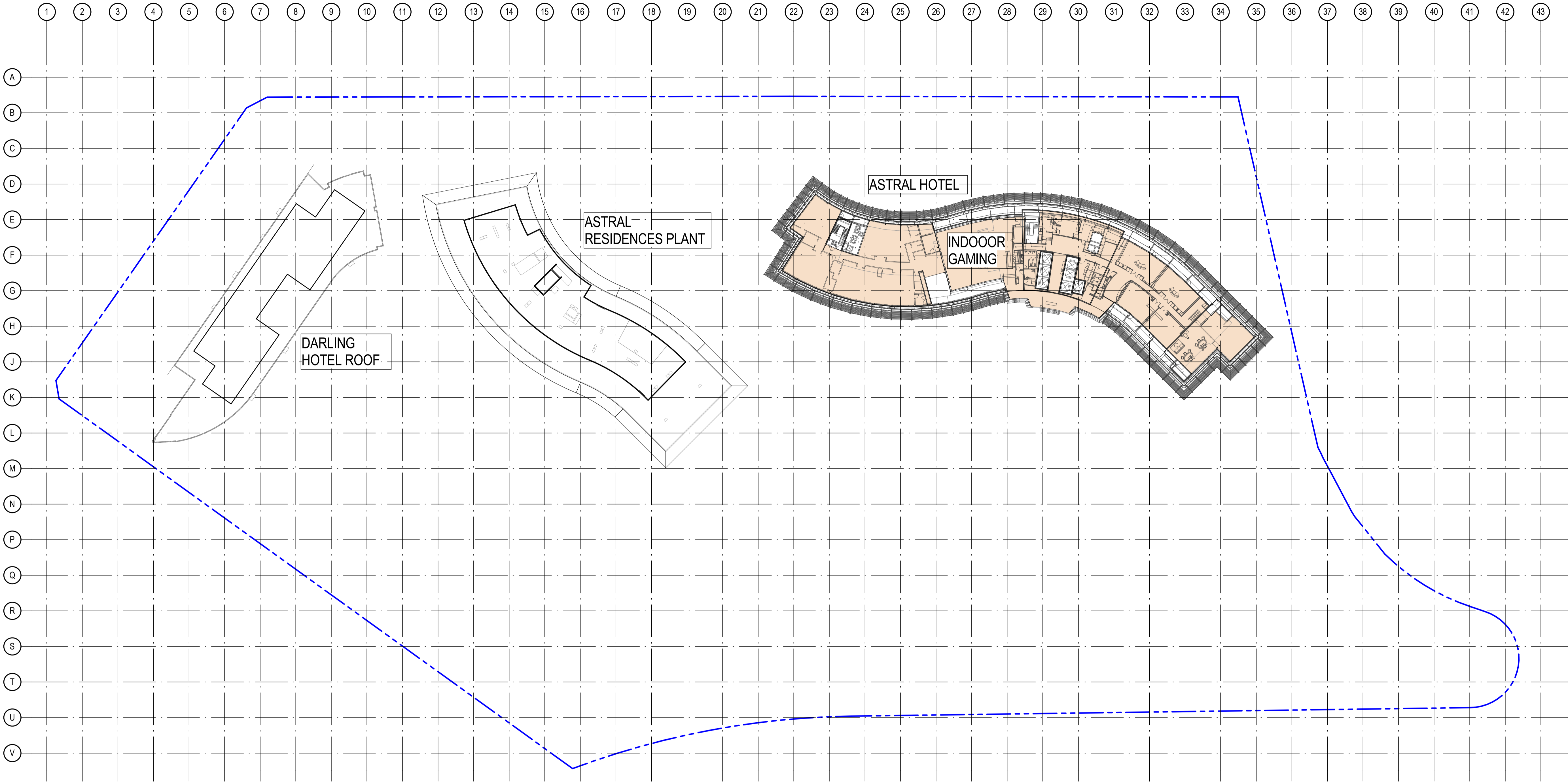

- Consultants**
- Planner, Heritage & Social
URBIS
 - Structural & Civil Engineer
TAYLOR THOMSON WHITTING
TTW Taylor Thomson Whitting
 - Structural, Mechanical & Fire
Protection Engineer
WSP PARSONS
BRINCKERHOFF
WSP PARSONS BRINCKERHOFF
 - Electrical, Communications &
Hydraulic Engineer
LMCW LAI
LMCW LAI
 - BCA Consultant
McKenzie Group
mckenzie group

North

PRELIMINARY
 NOT TO BE USED DURING CONSTRUCTION

EXISTING AREA	EXISTING PATRONS PER m ²
INDOOR GAMING (1700m ²)	@ 2.5 m ² / PERSON = 680 PAX

B	MODIFICATION 14	15-09-2016		
A	TEST OF ADEQUACY	03-06-2016		
Issue	Description	Date	Chk	Auth
Architect				
dwp/suters www.dwpsuters.com				
Project				
THE STAR - MODIFICATION 14				
Location				
80 PYRMONT STREET PYRMONT NSW 2009				
Client				
THE STAR ENTERTAINMENT GROUP				
THE STAR ENTERTAINMENT GROUP				
Drawing				
EXISTING SITE PLAN & GFA DIAGRAM - LEVEL 17				
Scale	Date Printed			
1: 500 @ A1	9/15/2016 12:12:05 PM			
Project Number	Drawing Number	Issue		
303457	MOD14-A9017	B		



File Name: D:\dwpsuters\REV\T\test\016\303457_THE STAR_MOD14_CENTRAL_R016_revised.rvt

Notes
 The information contained in this document is copyright and may not be used or reproduced for any other project or purpose.
 Verify all dimensions and levels on site and report any discrepancies to dwp/suters for direction prior to the commencement of work.
 Drawings are to be read in conjunction with all other contract documents.
 Use figured dimensions only. Do not scale from drawings. dwp/suters cannot guarantee the accuracy of content and format for copies of drawings issued electronically.
 The completion of the Issue Details Checked and Authorised section is confirmation of the status of the drawing. The drawing shall not be used for construction unless endorsed 'For Construction' and authorised for issue.
 © dwp Australia Pty Ltd
 Registered Business Name dwp/suters ABN 37 169 328 018
 Robert Macdonald Nominated Architect NSW AIB 4699

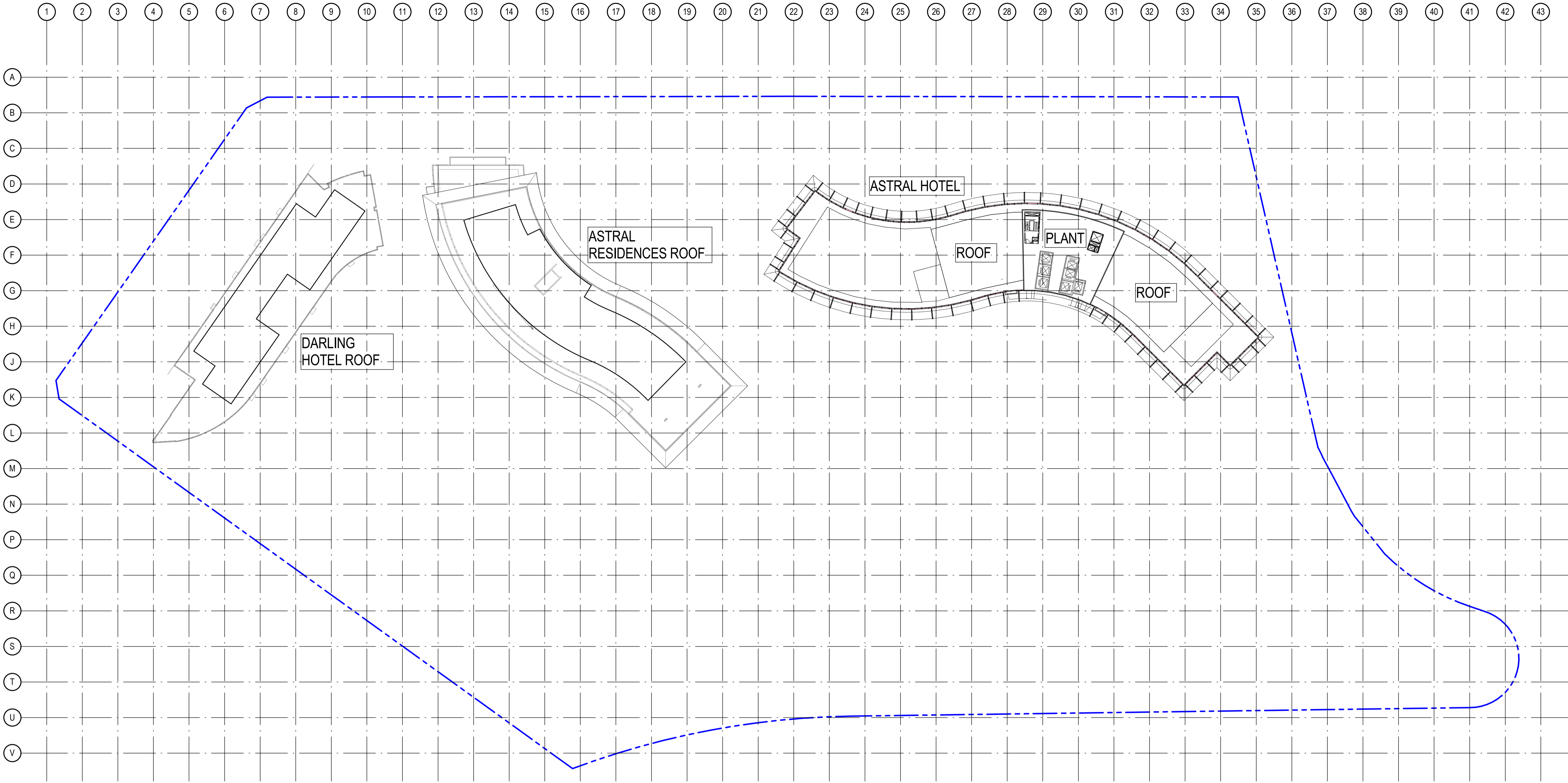

- Consultants**
- Planner, Heritage & Social
URBIS
 - Structural & Civil Engineer
TAYLOR THOMSON WHITTING
TTW Taylor Thomson Whitting
 - Structural, Mechanical & Fire
Protection Engineer
WSP/BRINCKERHOFF
WSP BRINCKERHOFF
 - Electrical, Communications &
Hydraulic Engineer
LMCW LAL
LMCW LAL
 - BCA Consultant
McKenzie Group
mckenzie group

North

PRELIMINARY
 NOT TO BE USED DURING CONSTRUCTION

B	MODIFICATION 14	15-09-2016		
A	TEST OF ADEQUACY	03-06-2016		
	Issue Description	Date	Chk	Auth
Architect				
dwp/suters www.dwpsuters.com				
Project				
THE STAR - MODIFICATION 14				
Location				
80 PYRMONT STREET PYRMONT NSW 2009				
Client				
THE STAR ENTERTAINMENT GROUP				
THE STAR ENTERTAINMENT GROUP				
Drawing				
EXISTING SITE PLAN & GFA DIAGRAM - LEVEL 18				
Scale	Date Printed			
1:500 @ A1	9/15/2016 12:12:20 PM			
Project Number	Drawing Number	Issue		
303457	MOD14-A9018	B		



File Name: D:\dwpsuters\REVIT\303457_THE STAR_MOD14_CENTRAL_R018.dwg

Notes
 The information contained in this document is copyright and may not be used or reproduced for any other project or purpose.
 Verify all dimensions and levels on site and report any discrepancies to dwp/suters for direction prior to the commencement of work.
 Drawings are to be read in conjunction with all other contract documents.
 Use figured dimensions only. Do not scale from drawings. dwp/suters cannot guarantee the accuracy of content and format for copies of drawings issued electronically.
 The completion of the Issue Details Checked and Authorised section is confirmation of the status of the drawing. The drawing shall not be used for construction unless endorsed 'For Construction' and authorised for issue.
 © dwp Australia Pty Ltd
 Registered Business Name dwp/suters ABN 37 169 328 018
 Robert McKenzie Nominated Architect NSW AIB 4699

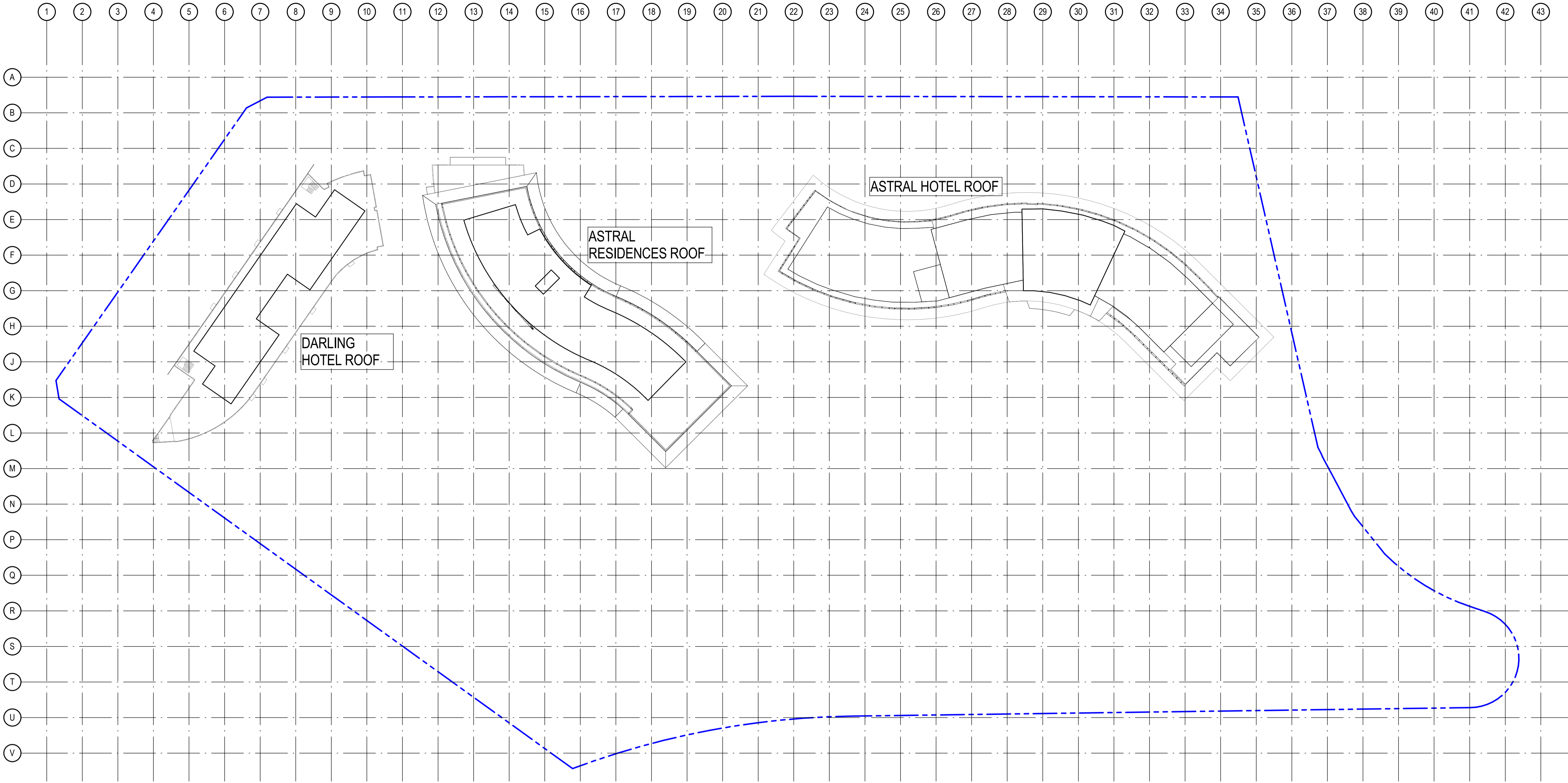

- Consultants**
- Planner, Heritage & Social
URBIS
 - Structural & Civil Engineer
TAYLOR THOMSON WHITTING
TTW Taylor Thomson Whitting
 - Structural, Mechanical & Fire
Protection Engineer
WSP/PARSONS BRINCKERHOFF
WSP PARSONS BRINCKERHOFF
 - Electrical, Communications &
Hydraulic Engineer
LMCW LAL
 - BCA Consultant
McKenzie Group
mckenzie group

North

PRELIMINARY
 NOT TO BE USED DURING CONSTRUCTION

B	MODIFICATION 14	15-09-2016		
A	TEST OF ADEQUACY	03-06-2016		
Issue	Description	Date	Chk	Auth
Architect				
dwp/suters www.dwpsuters.com				
Project				
THE STAR - MODIFICATION 14				
Location				
80 PYRMONT STREET PYRMONT NSW 2009				
Client				
THE STAR ENTERTAINMENT GROUP				
THE STAR ENTERTAINMENT GROUP				
Drawing				
EXISTING SITE PLAN & GFA DIAGRAM - ROOF				
Scale	Date Printed			
1:500 @ A1	9/15/2016 12:12:32 PM			
Project Number	Drawing Number	Issue		
303457	MOD14-A9019	B		



File Name: D:\dwpsuters\REVIT\303457_THE STAR_MOD14_CENTRAL_ROOTE_bromont