

Notes  
 The information contained in this document is copyright and may not be used or reproduced for any other project or purpose.  
 Verify all dimensions and levels on site and report any discrepancies to dwp/suters for direction prior to the commencement of work.  
 Drawings are to be read in conjunction with all other contract documents.  
 Use figured dimensions only. Do not scale from drawings. dwp/suters cannot guarantee the accuracy of content and format for copies of drawings issued electronically.  
 The completion of the Issue Details Checked and Authorised section is confirmation of the status of the drawing. The drawing shall not be used for construction unless endorsed 'For Construction' and authorised for issue.  
 © dwp Australia Pty Ltd  
 Registered Business Name dwp/suters ABN 37 169 328 018  
 Robert Mackenzie Nominated Architect NSW AIB 4699

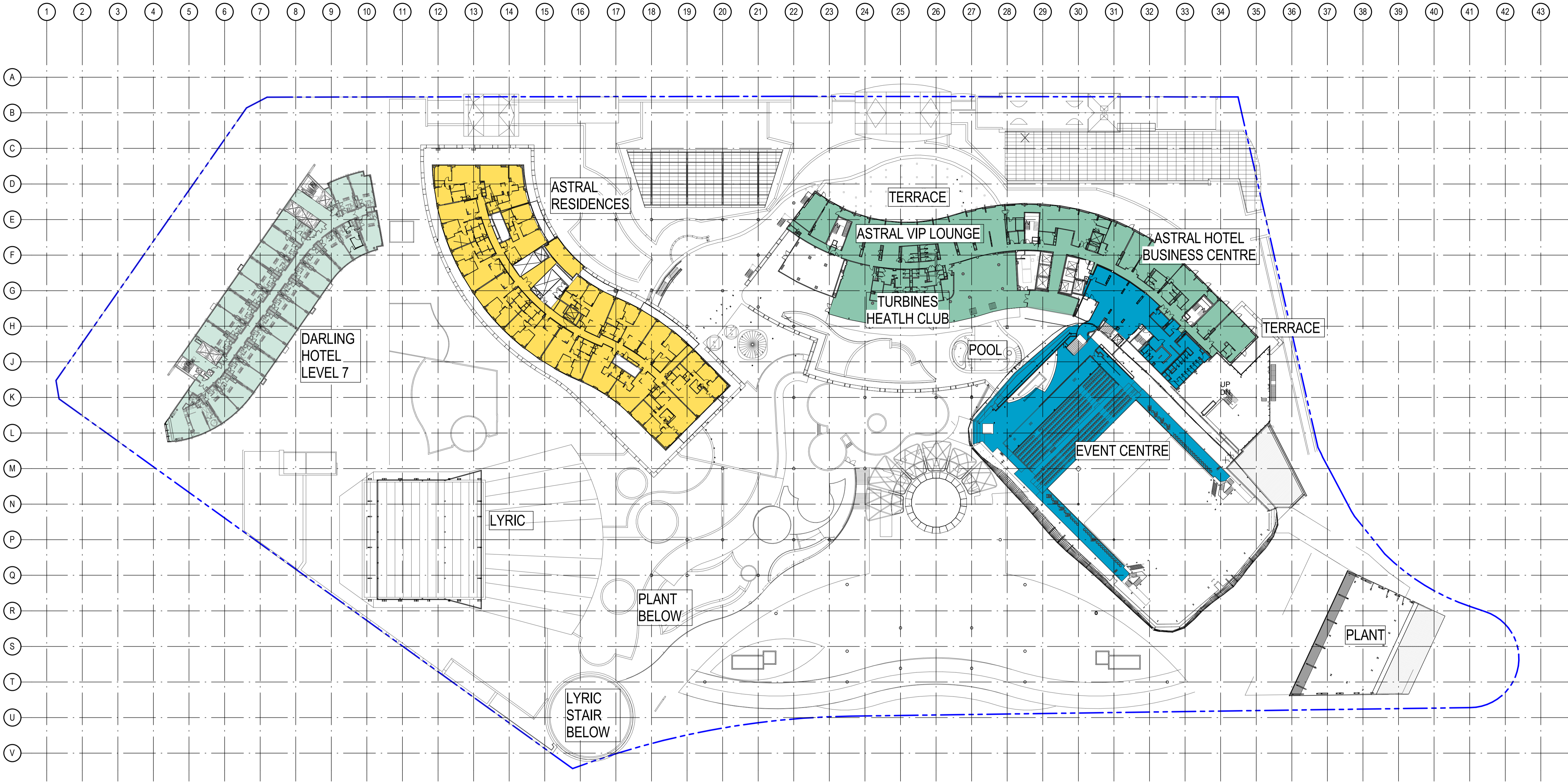

- Consultants
- Planner, Heritage & Social  
URBIS
  - Structural & Civil Engineer  
TAYLOR THOMSON WHITTING  
TTW Taylor Thomson Whitting
  - Structural, Mechanical & Fire  
Protection Engineer  
WSP PARSONS  
BRINCKERHOFF  
WSP PARSONS BRINCKERHOFF
  - Electrical, Communications &  
Hydraulic Engineer  
LMCW LAI  
LMCW LAI
  - BCA Consultant  
Mckenzie Group  
mckenzie group

North

**PRELIMINARY**  
 NOT TO BE USED DURING CONSTRUCTION

EXISTING AREA	EXISTING PATRONS PER m <sup>2</sup>
DARLING HOTEL (1159m <sup>2</sup> )	@ 15 m <sup>2</sup> / PERSON = 77 PAX
ASTRAL HOTEL (1790m <sup>2</sup> )	@ 15 m <sup>2</sup> / PERSON = 119 PAX
ASTRAL RESIDENCES (1618m <sup>2</sup> )	@ 15 m <sup>2</sup> / PERSON = 108 PAX
THEATRE (1256m <sup>2</sup> )	@ 1 m <sup>2</sup> / PERSON = 1256 PAX
<b>TOTAL AREA: 5823m<sup>2</sup></b>	<b>TOTAL PATRONS: 1560 PAX</b>

B MODIFICATION 14 15-09-2016  
 A TEST OF ADEQUACY 03-06-2016  
 Issue Description Date Chk Auth  
 Architect  
 dwp/suters  
 www.dwpsuters.com  
 Project  
 THE STAR - MODIFICATION 14  
 Location  
 80 PYRMONT STREET  
 PYRMONT NSW 2009  
 Client  
 THE STAR ENTERTAINMENT GROUP  
**THE STAR**  
 ENTERTAINMENT GROUP  
 Drawing  
 EXISTING SITE PLAN & GFA DIAGRAM -  
 LEVEL 05  
 Scale Date Printed  
 1:500 @ A1 9/15/2016 12:07:07 PM  
 Project Number Drawing Number Issue  
 303457 MOD14-A9005 B



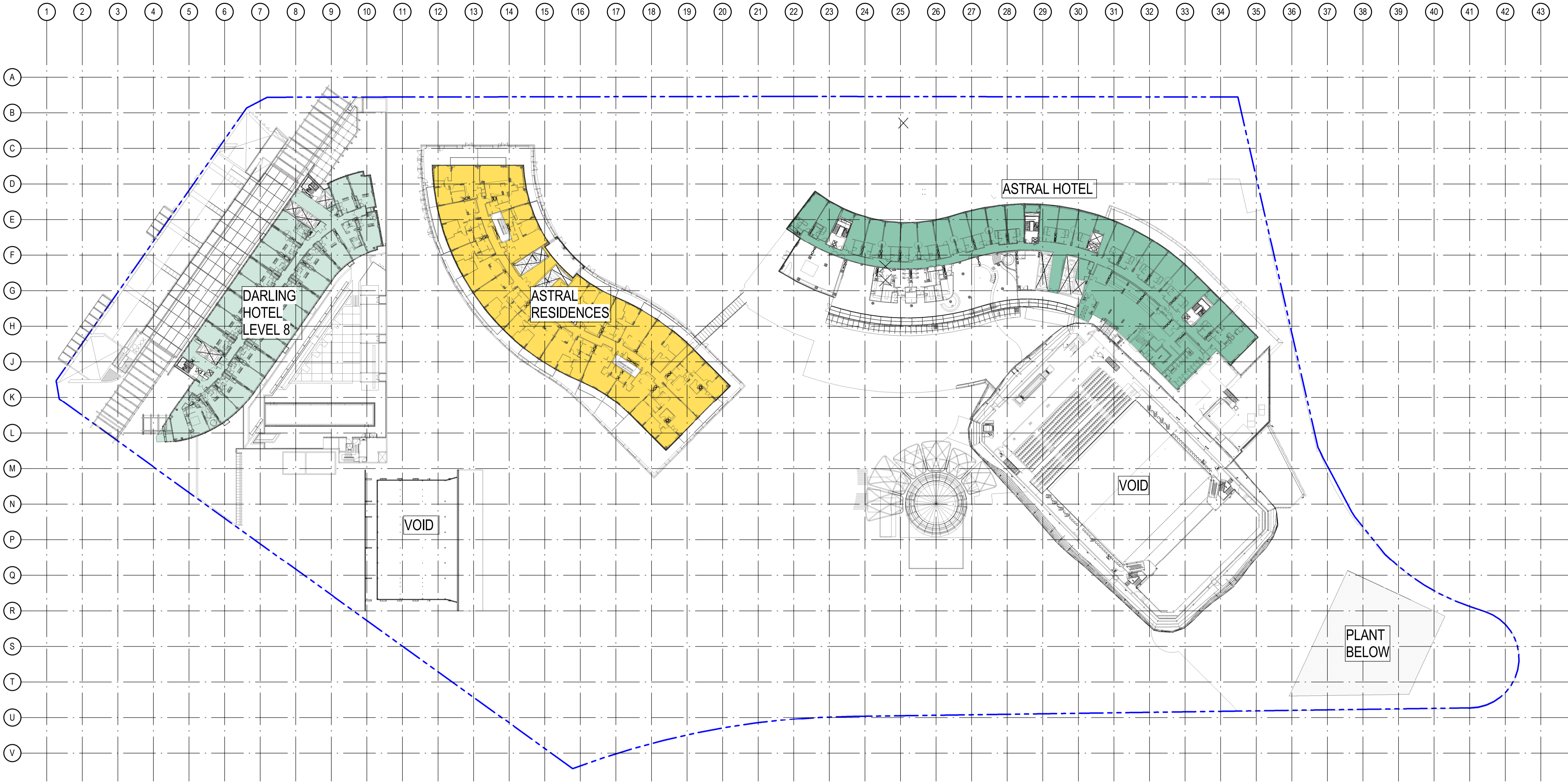

File Name: D:\dwpsuters\REV\T\303457\_THE STAR\_MOD14\_CENTRAL\_R016.rvt

Notes  
 The information contained in this document is copyright and may not be used or reproduced for any other project or purpose.  
 Verify all dimensions and levels on site and report any discrepancies to dwp/suters for direction prior to the commencement of work.  
 Drawings are to be read in conjunction with all other contract documents.  
 Use figured dimensions only. Do not scale from drawings. dwp/suters cannot guarantee the accuracy of content and format for copies of drawings issued electronically.  
 The completion of the Issue Details Checked and Authorised section is confirmation of the status of the drawing. The drawing shall not be used for construction unless endorsed 'For Construction' and authorised for issue.  
 © dwp Australia Pty Ltd  
 Registered Business Name dwp/suters ABN 37 169 328 018  
 Robert McKenzie Nominated Architect NSW AIB 4699



- Consultants**
- Planner, Heritage & Social URBIS
  - Structural & Civil Engineer TAYLOR THOMSON WHITTING TTW Taylor Thomson Whitting
  - Structural, Mechanical & Fire Protection Engineer WSP/BRINCKERHOFF WSP BRINCKERHOFF
  - Electrical, Communications & Hydraulic Engineer LMOW LAI
  - BCA Consultant Mckenzie Group mckenzie group

EXISTING AREA	EXISTING PATRONS PER m <sup>2</sup>
 DARLING HOTEL (1167m <sup>2</sup> )	@ 15 m <sup>2</sup> / PERSON = 78 PAX
 ASTRAL HOTEL (1556m <sup>2</sup> )	@ 15 m <sup>2</sup> / PERSON = 104 PAX
 ASTRAL RESIDENCES (1625m <sup>2</sup> )	@ 15 m <sup>2</sup> / PERSON = 108 PAX
<b>TOTAL AREA: 4348m<sup>2</sup></b>	<b>TOTAL PATRONS: 290 PAX</b>

B MODIFICATION 14 15-09-2016  
 A TEST OF ADEQUACY 03-06-2016  
 Issue Description Date Chk Auth  
 Architect  
 dwp/suters  
 www.dwpsuters.com  
 Project  
 THE STAR - MODIFICATION 14  
 Location  
 80 PYRMONT STREET  
 PYRMONT NSW 2009  
 Client  
 THE STAR ENTERTAINMENT GROUP  
**THE STAR**  
 ENTERTAINMENT GROUP  
 Drawing  
 EXISTING SITE PLAN & GFA DIAGRAM - LEVEL 06  
 Scale Date Printed  
 1: 500 @ A1 9/15/2016 12:10:08 PM  
 Project Number Drawing Number Issue  
 303457 MOD14-A9006 B



File Name: D:\dwpsuters\REV\T\303457\_THE STAR\_MOD14\_CENTRAL\_R016.premprint

Notes  
 The information contained in this document is copyright and may not be used or reproduced for any other project or purpose.  
 Verify all dimensions and levels on site and report any discrepancies to dwp|suters for direction prior to the commencement of work.  
 Drawings are to be read in conjunction with all other contract documents.  
 Use figured dimensions only. Do not scale from drawings. dwp|suters cannot guarantee the accuracy of content and format for copies of drawings issued electronically.  
 The completion of the Issue Details Checked and Authorised section is confirmation of the status of the drawing. The drawing shall not be used for construction unless endorsed 'For Construction' and authorised for issue.  
 © dwp Australia Pty Ltd  
 Registered Business Name dwp|suters ABN 37 169 320 018  
 Robert Macdonald Nominated Architect NSW AIB 4699

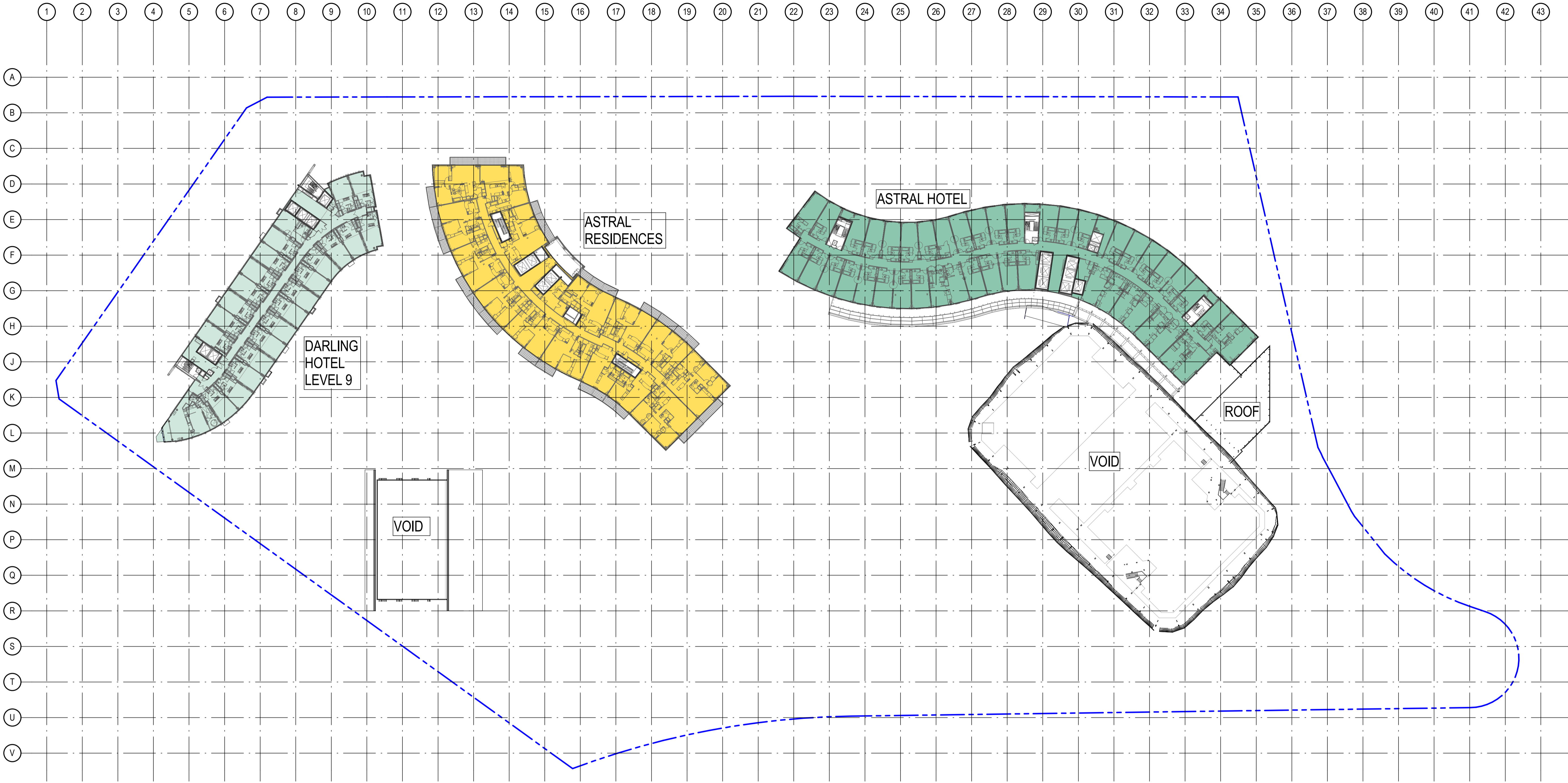

- Consultants**
- Planner, Heritage & Social URBIS
  - Structural & Civil Engineer TAYLOR THOMSON WHITTING TTW Taylor Thomson Whitting
  - Structural, Mechanical & Fire Protection Engineer WSP|PARSONS BRINCKERHOFF WSP PARSONS BRINCKERHOFF
  - Electrical, Communications & Hydraulic Engineer LMOW LAI
  - BCA Consultant Mckenzie Group

North

**PRELIMINARY**  
 NOT TO BE USED DURING CONSTRUCTION

EXISTING AREA	EXISTING PATRONS PER m <sup>2</sup>
DARLING HOTEL (1167m <sup>2</sup> )	@ 15 m <sup>2</sup> / PERSON = 78 PAX
ASTRAL HOTEL (2045m <sup>2</sup> )	@ 15 m <sup>2</sup> / PERSON = 136 PAX
ASTRAL RESIDENCES (1625m <sup>2</sup> )	@ 15 m <sup>2</sup> / PERSON = 108 PAX
<b>TOTAL AREA: 4837m<sup>2</sup></b>	<b>TOTAL PATRONS: 322 PAX</b>

B MODIFICATION 14 15-09-2016  
 A TEST OF ADEQUACY 03-06-2016  
 Issue Description Date Chk Auth  
 Architect  
 dwp|suters  
 www.dwpsuters.com  
 Project  
 THE STAR - MODIFICATION 14  
 Location  
 80 PYRMONT STREET  
 PYRMONT NSW 2009  
 Client  
 THE STAR ENTERTAINMENT GROUP  
**THE STAR**  
 ENTERTAINMENT GROUP  
 Drawing  
 EXISTING SITE PLAN & GFA DIAGRAM - LEVEL 07  
 Scale Date Printed  
 1:500 @ A1 9/15/2016 12:10:23 PM  
 Project Number Drawing Number Issue  
 303457 MOD14-A9007 B



File Name: D:\dwpsuters\REV\T\303457\_THE STAR\_MOD14\_CENTRAL\_R01E.rvt

Notes  
 The information contained in this document is copyright and may not be used or reproduced for any other project or purpose.  
 Verify all dimensions and levels on site and report any discrepancies to dwp/suters for direction prior to the commencement of work.  
 Drawings are to be read in conjunction with all other contract documents.  
 Use figured dimensions only. Do not scale from drawings. dwp/suters cannot guarantee the accuracy of content and format for copies of drawings issued electronically.  
 The completion of the Issue Details Checked and Authorised section is confirmation of the status of the drawing. The drawing shall not be used for construction unless endorsed 'For Construction' and authorised for issue.  
 © dwp Australia Pty Ltd  
 Registered Business Name dwp/suters ABN 37 169 328 018  
 Robert Macdonald Nominated Architect NSW AIB 4699

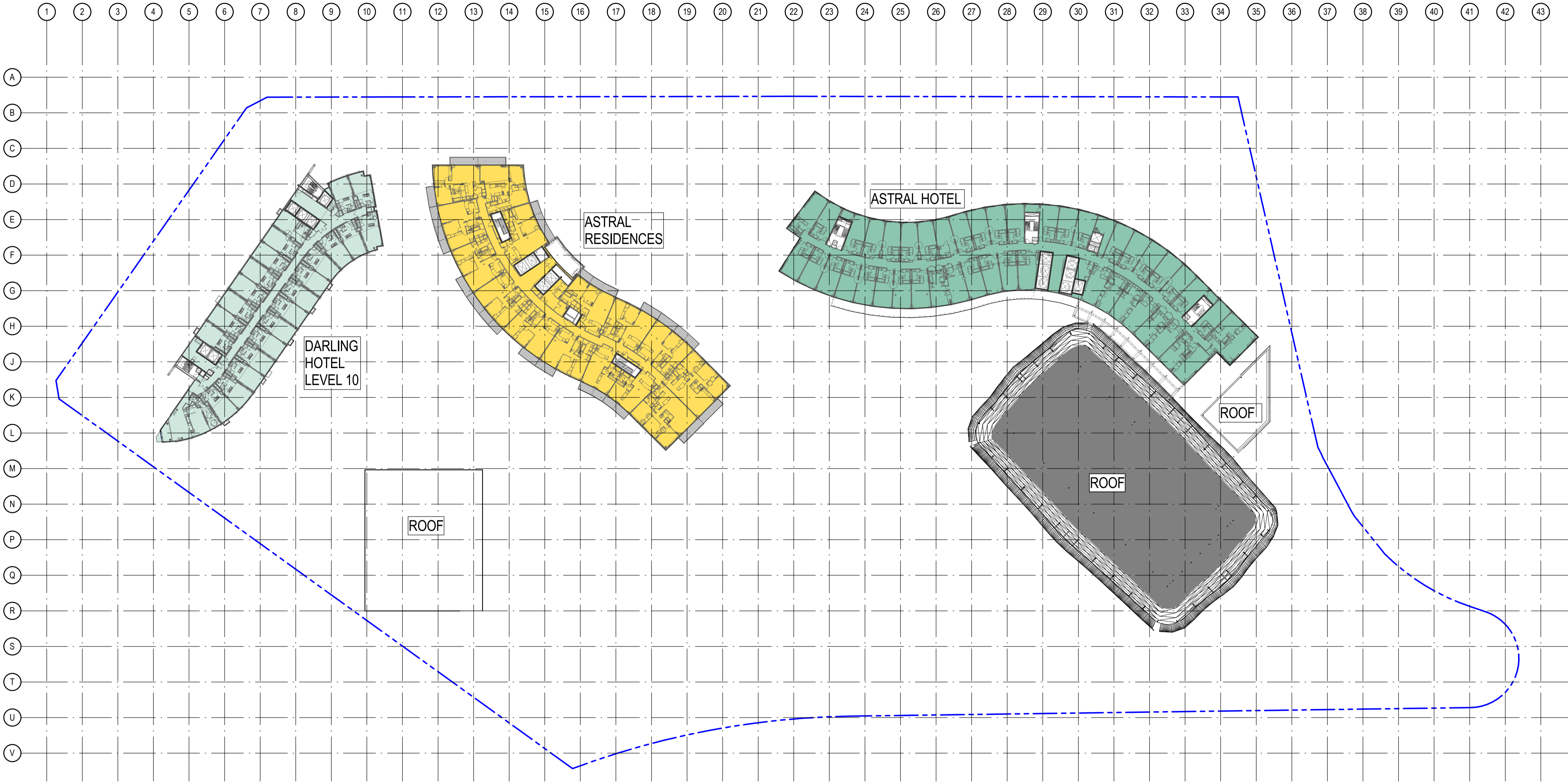

- Consultants**
- Planner, Heritage & Social URBIS
  - Structural & Civil Engineer TAYLOR THOMSON WHITTING TTW Taylor Thomson Whitting
  - Structural, Mechanical & Fire Protection Engineer WSP/BRINCKENHOFF WSP BRINCKENHOFF
  - Electrical, Communications & Hydraulic Engineer LMOW LAI
  - BCA Consultant Mckenzie Group

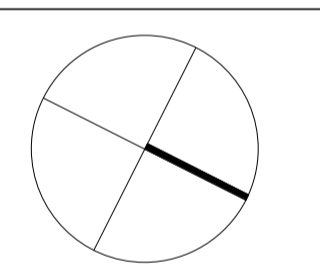

**PRELIMINARY**  
 NOT TO BE USED DURING CONSTRUCTION

EXISTING AREA	EXISTING PATRONS PER m <sup>2</sup>
DARLING HOTEL (1167m <sup>2</sup> )	@ 15 m <sup>2</sup> / PERSON = 78 PAX
ASTRAL HOTEL (2045m <sup>2</sup> )	@ 15 m <sup>2</sup> / PERSON = 136 PAX
ASTRAL RESIDENCES (1625m <sup>2</sup> )	@ 15 m <sup>2</sup> / PERSON = 108 PAX
<b>TOTAL AREA: 4837m<sup>2</sup></b>	<b>TOTAL PATRONS: 322 PAX</b>

B	MODIFICATION 14	15-09-2016		
A	TEST OF ADEQUACY	03-06-2016		
	Issue Description	Date	Chk	Auth
Architect				
dwp/suters www.dwpsuters.com				
Project				
THE STAR - MODIFICATION 14				
Location				
80 PYRMONT STREET PYRMONT NSW 2009				
Client				
THE STAR ENTERTAINMENT GROUP				
<b>THE STAR</b> ENTERTAINMENT GROUP				
Drawing				
EXISTING SITE PLAN & GFA DIAGRAM - LEVEL 08				
Scale				
1: 500 @ A1				
Date Printed				
9/15/2016 12:10:41 PM				
Project Number				
303457				
Drawing Number				
MOD14-A9008				
Issue				
B				



File Name: D:\dwpsuters\REV\T\303457\_THE STAR\_MOD14\_CENTRAL\_R01E.dwg

Notes  
 The information contained in this document is copyright and may not be used or reproduced for any other project or purpose.  
 Verify all dimensions and levels on site and report any discrepancies to dwp|suters for direction prior to the commencement of work.  
 Drawings are to be read in conjunction with all other contract documents.  
 Use figured dimensions only. Do not scale from drawings. dwp|suters cannot guarantee the accuracy of content and format for copies of drawings issued electronically.  
 The completion of the Issue Details Checked and Authorised section is confirmation of the status of the drawing. The drawing shall not be used for construction unless endorsed 'For Construction' and authorised for issue.  
 © dwp Australia Pty Ltd  
 Registered Business Name dwp|suters ABN 37 169 238 018  
 Robert McKenzie Nominated Architect NSW AIB 4699

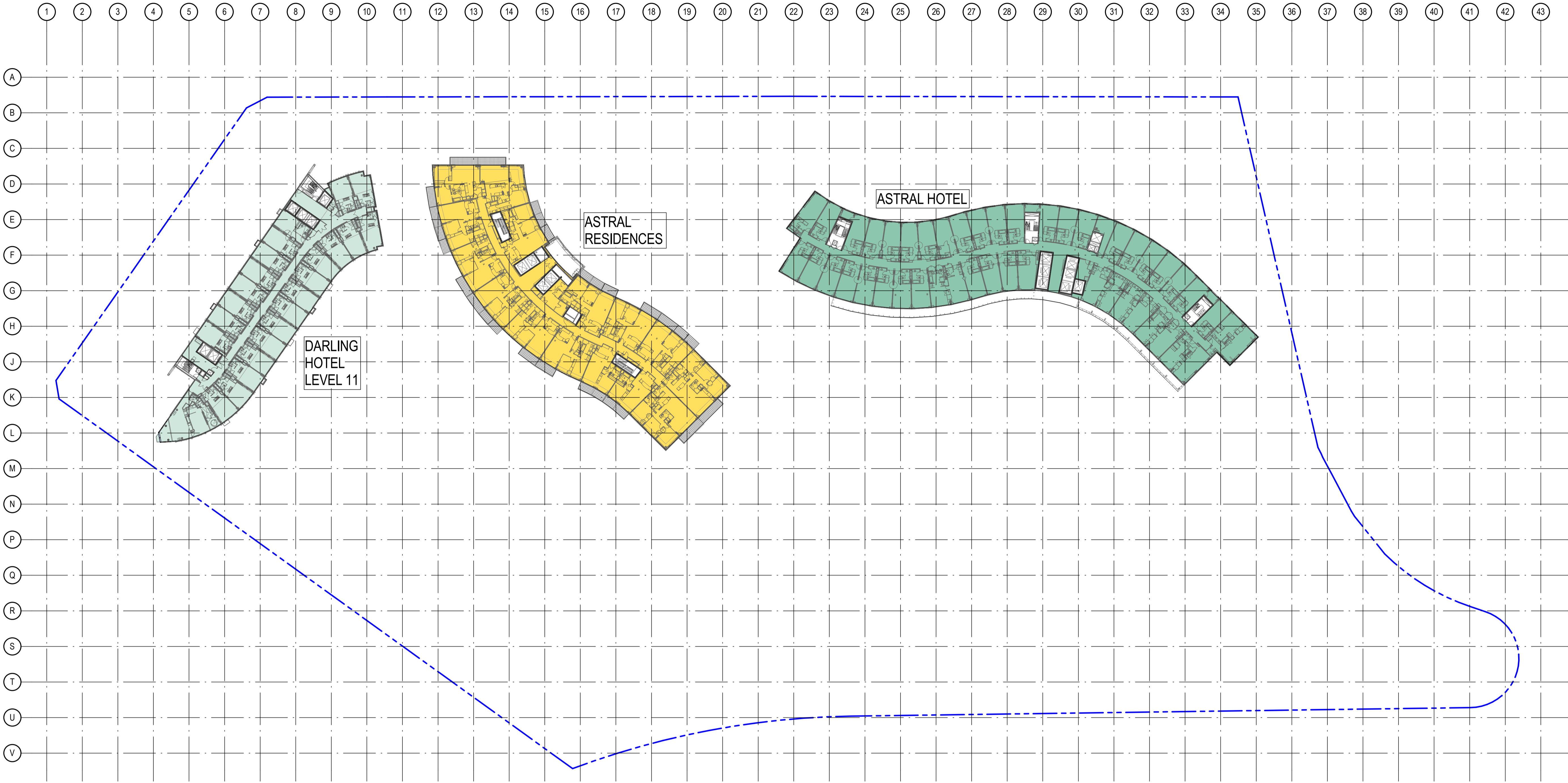

- Consultants**
- Planner, Heritage & Social URBIS
  - Structural & Civil Engineer TAYLOR THOMSON WHITTING TTW Taylor Thomson Whitting
  - Structural, Mechanical & Fire Protection Engineer WSP PARSONS BRINCKERHOFF WSP PARSONS BRINCKERHOFF
  - Electrical, Communications & Hydraulic Engineer LMOW LAI
  - BCA Consultant Mckenzie Group

North

**PRELIMINARY**  
 NOT TO BE USED DURING CONSTRUCTION

EXISTING AREA	EXISTING PATRONS PER m <sup>2</sup>
DARLING HOTEL (1167m <sup>2</sup> )	@ 15 m <sup>2</sup> / PERSON = 78 PAX
ASTRAL HOTEL (2045m <sup>2</sup> )	@ 15 m <sup>2</sup> / PERSON = 136 PAX
ASTRAL RESIDENCES (1625m <sup>2</sup> )	@ 15 m <sup>2</sup> / PERSON = 108 PAX
<b>TOTAL AREA: 4837m<sup>2</sup></b>	<b>TOTAL PATRONS: 322 PAX</b>

B MODIFICATION 14 15-09-2016  
 A TEST OF ADEQUACY 03-06-2016  
 Issue Description Date Chk Auth  
 Architect  
 dwp|suters  
 www.dwpsuters.com  
 Project  
 THE STAR - MODIFICATION 14  
 Location  
 80 PYRMONT STREET  
 PYRMONT NSW 2009  
 Client  
 THE STAR ENTERTAINMENT GROUP  
**THE STAR**  
 ENTERTAINMENT GROUP  
 Drawing  
 EXISTING SITE PLAN & GFA DIAGRAM - LEVEL 09  
 Scale Date Printed  
 1:500 @ A1 9/15/2016 12:10:54 PM  
 Project Number Drawing Number Issue  
 303457 MOD14-A9009 B



File Name: D:\dwpsuters\REVIT\tsa\0216\303457\_THE STAR\_MOD14\_CENTRAL\_R016.rvt