

SIGNATURES, SEALS AND STATEMENTS of intention to dedicate public roads or to create reserves, drainage reserves, easements, restrictions on the use of land or positive covenants.

SIGNED FOR THE ELECTRICITY COMMISSION OF N.S.W. PURSUANT TO A DELEGATION MADE ON 23rd JULY 1992.
MANAGER PROPERTY ASSETS

Crown Lands Office Approval
 PLAN APPROVED
 Land District
 Paper No.
 Field Book
 pages

Council Clerk's Certificate
 I hereby certify that -
 (a) the requirements of the Local Government Act, 1919 (other than the requirements for the registration of plans), and
 (b) the requirements of Part 3 Division 2 of the Water Board Act 1987 and the Water Supply Authorities Act 1987
 have been complied with by the applicant in relation to the proposed
 (insert "new road", "subdivision" or "consolidation" as appropriate)
 Subdivision No.
 Date
 (Signature)
 Council Clerk

SURVEYOR'S REFERENCE: S.L. 92/244 CHECKLIST

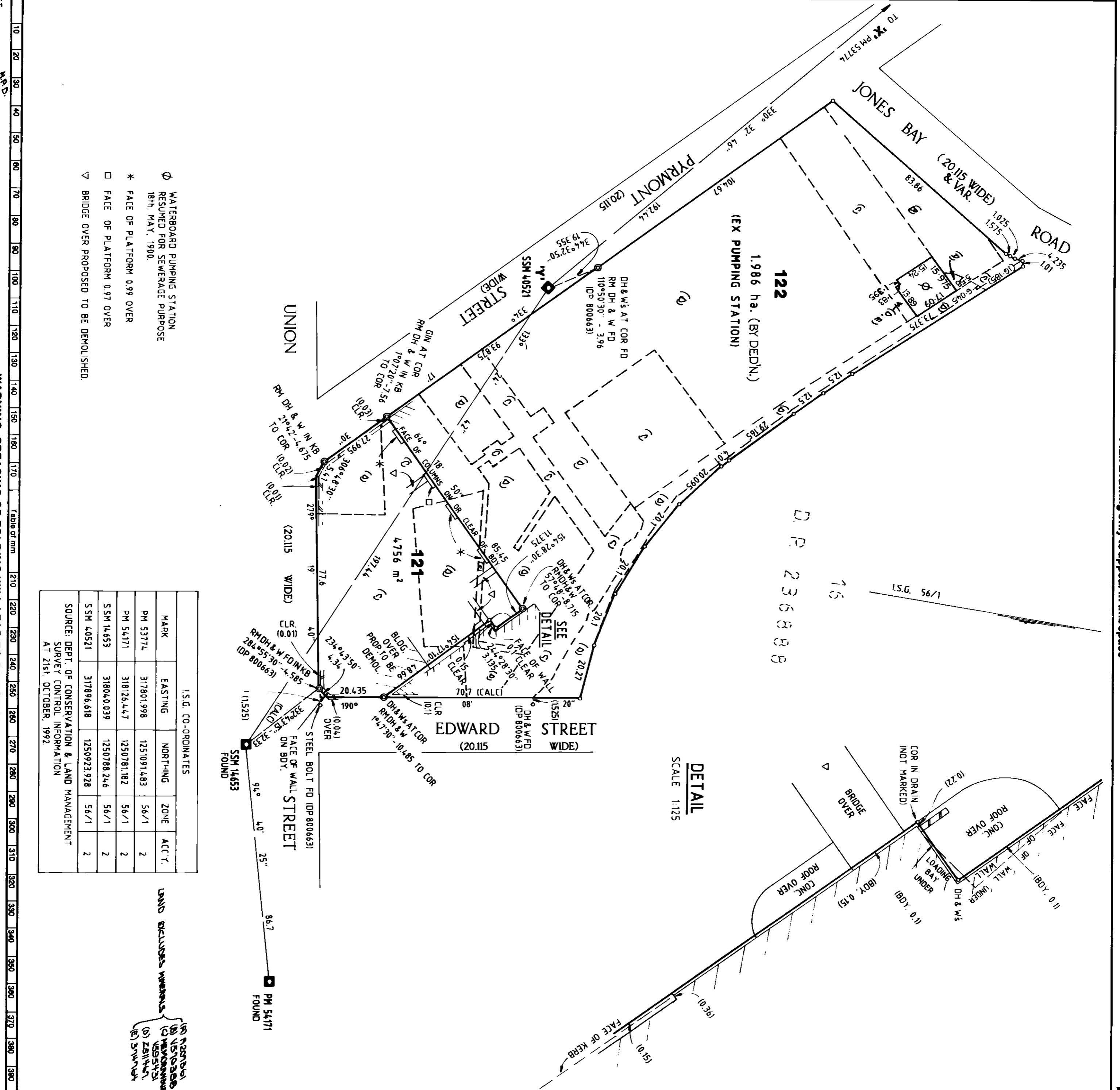

- ◊ WATERBOARD PUMPING STATION RESUMED FOR SEWERAGE PURPOSE 18th. MAY. 1900.
- * FACE OF PLATFORM 0.99 OVER
- FACE OF PLATFORM 0.97 OVER
- ▽ BRIDGE OVER PROPOSED TO BE DEMOLISHED.

WARNING: CREASING OR FOLDING WILL LEAD TO REJECTION

Table of mm

10	20	30	40	50	60	70	80	90	100	110	120	130	140	150	160	170	180	190	200	210	220	230	240	250	260	270	280	290	300	310	320	330	340	350	360	370	380	390
----	----	----	----	----	----	----	----	----	-----	-----	-----	-----	-----	-----	-----	-----	-----	-----	-----	-----	-----	-----	-----	-----	-----	-----	-----	-----	-----	-----	-----	-----	-----	-----	-----	-----	-----	-----

I.S.G. CO-ORDINATES

MARK	EASTING	NORTHING	ZONE	ACCT.
PM 53774	317801.998	1251091.483	56/1	2
PM 54171	318128.447	1250781.182	56/1	2
SSM 14653	318040.039	1250788.246	56/1	2
SSM 40521	317896.618	1250923.928	56/1	2

SOURCE: DEPT. OF CONSERVATION & LAND MANAGEMENT SURVEY CONTROL INFORMATION AT 21st. OCTOBER, 1992.

LAND EXCLUDED WHEREAS (A) PARTIAL (B) PARTIAL (C) PARTIAL (D) PARTIAL (E) PARTIAL

OFFICE USE ONLY

D.P. 828957

Registered: 21.4.1993

C.A. _____

Title System: TORRENS

Purpose: SUBMISSION

Ref. Map: PARISH

Last Plan: ROLL PLAN 1988

PLAN OF SUBDIVISION OF LOT 12 D.P. 800663 (F.L. 12/800663).

Lengths are in metres. Reduction Ratio 1:1000

City: SYDNEY

Locality: PYRMONT

Parish: ST. ANDREW (No. 44)

County: CUMBERLAND

This is sheet 1 of 1 sheets. (Delete if inapplicable)

JOHN JAMES TIERNEY
 a surveyor registered under the Surveyors Act, 1929, as amended, hereby certify that the survey represented in this plan AS REGARDS LOT 121 is accurate and has been made in accordance with the Survey Regulations, 1953 and any special requirements of the Department of Lands and is completed on 2nd NOVEMBER, 1992.

Signature: (S.M. 53774-1)
 Datum: Lid of Astoria. X-Y (SSM 40521)
 Plans used in preparation of survey/development: D.P. 800663

PACIFIC POWER
 PROPERTY AND SURVEY GROUP

Pacific Power is the registered business name of The Electricity Commission of New South Wales.
PYRMONT POWER STATION

PANEL FOR USE ONLY for statements of intention to dedicate public roads or to create public reserves, drainage reserves, easements or restrictions as to user.

S.L. 92/244

P. 18458