

EROSION AND SEDIMENT CONTROLS

- ES1** ALL WORK SHALL BE GENERALLY CARRIED OUT IN ACCORDANCE WITH:
 - (A) LOCAL AUTHORITY REQUIREMENTS
 - (B) APPLICABLE - POLLUTION CONTROL MANUAL FOR URBAN STORMWATER
 - (C) DEPARTMENT OF CONSERVATION AND LAND MANAGEMENT MANUAL- "URBAN EROSION & SEDIMENT CONTROL".
 - (D) NSW PROTECTION OF THE ENVIRONMENT ACT 1997
- ES2** THE CONTRACTOR SHALL PREPARE EROSION AND SEDIMENT CONTROL DRAWINGS AND NOTES FOR THE WHOLE OF THE WORKS. SHOULD THE CONTRACTOR STAGE THESE WORKS THEN THE DESIGN MAY REQUIRE TO BE MODIFIED. VARIATION TO THESE DETAILS MAY REQUIRE TO BE APPROVED BY THE RELEVANT AUTHORITIES. THE EROSION AND SEDIMENT CONTROL PLAN SHALL BE IMPLEMENTED AND ADOPTED TO MEET THE VARYING SITUATIONS AS WORK ON SITE PROGRESSES.
- ES3** MAINTAIN ALL EROSION AND SEDIMENT CONTROL DEVICES TO THE SATISFACTION OF THE SUPERINTENDENT AND THE LOCAL AUTHORITY AS APPROPRIATE (IE. PRIVATE / PUBLIC LAND)
- ES4** AS STORMWATER PITS ARE CONSTRUCTED PREVENT SITE RUNOFF ENTERING. ERECT SILT FENCES AROUND PITS.
- ES5** MINIMISE THE AREA OF SITE DISTURBED AT ANY ONE TIME.
- ES6** PROTECT ALL STOCKPILES OF MATERIALS FROM SCOUR AND EROSION. DO NOT STOCKPILE LOOSE MATERIAL IN ROADWAYS, NEAR DRAINAGE PITS OR IN WATERCOURSES.
- ES7** ALL SOIL AND WATER CONTROL MEASURES ARE TO BE PUT BACK IN PLACE AT THE END OF EACH WORKING DAY, AND MODIFIED TO BEST SUIT SITE CONDITIONS.
- ES8** CONTROL WATER FROM UPSTREAM OF THE SITE SO THAT IT DOES NOT ENTER THE DISTURBED SITE.
- ES9** ALL CONSTRUCTION VEHICLES SHALL ENTER AND EXIT THE SITE VIA THE AGREED TEMPORARY CONSTRUCTION ENTRY/EXIT.
- ES10** ALL VEHICLES ASSOCIATED WITH CIVIL WORKS SHALL BE CLEANED AND INSPECTED BY THE CONTRACTOR BEFORE LEAVING THE SITE.
- ES11** MAINTAIN ALL STORMWATER PIPES AND PITS CLEAR OF DEBRIS AND SEDIMENT. THE CONTRACTOR SHALL INSPECT STORMWATER SYSTEM AND CLEAN OUT AFTER EACH STORM EVENT AND / OR WHEN DIRECTED
- ES12** THE CONTRACTOR SHALL CLEAN OUT ALL EROSION AND SEDIMENT CONTROL DEVICES AFTER EACH STORM EVENT.

SEQUENCE OF WORKS

- SQ1** PRIOR TO COMMENCEMENT OF EXCAVATION THE FOLLOWING SOIL MANAGEMENT DEVICES MUST BE INSTALLED.
 - (A) CONSTRUCT ALL SILT FENCES BELOW THE SITE AND ACROSS ALL POTENTIAL RUNOFF SITES
 - (B) CONSTRUCT TEMPORARY CONSTRUCTION ENTRY / EXIT AND DIVERT RUNOFF TO SUITABLE CONTROL SYSTEMS
 - (C) CONSTRUCT MEASURES TO DIVERT UPSTREAM FLOWS AROUND WORK(S) AREAS
 - (D) CONSTRUCT SEDIMENTATION TRAPS / BASIN INCLUDING OUTLET CONTROL AND OVERFLOW
 - (E) PROVIDE SAND BAG SEDIMENT TRAPS / GRAVEL SEDIMENT SAUSAGE UPSTREAM OF EXISTING PITS
- SQ2** CONSTRUCT GEOTEXTILE FILTER PIT SURROUND AROUND ALL PROPOSED PITS AS THEY ARE CONSTRUCTED
- SQ3** ON COMPLETION OF PAVEMENT PROVIDE GRAVEL SAUSAGE AT KERB INLET PITS.
- SQ4** PROVIDE AND MAINTAIN A 450 WIDE STRIP OF TURN ON BOTH SIDES OF ALL PAVEMENTS AFTER CONSTRUCTION

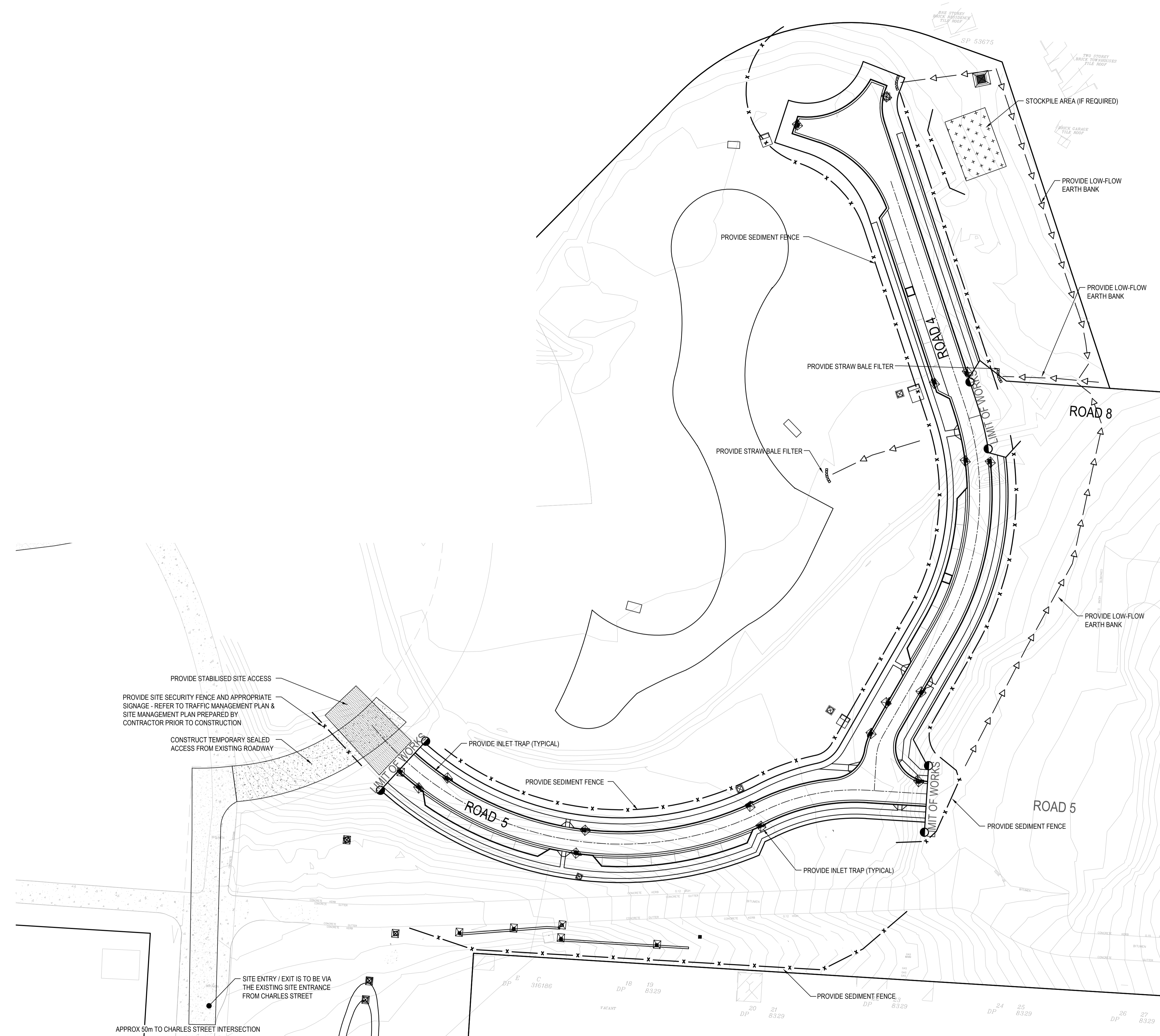

REV	DESCRIPTION	BY	APP	DATE
A	DRAFT CC ISSUE	RL	LD	03-09-10
B	CC ISSUE	RL	PD	08-09-10
D	REVISED FOR CONSTRUCTION CERTIFICATE	RL	LD	24-09-10
E	FOR INFORMATION	RL	LD	22-12-10
F	FOR SECTION 75W	RL	DB	04-03-11
G	RE-ISSUED FOR SECTION 75W	LC	DB	05-04-11
00	ISSUED FOR CONSTRUCTION	RL	DB	20-04-11

APPROX 50m TO CHARLES STREET INTERSECTION

Level 4, 66 Clarence Street
 Sydney NSW 2000
 Telephone: (02) 9699 3088
 Fax: (02) 9319 7508
 www.mearnsardt.com
 A.C.N. 951 627 591
 © Copyright

MEARNARDT
INFRASTRUCTURE & ENVIRONMENT

CLIENT		FRASERS PUTNEY PTY LTD		PROJECT	FRASERS PUTNEY RESIDENTIAL DEVELOPMENT CHARLES STREET, RYDE ROADS 4 & 5 WORKS		NORTH
DESIGNED	LD	DRAWN	RL	APPROVED	PD	SCALE @ A1 1:500	
STATUS		FOR CONSTRUCTION		TITLE	EROSION & SEDIMENT CONTROL PLAN		REV
				PROJECT No	104479-00- MIE051		00

DWG FILE: X:\104479_Putney Green (Fraser)\BIM\6.3.MIT.MIE051_3.MIT.MIE051_00.MIE051.dwg - MH PLOT TIME: 20 Apr 2011 5:05pm