

Important Notes:

BUILDING ENVELOPES SHOWN ARE FOR PLANNING PURPOSES ONLY TO CONFIRM THE REQUIRED BUILDING PAD (10m X 15m) FITS WITHIN EACH LOT, WHILST STILL MAINTAINING THE NECESSARY COUNCIL SETBACK REQUIREMENTS. AS SUCH, THIS PLAN IS NOT TO RESTRICT ANY DWELLING SITING ON EACH LOT.

ALL BUILDING ENVELOPE OFFSETS TO SIDE BOUNDARIES ARE IN COMPLIANCE WITH TWEED SHIRE COUNCIL REQUIREMENTS (I.E. SINGLE STOREY 0.9m, TWO STOREY 1.5m.)

KERBING & DESIGN CONTOURS SHOWN ARE INDICATIVE ONLY AND SUBJECT TO FINAL DETAILED ENGINEERING DESIGN.

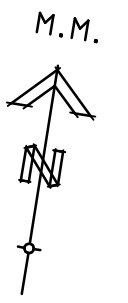

- (A) PROPOSED EASEMENT FOR ACCESS 2 WIDE & 4 WIDE (SUBJECT TO FINAL DETAILED DESIGN)
- (B) PROPOSED EASEMENT TO DRAIN SEWER AND WATER 3 WIDE (SUBJECT TO FINAL DETAILED DESIGN)
- (E) PROPOSED EASEMENT TO DRAIN WATER VARIABLE WIDTH (SUBJECT TO FINAL DETAILED DESIGN)

SHEET 1 of 2

Rev C – Amended Layout 24/11/09
 Rev B – Amended Lots 30 & 32 – 22/5/09
 Rev A – Amended Layout 21/5/09
 Revision

Chk'd

JACKSON INTERNATIONAL PTY LTD

Important Notes: (THIS NOTE IS AN INTEGRAL PART OF THIS PLAN)

THE PROPOSED LOT BOUNDARIES AND NUMBERS AS SHOWN HEREON ARE PRELIMINARY ONLY AND ARE SUBJECT TO FINAL DESIGN, LOCAL AUTHORITY APPROVAL AND REGISTRATION IN THE DEPARTMENT OF LANDS NSW.

Sheet Layout

SHEET 1

SHEET 2

⑥DENOTES INDICATIVE BUILDING SETBACK



DENOTES INDICATIVE 10m X 15m BUILDING PAD AS REQUIRED BY TWEED SHIRE COUNCIL

LOCATION PLAN

Showing Indicative Building Envelopes
 Lots 2 and 3 in DP244652
 Bilambil Road, Bilambil Village

Parish of TERRANORA County of ROUS

J: \15300\15337\Projects\17532D-C.pro

Scale	Level Datum	F.Bk	L.Bk	Drawn SDS
1 : 800	-	-	-	Chk'd

B & P SURVEYS CONSULTING SURVEYORS

A.B.N. 55 010117236
 30 Beryl Street
 Tweed Heads, NSW, 2485, Australia
 Telephone: (07) 5536 3611
 Fax: (07) 5536 3701
 Email: tweed@bpsurveys.com.au
 Webpage: www.bpsurveys.com.au



A QUALITY ASSURED COMPANY

Offices Also At : Surfers Paradise Murwillumbah
 Ph.(07)55390499 Ph.(02)66721924

Ref. No.	Date	Drawing No./Size	Rev.
T15337	17/03/09	17532 D	C

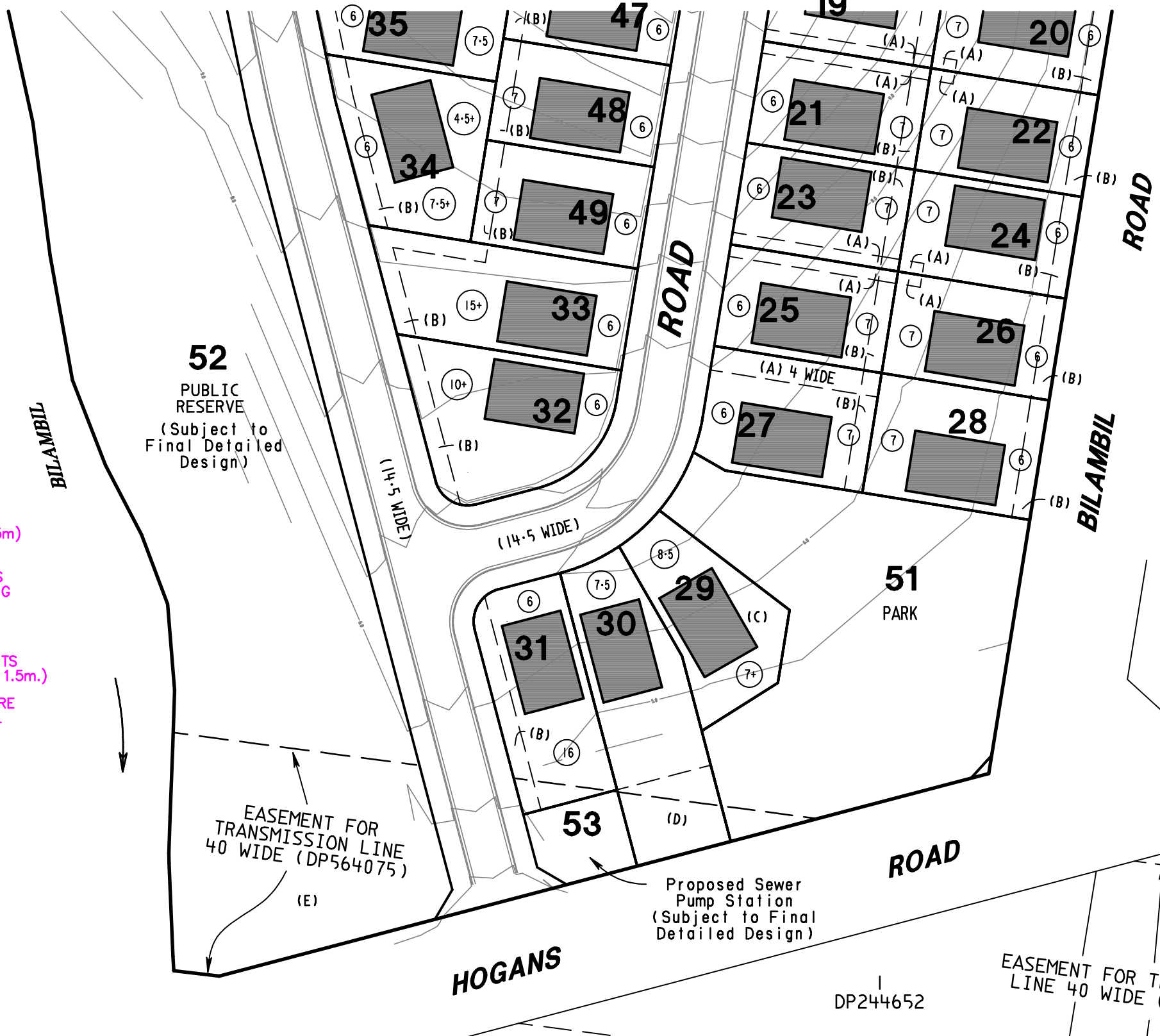
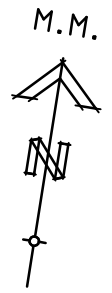

- (A) PROPOSED EASEMENT FOR ACCESS 2 WIDE & 4 WIDE (SUBJECT TO FINAL DETAILED DESIGN)
- (B) PROPOSED EASEMENT TO DRAIN SEWER AND WATER 3 WIDE (SUBJECT TO FINAL DETAILED DESIGN)
- (C) PROPOSED RESTRICTION ON TITLE TO PROVIDE ADDITIONAL VISITOR CARPARK ONSITE (SUBJECT TO FINAL DETAILED DESIGN)
- (D) PROPOSED EASEMENT FOR SERVICES VARIABLE WIDTH (SUBJECT TO FINAL DETAILED DESIGN)
- (E) PROPOSED EASEMENT TO DRAIN WATER VARIABLE WIDTH (SUBJECT TO FINAL DETAILED DESIGN)

Important Notes:

BUILDING ENVELOPES SHOWN ARE FOR PLANNING PURPOSES ONLY TO CONFIRM THE REQUIRED BUILDING PAD (10m X 15m) FITS WITHIN EACH LOT, WHILST STILL MAINTAINING THE NECESSARY COUNCIL SETBACK REQUIREMENTS. AS SUCH, THIS PLAN IS NOT TO RESTRICT ANY DWELLING SITING ON EACH LOT.

ALL BUILDING ENVELOPE OFFSETS TO SIDE BOUNDARIES ARE IN COMPLIANCE WITH TWEED SHIRE COUNCIL REQUIREMENTS (I.E. SINGLE STOREY 0.9m, TWO STOREY 1.5m.)

KERBING & DESIGN CONTOURS SHOWN ARE INDICATIVE ONLY AND SUBJECT TO FINAL DETAILED ENGINEERING DESIGN.

52
PUBLIC RESERVE
(Subject to Final Detailed Design)

EASEMENT FOR TRANSMISSION LINE 40 WIDE (DP564075)
(E)

Proposed Sewer Pump Station
(Subject to Final Detailed Design)

EASEMENT FOR TRANSMISSION LINE 40 WIDE (DP564075)

SHEET 2 of 2

Rev C – Amended Layout 24/11/09
Rev B – Amended Lots 30 & 32 – 22/5/09
Rev A – Amended Layout 21/5/09
Revision

Chk'd

JACKSON INTERNATIONAL PTY LTD

Important Notes: (THIS NOTE IS AN INTEGRAL PART OF THIS PLAN)

THE PROPOSED LOT BOUNDARIES AND NUMBERS AS SHOWN HEREON ARE PRELIMINARY ONLY AND ARE SUBJECT TO FINAL DESIGN, LOCAL AUTHORITY APPROVAL AND REGISTRATION IN THE DEPARTMENT OF LANDS NSW.

Sheet Layout

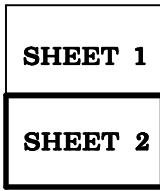

⑥DENOTES INDICATIVE BUILDING SETBACK



DENOTES INDICATIVE 10m X 15m BUILDING PAD AS REQUIRED BY TWEED SHIRE COUNCIL

LOCATION PLAN

Showing Indicative Building Envelopes
Lots 2 and 3 in DP244652
Bilambil Road, Bilambil Village

Parish of TERRANORA County of ROUS

J: \15300\15337\Projects\17532D-C.pro

Scale 1 : 800 @ A3	Level Datum -	F.Bk -	L.Bk -	Drawn SDS Chk'd
--------------------------	------------------	-----------	-----------	-----------------------

B & P SURVEYS CONSULTING SURVEYORS

A.B.N. 55 010117236
30 Beryl Street
Tweed Heads, NSW, 2485, Australia
Telephone: (07) 5536 3611
Fax: (07) 5536 3701
Email: tweed@bpsurveys.com.au
Webpage: www.bpsurveys.com.au



A QUALITY ASSURED COMPANY

Offices Also At : Surfers Paradise Murwillumbah
Ph.(07)55390499 Ph.(02)66721924

Ref. No. T15337	Date 17/03/09	Drawing No./Size 17532 D	Rev. C
--------------------	------------------	-----------------------------	-----------