

VEGETATION STRUCTURE

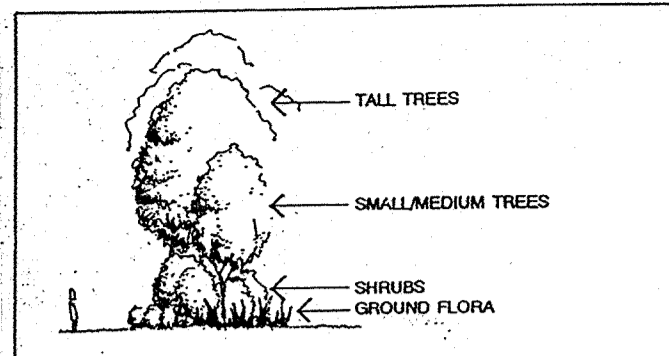

A

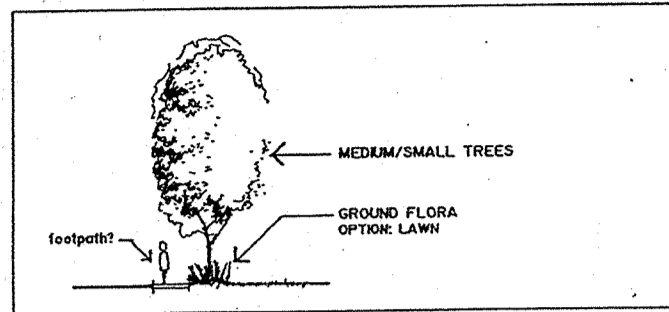

B

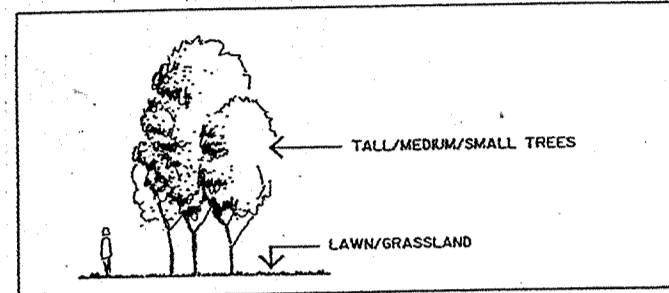

C

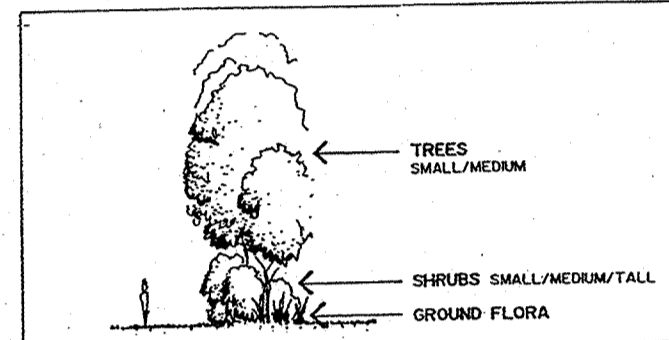

D

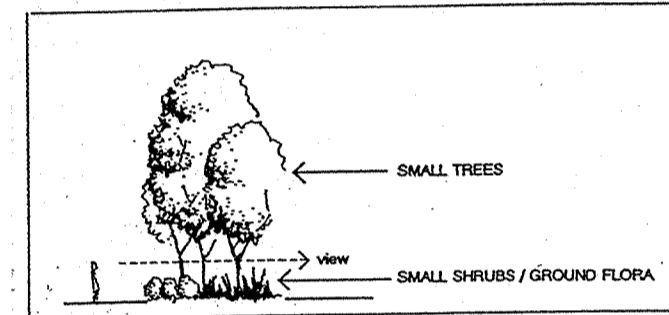

E

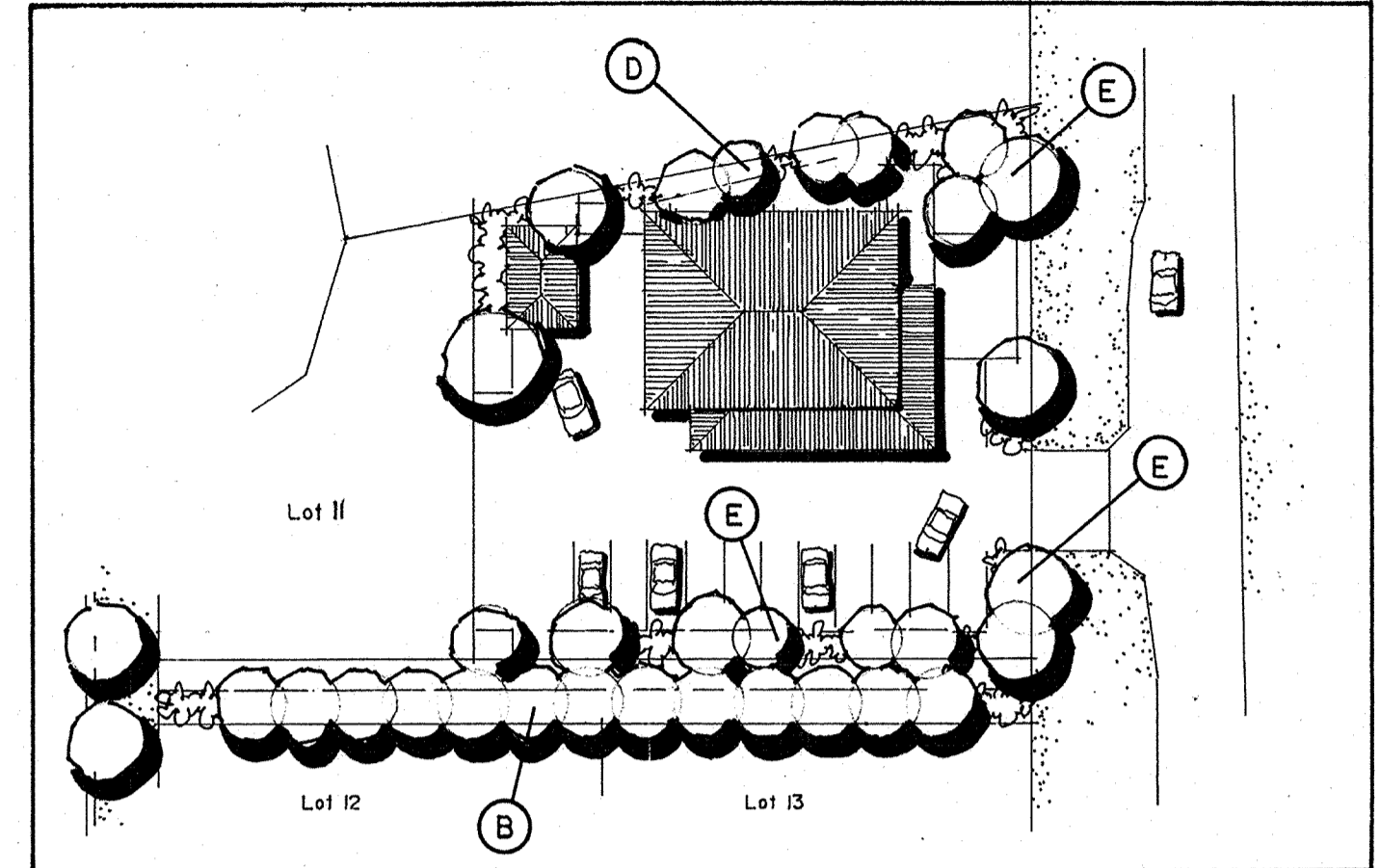
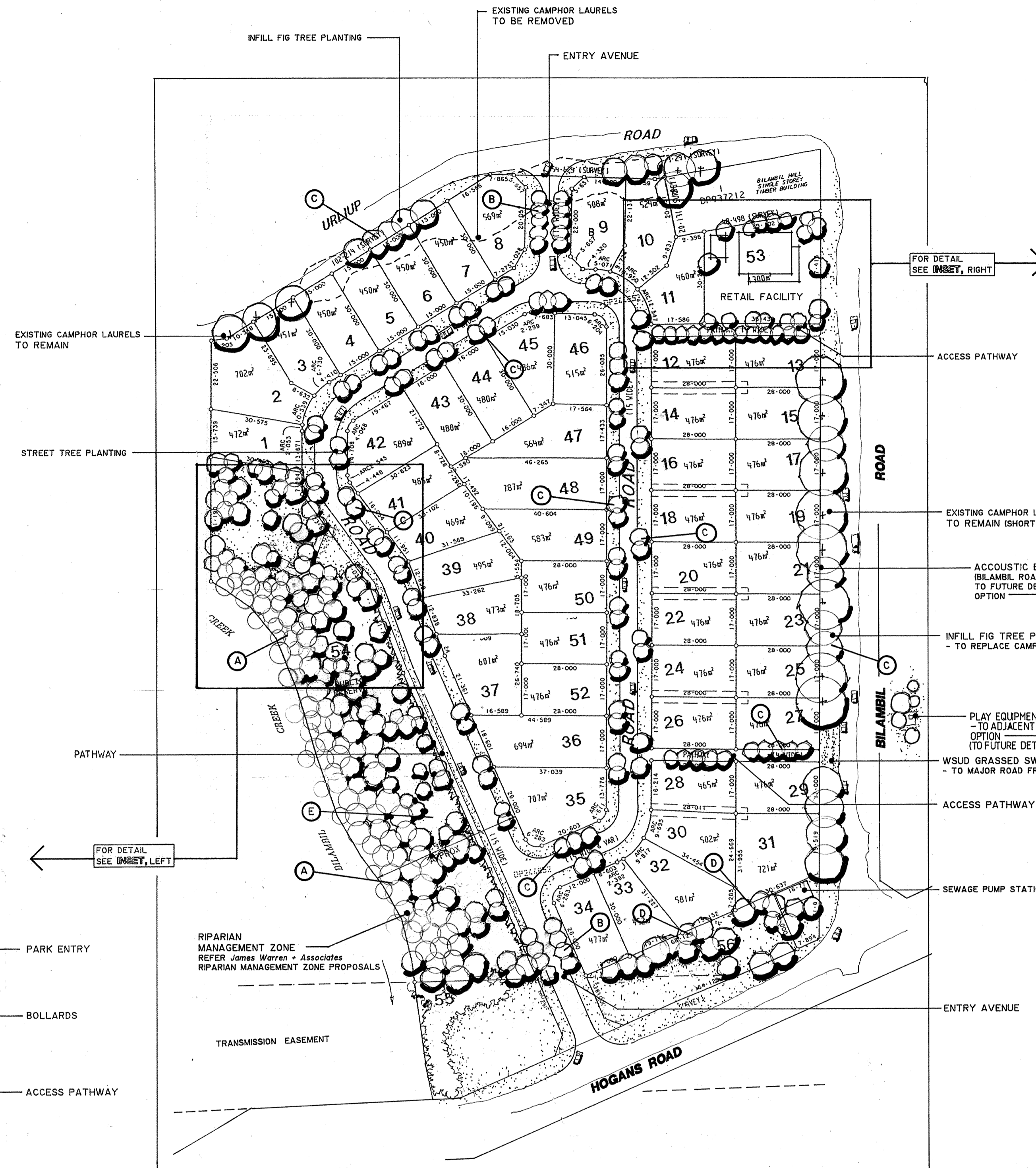

INSET RETAIL FACILITY

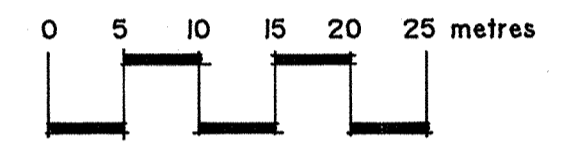

1:500 at A1

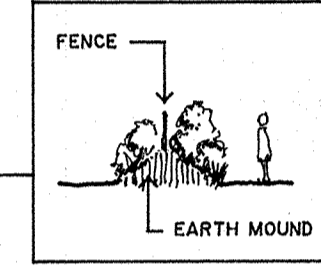

EXAMPLE PLANTS

SPECIES PROPOSED ARE PREDOMINANTLY ENDEMIC AND BASED ON THE SPECIES LISTS COMPILED BY JAMES WARREN + ASSOCIATES UNDER 'RIPARIAN MANAGEMENT ZONES'

TREES	
<i>Alphitonia excelsa</i>	red ash
<i>Cupaniopsis anacardioides</i>	tuckeroo
<i>Commersonia bartramia</i>	brown burreed
<i>Elaeocarpus grandis</i>	blue quandong
<i>Ficus macrophylla</i>	Moreton Bay fig
<i>Jagera pseudorhus</i>	foam bark
<i>Macaranga tanarius</i>	macaranga
<i>Podocarpus elatus</i>	plum pine
<i>Syzygium floribundum</i>	weeping lilly pilli
<i>Syzygium oleosum</i>	blue lilly pilli
SHRUBS	
<i>Acmena smithii</i>	common lilly pilli
<i>Alphitonia excelsa</i>	native ginger
<i>Austromyrtus dulcis</i>	midgenberry
<i>Backhousia myrtifolia</i>	grey myrtle
<i>Clerodendron floribundum</i>	smooth clerodendron
<i>Corylina spp</i>	palm lily
<i>Ptilostigma glabrum</i>	plum myrtle
<i>Pittosporum spp</i>	native daphne
<i>Wilkiea spp</i>	wilkiea
GROUND FLOORA	
<i>Cinnum pedunculatum</i>	swamp lily
<i>Dianella caerulea</i>	blue flax lily
<i>Dianella longifolia</i>	tall flax lily
<i>Hibbertia scandens</i>	climbing guinea flower
<i>Gahnia aspera</i>	cut grass sedge
<i>Lepidosperma laterale</i>	variable saw sedge
<i>Lomandra hystrix</i>	mat rush

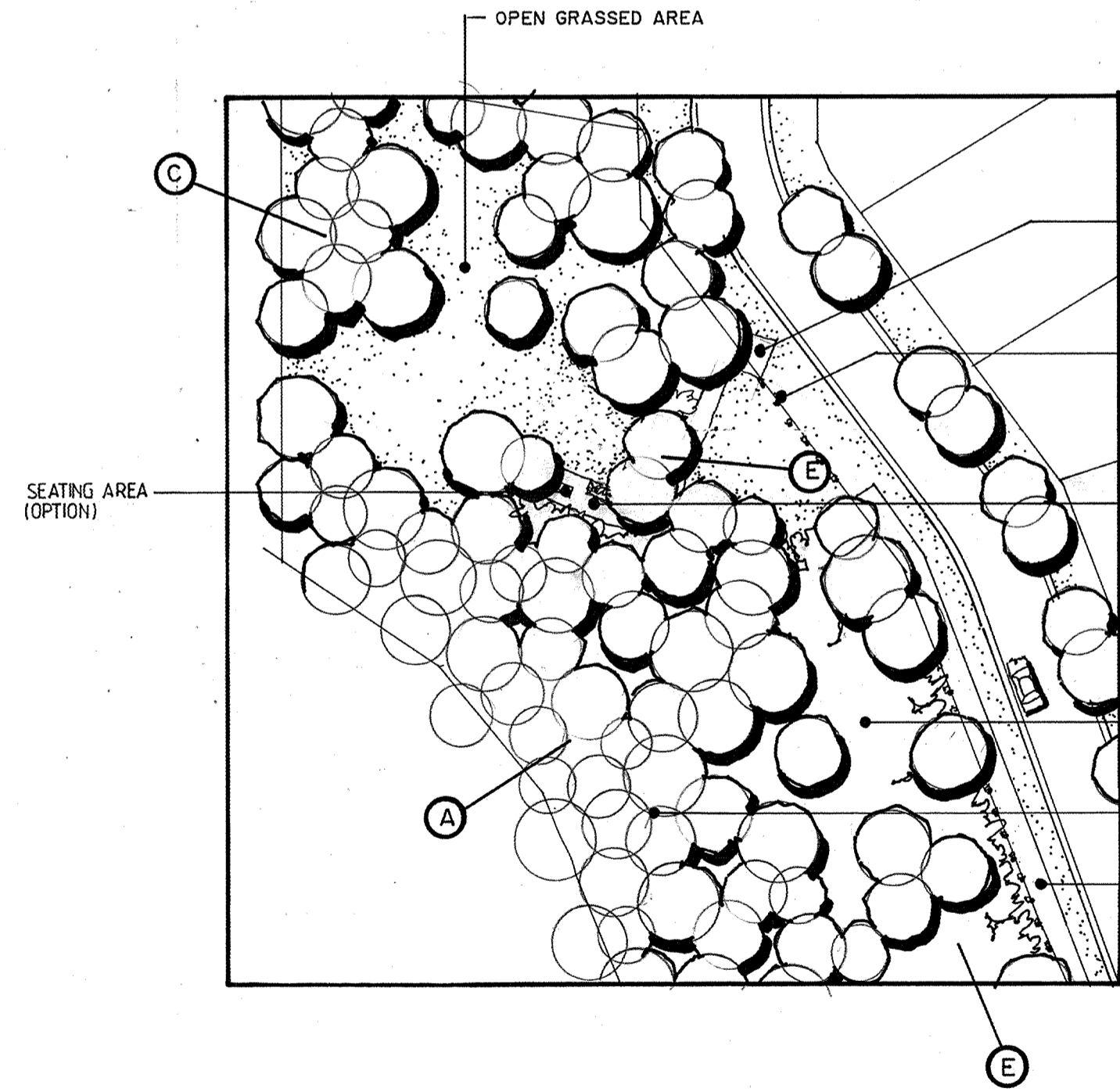
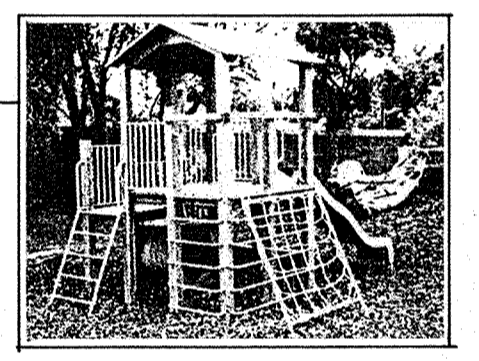

INSET PARK

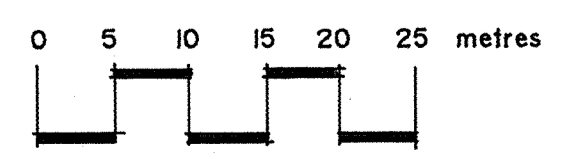

1:500 at A1

SITE PLAN

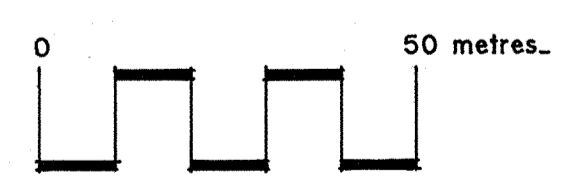

1:1000 at A1

Donald Irving Andrew Gold
LANDSCAPE ARCHITECTURE

John Sherwood for
JACKSON INTERNATIONAL Pty Ltd
Bilambil Residential Estate
Bilambil Road Lots 2 & 3 DP 244652 BILAMBIL, NSW
LANDSCAPE CONCEPT PLAN
A1.DD.2 March 2009

Donald Irving AILA BSc International ASLA
17 Lawnton Street, Daisy Hill Q 4127
P 07 3208 8574
F 07 3208 3768
E doni@bigpond.net.au

AMDT C 25/5/09 BIO BASINS DELETED
AMDT B 21/5/09 PLAYSACE RELOCATED
AMDT A 19/5/09 PATHWAY ADDED