

EROSION CONTROL NOTES

1. ALL CONTROL WORK INCLUDING DIVERSION BANKS AND CATCH DRAINS, V-DRAINS AND SILT FENCES SHALL BE COMPLETED DIRECTLY FOLLOWING THE COMPLETION OF THE EARTHWORKS.
2. SILT FENCES AND SILT FENCE RETURNS SHALL BE ERECTED CONVEX TO THE CONTOUR TO POND WATER.
3. HAY BALE BARRIERS AND GEO-FABRIC FENCES ARE TO BE CONSTRUCTED TO TOE OF BATTER, PRIOR TO COMMENCEMENT OF EARTHWORKS, IMMEDIATELY AFTER CLEARING OF VEGETATION AND BEFORE REMOVAL OF TOP SOIL.
4. ALL TEMPORARY EARTH BERMS, DIVERSION AND SILT DAM EMBANKMENTS ARE TO BE MACHINE COMPACTED, SEEDED AND MULCHED FOR TEMPORARY VEGETATION COVER AS SOON AS THEY HAVE BEEN FORMED.
5. CLEAR WATER IS TO BE DIVERTED AWAY FROM DISTURBED GROUND AND INTO THE DRAINAGE SYSTEM.
6. THE CONTRACTOR IS RESPONSIBLE FOR MAINTAINING AND PROVIDING ONGOING ADJUSTMENT TO EROSION CONTROL MEASURES AS REQUIRED DURING CONSTRUCTION.
7. ALL SEDIMENT TRAPPING STRUCTURES AND DEVICES ARE TO BE INSPECTED AFTER STORMS FOR STRUCTURAL DAMAGE OR CLOGGING, TRAPPED MATERIAL IS TO BE REMOVED TO A SAFE, APPROVED LOCATION.
8. ALL FINAL EROSION PREVENTION MEASURES INCLUDING THE ESTABLISHMENT OF GRASSING ARE TO BE MAINTAINED UNTIL THE END OF THE DEFECTS LIABILITY PERIOD.
9. ALL EARTHWORKS AREAS SHALL BE ROLLED ON A REGULAR BASIS TO SEAL THE EARTHWORKS.
10. ALL FILL AREAS ARE TO BE LEFT WITH A BUND AT THE TOP OF THE SLOPE AT THE END OF EACH DAY'S EARTHWORKS. THE HEIGHT OF THE BUND SHALL BE A MINIMUM OF 200MM.
11. ALL CUT AND FILL SLOPES ARE TO BE SEEDED AND HYDROMULCHED WITHIN 10 DAYS OF COMPLETION OF FORMATION.
12. AFTER REVEGETATION OF THE SITE IS COMPLETE AND THE SITE IS STABLE IN THE OPINION OF A SUITABLY QUALIFIED PERSON ALL TEMPORARY WORK SUCH AS SILT FENCE, DIVERSION DRAINS ETC SHALL BE REMOVED.
13. ALL TOPSOIL STOCKPILES ARE TO BE SUITABLY COVERED TO THE SATISFACTION OF THE SITE MANAGER TO PREVENT WIND AND WATER EROSION.
14. ANY AREA THAT IS NOT APPROVED BY THE CONTRACT ADMINISTRATOR FOR CLEARING OR DISTURBANCE BY THE CONTRACTOR'S ACTIVITIES SHALL BE CLEARLY MARKED AND SIGN POSTED, FENCED OFF OR OTHERWISE APPROPRIATELY PROTECTED AGAINST ANY SUCH DISTURBANCE.
15. ALL STOCKPILE SITES SHALL BE SITUATED IN AREAS APPROVED FOR SUCH USE BY THE SITE MANAGER. A 6m BUFFER ZONE SHALL EXIST BETWEEN STOCKPILE SITES AND ANY STREAM OR FLOW PATH. ALL STOCKPILES SHALL BE ADEQUATELY PROTECTED FROM EROSION AND CONTAMINATION OF THE SURROUNDING AREA BY USE OF THE MEASURES APPROVED IN THE EROSION AND SEDIMENTATION CONTROL PLAN.
16. ACCESS AND EXIT AREAS SHALL INCLUDE SHAKE-DOWN OR OTHER METHODS APPROVED BY THE SITE MANAGER FOR THE REMOVAL OF SOIL MATERIALS FROM MOTOR VEHICLES.
17. THE CONTRACTOR IS TO ENSURE RUNOFF FROM ALL AREAS WHERE THE NATURAL SURFACE IS DISTURBED BY CONSTRUCTION, INCLUDING ACCESS ROADS, DEPOT AND STOCKPILE SITES, SHALL BE FREE OF POLLUTANTS BEFORE IT IS EITHER DISPERSED TO STABLE AREAS OR DIRECTED TO NATURAL WATERCOURSES.
18. THE CONTRACTOR SHALL PROVIDE AND MAINTAIN SLOPES, CROUNTS AND DRAINS ON ALL EXCAVATIONS AND EMBANKMENTS TO ENSURE SATISFACTORY DRAINAGE AT ALL TIMES. WATER SHALL NOT BE ALLOWED TO POND ON THE WORKS UNLESS SUCH PONDING IS PART OF AN APPROVED ESCP / SWMP.

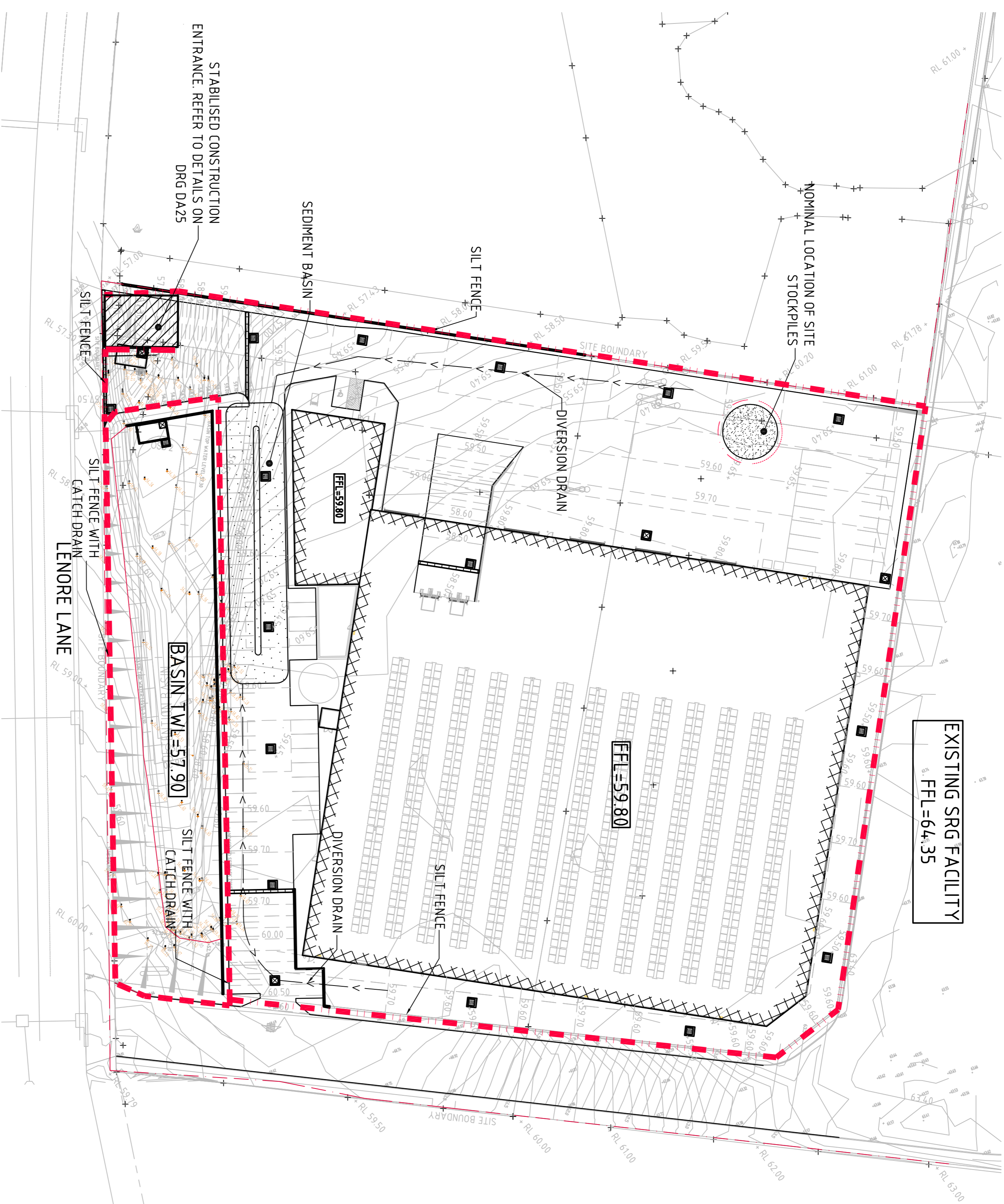

LEGEND:	
	- SILT FENCE WITH CATCH DRAIN
	- SILT FENCE ONLY
	- DIVERSION DRAIN

SEDIMENTATION BASIN NOTE:
 FOR SEDIMENT & EROSION CONTROL DETAILS REFER TO DRAWING C011888.04-DA25 & DA26.
 SEDIMENTATION BASIN SIZING BASED ON RECOMMENDATIONS OF 'SOILS AND CONSTRUCTION, MANAGING URBAN STORMWATER'-THE BLUE BOOK, CAPACITY BASED UPON 5 DAY RAINFALL DEPTH AT 95th PERCENTILE INTENSITY (32.2mm).
 APPROXIMATE AREA OF DISTURBED SITE = 1.38ha

SEDIMENTATION BASINS TO COLLECT RUN-OFF IN EXTREME RAINFALL EVENTS. COLLECTED RUN-OFF TO BE ASSESSED BY A QUALIFIED LABORATORY FOR DOUSING RATES OF ALUM OR GYPSUM TO ENSURE COAGULATION OF SEDIMENTS PRIOR TO WATER BEING DISCHARGED TO COUNCIL STORMWATER SYSTEM.
 EACH BASIN IS TO HAVE A MARKER PLACED AS PER THE DETAIL TO INDICATE WHEN SEDIMENT IS TO BE REMOVED. REMOVED SEDIMENT IS TO BE CLASSED AND DEWATERED PRIOR TO REMOVAL FROM SITE.
 ALLOWANCE TO BE MADE DURING BENCHING OF SITE TO ENSURE RUN-OFF IS DIRECTED TO SEDIMENTATION BASINS.

NOTES:
 1. ASSUME TYPE D SOIL (CLAY/SILT CLAY)
 2. ASSUME GROUP D SOIL (HIGH PLASTICITY AND SHRINK/SWELL PROPERTIES)
 SOIL TYPE ASSESSED FROM GEOTECHNICAL REPORT.

SEDIMENT BASIN 1:
 CATCHMENT AREA = 1.38ha
 REQUIRED BASIN VOLUME = 333m³
 BASE DIMENSION (LXB) = 4.0m x 1m
 TOP DIMENSION (LXB) = 4.9m x 10.0m
 MAX SIDE SLOPE = 1V:3H
 DEPTH = 1.5m
 PROVIDED BASIN VOLUME = 335m³

EROSION AND SEDIMENT CONTROL PLAN
 SCALE 1:500

FOR DEVELOPMENT APPROVAL

NOTE: ALL LEVELS ARE INDICATIVE (±500mm) & MAY BE SUBJECT TO MINOR VARIATION TO SUIT DETAILED DESIGN.
 SCALE 1:500 AT A1 SIZE SHEET

ISSUED FOR REVIEW	16.12.15	B	ARCHITECT	CLIENT	LOGOS PROPERTY	PROJECT	PROPOSED DEVELOPMENT	CONSULTANT	Costin Roe Consulting Pty Ltd. Consulting Engineers Level 1, 8 Miranda Street Maroubra NSW 1512 Phone (02) 953 7800 Fax (02) 954 3781 email: mail@costinroe.com.au								
ISSUED FOR REVIEW AMENDMENTS	15.12.15	A		SUITE 02 LEVEL 12 167 MACQUARIE STREET SYDNEY NSW	LOT 62/133-145 LENORE LANE, ERSKINE PARK NSW	DESIGNED (DPMW) MW	CHECKED (SD) SD	DATE		SIZE A1	SCALE AS SHOWN	CNO REF. 11888.04-DA20					
												DRAWING TITLE	EROSION AND SEDIMENT CONTROL PLAN	DRAWING No.	C011888.04-DA20	ISSUE	B

CostinRoe Consulting
 Value in Engineering and Management