

LEGEND:
 LEVELS DATUM IS AHD
 EXISTING SITE LEVELS AND DETAILS BASED ON SURVEY INFORMATION PROVIDED BY LOVEGROVE DIXLEY CONSULTANTS DATED 31/05/07.

- SGGP - SINGLE GRATED GULLY PIT
- SJP - SEALED JUNCTION PIT
- GD - GRATED DRAIN (200 WIDE)
- SW - DRAINAGE LINE
- SS - SUBSOIL LINE
- RW - ROOFWATER LINE
- FPH - FINISHED PAVEMENT SPOT HEIGHT
- FPL - FINISHED PAVEMENT CONTOUR (MAJOR) 0.5m INTERVALS
- FPM - FINISHED PAVEMENT CONTOUR (MINOR) 0.1m INTERVALS

NOTE:
 REFER TO DRAWING C41 FOR PIT SCHEDULE AND STORMWATER NOTES

PROPOSED WAREHOUSE 2
 FFL = 64.00

PROPOSED DANGEROUS GOODS STORE
 FFL = 64.00

ELECTRICAL EASEMENT REFER TO NOTE ON DRAWING C55

SPRINKLER TANK & PUMP ROOM
 FFL = 64.20

BREAKLINE - FOR CONTINUATION REFER TO DRAWING Co11888.00-C42

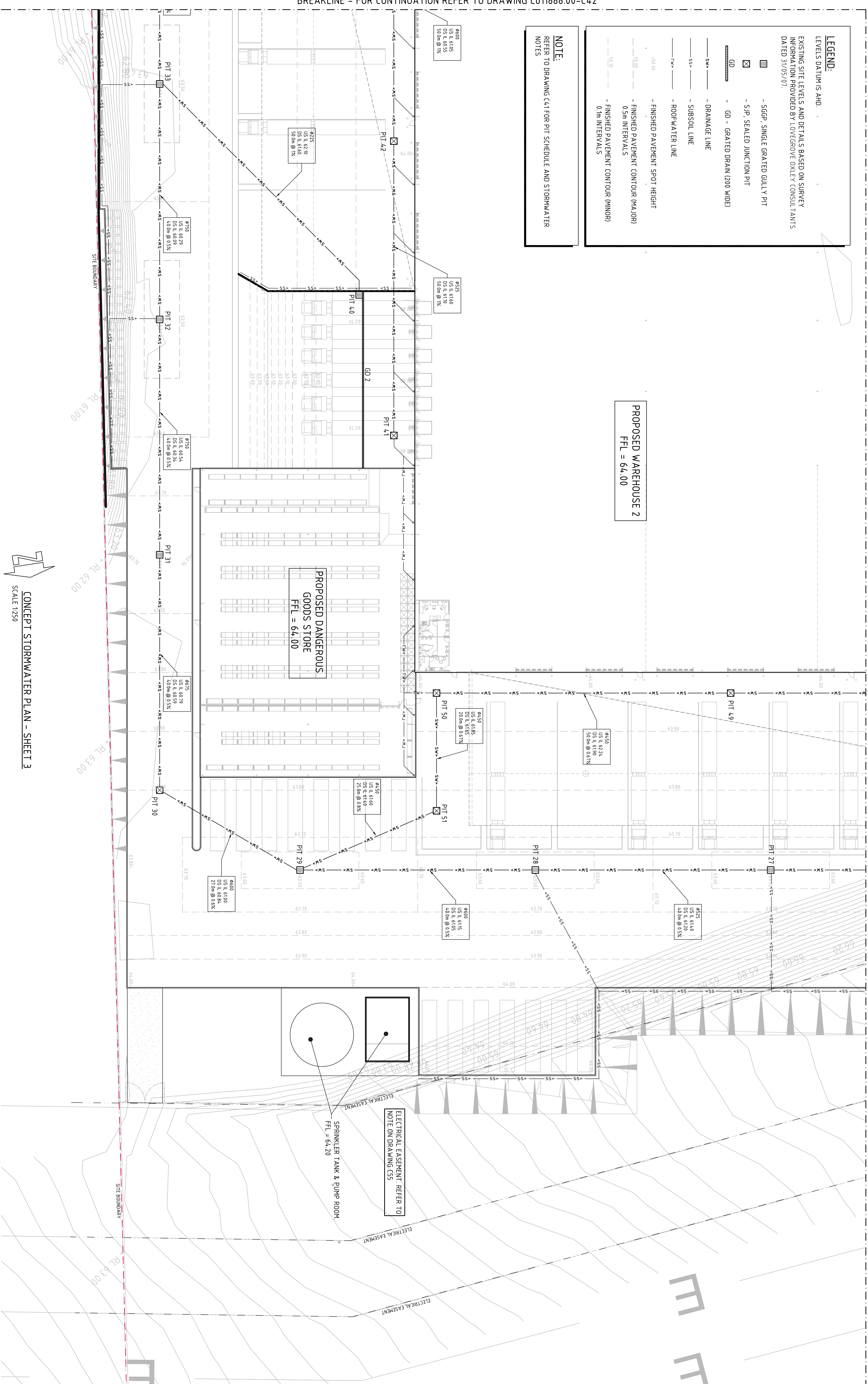

CONCEPT STORMWATER PLAN - SHEET 3
 SCALE 1:250

FOR SECTION 75W APPLICATION

| | | | | | | | | |
|----------------------------|----------|-------|------------|--|--|--|---|---|
| FOR 75W APPLICATION | 14.02.13 | D | ARCHITECT | AXIS ARCHITECTURE | LOGOS PROPERTY GROUP | PROPOSED WAREHOUSE SUPER RETAIL GROUP | Costin Roe Consulting Pty Ltd. | <p>Costin Roe Consulting</p> <p>Level 1, 8 Mitchell Street North Ryde, Sydney NSW 2113 Phone: 02 9380 2000 Email: muller@costinroe.com.au</p> |
| LEVELS/STORMWATER ADJUSTED | 25.01.12 | C | CLIENT | 4, 7 HZ CRONULLA CRONULLA, NSW 2230 | 133-145 LENORE LANE, ERSKINE PARK, NSW | Consulting Engineers | <p>Costin Roe Consulting</p> <p>Level 1, 8 Mitchell Street North Ryde, Sydney NSW 2113 Phone: 02 9380 2000 Email: muller@costinroe.com.au</p> | |
| FOR 75W APPLICATION | 7.11.12 | B | DATE | ISSUE | SYDNEY, NSW 2000 | 133-145 LENORE LANE, ERSKINE PARK, NSW | <p>Costin Roe Consulting</p> <p>Level 1, 8 Mitchell Street North Ryde, Sydney NSW 2113 Phone: 02 9380 2000 Email: muller@costinroe.com.au</p> | |
| FOR INFORMATION ONLY | 30.10.12 | A | DATE | ISSUE | SYDNEY, NSW 2000 | 133-145 LENORE LANE, ERSKINE PARK, NSW | <p>Costin Roe Consulting</p> <p>Level 1, 8 Mitchell Street North Ryde, Sydney NSW 2113 Phone: 02 9380 2000 Email: muller@costinroe.com.au</p> | |
| AMENDMENTS | DATE | ISSUE | AMENDMENTS | DATE | ISSUE | AMENDMENTS | DATE | ISSUE |

DRAWING TITLE
CONCEPT STORMWATER PLAN
 SHEET 3
 DRAWING No. Co11888.00-C43