

B-TRIPLE

Tractor Width	2.50	Lock to Lock Time	6.0
Trailer Width	2.50	Steering Angle	21.2
Tractor Track	2.50	Articulating Angle	70.0
Trailer Track	2.50		

LEGEND

- PROPOSED LOT BOUNDARY
- EXISTING LOT BOUNDARY
- MAJOR CONTOURS
- MINOR CONTOURS
- - - EXISTING ROAD ALIGNMENT
- - - PROPOSED LINE MARKING
- - - PROPOSED SITE LINE
- - - PROPOSED CATCH DRAIN
- PROPOSED ROAD PAVEMENT
- PROPOSED FOOTPATH/MEDIAN

NOTE:
SIGHT DISTANCE DEMONSTRATES THAT PROPOSED DESIGN COMPLIES WITH MINIMUM SAFE INTERSECTION SIGHT DISTANCE (SID) FROM SECTION 3.2.2 A.G.R.D. PART 4A.

CONTOUR INTERVAL = 1.0m

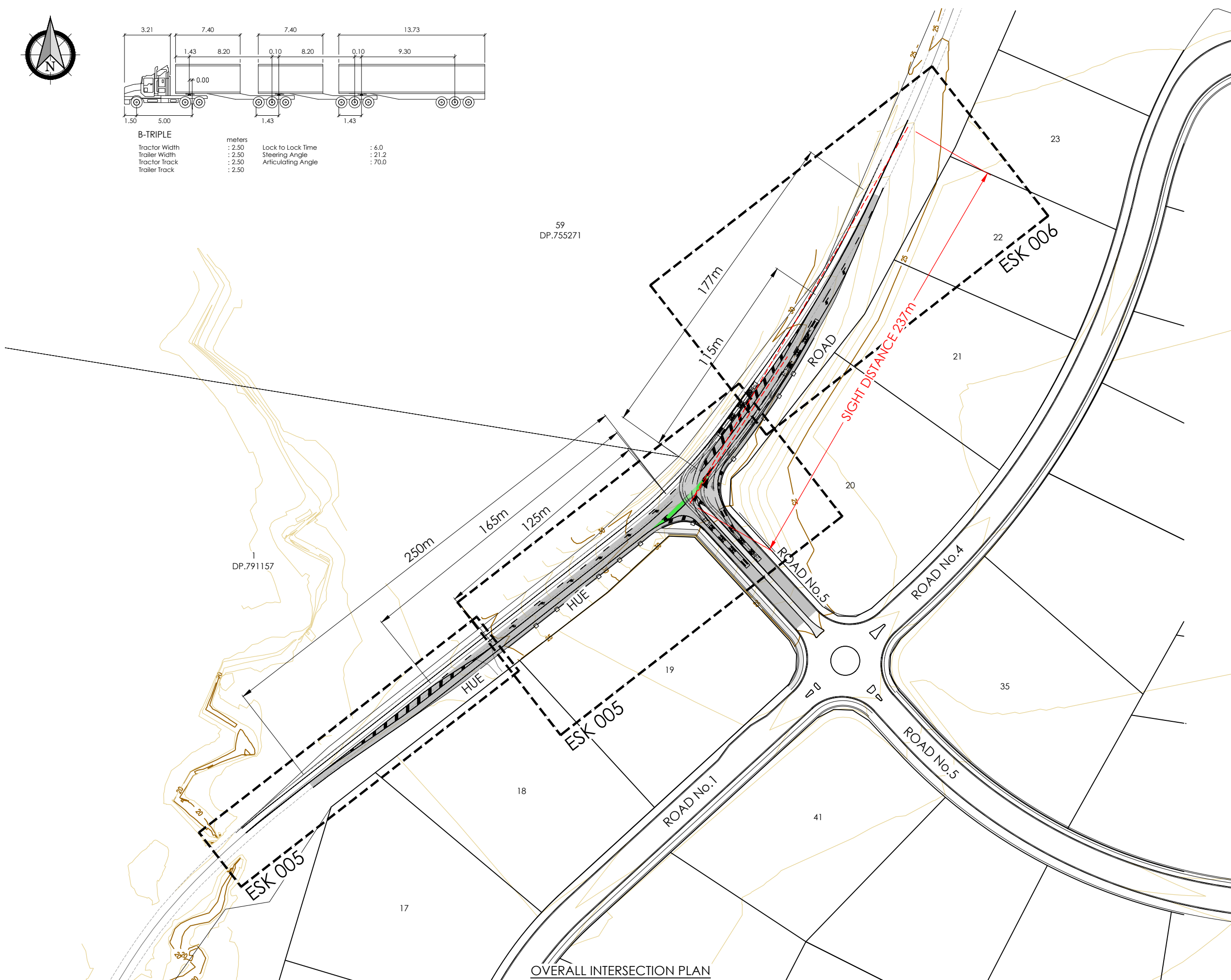

OVERALL INTERSECTION PLAN
SCALE 1:1000

Plotted By: Jacob Jackson Plot Date: 16/12/21 9:35:56AM Cad File: S:\190628\DWG\GENERAL\190628-ESK-004-006[B].DWG
This plan includes coloured information. If you have a black and white copy you do not have all of the information. This note is coloured RED.

ver.	date	comment	drawn	pm	level information	scale (A1 original size)	notes
B	16.12.2021	COUNCIL COMMENTS	JJ	JY	DATUM: N/A CONTOUR INTERVAL: 1.0m	A1 1:1000 0 25 50m A3 1:2000	

- project management
- civil engineering
- infrastructure
- superintendency
- social impact
- town planning
- surveying
- development feasibility
- visualisation
- urban design

drawing title:
HUE HUE ROAD INTERSECTION

location:
HUE HUE ROAD & SPARKS ROAD, WARNERVALE

council: CENTRAL COAST COUNCIL

dwg ref: 190628-ESK-004

client:
WINARCH CAPITAL

central coast office ph: (02) 4305 4300
hunter office ph: (02) 4978 5100
sydney office ph: (02) 8046 7411

www.adwjohanson.com.au

working beyond expectations

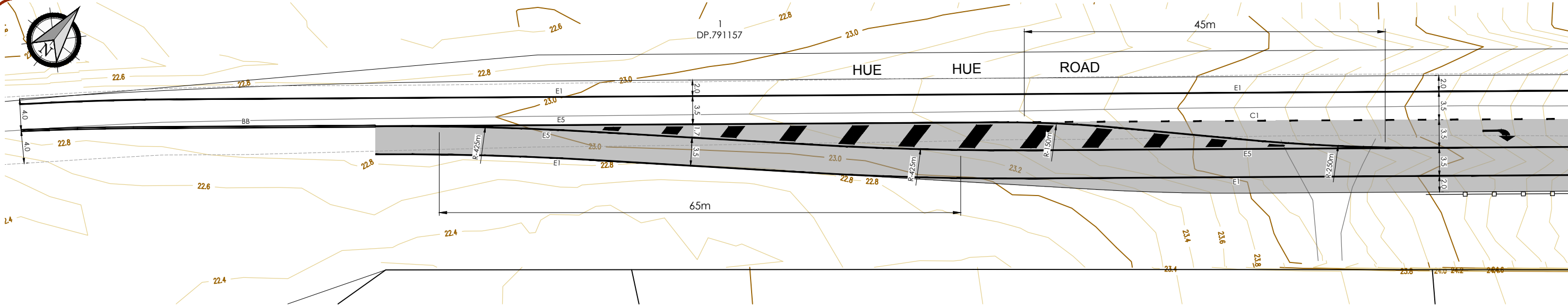

INTERSECTION PLAN
SCALE 1:250

REFER ESK006 FOR PLAN CONTINUATION

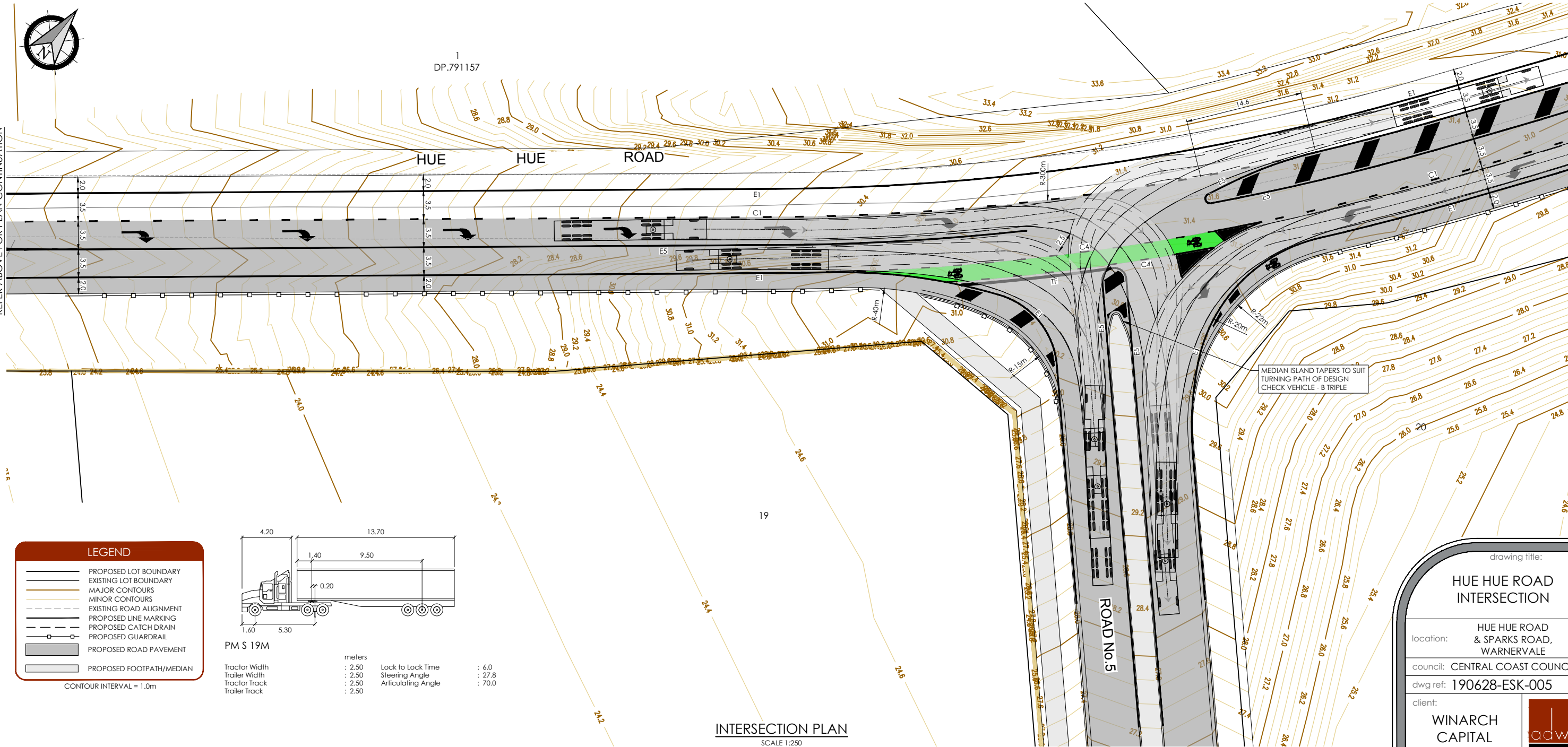

INTERSECTION PLAN
SCALE 1:250

LEGEND

- PROPOSED LOT BOUNDARY
- EXISTING LOT BOUNDARY
- MAJOR CONTOURS
- MINOR CONTOURS
- EXISTING ROAD ALIGNMENT
- PROPOSED LINE MARKING
- PROPOSED CATCH DRAIN
- PROPOSED GUARDRAIL
- PROPOSED ROAD PAVEMENT
- PROPOSED FOOTPATH/MEDIAN

CONTOUR INTERVAL = 1.0m

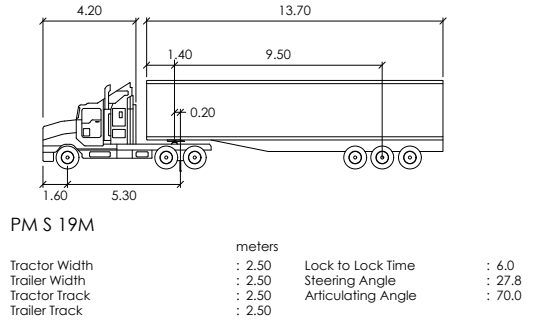

drawing title:
HUE HUE ROAD INTERSECTION

location:
HUE HUE ROAD & SPARKS ROAD, WARNERVALE

council: CENTRAL COAST COUNCIL

dwg ref: 190628-ESK-005

client:
WINARCH CAPITAL

central coast office ph: (02) 4305 4300
hunter office ph: (02) 4978 5100
sydney office ph: (02) 8046 7411

www.adwjohnson.com.au

ver.	date	comment	drawn	pm	level information	scale (A1 original size)	notes
B	16.12.2021	COUNCIL COMMENTS	JJ	JY	DATUM: N/A CONTOUR INTERVAL: 1.0m	A1 1:250 0 5.0 10.0 12.5m A3 1:500	



59
DP.755271

REFER ESK005 FOR PLAN CONTINUATION

Plotfile: Jacob Jackson Plot Date: 16/12/21 9:36:00AM Cad File: S:\190628\DWG\GENERAL\190628-ESK-004-006[B].DWG
This plan includes coloured information. If you have a black and white copy you do not have all the information. This note is coloured red.

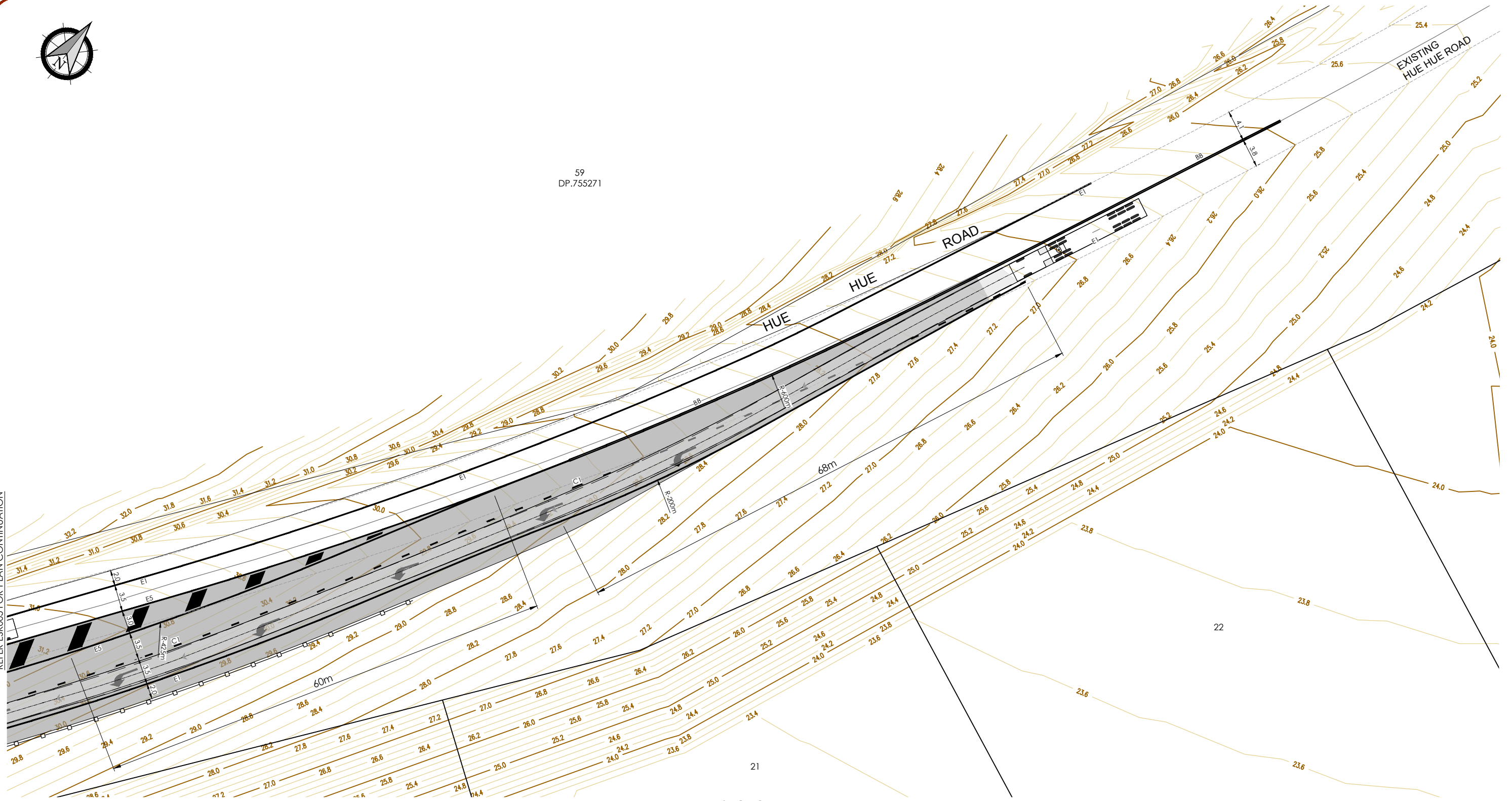

INTERSECTION PLAN
SCALE 1:250

LEGEND

- PROPOSED LOT BOUNDARY
- EXISTING LOT BOUNDARY
- MAJOR CONTOURS
- MINOR CONTOURS
- EXISTING ROAD ALIGNMENT
- PROPOSED LINE MARKING
- PROPOSED GUARDRAIL
- PROPOSED ROAD PAVEMENT
- PROPOSED FOOTPATH/MEDIAN

CONTOUR INTERVAL = 1.0m

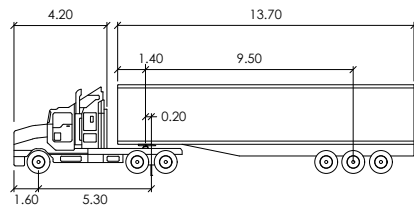

PMS 19M

meters	
Tractor Width	: 2.50
Trailer Width	: 2.50
Tractor Track	: 2.50
Trailer Track	: 2.50
Lock to Lock Time	: 6.0
Steering Angle	: 27.8
Articulating Angle	: 70.0

ver.	date	comment	drawn	pm	level information	scale (A1 original size)	notes
B	16.12.2021	COUNCIL COMMENTS	JJ	JY	DATUM: N/A CONTOUR INTERVAL: 1.0m	A1 1:250 0 5.0 10.0 12.5m A3 1:500	

- project management
- civil engineering
- infrastructure
- superintendency
- social impact
- town planning
- surveying
- development feasibility
- visualisation
- urban design

drawing title:
**HUE HUE ROAD
INTERSECTION**

location:
**HUE HUE ROAD
& SPARKS ROAD,
WARNERVALE**

council: **CENTRAL COAST COUNCIL**

dwg ref: **190628-ESK-006**

client:
**WINARCH
CAPITAL**



central coast office ph: (02) 4305 4300
hunter office ph: (02) 4978 5100
sydney office ph: (02) 8046 7411

www.adwjohnson.com.au