

SW DRAINAGE TO BE LOCATED CLEAR OF CRITICAL ROOT ZONE OF EXISTING TREES.

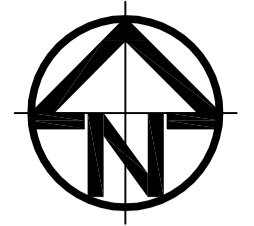

A1

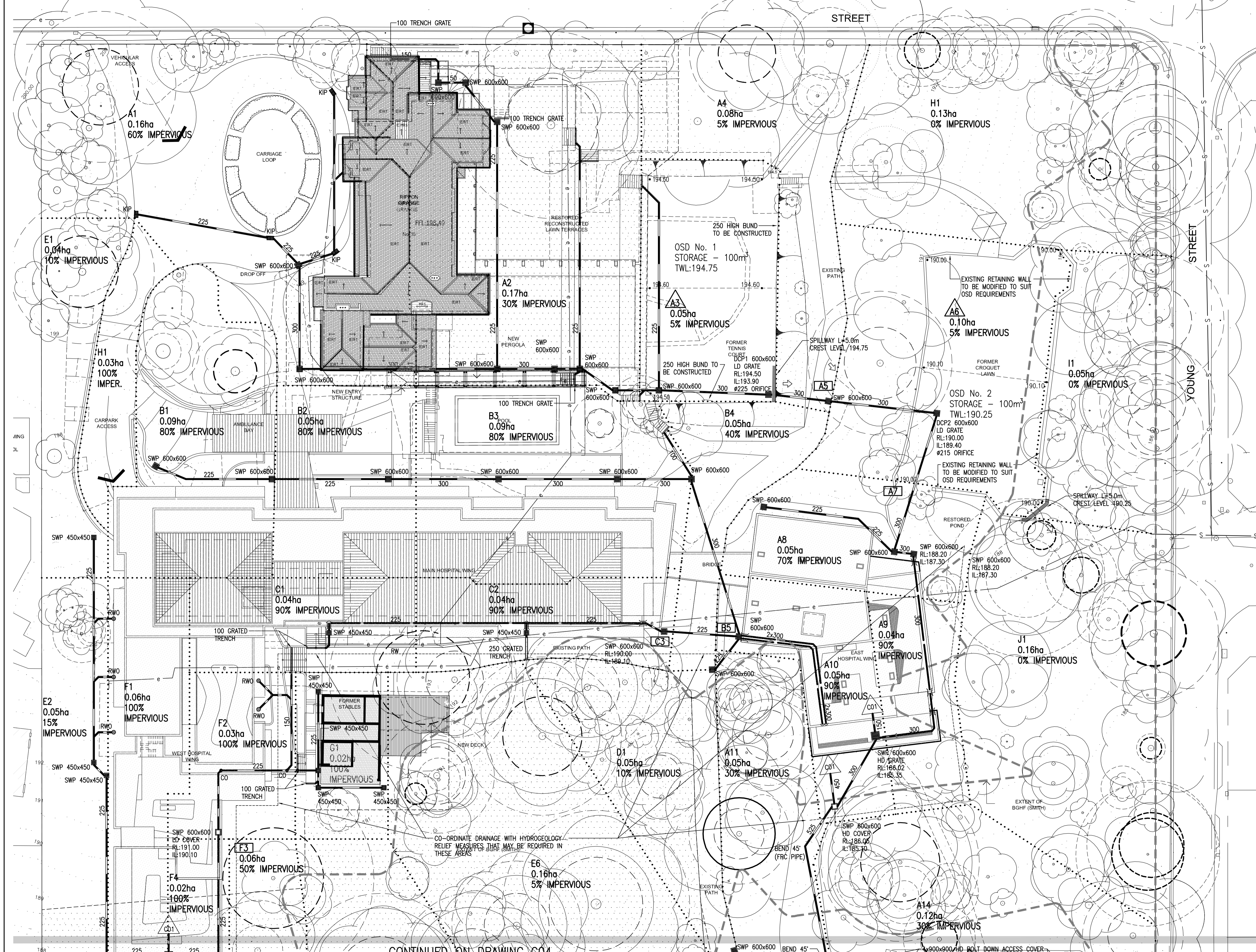

SERVICES ON THIS DRAWING ARE SHOWN BELOW SLAB U.N.O.

Revision	Amendment	Date	Initial
B	D.A. RE-SUBMISSION	18.11.09	MA
A	D.A. SUBMISSION	22.10.08	ZO

Discipline	Dwg. No.	Date	Revisions
ARCHITECTURAL	AR.DA.002	02.02.09	P3 P10
STRUCTURAL			
MECHANICAL			
ELECTRICAL			

Notes
Dimensions not shown to be checked on site. Do not scale of this drawing. This drawing is to be read in conjunction with a specification. Invert levels are indicative only and are to be checked prior to commencement of work. Position of Authorities mains and/or existing services are to be checked prior to commencement of work. Report any discrepancies to the Architect for decision/clarification before proceeding with the work. These designs, drawings, specifications and the copyright therein remain the property of the LHO Group and must not be used, altered, reproduced, or copied wholly or in part without the written permission of the owners.



Client
TANNER ARCHITECTS
52 ALBION STREET,
SURRY HILLS,
SYDNEY, NSW 2010
Telephone 61 2 9281 4399 Facsimile 61 2 9281 4337
Email t&a@tannerarchitects.com.au

Project
35 WATER STREET
WAHROONGA
PRIVATE HOSPITAL

Consultant
LHO GROUP
LHO Group Pty Limited
Level 1, 25 Atchison Street
St Leonards NSW 2066
PO Box 114
St Leonards NSW 1590
p: 02 9439 1422
f: 02 9438 1242
e: sydney@lhogroup.com.au
www.lhogroup.com.au
ABN 61 579 427 373
AS/NZS ISO 9001

Drawing **CIVIL SERVICES**
STORMWATER CONCEPT PLAN
NORTH

Design	ZO	Drawn	JK
Date	OCT 2008	Design Validated	MA
Sheet	4 OF 8	QA Approved	
Scale	1:250	Computer Dwg.No.	
Job No.	0608-0008	Dwg.No.	C03
		Issue	B

CONTINUED ON DRAWING C04