

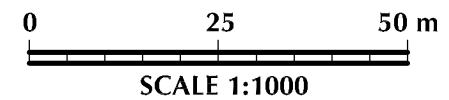

32
D. P. 1047234

HEARNES LAKE ROAD

RESIDENTIAL SUBDIVISION
 LOT 21, DP714858 HEARNES LAKE ROAD, WOOLGOOLGA
OVERALL CONCEPT PLAN



MAP 1
 Amendment No. 06265
 H

de Groot & Benson Pty Ltd
 Consulting Engineers & Planners
 A.C.N. 052 300 571
 236 Harbour Drive
 Coffs Harbour NSW 2450
 Phone (02) 6652 1700
 Fax (02) 6652 7418
 Email email@dgbc.com.au

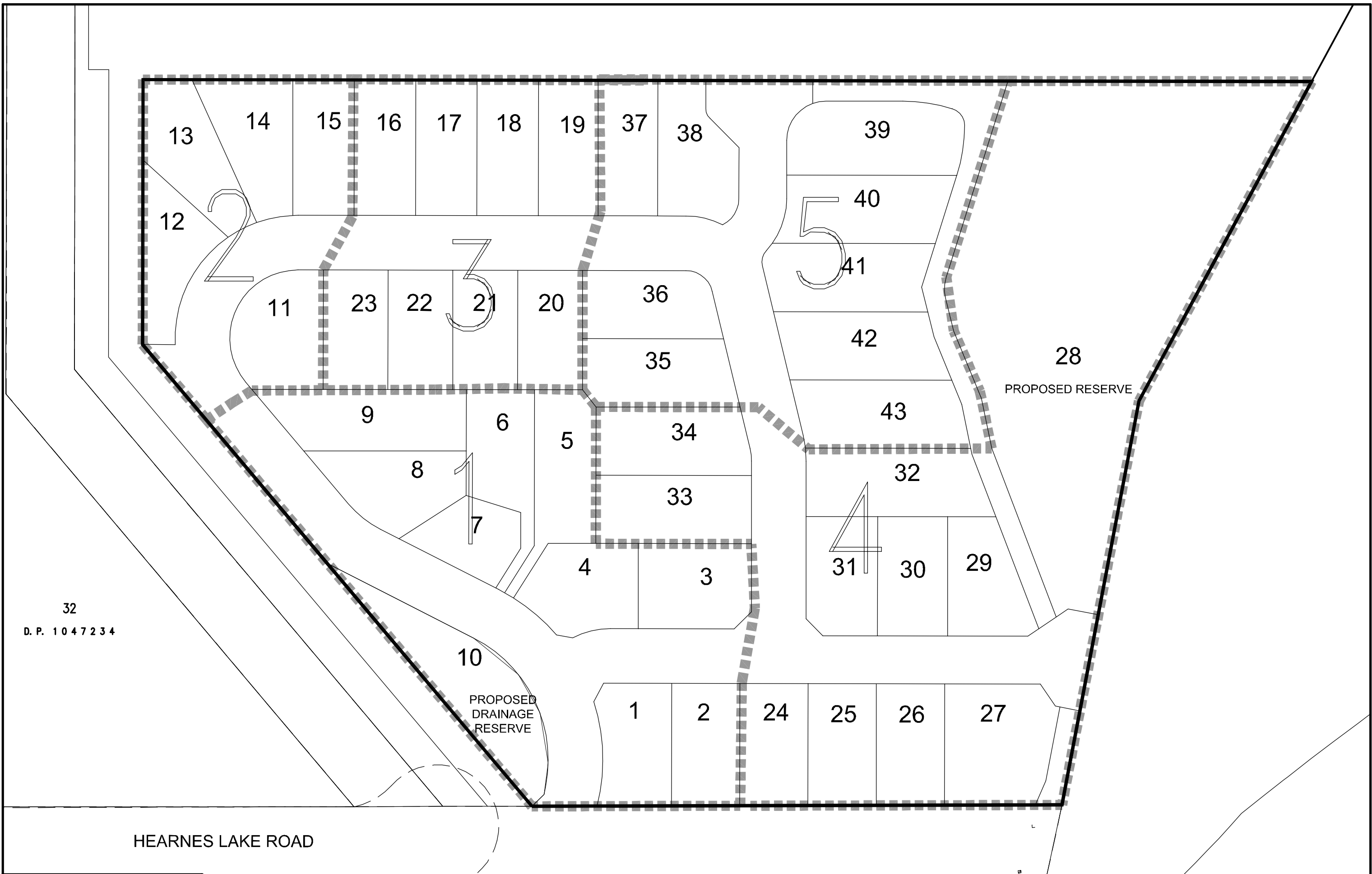

de Groot & Benson Pty Ltd
 Consulting Engineers & Planners
 A.C.N. 052 300 571
 236 Harbour Drive
 Coffs Harbour NSW 2450
 Phone (02) 6652 1700
 Fax (02) 6652 7418
 Email email@dgb.com.au

RESIDENTIAL SUBDIVISION
 LOT 21, DP714858 HEARNES LAKE ROAD, WOOLGOOLGA
STAGING PLAN

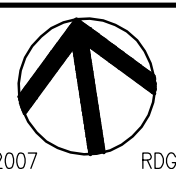
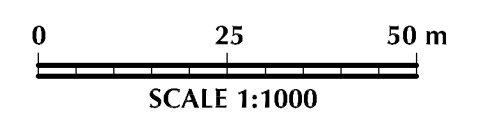

MAP 2
 Amendment No. 06265
 G

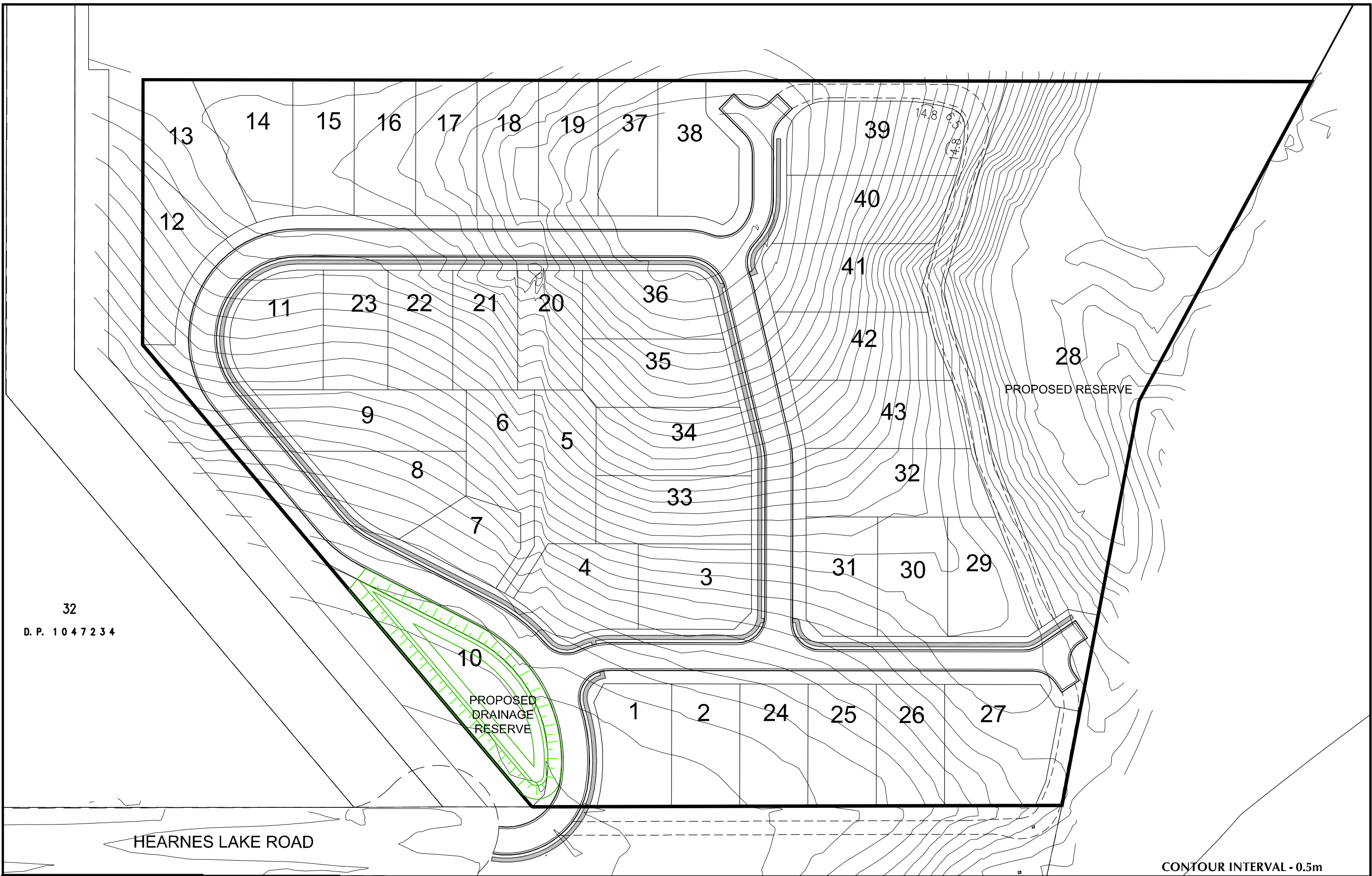

32
D.P. 1047234

HEARNES LAKE ROAD

28
PROPOSED RESERVE

10
PROPOSED DRAINAGE RESERVE

CONTOUR INTERVAL - 0.5m

de Groot & Benson Pty Ltd
Consulting Engineers & Planners

A.C.N. 052 300 571
236 Harbour Drive
Coffs Harbour NSW 2450

Phone (02) 6652 1700
Fax (02) 6652 7418
Email email@dgb.com.au

RESIDENTIAL SUBDIVISION
LOT 21, DP714858 HEARNES LAKE ROAD, WOOLGOOLGA
LAYOUT PLAN

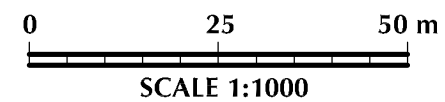

MAP 3
Amendment No. 06265
G

6 JULY 2007 RDG

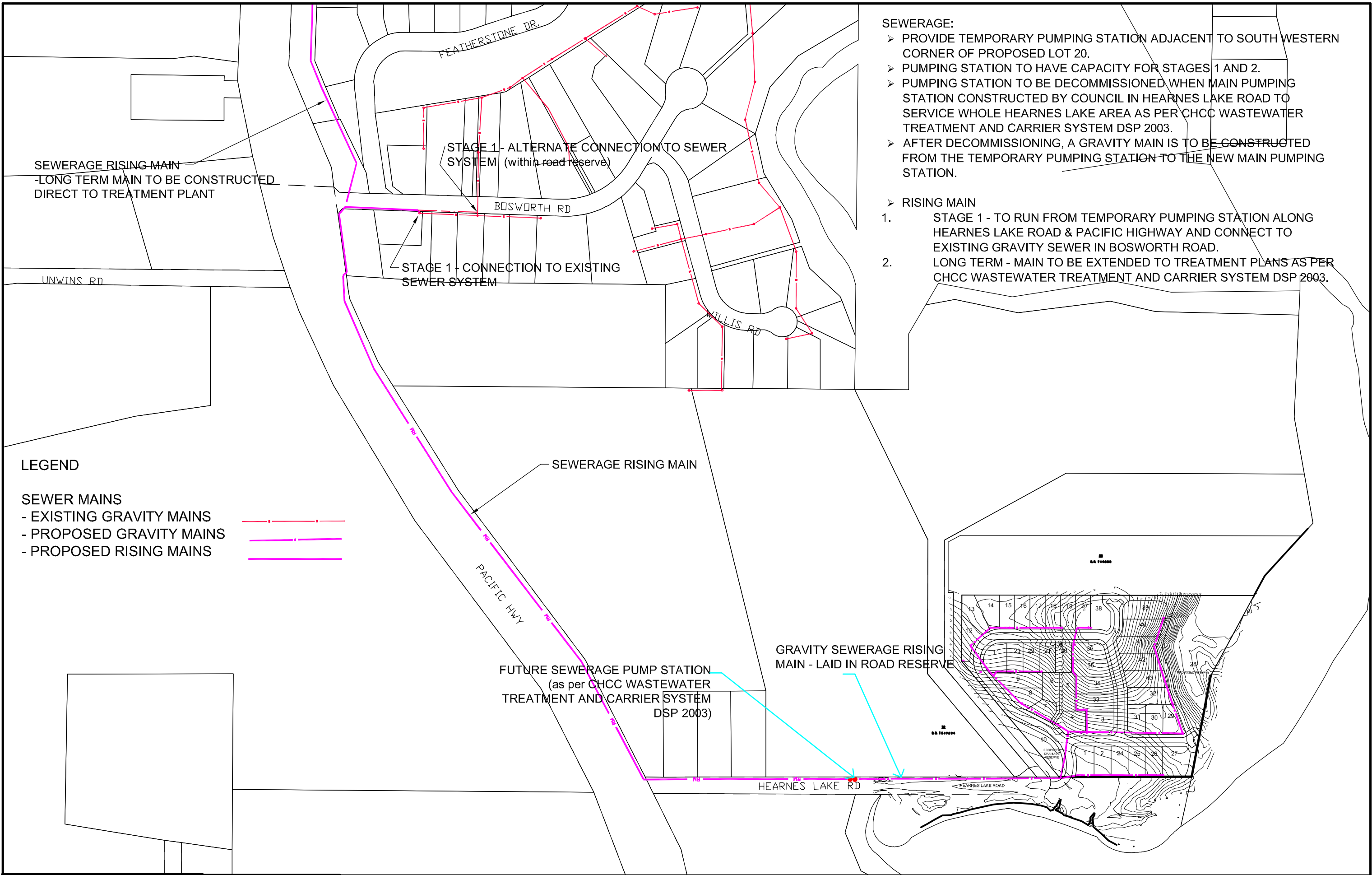

- SEWERAGE:**
- PROVIDE TEMPORARY PUMPING STATION ADJACENT TO SOUTH WESTERN CORNER OF PROPOSED LOT 20.
 - PUMPING STATION TO HAVE CAPACITY FOR STAGES 1 AND 2.
 - PUMPING STATION TO BE DECOMMISSIONED WHEN MAIN PUMPING STATION CONSTRUCTED BY COUNCIL IN HEARNES LAKE ROAD TO SERVICE WHOLE HEARNES LAKE AREA AS PER CHCC WASTEWATER TREATMENT AND CARRIER SYSTEM DSP 2003.
 - AFTER DECOMMISSIONING, A GRAVITY MAIN IS TO BE CONSTRUCTED FROM THE TEMPORARY PUMPING STATION TO THE NEW MAIN PUMPING STATION.
- RISING MAIN**
1. STAGE 1 - TO RUN FROM TEMPORARY PUMPING STATION ALONG HEARNES LAKE ROAD & PACIFIC HIGHWAY AND CONNECT TO EXISTING GRAVITY SEWER IN BOSWORTH ROAD.
 2. LONG TERM - MAIN TO BE EXTENDED TO TREATMENT PLANS AS PER CHCC WASTEWATER TREATMENT AND CARRIER SYSTEM DSP 2003.

SEWERAGE RISING MAIN
-LONG TERM MAIN TO BE CONSTRUCTED DIRECT TO TREATMENT PLANT

STAGE 1 - ALTERNATE CONNECTION TO SEWER SYSTEM (within road reserve)

STAGE 1 - CONNECTION TO EXISTING SEWER SYSTEM

LEGEND

SEWER MAINS

- EXISTING GRAVITY MAINS
- PROPOSED GRAVITY MAINS
- PROPOSED RISING MAINS

FUTURE SEWERAGE PUMP STATION
(as per CHCC WASTEWATER TREATMENT AND CARRIER SYSTEM DSP 2003)

GRAVITY SEWERAGE RISING MAIN - LAID IN ROAD RESERVE

de Groot & Benson Pty Ltd
Consulting Engineers & Planners

A.C.N. 052 300 571
236 Harbour Drive
Coffs Harbour NSW 2450

Phone (02) 6652 1700
Fax (02) 6652 7418
Email email@dgb.com.au

RESIDENTIAL SUBDIVISION
LOT 21, DP714858 HEARNES LAKE ROAD, WOOLGOOLGA
SEWER CONCEPT PLAN

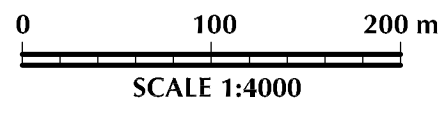

MAP 4S
Amendment No. 06265
G

WATER

- CONNECT TO EXISTING 225mm MAIN ON WESTERN SIDE OF PACIFIC HIGHWAY WITH 150mm WATERMAIN AS PER CHCC WATER SUPPLY STRATEGY.
- MAIN TO BE UNDER BORED PACIFIC HIGHWAY.
- INTERNAL SUBDIVISION PIPEWORK TO BE GENERALLY 100mm uPVC.
- FUTURE LINK TO WILLIS STREET TO BE PROVIDED BY OTHERS WITH THE DEVELOPMENT OF THE ADJOINING PARCELS OF LAND.

LEGEND

WATER MAINS
 - EXISTING
 - PROPOSED

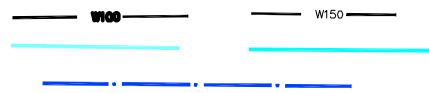

FUTURE 150mm WATERMAIN CONNECTION TO EXISTING RETICULATION IN WILLIS STREET (BY OTHERS)

150mm WATERMAIN AS PER WATER SUPPLY STRATEGY - LAID IN ROAD RESERVE

CONNECT TO EXISTING 225mm MAIN

UNDERBORE PACIFIC HIGHWAY

de Groot & Benson Pty Ltd
 Consulting Engineers & Planners
 A.C.N. 052 300 571
 236 Harbour Drive
 Coffs Harbour NSW 2450
 Phone (02) 6652 1700
 Fax (02) 6652 7418
 Email email@djgb.com.au

RESIDENTIAL SUBDIVISION
 LOT 21, DP714858 HEARNES LAKE ROAD, WOOLGOOLGA
WATER CONCEPT PLAN

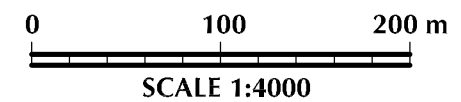

MAP 4W

Amendment No. 06265

G

6 JULY 2007

RDG

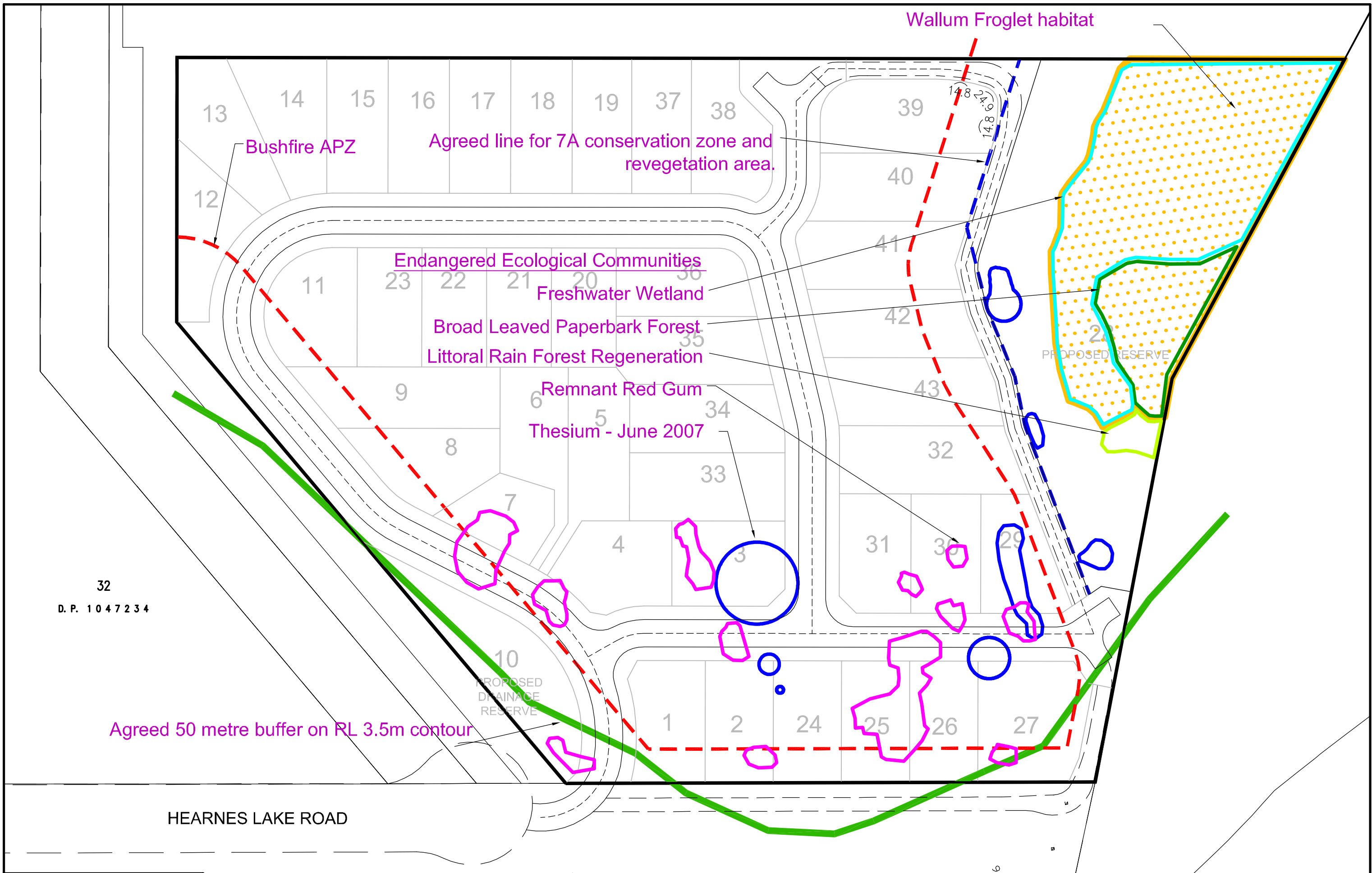

32
D. P. 1 0 4 7 2 3 4

Agreed 50 metre buffer on RL 3.5m contour

HEARNES LAKE ROAD

de Groot & Benson Pty Ltd
Consulting Engineers & Planners

A.C.N. 852 300 571
236 Harbour Drive
Coffs Harbour NSW 2450

Phone (02) 6652 1700
Fax (02) 6652 7418
Email email@dgbl.com.au

RESIDENTIAL SUBDIVISION
LOT 21, DP714858 HEARNES LAKE ROAD, WOOLGOOLGA
PLANNING NSW - CONSTRAINTS PLAN

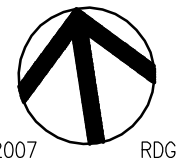
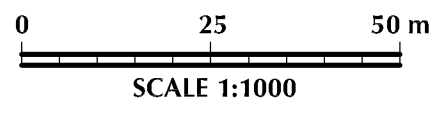

MAP 20
06265
Amendment No.
G

6 JULY 2007 RDG

