

32
D.P. 1047234

HEARNES LAKE ROAD

7A ENVIRONMENTAL PROTECTION
HABITAT & CATCHMENT

de Groot & Benson Pty Ltd
Consulting Engineers & Planners
A.C.N. 852 380 571
236 Harbour Drive
Coffs Harbour NSW 2450
Phone (02) 6652 1700
Fax (02) 6652 7418
Email email@dgpb.com.au

Geoff Smyth
Consulting
TOWN PLANNING & DEVELOPMENT ADVICE
124 Bellinger Road, PO Box 1809, Coffs Harbour NSW 2450

RESIDENTIAL SUBDIVISION
LOT 21, DP714858 HEARNES LAKE ROAD, WOOLGOOLGA
STAGING PLAN

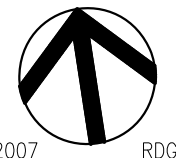
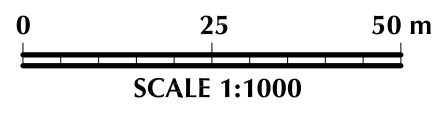

MAP 2
Amendment No. G
06265

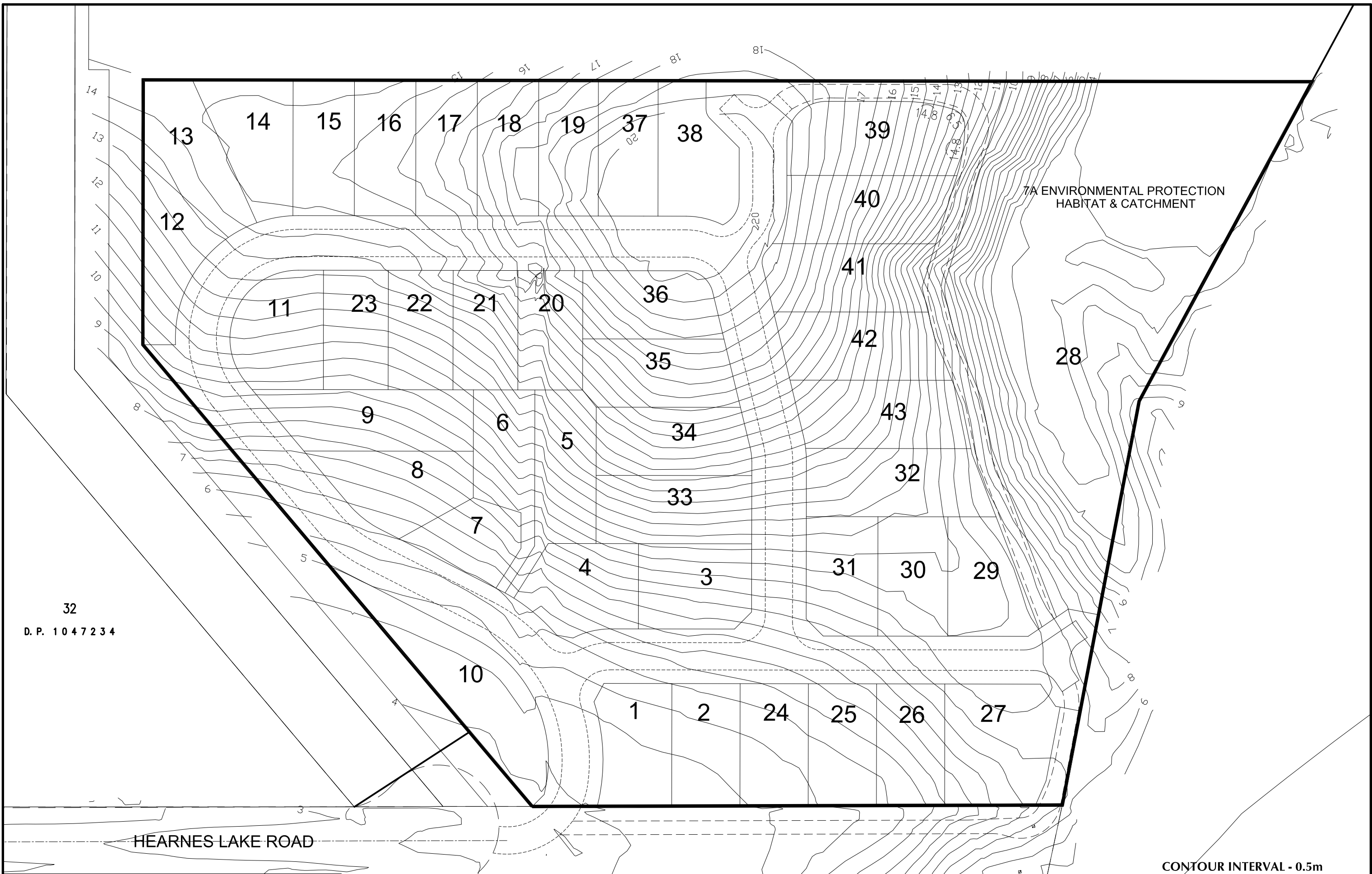

32
D.P. 1047234

HEARNES LAKE ROAD

7A ENVIRONMENTAL PROTECTION
HABITAT & CATCHMENT

CONTOUR INTERVAL - 0.5m

de Groot & Benson Pty Ltd
Consulting Engineers & Planners
A.C.N. 852 380 571
236 Harbour Drive
Coffs Harbour NSW 2450
Phone (02) 6652 1700
Fax (02) 6652 7418
Email email@dgbl.com.au

Geoff Smyth
Consulting
TOWN PLANNING & DEVELOPMENT ADVICE
134 Bellinger Road, PO Box 100, Coffs Harbour NSW 2450
Phone (02) 6652 1700
Fax (02) 6652 7418
Email geoff@gsmyth.com.au

RESIDENTIAL SUBDIVISION
LOT 21, DP714858 HEARNES LAKE ROAD, WOOLGOOLGA
SITE TOPOGRAPHY

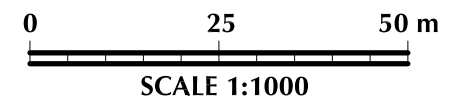

MAP 3
Amendment No. 06265
G

6 JULY 2007 RDG

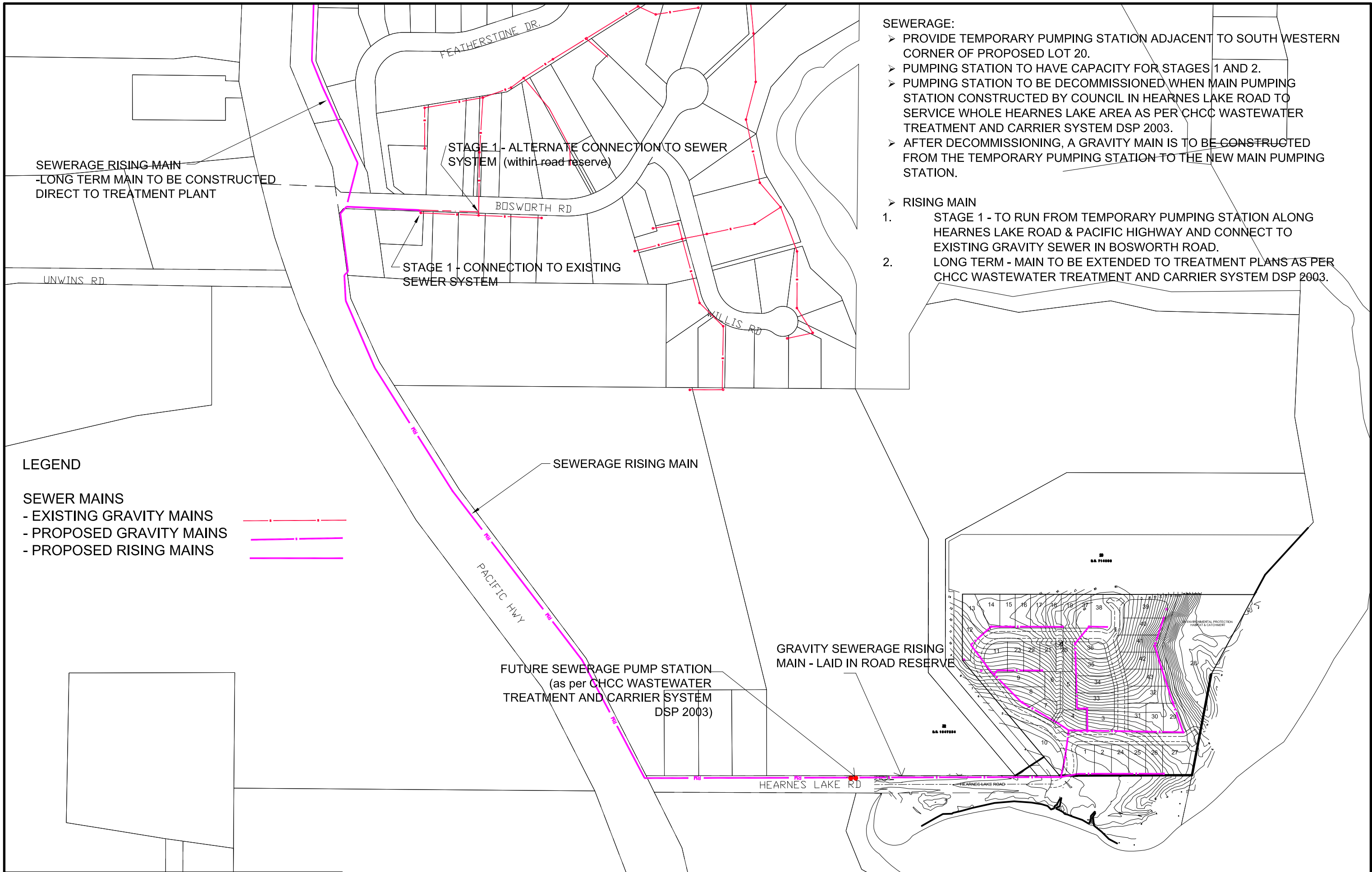

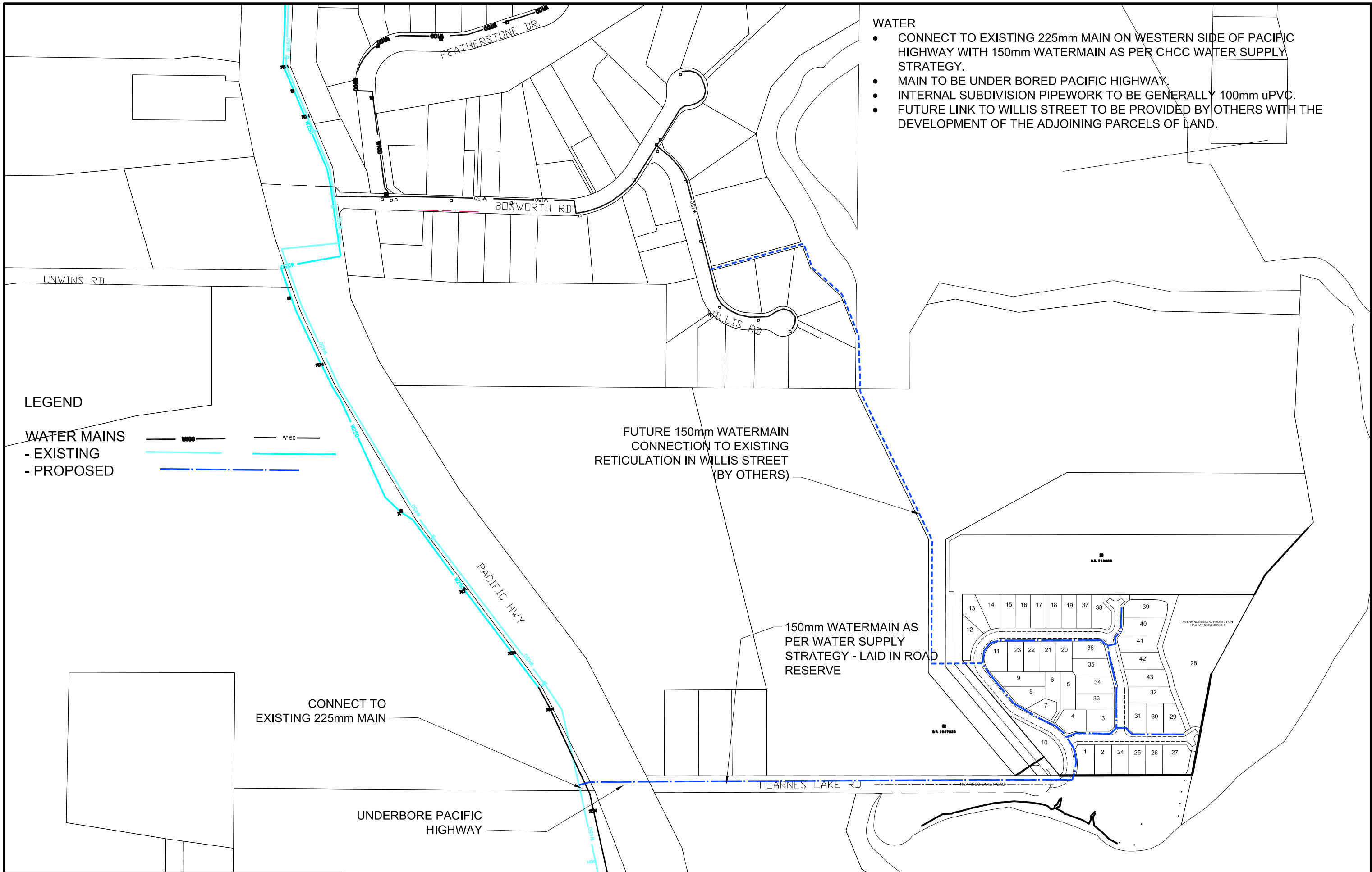

- WATER**
- CONNECT TO EXISTING 225mm MAIN ON WESTERN SIDE OF PACIFIC HIGHWAY WITH 150mm WATERMAIN AS PER CHCC WATER SUPPLY STRATEGY.
 - MAIN TO BE UNDER BORED PACIFIC HIGHWAY.
 - INTERNAL SUBDIVISION PIPEWORK TO BE GENERALLY 100mm uPVC.
 - FUTURE LINK TO WILLIS STREET TO BE PROVIDED BY OTHERS WITH THE DEVELOPMENT OF THE ADJOINING PARCELS OF LAND.

LEGEND

WATER MAINS
 - EXISTING
 - PROPOSED

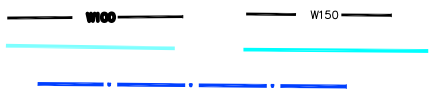

FUTURE 150mm WATERMAIN CONNECTION TO EXISTING RETICULATION IN WILLIS STREET (BY OTHERS)

150mm WATERMAIN AS PER WATER SUPPLY STRATEGY - LAID IN ROAD RESERVE

CONNECT TO EXISTING 225mm MAIN

UNDERBORE PACIFIC HIGHWAY

de Groot & Benson Pty Ltd
 Consulting Engineers & Planners
 A.C.N. 852 380 571
 236 Harbour Drive
 Coffs Harbour NSW 2450
 Phone (02) 6652 1700
 Fax (02) 6652 7418
 Email email@dgbl.com.au

Geoff Smyth Consulting
 TOWN PLANNING & DEVELOPMENT ADVICE
 124 Bellinger Road, PO Box 1809, Coffs Harbour NSW 2450
 Phone (02) 6652 1700
 Fax (02) 6652 7418
 Email geoff@geoffsmyth.com.au

RESIDENTIAL SUBDIVISION
 LOT 21, DP714858 HEARNES LAKE ROAD, WOOLGOOLGA
WATER CONCEPT PLAN

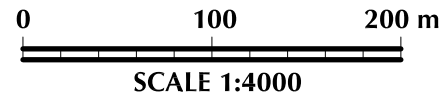

MAP 4W
 Amendment No. 06265
G

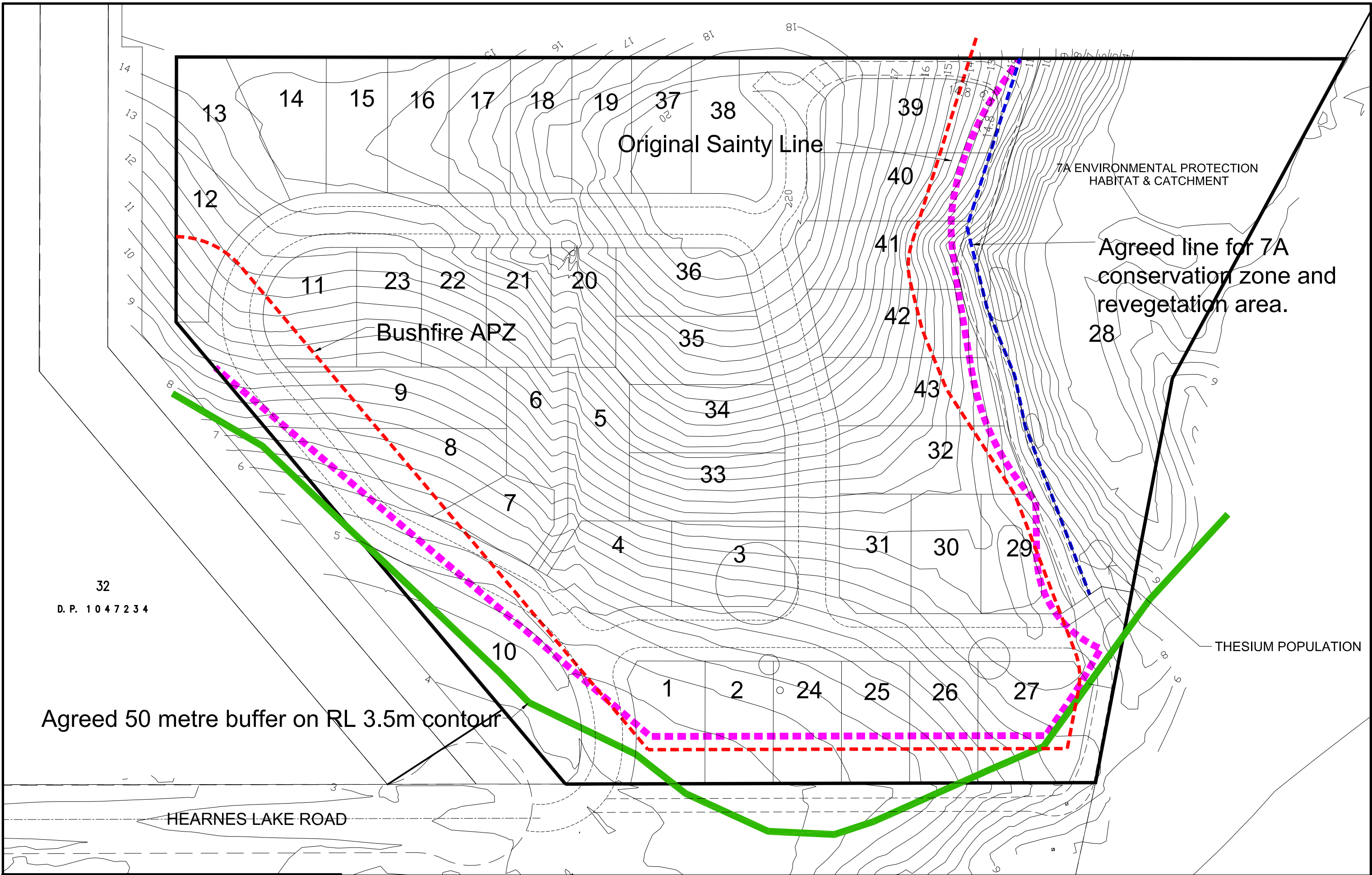



de Groot & Benson Pty Ltd
 Consulting Engineers & Planners
 A.C.N. 852 380 571
 236 Harbour Drive
 Coffs Harbour NSW 2450
 Phone (02) 6652 1700
 Fax (02) 6652 7418
 Email email@dgbl.com.au

Geoff Smyth
 Consulting
 TOWN PLANNING & DEVELOPMENT ADVICE
 133 Bellinger Road, PO Box 1805, Coffs Harbour NSW 2450
 Phone (02) 6652 2222
 Fax (02) 6652 2222
 Email geoff@geoffsmyth.com.au

RESIDENTIAL SUBDIVISION
 LOT 21, DP714858 HEARNES LAKE ROAD, WOOLGOOLGA
BUSHFIRE CONTROL PLAN

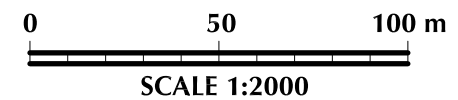

MAP 6
 Amendment No. 06265
 G

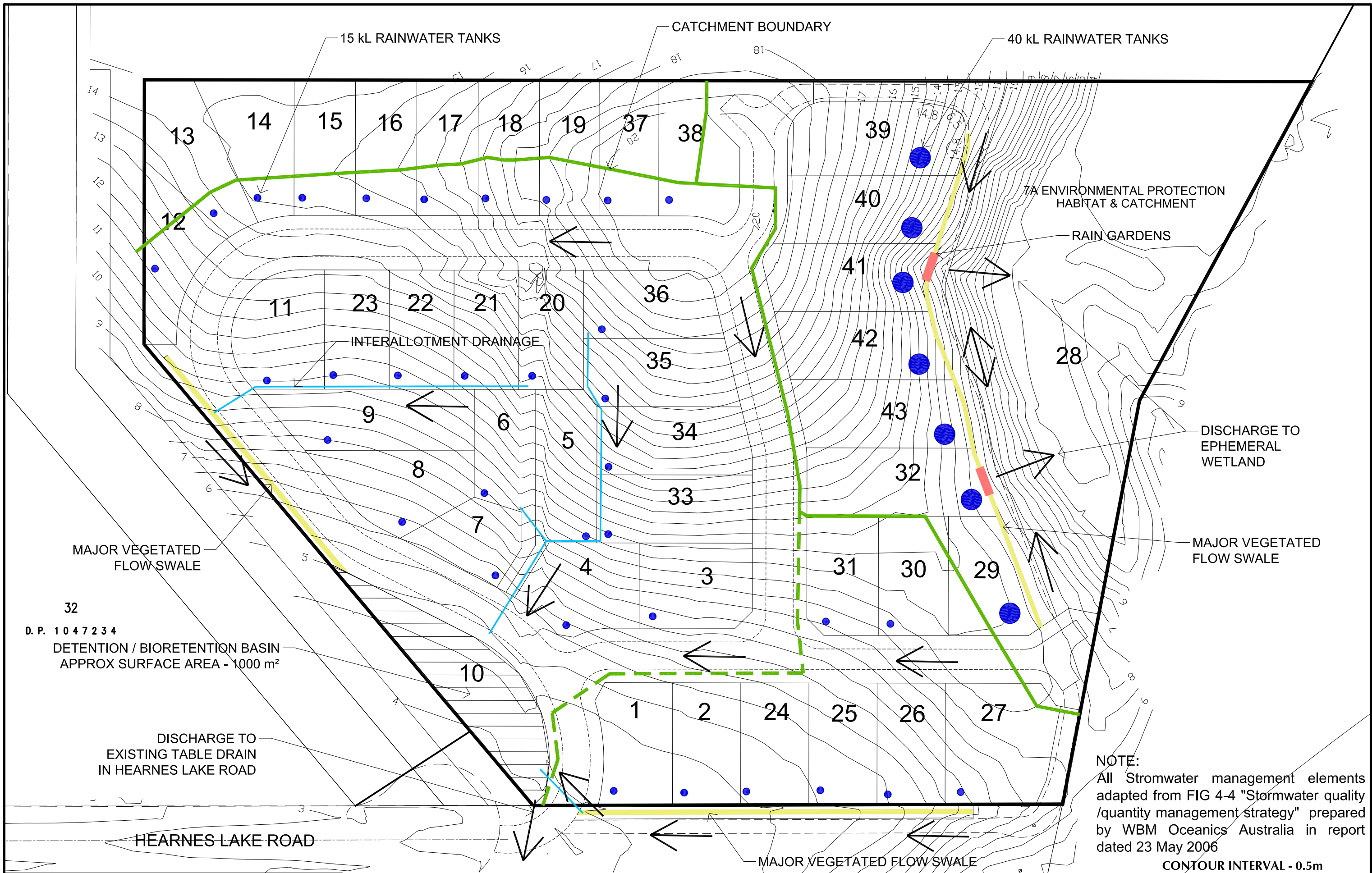

de Groot & Benson Pty Ltd
Consulting Engineers & Planners

A.C.N. 852 380 571
236 Harbour Drive
Coffs Harbour NSW 2450

Phone (02) 6652 1700
Fax (02) 6652 7418
Email email@dgpb.com.au

Geoff Smyth
Consulting

TOWN PLANNING & DEVELOPMENT ADVICE

124 Hargrave Road, PO Box 1805, Coffs Harbour NSW 2450

RESIDENTIAL SUBDIVISION
LOT 21, DP714858 HEARNES LAKE ROAD, WOOLGOOLGA
STORMWATER MANAGEMENT

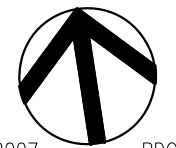
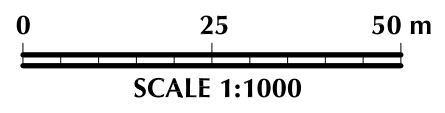

MAP 7
06265
Amendment No.
G