

PLAN LAYOUT - OSD TANK
SCALE 1:20

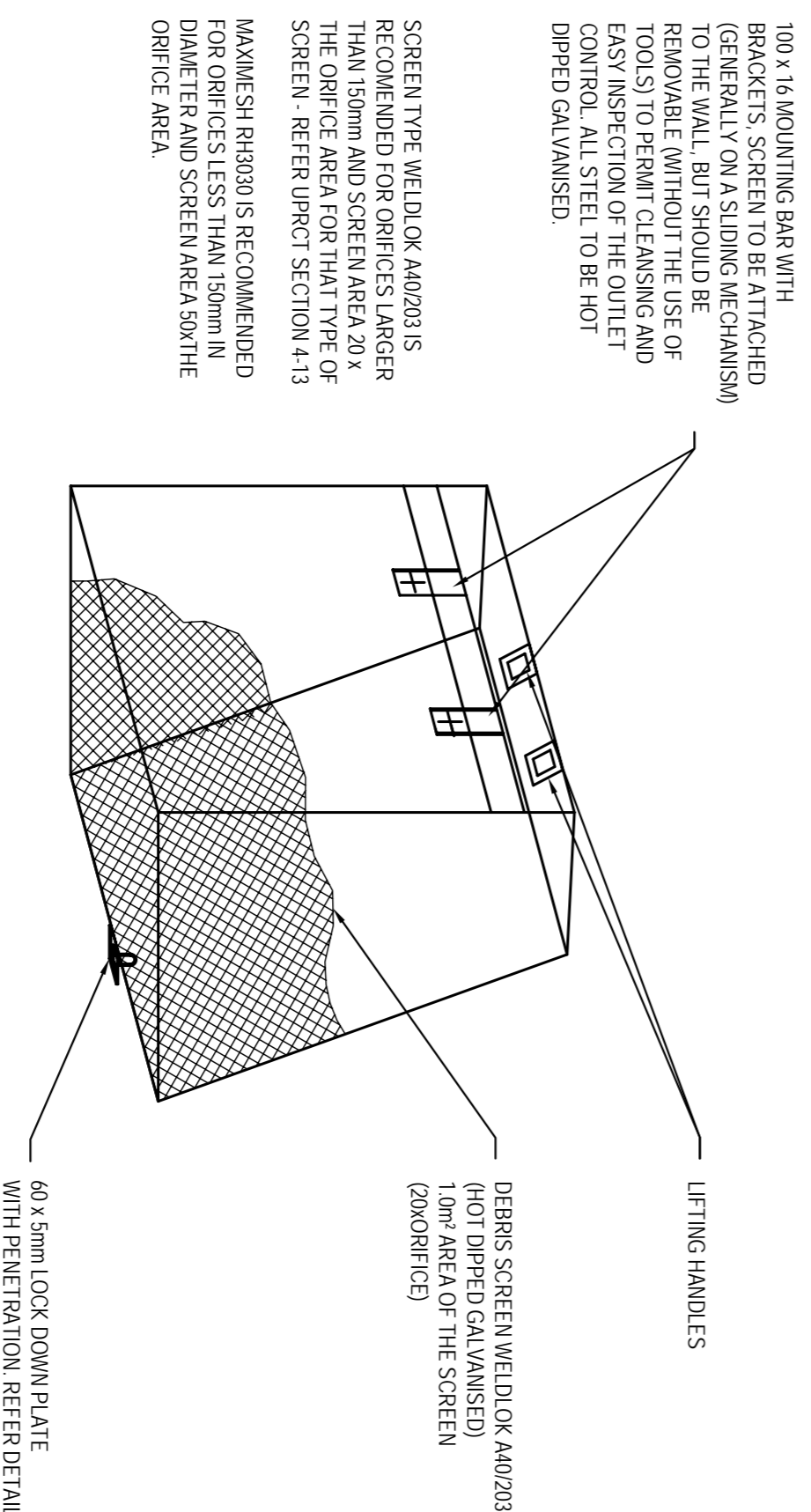

DEBRIS SCREEN DETAIL
NOT TO SCALE
ALL STEEL TO BE HOT DIPPED GALVANISED

ORIFICE PLATE DETAIL 1
SCALE 1:20

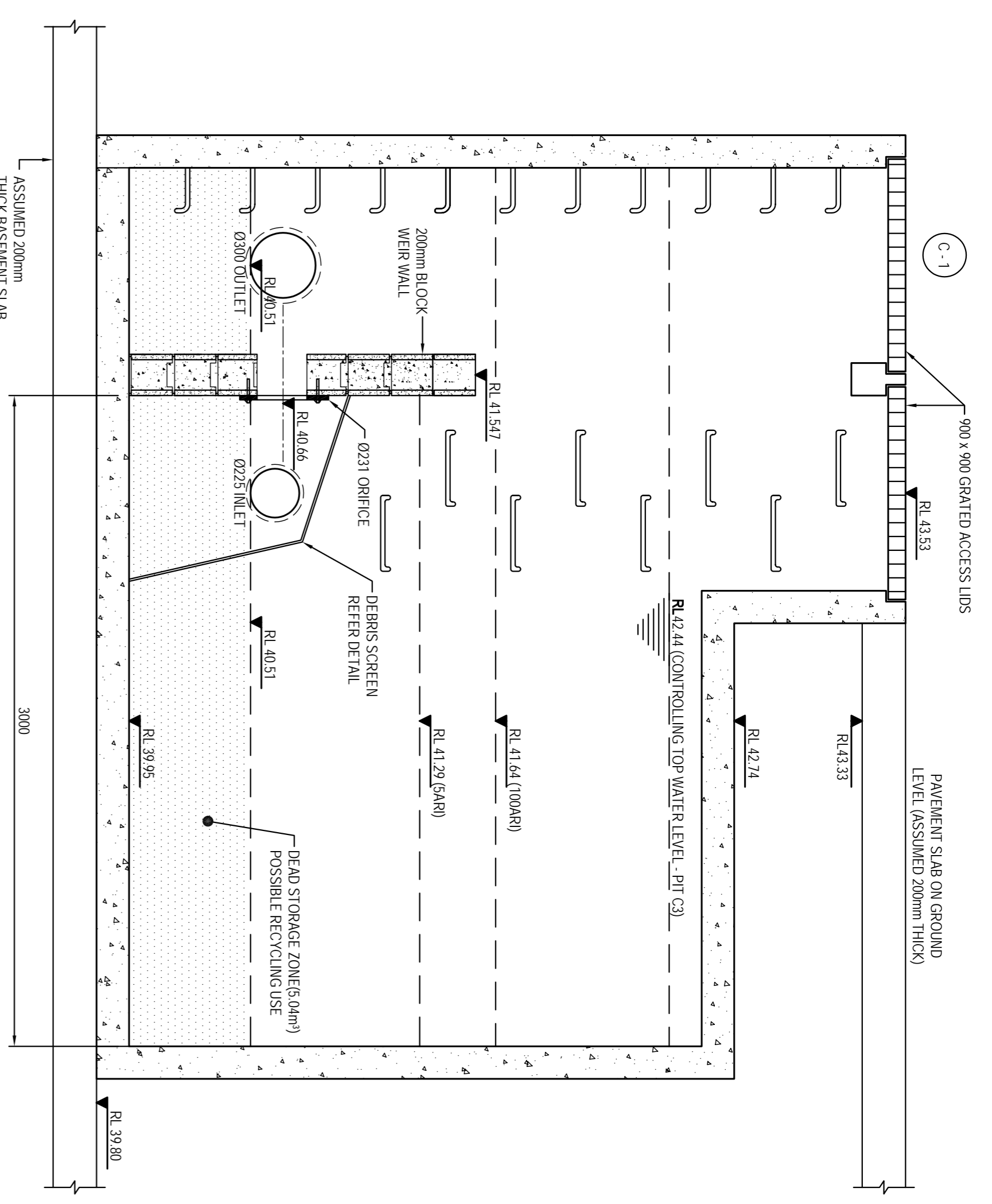
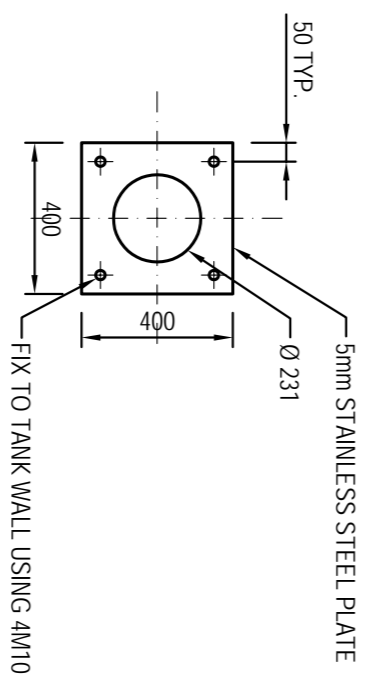

SECTION 1
SCALE 1:20

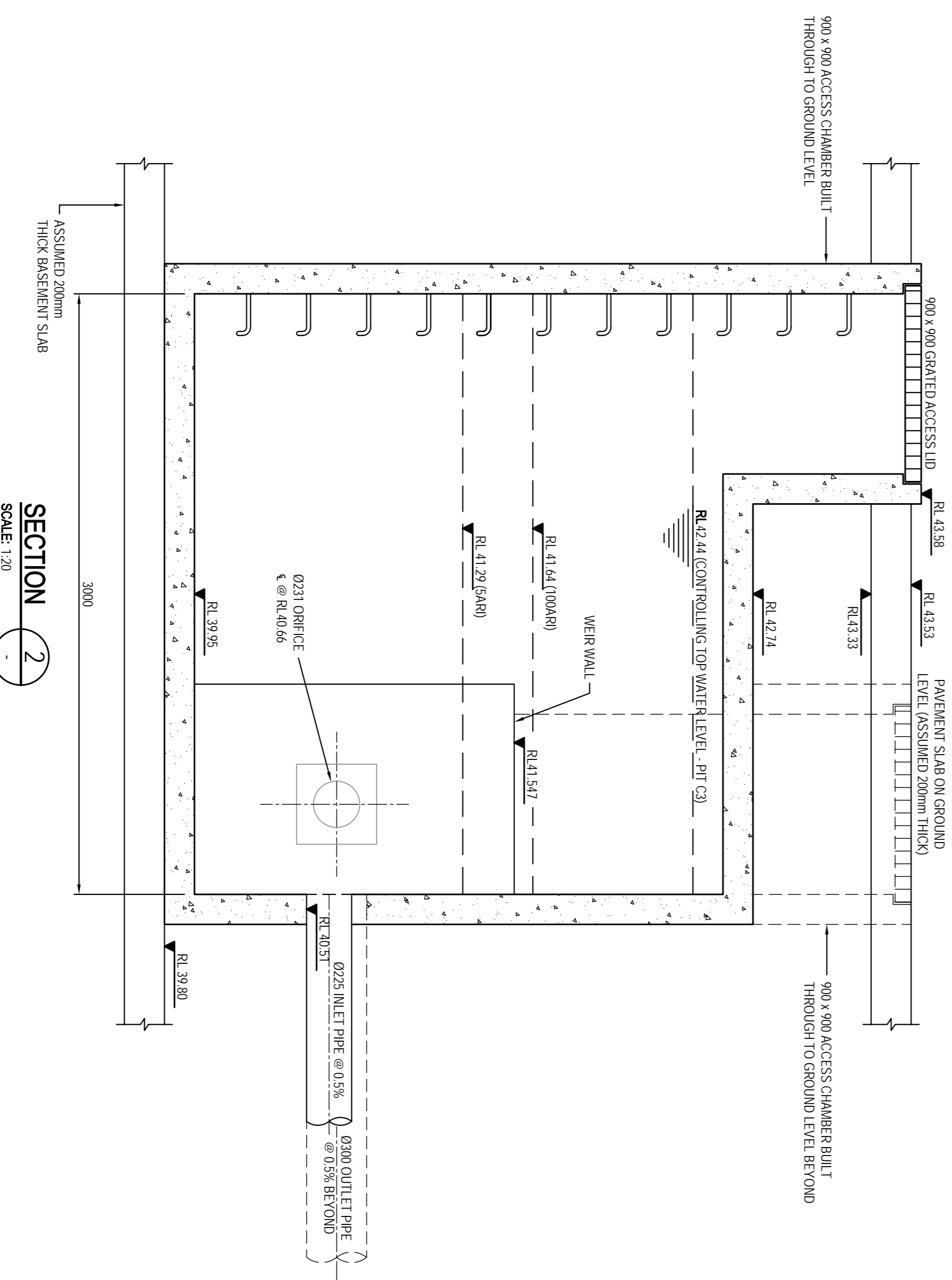

SECTION 2
SCALE 1:20



REVISION	AMENDMENT	DATE	REVISION	AMENDMENT	DATE
01	ISSUED FOR DA ONLY	01/04/2010			

Client	AA CROWN HOLDINGS PTY LTD
Architect	MURPHY'S ARCHITECTURE PTY LTD
This drawing and design remains the property of Henry & Hyman and may not be copied in whole or in part without the prior written approval of Henry & Hyman.	

HENRY & HYMAS
LEVEL 5 79 VICTORIA AVENUE
CHATSWOOD NSW 2067
Phone: 02 9417 6400
Fax: 02 9417 8337
Email: email@henryhyman.com.au
Web: www.henryhyman.com.au
Golder (Australia) Pty Ltd

Project
PROPOSED PRIVATE HOSPITAL
360-364 CROWN STREET WOLLONGONG
Title
OSD TANK PLAN, SECTIONS & DETAILS

Drawn	J.Liu	Designed	S. Cornin	Date	MAR 2010
Checked	T. Dampney	Approved	A. Francis	Scale	1:20 @ A1
Drawing number	10024_DA_C201	Revision			01

FOR DA ONLY