

17 SECTION-CARPARK ENTRY  
SCALE 1:100  
MALVERN AVENUE

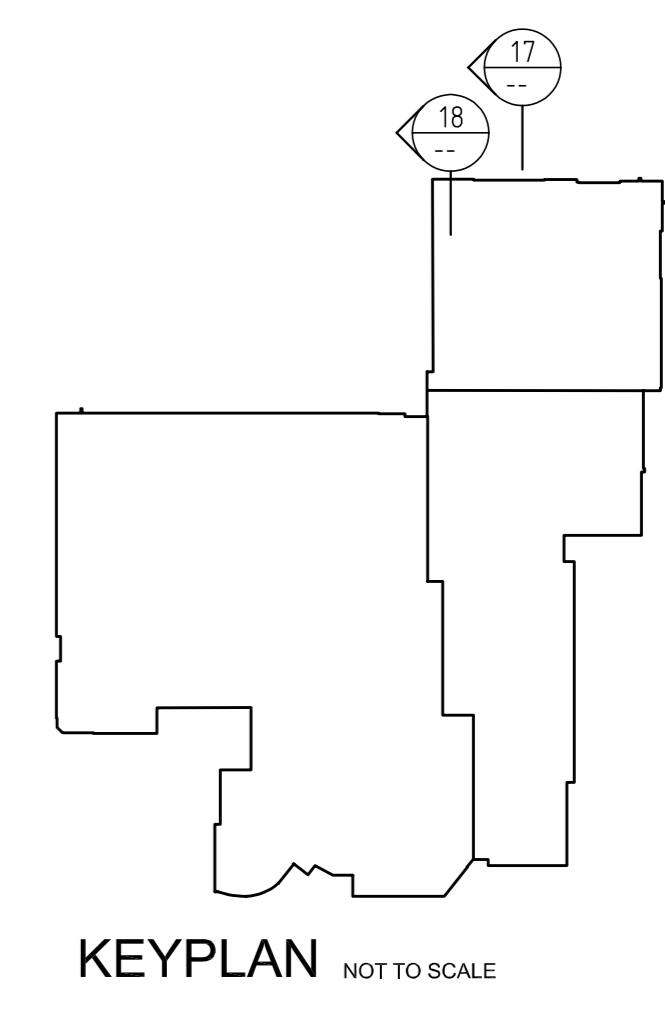

Revisions			
No.	Description	By	Date
00	DA SUBMISSION	JJ	11.04.07
01	DA INTERIM SUBMISSION	JJ	29.04.07
02	ISSUED TO JBA	JJ	21.05.07
03	ISSUED FOR RESUBMISSION	JJ	03.09.07
04	ISSUED FOR RESUBMISSION CLOUDS REMOVED	JJ	06.09.07
05	AMENDED FOR REVISED APPLICATION CLARIFICATION	JJ	28.09.07

Chatswood Chase Beautiful on Every Level  
**Chatswood Chase**  
 GROUP

**Colonial**  
**First State**  
 Property Management

THE **BUCHAN** GROUP  
 MELBOURNE  
 Buchanan Laid & Bowden (Pty) Ltd  
 A.C.N. 007 272 826  
 Architects Planners & Interior Designers  
 123 Rosslyn Street West Melbourne  
 Victoria 3003, AUSTRALIA  
 Tel: +613 9329 1077 Fax: +613 9329 0461  
 Email: btl@melbourne.buchan.com.au  
 © THE BUCHAN GROUP 2007

Project  
**CHATSWOOD CHASE REDEVELOPMENT**

Drawing Title  
**SECTIONS - MALVERN AVENUE**

This drawing has not been checked or approved unless signed. Checked by: Approved by:

Drawn by: **AS1**  
Date: **23-03-07**  
Scale: **1:100 @ A0**

Project Number: 305059 Drawing Number: ATP 506 Revision: 05

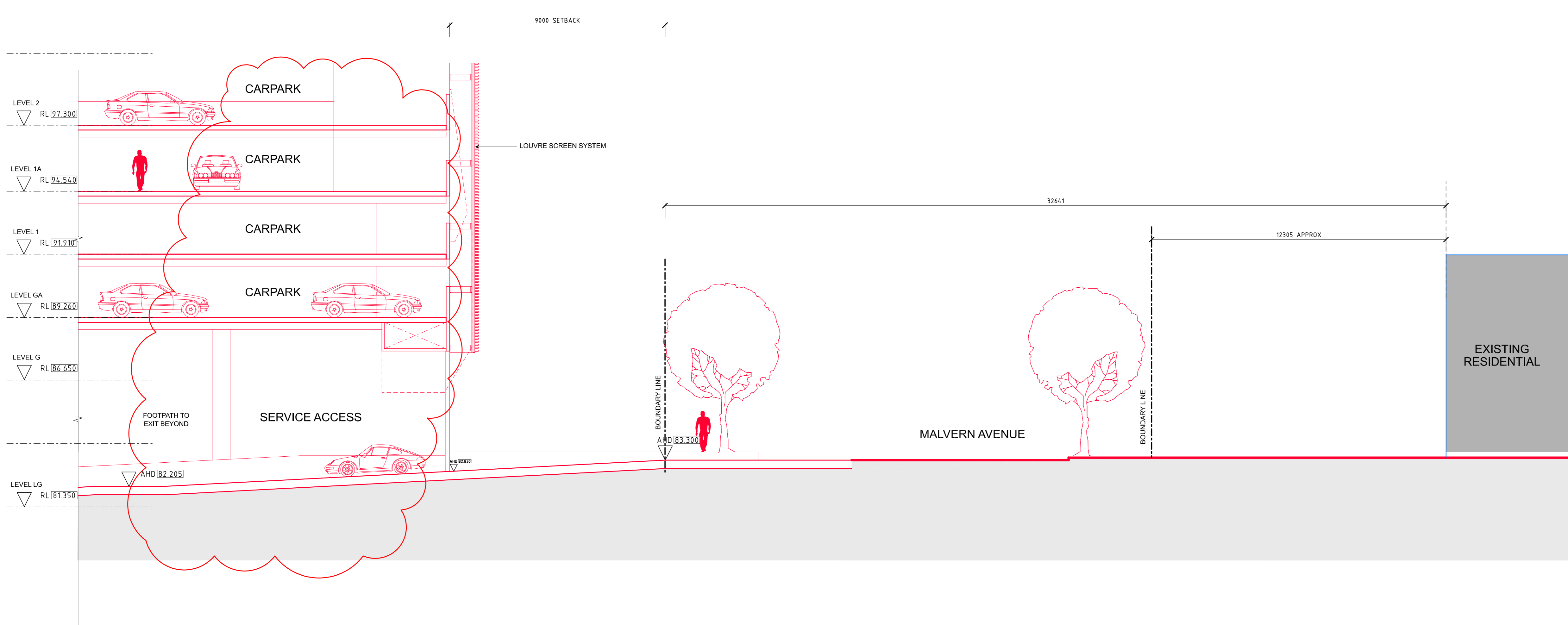

18 SECTION-SERVICE ENTRY  
SCALE 1:100  
MALVERN AVENUE