



Giovanni Cirrillo  
Executive Director  
Urban Renewal and Major Sites  
Department of Planning  
GPO Box 39  
**SYDNEY 2000 NSW**

Dear Mr Cirrillo

I refer to Determination of Major Project 06-0232 in respect to the Southern Highlands Regional Shooting Complex, Wattle Ridge Road, Hill Top.

Condition of Approval C1 provides for a staged vegetation clearing, and notes in particular that clearing for the 500m range is to be in accordance with Drawing No. 21-17859-C004 Rev A prepared by GHD. In summary, the approval permitted certain vegetation clearing of the head of the proposed 200m rifle/pistol range to allow access to the sedimentation pond area to the west of the 500/200 ranges.

Advice indicates that the C1 approval did not incorporate the exact drawing reference provided by GHD to allow this clearing to take place. We would seek for this matter to be rectified in order that the Approval details the correct drawing.

I refer also to the plan detail for the 500m rifle range. In the Environmental Assessment Report and subsequent documentation provided to the Department, the exact location of the 500m range was detailed.

Subsequent to Quantity Surveyor costings for the 500m range based on detailed drawings and topography configurations, it became clear that major earth works and clearing would be required at the stop-but end of the range (western aspect). It was estimated that a very significant earth moving exercise would be required to construct the stop-but and that it would encroach onto the beginning of a gully.

This was a major impediment to clearing and construction of the 500m range. It required Communities NSW (Sport and Recreation) to review the proposals for this range, including whether the range could physically be constructed. A shorter range length was contemplated.

It was finally agreed with GHD that the best approach to reduce the significant earth moving exercise, including the excessive cost involved, would be to lower the range and to re-locate it approximately 50m towards Wattle Ridge Road. The effect of this relocation would allow a fully functioning range without the need to clear additional vegetation and would overcome the requirement for a massive earth clearing operation.

Detail on the re-located 500m rifle range is included in the attached drawing, Drawing No. 21-17850-C004 prepared by GHD. We apologise for not submitting this re-located position for the 500m range.



Accordingly, we seek approval by the Department of Planning of the re-located site for the 500m rifle range, 200m rifle/pistol range and sedimentation pond location at the Southern Highlands Regional Shooting Complex as per the attached drawing.

Site clearing work has commenced and is current temporarily stopped due to proceedings in the Land and Environment Court. It would be appreciated if this approval could be expedited.

Yours sincerely

  
**Darryl Clout**  
General Manager  
19/10/2010

**LEGEND**

--- LIMIT OF CLEARING

--- EXTENT OF DETAILED SURVEY

--- CONTIGUOUS EXTERNAL TO THIS AREA BASED ON TOP AERIAL CONTIGUOUS INFORMATION THEREFOR. EXTENT OF DESIGN BOUNDARIES AND OF DETAILED SURVEY AREAS MAY VARY.



**RIFLE RANGE CLEARING SETOUT TABLE**

PT	EASTING	NORTHING
R1	265458.097	620045.562
R2	265554.402	620034.031
R3	265495.307	620024.580
R4	265542.013	620019.852
R5	265502.716	620013.641
R6	265442.435	620005.282
R7	265772.869	6199906.483
R8	265466.536	6199886.483
R9	265469.826	6199882.885
R10	265555.891	6199861.879
R11	265171.347	6199901.289
R12	265146.807	6199918.362
R13	265108.872	6199926.601
R14	265122.270	6199978.998
R15	265197.578	6199975.576
R16	265255.504	620019.543
R17	265223.17	620014.8353
R18	265255.813	6200198.695
R19	265292.221	6200170.548
R20	265301.427	6200127.745
R21	265238.833	6200172.786
R22	26524.3295	620018.473
R23	265283.548	620075.389
R24	26534.057	62004.33452
R25	265321.011	62004.06078
R26	265413.899	620034.6307

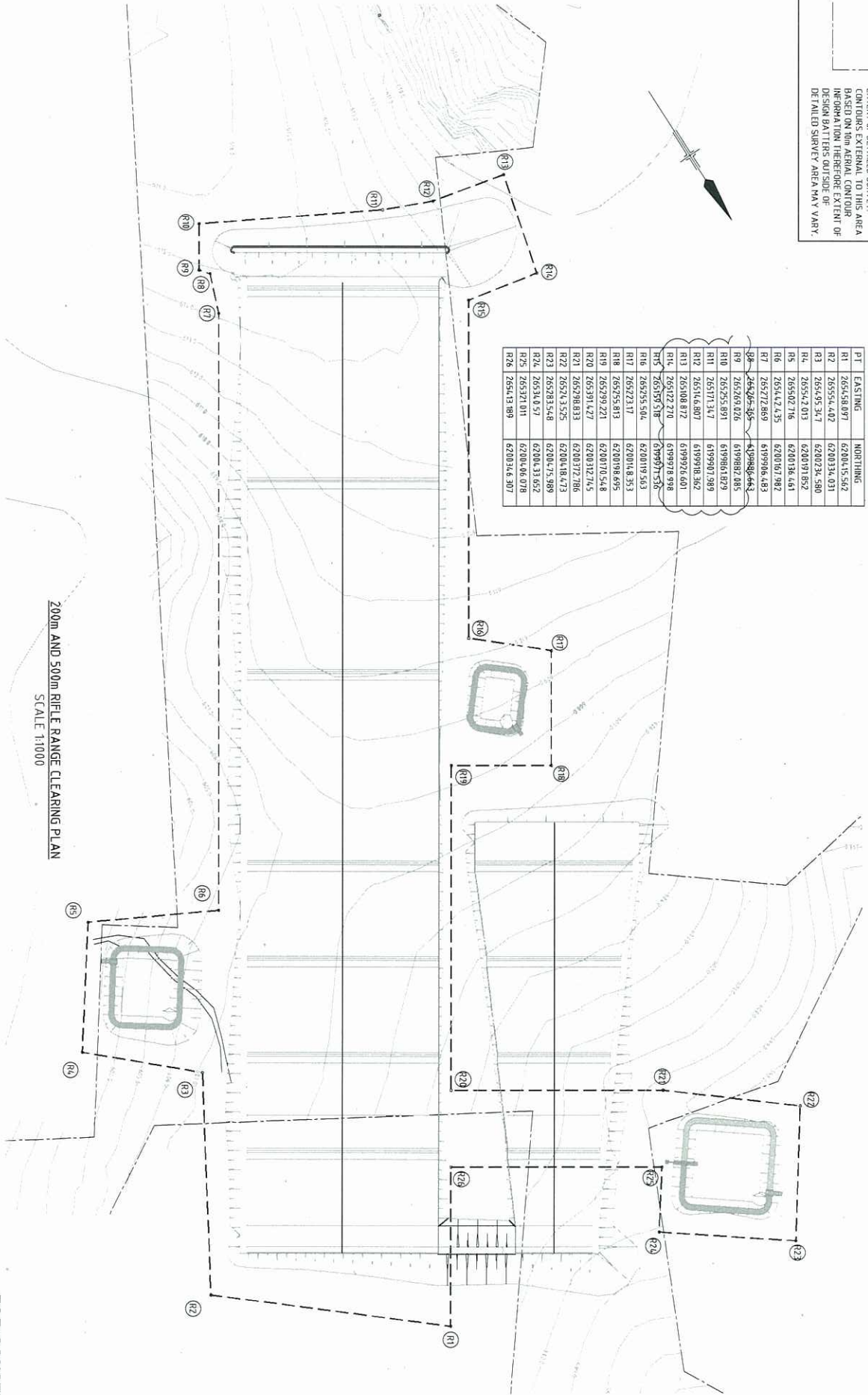

**200M AND 500M RIFLE RANGE CLEARING PLAN**  
SCALE 1:1000

**FOR CONSTRUCTION**

0	ISSUED FOR CONSTRUCTION	DATE	11-10-10
1	REVISED	DATE	
2	REVISED	DATE	
3	REVISED	DATE	
4	REVISED	DATE	
5	REVISED	DATE	
6	REVISED	DATE	
7	REVISED	DATE	
8	REVISED	DATE	
9	REVISED	DATE	
10	REVISED	DATE	

0 10 20 30 40 50m  
SCALE FROM A1 ORIGINAL SIZE

**NEWPORT & Associates**  
Level 10, 20 South Street, Parramatta NSW 2150 Australia  
Tel: 02 9638 9200 Fax: 02 9638 9201  
E: info@newport.com.au W: www.newport.com.au

**GHD** CLIENTS | PEOPLE | PERFORMANCE  
Level 10, 20 South Street, Parramatta NSW 2150 Australia  
Tel: 02 9638 9200 Fax: 02 9638 9201  
E: info@ghd.com.au W: www.ghd.com.au

**DO NOT SCALE**

Drawn	M. BELLOW	Designed	A. HORTON
Checked	S. ATKINS	Checked	F. CARROZZA
Approved	A. HORTON	Scale	AS SHOWN
Date	11.10.2010		

Client: **COMMUNITIES NSW**  
Project: **HILL TOP RANGE CLEARING SETOUT PLAN**  
Sheet: **SHEET 1**  
Drawing No: **21-17850-C004**

Rev: **0**