

Appendix B: Groundwater Bore Search Data

Department of Infrastructure, Planning and Natural Resources

Groundwater Locations



Department of Infrastructure, Planning
and Natural Resources

Area: Bannaweera
Client: Mausell Australia
PO Box Q410
QVB Post Office NSW 1230
Contact: Michael Borman
Date of Search: 30-10-03
By: Richard Myers
Job Ref: BAIGDS0093



1000 0 1000 2000 Metres

LEGEND	
	Groundwater Works Number
	Cadastral Boundaries
	Area of Interest

Data depicted here is the most up to date held by DIPNR in their Groundwater Database, at the time of printing.

Disclaimer

The State of New South Wales and the Department of Infrastructure, Planning and Natural Resources and its employees, officers, agents or servants are not responsible for the result of any actions taken on the basis of the information contained on this map or for any errors, omissions or inaccuracies contained in this map. The State of New South Wales and its employees, officers, agents or servants expressly disclaim all and any liability and responsibility to any person in respect of anything and of the consequences, of anything done or omitted to be done by any such person in reliance, whether wholly or partially upon the information contained on the map.

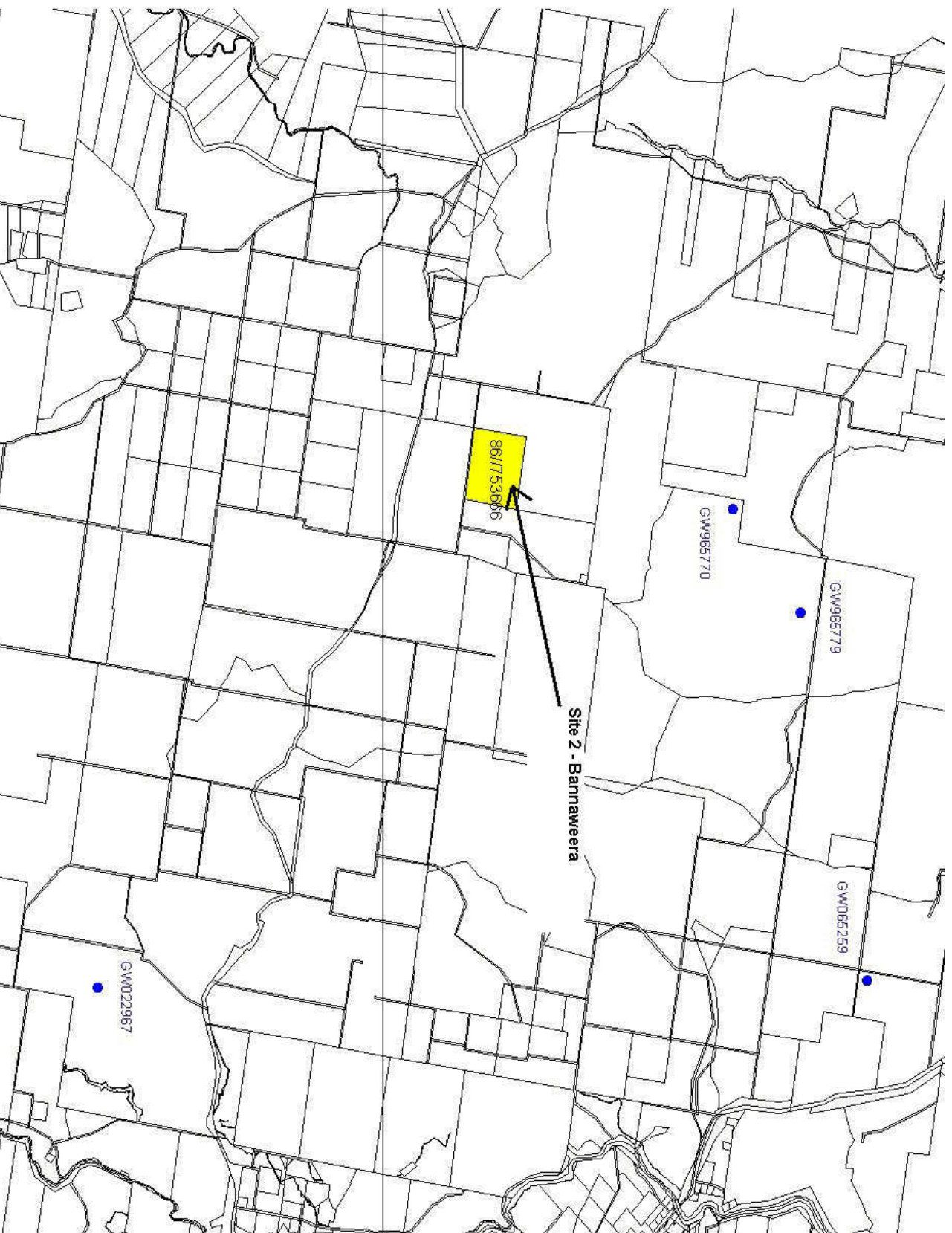

Date/Time :29-Oct-2003 01:22 PM
 User :GUEST
 Report :RMGW001D.QRP
 Executable :S:\G5\PROD32\Ground.exe
 Exe Date :29-Nov-2002
 System :Groundwater
 Database :Dlwcp



DEPARTMENT OF INFRASTRUCTURE, PLANNING AND NATURAL RESOURCES

Work Summary

GW022967

Converted From HYDSYS

License :30BL016312	Authorised Purpose(s) STOCK	Intended Purpose(s) STOCK
Work Type :Bore		
Work Status :(Unknown)		
Construct. Method :Rotary		
Owner Type :Private		
Commenced Date :	Final Depth : 12.80 m	
Completion Date :01-Nov-1965	Drilled Depth : 12.80 m	
Contractor Name :		
Driller :		
Property : - WILSONS CREEK	Standing Water Level :	
GWMA : -	Salinity :	(Unknown)
GW Zone : -	Yield :	

Site Details

Site Chosen By	County Form A :SANDON Licensed :SANDON	Parish DEVON DEVON	Portion/Lot DP 211 LT DP
Region :30 - NORTH COAST		CMA Map :9136-1S	URALLA
River Basin :418 - GWYDIR RIVER		Grid Zone :56/1	Scale :1:25,000
Area / District :			
Elevation :		Northing :6607132	Latitude (S) :30° 39' 32"
Elevation Source :(Unknown)		Easting :349859	Longitude (E) :151° 25' 59"
GS Map :0029B3	AMG Zone :56	Coordinate Source :GD.,ACC.MAP	

Construction

Negative depths indicate Above Ground Level;H-Hole;P-Pipe;OD-Outside Diameter;ID-Inside Diameter;C-Cemented;SL-Slot Length;A-Aperture;GS-Grain Size;Q-Quantity

H	P	Component	Type	From (m)	To (m)	OD (mm)	ID (mm)	Interval	Details
1	1	Casing	Threaded Steel	-0.30	11.60	127			Driven into Hole
1	1	Opening	Slots	8.50	11.50	127		1	SL: 0mm; A: 0mm

Water Bearing Zones

From (m)	To (m)	Thickness (m)	WBZ Type	S.W.L. (m)	D.D.L. (m)	Yield (L/s)	Hole Depth (m)	Duration (hr)	Salinity (mg/L)
9.80	10.10	0.30	Fractured						(Unknown)
12.20	12.40	0.20	Fractured			0.63			(Unknown)

Drillers Log

From (m)	To (m)	Thickness(m)	Drillers Description	Geological Material	Comments
0.00	0.61	0.61	Topsoil	Topsoil	
0.61	1.22	0.61	Clay	Clay	
1.22	2.44	1.22	Basalt	Basalt	
2.44	5.49	3.05	Clay	Clay	
5.49	9.14	3.65	Basalt Decomposed	Basalt	
9.14	12.19	3.05	Basalt Water Bearing	Basalt	
12.19	12.80	0.61	Granite Water Supply	Granite	

Remarks

*** End of GW022967 ***

DEPARTMENT OF INFRASTRUCTURE, PLANNING AND NATURAL RESOURCES

Work Summary

GW965770

License :90BL250685

Work Type :Bore
 Work Status :New Bore
 Construct. Method :Rotary Air
 Owner Type :Private

Authorised Purpose(s)
 DOMESTIC
 STOCK

Intended Purpose(s)
 DOMESTIC
 STOCK

Commenced Date : Final Depth : 57.90 m
 Completion Date :11-Jun-2002 Drilled Depth : 57.90 m

Contractor Name :J.V. KEEN
 Driller :1635 KEEN, John Vincent

Property : - MERRINDEE
 GWMA : -
 GW Zone : -

Standing Water Level : 12.20 m
 Salinity : 0.50 mg/L
 Yield : 1.30 L/s

Site Details

Site Chosen By : Diviner
 Driller :
 County : Form A :
 Licensed :HARDINGE
 Parish : MORSE
 Portion/Lot DP : LT 3 DP 591627
 Region :90 - BARWON
 River Basin :
 Area / District :
 CMA Map :
 Grid Zone : Scale :
 Elevation :
 Elevation Source :
 Northing :6615404
 Easting :344307
 Latitude (S) :30° 35' 1"
 Longitude (E) :151° 22' 35"
 GS Map : AMG Zone :56
 Coordinate Source :Map Interpretation

Construction

Negative depths indicate Above Ground Level;H-Hole;P-Pipe;OD-Outside Diameter;ID-Inside Diameter;C-Cemented;SL-Slot Length;A-Aperture;GS-Grain Size;Q-Quantity

H	P	Component	Type	From (m)	To (m)	OD (mm)	ID (mm)	Interval	Details
1		Hole	Hole	0.00	57.90	155			Rotary Air
1	1	Casing	PVC Class 9	-0.30	57.90	140	128		Rivet; Seated on Bottom
1	1	Opening	Slots - Horizontal	39.60	57.90	140			PVC Class 9; Sawn; SL: 50mm; A: 2mm

Water Bearing Zones

From (m)	To (m)	Thickness (m)	WBZ Type	S.W.L. (m)	D.D.L. (m)	Yield (L/s)	Hole Depth (m)	Duration (hr)	Salinity (mg/L)
39.60	51.80	12.20		12.20		0.51		1.00	0.50

Drillers Log

From (m)	To (m)	Thickness(m)	Drillers Description	Geological Material	Comments
0.00	0.30	0.30	topsoil/granite		
0.30	45.70	45.40	granitesand/coarse	Granite	
45.70	57.90	12.20	graniterock/blue	Granite	

Remarks

Form A Remarks:
 contractor is taken as the drillers name: J. Keen
 at water bearing zone 57.9m the estimated yield is 1.3L/s.
 type of casing bottom: open end.
 method of fixing code: glued and riveted.
 water entry opening type: casing-hand sawn slot.

*** End of GW965770 ***

DEPARTMENT OF INFRASTRUCTURE, PLANNING AND NATURAL RESOURCES

Work Summary

GW965779

License :90BL250686	Authorised Purpose(s) DOMESTIC STOCK	Intended Purpose(s) DOMESTIC STOCK
Work Type :Bore		
Work Status :New Bore		
Construct. Method :Rotary Air		
Owner Type :Private		
Commenced Date :	Final Depth :	47.30 m
Completion Date :07-Jun-2002	Drilled Depth :	47.30 m
Contractor Name :J.V. KEEN		
Driller :I635	KEEN, John Vincent	
Property : - MERRINDEE	Standing Water Level :	18.30 m
GWMA : -	Salinity :	0.50 mg/L
GW Zone : -	Yield :	0.57 L/s

Site Details

Site Chosen By Diviner	Driller	County Form A : Licensed :HARDINGE	Parish MORSE	Portion/Lot DP LT 3 DP 591627
Region :90 - BARWON			CMA Map :	
River Basin :			Grid Zone :	Scale :
Area / District :				
Elevation :			Northing :6616300	Latitude (S) :30° 34' 33"
Elevation Source :			Easting :345475	Longitude (E) :151° 23' 19"
GS Map :	AMG Zone :56		Coordinate Source :Map Interpretation	

Construction

Negative depths indicate Above Ground Level;H-Hole;P-Pipe;OD-Outside Diameter;ID-Inside Diameter;C-Cemented;SL-Slot Length;A-Aperture;GS-Grain Size;Q-Quantity

H	P	Component	Type	From (m)	To (m)	OD (mm)	ID (mm)	Interval	Details
1		Hole	Hole	0.00	47.30	155			Rotary Air
1	1	Casing	PVC Class 9	-0.30	47.30	140		128	Rivet; Seated on Bottom
1	1	Opening	Slots - Horizontal	27.40	47.30	140			PVC Class 9; Sawn; SL: 50mm; A: 2mm

Water Bearing Zones

From (m)	To (m)	Thickness (m)	WBZ Type	S.W.L. (m)	D.D.L. (m)	Yield (L/s)	Hole Depth (m)	Duration (hr)	Salinity (mg/L)
42.70	45.10	2.40		18.30		0.51		1.00	0.50
45.10	47.30	2.20				0.57			

Drillers Log

From (m)	To (m)	Thickness(m)	Drillers Description	Geological Material	Comments
0.00	0.30	0.30	topsoil - granite	Granite	
0.30	12.20	11.90	granite/soft and grey	Granite	
12.20	27.40	15.20	granite/hard blue	Granite	
27.40	47.30	19.90	granite/weathered blue grey	Granite	

Remarks

Form A Remarks:
checked the bore location in the GIS

Casing method of fixing - glued and riveted.
type of casing bottom - open end.

water entry desing - casing hand sawn slot
fixing code - glued and riveted.

*** End of GW965779 ***

*** End of Report ***

Department of Infrastructure, Planning and Natural Resources

Groundwater Locations



Area: Tillbuster
Client: Mausell Australia
 PO Box Q410
 QVB Post Office
 NSW 1230
Contact: Michael Borman
Date of Search: 30-10-03
By: Richard Myers
Job Ref: BAGDS0093

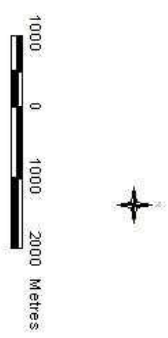

LEGEND

- Groundwater Works Number
- Cadastral Boundaries
- Area of Interest

Data depicted here is the most up to date held by DIPNR in their Groundwater Database, at the time of printing.

Disclaimer

The State of New South Wales and the Department of Infrastructure, Planning and Natural Resources and its employees, officers, agents or servants are not responsible for the result of any actions taken on the basis of the information contained on this map or for any errors, omissions or inaccuracies contained in this map. The State of New South Wales and its employees, officers, agents or servants expressly disclaim all and any liability and responsibility to any person in respect of anything and of the consequences, of anything done or omitted to be done by any such person in reliance, whether wholly or partially upon the information contained on the map.

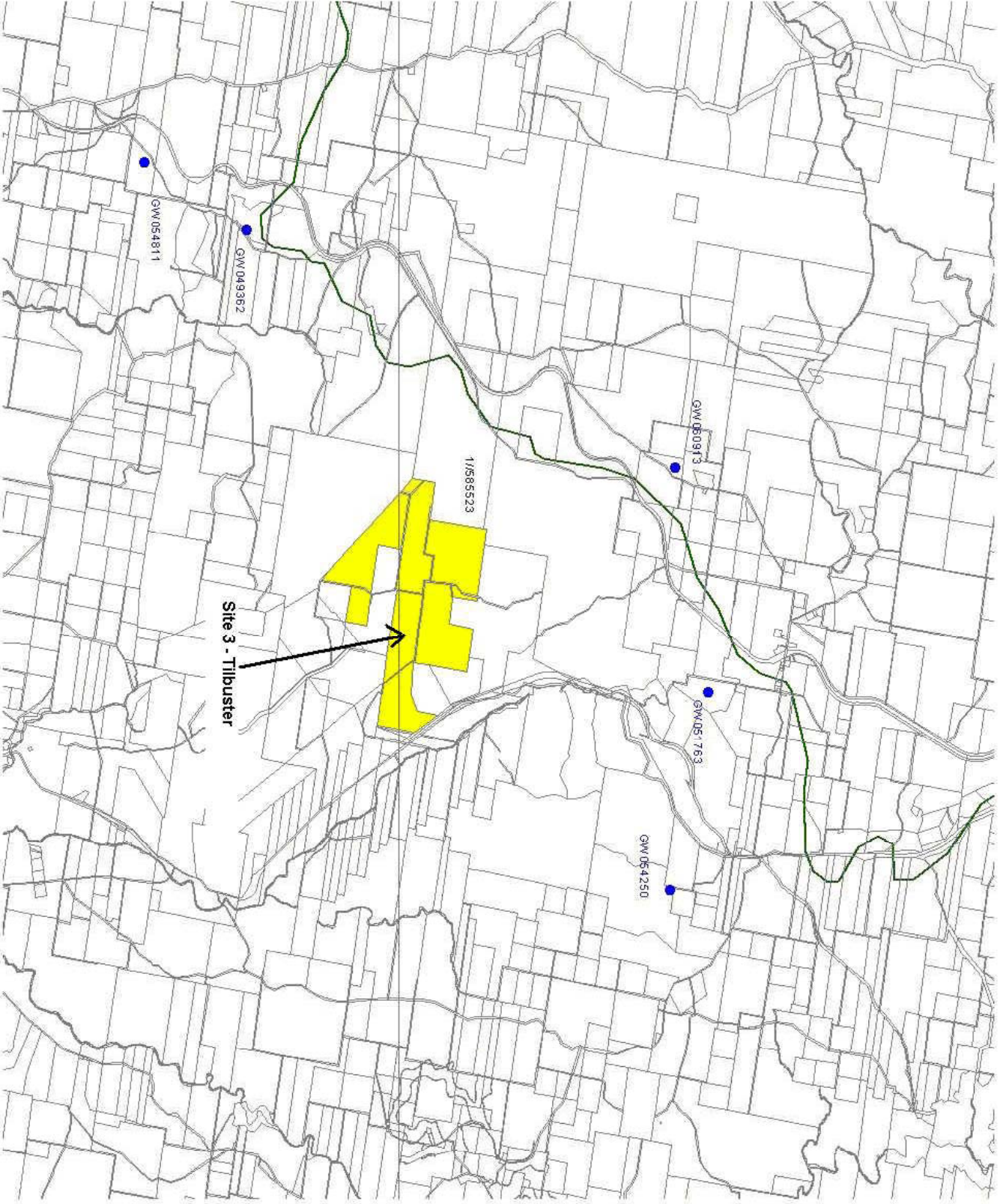

Date/Time :30-Oct-2003 03:48 PM
 User :GUEST
 Report :RMGW001D.QRP
 Executable :S:\G5\PROD32\Ground.exe
 Exe Date :29-Nov-2002
 System :Groundwater
 Database :Dlwcp



**Infrastructure, Planning
 and Natural Resources**

DEPARTMENT OF INFRASTRUCTURE, PLANNING AND NATURAL RESOURCES Work Summary

GW049362

Converted From HYDSYS

License :30BL107459	Authorised Purpose(s) STOCK	Intended Purpose(s) STOCK
Work Type :Bore		
Work Status :(Unknown)		
Construct. Method :Cable Tool		
Owner Type :Private		
Commenced Date :	Final Depth : 15.80 m	
Completion Date :01-Mar-1979	Drilled Depth : 15.90 m	
Contractor Name :		
Driller :		
Property : - THE LAURELS	Standing Water Level :	
GWMA : -	Salinity :	(Unknown)
GW Zone : -	Yield :	

Site Details

Site Chosen By	County Form A :SANDON Licensed :SANDON	Parish DUMARESQ DUMARESQ	Portion/Lot DP 104 104
Region :30 - NORTH COAST		CMA Map :9237-3S	DUMARESQ
River Basin :206 - MACLEAY RIVER		Grid Zone :56/1	Scale :1:25,000
Area / District :			
Elevation :		Northing :6635964	Latitude (S) :30° 24' 2"
Elevation Source :(Unknown)		Eastings :363990	Longitude (E) :151° 35' 3"
GS Map :0029C2	AMG Zone :56	Coordinate Source :GD.,ACC.MAP	

Construction

Negative depths indicate Above Ground Level;H-Hole;P-Pipe;OD-Outside Diameter;ID-Inside Diameter;C-Cemented;SL-Slot Length;A-Aperture;GS-Grain Size;Q-Quantity

H	P	Component	Type	From (m)	To (m)	OD (mm)	ID (mm)	Interval	Details
---	---	-----------	------	----------	--------	---------	---------	----------	---------

(No Construction Details Found)

Water Bearing Zones

From (m)	To (m)	Thickness (m)	WBZ Type	S.W.L. (m)	D.D.L. (m)	Yield (L/s)	Hole Depth (m)	Duration (hr)	Salinity (mg/L)
----------	--------	---------------	----------	------------	------------	-------------	----------------	---------------	-----------------

(No Water Bearing Zone Details Found)

Drillers Log

From (m)	To (m)	Thickness(m)	Drillers Description	Geological Material	Comments
0.00	2.74	2.74	Clay	Basalt	
2.74	14.02	11.28	Basalt	Rock	
14.02	15.85	1.83	Rock Grey		

Remarks

*** End of GW049362 ***

DEPARTMENT OF INFRASTRUCTURE, PLANNING AND NATURAL RESOURCES

Work Summary

GW051763

Converted From HYDSYS

License :90BL113703	Authorised Purpose(s) DOMESTIC STOCK	Intended Purpose(s) DOMESTIC STOCK
Work Type :Bore		
Work Status :(Unknown)		
Construct. Method :Cable Tool		
Owner Type :Private		
Commenced Date :	Final Depth : 42.60 m	
Completion Date :01-Oct-1980	Drilled Depth : 42.60 m	
Contractor Name :		
Driller :		
Property : - MILLBROOK	Standing Water Level :	
GWMA : -	Salinity :	Good
GW Zone : -	Yield :	

Site Details

Site Chosen By	County Form A :SANDON Licensed :SANDON	Parish EXMOUTH EXMOUTH	Portion/Lot DP 208 208
Region :90 - BARWON		CMA Map :9237-3N	BLACK MOUNTAIN
River Basin :206 - MACLEAY RIVER		Grid Zone :56/1	Scale :1:25,000
Area / District :			
Elevation :		Northing :6644610	Latitude (S) :30° 19' 24"
Elevation Source :(Unknown)		Easting :371300	Longitude (E) :151° 39' 41"
GS Map :0029C2	AMG Zone :56	Coordinate Source :GD.,ACC.MAP	

Construction

Negative depths indicate Above Ground Level;H-Hole;P-Pipe;OD-Outside Diameter;ID-Inside Diameter;C-Cemented;SL-Slot Length;A-Aperture;GS-Grain Size;Q-Quantity

H	P	Component	Type	From (m)	To (m)	OD (mm)	ID (mm)	Interval	Details
1	1	Casing	P.V.C.	0.00	42.60	133			Seated on Bottom
1	1	Opening	Slots - Vertical	18.30	42.60	133		1	Mechanically Slotted; SL: 0mm; A: 2.4mm

Water Bearing Zones

From (m)	To (m)	Thickness (m)	WBZ Type	S.W.L. (m)	D.D.L. (m)	Yield (L/s)	Hole Depth (m)	Duration (hr)	Salinity (mg/L)
35.80	42.60	6.80	(Unknown)	35.80		1.00			Good

Drillers Log

From (m)	To (m)	Thickness(m)	Drillers Description	Geological Material	Comments
0.00	12.50	12.50	Clay Dry	Clay	
12.50	14.30	1.80	Clay Moist	Basalt	
14.30	20.50	6.20	Basalt Hard	Shale	
20.50	26.70	6.20	Shale Black	Basalt	
26.70	40.10	13.40	Basalt Soft Water Supply	Basalt	
40.10	42.60	2.50	Gravel Water Supply	Gravel	

Remarks

*** End of GW051763 ***

DEPARTMENT OF INFRASTRUCTURE, PLANNING AND NATURAL RESOURCES

Work Summary

GW054250

Converted From HYDSYS

License :30BL114731	Authorised Purpose(s) DOMESTIC STOCK	Intended Purpose(s) DOMESTIC STOCK
Work Type :Bore		
Work Status :(Unknown)		
Construct. Method :Rotary Air		
Owner Type :Private		
Commenced Date :	Final Depth : 22.90 m	
Completion Date :01-Jul-1980	Drilled Depth : 22.90 m	
Contractor Name :		
Driller :1404	McKECHNIE, Malcolm Trevor	
Property : - COPNOR	Standing Water Level :	
GWMA : -	Salinity :	Fresh
GW Zone : -	Yield :	

Site Details

Site Chosen By	County Form A :SANDON Licensed :SANDON	Parish TILBUSTER TILBUSTER	Portion/Lot DP 144 144
Region :30 - NORTH COAST		CMA Map :9237-3N	BLACK MOUNTAIN
River Basin :206 - MACLEAY RIVER		Grid Zone :56/1	Scale :1:25,000
Area / District :			
Elevation :		Northing :6643930	Latitude (S) :30° 19' 47"
Elevation Source :(Unknown)		Easting :374500	Longitude (E) :151° 41' 40"
GS Map :0029C2	AMG Zone :56	Coordinate Source :GD.,ACC.MAP	

Construction

Negative depths indicate Above Ground Level;H-Hole;P-Pipe;OD-Outside Diameter;ID-Inside Diameter;C-Cemented;SL-Slot Length;A-Aperture;GS-Grain Size;Q-Quantity

H	P	Component	Type	From (m)	To (m)	OD (mm)	ID (mm)	Interval	Details
1	1	Casing	Welded Steel	-0.30	22.90	165			Seated on Bottom
1	1	Opening	Slots - Vertical	12.80	14.30	165		1	Oxy-Acetylene Slotted; SL: 0mm; A: 2mm

Water Bearing Zones

From (m)	To (m)	Thickness (m)	WBZ Type	S.W.L. (m)	D.D.L. (m)	Yield (L/s)	Hole Depth (m)	Duration (hr)	Salinity (mg/L)
13.70	14.30	0.60	Fractured	10.70		0.85			Fresh

Drillers Log

From (m)	To (m)	Thickness(m)	Drillers Description	Geological Material	Comments
0.00	1.20	1.20	Topsoil	Topsoil	
1.20	3.00	1.80	Clay	Clay	
3.00	8.50	5.50	Limestone	Limestone	
8.50	13.70	5.20	Basalt	Basalt	
13.70	21.60	7.90	Basalt Broken Water Supply	Basalt	
21.60	22.90	1.30	Clay	Clay	

Remarks

*** End of GW054250 ***

DEPARTMENT OF INFRASTRUCTURE, PLANNING AND NATURAL RESOURCES

Work Summary

GW054811

Converted From HYDSYS

License :30BL117933	Authorised Purpose(s) DOMESTIC STOCK	Intended Purpose(s) NOT KNOWN
Work Type :Excavation		
Work Status :Supply Obtained		
Construct. Method :(Unknown)		
Owner Type :Private		
Commenced Date :	Final Depth : 7.00 m	
Completion Date :	Drilled Depth : 0.00	
Contractor Name :		
Driller :		
Property : - KURRAJONG	Standing Water Level :	
GWMA : -	Salinity :	(Unknown)
GW Zone : -	Yield :	

Site Details

Site Chosen By	County Form A :SANDON Licensed :SANDON	Parish DUMARESQ DUMARESQ	Portion/Lot DP 135 LT 2 DP 584290
Region :30 - NORTH COAST		CMA Map :9237-3S	DUMARESQ
River Basin :206 - MACLEAY RIVER		Grid Zone :56/1	Scale :1:25,000
Area / District :			
Elevation :		Northing :6634065	Latitude (S) :30° 25' 3"
Elevation Source :(Unknown)		Easting :362920	Longitude (E) :151° 34' 22"
GS Map :0029C2	AMG Zone :56	Coordinate Source :GD.,ACC.MAP	

Construction Negative depths indicate Above Ground Level;H-Hole;P-Pipe;OD-Outside Diameter;ID-Inside Diameter;C-Cemented;SL-Slot Length;A-Aperture;GS-Grain Size;Q-Quantity

H P Component Type	From (m)	To (m)	OD (mm)	ID (mm)	Interval	Details
<i>(No Construction Details Found)</i>						

Water Bearing Zones

From (m)	To (m)	Thickness (m)	WBZ Type	S.W.L. (m)	D.D.L. (m)	Yield (L/s)	Hole Depth (m)	Duration (hr)	Salinity (mg/L)
3.00	6.00	3.00	Fractured	3.00					(Unknown)

Drillers Log

From (m)	To (m)	Thickness(m)	Drillers Description	Geological Material	Comments
----------	--------	--------------	----------------------	---------------------	----------

Remarks

*** End of GW054811 ***

DEPARTMENT OF INFRASTRUCTURE, PLANNING AND NATURAL RESOURCES

Work Summary

GW060913

Converted From HYDSYS

License :90BL132378	Authorised Purpose(s) DOMESTIC STOCK	Intended Purpose(s) DOMESTIC STOCK
Work Type :Bore open thru rock		
Work Status :(Unknown)		
Construct. Method :Rotary Air		
Owner Type :Private		
Commenced Date :	Final Depth : 30.50 m	
Completion Date :01-Mar-1985	Drilled Depth : 30.50 m	
Contractor Name :		
Driller :1530 JONES, Clive Francis		
Property :	Standing Water Level :	
GWMA : -	Salinity :	(Unknown)
GW Zone : -	Yield :	

Site Details

Site Chosen By	County Form A :SANDON Licensed :SANDON	Parish EXMOUTH EXMOUTH	Portion/Lot DP 150 PT150
Region :90 - BARWON		CMA Map :9237-3N	BLACK MOUNTAIN
River Basin :418 - GWYDIR RIVER		Grid Zone :56/1	Scale :1:25,000
Area / District :			
Elevation :		Northing :6643970	Latitude (S) :30° 19' 44"
Elevation Source :(Unknown)		Easting :367720	Longitude (E) :151° 37' 26"
GS Map :0029C2	AMG Zone :56	Coordinate Source :GD.,ACC.MAP	

Construction

Negative depths indicate Above Ground Level;H-Hole;P-Pipe;OD-Outside Diameter;ID-Inside Diameter;C-Cemented;SL-Slot Length;A-Aperture;GS-Grain Size;Q-Quantity

H	P	Component	Type	From (m)	To (m)	OD (mm)	ID (mm)	Interval	Details
1	1	Casing	Welded Steel	-0.30	14.20	165			Driven into Hole

Water Bearing Zones

From (m)	To (m)	Thickness (m)	WBZ Type	S.W.L. (m)	D.D.L. (m)	Yield (L/s)	Hole Depth (m)	Duration (hr)	Salinity (mg/L)
15.20	16.80	1.60	Fractured	7.60		0.12			(Unknown)
24.70	25.00	0.30	Fractured	3.30		0.12			(Unknown)

Drillers Log

From (m)	To (m)	Thickness(m)	Drillers Description	Geological Material	Comments
0.00	0.30	0.30	Topsoil		
0.30	14.20	13.90	Clay Red	Clay	
14.20	30.50	16.30	Basalt Water Supply	Basalt	

Remarks

*** End of GW060913 ***

*** End of Report ***



Department of Infrastructure, Planning and Natural Resources

Groundwater Locations



Area: Annaleeey
Client: Mausell Australia
PO Box: Q410
QVB Post Office
NSW 1230
Contact: Michael Borman
Date of Search: 30-10-03
By: Richard Myers
Job Ref: BAGDS0093



LEGEND	
	Groundwater Works Number
	Cadastral Boundaries
	Area of Interest

Data depicted here is the most up to date held by DJPIR in their Groundwater Database, at the time of printing.

Disclaimer

The State of New South Wales and the Department of Infrastructure, Planning and Natural Resources and its employees, officers, agents or servants are not responsible for the result of any actions taken on the basis of the information contained on this map or for any errors, omissions or inaccuracies contained in this map. The State of New South Wales and its employees, officers, agents or servants expressly disclaim all and any liability and responsibility to any person in respect of anything and of the consequences, of anything done or omitted to be done by any such person in reliance, whether wholly or partially upon the information contained on the map.

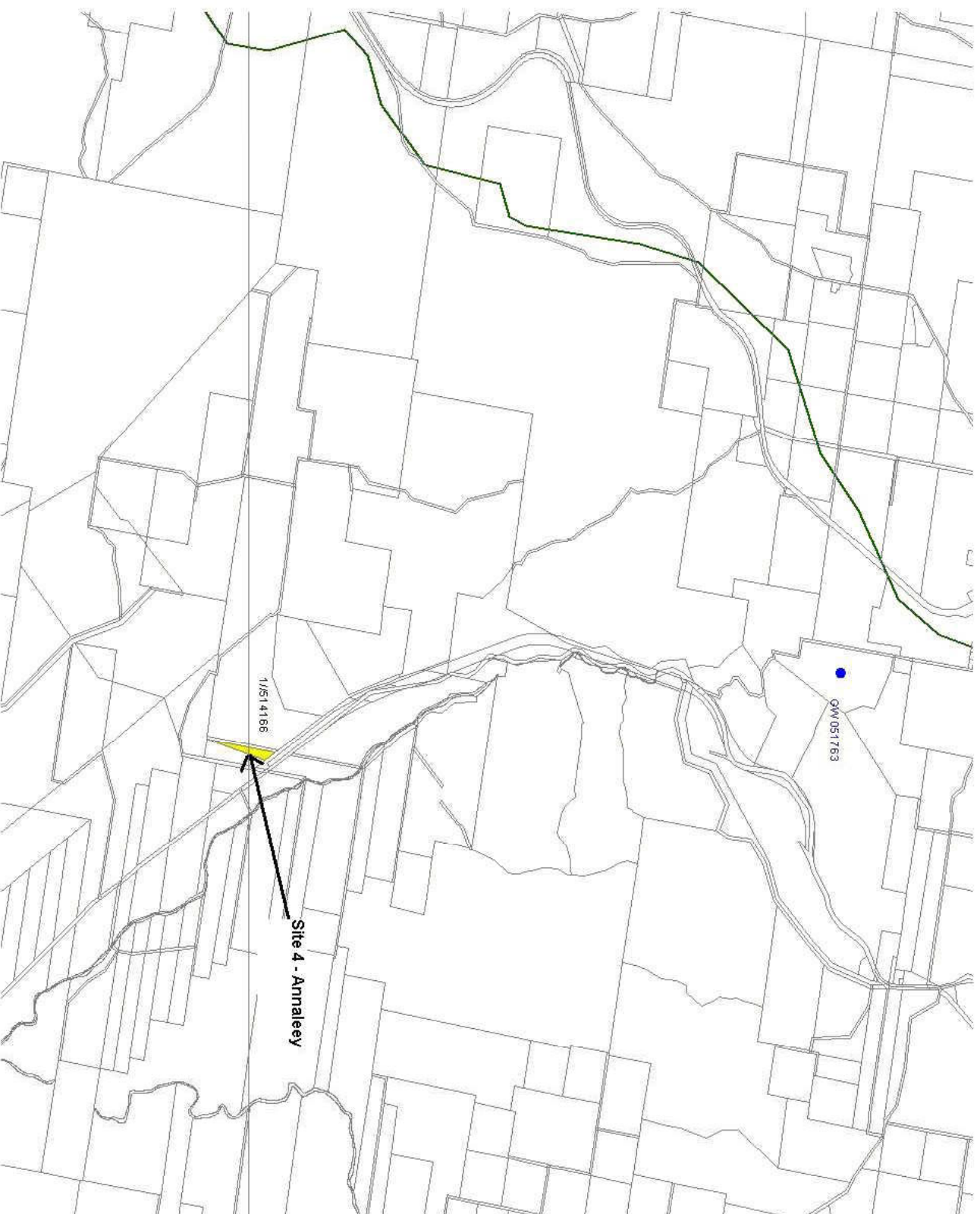

Date/Time :30-Oct-2003 02:31 PM
 User :GUEST
 Report :RMGW001D.QRP
 Executable :S:\G5\PROD32\Ground.exe
 Exe Date :29-Nov-2002
 System :Groundwater
 Database :Dlwcp



**Infrastructure, Planning
 and Natural Resources**

DEPARTMENT OF INFRASTRUCTURE, PLANNING AND NATURAL RESOURCES

Work Summary

GW051763

Converted From HYDSYS

License :90BL113703

Work Type :Bore
 Work Status :(Unknown)
 Construct. Method :Cable Tool
 Owner Type :Private

Authorised Purpose(s)
 DOMESTIC
 STOCK

Intended Purpose(s)
 DOMESTIC
 STOCK

Commenced Date : Final Depth : 42.60 m
 Completion Date :01-Oct-1980 Drilled Depth : 42.60 m

Contractor Name :
 Driller :

Property : - MILLBROOK
 GWMA : -
 GW Zone : -

Standing Water Level :
 Salinity : Good
 Yield :

Site Details

Site Chosen By

County
 Form A :SANDON
 Licensed :SANDON

Parish
 EXMOUTH
 EXMOUTH

Portion/Lot DP
 208
 208

Region :90 - BARWON
 River Basin :206 - MACLEAY RIVER
 Area / District :

CMA Map :9237-3N
 Grid Zone :56/1

BLACK MOUNTAIN
 Scale :1:25,000

Elevation :
 Elevation Source :(Unknown)

Northing :6644610
 Easting :371300

Latitude (S) :30° 19' 24"
 Longitude (E) :151° 39' 41"

GS Map :0029C2

AMG Zone :56

Coordinate Source :GD.,ACC.MAP

Construction

Negative depths indicate Above Ground Level;H-Hole;P-Pipe;OD-Outside Diameter;ID-Inside Diameter;C-Cemented;SL-Slot Length;A-Aperture;GS-Grain Size;Q-Quantity

H	P	Component	Type	From (m)	To (m)	OD (mm)	ID (mm)	Interval	Details
1	1	Casing	P.V.C.	0.00	42.60	133			Seated on Bottom
1	1	Opening	Slots - Vertical	18.30	42.60	133		1	Mechanically Slotted; SL: 0mm; A: 2.4mm

Water Bearing Zones

From (m)	To (m)	Thickness (m)	WBZ Type	S.W.L. (m)	D.D.L. (m)	Yield (L/s)	Hole Depth (m)	Duration (hr)	Salinity (mg/L)
35.80	42.60	6.80	(Unknown)	35.80		1.00			Good

Drillers Log

From (m)	To (m)	Thickness(m)	Drillers Description	Geological Material	Comments
0.00	12.50	12.50	Clay Dry	Clay	
12.50	14.30	1.80	Clay Moist	Basalt	
14.30	20.50	6.20	Basalt Hard	Shale	
20.50	26.70	6.20	Shale Black	Basalt	
26.70	40.10	13.40	Basalt Soft Water Supply	Gravel	
40.10	42.60	2.50	Gravel Water Supply		

Remarks

*** End of GW051763 ***

*** End of Report ***

Department of Infrastructure, Planning and Natural Resources

Groundwater Locations



Area: East Mhri
Client: Mausell Australia
 PO Box Q4/10
 QVB Post Office
 NSW 1230
Contact: Michael Borman
Date of Search: 30-10-03
By: Richard Myers
Job Ref: BAGDS0093



LEGEND

- Groundwater Works Number
- Cadastral Boundaries
- Area of Interest

Data depicted here is the most up to date held by DIPNR in their Groundwater Database, at the time of printing.

Disclaimer

The State of New South Wales and the Department of Infrastructure, Planning and Natural Resources and its employees, officers, agents or servants are not responsible for the result of any actions taken on the basis of the information contained on this map or for any errors, omissions or inaccuracies contained in this map. The State of New South Wales and its employees, officers, agents or servants expressly disclaim all and any liability and responsibility to any person in respect of anything and of the consequences, of anything done or omitted to be done by any such person in reliance, whether wholly or partially upon the information contained on the map.

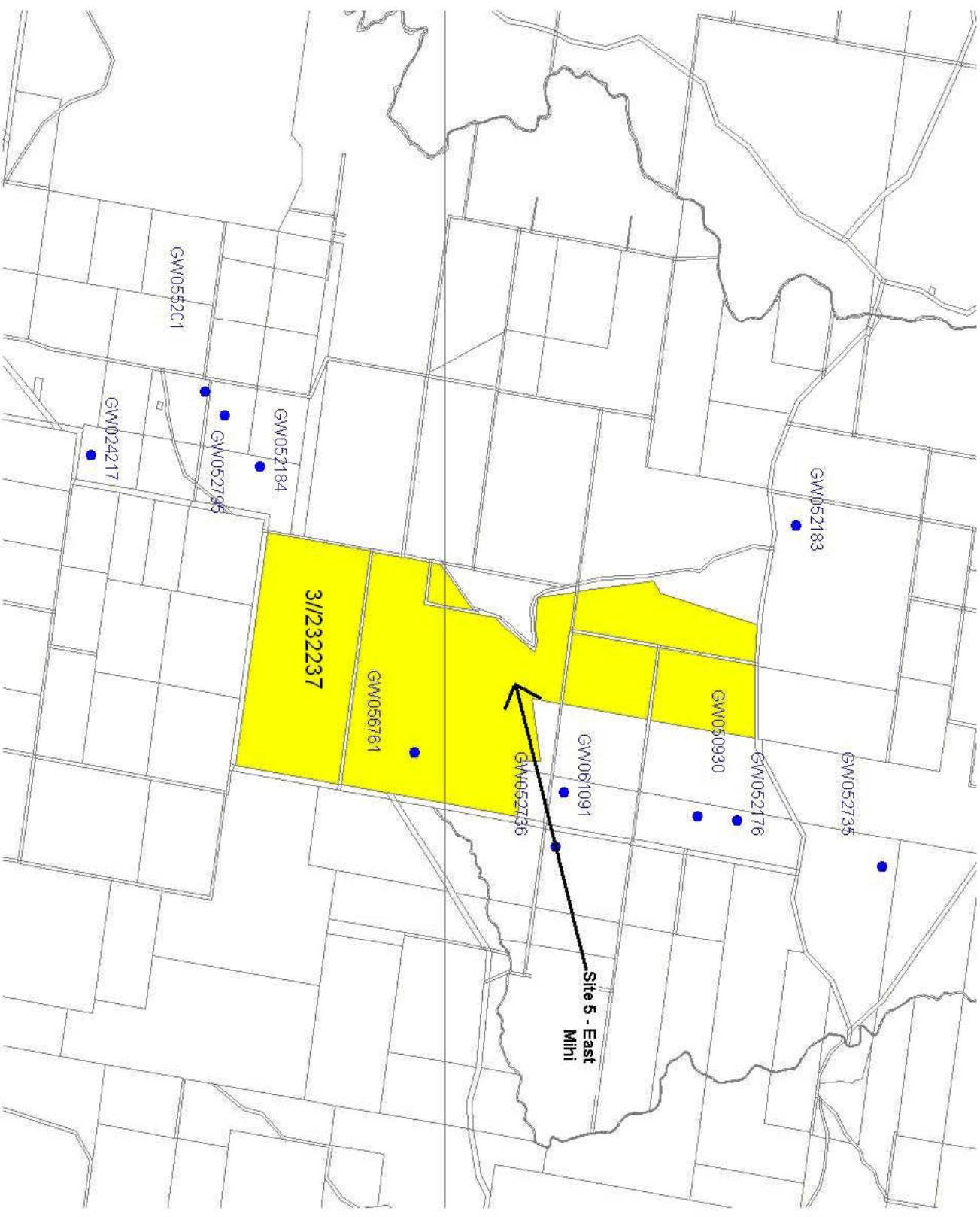

Date/Time :30-Oct-2003 04:14 PM
 User :GUEST
 Report :RMGW001D.QRP
 Executable :S:\G5\PROD32\Ground.exe
 Exe Date :29-Nov-2002
 System :Groundwater
 Database :Dlwcp



DEPARTMENT OF INFRASTRUCTURE, PLANNING AND NATURAL RESOURCES

Work Summary

GW024217

Converted From HYDSYS

License :30BL018832		
Work Type :Bore	Authorised Purpose(s) STOCK	Intended Purpose(s) STOCK
Work Status :(Unknown)		
Construct. Method :(Unknown)		
Owner Type :Private		
Commenced Date :	Final Depth : 21.60 m	
Completion Date :01-Jan-1966	Drilled Depth : 21.60 m	
Contractor Name :		
Driller :		
Property : - WYANGA	Standing Water Level :	
GWMA : -	Salinity :	Good
GW Zone : -	Yield :	

Site Details

Site Chosen By	County Form A :SANDON Licensed :SANDON	Parish LAWRENCE LAWRENCE	Portion/Lot DP 163 LT DP 755832
Region :30 - NORTH COAST		CMA Map :9236-3N	SALISBURY PLAINS
River Basin :206 - MACLEAY RIVER		Grid Zone :56/1	Scale :1:25,000
Area / District :			
Elevation :		Northing :6594580	Latitude (S) :30° 46' 30"
Elevation Source :(Unknown)		Eastings :373750	Longitude (E) :151° 40' 50"
GS Map :0029C4	AMG Zone :56	Coordinate Source :GD.,ACC.MAP	

Construction

Negative depths indicate Above Ground Level;H-Hole;P-Pipe;OD-Outside Diameter;ID-Inside Diameter;C-Cemented;SL-Slot Length;A-Aperture;GS-Grain Size;Q-Quantity

H	P	Component	Type	From (m)	To (m)	OD (mm)	ID (mm)	Interval	Details
1	1	Casing	Threaded Steel	0.00	12.50	127			(Unknown)

Water Bearing Zones

From (m)	To (m)	Thickness (m)	WBZ Type	S.W.L. (m)	D.D.L. (m)	Yield (L/s)	Hole Depth (m)	Duration (hr)	Salinity (mg/L)
7.60	21.60	14.00	(Unknown)	6.70		0.63			Good

Drillers Log

From (m)	To (m)	Thickness(m)	Drillers Description	Geological Material	Comments
0.00	3.05	3.05	Soil		
3.05	6.71	3.66	Clay Sandy	Clay	
6.71	21.64	14.93	Rock Sandy Water Supply	Rock	

Remarks

*** End of GW024217 ***

DEPARTMENT OF INFRASTRUCTURE, PLANNING AND NATURAL RESOURCES

Work Summary

GW050930

Converted From HYDSYS

License :30BL115267	Authorised Purpose(s) STOCK	Intended Purpose(s) STOCK
Work Type :Bore		
Work Status :(Unknown)		
Construct. Method :Rotary Air		
Owner Type :Private		
Commenced Date :	Final Depth : 30.50 m	
Completion Date :01-Jun-1980	Drilled Depth : 30.50 m	
Contractor Name :		
Driller :		
Property :	Standing Water Level :	
GWMA : -	Salinity :	Fresh
GW Zone : -	Yield :	

Site Details

Site Chosen By	County Form A :SANDON Licensed :SANDON	Parish LAWRENCE LAWRENCE	Portion/Lot DP 98 98
Region :30 - NORTH COAST		CMA Map :9236-4S	GOSTWYCK
River Basin :206 - MACLEAY RIVER		Grid Zone :56/1	Scale :1:25,000
Area / District :			
Elevation :		Northing :6599350	Latitude (S) :30° 43' 56"
Elevation Source :(Unknown)		Easting :376125	Longitude (E) :151° 42' 22"
GS Map :0029C3	AMG Zone :56	Coordinate Source :GD.,ACC.MAP	

Construction

Negative depths indicate Above Ground Level;H-Hole;P-Pipe;OD-Outside Diameter;ID-Inside Diameter;C-Cemented;SL-Slot Length;A-Aperture;GS-Grain Size;Q-Quantity

H	P	Component	Type	From (m)	To (m)	OD (mm)	ID (mm)	Interval	Details
1	1	Casing	Welded Steel	-0.30	20.40	165			Driven into Hole
1	1	Opening	Slots	18.90	20.40	165		1	SL: 0mm; A: 0mm

Water Bearing Zones

From (m)	To (m)	Thickness (m)	WBZ Type	S.W.L. (m)	D.D.L. (m)	Yield (L/s)	Hole Depth (m)	Duration (hr)	Salinity (mg/L)
19.80	20.40	0.60	Fractured	15.20		0.88			Fresh

Drillers Log

From (m)	To (m)	Thickness(m)	Drillers Description	Geological Material	Comments
0.00	0.61	0.61	Topsoil		
0.61	2.44	1.83	Clay	Clay	
2.44	7.62	5.18	Slate Broken	Slate	
7.62	19.81	12.19	Slate Hard	Slate	
19.81	20.42	0.61	Slate Broken Water Supply	Slate	
20.42	30.48	10.06	Slate Hard	Slate	

Remarks

*** End of GW050930 ***

DEPARTMENT OF INFRASTRUCTURE, PLANNING AND NATURAL RESOURCES

Work Summary

GW052176

Converted From HYDSYS

License :30BL114525	Authorised Purpose(s) STOCK	Intended Purpose(s)
Work Type :Bore		
Work Status :(Unknown)		
Construct. Method :Rotary Air		
Owner Type :Private		
Commenced Date :	Final Depth :	30.40 m
Completion Date :01-Jun-1980	Drilled Depth :	30.40 m
Contractor Name :		
Driller :		
Property : - LINFIELD	Standing Water Level :	
GWMA : -	Salinity :	Fresh
GW Zone : -	Yield :	

Site Details

Site Chosen By	County Form A :SANDON Licensed :SANDON	Parish LAWRENCE LAWRENCE	Portion/Lot DP 98 36
Region :30 - NORTH COAST		CMA Map :9236-4S	GOSTWYCK
River Basin :206 - MACLEAY RIVER		Grid Zone :56/1	Scale :1:25,000
Area / District :			
Elevation :		Northing :6599670	Latitude (S) :30° 43' 46"
Elevation Source :(Unknown)		Easting :376160	Longitude (E) :151° 42' 23"
GS Map :0029C3	AMG Zone :56	Coordinate Source :GD.,ACC.MAP	

Construction

Negative depths indicate Above Ground Level;H-Hole;P-Pipe;OD-Outside Diameter;ID-Inside Diameter;C-Cemented;SL-Slot Length;A-Aperture;GS-Grain Size;Q-Quantity

H	P	Component	Type	From (m)	To (m)	OD (mm)	ID (mm)	Interval	Details
1	1	Casing	Welded Steel	-0.30	20.70	165			Seated
1	1	Opening	Slots - Vertical	19.00	20.40	165		1	SL: 0mm; A: 4mm

Water Bearing Zones

From (m)	To (m)	Thickness (m)	WBZ Type	S.W.L. (m)	D.D.L. (m)	Yield (L/s)	Hole Depth (m)	Duration (hr)	Salinity (mg/L)
19.80	20.40	0.60	Fractured	15.20		0.90			Fresh

Drillers Log

From (m)	To (m)	Thickness(m)	Drillers Description	Geological Material	Comments
0.00	0.60	0.60	Topsoil		
0.60	2.40	1.80	Clay	Clay	
2.40	7.60	5.20	Slate Broken	Slate	
7.60	19.80	12.20	Slate Hard	Slate	
19.80	20.40	0.60	Slate Broken Water Supply	Slate	
20.40	30.40	10.00	Slate Hard	Slate	

Remarks

*** End of GW052176 ***

DEPARTMENT OF INFRASTRUCTURE, PLANNING AND NATURAL RESOURCES

Work Summary

GW052183

Converted From HYDSYS

License :30BL114630	Authorised Purpose(s) STOCK	Intended Purpose(s) STOCK
Work Type :Bore open thru rock		
Work Status :(Unknown)		
Construct. Method :Rotary		
Owner Type :Private		
Commenced Date :	Final Depth : 44.20 m	
Completion Date :01-Jun-1980	Drilled Depth : 44.20 m	
Contractor Name :		
Driller :		
Property : - LINFIELD	Standing Water Level :	
GWMA : -	Salinity :	Fresh
GW Zone : -	Yield :	

Site Details

Site Chosen By	County Form A :SANDON Licensed :SANDON	Parish LAWRENCE LAWRENCE	Portion/Lot DP 22 22
Region :30 - NORTH COAST		CMA Map :9236-4S	GOSTWYCK
River Basin :206 - MACLEAY RIVER		Grid Zone :56/1	Scale :1:25,000
Area / District :			
Elevation :		Northing :6600103	Latitude (S) :30° 43' 31"
Elevation Source :(Unknown)		Easting :374145	Longitude (E) :151° 41' 8"
GS Map :0029C3	AMG Zone :56	Coordinate Source :GD.,ACC.MAP	

Construction

Negative depths indicate Above Ground Level;H-Hole;P-Pipe;OD-Outside Diameter;ID-Inside Diameter;C-Cemented;SL-Slot Length;A-Aperture;GS-Grain Size;Q-Quantity

H	P	Component	Type	From (m)	To (m)	OD (mm)	ID (mm)	Interval	Details
1	1	Casing	Welded Steel	-0.30	28.00	165			Seated

Water Bearing Zones

From (m)	To (m)	Thickness (m)	WBZ Type	S.W.L. (m)	D.D.L. (m)	Yield (L/s)	Hole Depth (m)	Duration (hr)	Salinity (mg/L)
38.40	44.50	6.10	Fractured	10.00		0.90			Fresh

Drillers Log

From (m)	To (m)	Thickness(m)	Drillers Description	Geological Material	Comments
0.00	1.00	1.00	Topsoil		
1.00	3.00	2.00	Clay	Clay	
3.00	9.10	6.10	Limestone	Limestone	
9.10	27.40	18.30	Slate	Slate	
27.40	44.20	16.80	Slate Hard Water Supply	Slate	

Remarks

*** End of GW052183 ***

DEPARTMENT OF INFRASTRUCTURE, PLANNING AND NATURAL RESOURCES

Work Summary

GW052184

Converted From HYDSYS

License :30BL114631	Authorised Purpose(s) STOCK	Intended Purpose(s)
Work Type :Bore		
Work Status :(Unknown)		
Construct. Method :Rotary Air		
Owner Type :Private		
Commenced Date :	Final Depth : 0.00	
Completion Date :01-Jun-1980	Drilled Depth : 45.70 m	
Contractor Name :		
Driller :		
Property : - LINFIELD	Standing Water Level :	
GWMA : -	Salinity :	(Unknown)
GW Zone : -	Yield :	

Site Details

Site Chosen By	County Form A :SANDON Licensed :SANDON	Parish LAWRENCE LAWRENCE	Portion/Lot DP 159 159
Region :30 - NORTH COAST		CMA Map :9236-3N	SALISBURY PLAINS
River Basin :206 - MACLEAY RIVER		Grid Zone :56/1	Scale :1:25,000
Area / District :			
Elevation :		Northing :6595910	Latitude (S) :30° 45' 47"
Elevation Source :(Unknown)		Easting :373800	Longitude (E) :151° 40' 53"
GS Map :0029C4	AMG Zone :56	Coordinate Source :GD.,ACC.MAP	

Construction

Negative depths indicate Above Ground Level;H-Hole;P-Pipe;OD-Outside Diameter;ID-Inside Diameter;C-Cemented;SL-Slot Length;A-Aperture;GS-Grain Size;Q-Quantity

H	P	Component	Type	From (m)	To (m)	OD (mm)	ID (mm)	Interval	Details
1		Backfill	Backfill	0.00	45.70	153			

Water Bearing Zones

From (m)	To (m)	Thickness (m)	WBZ Type	S.W.L. (m)	D.D.L. (m)	Yield (L/s)	Hole Depth (m)	Duration (hr)	Salinity (mg/L)
----------	--------	---------------	----------	------------	------------	-------------	----------------	---------------	-----------------

(No Water Bearing Zone Details Found)

Drillers Log

From (m)	To (m)	Thickness(m)	Drillers Description	Geological Material	Comments
0.00	1.00	1.00	Topsoil	Topsoil	
1.00	2.00	1.00	Clay	Clay	
2.00	8.50	6.50	Limestone	Limestone	
8.50	11.50	3.00	Basalt	Basalt	
11.50	37.80	26.30	Limestone	Limestone	
37.80	45.70	7.90	Basalt	Basalt	

Remarks

*** End of GW052184 ***

DEPARTMENT OF INFRASTRUCTURE, PLANNING AND NATURAL RESOURCES

Work Summary

GW052735

Converted From HYDSYS

<p>License :30BL118853</p> <p>Work Type :Bore Work Status :(Unknown) Construct. Method :Rotary Air Owner Type :Private</p> <p>Commenced Date : Completion Date :01-Mar-1981</p> <p>Contractor Name : Driller :</p> <p>Property : - THE RANGE GWMA : - GW Zone : -</p>	<p>Authorised Purpose(s) DOMESTIC STOCK</p> <p>Final Depth : 30.50 m Drilled Depth : 30.50 m</p> <p>Standing Water Level : Salinity : Yield :</p>	<p>Intended Purpose(s)</p> <p style="text-align: center;">Fresh</p>
--	--	---

Site Details

Site Chosen By	County Form A :SANDON Licensed :SANDON	Parish LAWRENCE LAWRENCE	Portion/Lot DP 113 113
Region :30 - NORTH COAST River Basin :206 - MACLEAY RIVER Area / District :		CMA Map :9236-4S Grid Zone :56/1	GOSTWYCK Scale :1:25,000
Elevation : Elevation Source :(Unknown)		Northing :6600800 Easting :376460	Latitude (S) :30° 43' 9" Longitude (E) :151° 42' 35"
GS Map :0029C3 AMG Zone :56		Coordinate Source :GD.,ACC.MAP	

Construction

Negative depths indicate Above Ground Level;H-Hole;P-Pipe;OD-Outside Diameter;ID-Inside Diameter;C-Cemented;SL-Slot Length;A-Aperture;GS-Grain Size;Q-Quantity

H	P	Component	Type	From (m)	To (m)	OD (mm)	ID (mm)	Interval	Details
1	1	Casing	Welded Steel	-0.10	17.30	165			Seated

Water Bearing Zones

From (m)	To (m)	Thickness (m)	WBZ Type	S.W.L. (m)	D.D.L. (m)	Yield (L/s)	Hole Depth (m)	Duration (hr)	Salinity (mg/L)
20.40	20.70	0.30	Fractured	18.30		0.25			Fresh
26.80	27.40	0.60	Fractured	13.40		2.78			Fresh

Drillers Log

From (m)	To (m)	Thickness(m)	Drillers Description	Geological Material	Comments
0.00	0.30	0.30	Topsoil		
0.30	16.46	16.16	Shale	Shale	
16.46	30.48	14.02	Basalt Water Supply	Basalt	

Remarks

*** End of GW052735 ***

DEPARTMENT OF INFRASTRUCTURE, PLANNING AND NATURAL RESOURCES

Work Summary

GW052736

Converted From HYDSYS

<p>License :30BL118854</p> <p>Work Type :Bore Work Status :(Unknown) Construct. Method :Rotary Air Owner Type :Private</p> <p>Commenced Date : Completion Date :01-Mar-1981</p> <p>Contractor Name : Driller :</p> <p>Property : - THE RANGE GWMA : - GW Zone : -</p>	<p>Authorised Purpose(s) DOMESTIC STOCK</p> <p>Final Depth : 38.10 m Drilled Depth : 38.10 m</p> <p>Standing Water Level : Salinity : Yield :</p>	<p>Intended Purpose(s)</p> <p style="text-align: center;">Fresh</p>
--	--	---

Site Details

Site Chosen By	County Form A :SANDON Licensed :SANDON	Parish LAWRENCE LAWRENCE	Portion/Lot DP 37 37
Region :30 - NORTH COAST River Basin :206 - MACLEAY RIVER Area / District :	CMA Map :9236-4S Grid Zone :56/1	GOSTWYCK Scale :1:25,000	
Elevation : Elevation Source :(Unknown)	Northing :6598230 Easting :376360	Latitude (S) :30° 44' 32" Longitude (E) :151° 42' 30"	
GS Map :0029C3 AMG Zone :56	Coordinate Source :GD.,ACC.MAP		

Construction

Negative depths indicate Above Ground Level;H-Hole;P-Pipe;OD-Outside Diameter;ID-Inside Diameter;C-Cemented;SL-Slot Length;A-Aperture;GS-Grain Size;Q-Quantity

H	P	Component	Type	From (m)	To (m)	OD (mm)	ID (mm)	Interval	Details
1	1	Casing	Threaded Steel	-0.60	18.30	152			(Unknown)
1	1	Opening	Slots	16.80	18.30	152		1	SL: 0mm; A: 0mm

Water Bearing Zones

From (m)	To (m)	Thickness (m)	WBZ Type	S.W.L. (m)	D.D.L. (m)	Yield (L/s)	Hole Depth (m)	Duration (hr)	Salinity (mg/L)
17.70	18.30	0.60	Fractured	17.70		0.13			Fresh
20.40	21.30	0.90	Fractured	17.70		0.33			Fresh
33.50	34.40	0.90	Fractured	16.80		1.82			Fresh

Drillers Log

From (m)	To (m)	Thickness(m)	Drillers Description	Geological Material	Comments
0.00	0.30	0.30	Topsoil Soft	Clay	
0.30	1.22	0.92	Clay Soft	Shale	
1.22	18.29	17.07	Shale Soft Water Supply	Shale	
18.29	23.77	5.48	Shale Hard Water Supply	Basalt	
23.77	38.10	14.33	Basalt Hard Water Supply		

Remarks

*** End of GW052736 ***

DEPARTMENT OF INFRASTRUCTURE, PLANNING AND NATURAL RESOURCES

Work Summary

GW052795

Converted From HYDSYS

License :30BL120481	Authorised Purpose(s) STOCK	Intended Purpose(s)
Work Type :Bore open thru rock		
Work Status :(Unknown)		
Construct. Method :Rotary Air		
Owner Type :Private		
Commenced Date :	Final Depth : 45.70 m	
Completion Date :01-May-1981	Drilled Depth : 45.70 m	
Contractor Name :		
Driller :		
Property : - LINFIELD	Standing Water Level :	
GWMA : -	Salinity :	Fresh
GW Zone : -	Yield :	

Site Details

Site Chosen By	County Form A :SANDON Licensed :SANDON	Parish LAWRENCE LAWRENCE	Portion/Lot DP 161 161
Region :30 - NORTH COAST		CMA Map :9236-3N	SALISBURY PLAINS
River Basin :206 - MACLEAY RIVER		Grid Zone :56/1	Scale :1:25,000
Area / District :			
Elevation :		Northing :6595625	Latitude (S) :30° 45' 56"
Elevation Source :(Unknown)		Easting :373460	Longitude (E) :151° 40' 40"
GS Map :0029C4	AMG Zone :56	Coordinate Source :GD.,ACC.MAP	

Construction

Negative depths indicate Above Ground Level;H-Hole;P-Pipe;OD-Outside Diameter;ID-Inside Diameter;C-Cemented;SL-Slot Length;A-Aperture;GS-Grain Size;Q-Quantity

H	P	Component	Type	From (m)	To (m)	OD (mm)	ID (mm)	Interval	Details
1	1	Casing	Welded Steel	-0.50	4.50	166			Seated

Water Bearing Zones

From (m)	To (m)	Thickness (m)	WBZ Type	S.W.L. (m)	D.D.L. (m)	Yield (L/s)	Hole Depth (m)	Duration (hr)	Salinity (mg/L)
22.80	29.00	6.20	Fractured						(Unknown)
40.50	43.20	2.70	Fractured	20.00		1.26			Fresh
44.80	45.70	0.90	Fractured						(Unknown)

Drillers Log

From (m)	To (m)	Thickness(m)	Drillers Description	Geological Material	Comments
0.00	4.50	4.50	Topsoil Clay		
0.00	4.50	4.50	Rock Broken	Rock	
4.50	32.00	27.50	Basalt Hard Water Bearing	Basalt	
32.00	34.70	2.70	Basalt Broken	Basalt	
34.70	40.50	5.80	Basalt Hard	Basalt	
40.50	43.20	2.70	Basalt Broken Water Supply	Basalt	
40.50	43.20	2.70	Rock White Soft	Rock	
43.20	44.80	1.60	Basalt Hard Water Bearing	Basalt	
44.80	45.70	0.90	Basalt Broken	Basalt	

Remarks

*** End of GW052795 ***

DEPARTMENT OF INFRASTRUCTURE, PLANNING AND NATURAL RESOURCES

Work Summary

GW055201

Converted From HYDSYS

License :30BL119588	Authorised Purpose(s) STOCK	Intended Purpose(s)
Work Type :Bore		
Work Status :(Unknown)		
Construct. Method :Rotary Air		
Owner Type :Private		
Commenced Date :	Final Depth : 0.00	
Completion Date :01-Apr-1981	Drilled Depth : 54.80 m	
Contractor Name :		
Driller :		
Property : - LINFIELD	Standing Water Level :	
GWMA : -	Salinity :	(Unknown)
GW Zone : -	Yield :	

Site Details

Site Chosen By	County Form A :SANDON Licensed :SANDON	Parish LAWRENCE LAWRENCE	Portion/Lot DP 51 161
Region :30 - NORTH COAST		CMA Map :9236-3N	SALISBURY PLAINS
River Basin :206 - MACLEAY RIVER		Grid Zone :56/1	Scale :1:25,000
Area / District :			
Elevation :		Northing :6595475	Latitude (S) :30° 46' 1"
Elevation Source :(Unknown)		Easting :373295	Longitude (E) :151° 40' 34"
GS Map :0029C4	AMG Zone :56	Coordinate Source :GD.,ACC.MAP	

Construction

Negative depths indicate Above Ground Level;H-Hole;P-Pipe;OD-Outside Diameter;ID-Inside Diameter;C-Cemented;SL-Slot Length;A-Aperture;GS-Grain Size;Q-Quantity

H	P	Component	Type	From (m)	To (m)	OD (mm)	ID (mm)	Interval	Details
1		Backfill	Backfill	0.00	54.80	0			

Water Bearing Zones

From (m)	To (m)	Thickness (m)	WBZ Type	S.W.L. (m)	D.D.L. (m)	Yield (L/s)	Hole Depth (m)	Duration (hr)	Salinity (mg/L)
----------	--------	---------------	----------	------------	------------	-------------	----------------	---------------	-----------------

(No Water Bearing Zone Details Found)

Drillers Log

From (m)	To (m)	Thickness(m)	Drillers Description	Geological Material	Comments
0.00	6.40	6.40	Topsoil Clay	Basalt	
6.40	13.70	7.30	Basalt Hard	Basalt	
13.70	14.90	1.20	Rock Decomposed	Rock	
14.90	45.70	30.80	Basalt Hard	Basalt	
45.70	50.50	4.80	Rock Broken Soil	Rock	
50.50	54.80	4.30	Basalt Hard	Basalt	

Remarks

*** End of GW055201 ***

DEPARTMENT OF INFRASTRUCTURE, PLANNING AND NATURAL RESOURCES

Work Summary

GW056761

Converted From HYDSYS

License :30BL123662	Authorised Purpose(s)	Intended Purpose(s)
Work Type :Bore	DOMESTIC	
Work Status :(Unknown)	STOCK	
Construct. Method :Rotary Air		
Owner Type :Private		
Commenced Date :	Final Depth :	43.30 m
Completion Date :01-Nov-1982	Drilled Depth :	43.30 m
Contractor Name :		
Driller :		
Property : - RUTLAND	Standing Water Level :	
GWMA : -	Salinity :	Potable
GW Zone : -	Yield :	

Site Details

Site Chosen By	County	Parish	Portion/Lot DP
	Form A :SANDON	LAWRENCE	L3 DP232237 (43)
	Licensed :SANDON	LAWRENCE	LT 3 DP 232237
Region :30 - NORTH COAST		CMA Map : 9236-3N	SALISBURY PLAINS
River Basin :206 - MACLEAY RIVER		Grid Zone : 56/1	Scale :1:25,000
Area / District :			
Elevation :		Northing : 6597130	Latitude (S) : 30° 45' 8"
Elevation Source :(Unknown)		Easting : 375730	Longitude (E) : 151° 42' 6"
GS Map :0029C4	AMG Zone : 56	Coordinate Source : GD.,ACC.MAP	

Construction

Negative depths indicate Above Ground Level;H-Hole;P-Pipe;OD-Outside Diameter;ID-Inside Diameter;C-Cemented;SL-Slot Length;A-Aperture;GS-Grain Size;Q-Quantity

H	P	Component	Type	From (m)	To (m)	OD (mm)	ID (mm)	Interval	Details
1	1	Casing	P.V.C.	0.00	43.30	137			Seated on Bottom
1	1	Opening	Slots - Vertical	31.10	41.80	137		1	Mechanically Slotted; SL: 0mm; A: 4mm

Water Bearing Zones

From (m)	To (m)	Thickness (m)	WBZ Type	S.W.L. (m)	D.D.L. (m)	Yield (L/s)	Hole Depth (m)	Duration (hr)	Salinity (mg/L)
3.70	5.50	1.80	Unconsolidated						(Unknown)
12.80	14.60	1.80	Fractured						(Unknown)
29.00	29.30	0.30	Fractured						(Unknown)
35.10	36.00	0.90	Fractured						(Unknown)

Drillers Log

From (m)	To (m)	Thickness(m)	Drillers Description	Geological Material	Comments
0.00	0.60	0.60	Topsoil Clay		
0.60	3.65	3.05	Clay Yellow Wet	Clay	
3.65	5.48	1.83	Sand Gravel Water Bearing	Sand	
5.48	43.28	37.80	Granite Weathered Water Supply	Granite	

Remarks

*** End of GW056761 ***

DEPARTMENT OF INFRASTRUCTURE, PLANNING AND NATURAL RESOURCES

Work Summary

GW061091

Converted From HYDSYS

License :30BL133468	Authorised Purpose(s)	Intended Purpose(s)
Work Type :Bore	DOMESTIC	
Work Status :(Unknown)	STOCK	
Construct. Method :Rotary Air		
Owner Type :Private		
Commenced Date :	Final Depth :	40.00 m
Completion Date :01-Apr-1986	Drilled Depth :	40.00 m
Contractor Name :		
Driller :1493	LINTON, Alec	
Property :	Standing Water Level :	
GWMA : -	Salinity :	(Unknown)
GW Zone : -	Yield :	

Site Details

Site Chosen By	County	Parish	Portion/Lot DP
	Form A :SANDON	LAWRENCE	36
	Licensed :SANDON	LAWRENCE	36
Region : 30 - NORTH COAST		CMA Map : 9236-4S	GOSTWYCK
River Basin : 206 - MACLEAY RIVER		Grid Zone : 56/1	Scale : 1:25,000
Area / District :			
Elevation :		Northing : 6598300	Latitude (S) : 30° 44' 30"
Elevation Source :(Unknown)		Easting : 375980	Longitude (E) : 151° 42' 16"
GS Map : 0029C3	AMG Zone : 56	Coordinate Source : GD.,ACC.MAP	

Construction

Negative depths indicate Above Ground Level;H-Hole;P-Pipe;OD-Outside Diameter;ID-Inside Diameter;C-Cemented;SL-Slot Length;A-Aperture;GS-Grain Size;Q-Quantity

H	P	Component	Type	From (m)	To (m)	OD (mm)	ID (mm)	Interval	Details
1		Casing	Casing Protector	-0.50	1.00	170			Driven into Hole
1	1	Casing	P.V.C.	-0.50	40.00	135			Seated on Bottom
1	1	Opening	Slots - Horizontal	34.00	40.00	135		1	Mechanically Slotted; SL: 0mm; A: 4mm

Water Bearing Zones

From (m)	To (m)	Thickness (m)	WBZ Type	S.W.L. (m)	D.D.L. (m)	Yield (L/s)	Hole Depth (m)	Duration (hr)	Salinity (mg/L)
24.00	25.00	1.00	Fractured			0.00			(Unknown)
36.00	37.00	1.00	Fractured	24.00		1.00			(Unknown)

Drillers Log

From (m)	To (m)	Thickness(m)	Drillers Description	Geological Material	Comments
0.00	1.00	1.00	Soil Surface		
1.00	1.20	0.20	Clay Red	Clay	
1.20	20.00	18.80	Shale	Shale	
20.00	40.00	20.00	Shale Black Water Supply	Shale	

Remarks

*** End of GW061091 ***

*** End of Report ***

Department of Infrastructure, Planning and Natural Resources

Groundwater Locations





Department of Infrastructure, Planning
and Natural Resources

Area: Pinnaroo
Client: Mausell Australia
PO Box: Q410
QVB Post Office
NSW 1230
Contact: Michael Borman
Date of Search: 30-10-03
By: Richard Myers
Job Ref: BAGDS0093



1000 0 1000 2000 Metres

LEGEND	
	Groundwater Works Number
	Cadastral Boundaries
	Area of Interest

Data depicted here is the most up to date held by DJPIR in their Groundwater Database, at the time of printing.

Disclaimer

The State of New South Wales and the Department of Infrastructure, Planning and Natural Resources and its employees, officers, agents or servants are not responsible for the result of any actions taken on the basis of the information contained on this map or for any errors, omissions or inaccuracies contained in this map. The State of New South Wales and its employees, officers, agents or servants expressly disclaim all and any liability and responsibility to any person in respect of anything and of the consequences, of anything done or omitted to be done by any such person in reliance, whether wholly or partially upon the information contained on the map.

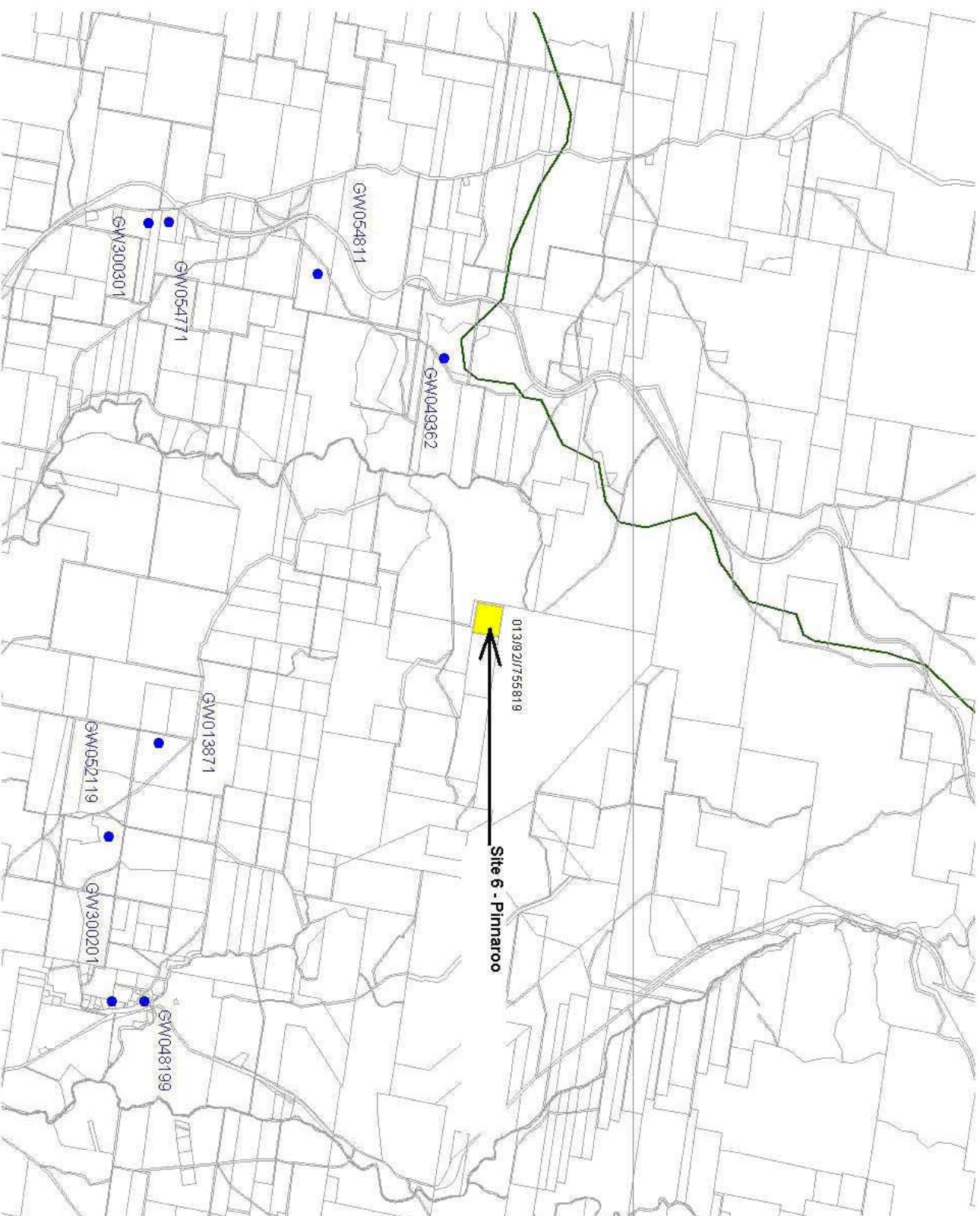

Date/Time :31-Oct-2003 09:35 AM
 User :GUEST
 Report :RMGW001D.QRP
 Executable :S:\G5\PROD32\Ground.exe
 Exe Date :29-Nov-2002
 System :Groundwater
 Database :Dlwcp



DEPARTMENT OF INFRASTRUCTURE, PLANNING AND NATURAL RESOURCES

Work Summary

GW013871

Converted From HYDSYS

License :30BL009012

Work Type :Bore
 Work Status :(Unknown)
 Construct. Method :Cable Tool
 Owner Type :Private

Authorised Purpose(s)
 STOCK

Intended Purpose(s)
 STOCK

Commenced Date : Final Depth : 52.70 m
 Completion Date :01-Jul-1958 Drilled Depth : 52.70 m

Contractor Name :
 Driller :

Property : - CLUNY
 GWMA : -
 GW Zone : -

Standing Water Level :
 Salinity : (Unknown)
 Yield :

Site Details

Site Chosen By	County Form A :SANDON Licensed :SANDON	Parish DUVAL DUVAL	Portion/Lot DP 10 LT DP
Region :30 - NORTH COAST River Basin :206 - MACLEAY RIVER Area / District :		CMA Map :9237-3S Grid Zone :56/1	DUMARESQ Scale :1:25,000
Elevation : Elevation Source :(Unknown)		Northing :6631768 Easting :369025	Latitude (S) :30° 26' 20" Longitude (E) :151° 38' 10"
GS Map :0029C2 AMG Zone :56		Coordinate Source :GD.,ACC.MAP	

Construction

Negative depths indicate Above Ground Level;H-Hole;P-Pipe;OD-Outside Diameter;ID-Inside Diameter;C-Cemented;SL-Slot Length;A-Aperture;GS-Grain Size;Q-Quantity

H	P	Component	Type	From (m)	To (m)	OD (mm)	ID (mm)	Interval	Details
1	1	Casing	Threaded Steel	0.00	40.50	152			Driven into Hole

Water Bearing Zones

From (m)	To (m)	Thickness (m)	WBZ Type	S.W.L. (m)	D.D.L. (m)	Yield (L/s)	Hole Depth (m)	Duration (hr)	Salinity (mg/L)
48.80	48.80	0.00	(Unknown)			0.00			(Unknown)

Drillers Log

From (m)	To (m)	Thickness(m)	Drillers Description	Geological Material	Comments
0.00	1.37	1.37	Soil Basaltic		
1.37	5.49	4.12	Basalt Broken	Basalt	
5.49	6.71	1.22	Basalt Hard	Basalt	
6.71	7.92	1.21	Pipe Clay White	Pipe Clay	
7.92	11.58	3.66	Clay Yellow	Clay	
11.58	51.21	39.63	Clay Pink	Clay	
51.21	52.73	1.52	Granite	Granite	

Remarks

*** End of GW013871 ***

DEPARTMENT OF INFRASTRUCTURE, PLANNING AND NATURAL RESOURCES

Work Summary

GW048199

Converted From HYDSYS

License :30BL105749	Authorised Purpose(s) DOMESTIC	Intended Purpose(s) DOMESTIC
Work Type :Bore open thru rock		
Work Status :(Unknown)		
Construct. Method :Rotary Air		
Owner Type :Private		
Commenced Date :	Final Depth : 15.80 m	
Completion Date :01-Jan-1977	Drilled Depth : 15.80 m	
Contractor Name :		
Driller :1493 LINTON, Alec		
Property :	Standing Water Level :	
GWMA : -	Salinity :	0-500 ppm
GW Zone : -	Yield :	

Site Details

Site Chosen By	County Form A :SANDON Licensed :SANDON	Parish DUVAL DUVAL	Portion/Lot DP 205 205
Region :30 - NORTH COAST		CMA Map :9237-3S	DUMARESQ
River Basin :206 - MACLEAY RIVER		Grid Zone :56/1	Scale :1:25,000
Area / District :			
Elevation :		Northing :6631610	Latitude (S) :30° 26' 27"
Elevation Source :(Unknown)		Easting :372372	Longitude (E) :151° 40' 15"
GS Map :0029C2	AMG Zone :56	Coordinate Source :GD.,ACC.MAP	

Construction

Negative depths indicate Above Ground Level;H-Hole;P-Pipe;OD-Outside Diameter;ID-Inside Diameter;C-Cemented;SL-Slot Length;A-Aperture;GS-Grain Size;Q-Quantity

H	P	Component	Type	From (m)	To (m)	OD (mm)	ID (mm)	Interval	Details
1	1	Casing	Threaded Steel	0.00	1.80	152			(Unknown)
1	1	Casing	P.V.C.	1.80	7.90	127			(Unknown)

Water Bearing Zones

From (m)	To (m)	Thickness (m)	WBZ Type	S.W.L. (m)	D.D.L. (m)	Yield (L/s)	Hole Depth (m)	Duration (hr)	Salinity (mg/L)
6.40	6.40	0.00	Fractured			0.03			(Unknown)
9.80	9.80	0.00	Fractured			0.09			(Unknown)
11.30	11.30	0.00	Fractured			0.76			(Unknown)

Drillers Log

From (m)	To (m)	Thickness(m)	Drillers Description	Geological Material	Comments
0.00	0.30	0.30	Loam Granite	Loam Granite	
0.30	0.60	0.30	Sand	Sand	
0.60	1.40	0.80	Clay Grey	Clay	
1.40	2.70	1.30	Granite Weathered	Granite	
2.70	3.70	1.00	Sand Wet Granite	Sand	
3.70	6.40	2.70	Granite Weathered	Granite	
6.40	15.80	9.40	Granite Grey Hard Fractured Water Supply	Granite	

Remarks

*** End of GW048199 ***

DEPARTMENT OF INFRASTRUCTURE, PLANNING AND NATURAL RESOURCES

Work Summary

GW049362

Converted From HYDSYS

License :30BL107459	Authorised Purpose(s) STOCK	Intended Purpose(s) STOCK
Work Type :Bore		
Work Status :(Unknown)		
Construct. Method :Cable Tool		
Owner Type :Private		
Commenced Date :	Final Depth : 15.80 m	
Completion Date :01-Mar-1979	Drilled Depth : 15.90 m	
Contractor Name :		
Driller :		
Property : - THE LAURELS	Standing Water Level :	
GWMA : -	Salinity :	(Unknown)
GW Zone : -	Yield :	

Site Details

Site Chosen By	County Form A :SANDON Licensed :SANDON	Parish DUMARESQ DUMARESQ	Portion/Lot DP 104 104
Region :30 - NORTH COAST		CMA Map :9237-3S	DUMARESQ
River Basin :206 - MACLEAY RIVER		Grid Zone :56/1	Scale :1:25,000
Area / District :			
Elevation :		Northing :6635964	Latitude (S) :30° 24' 2"
Elevation Source :(Unknown)		Easting :363990	Longitude (E) :151° 35' 3"
GS Map :0029C2	AMG Zone :56	Coordinate Source :GD.,ACC.MAP	

Construction

Negative depths indicate Above Ground Level;H-Hole;P-Pipe;OD-Outside Diameter;ID-Inside Diameter;C-Cemented;SL-Slot Length;A-Aperture;GS-Grain Size;Q-Quantity

H	P	Component	Type	From (m)	To (m)	OD (mm)	ID (mm)	Interval	Details
<i>(No Construction Details Found)</i>									

Water Bearing Zones

From (m)	To (m)	Thickness (m)	WBZ Type	S.W.L. (m)	D.D.L. (m)	Yield (L/s)	Hole Depth (m)	Duration (hr)	Salinity (mg/L)
<i>(No Water Bearing Zone Details Found)</i>									

Drillers Log

From (m)	To (m)	Thickness(m)	Drillers Description	Geological Material	Comments
0.00	2.74	2.74	Clay		
2.74	14.02	11.28	Basalt	Basalt	
14.02	15.85	1.83	Rock Grey	Rock	

Remarks

*** End of GW049362 ***

DEPARTMENT OF INFRASTRUCTURE, PLANNING AND NATURAL RESOURCES

Work Summary

GW052119

Converted From HYDSYS

License :30BL119038	Authorised Purpose(s) DOMESTIC STOCK	Intended Purpose(s) DOMESTIC STOCK
Work Type :Bore Work Status :(Unknown) Construct. Method :Rotary Owner Type :Private		
Commenced Date : Completion Date :01-Feb-1981	Final Depth : 72.90 m Drilled Depth : 72.90 m	
Contractor Name : Driller :		
Property : - CLUNY GWMA : - GW Zone : -	Standing Water Level : Salinity : Yield :	501-1000 ppm

Site Details

Site Chosen By	County Form A :SANDON Licensed :SANDON	Parish DUVAL DUVAL	Portion/Lot DP 4 4
Region :30 - NORTH COAST River Basin :206 - MACLEAY RIVER Area / District :	CMA Map :9237-3S Grid Zone :56/1	DUMARESQ Scale :1:25,000	
Elevation : Elevation Source :(Unknown)	Northing :6631050 Easting :370240	Latitude (S) :30° 26' 44" Longitude (E) :151° 38' 55"	
GS Map :0029C2 AMG Zone :56	Coordinate Source :GD.,ACC.MAP		

Construction

Negative depths indicate Above Ground Level;H-Hole;P-Pipe;OD-Outside Diameter;ID-Inside Diameter;C-Cemented;SL-Slot Length;A-Aperture;GS-Grain Size;Q-Quantity

H	P	Component	Type	From (m)	To (m)	OD (mm)	ID (mm)	Interval	Details
1	1	Casing	P.V.C.	0.00	72.90	137			Seated on Bottom
1	1	Opening	Slots - Vertical	48.60	66.80	137		1	Mechanically Slotted; SL: 0mm; A: 3mm

Water Bearing Zones

From (m)	To (m)	Thickness (m)	WBZ Type	S.W.L. (m)	D.D.L. (m)	Yield (L/s)	Hole Depth (m)	Duration (hr)	Salinity (mg/L)
34.90	67.50	32.60	(Unknown)	46.00		2.53			(Unknown)

Drillers Log

From (m)	To (m)	Thickness(m)	Drillers Description	Geological Material	Comments
0.00	0.30	0.30	Topsoil		
0.30	17.30	17.00	Clay	Clay	
17.30	41.30	24.00	Volcanic Rock Soft Water Supply	Volcanic Rock	
41.30	47.10	5.80	Clay Water Supply	Clay	
47.10	47.40	0.30	Basalt Water Supply	Basalt	
47.40	60.20	12.80	Clay Water Supply	Clay	
60.20	67.50	7.30	Granite Decomposed Water Supply	Granite	
67.50	72.90	5.40	Granite	Granite	

Remarks

*** End of GW052119 ***

DEPARTMENT OF INFRASTRUCTURE, PLANNING AND NATURAL RESOURCES

Work Summary

GW054771

Converted From HYDSYS

License :30BL117753	Authorised Purpose(s) DOMESTIC STOCK	Intended Purpose(s) DOMESTIC STOCK
Work Type :Bore		
Work Status :(Unknown)		
Construct. Method :Rotary Air		
Owner Type :Private		
Commenced Date :	Final Depth : 30.50 m	
Completion Date :01-Jan-1981	Drilled Depth : 34.70 m	
Contractor Name :		
Driller :		
Property :	Standing Water Level :	
GWMA : -	Salinity :	(Unknown)
GW Zone : -	Yield :	

Site Details

Site Chosen By	County Form A :SANDON Licensed :SANDON	Parish DUMARESQ DUMARESQ	Portion/Lot DP L2 (200) L2 (200)
Region :30 - NORTH COAST		CMA Map : 9237-3S	DUMARESQ
River Basin :206 - MACLEAY RIVER		Grid Zone : 56/1	Scale : 1:25,000
Area / District :			
Elevation :		Northing : 6631860	Latitude (S) : 30° 26' 15"
Elevation Source :(Unknown)		Easting : 362275	Longitude (E) : 151° 33' 57"
GS Map :0029C2	AMG Zone : 56	Coordinate Source : GD.,ACC.MAP	

Construction

Negative depths indicate Above Ground Level;H-Hole;P-Pipe;OD-Outside Diameter;ID-Inside Diameter;C-Cemented;SL-Slot Length;A-Aperture;GS-Grain Size;Q-Quantity

H	P	Component	Type	From (m)	To (m)	OD (mm)	ID (mm)	Interval	Details
1		Backfill	Backfill	30.50	34.80	165			
1	1	Casing	Steel	0.00	30.50	140			Suspended in Clamps
1	1	Opening	Slots - Vertical	21.30	30.20	140		1	Oxy-Acetylene Slotted; SL: 0mm; A: 8mm

Water Bearing Zones

From (m)	To (m)	Thickness (m)	WBZ Type	S.W.L. (m)	D.D.L. (m)	Yield (L/s)	Hole Depth (m)	Duration (hr)	Salinity (mg/L)
18.30	29.00	10.70	Unconsolidated	11.30		0.19			(Unknown)

Drillers Log

From (m)	To (m)	Thickness(m)	Drillers Description	Geological Material	Comments
0.00	34.74	34.74	Clay Yellow White Water Supply		

Remarks

*** End of GW054771 ***

DEPARTMENT OF INFRASTRUCTURE, PLANNING AND NATURAL RESOURCES

Work Summary

GW054811

Converted From HYDSYS

License :30BL117933	Authorised Purpose(s) DOMESTIC STOCK	Intended Purpose(s) NOT KNOWN
Work Type :Excavation		
Work Status :Supply Obtained		
Construct. Method :(Unknown)		
Owner Type :Private		
Commenced Date :	Final Depth : 7.00 m	
Completion Date :	Drilled Depth : 0.00	
Contractor Name :		
Driller :		
Property : - KURRAJONG	Standing Water Level :	
GWMA : -	Salinity :	(Unknown)
GW Zone : -	Yield :	

Site Details

Site Chosen By	County Form A :SANDON Licensed :SANDON	Parish DUMARESQ DUMARESQ	Portion/Lot DP 135 LT 2 DP 584290
Region :30 - NORTH COAST		CMA Map :9237-3S	DUMARESQ
River Basin :206 - MACLEAY RIVER		Grid Zone :56/1	Scale :1:25,000
Area / District :			
Elevation :		Northing :6634065	Latitude (S) :30° 25' 3"
Elevation Source :(Unknown)		Easting :362920	Longitude (E) :151° 34' 22"
GS Map :0029C2	AMG Zone :56	Coordinate Source :GD.,ACC.MAP	

Construction Negative depths indicate Above Ground Level;H-Hole;P-Pipe;OD-Outside Diameter;ID-Inside Diameter;C-Cemented;SL-Slot Length;A-Aperture;GS-Grain Size;Q-Quantity

H	P	Component	Type	From (m)	To (m)	OD (mm)	ID (mm)	Interval	Details
<i>(No Construction Details Found)</i>									

Water Bearing Zones

From (m)	To (m)	Thickness (m)	WBZ Type	S.W.L. (m)	D.D.L. (m)	Yield (L/s)	Hole Depth (m)	Duration (hr)	Salinity (mg/L)
3.00	6.00	3.00	Fractured	3.00					(Unknown)

Drillers Log

From (m)	To (m)	Thickness(m)	Drillers Description	Geological Material	Comments
----------	--------	--------------	----------------------	---------------------	----------

Remarks

*** End of GW054811 ***

DEPARTMENT OF INFRASTRUCTURE, PLANNING AND NATURAL RESOURCES

Work Summary

GW300201

License :30BL144620	Authorised Purpose(s) DOMESTIC STOCK	Intended Purpose(s) DOMESTIC
Work Type :Bore		
Work Status :(Unknown)		
Construct. Method :Rotary Air		
Owner Type :Private		
Commenced Date :	Final Depth : 47.20 m	
Completion Date :19-Nov-1991	Drilled Depth : 47.20 m	
Contractor Name :TAMWORTH DRILLING CO		
Driller :1417	STRUDWICK, Garry Stanley	
Property :	Standing Water Level :	
GWMA : -	Salinity :	
GW Zone : -	Yield :	

Site Details

Site Chosen By	County Form A : Licensed :SANDON	Parish DUVAL	Portion/Lot DP LT 212 DP 755819
Region :30 - NORTH COAST		CMA Map :	
River Basin :206 - MACLEAY RIVER		Grid Zone :	Scale :
Area / District :			
Elevation :		Northing :6631120	Latitude (S) :30° 26' 43"
Elevation Source :		Easting :372380	Longitude (E) :151° 40' 15"
GS Map :	AMG Zone :56	Coordinate Source :Map Interpretation	

Construction

Negative depths indicate Above Ground Level;H-Hole;P-Pipe;OD-Outside Diameter;ID-Inside Diameter;C-Cemented;SL-Slot Length;A-Aperture;GS-Grain Size;Q-Quantity

H	P	Component	Type	From (m)	To (m)	OD (mm)	ID (mm)	Interval	Details
1		Hole	Hole	0.00	47.20	160			Rotary Air
1	1	Casing	Steel	-0.30	2.70	168			Driven into Hole
1	1	Casing	P.V.C.	-0.20	47.20	155			Seated on Bottom
1	1	Opening	Slots - Vertical	21.00	47.20	135		1	PVC; Sawn; SL: 100mm; A: 2mm

Water Bearing Zones

From (m)	To (m)	Thickness (m)	WBZ Type	S.W.L. (m)	D.D.L. (m)	Yield (L/s)	Hole Depth (m)	Duration (hr)	Salinity (mg/L)
30.00	47.20	17.20		16.00		0.25	46.00	2.00	Good

Drillers Log

From (m)	To (m)	Thickness(m)	Drillers Description	Geological Material	Comments
0.00	12.00	12.00	SOFT GRANITE SAND		
12.00	41.00	29.00	FIRM GRANITE SAND		
41.00	42.50	1.50	GREY GRANITE		
42.50	47.20	4.70	BROWN GRANITE		

Remarks

*** End of GW300201 ***

DEPARTMENT OF INFRASTRUCTURE, PLANNING AND NATURAL RESOURCES

Work Summary

GW300301

License :30BL145770	Authorised Purpose(s) DOMESTIC STOCK	Intended Purpose(s) DOMESTIC STOCK
Work Type :Bore		
Work Status :(Unknown)		
Construct. Method :Rotary Air		
Owner Type :Private		
Commenced Date :	Final Depth : 48.00 m	
Completion Date :17-Apr-1991	Drilled Depth : 48.00 m	
Contractor Name :TANNER DRILLING		
Driller :1412	TANNER, Robert Leslie	
Property :	Standing Water Level :	
GWMA : -	Salinity :	Good
GW Zone : -	Yield :	

Site Details

Site Chosen By Driller	County Form A :SANDON Licensed :SANDON	Parish DUMARESQ DUMARESQ	Portion/Lot DP LT1 DP507562 LT 1 DP 507562
Region :30 - NORTH COAST	CMA Map :		
River Basin :206 - MACLEAY RIVER	Grid Zone :	Scale :	
Area / District :			
Elevation :	Northing :6631547	Latitude (S) :30° 26' 25"	
Elevation Source :	Easting :362288	Longitude (E) :151° 33' 57"	
GS Map :	AMG Zone :56	Coordinate Source :Map Interpretation	

Construction

Negative depths indicate Above Ground Level;H-Hole;P-Pipe;OD-Outside Diameter;ID-Inside Diameter;C-Cemented;SL-Slot Length;A-Aperture;GS-Grain Size;Q-Quantity

H	P	Component	Type	From (m)	To (m)	OD (mm)	ID (mm)	Interval	Details
1		Hole	Hole	0.00	48.00	170			Rotary Air
1	1	Casing	PVC Class 9	-0.30	27.00	152			Glued; Suspended in Clamps

Water Bearing Zones

From (m)	To (m)	Thickness (m)	WBZ Type	S.W.L. (m)	D.D.L. (m)	Yield (L/s)	Hole Depth (m)	Duration (hr)	Salinity (mg/L)
27.00	32.00	5.00		18.00		0.51	48.00	1.00	Good

Drillers Log

From (m)	To (m)	Thickness(m)	Drillers Description	Geological Material	Comments
0.00	0.30	0.30	GREY TOPSOIL		
0.30	2.00	1.70	BASALT FLOATERS		
2.00	12.00	10.00	BASALT		
12.00	24.00	12.00	GREY CLAY		
24.00	27.00	3.00	BASASLT		
27.00	32.00	5.00	CRACKY BASALT		
32.00	48.00	16.00	BASALT		

Remarks

*** End of GW300301 ***

*** End of Report ***

Department of Infrastructure, Planning and Natural Resources

Groundwater Locations

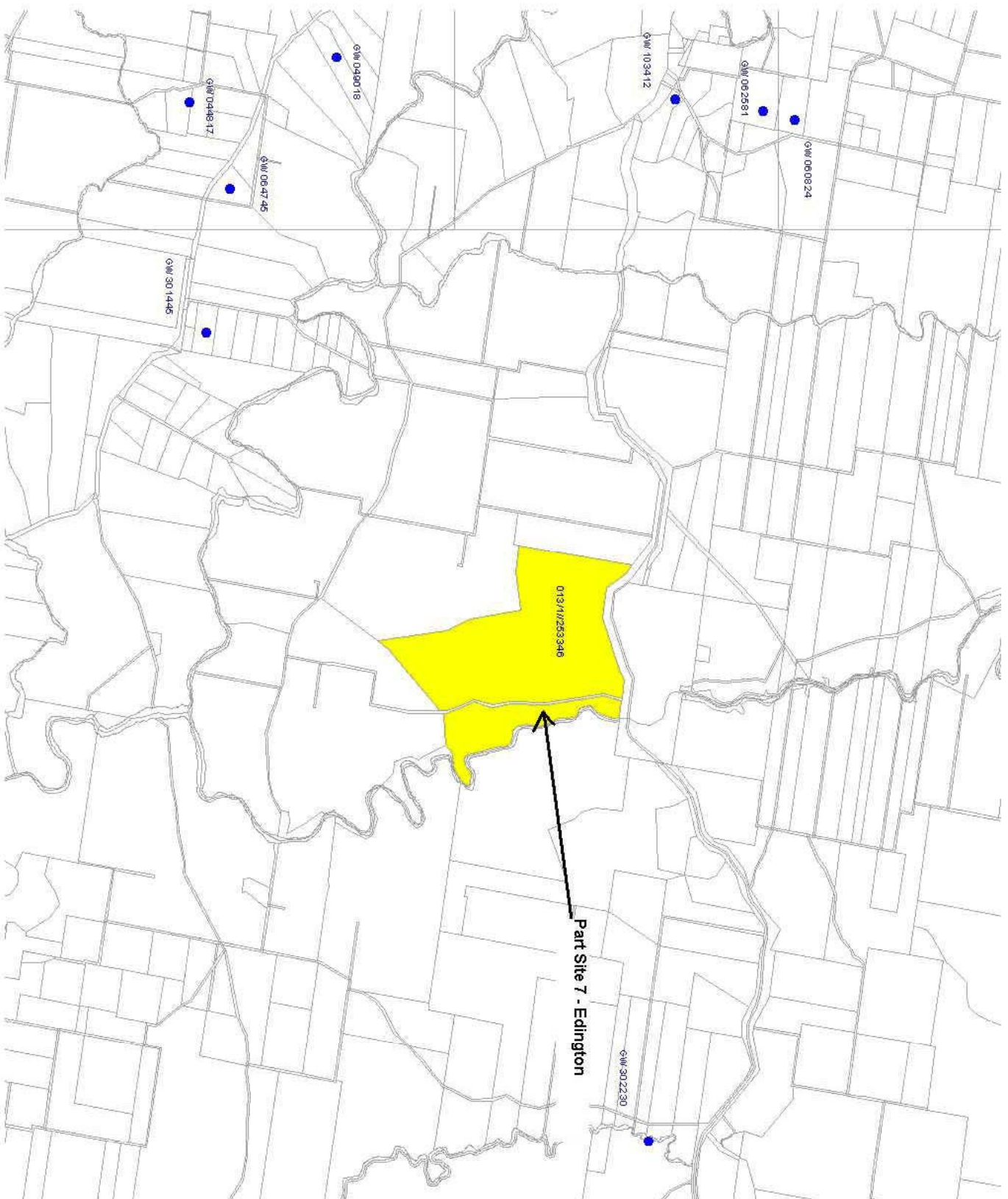

Area: Edington
Client: Mausell Australia
 PO Box Q410
 OVB Post Office
 NSW 1230
Contact: Michael Borman
Date of Search: 30-10-03
By: Richard Myers
Job Ref: BAGDS0093



LEGEND

- Groundwater Works Number
- Cadastral Boundaries
- Area of Interest

Data depicted here is the most up to date held by DJPIR in their Groundwater Database, at the time of printing.

Disclaimer

The State of New South Wales and the Department of Infrastructure, Planning and Natural Resources and its employees, officers, agents or servants are not responsible for the result of any actions taken on the basis of the information contained on this map or for any errors, omissions or inaccuracies contained in this map. The State of New South Wales and its employees, officers, agents or servants expressly disclaim all and any liability and responsibility to any person in respect of anything and of the consequences, of anything done or omitted to be done by any such person in reliance, whether wholly or partially upon the information contained on the map.

Date/Time :31-Oct-2003 10:23 AM
 User :GUEST
 Report :RMGW001D.QRP
 Executable :S:\G5\PROD32\Ground.exe
 Exe Date :29-Nov-2002
 System :Groundwater
 Database :Dlwcp



DEPARTMENT OF INFRASTRUCTURE, PLANNING AND NATURAL RESOURCES

Work Summary

GW044817

Converted From HYDSYS

License :30BL103279

Work Type :Bore
 Work Status :(Unknown)
 Construct. Method :Rotary Air
 Owner Type :Private

Authorised Purpose(s)
 DOMESTIC
 STOCK

Intended Purpose(s)
 DOMESTIC
 STOCK

Commenced Date : Final Depth : 61.00 m
 Completion Date :01-Jan-1976 Drilled Depth : 61.00 m

Contractor Name :
 Driller :

Property :
 GWMA : -
 GW Zone : -

Standing Water Level :
 Salinity : (Unknown)
 Yield :

Site Details

Site Chosen By	County Form A :SANDON Licensed :SANDON	Parish TIVERTON TIVERTON	Portion/Lot DP 41 UNKNOWN FROM HYDSYS
Region :30 - NORTH COAST River Basin :206 - MACLEAY RIVER Area / District :		CMA Map :9236-4N Grid Zone :56/1	ARMIDALE Scale :1:25,000
Elevation : Elevation Source :(Unknown)		Northing :6615365 Easting :378980	Latitude (S) :30° 35' 17" Longitude (E) :151° 44' 16"
GS Map :0029C3 AMG Zone :56		Coordinate Source :GD.,ACC.MAP	

Construction

Negative depths indicate Above Ground Level;H-Hole;P-Pipe;OD-Outside Diameter;ID-Inside Diameter;C-Cemented;SL-Slot Length;A-Aperture;GS-Grain Size;Q-Quantity

H P Component Type	From (m)	To (m)	OD (mm)	ID (mm)	Interval	Details
--------------------	----------	--------	---------	---------	----------	---------

(No Construction Details Found)

Water Bearing Zones

From (m)	To (m)	Thickness (m)	WBZ Type	S.W.L. (m)	D.D.L. (m)	Yield (L/s)	Hole Depth (m)	Duration (hr)	Salinity (mg/L)
----------	--------	---------------	----------	------------	------------	-------------	----------------	---------------	-----------------

(No Water Bearing Zone Details Found)

Drillers Log

From (m)	To (m)	Thickness(m)	Drillers Description	Geological Material	Comments
0.00	0.30	0.30	Topsoil		
0.30	2.44	2.14	Clay	Clay	
2.44	9.14	6.70	Clay Boulder	Clay	
9.14	18.29	9.15	Shale	Shale	
18.29	60.96	42.67	Slate Some	Slate	

Remarks

*** End of GW044817 ***

DEPARTMENT OF INFRASTRUCTURE, PLANNING AND NATURAL RESOURCES

Work Summary

GW049018

Converted From HYDSYS

License :30BL106233	Authorised Purpose(s) DOMESTIC STOCK	Intended Purpose(s) DOMESTIC STOCK
Work Type :Bore Work Status :(Unknown) Construct. Method :Cable Tool Owner Type :Private		
Commenced Date : Completion Date :01-Jun-1977	Final Depth : 32.00 m Drilled Depth : 0.00	
Contractor Name : Driller :		
Property : GWMA : - GW Zone : -	Standing Water Level : Salinity : Yield :	(Unknown)

Site Details

Site Chosen By	County Form A :SANDON Licensed :SANDON	Parish TIVERTON TIVERTON	Portion/Lot DP L4 DP240444 (29) LT 4 DP 240444
Region :30 - NORTH COAST River Basin :206 - MACLEAY RIVER Area / District :		CMA Map :9236-4N Grid Zone :56/1	ARMIDALE Scale :1:25,000
Elevation : Elevation Source :(Unknown)		Northing :6616920 Easting :378550	Latitude (S) :30° 34' 26" Longitude (E) :151° 43' 60"
GS Map :0029C3 AMG Zone :56		Coordinate Source :GD.,ACC.MAP	

Construction

Negative depths indicate Above Ground Level;H-Hole;P-Pipe;OD-Outside Diameter;ID-Inside Diameter;C-Cemented;SL-Slot Length;A-Aperture;GS-Grain Size;Q-Quantity

H	P	Component	Type	From (m)	To (m)	OD (mm)	ID (mm)	Interval	Details
<i>(No Construction Details Found)</i>									

Water Bearing Zones

From (m)	To (m)	Thickness (m)	WBZ Type	S.W.L. (m)	D.D.L. (m)	Yield (L/s)	Hole Depth (m)	Duration (hr)	Salinity (mg/L)
<i>(No Water Bearing Zone Details Found)</i>									

Drillers Log

From (m)	To (m)	Thickness(m)	Drillers Description	Geological Material	Comments
----------	--------	--------------	----------------------	---------------------	----------

Remarks

*** End of GW049018 ***

DEPARTMENT OF INFRASTRUCTURE, PLANNING AND NATURAL RESOURCES

Work Summary

GW060824

Converted From HYDSYS

License :30BL132172	Authorised Purpose(s) DOMESTIC STOCK	Intended Purpose(s) DOMESTIC STOCK
Work Type :Bore open thru rock		
Work Status :(Unknown)		
Construct. Method :Rotary Air		
Owner Type :Private		
Commenced Date :	Final Depth : 54.90 m	
Completion Date :01-Mar-1985	Drilled Depth : 54.90 m	
Contractor Name :		
Driller :		
Property :	Standing Water Level :	
GWMA : -	Salinity :	501-1000 ppm
GW Zone : -	Yield :	

Site Details

Site Chosen By	County Form A :SANDON Licensed :SANDON	Parish GARA GARA	Portion/Lot DP L2 DP527565 (99) LT 2 DP 527565
Region :30 - NORTH COAST		CMA Map : 9236-4N	ARMIDALE
River Basin :206 - MACLEAY RIVER		Grid Zone : 56/1	Scale : 1:25,000
Area / District :			
Elevation :		Northing : 6621825	Latitude (S) : 30° 31' 47"
Elevation Source :(Unknown)		Easting : 379055	Longitude (E) : 151° 44' 22"
GS Map :0029C3	AMG Zone : 56	Coordinate Source : GD.,ACC.MAP	

Construction

Negative depths indicate Above Ground Level;H-Hole;P-Pipe;OD-Outside Diameter;ID-Inside Diameter;C-Cemented;SL-Slot Length;A-Aperture;GS-Grain Size;Q-Quantity

H	P	Component	Type	From (m)	To (m)	OD (mm)	ID (mm)	Interval	Details
1	1	Casing	Threaded Steel	0.00	11.40	152			Seated

Water Bearing Zones

From (m)	To (m)	Thickness (m)	WBZ Type	S.W.L. (m)	D.D.L. (m)	Yield (L/s)	Hole Depth (m)	Duration (hr)	Salinity (mg/L)
46.00	54.80	8.80	(Unknown)	40.20		0.19			501-1000 ppm

Drillers Log

From (m)	To (m)	Thickness(m)	Drillers Description	Geological Material	Comments
0.00	0.09	0.09	Topsoil		
0.09	11.28	11.19	Clay	Clay	
11.28	18.59	7.31	Rock Decomposed	Rock	
18.59	46.02	27.43	Basalt	Basalt	
46.02	46.63	0.61	Clay Sedimentary Water Supply	Clay	
46.63	54.86	8.23	Clay Layers Water Supply	Clay	
46.63	54.86	8.23	Basalt Hard	Basalt	

Remarks

*** End of GW060824 ***

DEPARTMENT OF INFRASTRUCTURE, PLANNING AND NATURAL RESOURCES

Work Summary

GW062581

Converted From HYDSYS

License :30BL134330	Authorised Purpose(s)	Intended Purpose(s)
Work Type :Bore	DOMESTIC	DOMESTIC
Work Status :(Unknown)	STOCK	STOCK
Construct. Method :Rotary Air		
Owner Type :Private		
Commenced Date :	Final Depth :	47.50 m
Completion Date :01-Jun-1986	Drilled Depth :	47.50 m
Contractor Name :		
Driller :1417	STRUDWICK, Garry Stanley	
Property :	Standing Water Level :	
GWMA : -	Salinity :	1001-3000 ppm
GW Zone : -	Yield :	

Site Details

Site Chosen By	County	Parish	Portion/Lot DP
	Form A :SANDON	GARA	97
	Licensed :SANDON	GARA	97
Region :30 - NORTH COAST		CMA Map : 9236-4N	ARMIDALE
River Basin :206 - MACLEAY RIVER		Grid Zone : 56/1	Scale :1:25,000
Area / District :			
Elevation :		Northing : 6621487	Latitude (S) : 30° 31' 58"
Elevation Source :(Unknown)		Eastings : 379000	Longitude (E) : 151° 44' 19"
GS Map :0029C3	AMG Zone : 56	Coordinate Source : GD.,ACC.MAP	

Construction Negative depths indicate Above Ground Level;H-Hole;P-Pipe;OD-Outside Diameter;ID-Inside Diameter;C-Cemented;SL-Slot Length;A-Aperture;GS-Grain Size;Q-Quantity

H	P	Component	Type	From (m)	To (m)	OD (mm)	ID (mm)	Interval	Details
1	1	Casing	P.V.C.	0.00	47.50	152			Seated on Bottom

Water Bearing Zones

From (m)	To (m)	Thickness (m)	WBZ Type	S.W.L. (m)	D.D.L. (m)	Yield (L/s)	Hole Depth (m)	Duration (hr)	Salinity (mg/L)
27.40	28.30	0.90	Fractured			0.25			1001-3000 ppm
43.90	47.50	3.60	Fractured	24.50		2.25			1001-3000 ppm

Drillers Log

From (m)	To (m)	Thickness(m)	Drillers Description	Geological Material	Comments
0.00	4.00	4.00	Soil Trap		
4.00	10.00	6.00	Rock Trap	Rock	
10.00	47.50	37.50	Granite Black Water Supply	Granite	

Remarks

CONDUCTIVITY = 1800

*** End of GW062581 ***

DEPARTMENT OF INFRASTRUCTURE, PLANNING AND NATURAL RESOURCES

Work Summary

GW064745

Converted From HYDSYS

License :30BL137451	Authorised Purpose(s) DOMESTIC STOCK	Intended Purpose(s) DOMESTIC STOCK
Work Type :Bore Work Status :(Unknown) Construct. Method :Rotary Owner Type :Private		
Commenced Date : Completion Date :01-Feb-1988	Final Depth : 0.00 Drilled Depth : 53.00 m	
Contractor Name : Driller :		
Property : GWMA : - GW Zone : -	Standing Water Level : Salinity : Yield :	(Unknown)

Site Details

Site Chosen By	County Form A :SANDON Licensed :SANDON	Parish TIVERTON TIVERTON	Portion/Lot DP LT2 DP247588 LT 2 DP 247588
Region :30 - NORTH COAST River Basin :206 - MACLEAY RIVER Area / District :		CMA Map :9236-4N Grid Zone :56/1	ARMIDALE Scale :1:25,000
Elevation : Elevation Source :(Unknown)		Northing :6615810 Easting :379780	Latitude (S) :30° 35' 3" Longitude (E) :151° 44' 46"
GS Map :0029C3 AMG Zone :56		Coordinate Source :GD.,ACC.MAP	

Construction

Negative depths indicate Above Ground Level;H-Hole;P-Pipe;OD-Outside Diameter;ID-Inside Diameter;C-Cemented;SL-Slot Length;A-Aperture;GS-Grain Size;Q-Quantity

H	P	Component	Type	From (m)	To (m)	OD (mm)	ID (mm)	Interval	Details
(No Construction Details Found)									

Water Bearing Zones

From (m)	To (m)	Thickness (m)	WBZ Type	S.W.L. (m)	D.D.L. (m)	Yield (L/s)	Hole Depth (m)	Duration (hr)	Salinity (mg/L)
(No Water Bearing Zone Details Found)									

Drillers Log

From (m)	To (m)	Thickness(m)	Drillers Description	Geological Material	Comments
0.00	2.00	2.00	Clay		
2.00	15.00	13.00	Basalt Decomposed	Basalt	
15.00	53.00	38.00	Basalt Hard	Basalt	

Remarks

*** End of GW064745 ***

DEPARTMENT OF INFRASTRUCTURE, PLANNING AND NATURAL RESOURCES

Work Summary

GW103412

License :30BL177194	Authorised Purpose(s) DOMESTIC STOCK	Intended Purpose(s) DOMESTIC STOCK
Work Type :Bore		
Work Status :(Unknown)		
Construct. Method :		
Owner Type :		
Commenced Date :	Final Depth : 60.00 m	
Completion Date :31-Dec-1995	Drilled Depth :	
Contractor Name :TANNER DRILLING		
Driller :		
Property : - " RAYENDA "	Standing Water Level :	
GWMA : -	Salinity :	
GW Zone : -	Yield :	0.25 L/s

Site Details

Site Chosen By	County Form A :SANDON Licensed :SANDON	Parish GARA GARA	Portion/Lot DP LOT 4 DP838032 LT 4 DP 838032
Region :30 - NORTH COAST		CMA Map :	
River Basin :		Grid Zone :	Scale :
Area / District :			
Elevation :		Northing :6620551	Latitude (S) :30° 32' 28"
Elevation Source :		Easting :378895	Longitude (E) :151° 44' 15"
GS Map :	AMG Zone :56	Coordinate Source :Map Interpretation	

Construction

Negative depths indicate Above Ground Level;H-Hole;P-Pipe;OD-Outside Diameter;ID-Inside Diameter;C-Cemented;SL-Slot Length;A-Aperture;GS-Grain Size;Q-Quantity

H	P	Component	Type	From (m)	To (m)	OD (mm)	ID (mm)	Interval	Details
1		Hole	Hole	0.00	60.00	100			

Water Bearing Zones

From (m)	To (m)	Thickness (m)	WBZ Type	S.W.L. (m)	D.D.L. (m)	Yield (L/s)	Hole Depth (m)	Duration (hr)	Salinity (mg/L)
(No Water Bearing Zone Details Found)									

Drillers Log

From (m)	To (m)	Thickness(m)	Drillers Description	Geological Material	Comments

Remarks

Form A Remarks:
Tanner the driller came from Coff's Harbour. No further details. Mr Tanner sent all relevant details to Land and Water Conservation.

*** End of GW103412 ***

DEPARTMENT OF INFRASTRUCTURE, PLANNING AND NATURAL RESOURCES

Work Summary

GW301445

License :30BL177305	Authorised Purpose(s)	Intended Purpose(s)
Work Type :Bore	DOMESTIC	DOMESTIC
Work Status :(Unknown)	STOCK	IRRIGATION
Construct. Method :Rot. Rev. Circ. Air		STOCK
Owner Type :		
Commenced Date :	Final Depth :	62.00 m
Completion Date :13-Oct-1994	Drilled Depth :	62.00 m
Contractor Name :DROUGHT BUSTER DRILLING		
Driller :1647	DELL, Garry Noel	
Property : - BYGALORIE	Standing Water Level :	28.00 m
GWMA : -	Salinity :	Good
GW Zone : -	Yield :	0.08 L/s

Site Details

Site Chosen By	County	Parish	Portion/Lot DP
	Form A :SANDON	TIVERTON	LOT 22 DP569395
	Licensed :SANDON	TIVERTON	LT 22 DP 569395
Region :30 - NORTH COAST		CMA Map :	
River Basin :		Grid Zone :	Scale :
Area / District :			
Elevation :		Northing :6615564	Latitude (S) :30° 35' 11"
Elevation Source :		Easting :381116	Longitude (E) :151° 45' 36"
GS Map :	AMG Zone :56	Coordinate Source :Map Interpretation	

Construction

Negative depths indicate Above Ground Level;H-Hole;P-Pipe;OD-Outside Diameter;ID-Inside Diameter;C-Cemented;SL-Slot Length;A-Aperture;GS-Grain Size;Q-Quantity

H	P	Component	Type	From (m)	To (m)	OD (mm)	ID (mm)	Interval	Details
1		Hole	Hole	0.00	62.00	127			Rot. Rev. Circ. Air
1	1	Casing	P.V.C.	-0.80	62.00	112			C: -, I-.6m; Cemented; Seated on Bottom
1	1	Opening	Slots - Horizontal	28.00	34.00	112			PVC; Sawm; SL: 100mm; A: 2mm

Water Bearing Zones

From (m)	To (m)	Thickness (m)	WBZ Type	S.W.L. (m)	D.D.L. (m)	Yield (L/s)	Hole Depth (m)	Duration (hr)	Salinity (mg/L)
30.00	33.00	3.00		28.00		0.08	36.00		Good

Drillers Log

From (m)	To (m)	Thickness(m)	Drillers Description	Geological Material	Comments
0.00	8.00	8.00	broken basalt rock		
8.00	62.00	54.00	clean basalt rock		

Remarks

*** End of GW301445 ***

DEPARTMENT OF INFRASTRUCTURE, PLANNING AND NATURAL RESOURCES

Work Summary

GW302230

License :30BL178609	Authorised Purpose(s) DOMESTIC STOCK	Intended Purpose(s) DOMESTIC STOCK
Work Type :Bore		
Work Status :(Unknown)		
Construct. Method :Rotary Air		
Owner Type :		
Commenced Date :	Final Depth : 42.00 m	
Completion Date :27-May-1999	Drilled Depth : 42.00 m	
Contractor Name :TDM P/L		
Driller :1701	TANNER, Robert Leslie	
Property : - MORUNDA	Standing Water Level :	6.00 m
GWMA : -	Salinity :	120.00 mg/L
GW Zone : -	Yield :	0.51 L/s

Site Details

Site Chosen By	County Form A : Licensed :SANDON	Parish METZ	Portion/Lot DP LT 230 DP 755834
Region :30 - NORTH COAST		CMA Map :	
River Basin :		Grid Zone :	Scale :
Area / District :			
Elevation :		Northing :6620371	Latitude (S) :30° 32' 38"
Elevation Source :		Easting :388568	Longitude (E) :151° 50' 18"
GS Map :	AMG Zone :56	Coordinate Source :	

Construction

Negative depths indicate Above Ground Level;H-Hole;P-Pipe;OD-Outside Diameter;ID-Inside Diameter;C-Cemented;SL-Slot Length;A-Aperture;GS-Grain Size;Q-Quantity

H	P	Component	Type	From (m)	To (m)	OD (mm)	ID (mm)	Interval	Details
1		Hole	Hole	0.00	18.00	200			Rotary Air
1		Hole	Hole	18.00	42.00	140			Down Hole Hammer
1	1	Casing	PVC Class 9	-0.30	18.00	170		154	Glued; Driven into Hole
1	1	Casing	PVC Class 9	-0.30	42.00	125		113	Glued; Seated on Bottom
1	1	Opening	Slots - Vertical	37.00	42.00	125			PVC Class 9; Slotted In Hole; SL: 100mm; A: 4mm

Water Bearing Zones

From (m)	To (m)	Thickness (m)	WBZ Type	S.W.L. (m)	D.D.L. (m)	Yield (L/s)	Hole Depth (m)	Duration (hr)	Salinity (mg/L)
37.00	42.00	5.00		6.00		0.51	42.00	1.50	120.00

Drillers Log

From (m)	To (m)	Thickness(m)	Drillers Description	Geological	Comments
0.00	0.60	0.60	brown top soil	Material	
0.60	2.00	1.40	brown clay	Bands	
2.00	18.00	16.00	brown sandy clay (granitic)	Brown Clay Bands	
18.00	37.00	19.00	weathered granite	Brown Streaks	
37.00	42.00	5.00	broken granite	Weathered Rock(Unident)	
				Broken	

Remarks

*** End of GW302230 ***

*** End of Report ***

Department of Infrastructure, Planning and Natural Resources

Groundwater Locations



Area: Waloma
 Client: Mausell Australia
 PO Box Q410
 QVB Post Office
 NSW 1230
 Contact: Michael Borman
 Date of Search: 30-10-03
 By: Richard Myers
 Job Ref: BAQD50093

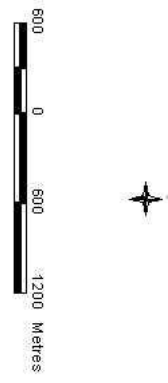

LEGEND

- Groundwater Works Number
- Cadastral Boundaries
- Area of Interest

Data depicted here is the most up to date held by DIPNR in their Groundwater Database, at the time of printing.

Disclaimer

This State of New South Wales and the Department of Infrastructure, Planning and Natural Resources and its employees, officers, agents or servants are not responsible for the result of any actions taken on the basis of the information contained on this map or for any error, omissions or inaccuracies contained in this map. The State of New South Wales and its employees, officers, agents or servants expressly disclaim all and any liability and responsibility to any person in respect of anything and of the consequences, of anything done or omitted to be done by any such person in reliance, whether wholly or partially upon the information contained on the map.

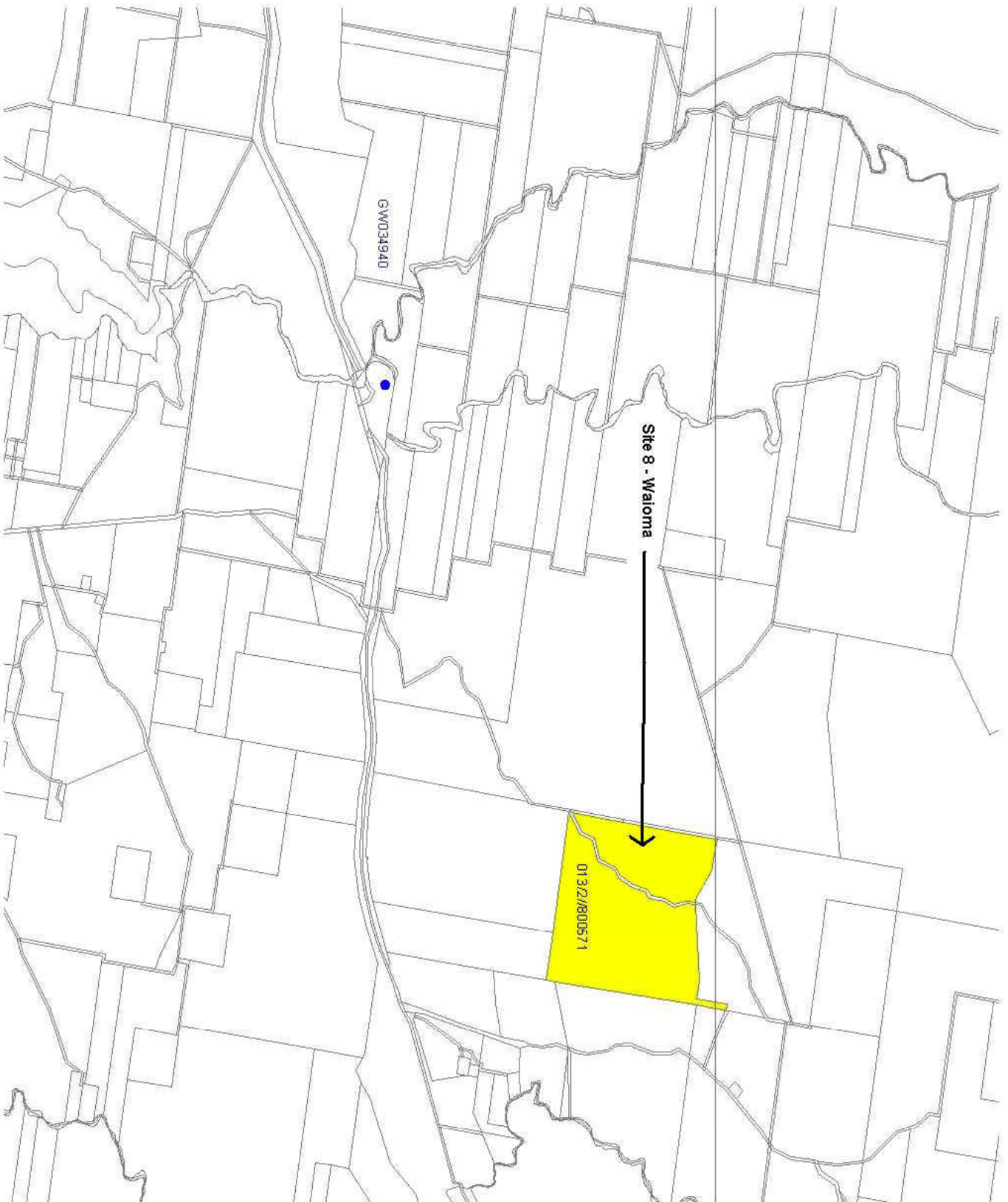

Date/Time :31-Oct-2003 11:01 AM
 User :GUEST
 Report :RMGW001D.QRP
 Executable :S:\G5\PROD32\Ground.exe
 Exe Date :29-Nov-2002
 System :Groundwater
 Database :Dlwc



DEPARTMENT OF INFRASTRUCTURE, PLANNING AND NATURAL RESOURCES

Work Summary

GW034940

Converted From HYDSYS

License :30BL027319

Work Type :Bore open thru rock
 Work Status :(Unknown)
 Construct. Method :Rotary
 Owner Type :Private

Authorised Purpose(s)
 DOMESTIC
 STOCK

Intended Purpose(s)
 DOMESTIC
 STOCK

Commenced Date : Final Depth : 45.70 m
 Completion Date :01-Mar-1972 Drilled Depth : 45.70 m

Contractor Name :
 Driller :

Property : - HILLGROVE STATION
 GWMA : -
 GW Zone : -

Standing Water Level :
 Salinity : (Unknown)
 Yield :

Site Details

Site Chosen By	County Form A :SANDON Licensed :SANDON	Parish METZ METZ	Portion/Lot DP 1 LT DP
Region :30 - NORTH COAST River Basin :206 - MACLEAY RIVER Area / District :		CMA Map :9236-1N Grid Zone :56/1	HILLGROVE Scale :1:25,000
Elevation : Elevation Source :(Unknown)		Northing :6622340 Easting :394240	Latitude (S) :30° 31' 36" Longitude (E) :151° 53' 51"
GS Map :0029D3 AMG Zone :56		Coordinate Source :GD.,ACC.MAP	

Construction

Negative depths indicate Above Ground Level;H-Hole;P-Pipe;OD-Outside Diameter;ID-Inside Diameter;C-Cemented;SL-Slot Length;A-Aperture;GS-Grain Size;Q-Quantity

H	P	Component	Type	From (m)	To (m)	OD (mm)	ID (mm)	Interval	Details
1	1	Casing	Rolled Steel	-0.30	5.70	152			Driven into Hole

Water Bearing Zones

From (m)	To (m)	Thickness (m)	WBZ Type	S.W.L. (m)	D.D.L. (m)	Yield (L/s)	Hole Depth (m)	Duration (hr)	Salinity (mg/L)
11.50	12.10	0.60	Fractured						(Unknown)
17.30	17.60	0.30	Fractured						(Unknown)
29.80	30.70	0.90	Fractured						(Unknown)

Drillers Log

From (m)	To (m)	Thickness(m)	Drillers Description	Geological Material	Comments
0.00	0.45	0.45	Topsoil	Topsoil	
0.45	3.65	3.20	Clay	Clay	
3.65	4.26	0.61	Boulders	Boulders	
4.26	5.79	1.53	Basalt Decomposed	Basalt	
5.79	45.72	39.93	Basalt Water Supply	Basalt	

Remarks

*** End of GW034940 ***

*** End of Report ***

Department of Infrastructure, Planning and Natural Resources

Groundwater Locations



Area: Ballerntrea
Client: Mausell Australia
 PO Box Q4110
 OVB Post Office
 NSW 1230
Contact: Michael Borman
Date of Search: 30-10-03
By: Richard Myers
Job Ref: BAGDS0093

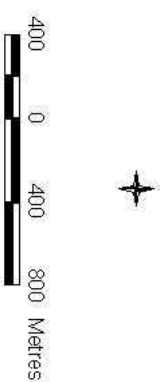

LEGEND

- Groundwater Works Number
- Cadastral Boundaries
- Area of Interest

Data depicted here is the most up to date held by DJPNR in their Groundwater Database, at the time of printing.

Disclaimer

The State of New South Wales and the Department of Infrastructure, Planning and Natural Resources and its employees, officers, agents or servants are not responsible for the result of any actions taken on the basis of the information contained on this map or for any errors, omissions or inaccuracies contained in this map. The State of New South Wales and its employees, officers, agents or servants expressly disclaim all and any liability and responsibility to any person in respect of anything and of the consequences, of anything done or omitted to be done by any such person in reliance, whether wholly or partially upon the information contained on the map.

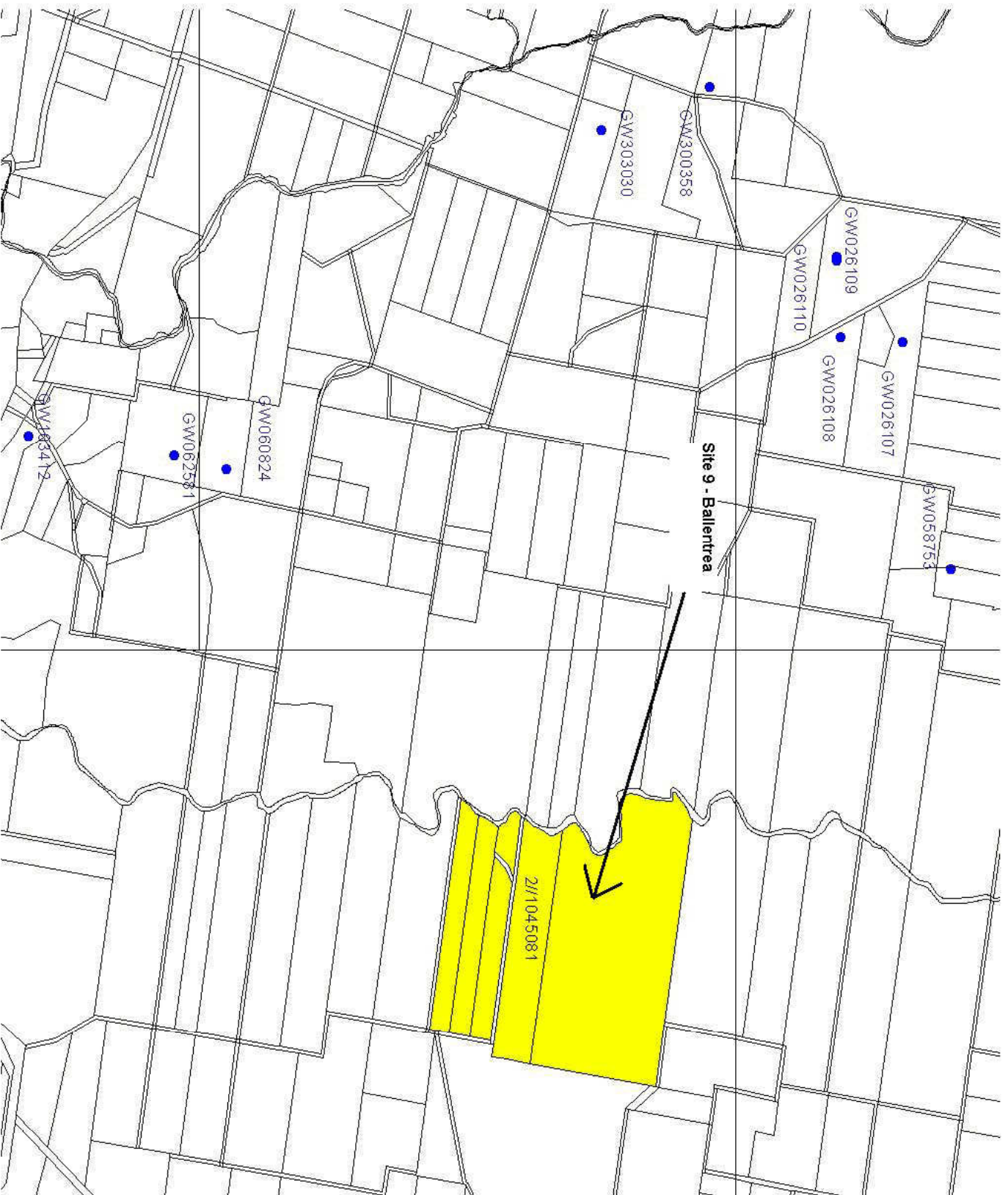

Date/Time :31-Oct-2003 01:05 PM
 User :GUEST
 Report :RMGW001D.QRP
 Executable :S:\G5\PROD32\Ground.exe
 Exe Date :29-Nov-2002
 System :Groundwater
 Database :Dlwcp



DEPARTMENT OF INFRASTRUCTURE, PLANNING AND NATURAL RESOURCES

Work Summary

GW026107

Converted From HYDSYS

License :30BL016202

Work Type :Bore
 Work Status :(Unknown)
 Construct. Method :Rotary
 Owner Type :Private

Authorised Purpose(s)
 DOMESTIC
 STOCK

Intended Purpose(s)
 DOMESTIC
 STOCK

Commenced Date : Final Depth : 24.40 m
 Completion Date :01-Sep-1965 Drilled Depth : 24.40 m

Contractor Name :
 Driller :

Property : - GERRA
 GWMA : -
 GW Zone : -

Standing Water Level :
 Salinity : (Unknown)
 Yield :

Site Details

Site Chosen By

County
 Form A :SANDON
 Licensed :SANDON

Parish
 GARA
 GARA

Portion/Lot DP
 78
 LT DP

Region :30 - NORTH COAST
 River Basin :206 - MACLEAY RIVER
 Area / District :

CMA Map :9237-3S
 Grid Zone :56/1

DUMARESQ
 Scale :1:25,000

Elevation :
 Elevation Source :(Unknown)

Northing :6626195
 Easting :378291

Latitude (S) :30° 29' 25"
 Longitude (E) :151° 43' 55"

GS Map :0029C2 AMG Zone :56

Coordinate Source :GD.,ACC.MAP

Construction

Negative depths indicate Above Ground Level;H-Hole;P-Pipe;OD-Outside Diameter;ID-Inside Diameter;C-Cemented;SL-Slot Length;A-Aperture;GS-Grain Size;Q-Quantity

H	P	Component	Type	From (m)	To (m)	OD (mm)	ID (mm)	Interval	Details
---	---	-----------	------	----------	--------	---------	---------	----------	---------

(No Construction Details Found)

Water Bearing Zones

From (m)	To (m)	Thickness (m)	WBZ Type	S.W.L. (m)	D.D.L. (m)	Yield (L/s)	Hole Depth (m)	Duration (hr)	Salinity (mg/L)
----------	--------	---------------	----------	------------	------------	-------------	----------------	---------------	-----------------

(No Water Bearing Zone Details Found)

Drillers Log

From (m)	To (m)	Thickness(m)	Drillers Description	Geological Material	Comments
0.00	0.91	0.91	Clay Gravel		
0.91	24.38	23.47	Sediment Silurian	Sediment	
0.91	24.38	23.47	Heavy Metamorphosed		

Remarks

*** End of GW026107 ***

DEPARTMENT OF INFRASTRUCTURE, PLANNING AND NATURAL RESOURCES

Work Summary

GW026108

Converted From HYDSYS

License :30BL019584	Authorised Purpose(s) STOCK	Intended Purpose(s) STOCK
Work Type :Bore		
Work Status :(Unknown)		
Construct. Method :Rotary		
Owner Type :Private		
Commenced Date :	Final Depth : 36.60 m	
Completion Date :01-Sep-1965	Drilled Depth : 36.60 m	
Contractor Name :		
Driller :		
Property : - GIRRA	Standing Water Level :	
GWMA : -	Salinity :	(Unknown)
GW Zone : -	Yield :	

Site Details

Site Chosen By	County Form A :SANDON Licensed :SANDON	Parish GARA GARA	Portion/Lot DP 79 LT DP
Region :30 - NORTH COAST		CMA Map :9237-3S	DUMARESQ
River Basin :206 - MACLEAY RIVER		Grid Zone :56/1	Scale :1:25,000
Area / District :			
Elevation :		Northing :6625785	Latitude (S) :30° 29' 38"
Elevation Source :(Unknown)		Easting :378280	Longitude (E) :151° 43' 54"
GS Map :0029C2	AMG Zone :56	Coordinate Source :GD.,ACC.MAP	

Construction Negative depths indicate Above Ground Level;H-Hole;P-Pipe;OD-Outside Diameter;ID-Inside Diameter;C-Cemented;SL-Slot Length;A-Aperture;GS-Grain Size;Q-Quantity

H P Component Type	From (m)	To (m)	OD (mm)	ID (mm)	Interval	Details
<i>(No Construction Details Found)</i>						

Water Bearing Zones

From (m)	To (m)	Thickness (m)	WBZ Type	S.W.L. (m)	D.D.L. (m)	Yield (L/s)	Hole Depth (m)	Duration (hr)	Salinity (mg/L)
<i>(No Water Bearing Zone Details Found)</i>									

Drillers Log

From (m)	To (m)	Thickness(m)	Drillers Description	Geological Material	Comments
0.00	0.91	0.91	Clay Gravel		
0.91	36.58	35.67	Sediment Metamorphosed	Silurian	

Remarks

*** End of GW026108 ***

DEPARTMENT OF INFRASTRUCTURE, PLANNING AND NATURAL RESOURCES

Work Summary

GW026109

Converted From HYDSYS

License :30BL019585	Authorised Purpose(s) STOCK	Intended Purpose(s) STOCK
Work Type :Bore		
Work Status :(Unknown)		
Construct. Method :Rotary		
Owner Type :Private		
Commenced Date :	Final Depth :	15.20 m
Completion Date :01-Sep-1965	Drilled Depth :	15.20 m
Contractor Name :		
Driller :		
Property : - GIRRA	Standing Water Level :	
GWMA : -	Salinity :	(Unknown)
GW Zone : -	Yield :	

Site Details

Site Chosen By	County Form A :SANDON Licensed :SANDON	Parish GARA GARA	Portion/Lot DP 80 LT DP
Region :30 - NORTH COAST		CMA Map :9237-3S	DUMARESQ
River Basin :206 - MACLEAY RIVER		Grid Zone :56/1	Scale :1:25,000
Area / District :			
Elevation :		Northing :6625753	Latitude (S) :30° 29' 39"
Elevation Source :(Unknown)		Easting :377852	Longitude (E) :151° 43' 38"
GS Map :0029C2	AMG Zone :56	Coordinate Source :GD.,ACC.MAP	

Construction

Negative depths indicate Above Ground Level;H-Hole;P-Pipe;OD-Outside Diameter;ID-Inside Diameter;C-Cemented;SL-Slot Length;A-Aperture;GS-Grain Size;Q-Quantity

H	P	Component	Type	From (m)	To (m)	OD (mm)	ID (mm)	Interval	Details
<i>(No Construction Details Found)</i>									

Water Bearing Zones

From (m)	To (m)	Thickness (m)	WBZ Type	S.W.L. (m)	D.D.L. (m)	Yield (L/s)	Hole Depth (m)	Duration (hr)	Salinity (mg/L)
<i>(No Water Bearing Zone Details Found)</i>									

Drillers Log

From (m)	To (m)	Thickness(m)	Drillers Description	Geological Material	Comments
0.00	0.91	0.91	Clay Gravel		
0.91	15.24	14.33	Sediment Metamorphosed	Silurian	

Remarks

*** End of GW026109 ***

DEPARTMENT OF INFRASTRUCTURE, PLANNING AND NATURAL RESOURCES

Work Summary

GW026110

Converted From HYDSYS

License :30BL019586	Authorised Purpose(s) STOCK	Intended Purpose(s) STOCK
Work Type :Bore		
Work Status :(Unknown)		
Construct. Method :Rotary		
Owner Type :Private		
Commenced Date :	Final Depth : 9.10 m	
Completion Date :01-Sep-1965	Drilled Depth : 9.10 m	
Contractor Name :		
Driller :		
Property : - GIRRA	Standing Water Level :	
GWMA : -	Salinity :	(Unknown)
GW Zone : -	Yield :	

Site Details

Site Chosen By	County Form A :SANDON Licensed :SANDON	Parish GARA GARA	Portion/Lot DP 80 LT DP
Region :30 - NORTH COAST		CMA Map :9237-3S	DUMARESQ
River Basin :206 - MACLEAY RIVER		Grid Zone :56/1	Scale :1:25,000
Area / District :			
Elevation :		Northing :6625756	Latitude (S) :30° 29' 39"
Elevation Source :(Unknown)		Easting :377816	Longitude (E) :151° 43' 37"
GS Map :0029C2	AMG Zone :56	Coordinate Source :GD.,ACC.MAP	

Construction Negative depths indicate Above Ground Level;H-Hole;P-Pipe;OD-Outside Diameter;ID-Inside Diameter;C-Cemented;SL-Slot Length;A-Aperture;GS-Grain Size;Q-Quantity

H P Component Type	From (m)	To (m)	OD (mm)	ID (mm)	Interval	Details
<i>(No Construction Details Found)</i>						

Water Bearing Zones

From (m)	To (m)	Thickness (m)	WBZ Type	S.W.L. (m)	D.D.L. (m)	Yield (L/s)	Hole Depth (m)	Duration (hr)	Salinity (mg/L)
<i>(No Water Bearing Zone Details Found)</i>									

Drillers Log

From (m)	To (m)	Thickness(m)	Drillers Description	Geological Material	Comments
0.00	0.91	0.91	Clay Gravel		
0.91	9.14	8.23	Sediment Metamorphosed	Silurian	

Remarks

*** End of GW026110 ***

DEPARTMENT OF INFRASTRUCTURE, PLANNING AND NATURAL RESOURCES

Work Summary

GW058753

Converted From HYDSYS

License :30BL130377	Authorised Purpose(s) DOMESTIC STOCK	Intended Purpose(s) DOMESTIC STOCK
Work Type :Bore		
Work Status :(Unknown)		
Construct. Method :Rotary Air		
Owner Type :Private		
Commenced Date :	Final Depth : 73.10 m	
Completion Date :01-Dec-1980	Drilled Depth : 73.10 m	
Contractor Name :		
Driller :		
Property :	Standing Water Level :	
GWMA : -	Salinity :	Fair
GW Zone : -	Yield :	

Site Details

Site Chosen By	County Form A :SANDON Licensed :SANDON	Parish DONALD DONALD	Portion/Lot DP 99 99
Region :30 - NORTH COAST		CMA Map :9237-3S	DUMARESQ
River Basin :206 - MACLEAY RIVER		Grid Zone :56/1	Scale :1:25,000
Area / District :			
Elevation :		Northing :6626500	Latitude (S) :30° 29' 15"
Elevation Source :(Unknown)		Easting :379585	Longitude (E) :151° 44' 43"
GS Map :0029C2	AMG Zone :56	Coordinate Source :GD.,ACC.MAP	

Construction

Negative depths indicate Above Ground Level;H-Hole;P-Pipe;OD-Outside Diameter;ID-Inside Diameter;C-Cemented;SL-Slot Length;A-Aperture;GS-Grain Size;Q-Quantity

H	P	Component	Type	From (m)	To (m)	OD (mm)	ID (mm)	Interval	Details
<i>(No Construction Details Found)</i>									

Water Bearing Zones

From (m)	To (m)	Thickness (m)	WBZ Type	S.W.L. (m)	D.D.L. (m)	Yield (L/s)	Hole Depth (m)	Duration (hr)	Salinity (mg/L)
66.80	67.20	0.40	Unconsolidated	60.00		0.68			Fair

Drillers Log

From (m)	To (m)	Thickness(m)	Drillers Description	Geological Material	Comments
0.00	0.10	0.10	Topsoil		
0.10	17.50	17.40	Clay Dry	Clay	
17.50	17.80	0.30	Sand Red	Sand	
17.80	22.50	4.70	Clay Dry	Clay	
22.50	22.60	0.10	Sand Red	Sand	
22.60	59.30	36.70	Clay Dry	Clay	
59.30	60.90	1.60	Clay Fine	Clay	
60.90	61.10	0.20	Shale Black	Shale	
61.10	62.40	1.30	Clay Fine	Clay	
62.40	62.60	0.20	Shale Black	Shale	
62.60	65.40	2.80	Clay Fine	Clay	
65.40	65.70	0.30	Shale Black	Shale	
65.70	67.90	2.20	Clay Fine Water Supply	Clay	
67.90	68.60	0.70	Shale Black	Shale	
68.60	73.10	4.50	Granite Hard	Granite	

Remarks

*** End of GW058753 ***

DEPARTMENT OF INFRASTRUCTURE, PLANNING AND NATURAL RESOURCES

Work Summary

GW060824

Converted From HYDSYS

License :30BL132172		
Work Type :Bore open thru rock	Authorised Purpose(s) DOMESTIC	Intended Purpose(s) DOMESTIC
Work Status :(Unknown)	STOCK	STOCK
Construct. Method :Rotary Air		
Owner Type :Private		
Commenced Date :	Final Depth : 54.90 m	
Completion Date :01-Mar-1985	Drilled Depth : 54.90 m	
Contractor Name :		
Driller :		
Property :	Standing Water Level :	
GWMA : -	Salinity :	501-1000 ppm
GW Zone : -	Yield :	

Site Details

Site Chosen By	County Form A :SANDON Licensed :SANDON	Parish GARA GARA	Portion/Lot DP L2 DP527565 (99) LT 2 DP 527565
Region :30 - NORTH COAST		CMA Map :9236-4N	ARMIDALE
River Basin :206 - MACLEAY RIVER		Grid Zone :56/1	Scale :1:25,000
Area / District :			
Elevation :		Northing :6621825	Latitude (S) :30° 31' 47"
Elevation Source :(Unknown)		Easting :379055	Longitude (E) :151° 44' 22"
GS Map :0029C3	AMG Zone :56	Coordinate Source :GD.,ACC.MAP	

Construction

Negative depths indicate Above Ground Level;H-Hole;P-Pipe;OD-Outside Diameter;ID-Inside Diameter;C-Cemented;SL-Slot Length;A-Aperture;GS-Grain Size;Q-Quantity

H	P	Component	Type	From (m)	To (m)	OD (mm)	ID (mm)	Interval	Details
1	1	Casing	Threaded Steel	0.00	11.40	152			Seated

Water Bearing Zones

From (m)	To (m)	Thickness (m)	WBZ Type	S.W.L. (m)	D.D.L. (m)	Yield (L/s)	Hole Depth (m)	Duration (hr)	Salinity (mg/L)
46.00	54.80	8.80	(Unknown)	40.20		0.19			501-1000 ppm

Drillers Log

From (m)	To (m)	Thickness(m)	Drillers Description	Geological Material	Comments
0.00	0.09	0.09	Topsoil		
0.09	11.28	11.19	Clay	Clay	
11.28	18.59	7.31	Rock Decomposed	Rock	
18.59	46.02	27.43	Basalt	Basalt	
46.02	46.63	0.61	Clay Sedimentary Water Supply	Clay	
46.63	54.86	8.23	Clay Layers Water Supply	Clay	
46.63	54.86	8.23	Basalt Hard	Basalt	

Remarks

*** End of GW060824 ***

DEPARTMENT OF INFRASTRUCTURE, PLANNING AND NATURAL RESOURCES

Work Summary

GW062581

Converted From HYDSYS

License :30BL134330	Authorised Purpose(s) DOMESTIC STOCK	Intended Purpose(s) DOMESTIC STOCK
Work Type :Bore		
Work Status :(Unknown)		
Construct. Method :Rotary Air		
Owner Type :Private		
Commenced Date :	Final Depth : 47.50 m	
Completion Date :01-Jun-1986	Drilled Depth : 47.50 m	
Contractor Name :		
Driller :1417	STRUDWICK, Garry Stanley	
Property :	Standing Water Level :	
GWMA : -	Salinity :	1001-3000 ppm
GW Zone : -	Yield :	

Site Details

Site Chosen By	County Form A :SANDON Licensed :SANDON	Parish GARA GARA	Portion/Lot DP 97 97
Region :30 - NORTH COAST		CMA Map :9236-4N	ARMIDALE
River Basin :206 - MACLEAY RIVER		Grid Zone :56/1	Scale :1:25,000
Area / District :			
Elevation :		Northing :6621487	Latitude (S) :30° 31' 58"
Elevation Source :(Unknown)		Easting :379000	Longitude (E) :151° 44' 19"
GS Map :0029C3	AMG Zone :56	Coordinate Source :GD.,ACC.MAP	

Construction

Negative depths indicate Above Ground Level;H-Hole;P-Pipe;OD-Outside Diameter;ID-Inside Diameter;C-Cemented;SL-Slot Length;A-Aperture;GS-Grain Size;Q-Quantity

H	P	Component	Type	From (m)	To (m)	OD (mm)	ID (mm)	Interval	Details
1	1	Casing	P.V.C.	0.00	47.50	152			Seated on Bottom

Water Bearing Zones

From (m)	To (m)	Thickness (m)	WBZ Type	S.W.L. (m)	D.D.L. (m)	Yield (L/s)	Hole Depth (m)	Duration (hr)	Salinity (mg/L)
27.40	28.30	0.90	Fractured			0.25			1001-3000 ppm
43.90	47.50	3.60	Fractured	24.50		2.25			1001-3000 ppm

Drillers Log

From (m)	To (m)	Thickness(m)	Drillers Description	Geological Material	Comments
0.00	4.00	4.00	Soil Trap		
4.00	10.00	6.00	Rock Trap	Rock	
10.00	47.50	37.50	Granite Black Water Supply	Granite	

Remarks

CONDUCTIVITY = 1800

*** End of GW062581 ***

DEPARTMENT OF INFRASTRUCTURE, PLANNING AND NATURAL RESOURCES

Work Summary

GW103412

License :30BL177194	Authorised Purpose(s) DOMESTIC STOCK	Intended Purpose(s) DOMESTIC STOCK
Work Type :Bore		
Work Status :(Unknown)		
Construct. Method :		
Owner Type :		
Commenced Date :	Final Depth : 60.00 m	
Completion Date :31-Dec-1995	Drilled Depth :	
Contractor Name :TANNER DRILLING		
Driller :		
Property : - " RAYENDA "	Standing Water Level :	
GWMA : -	Salinity :	
GW Zone : -	Yield :	0.25 L/s

Site Details

Site Chosen By	County Form A :SANDON Licensed :SANDON	Parish GARA GARA	Portion/Lot DP LOT 4 DP838032 LT 4 DP 838032
Region :30 - NORTH COAST		CMA Map :	
River Basin :		Grid Zone :	Scale :
Area / District :			
Elevation :		Northing :6620551	Latitude (S) :30° 32' 28"
Elevation Source :		Easting :378895	Longitude (E) :151° 44' 15"
GS Map :	AMG Zone :56	Coordinate Source :Map Interpretation	

Construction

Negative depths indicate Above Ground Level;H-Hole;P-Pipe;OD-Outside Diameter;ID-Inside Diameter;C-Cemented;SL-Slot Length;A-Aperture;GS-Grain Size;Q-Quantity

H	P	Component	Type	From (m)	To (m)	OD (mm)	ID (mm)	Interval	Details
1		Hole	Hole	0.00	60.00	100			

Water Bearing Zones

From (m)	To (m)	Thickness (m)	WBZ Type	S.W.L. (m)	D.D.L. (m)	Yield (L/s)	Hole Depth (m)	Duration (hr)	Salinity (mg/L)
----------	--------	---------------	----------	------------	------------	-------------	----------------	---------------	-----------------

(No Water Bearing Zone Details Found)

Drillers Log

From (m)	To (m)	Thickness(m)	Drillers Description	Geological Material	Comments
----------	--------	--------------	----------------------	---------------------	----------

Remarks

Form A Remarks:
Tanner the driller came from Coff's Harbour. No further details. Mr Tanner sent all relevant details to Land and Water Conservation.

*** End of GW103412 ***

DEPARTMENT OF INFRASTRUCTURE, PLANNING AND NATURAL RESOURCES

Work Summary

GW300358

License :30BL145109	Authorised Purpose(s) DOMESTIC	Intended Purpose(s) DOMESTIC
Work Type :Bore		
Work Status :(Unknown)		
Construct. Method :(Unknown)		
Owner Type :Private		
Commenced Date :	Final Depth : 44.00 m	
Completion Date :	Drilled Depth :	
Contractor Name :		
Driller :	, Driller Unknown	
Property :	Standing Water Level :	
GWMA : -	Salinity :	
GW Zone : -	Yield :	

Site Details

Site Chosen By	County Form A : Licensed :SANDON	Parish GARA	Portion/Lot DP LT 92 DP 755826
Region :30 - NORTH COAST		CMA Map :	
River Basin :206 - MACLEAY RIVER		Grid Zone :	Scale :
Area / District :			
Elevation :		Northing :6624925	Latitude (S) :30° 30' 6"
Elevation Source :		Easting :376885	Longitude (E) :151° 43' 1"
GS Map :	AMG Zone :56	Coordinate Source :Map Interpretation	

Construction

Negative depths indicate Above Ground Level;H-Hole;P-Pipe;OD-Outside Diameter;ID-Inside Diameter;C-Cemented;SL-Slot Length;A-Aperture;GS-Grain Size;Q-Quantity

H	P	Component	Type	From (m)	To (m)	OD (mm)	ID (mm)	Interval	Details
1		Hole	Hole	0.00	1.00				(Unknown)

Water Bearing Zones

From (m)	To (m)	Thickness (m)	WBZ Type	S.W.L. (m)	D.D.L. (m)	Yield (L/s)	Hole Depth (m)	Duration (hr)	Salinity (mg/L)
0.00	44.00	44.00		11.00					

Drillers Log

From (m)	To (m)	Thickness(m)	Drillers Description	Geological Material	Comments
----------	--------	--------------	----------------------	---------------------	----------

Remarks

*** End of GW300358 ***

DEPARTMENT OF INFRASTRUCTURE, PLANNING AND NATURAL RESOURCES

Work Summary

GW303030

License :30BL179504	Authorised Purpose(s) DOMESTIC STOCK	Intended Purpose(s) DOMESTIC STOCK
Work Type :Bore		
Work Status :		
Construct. Method :Rotary		
Owner Type :		
Commenced Date :	Final Depth : 54.87 m	
Completion Date :06-Sep-2001	Drilled Depth : 54.87 m	
Contractor Name :DRILLWELL CONST		
Driller :1493 LINTON, Alec		
Property : - " PART JUNCTION VIEW "	Standing Water Level :	23.40 m
GWMA : -	Salinity :	
GW Zone : -	Yield :	0.50 L/s

Site Details

Site Chosen By	County Form A :SANDON Licensed :SANDON	Parish GARA GARA	Portion/Lot DP LT 1 DP 755826 LT 1 DP 755826
Region :30 - NORTH COAST		CMA Map :	
River Basin :		Grid Zone :	Scale :
Area / District :			
Elevation :		Northing :6624226	Latitude (S) :30° 30' 28"
Elevation Source :		Easting :377131	Longitude (E) :151° 43' 10"
GS Map :	AMG Zone :56	Coordinate Source :	

Construction

Negative depths indicate Above Ground Level;H-Hole;P-Pipe;OD-Outside Diameter;ID-Inside Diameter;C-Cemented;SL-Slot Length;A-Aperture;GS-Grain Size;Q-Quantity

H	P	Component	Type	From (m)	To (m)	OD (mm)	ID (mm)	Interval	Details
1		Hole	Hole	0.00	54.87	160			Rotary Air
1	1	Casing	Steel	-0.06	3.00	160	150.8		Driven into Hole
1	1	Casing	PVC Class 9	-0.06	54.87	140			Glued; Seated on Bottom
1	1	Opening	Slots - Vertical	36.87	54.87	140			PVC Class 9; Sawn; SL: 18mm; A: 4mm

Water Bearing Zones

From (m)	To (m)	Thickness (m)	WBZ Type	S.W.L. (m)	D.D.L. (m)	Yield (L/s)	Hole Depth (m)	Duration (hr)	Salinity (mg/L)
51.20	51.40	0.20		23.40		0.50	54.87		

Drillers Log

From (m)	To (m)	Thickness(m)	Drillers Description	Geological Material	Comments
0.00	0.30	0.30	Surface soil		
0.30	3.57	3.27	Yellow Clay	Yellow Clay Bands	
3.57	6.70	3.13	Blue Shale	Blue Streaks	
6.70	8.23	1.53	Badly Broken Shale	Broken	
8.23	19.20	10.97	Blue Basalt	Blue Bands	
19.20	25.50	6.30	Badly Broken Basalt	Broken	
25.50	54.87	29.37	Blue Basalt	Blue Bands	

Remarks

*** End of GW303030 ***

*** End of Report ***