

THIS DRAWING IS FOR COUNCIL APPROVAL PURPOSES ONLY. IT SHALL NOT BE USED FOR CONSTRUCTION. THIS DRAWING IS COPYRIGHT AND CANNOT BE REPRODUCED IN WHOLE OR IN PART OR BY ANY MEANS WITHOUT THE WRITTEN PERMISSION OF BILLBERGIA DESIGN PTY LTD.

DRAWINGS PREPARED BY  
**BILLBERGIA design PTY LTD**  
**BILLBERGIA GROUP**  
SUITE 101, 25 ANGLAS ST, MEADOWBANK NSW 2114  
HONORABLE ARCHITECT: BEN MICHELL (REG. NO. 6339)

CONSULTANTS AND ENGINEERS  
TYPICAL CONSULTANTS AND ENGINEERS  
IN ASSOCIATION WITH  
THE DESIGN DEVELOPMENT ARCHITECTS  
CONSULTANTS HAVE BEEN PREPARED BY  
**BILLBERGIA DESIGN PTY LTD**

NO.	DESCRIPTION	DATE	DESIGNED/APPROVED BY
1	ISSUED FOR PERMIT	13.11.08	TURNER AND ASSOCIATES
2	ISSUED FOR PERMIT	13.11.08	TURNER AND ASSOCIATES
3	ISSUED FOR PERMIT	13.11.08	TURNER AND ASSOCIATES
4	ISSUED FOR PERMIT	13.11.08	TURNER AND ASSOCIATES
5	PRELIMINARY 25% ISSUE	06.03.09	TURNER AND ASSOCIATES
6	SECTION 25% SUBMISSION 1	06.03.09	TURNER AND ASSOCIATES
7	SECTION 25% SUBMISSION 2	26.08.10	BILLBERGIA DESIGN PTY LTD

APPLICANT  
**DEVELOPMENT COMPANY PTY LTD**  
MEADOWBANK NSW 2114

PROJECT  
**SOP 3.1**

**PROPOSED DEVELOPMENT**  
SYDNEY OLYMPIC PARK  
STAGE 3 - SITE 1

SCALE  
**1:200 @ A1**    **1:400 @ A3**  
SCALE BAR  
0 2 4 6 8 10 12m

DRAWING TITLE  
**GROUND FLOOR LEVEL**  
PRINT DATE  
06.09.10  
PROJECT ID  
SOP3.1  
DRAWING NO.  
DA06  
ISSUE  
7

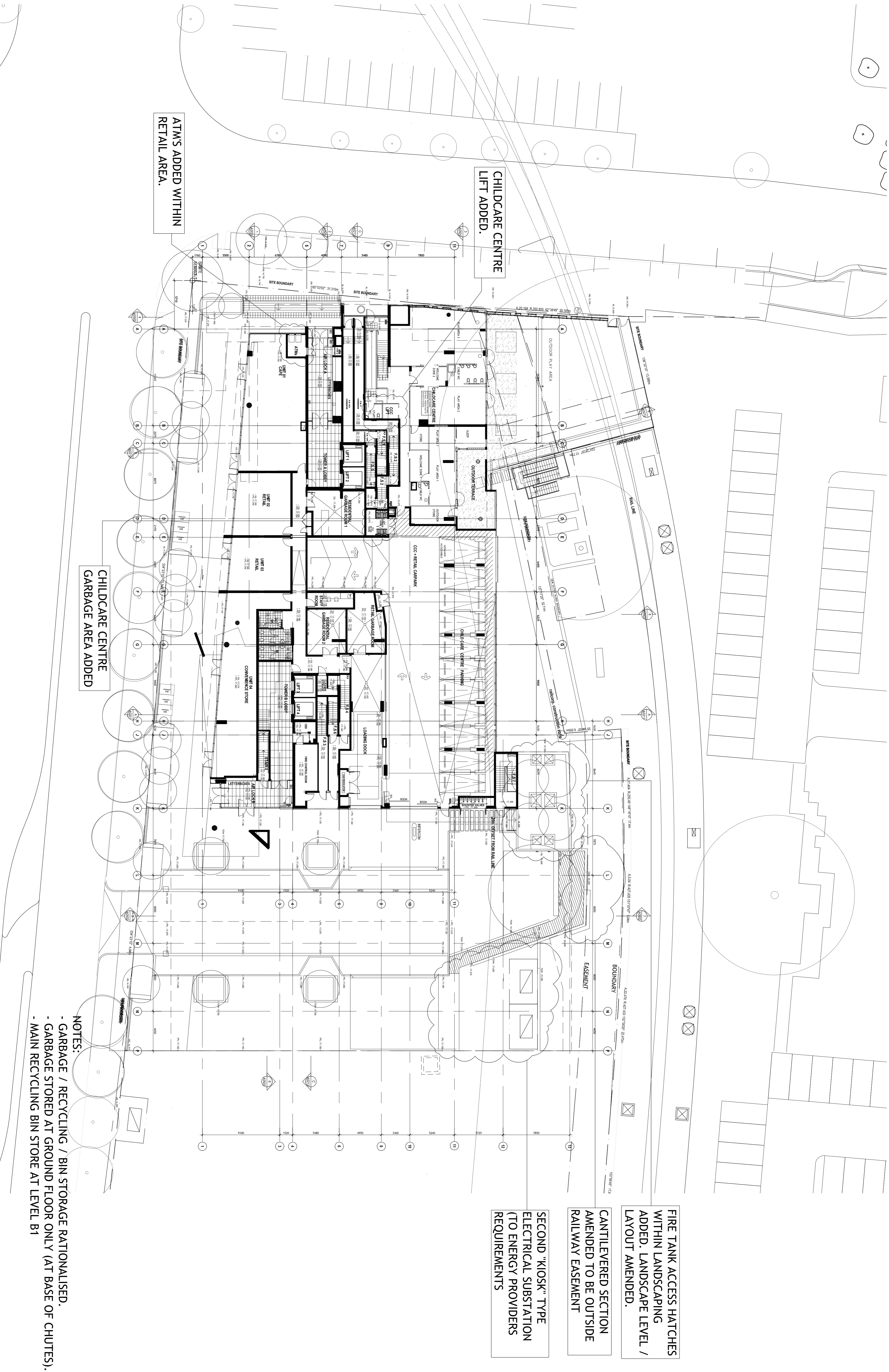

CHILD CARE CENTRE  
LIFT ADDED.

ATMS ADDED WITHIN  
RETAIL AREA.

CHILD CARE CENTRE  
GARBAGE AREA ADDED

- NOTES:
- GARBAGE / RECYCLING / BIN STORAGE RATIONALISED.
  - GARBAGE STORED AT GROUND FLOOR ONLY (AT BASE OF CHUTES).
  - MAIN RECYCLING BIN STORE AT LEVEL B1

SECOND "KIOSK" TYPE  
ELECTRICAL SUBSTATION  
(TO ENERGY PROVIDERS  
REQUIREMENTS)

CANTILEVERED SECTION  
AMENDED TO BE OUTSIDE  
RAILWAY EASEMENT

FIRE TANK ACCESS HATCHES  
WITHIN LANDSCAPING  
ADDED. LANDSCAPE LEVEL /  
LAYOUT AMENDED.