

RIVEROAKS Development Site

- Legend**
- 2 — Joint type 2 - Longitudinal, tied and formed
  - 7 — Joint type 7 - Transverse construction, tied and formed
  - 8 — Joint type 8 - Transverse construction, unadorned and induced
  - 14 — Joint type 14 - Isolation, with beam
  - TA — Joint type TA - Terminal anchor, subgrade beam
  - No base
  - ▨ Existing concrete slab
  - 1000 — Tiebar spacings - all tiebars N12 u.n.o.

This plan is NOT to be used for construction purposes unless it carries the approval stamp of the local authority.

Issue	Date	Description	App'd
A	5.3.07	Adjust to 2 lane entries on side roads	EE
		Amendment	

Client:  
**Rayshield Pty. Ltd.**

Project:  
**Riveroaks Development**  
**Pacific Highway**  
**Ballina**

Title:  
**Concrete Pavement**  
**Jointing Plan**

Do not scale drawing, use dimensions only  
This plan is copyright © 2006 Ardill Payne

**ARDILL PAYNE & PARTNERS**  
CONSULTING CIVIL AND STRUCTURAL ENGINEERS  
PROJECT MANAGERS TOWN PLANNERS AND SURVEYORS

79 Tamar Street  
P.O. Box 20  
BALLINA NSW 2478  
ABN: 113 951 522 12

Telephone: 02 6666 3280  
Facsimile: 02 6666 7920  
e-mail: info@ardillpayne.com.au  
Website: www.ardillpayne.com.au

Design	PB	Scale	A1	1:200
Drawn	PB	Drawn	AHD	
Date	28-06-06	File name	6316-plans	
Checked		Approval		
Job No.	<b>6316</b>	Draw. No.	<b>C5</b>	Issue
			(5 of 11)	<b>A</b>

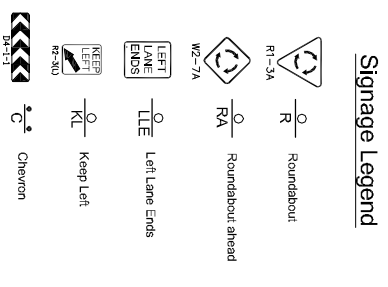
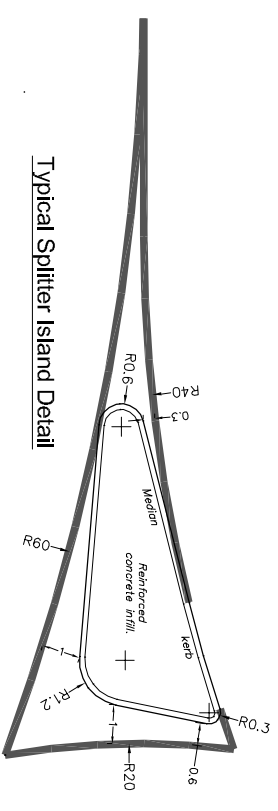
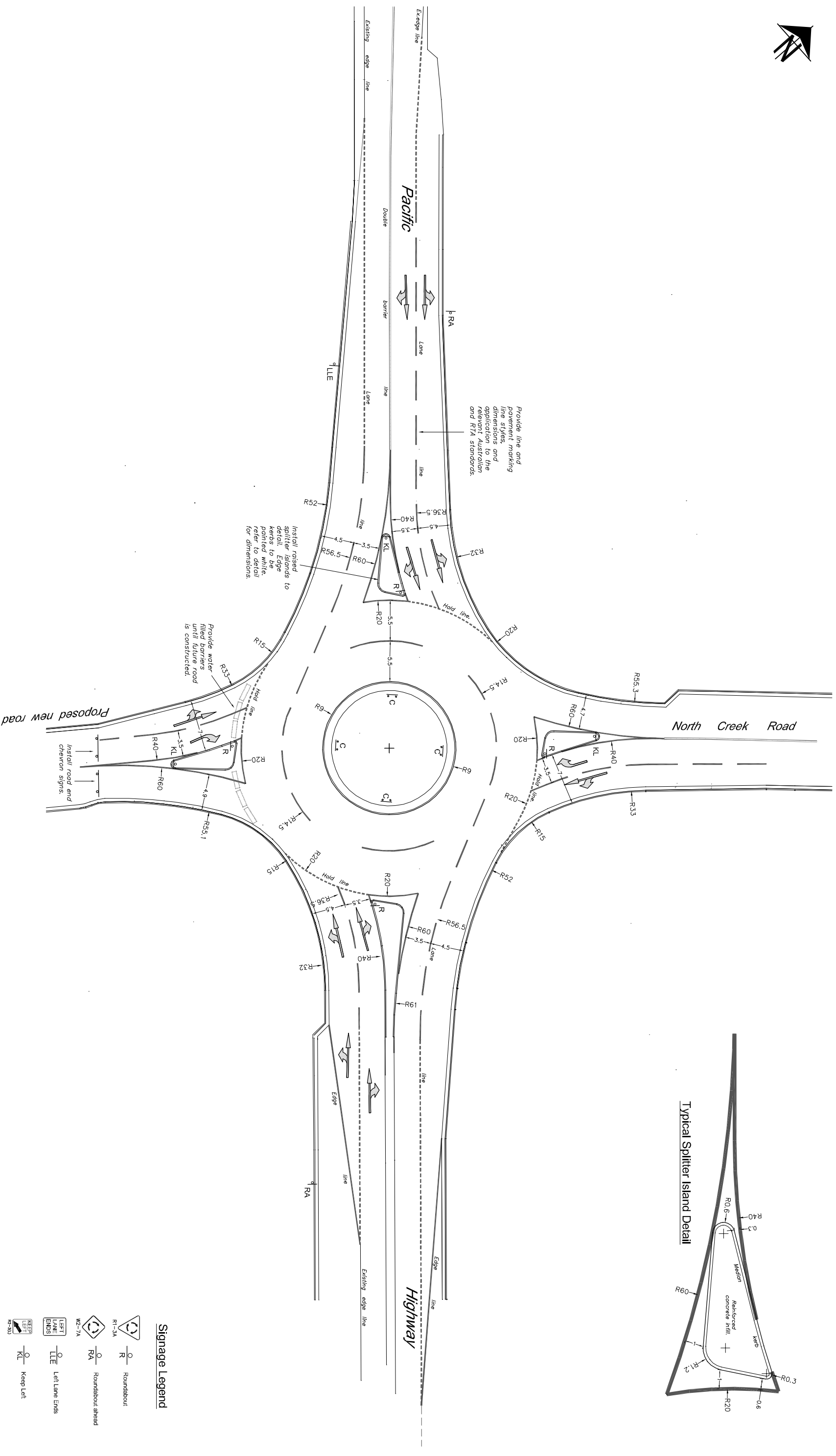

This plan is NOT to be used for construction purposes unless it carries the approval stamp of the local authority.

Issue	Date	Appr
A	5.3.07	EE
Adjust to 2 lane entries on side roads		
Amendment		

Client:  
**Rayshield Pty. Ltd.**

Project:  
**Riveroaks Development**  
Pacific Highway  
Ballina

Title:  
**Linemarking, Signage and Dimensions**

**ARDILL PAYNE & PARTNERS**  
CONSULTING CIVIL AND STRUCTURAL ENGINEERS  
PROJECT MANAGERS TOWN PLANNERS AND SURVEYORS

79 Tamar Street  
PO BOX 22  
BALLINA NSW 2478  
A.B.N. 113 861 622 12

Telephone: 02 6686 3280  
Facsimile: 02 6686 7320  
Email: [ardill@ardillpayne.com.au](mailto:ardill@ardillpayne.com.au)  
Website: [www.ardillpayne.com.au](http://www.ardillpayne.com.au)

Design	Scale at A1	1:250
Drawn	Drawn	AHD
Date	File name	6316-plans
28-06-06	Approved	
Checked	Issue	
6316	6 of 11	A

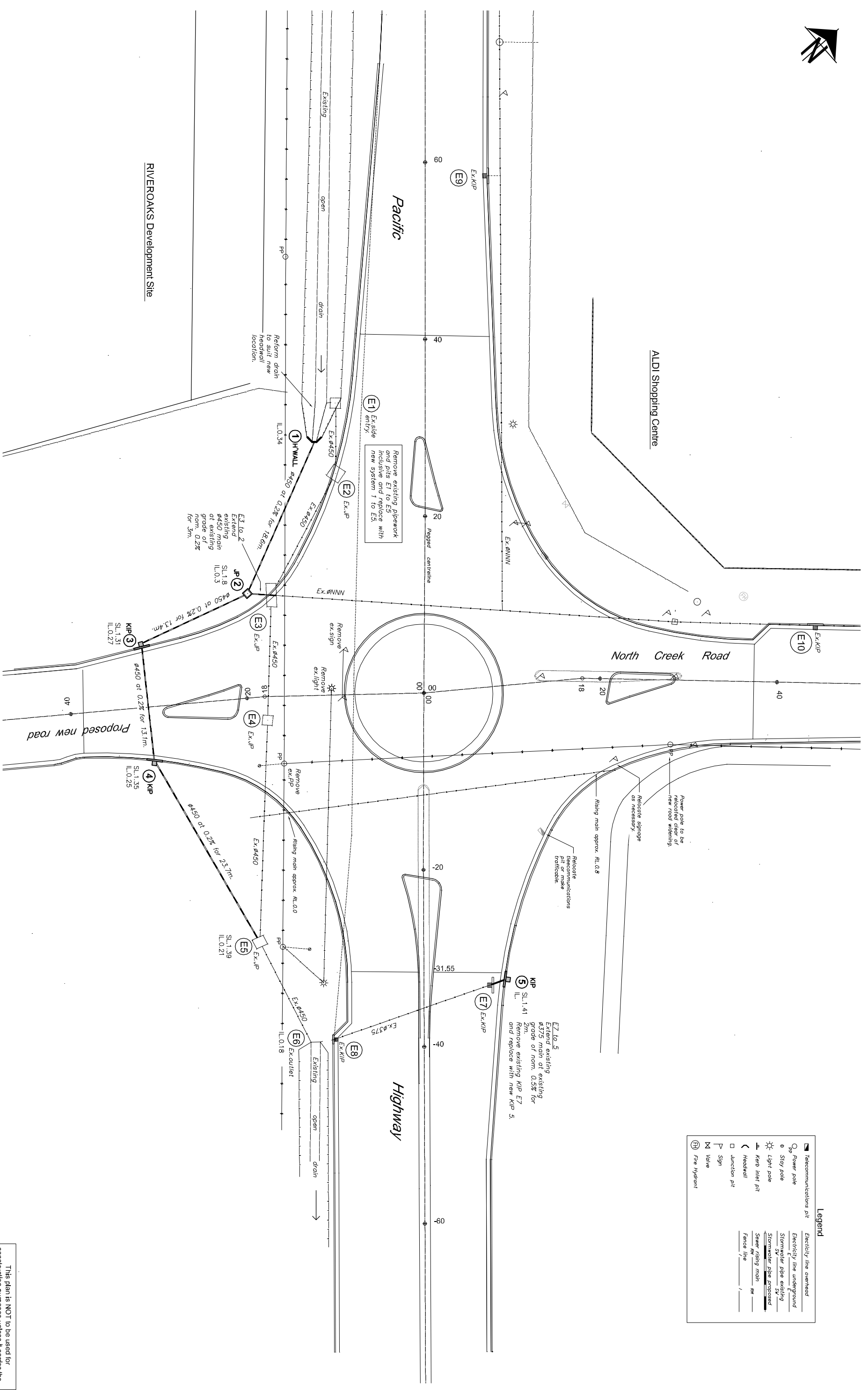

**Legend**

☐ Telecommunications pit	— Electricity line overhead
○ Power pole	— Electricity line underground
○ Stay pole	— Stormwater pipe existing
☼ Light pole	— Stormwater pipe proposed
▲ Kerb inlet pit	— Sewer rising man. RW
☐ Junction pit	— Fence line
☐ Sign	
☐ Valve	
Ⓜ Fire hydrant	

RIVEROAKS Development Site

ALDI Shopping Centre

North Creek Road

Highway

Issue	Date	Amendment	Appr
A	5.3.07	Adjust to 2 lane entries on side roads	EE

Client:  
**Rayshield Pty. Ltd.**

Project:  
**Riveroaks Development**  
Pacific Highway  
Ballina

Title:  
**Site Services Plan**

**ARDILL PAYNE & PARTNERS**  
CONSULTING CIVIL AND STRUCTURAL ENGINEERS  
PROJECT MANAGERS TOWN PLANNERS AND SURVEYORS  
79 Tamar Street  
P.O. Box 20  
BALLINA NSW 2478  
ABN: 112 851 522 12  
Telephone: 02 6666 5280  
Facsimile: 02 6666 7920  
Email: info@ardillpayne.com.au  
WebSite: www.ardillpayne.com.au

Design	PB	Scale	A1	1:200
Drawn	PB	Drawn	AHD	
Date	28-06-06	Figure	6316-plans	
Checked		Approved		
Job No.	<b>6316</b>	Draw. No.	<b>C7</b>	Issue
			(7 of 11)	<b>A</b>

This plan is NOT to be used for construction purposes unless it carries the approval stamp of the local authority.



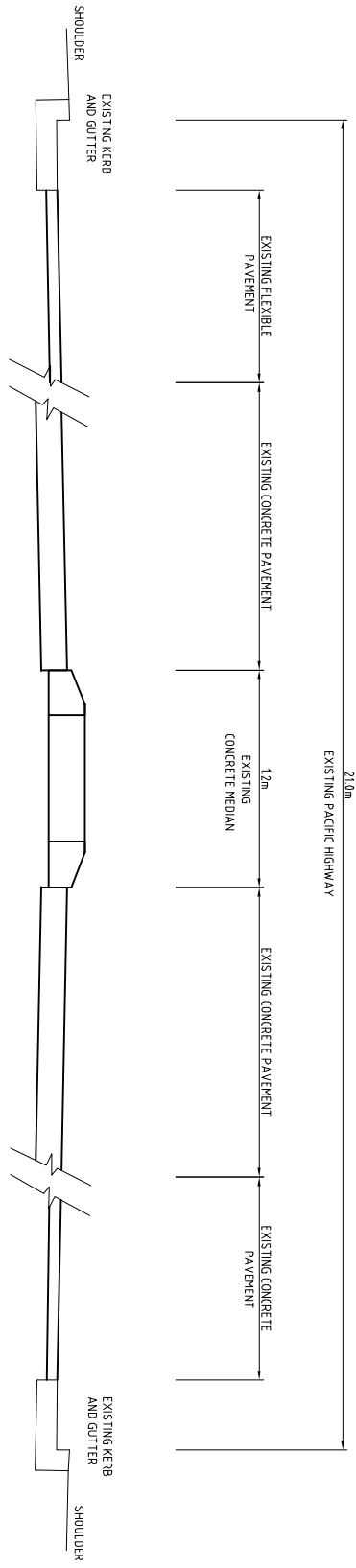

Typical Highway Section - Existing Ch.-60  
Section AA

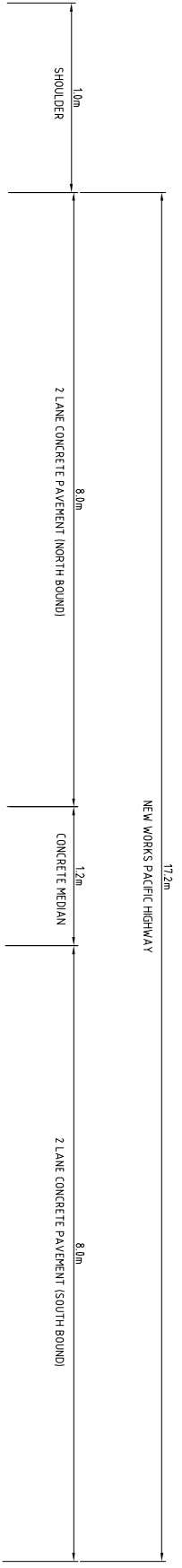

Typical Section BB

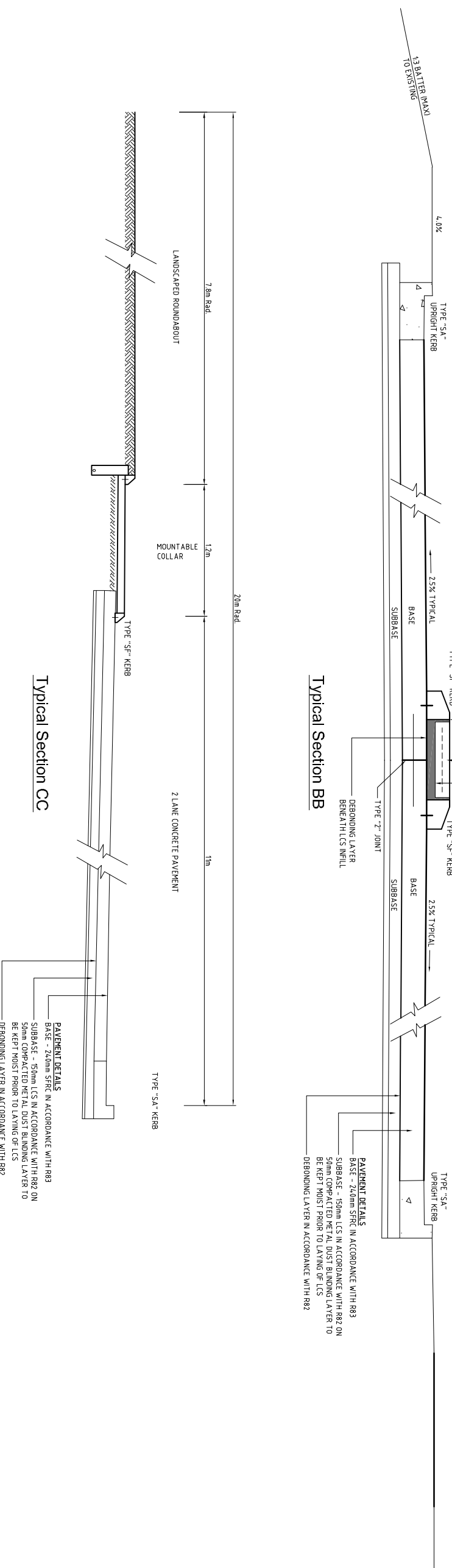

Typical Section CC

Issue	Date	Amendment
A	5.3.07	Adjust to 2 lane entries on side roads
		EE

Client:  
**Rayshield Pty. Ltd.**

Project:  
**Riveroaks Development  
Pacific Highway  
Ballina**

Title:  
**Construction Details 2**

**ARDILL PAYNE & PARTNERS**  
CONSULTING CIVIL AND STRUCTURAL ENGINEERS  
PROJECT MANAGERS TOWN PLANNERS AND SURVEYORS  
79 Tamar Street  
P.O. Box 20  
BALLINA NSW 2479  
ABN: 119 981 522 12  
Telephone: 02 6686 3280  
Facsimile: 02 6686 7920  
Email: [ardillpayne@ardillpayne.com.au](mailto:ardillpayne@ardillpayne.com.au)  
Website: [www.ardillpayne.com.au](http://www.ardillpayne.com.au)

Design	PB	Scale	A1
Drawn	PB	Drawn	AHD
Date	28-06-06	Figure	6316-details
Checked		Approved	
Job No.	6316	Draw. No.	C9 (9 of 11)
		Issue	A

This plan is NOT to be used for construction purposes unless it carries the approval stamp of the local authority.



**GENERAL NOTES:**

- G1. All works to be carried out in accordance with RTA standard specifications for engineering works, the RTA specification concrete roadwork Part 1 and the approved plans.
- G2. The Contractor shall verify the location and level of all existing services, regardless of what is shown on these drawings, prior to commencing construction and make arrangements with the Superintendent and the relevant authority to relocate or adjust if necessary.
- G3. The Contractor shall not enter upon nor do any work within adjacent lands without the written permission of the Superintendent.
- G4. The Contractor shall ensure that no nuisance or interference with the amenity of the area is created by reason of any process or operation during the work, causing the emission of noise, dust, smoke or any polluted discharge into the atmosphere, or any other nuisance, and all weather access at all times to adjacent and adjoining properties.
- G5. The Contractor shall dispose of any surplus excavated material as directed by the Superintendent.
- G6. The Contractor shall give notice to Council and the RTA in the required form of the commencement of work.
- G7. The Contractor shall observe requirements of the Occupational Health & Safety Act, the Environmental Planning and Assessment Act and any other Acts and Regulations pertaining to the works. The Principal and the Superintendent accept no responsibility for any fines or legal action that may be instigated by actions of the Contractor or Sub-Contractors.
- G8. The Contractor and their Sub-Contractor shall provide their "Site Work Method Statement" to the Superintendent for approval before the commencement of any works.
- G9. The Contractor should not carelessly that the site is surrounded by built assets of the Council and other service providers. The Contractor is fully responsible for the protection of these assets during construction. The Principal and Superintendent accept no responsibility for damage caused by the Contractor or their Sub-Contractors to these assets.
- G10. All work carried out in confined spaces is to be done by personnel specifically qualified for confined spaces work.
- G11. All works shall be performed in accordance with the Development Consent.

**CONSTRUCTION NOTES:**

- C1. All finished surfaces to be self draining.
- C2. All new works shall make a smooth junction/transition to existing. This includes the kerbs and concrete transitions that extend past the "End of Road Construction" limit shown on plans.
- C3. Existing services to be protected, supported and/or removed as required in accordance with the relevant authorities' specifications.
- C4. All existing service covers to be adjusted to new finished surfaces as required.
- C5. Contractor is to verify the location of all services prior to commencement of any work.
- C6. Install erosion control measures prior to commencement of earthworks and keep functional to end of project and the site has been stabilised.
- C7. Place 80mm min thick topsoil on all barriers and earthwork areas and grass without delay. 80% grass cover to be achieved by end of project.
- C8. Existing fences to be preserved, relocated and/or removed as directed by the Superintendent.
- C9. Contractor will be held responsible for damage to existing roads and other assets caused by construction equipment.
- C10. Surfaces of existing roads that are used as access by Contractor shall be kept free of obstruction materials, dirt and other foreign matter at all times.
- C11. The Contractor shall reinforce and/or make good any disturbed areas associated with the work to the satisfaction of the Superintendent.
- C12. The Contractor must contact "Dial Before You Dig" to ensure the services on site are located and co-ordinated with plant owners.
- C13. As a minimum, inspection by either the nominated RTA Road Surveillance Officer or the Engineer are required at the RTA specified hold points.

**CONCRETE NOTES:**

- 1. All workmanship and materials to be in accordance with RTA QA Specifications 882 and 883.

**WARNING NOTES:**

- A1. These plans are not to be used for construction unless they have been signed and approved by the RTA and Council.
- A2. A full set of approved plans and a copy of the relevant Development Consent and Construction Certificate are to be noted by the Contractor and is to be retained on site by the Contractor at all times when work is being carried out.
- A3. Set out dimensions of all drainage lines, centre lines, recovery marks and bench marks should be verified and confirmed by the Contractor and any discrepancies should be clarified in writing with the Superintendent prior to commencement of the work.
- A4. The contours shown on these plans are suitable only for the purposes of this design and may change with construction. No reliance should be placed upon such contours for any purpose other than for the purpose of these drawings.
- A5. Services on these plans were located where possible by field survey. If not able to be located, known services have been plotted from the records of relevant authorities where available and have been noted accordingly on these plans. Where such records either do not exist or are considered to be inadequate a notation has been made hereon. Prior to any reconstruction, excavation or construction on the site, the relevant authority should be contacted for possible location of further underground services and detailed locations of all services. No work should be undertaken until the location of all services is confirmed by the Contractor.
- A6. No sheet of these plans may be reproduced unless the reproduction includes these notes. These notes are an integral part of these plans.

**EROSION CONTROL:**

- E1. Erosion control works on the site shall be carried out in the following sequence:
  - Install barrier and silt fences
  - Strip and stociple topsoil
  - Under take site development works
  - Rehabilitate site, clean up and remove rubbish debris
  - Remove temporary soils and water management works once approved to do so by the RTA and Council
- E2. The principal strategy is:
  - Provide "Silt" fences, straw bale fences or soil berms downstream of all upstream disturbed areas to capture any sediment passing from the site.
  - Land disturbance shall be limited to that necessary for implementation of the plans of works. Buffer zones and lands not to be disturbed shall be clearly marked with barrier fences. "Silt" fences or straw bale sediment traps shall be placed immediately downstream of all unpermitted disturbed lands.
- E3. Temporary rehabilitation shall be undertaken on disturbed areas where works have stopped and soils are expected to remain exposed for more than one month. To approval of Superintendent.
- E4. The Contractor shall maintain daily all water and soil management devices.
- E5. Silt from trenches is to be placed on the uphill side of the trench. Unfinished Pipework is to be capped with a diaphragm of geotextile filter fabric at the end of each day or at the likely threat of rain.
- E6. Silt traps shall be installed at entry to kerb and gutter inlet pits. The Contractor shall be responsible for their maintenance during construction.
- E7. The location of "Silt" fences, barrier fences, sediment traps and other devices are indicative only and final locations shall be confirmed by the Superintendent. Variations are to be noted in the circumstances and construction progress.

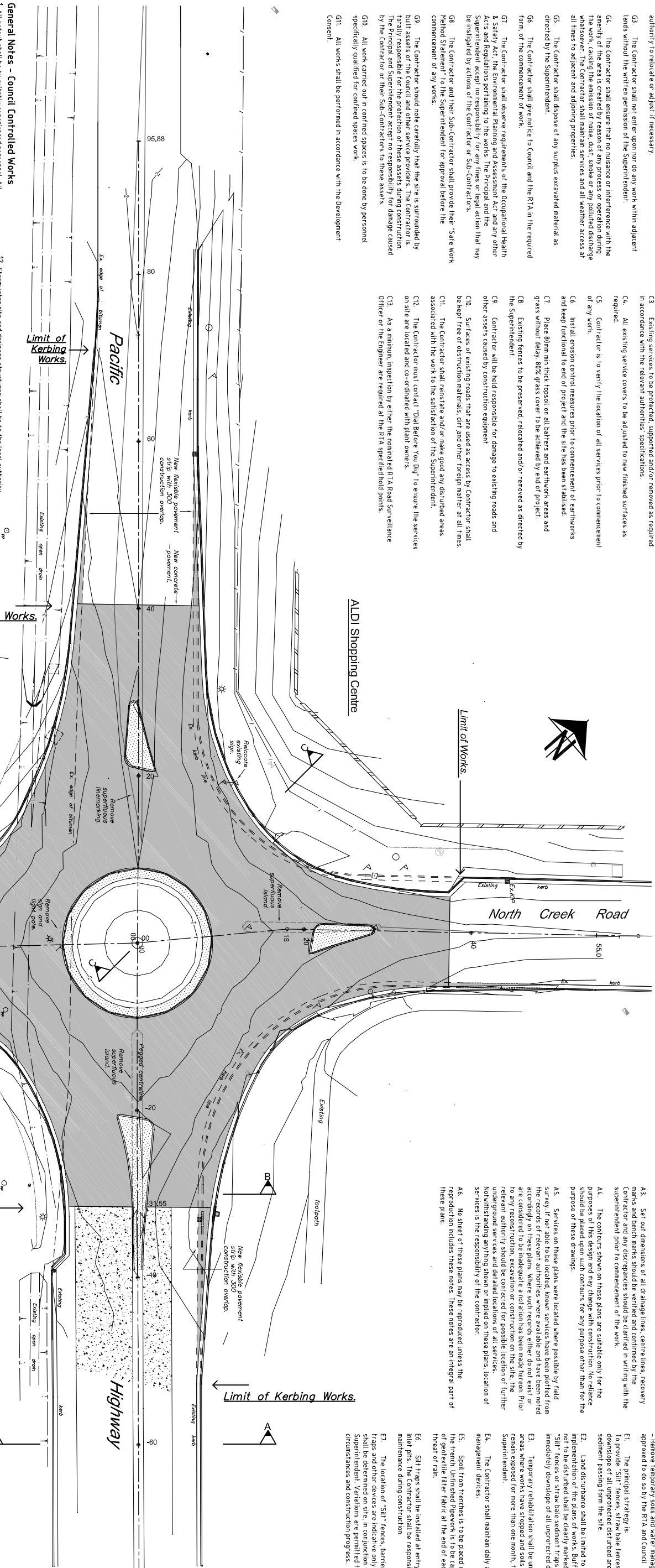

- General Notes - Council Controlled Works**
1. All work shall be by suitably experienced personnel. All works-as-executed plans shall be certified by a Registered Surveyor or Engineer.
  2. All dimensions are in metres unless noted otherwise.
  3. All levels are in metres unless noted otherwise.
  4. All levels shown are invert of kerb unless noted otherwise.
  5. Council inspection hold points of road pavement required at the following construction stages:
    - a) Box inspection of subgrade and proof roll.
    - b) Inspection of sub base gravels and proof roll prior to installation of kerb.
    - c) Inspection of base gravels and proof roll prior to sealing.
    - d) Any service crossings of road pavement.
  6. Inspections are organised by contacting Council's Development Engineer. Please note 24hours notice of inspection is required.
  7. Typical flexible road pavement to consist of:
    - 25mm AC 10 bottom seal
    - 150mm em. DGSD sub-base to RTA spec:3J51
    - 150mm em. DGSD base course to RTA spec:3J51
    - 150mm em. DGSD base course to RTA spec:3J51
  8. Density testing is to be carried out at max. 100m spacing or in accordance with Table 8.1 of AS 3798 - Guidelines on Earthworks for Commercial and Residential Development, whichever gives the greater frequency of testing. Compaction is to be to the following:
    - subgrade to 95% standard compaction;
    - sub-base gravels to 98% modified compaction;
    - base course gravels to 98% modified compaction;
  9. The gravel pavement shall extend full depth under, and 150 behind all kerbs.
  10. RC pipes of 900 dia or less shall be minimum class 7, rubber ring jointed, unless noted otherwise. FRC pipes are to be of an equivalent structural class to the RC pipes. LHD pipes may be PVC, FRC or RC (lubber ring jointed).
  11. Minimum cover to stormwater pipes shall be 150mm in landscape areas, and 600mm under road pavements, unless noted otherwise.

12. Stormwater pits and drainage structures shall be to the local authority standards and conform to AS 3500. Pits over 12m deep shall have galvanised steel floors at 300 c/c vertically and 225 c/c horizontally. Grates shall be cast iron class 'D' and bysize shall be in accordance with AS 3398.
13. Liner openings nominal size represent the minimum clear opening of the kerb inlet (ie 2.4m inlet = 2.4m clear opening).
14. The contractor is responsible for maintaining sufficient cover over stormwater and sewer mains during construction, and ensuring that trenches are correctly backfilled and compacted to eliminate damage caused by construction traffic.
15. General concrete works shall have the following properties:
  - a) Class of concrete shall be normal.
  - b) Maximum slump shall be 80mm.
  - c) Maximum aggregate size shall be 20mm.
  - d) Min 28 days concrete compressive strength shall be 25 Mpa including all kerbs up to
  - e) Concrete works shall conform to AS 3460
16. Lining and signage shall conform to AS 1742 Manual of Uniform Traffic Control Devices.
17. It is the responsibility of the contractor to ensure that adequate erosion and sedimentation control devices are erected and maintained at all times during construction and to the satisfaction of the local authority.
18. All traffic control during construction shall be in accordance with the RTA Guidelines - Traffic Control at Work Sites and AS 1742.3 - 2004 Manual of Uniform Traffic Control Devices. Traffic Control Devices for Works on Roads.
19. All works shall be carried out in accordance with the Local Authorities subdivision code and associated standard drawings.
20. It is the contractor's responsibility to provide to the site surveyor any information necessary to prepare works-as-executed drawings for submission to the local authority. It will be necessary to liaise with the surveyor to coordinate the location of some items prior to backfilling.

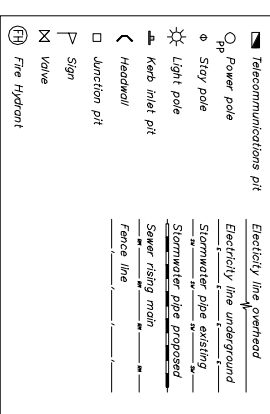

Note:  
Contours shown hereon represent the finished design surface modelled at 0.2m intervals.

This plan is NOT to be used for construction purposes unless it carries the approval stamp of the local authority.

Issue	Date	Amendment	Apprv
A	5.3.07	Adjust to 2 lane entries on side roads	EE

Client:  
**Rayshield Pty. Ltd.**

Project:  
**Riveroaks Development  
Pacific Highway  
Ballina**

Title:  
**Site Layout Plan**

**ARDILL PAYNE & PARTNERS**  
CONSULTING CIVIL AND STRUCTURAL ENGINEERS  
PROJECT MANAGERS TOWN PLANNERS AND SURVEYORS

79 Tamar Street  
P.O. Box 20  
BALLINA, NSW 2478  
ABN: 113 951 523 12

Telephone: 02 6686 3280  
Facsimile: 02 6686 7920  
Email: info@ardillpayne.com.au  
Website: www.ardillpayne.com.au

Design	PB	Scale	A1	1:250
Drawn	PB	Drawn	AHD	
Date	28-06-06	Filename	6316-plans	
Checked		Approved		
Job No.	<b>6316</b>	Draw. No.	<b>C1</b>	Issue
			(1 of 11)	<b>A</b>