



The Proposed Development as Viewed from the Bridge



The Proposed Development as Viewed from Clyde St



The Proposed Development as Viewed from Orient St



The Proposed Development as Viewed from Perry St



The Proposed Development as Viewed from Vesper St

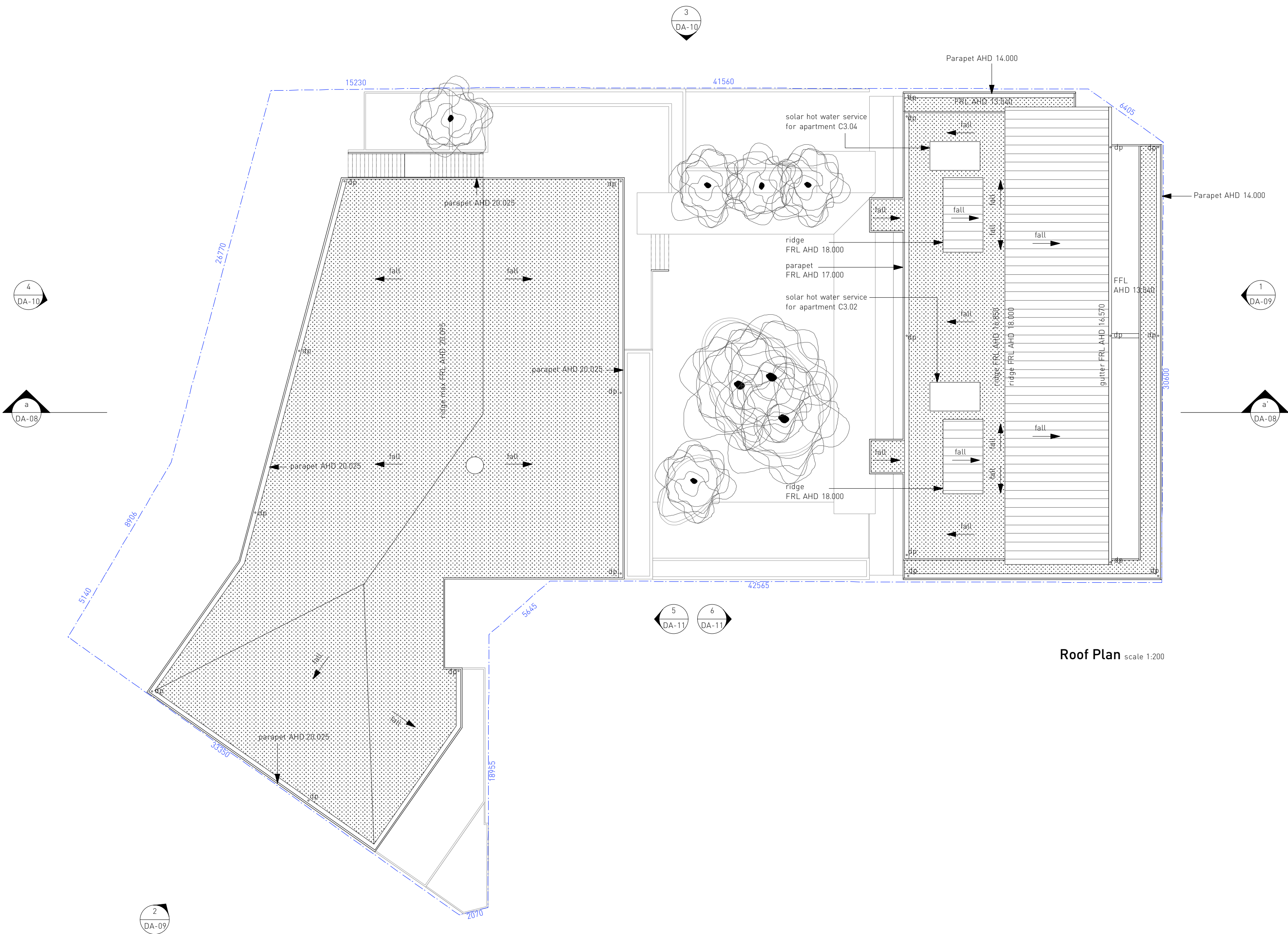

Roof Plan Scale 1:200

Revisions

00	Issued for Development Approval	13.08.08
01	Issued for Development Approval - North Street building amended to accommodate revised vehicle access arrangements at ground level	15.12.08

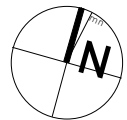

key

- studio apartment
- 1 bed apartment
- 1 bed terrace apartment
- 2 bed terrace apartment
- 3 bed terrace apartment
- reception + conferencing
- back of house
- retail
- circulation
- plant and storage zones
- fh fire hydrant
- fhr fire hose reel
- pfe portable fire extinguisher
- ftd first flush diverter
- dp down pipe
- hp heat pump hot water service
- AHD australian height datum
- FFL finished floor level
- FRL finished roof level
- FGL finished ground level

Consultants

Surveyor - The Lawrence Group
Ph: 02 9557 2299
Structural Engineer - Simpson Design Associates
Ph: 02 9810 8911
Geotechnical Engineer - Douglas Partners
Ph: 02 4271 1836
Building Services Engineers + Consultants - GHD Pty Ltd
Ph: 02 4579 9521
Civil and Hydraulic Engineer - Whippo-Wood Consulting
Ph: 02 8723 8444
Acoustical Consultant - Wilkinson Murray Pty Ltd
Ph: 02 9437 4611
Landscape Architect - Ayling + Drury Landscape Architecture
Ph: 02 4422 9901
Planner - SPD Team Planners
Ph: 02 9212 5999
Environmental Engineer - Peter Spurway + Associates
Ph: 02 4473 8665
BASIX Assessor - Building Sustainability Assessments
Ph: 02 4762 3429
Traffic + Transport Consultant - Masson Wilson Twiney
Ph: 02 9410 4100
Traffic Construction Management Plan - John Condon and Associates
Ph: 02 4413 7755
BCA Consultant - BCA Logic Pty Ltd
Ph: 02 9411 5360
Quantity Surveyor - BDA Pty Ltd
Ph: 02 9281 7964

workshop
dunn + hiliam architects

Workshop 1 Pty Ltd ACN 098 339 196
33 Salisbury St, Botany NSW 2019
T +61 2 9316 7715
F +61 2 9316 7725
E studio@workshop1.com.au
Nominated architect A88 No. 7547
This drawing, the information and design in it are copyright to Workshop 1 Pty Ltd.

Project Clyde River Motor Inn
Lot 4 DP 585 556

Issue Development Approval

Date Thursday, 8 January 2009
4:09:30 PM

Scale 1:200 @ A1

Drawing Roof Plan

Dwg No. DA03 - 07 01