

# PROPOSED RESIDENTIAL SUBDIVISION

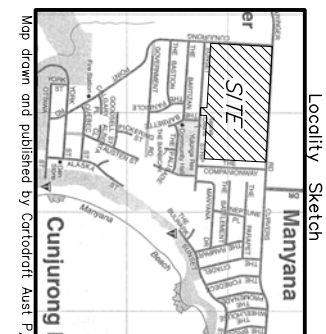
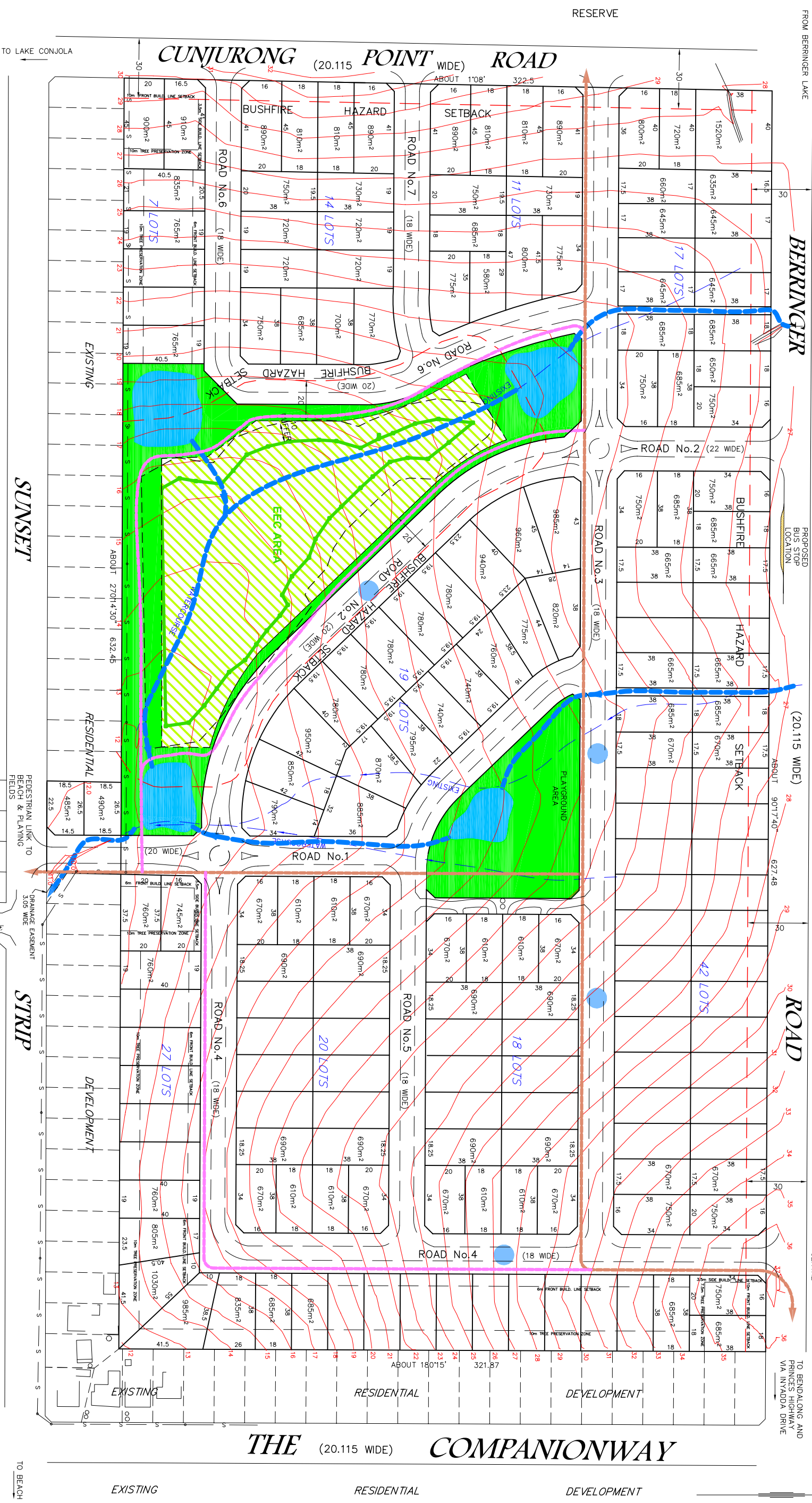

- PROPOSED TRAFFIC CALMING DEVICE
- DENOTES EDGE OF EEC AREA AS DETERMINED BY FIELD SURVEY JULY 2006.
- PROPOSED DRAINAGE PATH
- PROPOSED PEDESTRIAN LINKAGE
- PROPOSED CYCLEWAY/PEDESTRIAN LINKAGE
- PROPOSED WATER QUALITY FACILITY
- PROPOSED PUBLIC RESERVE / DRAINAGE RESERVE (INNER PROTECTION AREA)
- PROPOSED PUBLIC RESERVE / DRAINAGE RESERVE (BUSHLAND AREA INCORPORATING EEC AREA 1.43ha)

PUBLIC RESERVE AREA REQUIRED UNDER SCC SECTION 94 PLAN IS 5005m<sup>2</sup>

PROPOSED PUBLIC RESERVE AREA IS:  
 5,300m<sup>2</sup> (SMALL AREA)  
 25,375m<sup>2</sup> (LARGE AREA) COMPRISING 14,500m<sup>2</sup> OF BUSHLAND AND 11,075m<sup>2</sup> OF IPA

LOT YIELD – 175 LOTS ON LOT 172  
 LOT YIELD – 2 LOTS ON LOT 823 (ON SUNSET STRIP)  
**TOTAL – 177 LOTS**

DIMENSIONS AND AREAS ARE SUBJECT TO SURVEY

RATIO:  
**1 : 1000 (A1)**  
**1 : 2000 (A3)**

DATE:	BY:	DATE:
ORIGIN:	DESIGN:	DATE OF PLAN:
DRAMA:	MP	27 JULY 2006
5	MP	
6	MP	

**allen, price & associates**  
 land and development consultants  
 75 plunkett street, nowra, nsw, 2541  
 phone (02) 4421 6544 fax (02) 4422 1821 DX 5310 nowra  
 consultants@allenprice.com.au www.allenprice.com.au

PLAN SHOWING PROPOSED SUBDIVISION OVER LOT 172 DP 755923 & LOT 823 DP 247285 AT BERRINGER ROAD & CUNJURONG POINT ROAD, MANYANA FOR MALBEC PROPERTIES PTY LIMITED

REF. No.	24256-01
LAYOUT	G
SHEET	1
OF 1 SHEETS	
REVISION	6

