

DETAILED SHADOW ANALYSIS

5. SITE PHOTOS AND STREET VIEW OF ENTRY PORCH AND WINDOWS TO LIVING SPACE



 POTENTIALLY AFFECTED APARTMENT (29/23 BUCKLAND STREET, CHIPPENDALE)

6. INTERNAL VIEW COMPARISON STUDY OF 29/23 BUCKLAND STREET

EXISTING INTERNAL VIEW

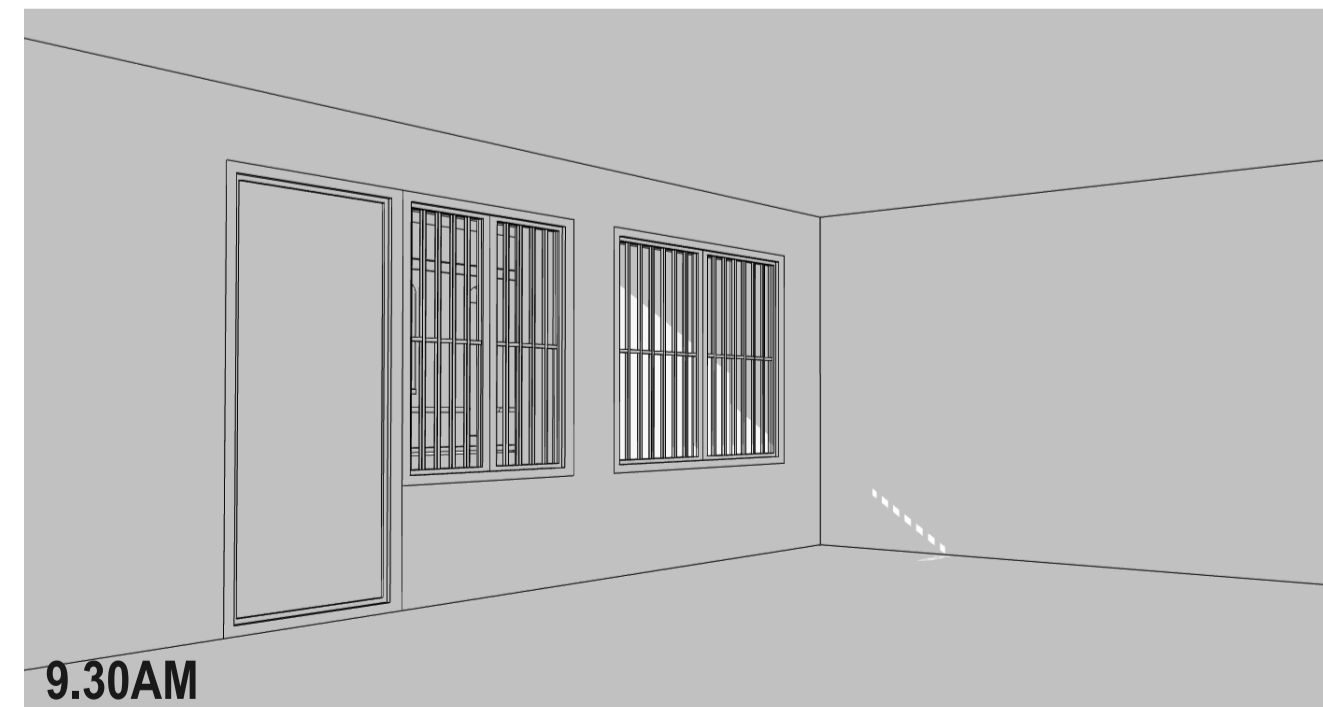
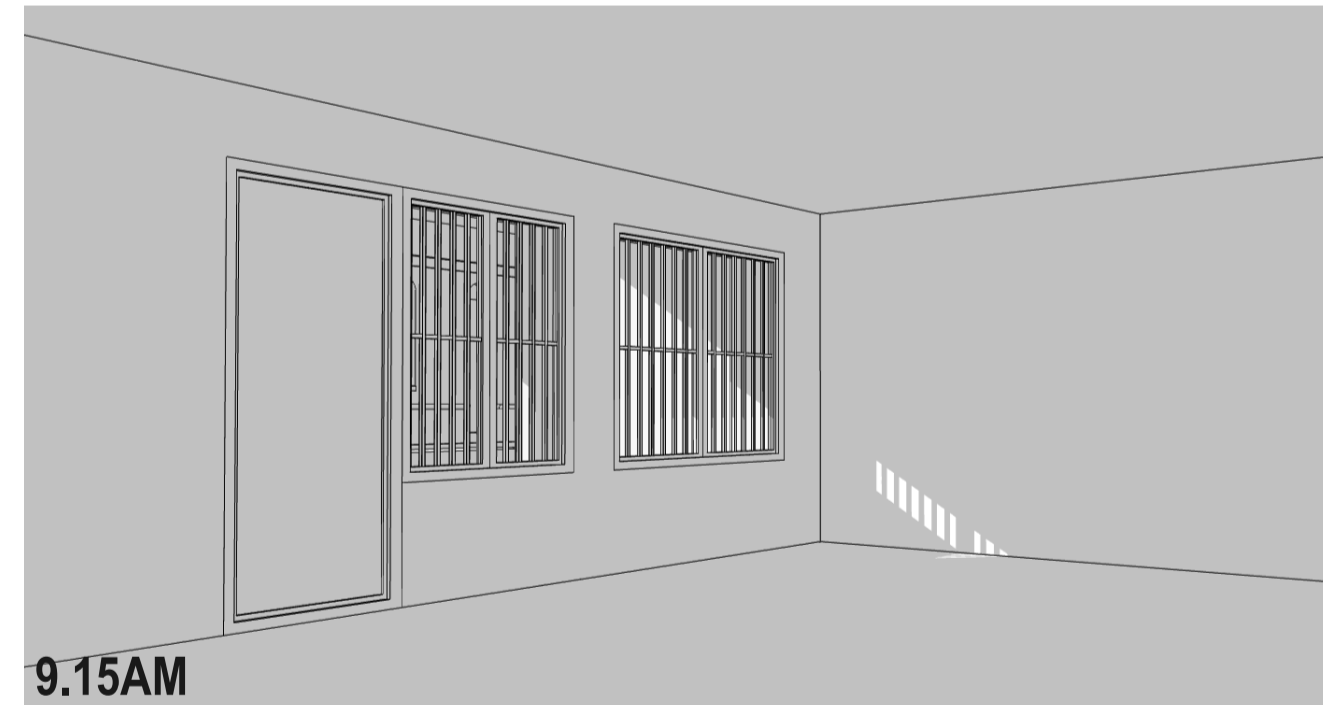

PROPOSED INTERNAL VIEW

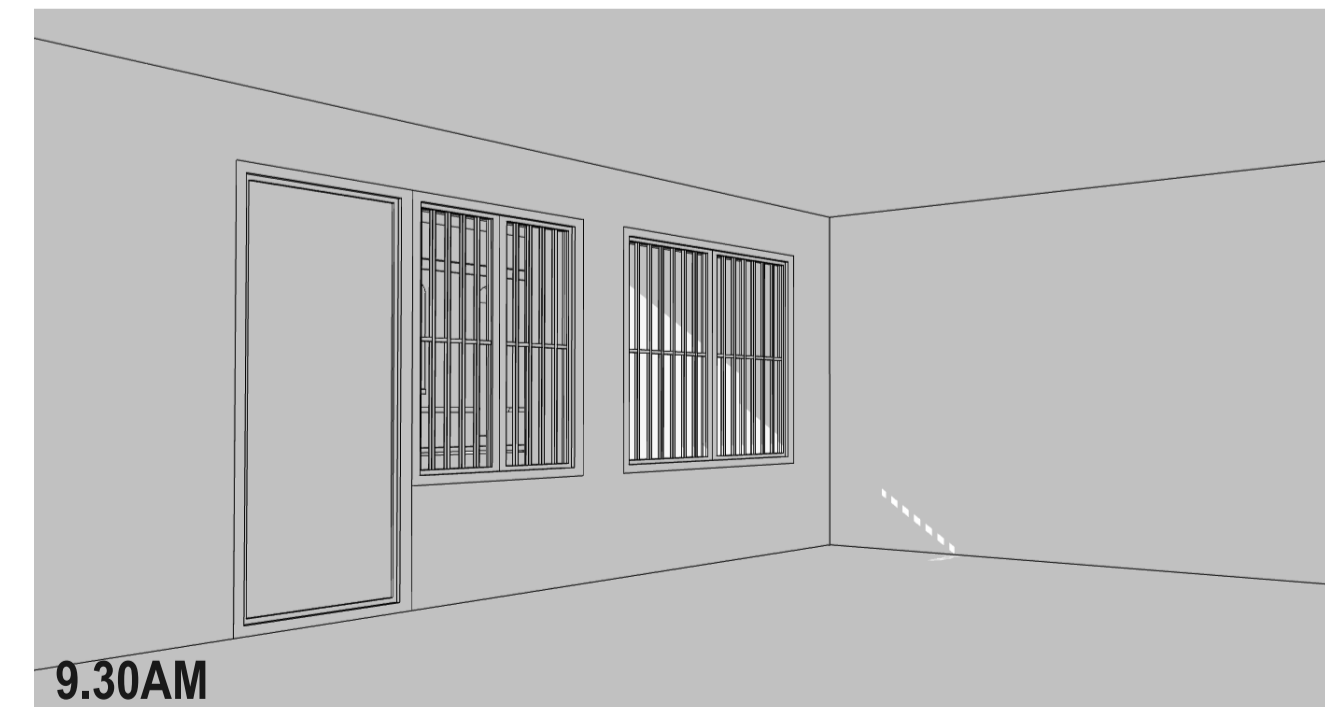
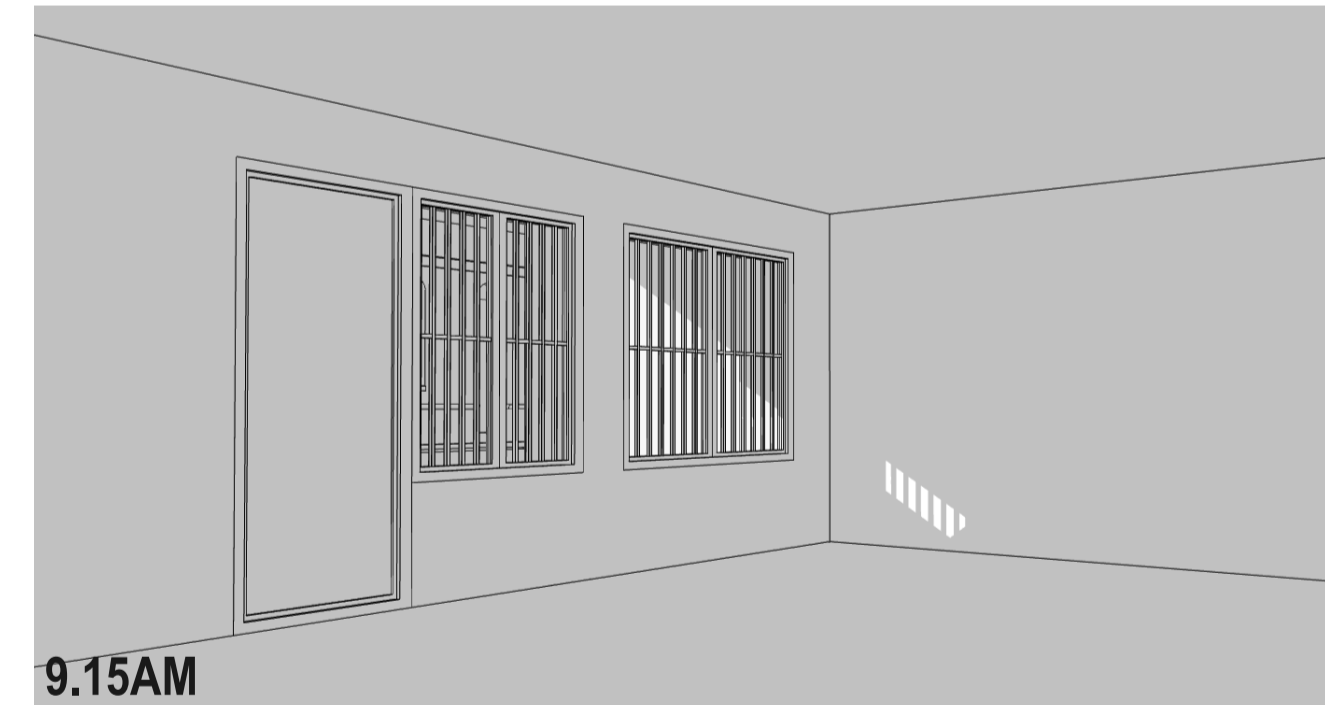

Rev.	Description	Issue Date
1	MOD 1 SSD6746 - COS Response	19.12.2018

Consultants
For all consultants contact details, Please refer to Page Coverage

Notes
Do not scale off drawings. Use figured dimensions only. Report any discrepancies to the architect. These designs, plans, specifications and the copyright therein are the property of Tonkin Zulaikha Greer Architects Pty Ltd, and must not be reproduced or copied wholly or in part without written permission of Tonkin Zulaikha Greer Architects Pty Ltd.

Project Name
**UTS BLACKFRIARS
INDUSTRY HUB**



UNIVERSITY OF TECHNOLOGY, SYDNEY
FACILITIES MANAGEMENT OPERATIONS
Tower, Building 1, Level 19, 15 Broadway
Broadway NSW 2007
Ph: 9514-2000 Fax: 9514-4690

Drawing Title
UTS BLACKFRIARS CAMPUS CB23
**A17 - DETAILED SHADOW
ANALYSIS - 2**

FMU Project Number 03013-C-18			
Drawn By SB, JH, JB, KP	Checked RS, KL	Approved By TG	Date App. 00-00-18
Drawing Scale @A1	Drawing Status DA		A1
UTS Drg File Name	UTS Drg File No 70008	Rev No 1	