

EXPLANATORY NOTES:

- THIS MODEL SHOULD BE VIEWED IN A CAD ENVIRONMENT TO INTERPRET THE 3D INFORMATION.
- ANY ELECTRONIC FILE IS PROVIDED WITHOUT WARRANTY AND SHOULD BE USED ONLY IN CONJUNCTION WITH THE SUPPLIED PDF/PAPER COPY OF THIS PLAN.
- THESE NOTES ARE AN INTEGRAL PART OF THE DIGITAL DATA FILE AND SHOULD BE READ WITH THE DATA FILE AND MUST NOT BE REMOVED FROM THE DATA FILE.
- NO INVESTIGATION OF UNDERGROUND SERVICES HAS BEEN MADE.
- IT REMAINS THE RESPONSIBILITY OF THOSE CONDUCTING PHYSICAL WORKS TO ENSURE AN UP-TO-DATE VERSION OF DIAL BEFORE YOU DIG PLANS IS CONSULTED AND AVAILABLE ON SITE.
- ALL UTILITIES SHOULD TO BE POTHOLED TO VERIFY LOCATION AND DEPTH.

- THIS SURVEY PLAN REPRESENTS THE LOCATION OF FEATURES THAT WERE ACCESSIBLE AT THE TIME OF SURVEY.
- COPYRIGHT : © RPS AAP CONSULTING PTY LTD INFORMATION CONTAINED IN THIS DRAWING / FILE IS THE COPYRIGHT OF RPS AAP CONSULTING PTY LTD. COPYING OR USING THIS DATA IN WHOLE OR PART, IN ANY FORMAT, WITHOUT PERMISSION INFRINGES COPYRIGHT.
- FOR REASONS OF PLAN PRESENTATION, NOT ALL OF THE INFORMATION CAN BE SHOWN ON THIS PLAN. PLEASE REFER TO ACCOMPANYING DIGITAL DATA FOR ALL SURVEY INFORMATION AND ATTRIBUTES.
- CONTEXTUAL BOUNDARIES SHOWN HAVE BEEN TAKEN FROM NSW DIGITAL CADASTRAL DATABASE (DCDB) AND HAVE NOT BEEN VERIFIED BY SURVEY AND ARE FOR CONTEXT PURPOSES ONLY. NO INVESTIGATION OF LAND TITLES HAS BEEN CONDUCTED.
- CONTOURS ARE AN INDICATION OF LANDFORM AND SHOULD NOT BE TAKEN IN PREFERENCE TO SPOT LEVELS SHOWN.
- CONTOUR INTERVAL SHOWN IS 1.0 MAJOR AND 0.5 MINOR.

- BUILDING FOOTPRINTS SHOWN ARE AT GROUND LEVEL. FOOTPRINTS MAY DIFFER AT OTHER LEVELS.
- RIDGE, EAVE, GUTTER & AWNING HEIGHTS HAVE BEEN OBTAINED BY AN INDIRECT METHOD AND ARE ACCURATE TO ±0.05m.
- ONLY SIGNIFICANT TREES ON THE SUBJECT SITE WITH A TRUNK DIAMETER OF GREATER THAN 0.15M HAVE BEEN SURVEYED. SMALLER TREES AND SHRUBS EXIST ON THE SITE. NO TREE TAGS HAVE BEEN PLACED.
- OVERHEAD POWERLINES HAVE NOT BEEN SURVEYED. NO ATTEMPT HAS BEEN MADE TO LOCATE THE POSITION OR RL OF INDIVIDUAL CABLES.
- ALL KERBS ARE CONCRETE UNLESS LABELLED OTHERWISE
- WHITELEY LANE AND DENISON STREET SURVEYED IN 2019
- VICTORIA CROSS METRO STATION SOUTHERN SHAFT ADDED FROM COORDINATES OF THE MINIMUM CLEAR OPENING (MCO) FROM DRAWING SMCSWTSE-JAB-SVC-EX-DRG-540011.

PUBLIC UTILITY LEGEND

E ELEC

- CABLE JUNCTION BOX (PEJB)
- CABLE MANHOLE (PEMH)
- DISTRIBUTION FUSE POINT
- POLE - LIGHT (PLPL)
- POLE - POWER (PPPL)
- POLE - POWER & LIGHT (PPLP)
- GARDEN LIGHT (PLGN)
- POWER SERVICE PILLAR - UNDERGROUND (PEUP)
- TRANSFORMER CABINET CENTRE (PETC)
- LIGHT WITH OUTREACH (LI)

E TCS

- TRAFFIC CONTROL SIGNAL (PSGL)
- TRAFFIC SIGNAL CONTROLLER (PSCCL)
- TRAFFIC SIGNAL DETECTOR (PSDR)
- TRAFFIC SIGNAL JUNCTION BOX (PSJX)
- TRAFFIC LIGHT WITH OUTREACH (TO)

E COMMS (COMMUNICATIONS)

- TELEPHONE DISTRIBUTION PILLAR (PTDP)
- ABOVE GROUND JOINING POST (PTJP)
- OPTICAL FIBRE JUNCTION BOX (POFJ)
- OPTICAL FIBRE PIT (POFP)
- STD 1.1m BY 1.1m MAN PIT (PTMP)
- TELEPHONE BOX POINT (PTBX)
- TELEPHONE POLE (PTPL)
- TELEPHONE SINGLE CONCRETE PIT (PTSP)
- TELEPHONE TRIPLE CONCRETE PIT (PT3P)
- TELEPHONE TWIN CONCRETE PIT (PTTP)

E GAS

- MANHOLE COVER (PGHL)
- METER (PGMR)
- PIPELINE MARKER (PGPM)
- PIPELINE MARKER - HIGH PRESSURE (PGHM)
- VALVE BOX (PGAS)
- VENT PIPE (PGVP)
- TEST POINT (PGTP)

E WATR

- AIR VALVE (PWAV)
- EARTH TERMINAL (PWET)
- FIRE HYDRANT (PWFH)
- HYDRANT (PWHY)
- METER (PWMR)
- STOP VALVE (PWSV)
- TAP (PWTF)

E SWER

- MANHOLE COVER (PSMH)
- VENT PIPE (PSVP)
- LAMPHOLE (PSLH)

E DRAIN (STORMWATER)

- DRAINAGE JUNCTION MANHOLE (PDJM)
- GULLY PIT POINT (PGUL)
- INLET TO SUMP (PILT)
- INVERT OF PIPE (PINV)
- TOP OF CONCRETE JUNCTION BOX (PJCB)
- SUBSOIL DRAIN FLUSH POINT (PSFP)
- KERB INLET (KI)

E CULT (CULTURAL)

- SIGN POST (PSIN)
- FLAG POLE (PFLG)
- BUS STOP (PBUS)
- LARGE SIGN (SIL)
- HISTORICAL POINT OF INTEREST (PHIS)
- BOLLARD (AC)
- FLOOR LEVEL
- RUBBISH BIN (PBN)
- PARKING METER (PKME)
- MAILBOX (PMBX)
- GATE
- DOORWAY
- UMBRELLA
- BUILDING
- FENCE - MANROOF
- FENCE - CONSTRUCTED
- RL OF GUTTER FLOW INVERT

E MISC

- GATIC COVER LID (PGAT)
- UNIDENTIFIED POLE (PPOL)
- UNIDENTIFIED SERVICE (PUSR)
- BOREHOLE

E TOPO

- SPOT HEIGHT (PSHT)
- NATURAL SURFACE
- TREE
 - S-01 SPREAD=1
 - T-02 TRUNK=0.2
 - H-3 HEIGHT=3

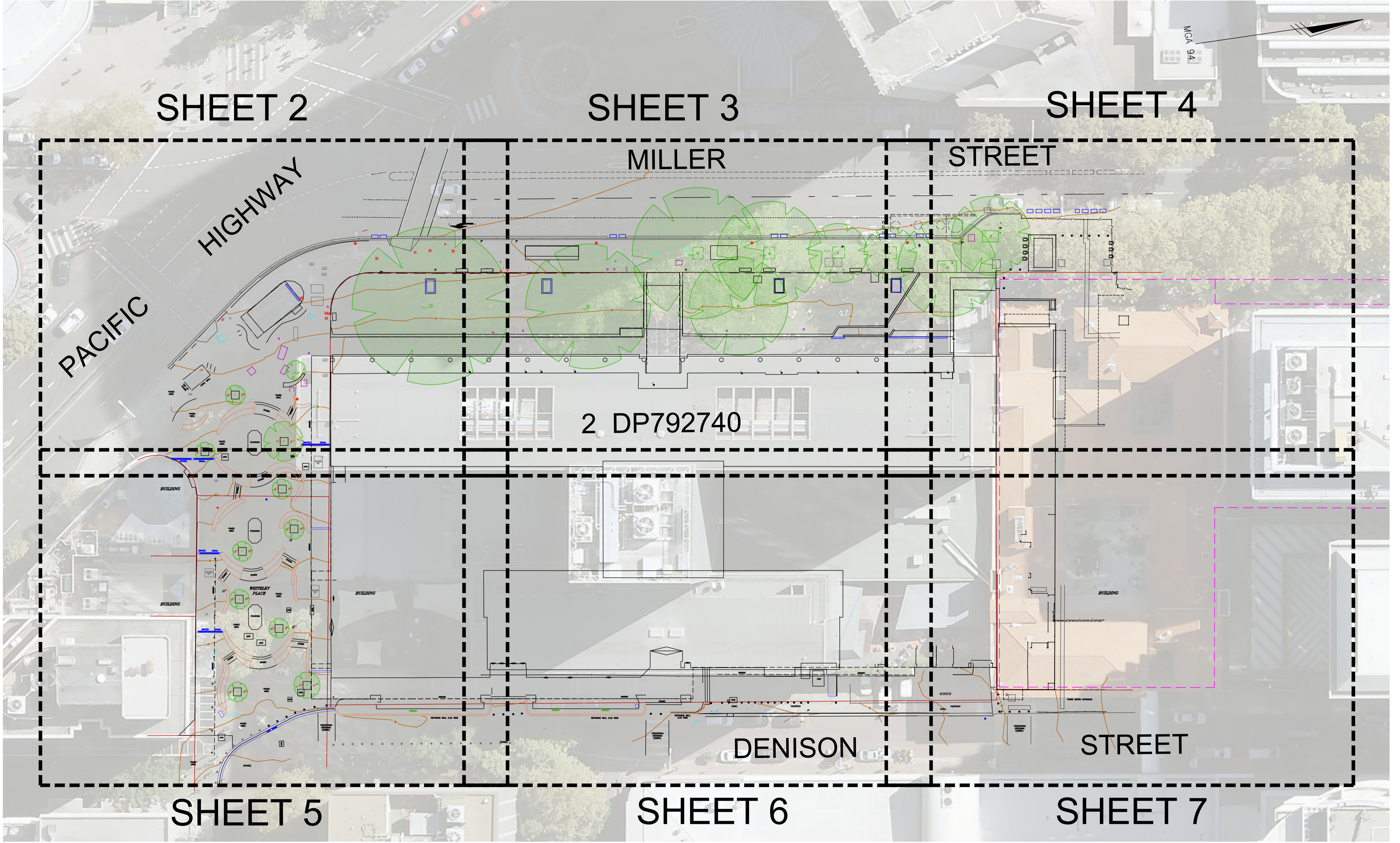

| NO. | DATE | REVISION DETAILS | DRAWN | CHK | APP |
|-----|------------|---|-------|-----|-----|
| D | 28.08.2025 | ADD VICTORIA CROSS METRO STATION SOUTHERN SHAFT SURVEY EXTENTS, SHEET LAYOUT AND CONTOURS | HY | TC | GE |
| C | 2.12.2024 | SURVEY EXTENTS, SHEET LAYOUT AND CONTOURS AMENDED | LB | TC | GE |
| B | 29.11.2024 | 2019 SURVEY ADDED (WHITELEY LANE & DENISON ST) | LB | TC | GE |
| A | 11.05.2022 | INITIAL PLAN | LB | JC | GE |

| | |
|--------------------------|-----------------------|
| HORIZ. SCALE: 1:300 @ A1 | VERT. SCALE: N/A @ A1 |
| COORDINATES: MGA94 | DATUM: AHD71 |
| ORIGIN: PM74608 | ORIGIN: PM74608 |

NOTES

EXPLANATORY NOTES ON SHEET 1 ARE APPLICABLE TO ALL SHEETS ON THIS PLAN

| | |
|--------------|---|
| CLIENT: | TITLE: CONTOUR & DETAIL SURVEY Miller Street, North Sydney |
| SURVEY: AF | DATE OF SURVEY: 3.05.2022 |
| DRAWN: LB | DATE OF PLAN: 07.05.2020 |
| CHECKED: JC | DATE LAST SAVED: 28.08.2025 |
| APPROVED: GE | DATE APPROVED: 07.05.2020 |

| | |
|------------------------------------|----------|
| JOB No: PR144264-08 | ISSUE: D |
| DRAWING No: PR144264-DET-002-C.dwg | |
| SHEET 1 OF 10 SHEETS | SIZE: A1 |

PUBLIC UTILITY LEGEND

- E ELEC**
 - CABLE JUNCTION BOX (PEJB)
 - CABLE MANHOLE (PEMH)
 - DISTRIBUTION FUSE POINT
 - POLE - LIGHT (PLPL)
 - POLE - POWER (PPPL)
 - POLE - POWER & LIGHT (PPLP)
 - GARDEN LIGHT (PLGN)
 - POWER SERVICE PILLAR - UNDERGROUND (PEUP)
 - TRANSFORMER CABINET CENTRE (PETC)
 - LIGHT WITH OUTREACH (LI)
- E TCS**
 - TRAFFIC CONTROL SIGNAL (PSGL)
 - TRAFFIC SIGNAL CONTROLLER (PSCL)
 - TRAFFIC SIGNAL DETECTOR (PSDR)
 - TRAFFIC SIGNAL JUNCTION BOX (PSJX)
 - TRAFFIC LIGHT WITH OUTREACH (TO)
- E COMMS (COMMUNICATIONS)**
 - TELEPHONE DISTRIBUTION PILLAR (PTDP)
 - ABOVE GROUND JOINING POST (PTJP)
 - OPTICAL FIBRE JUNCTION BOX (POFJ)
 - OPTICAL FIBRE PIT (POFP)
 - STD 1.1m BY 1.1m MAIN PIT (PTMP)
 - TELEPHONE BOX POINT (PTBX)
 - TELEPHONE POLE (PTPL)
 - TELEPHONE SINGLE CONCRETE PIT (PTSP)
 - TELEPHONE TRIPLE CONCRETE PIT (PT3P)
 - TELEPHONE TWIN CONCRETE PIT (PTTP)
- E GAS**
 - MANHOLE COVER (PGHL)
 - METER (PGMR)
 - PIPELINE MARKER (PGPM)
 - PIPELINE MARKER - HIGH PRESSURE (PGHM)
 - VALVE BOX (PGAS)
 - VENT PIPE (PGVP)
 - TEST POINT (PGTP)
- E WATER**
 - AIR VALVE (PWAV)
 - EARTH TERMINAL (PWET)
 - FIRE HYDRANT (PWFH)
 - HYDRANT (PWHY)
 - METER (PWMR)
 - STOP VALVE (PWSV)
 - TAP (PWTP)
- E SWER**
 - MANHOLE COVER (PSMH)
 - VENT PIPE (PSVP)
 - LAMPHOLE (PSLH)
- E DRAIN (STORMWATER)**
 - DRAINAGE JUNCTION MANHOLE (PDJM)
 - GULLY PIT POINT (PGUL)
 - INLET TO SLUMP (PILT)
 - INVERT OF PIPE (PINV)
 - TOP OF CONCRETE JUNCTION BOX (PJCB)
 - SUBSOIL DRAIN FLUSH POINT (PSFP)
 - KERB INLET (KI)
- E CULT (CULTURAL)**
 - SIGN POST (PSIN)
 - FLAG POLE (PFLG)
 - BUS STOP (PBUS)
 - LARGE SIGN (SL)
 - HISTORICAL POINT OF INTEREST (PHIS)
 - BOLLARD (AC)
 - FLOOR LEVEL
 - RUBBISH BIN (PBIN)
 - PARKING METER (PKME)
 - MAILBOX (PMBX)
 - GATE
 - DOORWAY
 - UMBRELLA
 - BUILDING
 - FENCE - MANPROOF
 - FENCE - CONSTRUCTED
 - RL OF GUTTER FLOW INVERT
- E MISC**
 - GATIC COVER LID (PGAT)
 - UNIDENTIFIED POLE (PPOL)
 - UNIDENTIFIED SERVICE (PUSR)
 - BOREHOLE
- E TOPO**
 - SPOT HEIGHT (PSHT)
 - NATURAL SURFACE
 - TREE
 - 0.01 SPREAD=1
 - 0.02 TRUNK=0.2
 - 0.03 HEIGHT=3

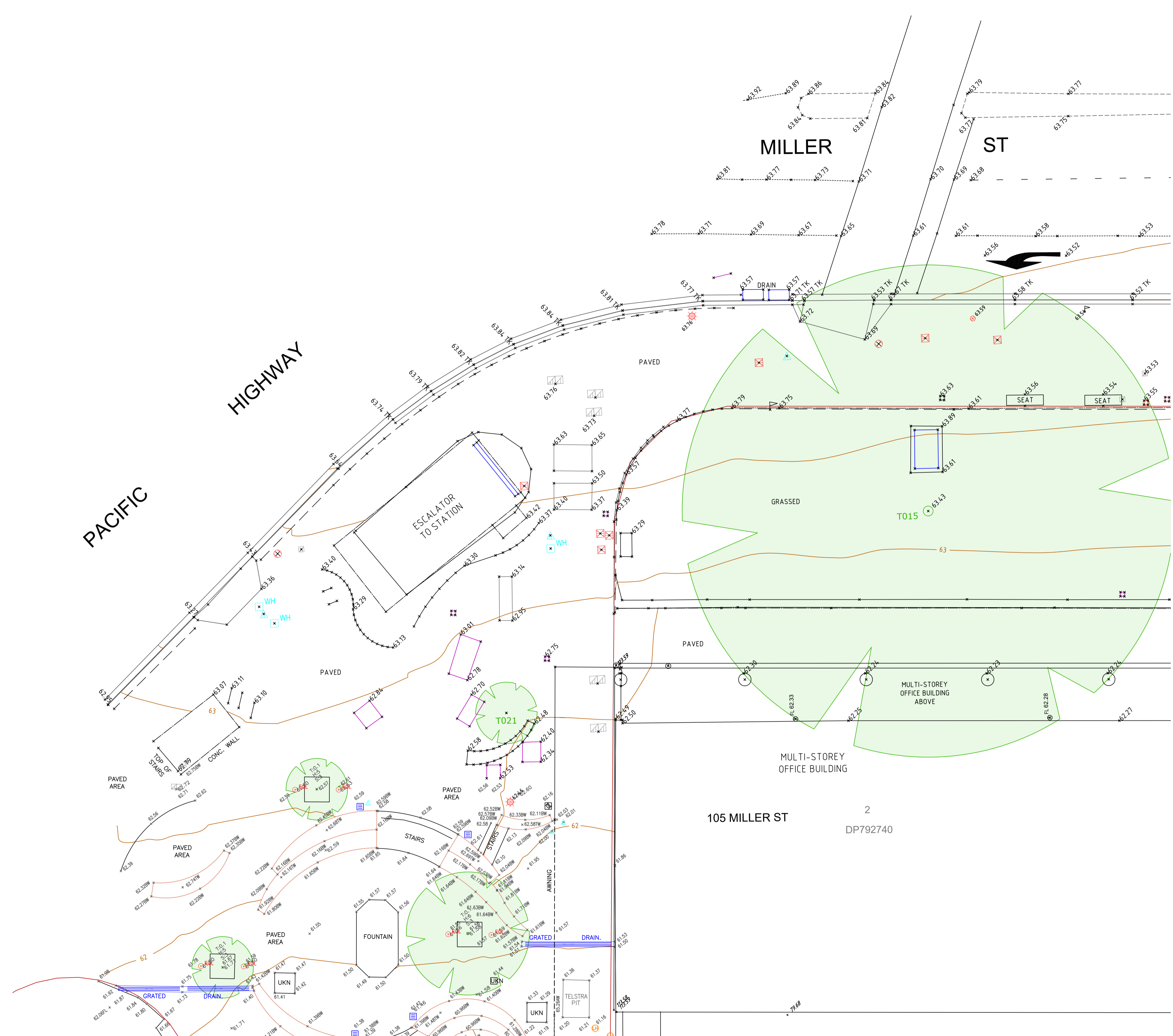
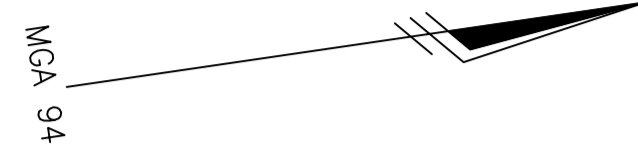

| Site Tree Table | | | |
|-----------------|------------|------------|------------|
| ID | Trunk (mm) | Spread (m) | Height (m) |
| T013 | 0.60 | 20 | 20 |
| T014 | 0.50 | 16 | 18 |
| T015 | 0.80 | 24 | 24 |
| T016 | 0.70 | 9 | 13 |
| T017 | 0.45 | 12 | 10 |
| T018 | 0.40 | 8 | 11 |
| T019 | 0.70 | 19 | 20 |
| T020 | 0.70 | 15 | 20 |
| T021 | 0.10 | 3 | 15 |
| T022 | 0.70 | 15 | 21 |
| T023 | 0.40 | 14 | 11 |
| T024 | 0.30 | 10 | 10 |

| NO. | DATE | REVISION DETAILS | DRAWN | CHK | APP |
|-----|------------|---|-------|-----|-----|
| D | 28.08.2025 | ADD VICTORIA CROSS METRO STATION SOUTHERN SHAFT | HY | TC | GE |
| C | 2.12.2024 | SURVEY EXTENTS, SHEET LAYOUT AND CONTOURS AMENDED | LB | TC | GE |
| B | 29.11.2024 | 2019 SURVEY ADDED (WHITELEY LANE & DENISON ST) | LB | TC | GE |
| A | 11.05.2022 | INITIAL PLAN | LB | JC | GE |

| | |
|--------------------------|-----------------------|
| HORIZ. SCALE: 1:100 @ A1 | VERT. SCALE: N/A @ A1 |
| COORDINATES: MGA94 | DATUM: AHD71 |
| ORIGIN: PM74608 | ORIGIN: PM74608 |

EXPLANATORY NOTES ON SHEET 1 ARE APPLICABLE TO ALL SHEETS ON THIS PLAN

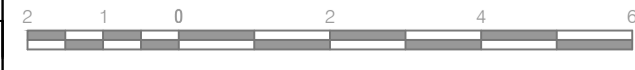

NOTES

| | |
|--------------|--|
| CLIENT: | TITLE: CONTOUR & DETAIL SURVEY Miller Street, North Sydney |
| SURVEY: AF | DATE OF SURVEY: 3.05.2022 |
| DRAWN: LB | DATE OF PLAN: 07.05.2020 |
| CHECKED: JC | DATE LAST SAVED: 28.08.2025 |
| APPROVED: GE | DATE APPROVED: 07.05.2020 |

JOB No: PR144264-08

ISSUE: **D**

DRAWING No: PR144264-DET-002-C.dwg

SHEET 2 OF 10 SHEETS

SIZE: A1

MAKING COMPLEX EASY

RPS

- PUBLIC UTILITY LEGEND**
- E/ELEC**
 - CABLE JUNCTION BOX (PEJB)
 - CABLE MANHOLE (PEMH)
 - DISTRIBUTION FUSE POINT
 - POLE - LIGHT (PLPL)
 - POLE - POWER (PPPL)
 - POLE - POWER & LIGHT (PPLP)
 - GARDEN LIGHT (PLGN)
 - POWER SERVICE PILLAR - UNDERGROUND (PEUP)
 - TRANSFORMER CABINET CENTRE (PETC)
 - LIGHT WITH OUTREACH (LI)
 - E/TCS**
 - TRAFFIC CONTROL SIGNAL (PSGL)
 - TRAFFIC SIGNAL CONTROLLER (PSCL)
 - TRAFFIC SIGNAL DETECTOR (PSDR)
 - TRAFFIC SIGNAL JUNCTION BOX (PSJX)
 - TRAFFIC LIGHT WITH OUTREACH (TO)
 - E/COMMS (COMMUNICATIONS)**
 - TELEPHONE DISTRIBUTION PILLAR (PTDP)
 - ABOVE GROUND JOINING POST (PTJP)
 - OPTICAL FIBRE JUNCTION BOX (POFJ)
 - OPTICAL FIBRE PIT (POFP)
 - STD 1.1m BY 1.1m MAIN PIT (PTMP)
 - TELEPHONE BOX POINT (PTBX)
 - TELEPHONE POLE (PTPL)
 - TELEPHONE SINGLE CONCRETE PIT (PTSP)
 - TELEPHONE TRIPLE CONCRETE PIT (PT3P)
 - TELEPHONE TWIN CONCRETE PIT (PTTP)
 - E/GAS**
 - MANHOLE COVER (PGHL)
 - METER (PGMR)
 - PIPELINE MARKER (PGPM)
 - PIPELINE MARKER - HIGH PRESSURE (PGHM)
 - VALVE BOX (PGAS)
 - VENT PIPE (PGVP)
 - TEST POINT (PGTP)
 - E/WATR**
 - AIR VALVE (PWAU)
 - EARTH TERMINAL (PWET)
 - FIRE HYDRANT (PWFH)
 - HYDRANT (PWHY)
 - METER (PWMR)
 - STOP VALVE (PWSV)
 - TAP (PWTP)
 - E/SWER**
 - MANHOLE COVER (PSMH)
 - VENT PIPE (PSVP)
 - LAMPHOLE (PSLH)
 - E/DRAIN (STORMWATER)**
 - DRAINAGE JUNCTION MANHOLE (PDJM)
 - GULLY PIT POINT (PGUL)
 - INLET TO SLUMP (PILT)
 - INVERT OF PIPE (PINV)
 - TOP OF CONCRETE JUNCTION BOX (PJCB)
 - SUBSOIL DRAIN FLUSH POINT (PSFP)
 - KERB INLET (KI)
 - E/CULT (CULTURAL)**
 - SIGN POST (PSIN)
 - FLAG POLE (PFLG)
 - BUS STOP (PBUS)
 - LARGE SIGN (PS)
 - HISTORICAL POINT OF INTEREST (PHIS)
 - BOLLARD (AC)
 - FLOOR LEVEL
 - RUBBISH BIN (PBIN)
 - PARKING METER (PKME)
 - MAILBOX (PMBX)
 - GATE
 - DOORWAY
 - UMBRELLA
 - BUILDING
 - FENCE - MANPROOF
 - FENCE - CONSTRUCTED
 - RL OF GUTTER FLOW INVERT
 - E/MISC**
 - GATIC COVER LID (PGAT)
 - UNIDENTIFIED POLE (PPOL)
 - UNIDENTIFIED SERVICE (PUSR)
 - BOREHOLE
 - E/TOPO**
 - SPOT HEIGHT (PSHT)
 - NATURAL SURFACE
 - TREE**
 - SPREAD=1
 - TRUNK=0.2
 - HEIGHT=3

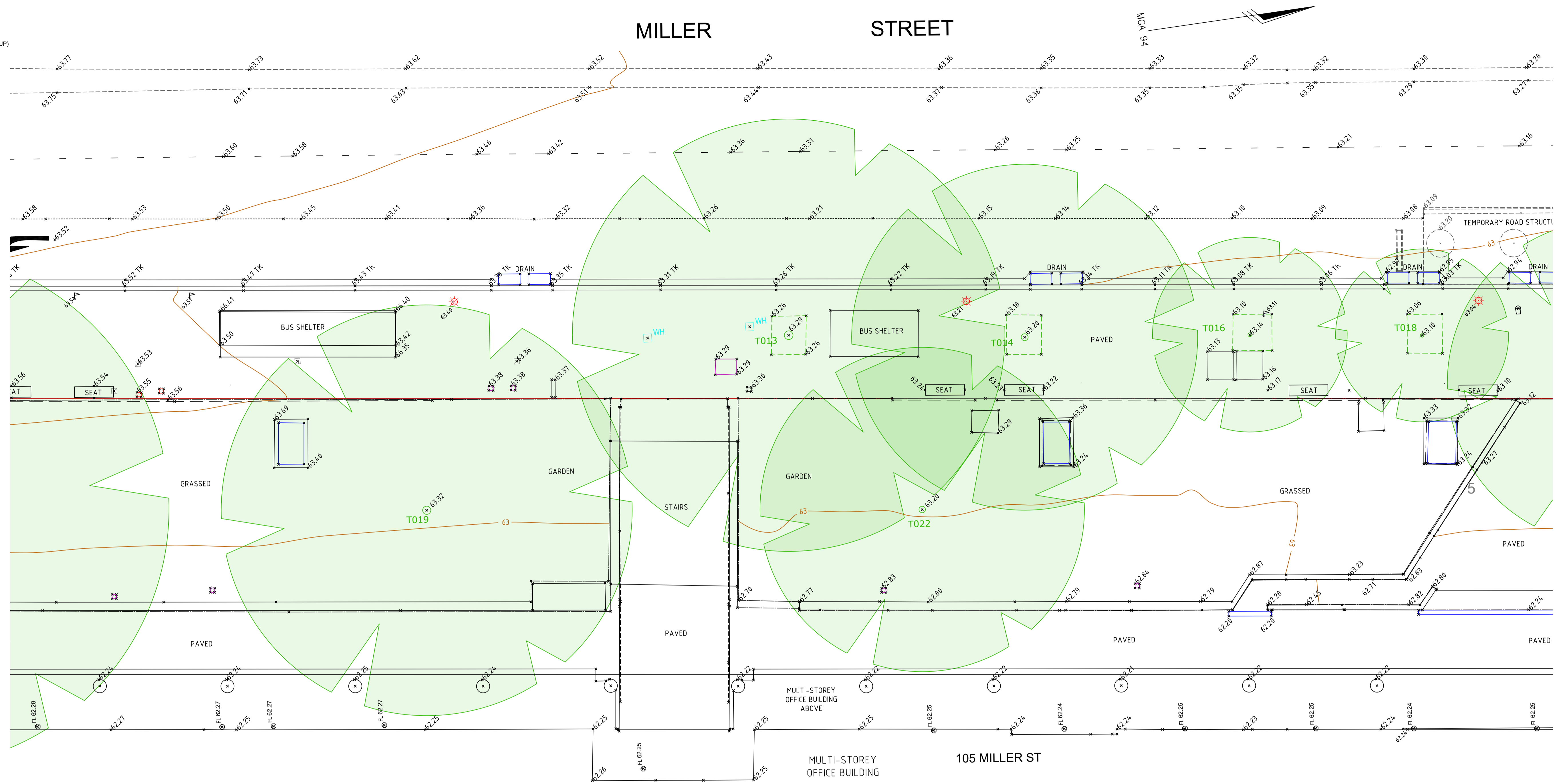

| ID | Trunk (mm) | Spread (m) | Height (m) |
|------|------------|------------|------------|
| T013 | 0.60 | 20 | 20 |
| T014 | 0.50 | 16 | 18 |
| T015 | 0.80 | 24 | 24 |
| T016 | 0.70 | 9 | 13 |
| T017 | 0.45 | 12 | 10 |
| T018 | 0.40 | 8 | 11 |
| T019 | 0.70 | 19 | 20 |
| T020 | 0.70 | 15 | 20 |
| T021 | 0.10 | 3 | 15 |
| T022 | 0.70 | 15 | 21 |
| T023 | 0.40 | 14 | 11 |
| T024 | 0.30 | 10 | 10 |

| No. | DATE | REVISION DETAILS | DRAWN | CHK | APP |
|-----|------------|---|-------|-----|-----|
| D | 28.08.2025 | ADD VICTORIA CROSS METRO STATION SOUTHERN SHAFT | | | |
| C | 2.12.2024 | SURVEY EXTENTS, SHEET LAYOUT AND CONTOURS AMENDED | | | |
| B | 29.11.2024 | 2019 SURVEY ADDED (WHITLEY LANE & DENISON ST) | | | |
| A | 11.05.2022 | INITIAL PLAN | | | |

| | |
|--------------------------|-----------------------|
| HORIZ. SCALE: 1:100 @ A1 | VERT. SCALE: N/A @ A1 |
| COORDINATES: MGA94 | DATUM: AHD71 |
| ORIGIN: PM74608 | ORIGIN: PM74608 |

EXPLANATORY NOTES ON SHEET 1 ARE APPLICABLE TO ALL SHEETS ON THIS PLAN



2
DP792740

PUBLIC UTILITY LEGEND

- E ELEC**
 - CABLE JUNCTION BOX (PEJB)
 - CABLE MANHOLE (PEMH)
 - DISTRIBUTION FUSE POINT
 - POLE - LIGHT (PLPL)
 - POLE - POWER (PPPL)
 - POLE - POWER & LIGHT (PPLP)
 - GARDEN LIGHT (PLGN)
 - POWER SERVICE PILLAR - UNDERGROUND (PEUP)
 - TRANSFORMER CABINET CENTRE (PETC)
 - LIGHT WITH OUTREACH (LI)
- E TCS**
 - TRAFFIC CONTROL SIGNAL (PSGL)
 - TRAFFIC SIGNAL CONTROLLER (PSCL)
 - TRAFFIC SIGNAL DETECTOR (PSDR)
 - TRAFFIC SIGNAL JUNCTION BOX (PSJX)
 - TRAFFIC LIGHT WITH OUTREACH (TO)
- E COMMS (COMMUNICATIONS)**
 - TELEPHONE DISTRIBUTION PILLAR (PTDP)
 - ABOVE GROUND JOINING POST (PTJP)
 - OPTICAL FIBRE JUNCTION BOX (POFJ)
 - OPTICAL FIBRE PIT (POFP)
 - STD 1.1m BY 1.1m MAIN PIT (PTMP)
 - TELEPHONE BOX POINT (PTBX)
 - TELEPHONE POLE (PTPL)
 - TELEPHONE SINGLE CONCRETE PIT (PTSP)
 - TELEPHONE TRIPLE CONCRETE PIT (PT3P)
 - TELEPHONE TWIN CONCRETE PIT (PTTP)
- E GAS**
 - MANHOLE COVER (PGHL)
 - METER (PGMR)
 - PIPELINE MARKER (PGPM)
 - PIPELINE MARKER - HIGH PRESSURE (PGHM)
 - VALVE BOX (PGAS)
 - VENT PIPE (PGVP)
 - TEST POINT (PGTP)
- E WATER**
 - AIR VALVE (PWAV)
 - EARTH TERMINAL (PWET)
 - FIRE HYDRANT (PWFB)
 - HYDRANT (PWV)
 - METER (PWRM)
 - STOP VALVE (PWSV)
 - TAP (PWTP)
- E SWER**
 - MANHOLE COVER (PSMH)
 - VENT PIPE (PSVP)
 - LAMPHOLE (PSLH)
- E DRAIN (STORMWATER)**
 - DRAINAGE JUNCTION MANHOLE (PDJM)
 - GULLY PIT POINT (PGUL)
 - INLET TO SLUMP (PILT)
 - INVERT OF PIPE (PINV)
 - TOP OF CONCRETE JUNCTION BOX (PJCB)
 - SUBSOIL DRAIN FLUSH POINT (PSFP)
 - KERB INLET (KI)
- E CULT (CULTURAL)**
 - SIGN POST (PSIN)
 - FLAG POLE (PFLG)
 - BUS STOP (PBUS)
 - LARGE SIGN (SL)
 - HISTORICAL POINT OF INTEREST (PHIS)
 - BOLLARD (AC)
 - FLOOR LEVEL
 - RUBBISH BIN (PBIN)
 - PARKING METER (PKME)
 - MAILBOX (PMBX)
 - GATE
 - DOORWAY
 - UMBRELLA
 - BUILDING
 - FENCE - MANPROOF
 - FENCE - CONSTRUCTED
 - RL OF GUTTER FLOW INVERT
- E MISC**
 - GATIC COVER LID (PGAT)
 - UNIDENTIFIED POLE (PPOL)
 - UNIDENTIFIED SERVICE (PUSR)
 - BORHOLE
- E TOPO**
 - SPOT HEIGHT (PSHT)
 - NATURAL SURFACE
 - TREE
 - SPREAD=1
 - TRUNK=0.2
 - HEIGHT=3

MILLER STREET

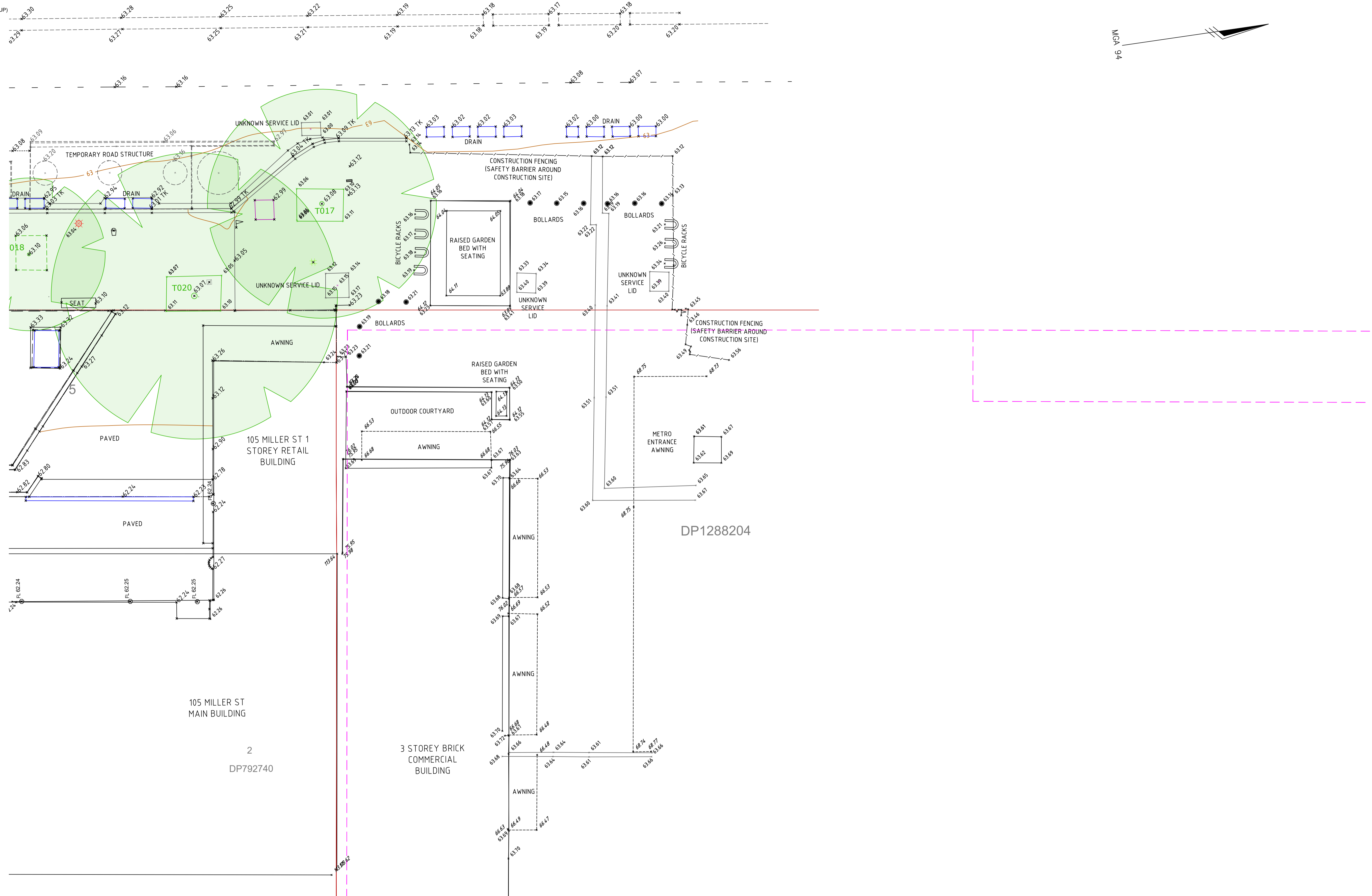

| ID | Trunk (mm) | Spread (m) | Height (m) |
|------|------------|------------|------------|
| T013 | 0.60 | 20 | 20 |
| T014 | 0.50 | 16 | 18 |
| T015 | 0.80 | 24 | 24 |
| T016 | 0.70 | 9 | 13 |
| T017 | 0.45 | 12 | 10 |
| T018 | 0.40 | 8 | 11 |
| T019 | 0.70 | 19 | 20 |
| T020 | 0.70 | 15 | 20 |
| T021 | 0.10 | 3 | 15 |
| T022 | 0.70 | 15 | 21 |
| T023 | 0.40 | 14 | 11 |
| T024 | 0.30 | 10 | 10 |

| No. | DATE | REVISION DETAILS | DRAWN | CHK | APP |
|-----|------------|---|-------|-----|-----|
| D | 28.08.2025 | ADD VICTORIA CROSS METRO STATION SOUTHERN SHAFT | HY | TC | GE |
| C | 2.12.2024 | SURVEY EXTENTS, SHEET LAYOUT AND CONTOURS AMENDED | LB | TC | GE |
| B | 29.11.2024 | 2019 SURVEY ADDED (WHITELEY LANE & DENISON ST) | LB | TC | GE |
| A | 11.05.2022 | INITIAL PLAN | LB | JC | GE |

| | |
|--------------------------|-----------------------|
| HORIZ. SCALE: 1:100 @ A1 | VERT. SCALE: N/A @ A1 |
| COORDINATES: MGA94 | DATUM: AHD71 |
| ORIGIN: PM74608 | ORIGIN: PM74608 |

EXPLANATORY NOTES ON SHEET 1 ARE APPLICABLE TO ALL SHEETS ON THIS PLAN

| | |
|--------------|-----------------------------|
| CHECKED: JC | DATE LAST SAVED: 28.08.2025 |
| APPROVED: GE | DATE APPROVED: 07.05.2020 |

CONTOUR & DETAIL SURVEY
Miller Street, North Sydney

CLIENT: DATE OF SURVEY: 3.05.2022

DRAWN: LB DATE OF PLAN: 07.05.2020

CHECKED: JC DATE LAST SAVED: 28.08.2025

APPROVED: GE DATE APPROVED: 07.05.2020

JOB No: PR144264-08

ISSUE: **D**

DRAWING No: PR144264-DET-002-C.dwg

SHEET 4 OF 10 SHEETS

- PUBLIC UTILITY LEGEND**
- E ELEC**
- CABLE JUNCTION BOX (PEJB)
 - CABLE MANHOLE (PEMH)
 - DISTRIBUTION FUSE POINT
 - POLE - LIGHT (PLPL)
 - POLE - POWER (PPPL)
 - POLE - POWER & LIGHT (PPLP)
 - GARDEN LIGHT (PLGN)
 - POWER SERVICE PILLAR - UNDERGROUND (PEUP)
 - TRANSFORMER CABINET CENTRE (PETC)
 - LIGHT WITH OUTREACH (LI)
- E TCS**
- TRAFFIC CONTROL SIGNAL (PSGL)
 - TRAFFIC SIGNAL CONTROLLER (PSCL)
 - TRAFFIC SIGNAL DETECTOR (PSDR)
 - TRAFFIC SIGNAL JUNCTION BOX (PSJX)
 - TRAFFIC LIGHT WITH OUTREACH (TO)
- E COMMS (COMMUNICATIONS)**
- TELEPHONE DISTRIBUTION PILLAR (PTDP)
 - ABOVE GROUND JOINING POST (PTJP)
 - OPTICAL FIBRE JUNCTION BOX (POFJ)
 - OPTICAL FIBRE PIT (POFP)
 - STD 1.1m BY 1.1m MAIN PIT (PTMP)
 - TELEPHONE BOX POINT (PTBX)
 - TELEPHONE POLE (PTPL)
 - TELEPHONE SINGLE CONCRETE PIT (PTSP)
 - TELEPHONE TRIPLE CONCRETE PIT (PT3P)
 - TELEPHONE TWIN CONCRETE PIT (PTTP)
- E GAS**
- MANHOLE COVER (PGHL)
 - METER (PGMR)
 - PIPELINE MARKER (PGPM)
 - PIPELINE MARKER - HIGH PRESSURE (PGHM)
 - VALVE BOX (PGAS)
 - VENT PIPE (PGVP)
 - TEST POINT (PGTP)
- E WATER**
- AIR VALVE (PWAV)
 - EARTH TERMINAL (PWET)
 - FIRE HYDRANT (PWFB)
 - HYDRANT (PWHY)
 - METER (PWMR)
 - STOP VALVE (PWSV)
 - TAP (PWTP)
- E SWER**
- MANHOLE COVER (PSMH)
 - VENT PIPE (PSVP)
 - LAMPPOLE (PSLH)
- E DRAIN (STORMWATER)**
- DRAINAGE JUNCTION MANHOLE (PDJM)
 - GULLY PIT POINT (PGUL)
 - INLET TO SLUMP (PIL1)
 - INVERT OF PIPE (PINV)
 - TOP OF CONCRETE JUNCTION BOX (PJCB)
 - SUBSOIL DRAIN FLUSH POINT (PSFP)
 - KERB INLET (KI)
- E CULT (CULTURAL)**
- SIGN POST (PSIN)
 - FLAG POLE (PFLG)
 - BUS STOP (PBUS)
 - LARGE SIGN (PS)
 - HISTORICAL POINT OF INTEREST (PHIS)
 - BOLLARD (AC)
 - FLOOR LEVEL
 - RUBBISH BIN (PBIN)
 - PARKING METER (PKME)
 - MAILBOX (PMBX)
 - GATE
 - DOORWAY
 - UMBRELLA
 - BUILDING
 - FENCE - MANPROOF
 - FENCE - CONSTRUCTED
 - RL OF GUTTER FLOW INVERT
- E MISC**
- GATIC COVER LID (PGAT)
 - UNIDENTIFIED POLE (PPOL)
 - UNIDENTIFIED SERVICE (PUSR)
 - BOREHOLE
- E TOPO**
- SPOT HEIGHT (PSHT)
 - NATURAL SURFACE
 - TREE
 - SPREAD=1
 - TRUNK=0.2
 - HEIGHT=3

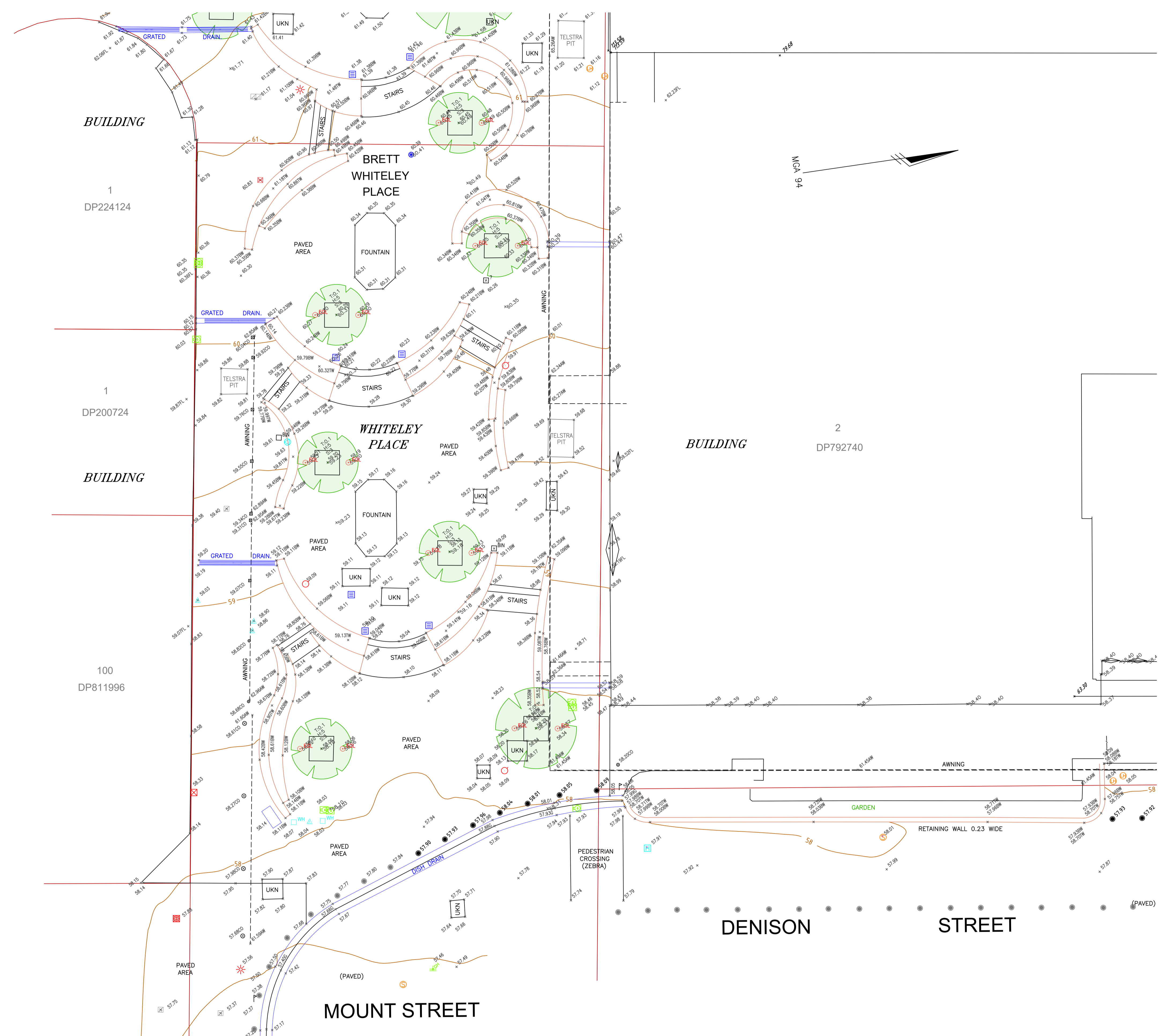

| NO. | DATE | REVISION DETAILS | DRAWN | CHK | APP |
|-----|------------|---|-------|-----|-----|
| D | 28.08.2025 | ADD VICTORIA CROSS METRO STATION SOUTHERN SHAFT | HY | TC | GE |
| C | 2.12.2024 | SURVEY EXTENTS, SHEET LAYOUT AND CONTOURS AMENDED | LB | TC | GE |
| B | 29.11.2024 | 2019 SURVEY ADDED (WHITELEY LANE & DENISON ST) | LB | TC | GE |
| A | 11.05.2022 | INITIAL PLAN | LB | JC | GE |

| | | | |
|---------------|------------|--------------|----------|
| HORIZ. SCALE: | 1:100 @ A1 | VERT. SCALE: | N/A @ A1 |
| COORDINATES: | MGA94 | DATUM: | AHD71 |
| ORIGIN: | PM74608 | ORIGIN: | PM74608 |

EXPLANATORY NOTES ON SHEET 1 ARE APPLICABLE TO ALL SHEETS ON THIS PLAN

| | |
|------------------|------------|
| CLIENT: | |
| SURVEY: | AF |
| DRAWN: | LB |
| CHECKED: | JC |
| APPROVED: | GE |
| DATE OF SURVEY: | 3.05.2022 |
| DATE OF PLAN: | 07.05.2020 |
| DATE LAST SAVED: | 28.08.2025 |
| DATE APPROVED: | 07.05.2020 |

TITLE

CONTOUR & DETAIL SURVEY
Miller Street, North Sydney

JOB No PR144264-08

ISSUE D

BEFORE YOU DIG
www.beforeyoudig.com.au

DRAWING No PR144264-DET-002-C.dwg

SHEET 5 OF 10 SHEETS

SIZE A1
MAKING COMPLEX EASY

- PUBLIC UTILITY LEGEND**
- E ELEC**
- CABLE JUNCTION BOX (PEJB)
 - CABLE MANHOLE (PEMH)
 - DISTRIBUTION FUSE POINT
 - POLE - LIGHT (PLPL)
 - POLE - POWER (PPPL)
 - POLE - POWER & LIGHT (PPLP)
 - GARDEN LIGHT (PLGN)
 - POWER SERVICE PILLAR - UNDERGROUND (PEUP)
 - TRANSFORMER CABINET CENTRE (PETC)
 - LIGHT WITH OUTREACH (LI)
- E TCS**
- TRAFFIC CONTROL SIGNAL (PSGL)
 - TRAFFIC SIGNAL CONTROLLER (PSCL)
 - TRAFFIC SIGNAL DETECTOR (PSDR)
 - TRAFFIC SIGNAL JUNCTION BOX (PSJX)
 - TRAFFIC LIGHT WITH OUTREACH (TO)
- E COMMS (COMMUNICATIONS)**
- TELEPHONE DISTRIBUTION PILLAR (PTDP)
 - ABOVE GROUND JOINING POST (PTJP)
 - OPTICAL FIBRE JUNCTION BOX (POFJ)
 - OPTICAL FIBRE PIT (POFP)
 - STD 1.1m BY 1.1m MAIN PIT (PTMP)
 - TELEPHONE BOX POINT (PTBX)
 - TELEPHONE POLE (PTPL)
 - TELEPHONE SINGLE CONCRETE PIT (PTSP)
 - TELEPHONE TRIPLE CONCRETE PIT (PT3P)
 - TELEPHONE TWIN CONCRETE PIT (PTTP)
- E GAS**
- MANHOLE COVER (PGHL)
 - METER (PGMR)
 - PIPELINE MARKER (PGPM)
 - PIPELINE MARKER - HIGH PRESSURE (PGHM)
 - VALVE BOX (PGAS)
 - VENT PIPE (PGVP)
 - TEST POINT (PGTP)
- E WATR**
- AIR VALVE (PWAV)
 - EARTH TERMINAL (PWET)
 - FIRE HYDRANT (PWFB)
 - HYDRANT (PWHY)
 - METER (PWMR)
 - STOP VALVE (PWSV)
 - TAP (PWTP)
- E SWER**
- MANHOLE COVER (PSMH)
 - VENT PIPE (PSVP)
 - LAMPHOLE (PSLH)
- E DRAIN (STORMWATER)**
- DRAINAGE JUNCTION MANHOLE (PDJM)
 - GULLY PIT POINT (PGUL)
 - INLET TO SUMP (PIL1)
 - INVERT OF PIPE (PINV)
 - TOP OF CONCRETE JUNCTION BOX (PJXB)
 - SUBSOIL DRAIN FLUSH POINT (PSFP)
 - KERB INLET (KI)
- E CULT (CULTURAL)**
- SIGN POST (PSIN)
 - FLAG POLE (PFLG)
 - BUS STOP (PBUS)
 - LARGE SIGN (SL)
 - HISTORICAL POINT OF INTEREST (PHIS)
 - BOLLARD (AC)
 - FLOOR LEVEL
 - RUBBISH BIN (PBIN)
 - PARKING METER (PKME)
 - MAILBOX (PMBX)
 - GATE
 - DOORWAY
 - UMBRELLA
 - BUILDING
 - FENCE - MANPROOF
 - FENCE - CONSTRUCTED
 - RL OF GUTTER FLOW INVERT
- E MISC**
- GATIC COVER LID (PGAT)
 - UNIDENTIFIED POLE (PPOL)
 - UNIDENTIFIED SERVICE (PUSR)
 - BOREHOLE
- E TOPO**
- SPOT HEIGHT (PSHT)
 - NATURAL SURFACE
 - TREE
 - SPREAD=1
 - TRUNK=0.2
 - HEIGHT=3

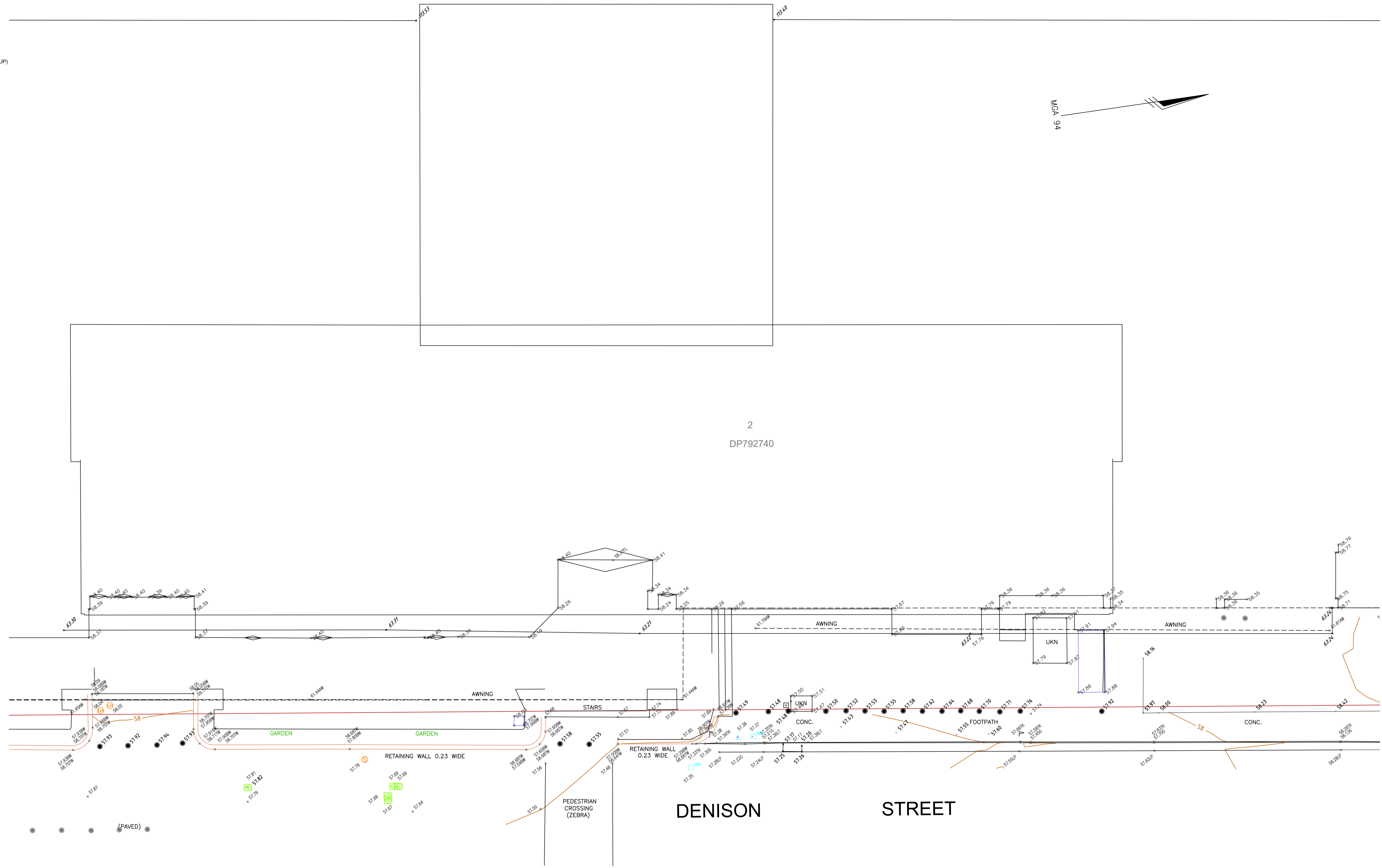

| NO. | DATE | REVISION DETAILS | DRAWN | CHK | APP |
|-----|------------|---|-------|-----|-----|
| D | 28.08.2025 | ADD VICTORIA CROSS METRO STATION SOUTHERN SHAFT | HY | TC | GE |
| C | 2.12.2024 | SURVEY EXTENTS, SHEET LAYOUT AND CONTOURS AMENDED | LB | TC | GE |
| B | 29.11.2024 | 2019 SURVEY ADDED (WHITELEY LANE & DENISON ST) | LB | TC | GE |
| A | 11.05.2022 | INITIAL PLAN | LB | JC | GE |

| | | | |
|---------------|------------|--------------|----------|
| HORIZ. SCALE: | 1:100 @ A1 | VERT. SCALE: | N/A @ A1 |
| COORDINATES: | MGA94 | DATUM: | AHD71 |
| ORIGIN: | PM74608 | ORIGIN: | PM74608 |

NOTES

EXPLANATORY NOTES ON SHEET 1 ARE APPLICABLE TO ALL SHEETS ON THIS PLAN

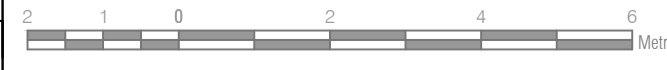

| | | | |
|-----------|----|------------------|------------|
| CHECKED: | JC | DATE LAST SAVED: | 28.08.2025 |
| APPROVED: | GE | DATE APPROVED: | 07.05.2020 |

TITLE

CONTOUR & DETAIL SURVEY
Miller Street, North Sydney

DRAWING No: PR144264-DET-002-C.dwg

JOB No: PR144264-08

ISSUE: D

BEFORE YOU DIG

SHEET 6 OF 10 SHEETS

- PUBLIC UTILITY LEGEND**
- E ELEC**
- CABLE JUNCTION BOX (PEJB)
 - CABLE MANHOLE (PEMH)
 - DISTRIBUTION FUSE POINT
 - POLE - LIGHT (PLPL)
 - POLE - POWER (PPPL)
 - POLE - POWER & LIGHT (PPLP)
 - GARDEN LIGHT (PLGN)
 - POWER SERVICE PILLAR - UNDERGROUND (PEUP)
 - TRANSFORMER CABINET CENTRE (PETC)
 - LIGHT WITH OUTREACH (LI)
- E TCS**
- TRAFFIC CONTROL SIGNAL (PSGL)
 - TRAFFIC SIGNAL CONTROLLER (PSCL)
 - TRAFFIC SIGNAL DETECTOR (PSDR)
 - TRAFFIC SIGNAL JUNCTION BOX (PSJX)
 - TRAFFIC LIGHT WITH OUTREACH (TO)
- E COMMS (COMMUNICATIONS)**
- TELEPHONE DISTRIBUTION PILLAR (PTDP)
 - ABOVE GROUND JOINING POST (PTJP)
 - OPTICAL FIBRE JUNCTION BOX (POFJ)
 - OPTICAL FIBRE PIT (POFP)
 - STD 1.1m BY 1.1m MAIN PIT (PTMP)
 - TELEPHONE BOX POINT (PTBX)
 - TELEPHONE POLE (PTPL)
 - TELEPHONE SINGLE CONCRETE PIT (PTSP)
 - TELEPHONE TRIPLE CONCRETE PIT (PT3P)
 - TELEPHONE TWIN CONCRETE PIT (PTTP)
- E GAS**
- MANHOLE COVER (PGHL)
 - METER (PGMR)
 - PIPELINE MARKER (PGPM)
 - PIPELINE MARKER - HIGH PRESSURE (PGHM)
 - VALVE BOX (PGAS)
 - VENT PIPE (PGVP)
 - TEST POINT (PGTP)
- E WATR**
- AIR VALVE (PWAV)
 - EARTH TERMINAL (PWET)
 - FIRE HYDRANT (PWFB)
 - HYDRANT (PWHY)
 - METER (PWMR)
 - STOP VALVE (PWSV)
 - TAP (PWTP)
- E SWER**
- MANHOLE COVER (PSMH)
 - VENT PIPE (PSVP)
 - LAMPHOLE (PSLH)
- E DRAIN (STORMWATER)**
- DRAINAGE JUNCTION MANHOLE (PDJM)
 - GULLY PIT POINT (PGUL)
 - INLET TO SUMP (PIL1)
 - INVERT OF PIPE (PINV)
 - TOP OF CONCRETE JUNCTION BOX (PJCB)
 - SUBSOIL DRAIN FLUSH POINT (PSFP)
 - KERB INLET (KI)
- E CULT (CULTURAL)**
- SIGN POST (PSIN)
 - FLAG POLE (PFLG)
 - BUS STOP (PBUS)
 - LARGE SIGN (SL)
 - HISTORICAL POINT OF INTEREST (PHIS)
 - BOLLARD (AC)
 - FLOOR LEVEL
 - RUBBISH BIN (PBIN)
 - PARKING METER (PKME)
 - MAILBOX (PMBX)
 - GATE
 - DOORWAY
 - UMBRELLA
 - BUILDING
 - FENCE - MANPROOF
 - FENCE - CONSTRUCTED
 - RL OF GUTTER FLOW INVERT
- E MISC**
- GATIC COVER LID (PGAT)
 - UNIDENTIFIED POLE (PPOL)
 - UNIDENTIFIED SERVICE (PUSR)
 - BOREHOLE
- E TOPO**
- SPOT HEIGHT (PSHT)
 - NATURAL SURFACE
 - TREE
 - SPREAD=1
 - TRUNK=0.2
 - HEIGHT=3

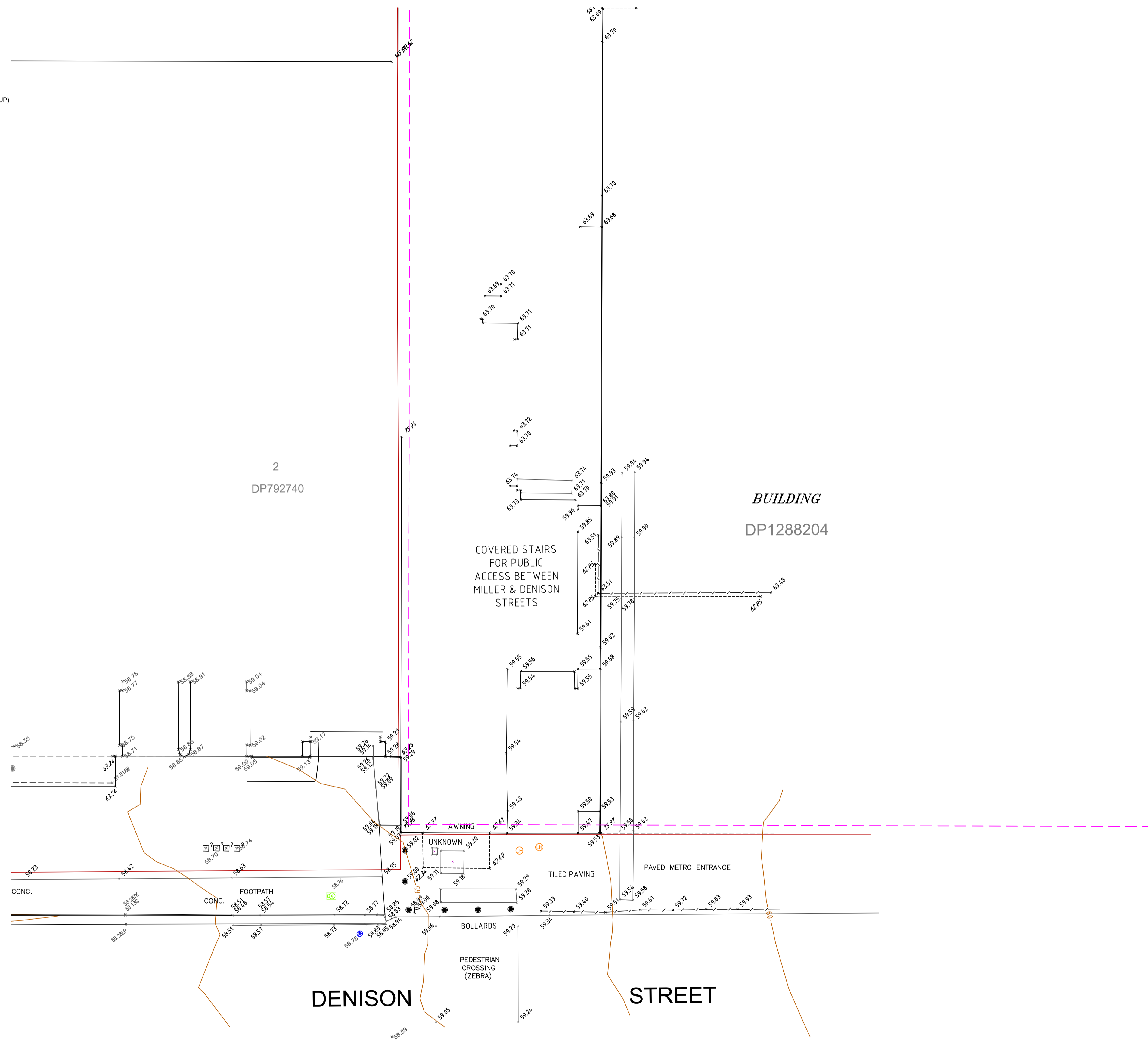
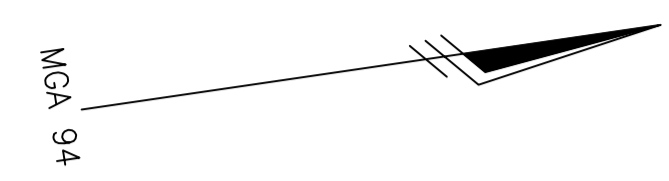

| NO. | DATE | REVISION DETAILS | DRAWN | CHK | APP |
|-----|------------|---|-------|-----|-----|
| D | 28.08.2025 | ADD VICTORIA CROSS METRO STATION SOUTHERN SHAFT | HY | TC | GE |
| C | 2.12.2024 | SURVEY EXTENTS, SHEET LAYOUT AND CONTOURS AMENDED | LB | TC | GE |
| B | 29.11.2024 | 2019 SURVEY ADDED (WHITELEY LANE & DENISON ST) | LB | TC | GE |
| A | 11.05.2022 | INITIAL PLAN | LB | JC | GE |

| | |
|--------------------------|-----------------------|
| HORIZ. SCALE: 1:100 @ A1 | VERT. SCALE: N/A @ A1 |
| COORDINATES: MGA94 | DATUM: AHD71 |
| ORIGIN: PM74608 | ORIGIN: PM74608 |

NOTES

EXPLANATORY NOTES ON SHEET 1 ARE APPLICABLE TO ALL SHEETS ON THIS PLAN

| | |
|--------------|-----------------------------|
| CLIENT: | |
| SURVEY: AF | DATE OF SURVEY: 3.05.2022 |
| DRAWN: LB | DATE OF PLAN: 07.05.2020 |
| CHECKED: JC | DATE LAST SAVED: 28.08.2025 |
| APPROVED: GE | DATE APPROVED: 07.05.2020 |

TITLE

CONTOUR & DETAIL SURVEY

Miller Street, North Sydney

DRAWING No: PR144264-DET-002-C.dwg

| | |
|----------------------|----------|
| JOB No: PR144264-08 | ISSUE: D |
| | |
| SHEET 7 OF 10 SHEETS | SIZE: A1 |

COPYRIGHT © RPS AAP CONSULTING PTY LTD. INFORMATION CONTAINED IN THIS DRAWING IS THE PROPERTY OF RPS AAP CONSULTING PTY LTD. COPYING OR USING THIS DATA IN WHOLE OR PART, WITHOUT PERMISSION INFRINGES COPYRIGHT. THIS DOCUMENT IN BOTH ELECTRONIC AND HARD COPY FORM IS AND SHALL REMAIN THE PROPERTY OF RPS AAP CONSULTING PTY LTD. THE INFORMATION MAY ONLY BE USED FOR THE PURPOSE FOR WHICH IT WAS COMMISSIONED AND IN ACCORDANCE WITH THE TERMS OF ENGAGEMENT FOR THE COMMISSION. UNAUTHORISED USE OF THIS INFORMATION IN ANY FORM WHATSOEVER IS PROHIBITED.