

## Memorandum

To	Scott Eggleton
Date	12 November 2025
Copies	Rosanna Petteno (PPC), Greg Hastie (PLC)
Reference number	
From	Andrew Johnson
File reference	
Subject	Pymble Ladies College SIP Structural Engineering Impact of Building Shift to the East

---

### Introduction

Arup have been requested to provide commentary regarding the potential structural issues associated with relocating the building to the east/south-east of the currently proposed location.

### Commentary

With reference to Figure 1 below, the currently proposed location of the SIP building is located immediately adjacent to the existing access road that circumnavigates the sporting oval immediately to the east of the development site.

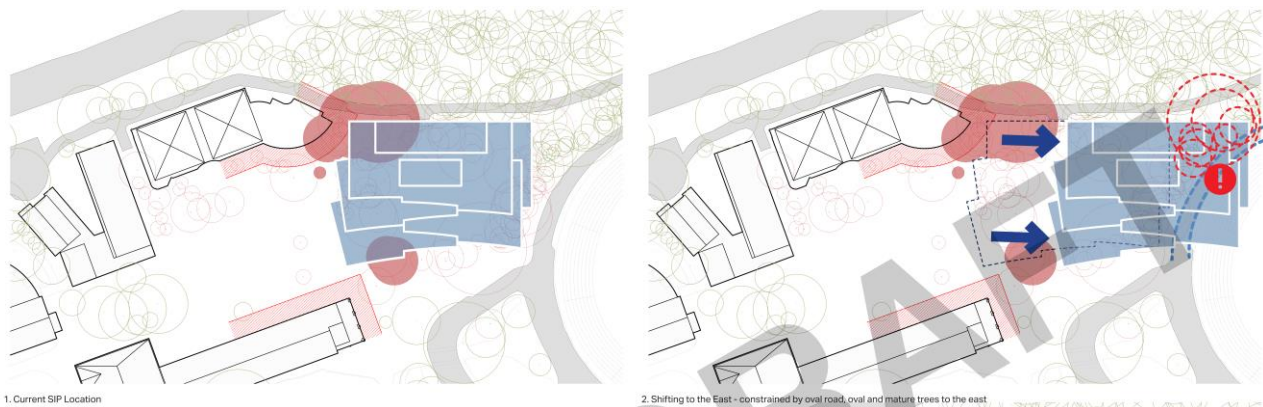

**Figure 1: Currently proposed SIP location (left) and indicative eastern relocation (right)**

Due to the topography of the development site, the south-east corner of the proposed building adjacent the existing road is the highest point, with the development site sloping downward from south-east to north-west.

With existing utility services that serve the campus located below the footpath immediately west of the roadway, the proposed new building excavation has been located as far east as possible (as close to the existing road), including the need to provide a piled shoring wall (refer Figure 2) immediately adjacent to these services to allow vertical excavation whilst maintaining the operation of these services and the access road.

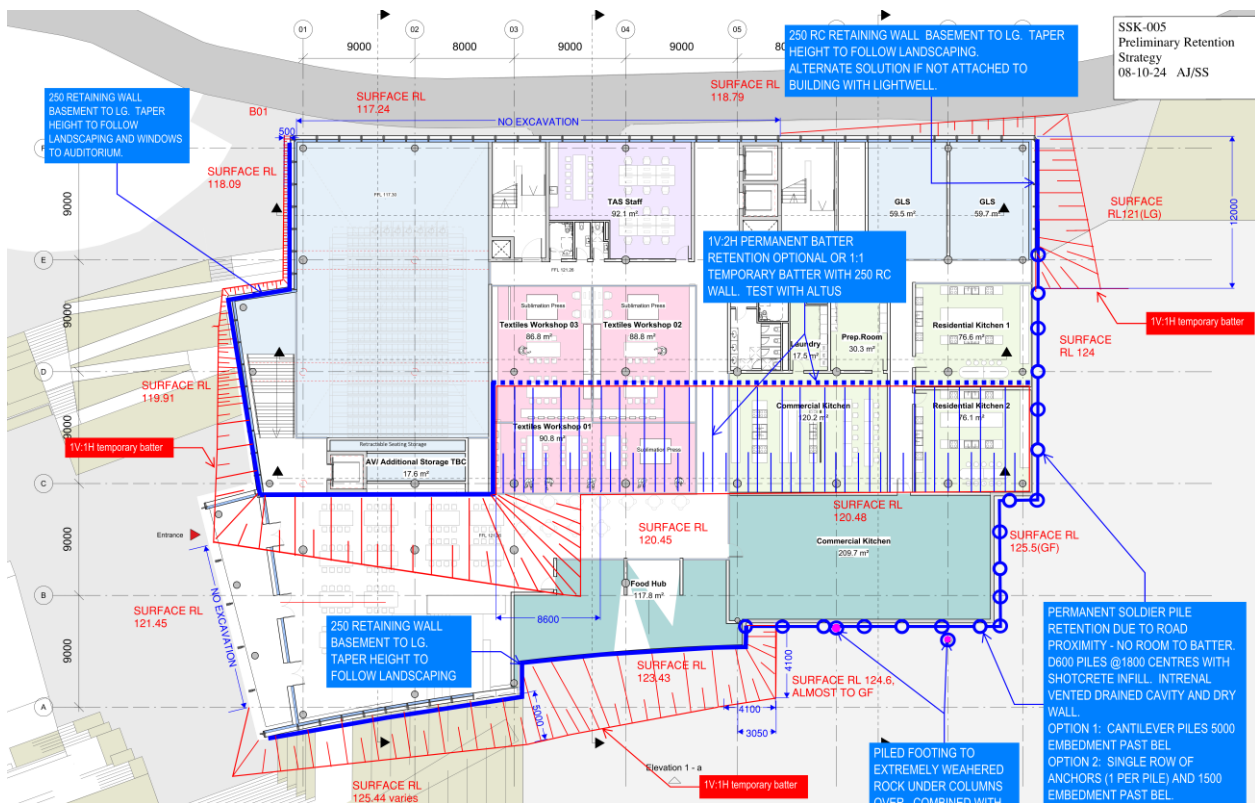

Figure 2: Preliminary retention plan – Arup

Any relocation of the building further to the east or southeast will require **permanent** relocation of these services and access road for both basement excavation and foundation construction.

The results of the geotechnical report prepared by JK also indicate the depth to rock increasing to the east, with the necessary retention systems likely to be more onerous if the building is moved in this direction. It is also likely that the extent of earthworks batter of piled wall on the eastern boundary would extend to the north with the building further embedded.