

STAGE 1

NOTE:
 This plan was prepared for the client as an indicative subdivision plan to accompany a development application to Shoalhaven City Council.
 The information shown on this plan is not suitable for any other purpose.
 The property dimensions, contours and other physical features have been compiled from existing information and limited field survey. The proposed development and internal boundaries have been sited per drawing file x1mpa.dwg, supplied by Sparc Development Pty Ltd on 03.02.2025.
 The dimensions, areas and total number of lots shown on this plan are subject to further field survey at subdivision certificate stage and also to the requirements of Council and any other authority which may have requirements under any relevant legislation.
 In particular, no reliance should be placed on the information on this plan for detailed subdivision design or for any financial dealings involving the land.
 Allen Price Pty Ltd therefore disclaims any liability for any loss or damage whatsoever or howsoever incurred, arising from any party using or relying upon this plan for any purpose other than as a document prepared for the sole purpose of accompanying an application to council for development and which may be subject to alteration for reasons beyond the control of Allen Price Pty Ltd.
 Unless stamped by Council, this plan is not a plan of an approved subdivision.
 This note is an integral part of this plan.

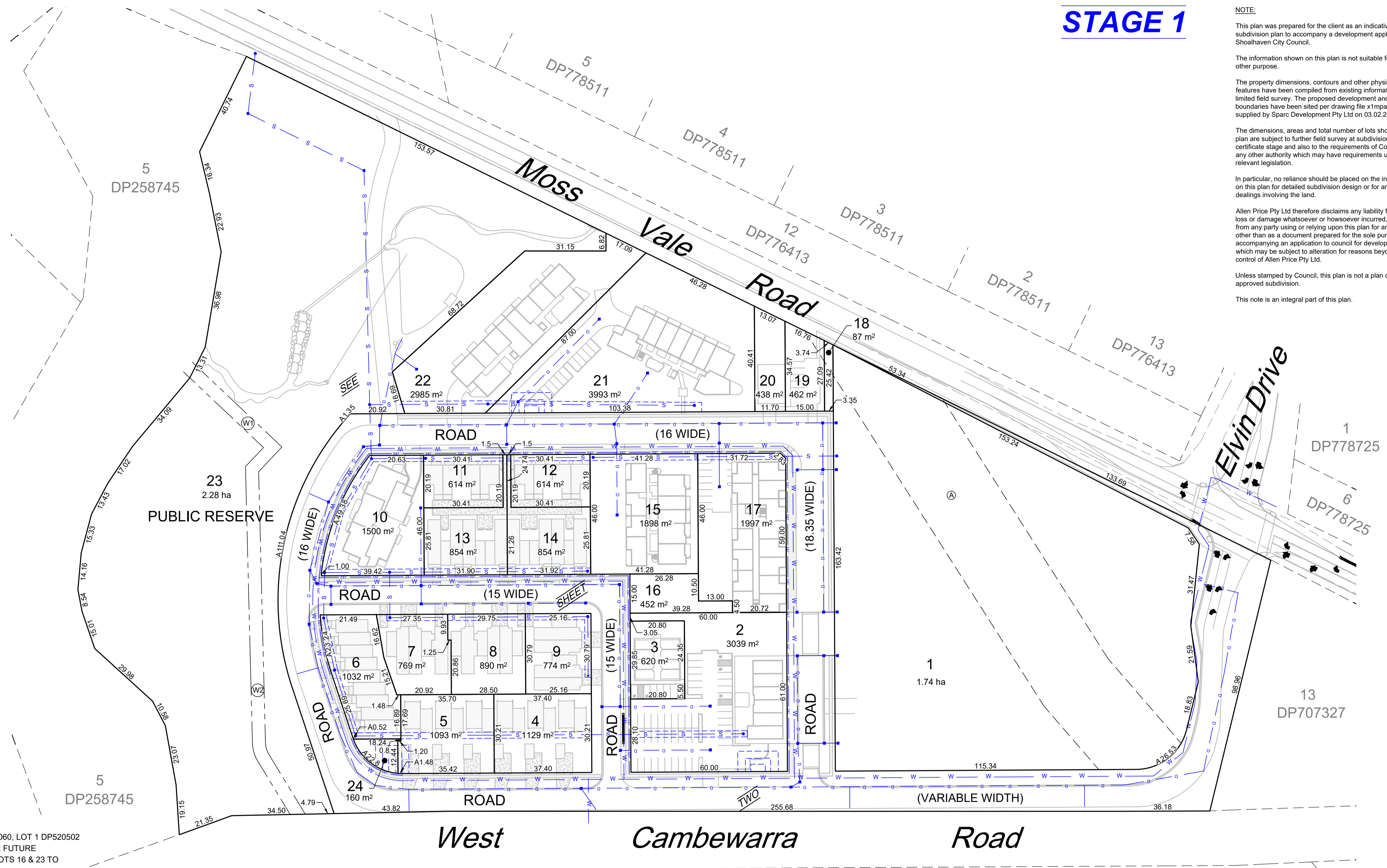

NOTE:
 STAGE 1 IS A SUBDIVISION OF LOT 129 DP3060, LOT 1 DP520502 & LOT 110 DP131219 INTO SUPER LOTS FOR FUTURE DEVELOPMENT AND THE DEDICATION OF LOTS 16 & 23 TO PUBLIC AS PUBLIC RESERVE.

FOLLOWING COMPLETION OF THE STAGE 1 SUBDIVISION, SUBSEQUENT STAGES 2-11 CAN BE DEVELOPED AND RELEASED IN ANY ORDER

- S — S — S — DENOTES PROPOSED SEWER MAIN (N27790-407-415 REV 2 DATED 15.09.2025)
- W — DENOTES PROPOSED WATER MAIN (N27790-407-415 REV 2 DATED 15.09.2025)
- D — D — DENOTES PROPOSED STORMWATER PIPE (N27790-407-415 REV 2 DATED 15.09.2025)
- E — E — DENOTES PROPOSED ELECTRICAL / COMMS ROUTE (N27790-407-415 REV 2 DATED 15.09.2025)
- DENOTES PROPOSED STORMWATER PIT (N27790-407-415 REV 2 DATED 15.09.2025)

- (A) EASEMENT FOR TRANSMISSION LINE 30.48 WIDE (G858188)
- (W1) EASEMENT FOR WATER MAIN 5 WIDE (AT526683) (DP1289655)
- (W2) EASEMENT FOR WATER MAIN 5 WIDE (AT526682) (DP1289655)

BEWARE!
 THE CONTRACTOR IS TO VERIFY THE LOCATION OF ALL EXISTING SERVICES PRIOR TO COMMENCEMENT OF CONSTRUCTION AND SHALL BE RESPONSIBLE, AT THE CONTRACTOR'S EXPENSE, FOR ANY REPAIRS TO DAMAGE CAUSED DURING CONSTRUCTION.



STAGE 1 SUBDIVISION - 23 LOTS
PROPOSED STAGED TORRENS TITLE SUBDIVISION
 Over Lot 129 DP3060, Lot 1 DP520502 & Lot 110 DP131219
 At 25 Moss Vale Road, Bomaderry
 For Southern Cross Community Housing c/o Homa Advisory

ISSUE	DESCRIPTION	BY	DATE
0	INITIAL ISSUE	AE	30.03.2026
1	ADDITIONAL STAGE 1 LOT	AE	13.04.2026

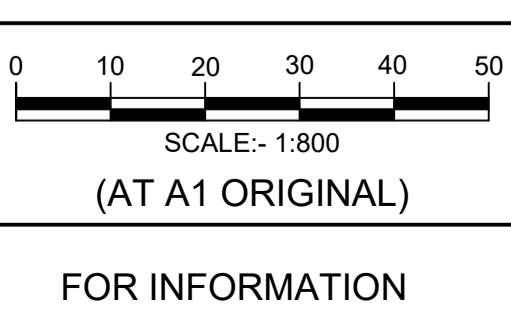

SURVEY	DESIGN	DRAWN	CHECK'D	DATUM
-	-	AE	TL	NOT APPLICABLE

ALLEN PRICE PTY LTD
 Nowra Office • 75 Plunkett St, Nowra NSW 2541
 Kiama Office • 1/28 Bong Bong St, Kiama NSW 2533
 Wollongong Office • SE 1 L2 83-85 Market St, Wollongong NSW 2500
 (02) 4421 6544 • consultants@allenprice.com.au • allenprice.com.au

ORIGIN	DATE OF SURVEY	DRAWING NUMBER	SHEET	ISSUE
N/A	NOT APPLICABLE	N27790-08	01/10	1



M:\CAD Files - Projects\N27790 Drawings\N27790-08 STAGED SUBDIVISION PLANS.dwg

NOTE:

This plan was prepared for the client as an indicative subdivision plan to accompany a development application to Shoalhaven City Council.

The information shown on this plan is not suitable for any other purpose.

The property dimensions, contours and other physical features have been compiled from existing information and limited field survey. The proposed development and internal boundaries have been sited per drawing file x1mpa.dwg, supplied by Sparc Development Pty Ltd on 03.02.2026

The dimensions, areas and total number of lots shown on this plan are subject to further field survey at subdivision certificate stage and also to the requirements of Council and any other authority which may have requirements under any relevant legislation.

In particular, no reliance should be placed on the information on this plan for detailed subdivision design or for any financial dealings involving the land.

Allen Price Pty Ltd therefore disclaims any liability for any loss or damage whatsoever or howsoever incurred, arising from any party using or relying upon this plan for any purpose other than as a document prepared for the sole purpose of accompanying an application to council for development and which may be subject to alteration for reasons beyond the control of Allen Price Pty Ltd.

Unless stamped by Council, this plan is not a plan of an approved subdivision.

This note is an integral part of this plan.

NOTE:

STAGE 1 IS A SUBDIVISION OF LOT 129 DP3060, LOT 1 DP520502 & LOT 110 DP131219 INTO SUPER LOTS FOR FUTURE DEVELOPMENT AND THE DEDICATION OF LOTS 16 & 23 TO PUBLIC AS PUBLIC RESERVE.

FOLLOWING COMPLETION OF THE STAGE 1 SUBDIVISION, SUBSEQUENT STAGES 2-11 CAN BE DEVELOPED AND RELEASED IN ANY ORDER

- S - S - S - DENOTES PROPOSED SEWER MAIN (N27790-407-415 REV 2 DATED 15.09.2025)
- W - W - W - DENOTES PROPOSED WATER MAIN (N27790-407-415 REV 2 DATED 15.09.2025)
- D - D - D - DENOTES PROPOSED STORMWATER PIPE (N27790-407-415 REV 2 DATED 15.09.2025)
- E - E - E - DENOTES PROPOSED ELECTRICAL / COMMS ROUTE (N27790-407-415 REV 2 DATED 15.09.2025)
- DENOTES PROPOSED STORMWATER PIT (N27790-407-415 REV 2 DATED 15.09.2025)

- (A) EASEMENT FOR TRANSMISSION LINE 30.48 WIDE (G858188)
- (W1) EASEMENT FOR WATER MAIN 5 WIDE (AT526683) (DP1289655)
- (W2) EASEMENT FOR WATER MAIN 5 WIDE (AT526682) (DP1289655)
- (P) PROPOSED EASEMENT FOR PADMOUNT SUBSTATION 2.75 WIDE
- (R1) PROPOSED RESTRICTION ON THE USE OF LAND
- (R2) PROPOSED RESTRICTION ON THE USE OF LAND
- (S1) PROPOSED EASEMENT FOR SEWER MAIN VARIABLE WIDTH
- (S2) PROPOSED EASEMENT FOR SEWER MAIN 2.4 WIDE

BEWARE!

THE CONTRACTOR IS TO VERIFY THE LOCATION OF ALL EXISTING SERVICES PRIOR TO COMMENCEMENT OF CONSTRUCTION AND SHALL BE RESPONSIBLE, AT THE CONTRACTOR'S EXPENSE, FOR ANY REPAIRS TO DAMAGE CAUSED DURING CONSTRUCTION.

STAGE 1

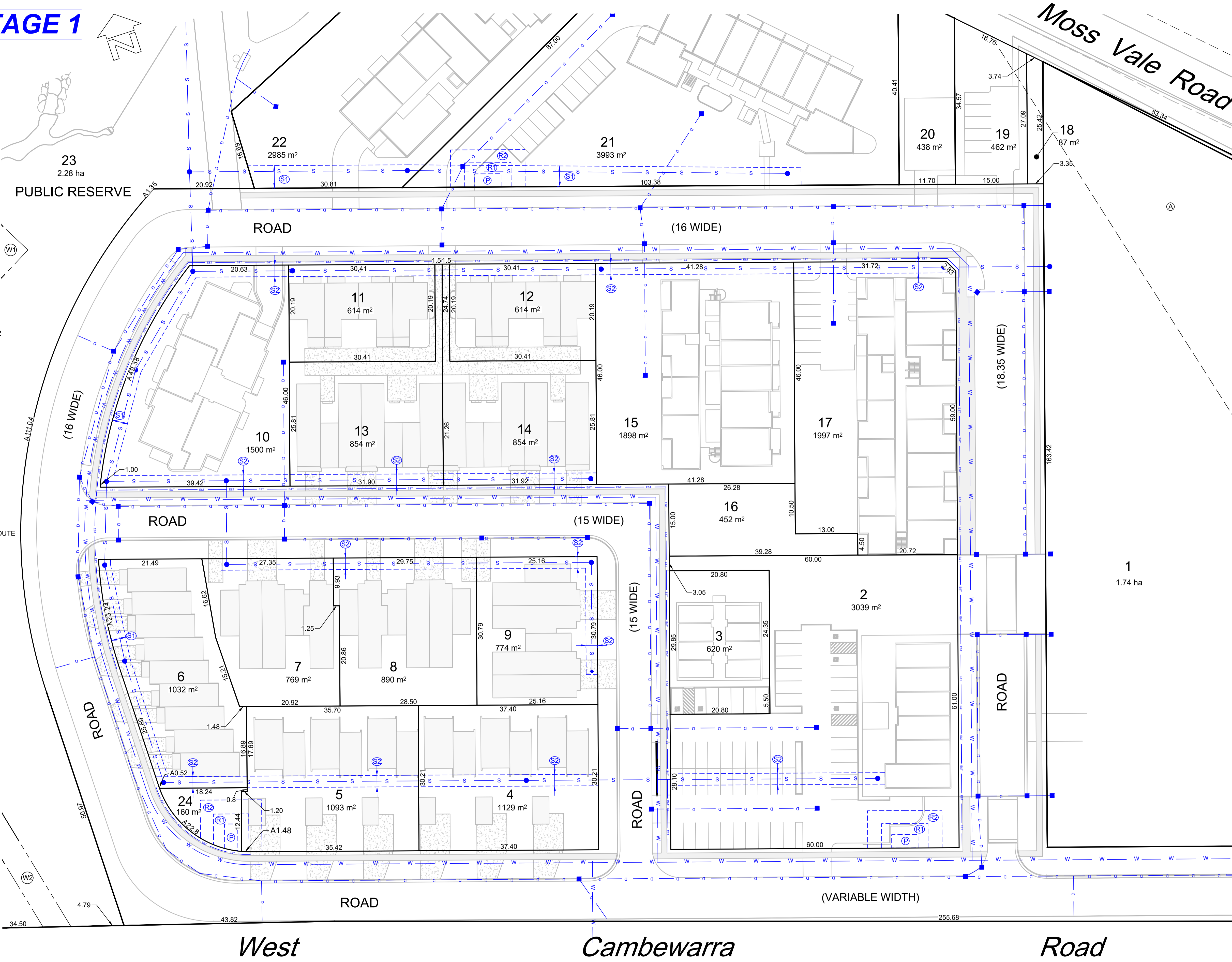

STAGE 1 SUBDIVISION - 23 LOTS
PROPOSED STAGED TORRENS TITLE SUBDIVISION
 Over Lot 129 DP3060, Lot 1 DP520502 & Lot 110 DP131219
 At 25 Moss Vale Road, Bomaderry
 For Southern Cross Community Housing c/o Homa Advisory

ISSUE	DESCRIPTION	BY	DATE
0	INITIAL ISSUE	AE	30.03.2026
1	ADDITIONAL STAGE 1 LOT	AE	13.04.2026

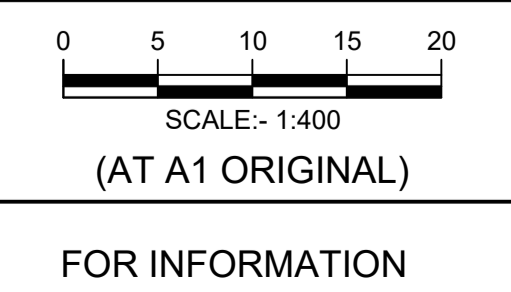

SURVEY	DESIGN	DRAWN	CHECK'D	DATUM
-	-	AE	TL	AS SHOWN

ALLEN PRICE PTY LTD
 Nowra Office • 75 Plunkett St, Nowra NSW 2541
 Kiama Office • 1/28 Bong Bong St, Kiama NSW 2533
 Wollongong Office • SE 1 L2 83-85 Market St, Wollongong NSW 2500
 (02) 4421 6544 • consultants@allenprice.com.au • allenprice.com.au

DATE OF SURVEY	ORIGIN	SHEET	ISSUE
NOT APPLICABLE	N/A	02/10	1

DRAWING NUMBER: N27790-08

Liability limited by a scheme approved under Professional Standards Legislation

M:\CAD Files - Projects\N27790 - Drawings\N27790-08 STAGED SUBDIVISION PLANS.dwg

NOTE:

This plan was prepared for the client as an indicative subdivision plan to accompany a development application to Shoalhaven City Council.

The information shown on this plan is not suitable for any other purpose.

The property dimensions, contours and other physical features have been compiled from existing information and limited field survey. The proposed development and internal boundaries have been sited per drawing file x1mpa.dwg, supplied by Sparc Development Pty Ltd on 03.02.2026

The dimensions, areas and total number of lots shown on this plan are subject to further field survey at subdivision certificate stage and also to the requirements of Council and any other authority which may have requirements under any relevant legislation.

In particular, no reliance should be placed on the information on this plan for detailed subdivision design or for any financial dealings involving the land.

Allen Price Pty Ltd therefore disclaims any liability for any loss or damage whatsoever or howsoever incurred, arising from any party using or relying upon this plan for any purpose other than as a document prepared for the sole purpose of accompanying an application to council for development and which may be subject to alteration for reasons beyond the control of Allen Price Pty Ltd.

Unless stamped by Council, this plan is not a plan of an approved subdivision.

This note is an integral part of this plan.

STAGE 2

SUBDIVISION OF LOT 6 FROM STAGE 1

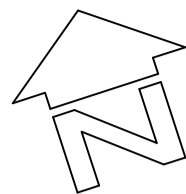

- S — S — S — DENOTES PROPOSED SEWER MAIN (N27790-407-415 REV 2 DATED 15.09.2025)
 - W — W — W — DENOTES PROPOSED WATER MAIN (N27790-407-415 REV 2 DATED 15.09.2025)
 - D — D — D — DENOTES PROPOSED STORMWATER PIPE (N27790-407-415 REV 2 DATED 15.09.2025)
 - E — E — E — DENOTES PROPOSED ELECTRICAL / COMMS ROUTE (N27790-407-415 REV 2 DATED 15.09.2025)
 - DENOTES PROPOSED STORMWATER PIT (N27790-407-415 REV 2 DATED 15.09.2025)
- CONSTRUCTED IN PREVIOUS STAGE

- Ⓟ PROPOSED EASEMENT FOR PADMOUNT SUBSTATION 2.75 WIDE (STAGE 1)
- Ⓡ1 PROPOSED RESTRICTION ON THE USE OF LAND (STAGE 1)
- Ⓡ2 PROPOSED RESTRICTION ON THE USE OF LAND (STAGE 1)
- Ⓢ1 PROPOSED EASEMENT FOR SEWER MAIN VARIABLE WIDTH (STAGE 1)
- Ⓢ2 PROPOSED EASEMENT FOR SEWER MAIN 2.4 WIDE (STAGE 1)
- Ⓜ1 PROPOSED EASEMENT FOR MAINTENANCE & SUPPORT 0.3 WIDE

BEWARE!
THE CONTRACTOR IS TO VERIFY THE LOCATION OF ALL EXISTING SERVICES PRIOR TO COMMENCEMENT OF CONSTRUCTION AND SHALL BE RESPONSIBLE, AT THE CONTRACTOR'S EXPENSE, FOR ANY REPAIRS TO DAMAGE CAUSED DURING CONSTRUCTION.



STAGE 2 SUBDIVISION - 9 LOTS
PROPOSED STAGED TORRENS TITLE SUBDIVISION
Over Lot 129 DP3060, Lot 1 DP520502 & Lot 110 DP131219
At 25 Moss Vale Road, Bomaderry
For Southern Cross Community Housing c/o Homa Advisory

ISSUE	DESCRIPTION	BY	DATE
0	INITIAL ISSUE	AE	30.03.2026
1	ADDITIONAL STAGE 1 LOT	AE	13.04.2026

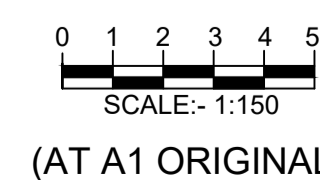

FOR INFORMATION

SURVEY	DESIGN	DRAWN	CHECK'D	DATUM
-	-	AE	TL	AS SHOWN

ALLEN PRICE PTY LTD
Nowra Office • 75 Plunkett St, Nowra NSW 2541
Kiama Office • 1/28 Bong Bong St, Kiama NSW 2533
Wollongong Office • SE 1 L2 83-85 Market St, Wollongong NSW 2500
(02) 4421 6544 • consultants@allenprice.com.au • allenprice.com.au

DATE OF SURVEY	DRAWING NUMBER
NOT APPLICABLE	N27790-08

ORIGIN	SHEET	ISSUE
N/A	03/10	1

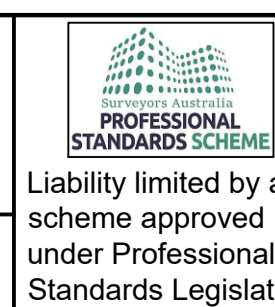

Liability limited by a scheme approved under Professional Standards Legislation

23
(STAGE 1)

ROAD

ROAD

(15 WIDE)

(16 WIDE)

7
(STAGE 1)

24
(STAGE 1)

5
(STAGE 1)

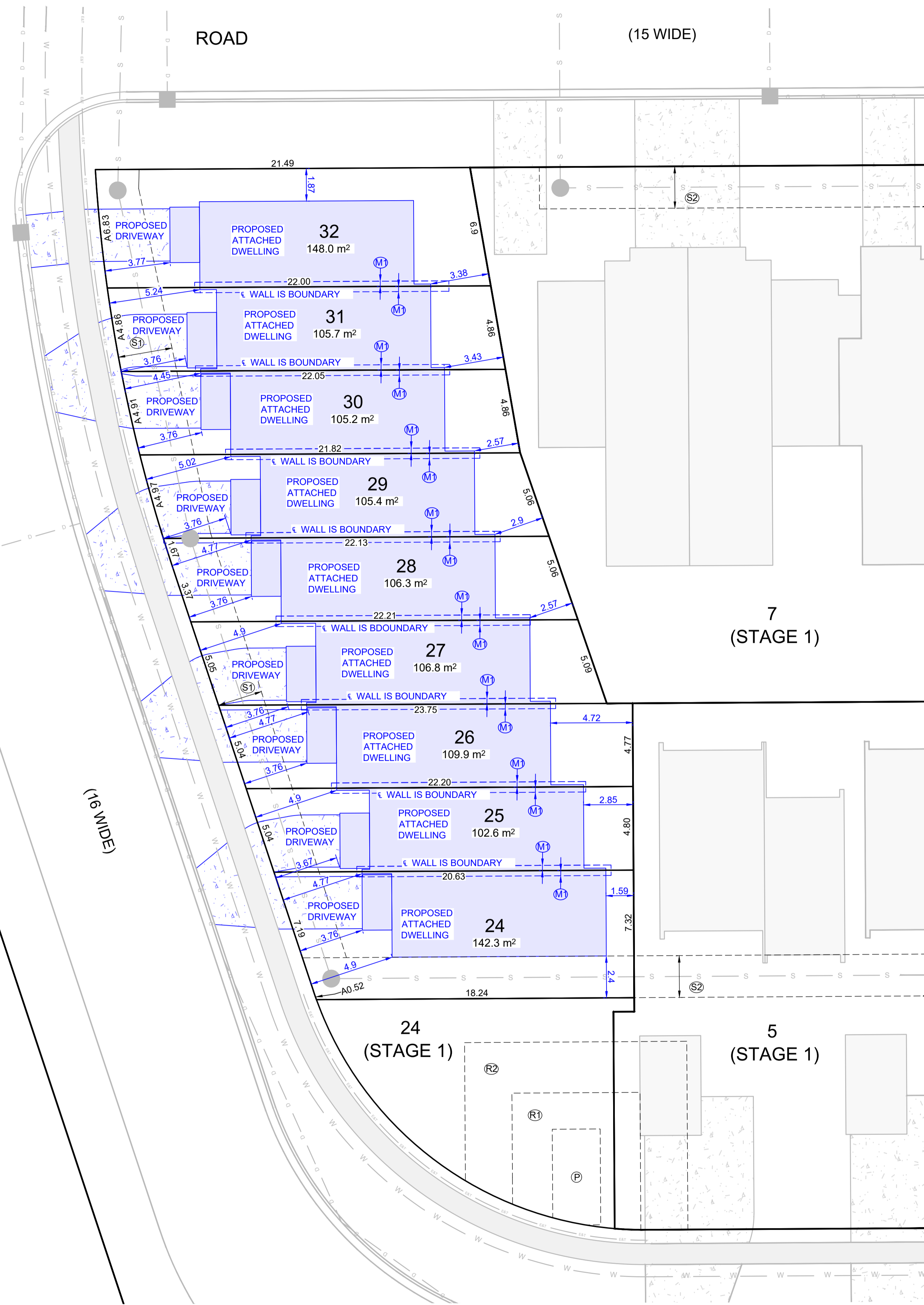

NOTE:

This plan was prepared for the client as an indicative subdivision plan to accompany a development application to Shoalhaven City Council.

The information shown on this plan is not suitable for any other purpose.

The property dimensions, contours and other physical features have been compiled from existing information and limited field survey. The proposed development and internal boundaries have been sited per drawing file x1mpa.dwg, supplied by Sparc Development Pty Ltd on 03.02.2026

The dimensions, areas and total number of lots shown on this plan are subject to further field survey at subdivision certificate stage and also to the requirements of Council and any other authority which may have requirements under any relevant legislation.

In particular, no reliance should be placed on the information on this plan for detailed subdivision design or for any financial dealings involving the land.

Allen Price Pty Ltd therefore disclaims any liability for any loss or damage whatsoever or howsoever incurred, arising from any party using or relying upon this plan for any purpose other than as a document prepared for the sole purpose of accompanying an application to council for development and which may be subject to alteration for reasons beyond the control of Allen Price Pty Ltd.

Unless stamped by Council, this plan is not a plan of an approved subdivision.

This note is an integral part of this plan.

NOTE:

STAGE 1 IS A SUBDIVISION OF LOT 129 DP3060, LOT 1 DP520502 & LOT 110 DP131219 INTO SUPER LOTS FOR FUTURE DEVELOPMENT AND THE DEDICATION OF LOTS 16 & 23 TO PUBLIC AS PUBLIC RESERVE.

FOLLOWING COMPLETION OF THE STAGE 1 SUBDIVISION, SUBSEQUENT STAGES 2-11 CAN BE DEVELOPED AND RELEASED IN ANY ORDER

- DENOTES PROPOSED SEWER MAIN (N27790-407-415 REV 2 DATED 15.09.2025)
 - DENOTES PROPOSED WATER MAIN (N27790-407-415 REV 2 DATED 15.09.2025)
 - DENOTES PROPOSED STORMWATER PIPE (N27790-407-415 REV 2 DATED 15.09.2025)
 - DENOTES PROPOSED ELECTRICAL / COMMS ROUTE (N27790-407-415 REV 2 DATED 15.09.2025)
 - DENOTES PROPOSED STORMWATER PIT (N27790-407-415 REV 2 DATED 15.09.2025)
- CONSTRUCTED IN PREVIOUS STAGE

PROPOSED EASEMENT FOR SEWER MAIN 2.4 WIDE (STAGE 1)

PROPOSED EASEMENT FOR MAINTENANCE & SUPPORT 0.3 WIDE

PROPOSED EASEMENT FOR MAINTENANCE 1.0 WIDE

BEWARE!

THE CONTRACTOR IS TO VERIFY THE LOCATION OF ALL EXISTING SERVICES PRIOR TO COMMENCEMENT OF CONSTRUCTION AND SHALL BE RESPONSIBLE, AT THE CONTRACTOR'S EXPENSE, FOR ANY REPAIRS TO DAMAGE CAUSED DURING CONSTRUCTION.

STAGE 3

SUBDIVISION OF LOT 7 FROM STAGE 1

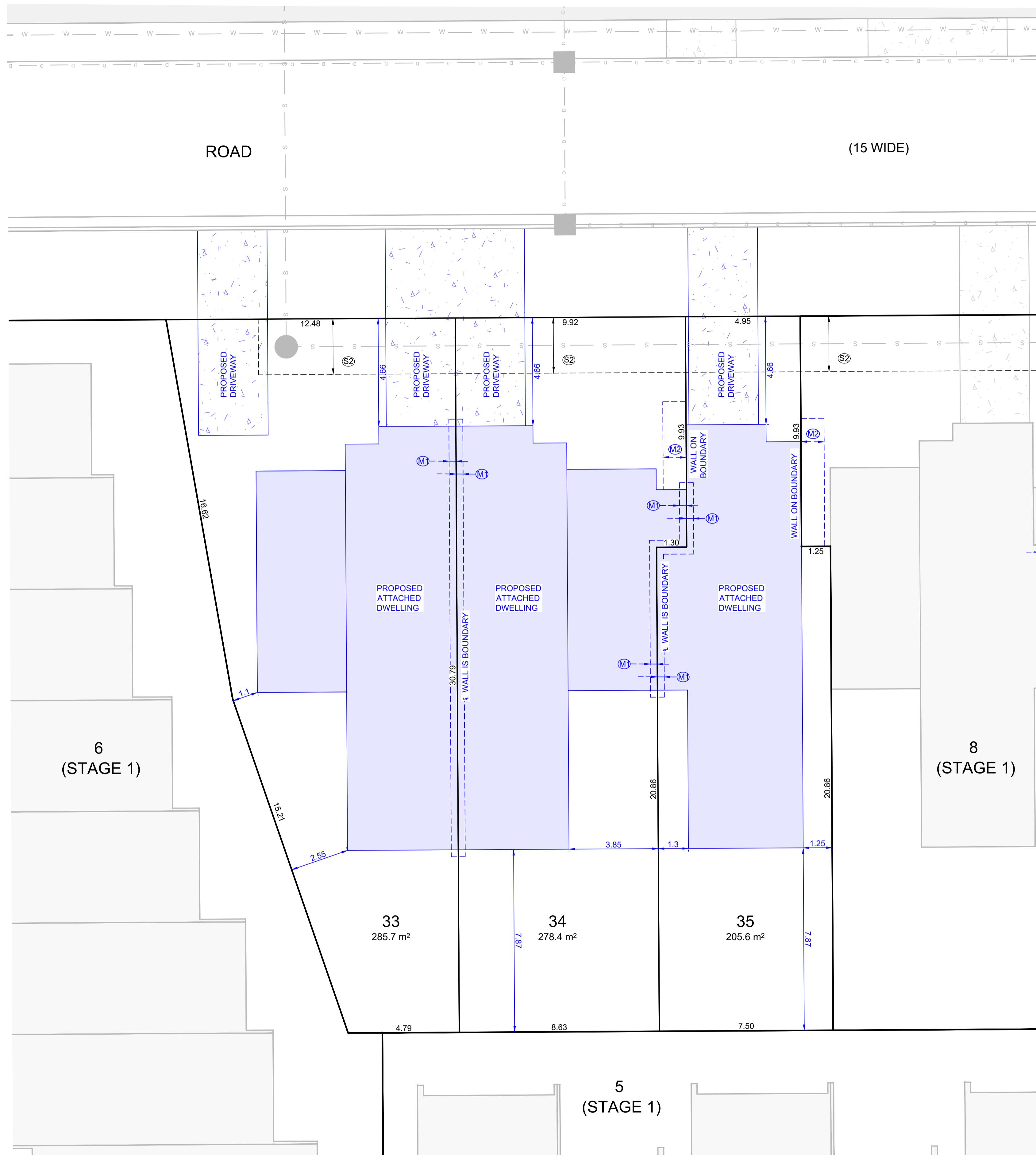
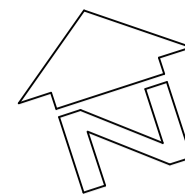

STAGE 3 SUBDIVISION - 3 LOTS
PROPOSED STAGED TORRENS TITLE SUBDIVISION
 Over Lot 129 DP3060, Lot 1 DP520502 & Lot 110 DP131219
 At 25 Moss Vale Road, Bomaderry
 For Southern Cross Community Housing c/o Homa Advisory

ISSUE	DESCRIPTION	BY	DATE
0	INITIAL ISSUE	AE	30.03.2026
AE	ADDITIONAL STAGE 1 LOT	AE	13.04.2026

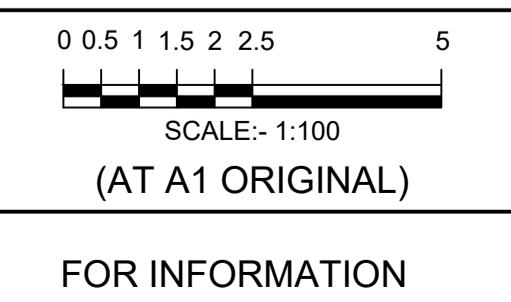

SURVEY	DESIGN	DRAWN	CHECK'D	DATUM
-	-	AE	TL	AS SHOWN

ALLEN PRICE PTY LTD
 Nowra Office • 75 Plunkett St, Nowra NSW 2541
 Kiama Office • 1/28 Bong Bong St, Kiama NSW 2533
 Wollongong Office • SE 1 L2 83-85 Market St, Wollongong NSW 2500
 (02) 4421 6544 • consultants@allenprice.com.au • allenprice.com.au

DATUM	ORIGIN	SHEET	ISSUE
AS SHOWN	N/A	04/10	1



NOTE:

This plan was prepared for the client as an indicative subdivision plan to accompany a development application to Shoalhaven City Council.

The information shown on this plan is not suitable for any other purpose.

The property dimensions, contours and other physical features have been compiled from existing information and limited field survey. The proposed development and internal boundaries have been sited per drawing file x1mpa.dwg, supplied by Sparc Development Pty Ltd on 03.02.2026

The dimensions, areas and total number of lots shown on this plan are subject to further field survey at subdivision certificate stage and also to the requirements of Council and any other authority which may have requirements under any relevant legislation.

In particular, no reliance should be placed on the information on this plan for detailed subdivision design or for any financial dealings involving the land.

Allen Price Pty Ltd therefore disclaims any liability for any loss or damage whatsoever or howsoever incurred, arising from any party using or relying upon this plan for any purpose other than as a document prepared for the sole purpose of accompanying an application to council for development and which may be subject to alteration for reasons beyond the control of Allen Price Pty Ltd.

Unless stamped by Council, this plan is not a plan of an approved subdivision.

This note is an integral part of this plan.

STAGE 4

SUBDIVISION OF LOT 8 FROM STAGE 1

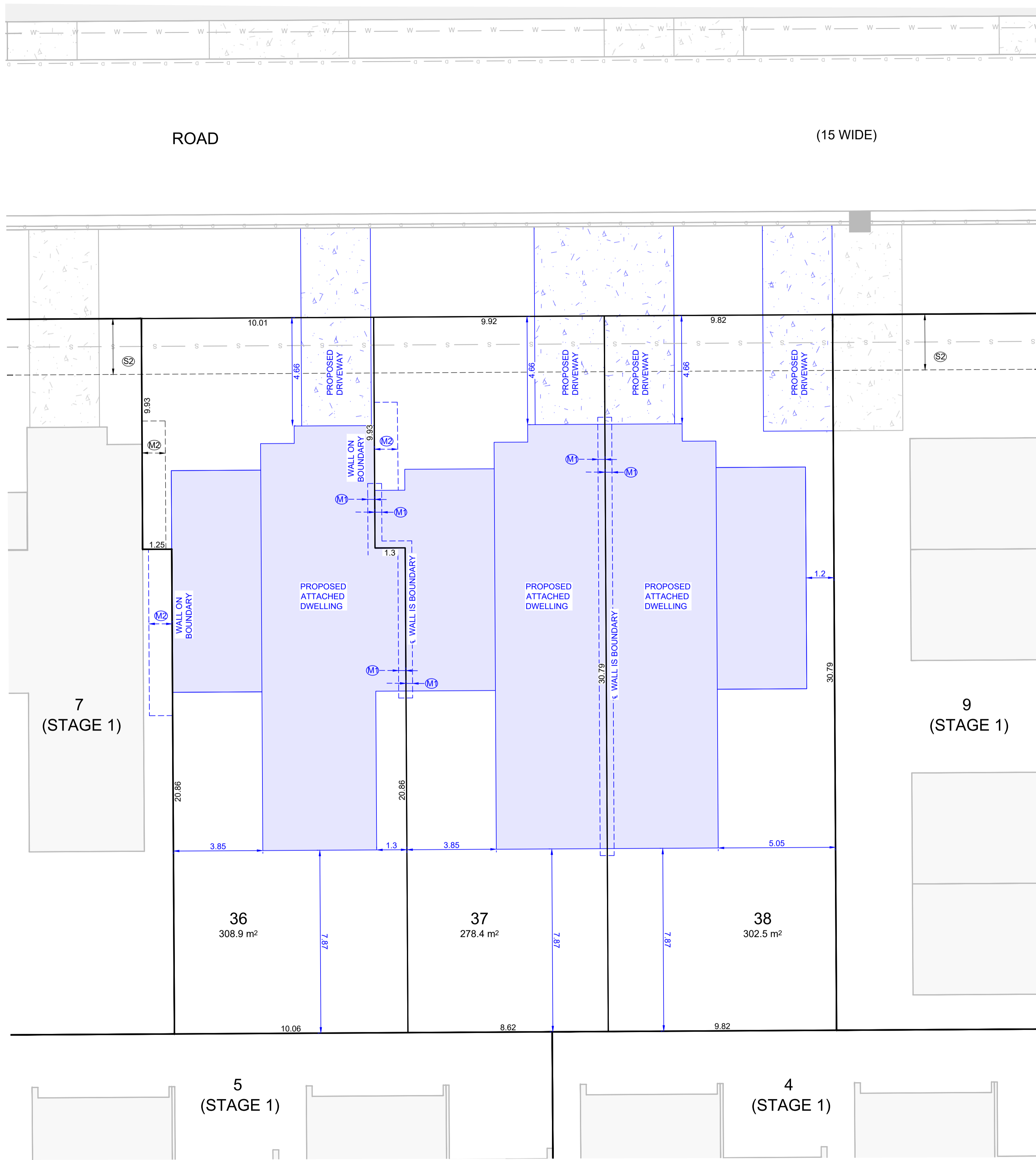
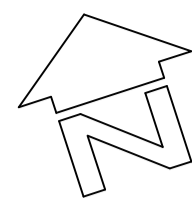

- S — S — S — DENOTES PROPOSED SEWER MAIN (N27790-407-415 REV 2 DATED 15.09.2025)
 - W — — — — DENOTES PROPOSED WATER MAIN (N27790-407-415 REV 2 DATED 15.09.2025)
 - D — D — — — DENOTES PROPOSED STORMWATER PIPE (N27790-407-415 REV 2 DATED 15.09.2025)
 - — — — — DENOTES PROPOSED ELECTRICAL / COMMS ROUTE (N27790-407-415 REV 2 DATED 15.09.2025)
 - DENOTES PROPOSED STORMWATER PIT (N27790-407-415 REV 2 DATED 15.09.2025)
- CONSTRUCTED IN PREVIOUS STAGE

- Ⓢ PROPOSED EASEMENT FOR SEWER MAIN 2.4 WIDE (STAGE 1)
- Ⓜ PROPOSED EASEMENT FOR MAINTENANCE (STAGE 3)
- Ⓜ PROPOSED EASEMENT FOR MAINTENANCE & SUPPORT 0.3 WIDE
- Ⓜ PROPOSED EASEMENT FOR MAINTENANCE 1.0 WIDE

BEWARE!
THE CONTRACTOR IS TO VERIFY THE LOCATION OF ALL EXISTING SERVICES PRIOR TO COMMENCEMENT OF CONSTRUCTION AND SHALL BE RESPONSIBLE, AT THE CONTRACTOR'S EXPENSE, FOR ANY REPAIRS TO DAMAGE CAUSED DURING CONSTRUCTION.

STAGE 4 SUBDIVISION - 3 LOTS

PROPOSED STAGED TORRENS TITLE SUBDIVISION

Over Lot 129 DP3060, Lot 1 DP520502 & Lot 110 DP131219

At 25 Moss Vale Road, Bomaderry

For Southern Cross Community Housing c/o Homa Advisory

ISSUE	DESCRIPTION	BY	DATE
0	INITIAL ISSUE	AE	30.03.2026
1	ADDITIONAL STAGE 1 LOT	AE	13.04.2026

0 0.5 1 1.5 2 2.5 5

SCALE:- 1:100

(AT A1 ORIGINAL)

FOR INFORMATION

SURVEY	DESIGN	DRAWN	CHECK'D	DATUM	ORIGIN
-	-	AE	TL	AS SHOWN	N/A
ALLEN PRICE PTY LTD Nowra Office • 75 Plunkett St, Nowra NSW 2541 Kiama Office • 1/28 Bong Bong St, Kiama NSW 2533 Wollongong Office • SE 1 L2 83-85 Market St, Wollongong NSW 2500 (02) 4421 6544 • consultants@allenprice.com.au • allenprice.com.au				DATE OF SURVEY NOT APPLICABLE	SHEET 05/10
				DRAWING NUMBER N27790-08	

Liability limited by a scheme approved under Professional Standards Legislation

M:\CAD Files - Projects\N27790 Drawings\N27790-08 STAGED SUBDIVISION PLANS.dwg

NOTE:

This plan was prepared for the client as an indicative subdivision plan to accompany a development application to Shoalhaven City Council.

The information shown on this plan is not suitable for any other purpose.

The property dimensions, contours and other physical features have been compiled from existing information and limited field survey. The proposed development and internal boundaries have been sited per drawing file x1mpa.dwg, supplied by Sparc Development Pty Ltd on 03.02.2026

The dimensions, areas and total number of lots shown on this plan are subject to further field survey at subdivision certificate stage and also to the requirements of Council and any other authority which may have requirements under any relevant legislation.

In particular, no reliance should be placed on the information on this plan for detailed subdivision design or for any financial dealings involving the land.

Allen Price Pty Ltd therefore disclaims any liability for any loss or damage whatsoever or howsoever incurred, arising from any party using or relying upon this plan for any purpose other than as a document prepared for the sole purpose of accompanying an application to council for development and which may be subject to alteration for reasons beyond the control of Allen Price Pty Ltd.

Unless stamped by Council, this plan is not a plan of an approved subdivision.

This note is an integral part of this plan.

STAGE 5

SUBDIVISION OF LOT 9 FROM STAGE 1

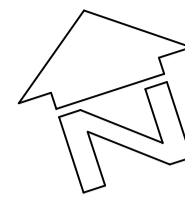

- DENOTES PROPOSED SEWER MAIN (N27790-407-415 REV 2 DATED 15.09.2025)
- DENOTES PROPOSED WATER MAIN (N27790-407-415 REV 2 DATED 15.09.2025)
- DENOTES PROPOSED STORMWATER PIPE (N27790-407-415 REV 2 DATED 15.09.2025)
- DENOTES PROPOSED ELECTRICAL / COMMS ROUTE (N27790-407-415 REV 2 DATED 15.09.2025)
- DENOTES PROPOSED STORMWATER PIT (N27790-407-415 REV 2 DATED 15.09.2025)
- DENOTES PROPOSED STORMWATER PIPE (N27790-407-415 REV 2 DATED 15.09.2025)
- DENOTES PROPOSED STORMWATER PIT (N27790-407-415 REV 2 DATED 15.09.2025)

CONSTRUCTED IN PREVIOUS STAGE

- PROPOSED EASEMENT FOR PADMOUNT SUBSTATION 2.75 WIDE (STAGE 1)
- PROPOSED RESTRICTION ON THE USE OF LAND (STAGE 1)
- PROPOSED RESTRICTION ON THE USE OF LAND (STAGE 1)
- PROPOSED EASEMENT FOR SEWER MAIN VARIABLE WIDTH (STAGE 1)
- PROPOSED EASEMENT FOR SEWER MAIN 2.4 WIDE (STAGE 1)
- PROPOSED EASEMENT FOR WATER DRAINAGE 1.7 WIDE
- PROPOSED EASEMENT FOR MAINTENANCE & SUPPORT 0.3 WIDE
- PROPOSED EASEMENT FOR MAINTENANCE 0.9 WIDE

BEWARE!

THE CONTRACTOR IS TO VERIFY THE LOCATION OF ALL EXISTING SERVICES PRIOR TO COMMENCEMENT OF CONSTRUCTION AND SHALL BE RESPONSIBLE, AT THE CONTRACTOR'S EXPENSE, FOR ANY REPAIRS TO DAMAGE CAUSED DURING CONSTRUCTION.



STAGE 5 SUBDIVISION - 4 LOTS
PROPOSED STAGED TORRENS TITLE SUBDIVISION
 Over Lot 129 DP3060, Lot 1 DP520502 & Lot 110 DP131219
 At 25 Moss Vale Road, Bomaderry
 For Southern Cross Community Housing c/o Homa Advisory

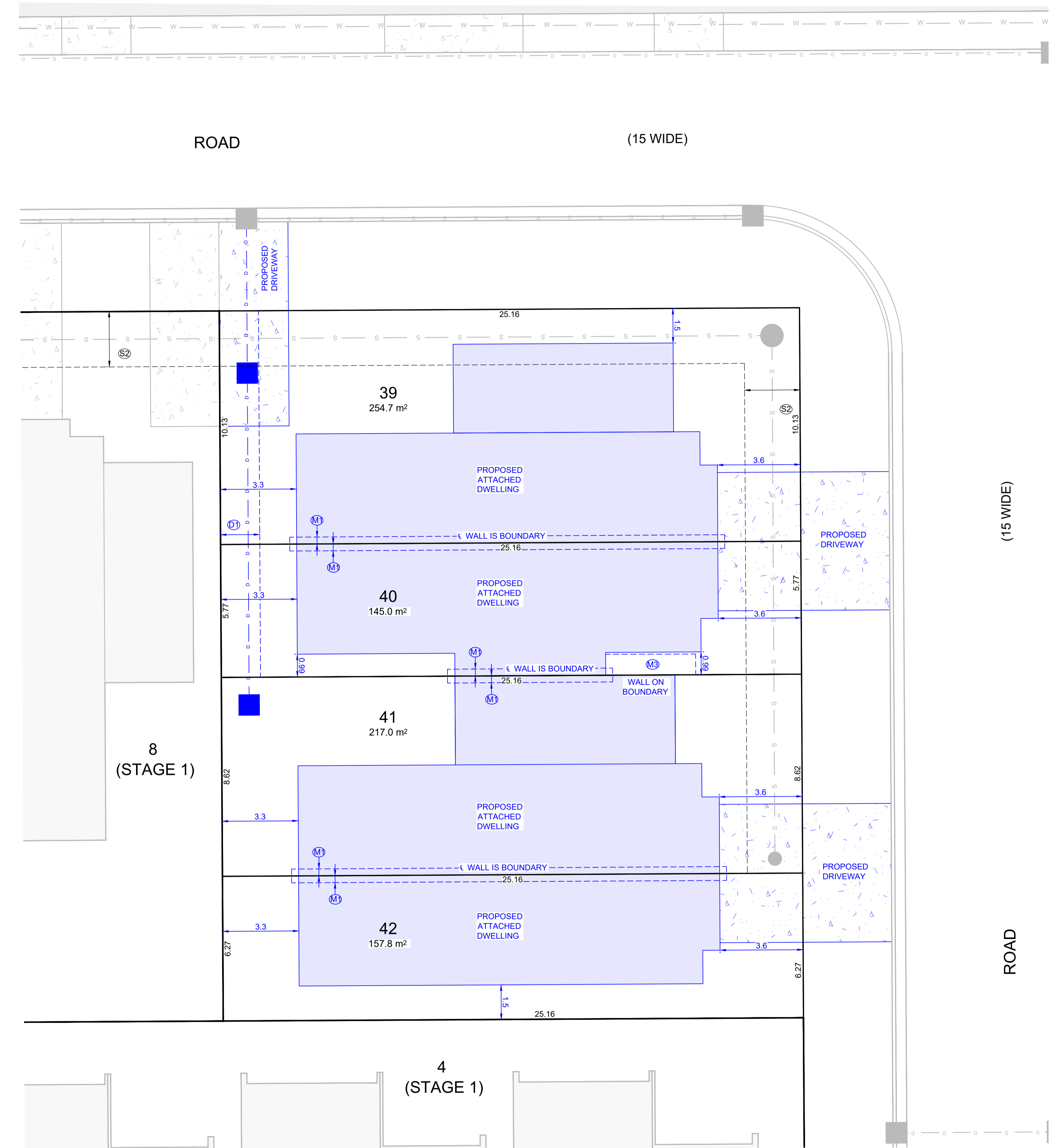

ISSUE	DESCRIPTION	BY	DATE
0	INITIAL ISSUE	AE	30.03.2026
1	ADDITIONAL STAGE 1 LOT	AE	13.04.2026

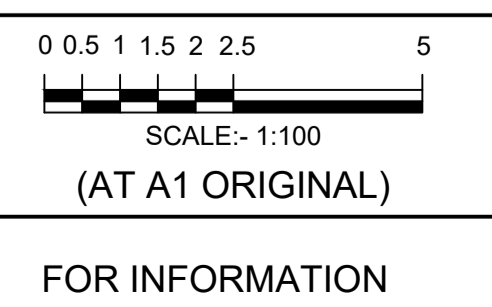

SURVEY	DESIGN	DRAWN	CHECK'D	DATUM
-	-	AE	TL	AS SHOWN

ALLEN PRICE PTY LTD
 Nowra Office • 75 Plunkett St, Nowra NSW 2541
 Kiama Office • 1/28 Bong Bong St, Kiama NSW 2533
 Wollongong Office • SE 1 L2 83-85 Market St, Wollongong NSW 2500
 (02) 4421 6544 • consultants@allenprice.com.au • allenprice.com.au

DATE OF SURVEY	DRAWING NUMBER
NOT APPLICABLE	N27790-08

ORIGIN	SHEET	ISSUE
N/A	06/10	1



M:\CAD Files - Projects\N27790 Drawings\N27790-08 STAGED SUBDIVISION PLANS.dwg

NOTE:

This plan was prepared for the client as an indicative subdivision plan to accompany a development application to Shoalhaven City Council.

The information shown on this plan is not suitable for any other purpose.

The property dimensions, contours and other physical features have been compiled from existing information and limited field survey. The proposed development and internal boundaries have been sited per drawing file x1mpa.dwg, supplied by Sparc Development Pty Ltd on 03.02.2026

The dimensions, areas and total number of lots shown on this plan are subject to further field survey at subdivision certificate stage and also to the requirements of Council and any other authority which may have requirements under any relevant legislation.

In particular, no reliance should be placed on the information on this plan for detailed subdivision design or for any financial dealings involving the land.

Allen Price Pty Ltd therefore disclaims any liability for any loss or damage whatsoever or howsoever incurred, arising from any party using or relying upon this plan for any purpose other than as a document prepared for the sole purpose of accompanying an application to council for development and which may be subject to alteration for reasons beyond the control of Allen Price Pty Ltd.

Unless stamped by Council, this plan is not a plan of an approved subdivision.

This note is an integral part of this plan.

STAGE 6

SUBDIVISION OF LOT 12 FROM STAGE 1

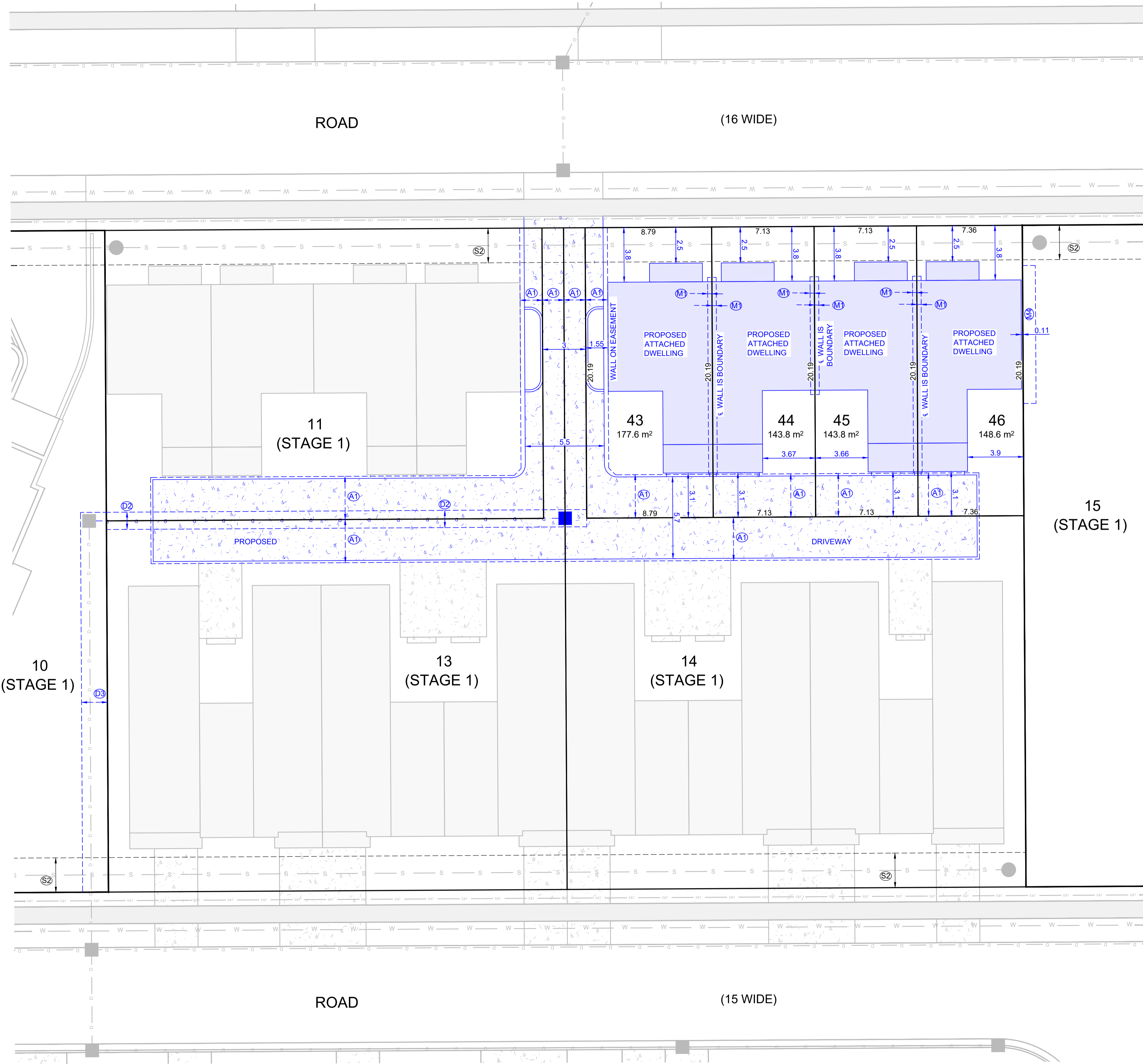
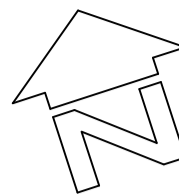

- DENOTES PROPOSED SEWER MAIN (N27790-407-415 REV 2 DATED 15.09.2025)
- DENOTES PROPOSED WATER MAIN (N27790-407-415 REV 2 DATED 15.09.2025)
- DENOTES PROPOSED STORMWATER PIPE (N27790-407-415 REV 2 DATED 15.09.2025)
- DENOTES PROPOSED ELECTRICAL / COMMS ROUTE (N27790-407-415 REV 2 DATED 15.09.2025)
- DENOTES PROPOSED STORMWATER PIT (N27790-407-415 REV 2 DATED 15.09.2025)
- DENOTES PROPOSED STORMWATER PIPE (N27790-407-415 REV 2 DATED 15.09.2025)
- DENOTES PROPOSED STORMWATER PIT (N27790-407-415 REV 2 DATED 15.09.2025)

CONSTRUCTED IN PREVIOUS STAGE

- PROPOSED EASEMENT FOR SEWER MAIN 2.4 WIDE (STAGE 1)
- PROPOSED EASEMENT FOR ACCESS & SERVICES VARIABLE WIDTH
- PROPOSED EASEMENT FOR WATER DRAINAGE 1.2 WIDE
- PROPOSED EASEMENT FOR WATER DRAINAGE 1.8 WIDE
- PROPOSED EASEMENT FOR MAINTENANCE & SUPPORT 0.3 WIDE
- PROPOSED EASEMENT FOR MAINTENANCE 0.89 WIDE

BEWARE!
THE CONTRACTOR IS TO VERIFY THE LOCATION OF ALL EXISTING SERVICES PRIOR TO COMMENCEMENT OF CONSTRUCTION AND SHALL BE RESPONSIBLE, AT THE CONTRACTOR'S EXPENSE, FOR ANY REPAIRS TO DAMAGE CAUSED DURING CONSTRUCTION.



1 PROPOSED STAGED TORRENS TITLE SUBDIVISION
Over Lot 129 DP3060, Lot 1 DP520502 & Lot 110 DP131219
At 25 Moss Vale Road, Bomaderry
For Southern Cross Community Housing c/o Homa Advisory

ISSUE	DESCRIPTION	BY	DATE
0	INITIAL ISSUE	AE	30.03.2026
1	ADDITIONAL STAGE 1 LOT	AE	13.04.2026

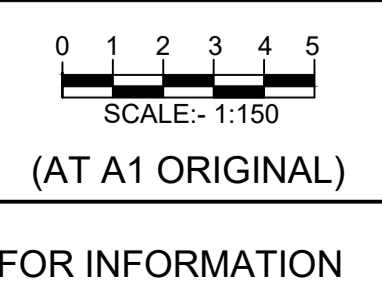

SURVEY	DESIGN	DRAWN	CHECK'D	DATUM
-	-	AE	TL	AS SHOWN

ALLEN PRICE PTY LTD
Nowra Office • 75 Plunkett St, Nowra NSW 2541
Kiama Office • 1/28 Bong Bong St, Kiama NSW 2533
Wollongong Office • SE 1 L2 83-85 Market St, Wollongong NSW 2500
(02) 4421 6544 • consultants@allenprice.com.au • allenprice.com.au

DATE OF SURVEY	ORIGIN
NOT APPLICABLE	N/A
DRAWING NUMBER	SHEET
N27790-08	07/10
ISSUE	1



M:\CAD Files - Projects\N27790 Drawings\N27790-08 STAGED SUBDIVISION PLANS.dwg

NOTE:

This plan was prepared for the client as an indicative subdivision plan to accompany a development application to Shoalhaven City Council.

STAGE 7

SUBDIVISION OF LOT 11 FROM STAGE 1

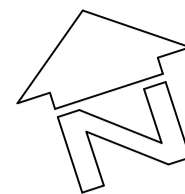

The information shown on this plan is not suitable for any other purpose.

The property dimensions, contours and other physical features have been compiled from existing information and limited field survey. The proposed development and internal boundaries have been sited per drawing file x1mpa.dwg, supplied by Sparc Development Pty Ltd on 03.02.2026

The dimensions, areas and total number of lots shown on this plan are subject to further field survey at subdivision certificate stage and also to the requirements of Council and any other authority which may have requirements under any relevant legislation.

In particular, no reliance should be placed on the information on this plan for detailed subdivision design or for any financial dealings involving the land.

Allen Price Pty Ltd therefore disclaims any liability for any loss or damage whatsoever or howsoever incurred, arising from any party using or relying upon this plan for any purpose other than as a document prepared for the sole purpose of accompanying an application to council for development and which may be subject to alteration for reasons beyond the control of Allen Price Pty Ltd.

Unless stamped by Council, this plan is not a plan of an approved subdivision.

This note is an integral part of this plan.



- S — S — S — DENOTES PROPOSED SEWER MAIN (N27790-407-415 REV 2 DATED 15.09.2025)
 - W — W — W — DENOTES PROPOSED WATER MAIN (N27790-407-415 REV 2 DATED 15.09.2025)
 - D — D — D — DENOTES PROPOSED STORMWATER PIPE (N27790-407-415 REV 2 DATED 15.09.2025)
 - E — E — E — DENOTES PROPOSED ELECTRICAL / COMMS ROUTE (N27790-407-415 REV 2 DATED 15.09.2025)
 - DENOTES PROPOSED STORMWATER PIT (N27790-407-415 REV 2 DATED 15.09.2025)
- CONSTRUCTED IN PREVIOUS STAGE

- (A1) PROPOSED EASEMENT FOR ACCESS & SERVICES VARIABLE WIDTH (STAGE 6)
- (D2) PROPOSED EASEMENT FOR WATER DRAINAGE 1.2 WIDE (STAGE 6)
- (D3) PROPOSED EASEMENT FOR WATER DRAINAGE 1.8 WIDE (STAGE 6)
- (S2) PROPOSED EASEMENT FOR SEWER MAIN 2.4 WIDE (STAGE 1)

- (M1) PROPOSED EASEMENT FOR MAINTENANCE & SUPPORT 0.3 WIDE
- (M2) PROPOSED EASEMENT FOR MAINTENANCE 0.89 WIDE

BEWARE!

THE CONTRACTOR IS TO VERIFY THE LOCATION OF ALL EXISTING SERVICES PRIOR TO COMMENCEMENT OF CONSTRUCTION AND SHALL BE RESPONSIBLE, AT THE CONTRACTOR'S EXPENSE, FOR ANY REPAIRS TO DAMAGE CAUSED DURING CONSTRUCTION.



STAGE 7 SUBDIVISION - 4 LOTS
PROPOSED STAGED TORRENS TITLE SUBDIVISION
 Over Lot 129 DP3060, Lot 1 DP520502 & Lot 110 DP131219
 At 25 Moss Vale Road, Bomaderry
 For Southern Cross Community Housing c/o Homa Advisory

ISSUE	DESCRIPTION	BY	DATE
0	INITIAL ISSUE	AE	30.03.2026
1	ADDITIONAL STAGE 1 LOT	AE	13.04.2026

0 0.5 1 1.5 2 2.5 5
 SCALE:- 1:100
 (AT A1 ORIGINAL)
 FOR INFORMATION

SURVEY	DESIGN	DRAWN	CHECK'D	DATUM
-	-	AE	TL	AS SHOWN

ALLEN PRICE PTY LTD
 Nowra Office • 75 Plunkett St, Nowra NSW 2541
 Kiama Office • 1/28 Bong Bong St, Kiama NSW 2533
 Wollongong Office • SE 1 L2 83-85 Market St, Wollongong NSW 2500
 (02) 4421 6544 • consultants@allenprice.com.au • allenprice.com.au

DATE OF SURVEY	DRAWING NUMBER
NOT APPLICABLE	N27790-08

ORIGIN	SHEET	ISSUE
N/A	08/10	1

PROFESSIONAL STANDARDS SCHEME
 Liability limited by a scheme approved under Professional Standards Legislation

M:\CAD Files - Projects\N27790 Drawings\N27790-08 STAGED SUBDIVISION PLANS.dwg

NOTE:

This plan was prepared for the client as an indicative subdivision plan to accompany a development application to Shoalhaven City Council.

The information shown on this plan is not suitable for any other purpose.

The property dimensions, contours and other physical features have been compiled from existing information and limited field survey. The proposed development and internal boundaries have been sited per drawing file x1mpa.dwg, supplied by Sparc Development Pty Ltd on 03.02.2026

The dimensions, areas and total number of lots shown on this plan are subject to further field survey at subdivision certificate stage and also to the requirements of Council and any other authority which may have requirements under any relevant legislation.

In particular, no reliance should be placed on the information on this plan for detailed subdivision design or for any financial dealings involving the land.

Allen Price Pty Ltd therefore disclaims any liability for any loss or damage whatsoever or howsoever incurred, arising from any party using or relying upon this plan for any purpose other than as a document prepared for the sole purpose of accompanying an application to council for development and which may be subject to alteration for reasons beyond the control of Allen Price Pty Ltd.

Unless stamped by Council, this plan is not a plan of an approved subdivision.

This note is an integral part of this plan.

STAGE 8

SUBDIVISION OF LOT 13 FROM STAGE 1

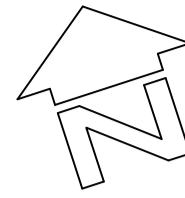

ROAD (16 WIDE)

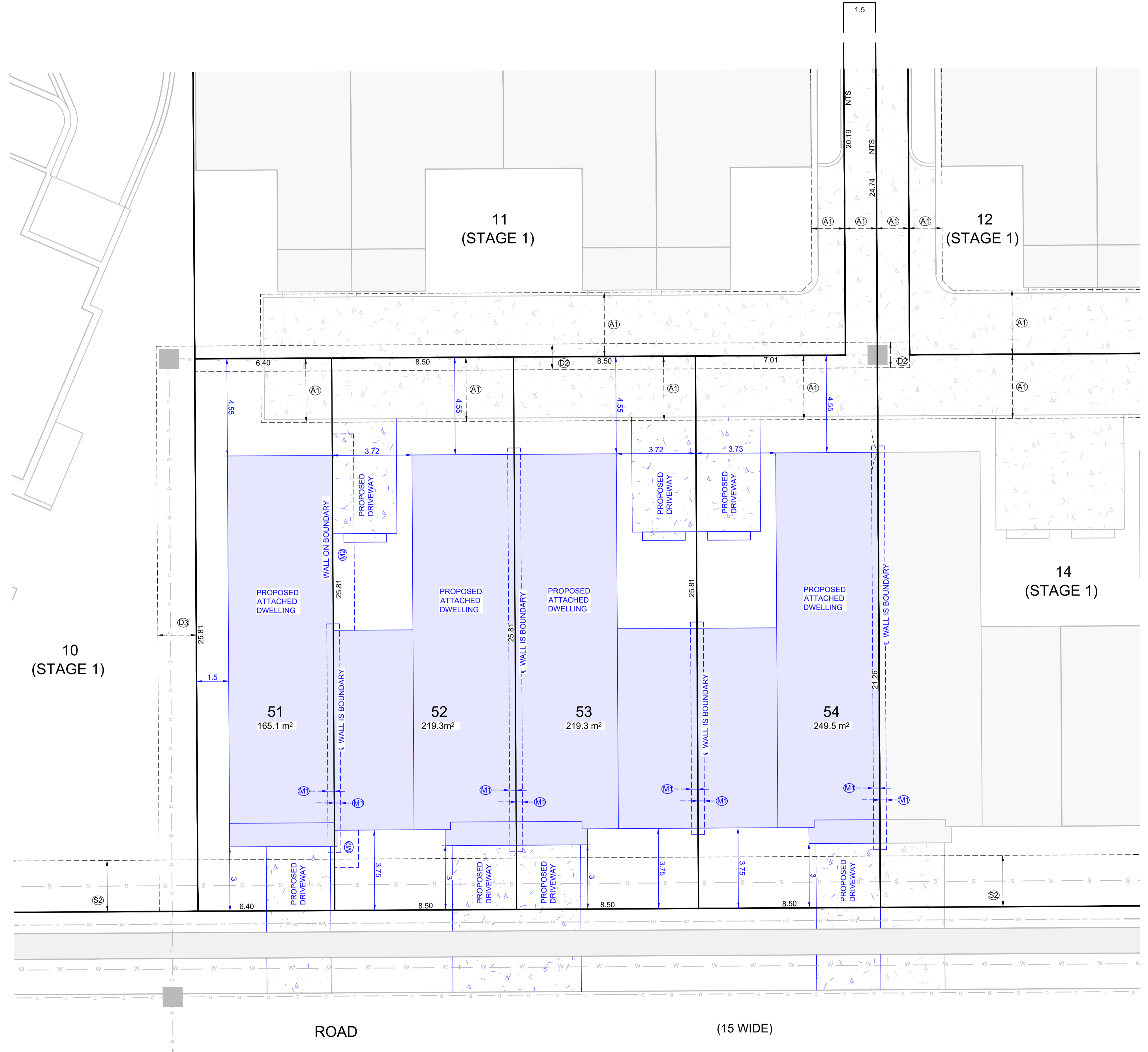

- S — S — S — DENOTES PROPOSED SEWER MAIN (N27790-407-415 REV 2 DATED 15.09.2025)
 - W — W — W — DENOTES PROPOSED WATER MAIN (N27790-407-415 REV 2 DATED 15.09.2025)
 - D — D — D — DENOTES PROPOSED STORMWATER PIPE (N27790-407-415 REV 2 DATED 15.09.2025)
 - E — E — E — DENOTES PROPOSED ELECTRICAL / COMMS ROUTE (N27790-407-415 REV 2 DATED 15.09.2025)
 - DENOTES PROPOSED STORMWATER PIT (N27790-407-415 REV 2 DATED 15.09.2025)
- CONSTRUCTED IN PREVIOUS STAGE

- (A1) PROPOSED EASEMENT FOR ACCESS & SERVICES VARIABLE WIDTH (STAGE 6)
- (D2) PROPOSED EASEMENT FOR WATER DRAINAGE 1.2 WIDE (STAGE 6)
- (D3) PROPOSED EASEMENT FOR WATER DRAINAGE 1.8 WIDE (STAGE 6)
- (S2) PROPOSED EASEMENT FOR SEWER MAIN 2.4 WIDE (STAGE 1)
- (M1) PROPOSED EASEMENT FOR MAINTENANCE & SUPPORT 0.3 WIDE
- (M2) PROPOSED EASEMENT FOR MAINTENANCE 1.0 WIDE

BEWARE!

THE CONTRACTOR IS TO VERIFY THE LOCATION OF ALL EXISTING SERVICES PRIOR TO COMMENCEMENT OF CONSTRUCTION AND SHALL BE RESPONSIBLE, AT THE CONTRACTOR'S EXPENSE, FOR ANY REPAIRS TO DAMAGE CAUSED DURING CONSTRUCTION.



STAGE 8 SUBDIVISION - 4 LOTS
PROPOSED STAGED TORRENS TITLE SUBDIVISION
 Over Lot 129 DP3060, Lot 1 DP520502 & Lot 110 DP131219
 At 25 Moss Vale Road, Bomaderry
 For Southern Cross Community Housing c/o Homa Advisory

ISSUE	DESCRIPTION	BY	DATE
0	INITIAL ISSUE	AE	30.03.2026
1	ADDITIONAL STAGE 1 LOT	AE	13.04.2026

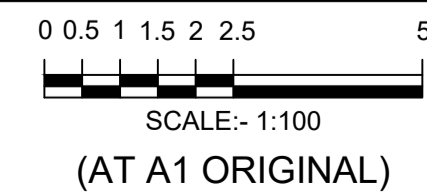

FOR INFORMATION

SURVEY	DESIGN	DRAWN	CHECK'D	DATUM
-	-	AE	TL	AS SHOWN

ALLEN PRICE PTY LTD
 Nowra Office • 75 Plunkett St, Nowra NSW 2541
 Kiama Office • 1/28 Bong Bong St, Kiama NSW 2533
 Wollongong Office • SE 1 L2 83-85 Market St, Wollongong NSW 2500
 (02) 4421 6544 • consultants@allenprice.com.au • allenprice.com.au

DATUM	ORIGIN
AS SHOWN	N/A
DATE OF SURVEY	NOT APPLICABLE
DRAWING NUMBER	N27790-08

SHEET	ISSUE
09/10	1



M:\CAD Files - Projects\N27790 Drawings\N27790-08 STAGED SUBDIVISION PLANS.dwg

NOTE:

This plan was prepared for the client as an indicative subdivision plan to accompany a development application to Shoalhaven City Council.

The information shown on this plan is not suitable for any other purpose.

The property dimensions, contours and other physical features have been compiled from existing information and limited field survey. The proposed development and internal boundaries have been sited per drawing file x1mpa.dwg, supplied by Sparc Development Pty Ltd on 03.02.2026

The dimensions, areas and total number of lots shown on this plan are subject to further field survey at subdivision certificate stage and also to the requirements of Council and any other authority which may have requirements under any relevant legislation.

In particular, no reliance should be placed on the information on this plan for detailed subdivision design or for any financial dealings involving the land.

Allen Price Pty Ltd therefore disclaims any liability for any loss or damage whatsoever or howsoever incurred, arising from any party using or relying upon this plan for any purpose other than as a document prepared for the sole purpose of accompanying an application to council for development and which may be subject to alteration for reasons beyond the control of Allen Price Pty Ltd.

Unless stamped by Council, this plan is not a plan of an approved subdivision.

This note is an integral part of this plan.

STAGE 9

SUBDIVISION OF LOT 14 FROM STAGE 1

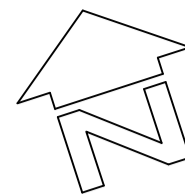

ROAD (16 WIDE)

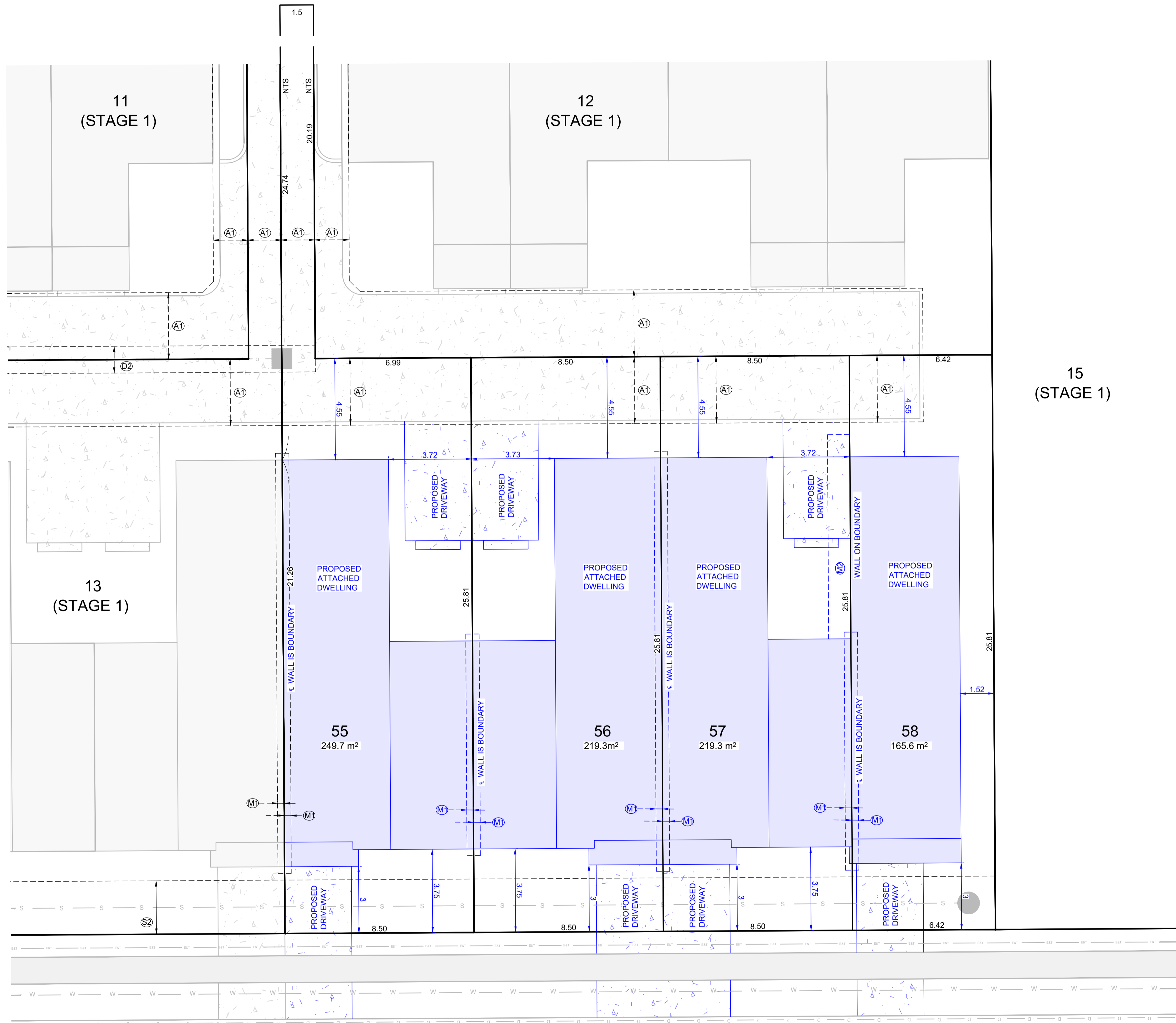

- S — S — S — DENOTES PROPOSED SEWER MAIN (N27790-407-415 REV 2 DATED 15.09.2025)
 - W — W — W — DENOTES PROPOSED WATER MAIN (N27790-407-415 REV 2 DATED 15.09.2025)
 - D — D — D — DENOTES PROPOSED STORMWATER PIPE (N27790-407-415 REV 2 DATED 15.09.2025)
 - E — E — E — DENOTES PROPOSED ELECTRICAL / COMMS ROUTE (N27790-407-415 REV 2 DATED 15.09.2025)
 - DENOTES PROPOSED STORMWATER PIT (N27790-407-415 REV 2 DATED 15.09.2025)
- CONSTRUCTED IN PREVIOUS STAGE

- (A1) PROPOSED EASEMENT FOR ACCESS & SERVICES VARIABLE WIDTH (STAGE 6)
- (D2) PROPOSED EASEMENT FOR WATER DRAINAGE 1.2 WIDE (STAGE 6)
- (D3) PROPOSED EASEMENT FOR WATER DRAINAGE 1.8 WIDE (STAGE 6)
- (S2) PROPOSED EASEMENT FOR SEWER MAIN 2.4 WIDE (STAGE 1)
- (M1) PROPOSED EASEMENT FOR MAINTENANCE & SUPPORT 0.3 WIDE
- (M2) PROPOSED EASEMENT FOR MAINTENANCE 1.0 WIDE

BEWARE!
THE CONTRACTOR IS TO VERIFY THE LOCATION OF ALL EXISTING SERVICES PRIOR TO COMMENCEMENT OF CONSTRUCTION AND SHALL BE RESPONSIBLE, AT THE CONTRACTOR'S EXPENSE, FOR ANY REPAIRS TO DAMAGE CAUSED DURING CONSTRUCTION.

ROAD

(15 WIDE)



STAGE 9 SUBDIVISION - 4 LOTS
PROPOSED STAGED TORRENS TITLE SUBDIVISION
 Over Lot 129 DP3060, Lot 1 DP520502 & Lot 110 DP131219
 At 25 Moss Vale Road, Bomaderry
 For Southern Cross Community Housing c/o Homa Advisory

ISSUE	DESCRIPTION	BY	DATE
0	INITIAL ISSUE	AE	30.03.2026
1	ADDITIONAL STAGE 1 LOT	AE	13.04.2026

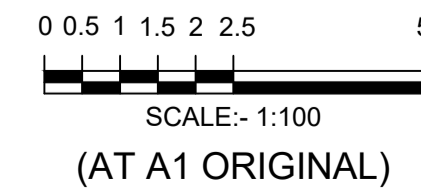

FOR INFORMATION

SURVEY	DESIGN	DRAWN	CHECK'D	DATUM
-	-	AE	TL	AS SHOWN

ALLEN PRICE PTY LTD
 Nowra Office • 75 Plunkett St, Nowra NSW 2541
 Kiama Office • 1/28 Bong Bong St, Kiama NSW 2533
 Wollongong Office • SE 1 L2 83-85 Market St, Wollongong NSW 2500
 (02) 4421 6544 • consultants@allenprice.com.au • allenprice.com.au

DATUM	ORIGIN
AS SHOWN	N/A
DATE OF SURVEY	NOT APPLICABLE
DRAWING NUMBER	N27790-08

SHEET	ISSUE
10/10	1

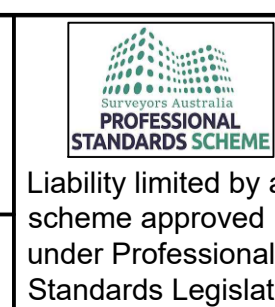

M:\CAD Files - Projects\N27790 - Drawings\N27790-08 STAGED SUBDIVISION PLANS.dwg