

PLAN OF PART LOT 110 IN DP 3060 BEING PART OF LAND COMPRISED IN VOL. 8495 FOL. 232

LGA SHOALHAVEN
 Mun./Shire/City BOMADERRY
 Town or Locality BUNBERRA
 Parish CAMDEN
 County CAMDEN
 Reduction Ratio 1: N.T.S. Lengths are in metres

D. P. 131219
 Registered:  *Blair* 22-11-1995
 C.A.: _____
 Title System: TORRENS
 Purpose: DEPARTMENTAL
 Ref. Map: W5540-6 #
 Last Plan: D P 3060

NOIDIB

20-0090

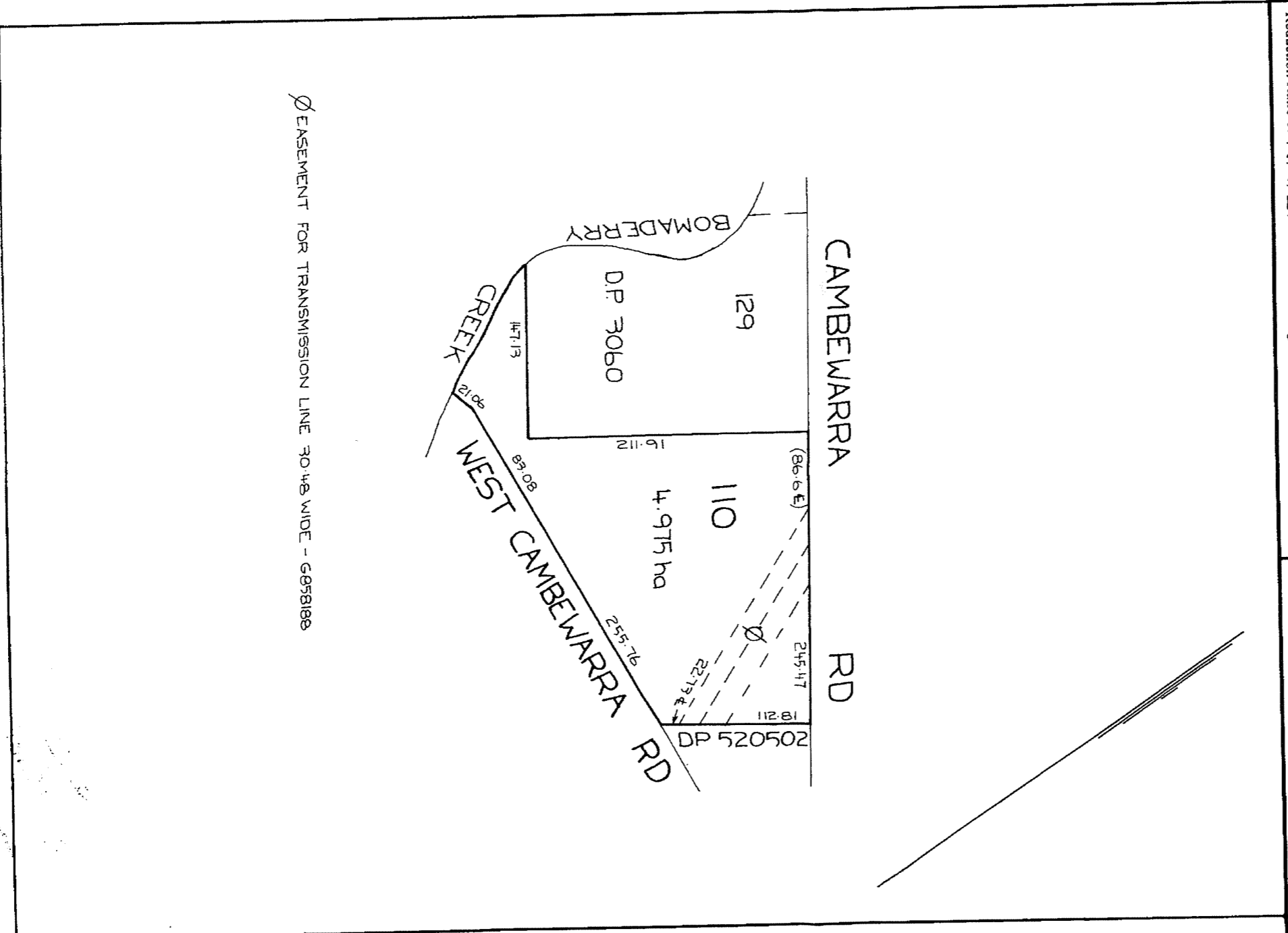

Ø EASEMENT FOR TRANSMISSION LINE 30.48 WIDE - 6858189