

Naturally Trees

'Expert Arboricultural planning, advice and care since 1998'

Arborist Reports, Landscape Design, Flora and Fauna Surveys,
Biodiversity and Ecological Impact Assessments &
Bushfire Protection Assessment Services

Naturally Trees
PO Box 5085
Elanora Heights
NSW 2101, Australia
Phone: 0417250420
info@naturallytrees.com.au
www.naturallytrees.com.au
ABN: 58 359 914 843

Cumberland Golf Course
248 Old Prospect Road
Greystanes NSW 2145

7 August 2024

To whom it may concern,

**ARBORIST - RESPONSE TO COUNCIL RFI
SSD-64795219
248 Old Prospect Road, Greystanes NSW**

This letter has been commissioned by Pariter to provide a response to Cumberland Council's RFI.

The subject trees had been included within an earlier Arboricultural Impact Appraisal and Method Statement by Naturally Trees dated 29 January 2024.

1. RFI Matter – *Unidentified trees and screen planting within construction area adjacent to Building F -*

Trees seen at the rear of 21 and 23 Kootingal Street will need to be assessed by the Arborist and included in future documentation. The trees and large shrubs currently screen the site from the properties and would have contributed to screening of Building F and possibly reducing potential overlooking of the rear yards of these properties. As the trees have not been identified, no assessment can be made based on the location of existing and proposed drainage works and potential cut and fill associated with the development:

RESPONSE: These trees were assessed and mapped on 30 July 2024 and included into the revised Arboricultural Impact Appraisal and Method Statement by Naturally Trees. Trees 332 to 336 are mostly small trees that will remain unaffected by the proposed works.





No.	Genus species	Height	Spread	DBH	Foliage	Age class	Defects	Location	Services	Sign.	Tree AZ
332	<i>Phoenix canariensis</i>	3	3	300	80%	S	Nil	Garden	Nil	L	ZZ1
333	<i>Syzygium sp.</i>	5	3	100	80%	S	Nil	Grass	Nil	L	Z1
334	<i>Callistemon sp.</i>	8	6	250	80%	M	Nil	Grass	Nil	M	A1
335	<i>Callistemon sp.</i>	4	4	150	70%	M	Nil	Grass	Nil	L	Z1
336	<i>Callistemon sp.</i>	5	2	150	60%	M	Nil	Grass	Nil	L	Z1



2. RFI Matter – Recommended management for the following trees:

RESPONSE: The following is a summary of trees to be retained and protected.

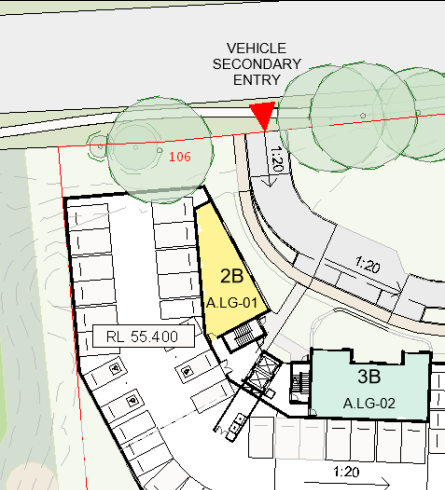
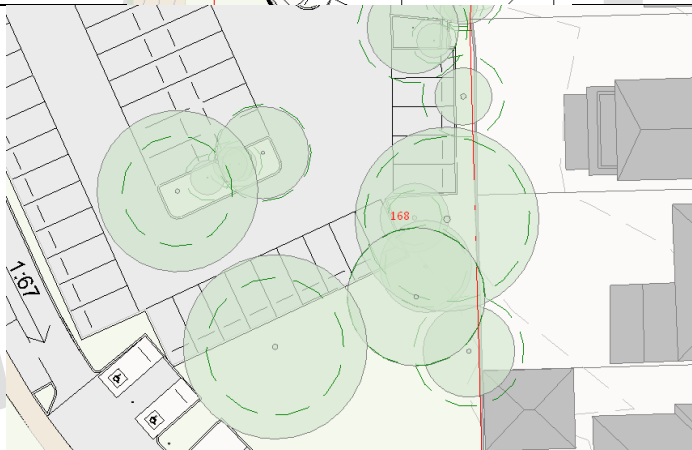
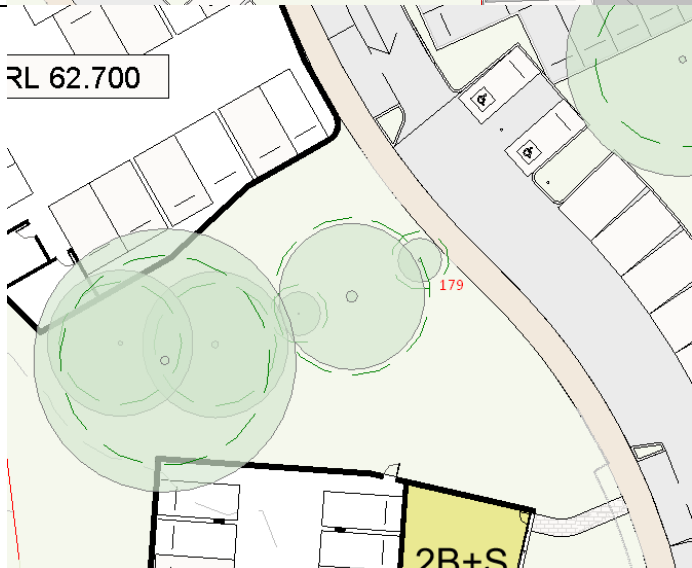
<p>Tree 106 can be retained under the current proposal.</p>	 <p>VEHICLE SECONDARY ENTRY</p> <p>106</p> <p>2B ALG-01</p> <p>3B ALG-02</p> <p>RL 55.400</p> <p>1:20</p>
<p>Tree 168 can be retained providing no modifications occur to the existing carpark layout.</p>	 <p>168</p> <p>1:57</p>
<p>Tree 179 is a low category tree. It is too close to proposed works and should be removed and replaced.</p>	 <p>RL 62.700</p> <p>179</p> <p>2B+S</p>



Tree 184 will be impacted from both sides of the TPZ. The proposed incursion equates to 6% and is in accordance with AS4970-2009 recommendations.

This tree can be retained and protected.

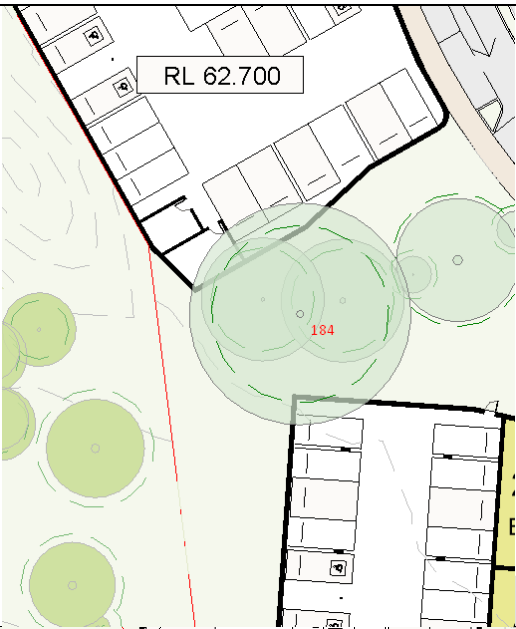

Trees 205 and 206 are located within a similar location and proximity to new building. The proposed building will occupy 11% of their TPZ and slightly exceeds AS4970-2009 recommendations (refer revised plans, Revision B, dated 5 August 2024).

These trees are to be retained and protected

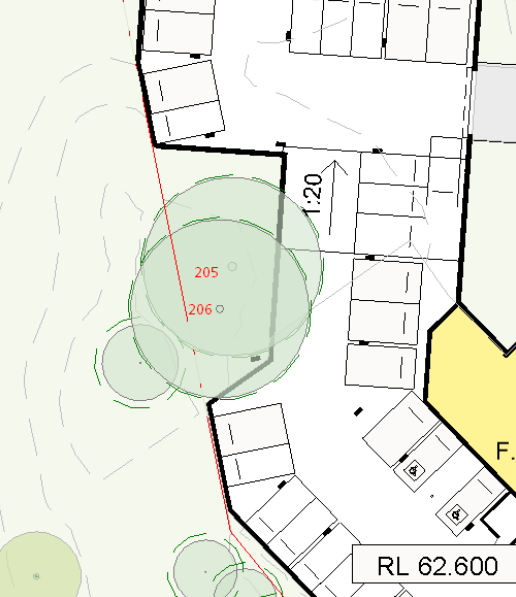

Tree 217 is a low category tree. It is 1800mm from the proposed building and cannot be successfully retained.

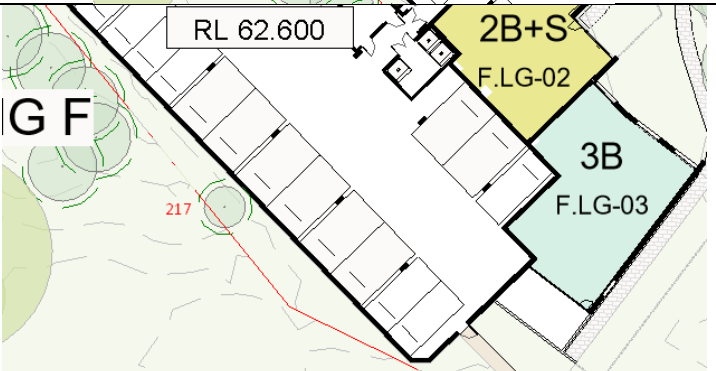

Tree 231 will undergo major encroachment within its TPZ and is unlikely to survive long term.

It is recommended to retain and protect this tree.

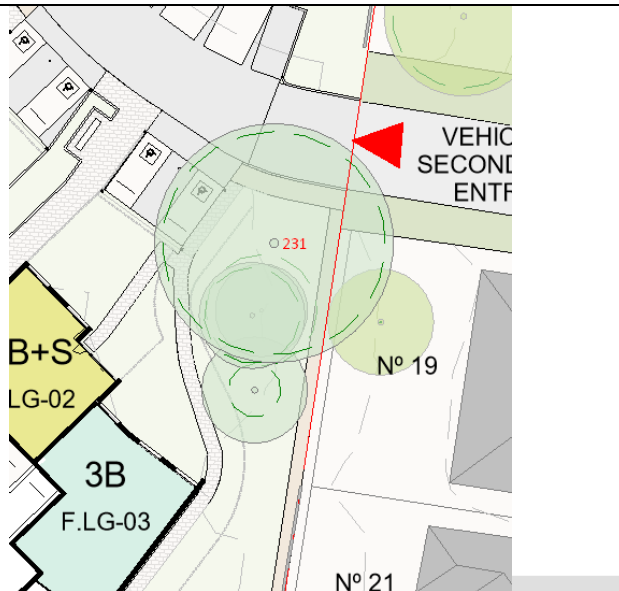

Yours sincerely

Andrew Scales
Dip. Horticulture
Dip. Arboriculture AQF5

