

Last saved by: MCKENNA/2022-07-20 | Last Plotted: 2022-07-21  
 Filename: C:\USERS\MCKENNA\DOCUMENTS\USEFUL\_INFOLTHGOW BATTERY STORAGE AREA\60639954-REF-0000-RD-ROAD-PLAN.DWG

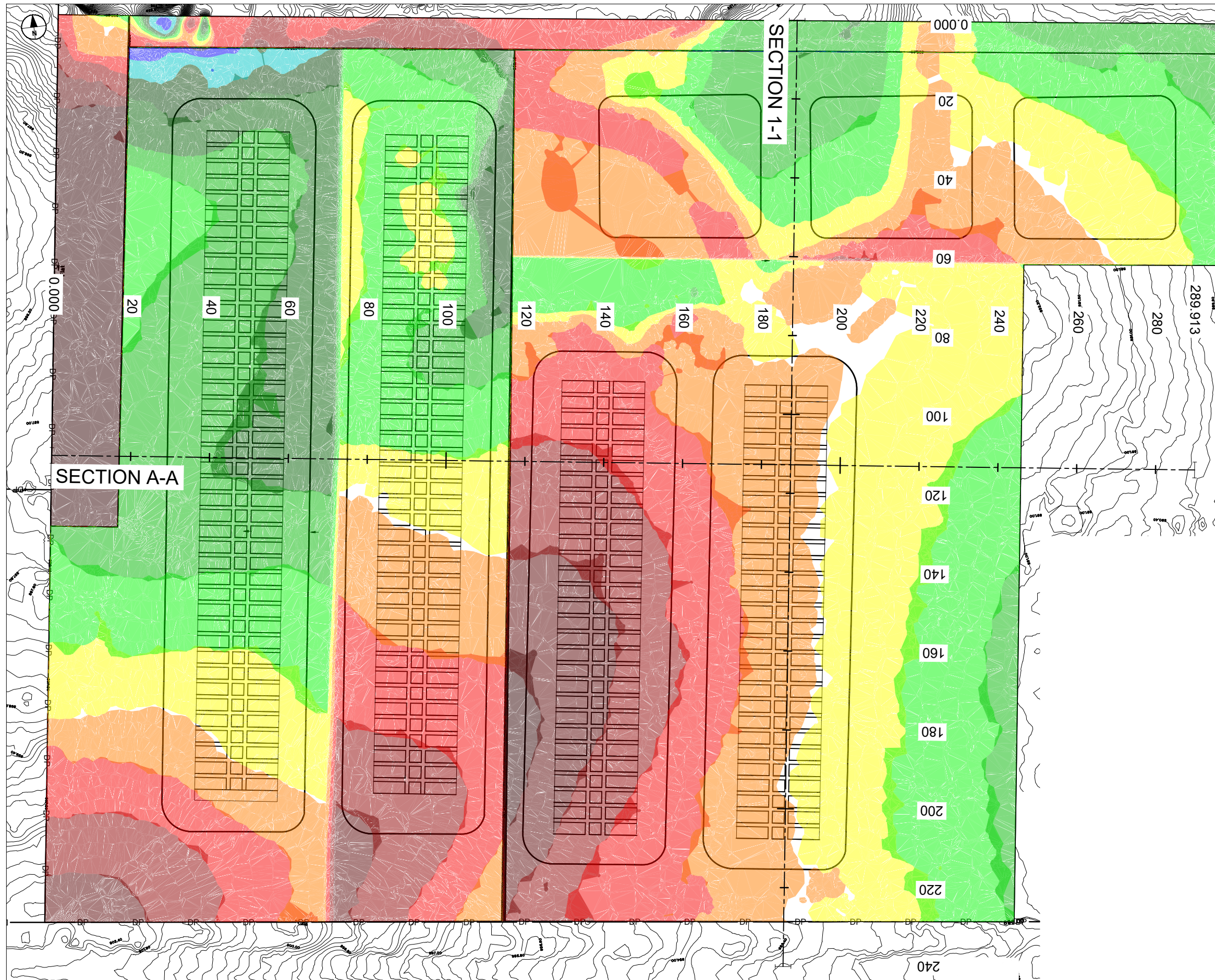

Cut fill volumes		Colour	
Lower_value	Upper_value		
-7	to -4	m	
-4	to -3	m	
-3	to -2	m	
-2	to -1	m	
-1	to 0.00	m	
0	to 1	m	
1	to 2	m	
2	to 3	m	
3	to 4	m	
4	to 5	m	
5	to 6	m	
6	to 7	m	
7	to 8	m	

**CUT FILL VOLUMES (m<sup>3</sup>)**

CUT: 47,000  
 FILL: 52,000  
 BALANCE: 5,000 IMPORT

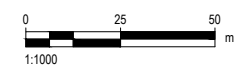

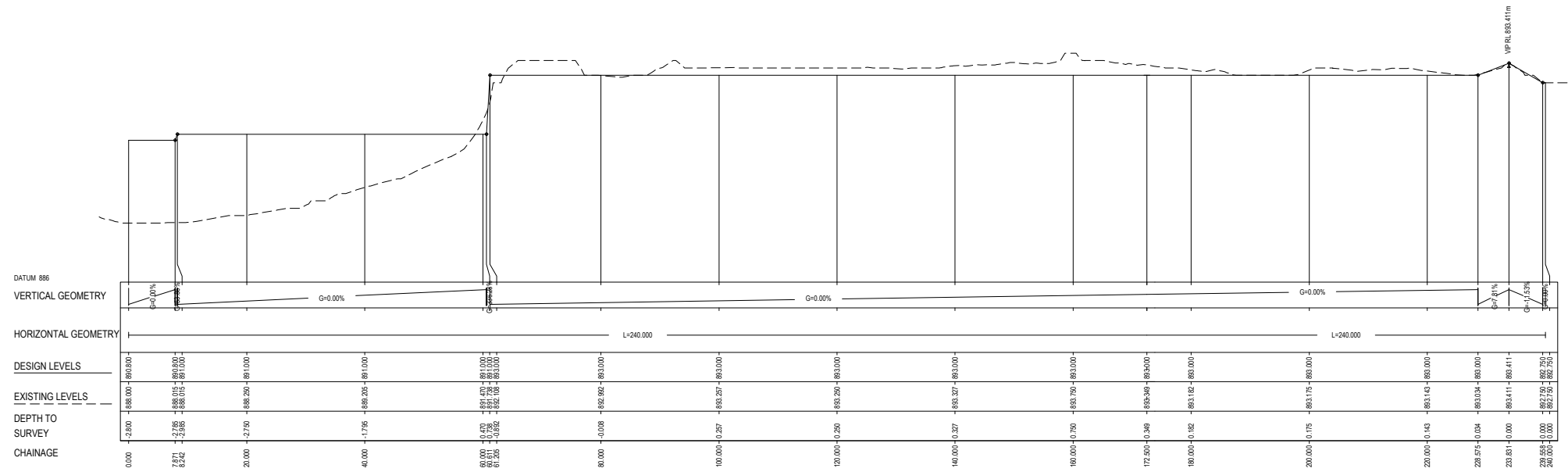

LITHGOW BATTERY STORAGE AREA - TYPICAL SECTION 1-1  
 A3 Horizontal scale 1:500  
 A3 Vertical scale 1:100



CONSULTANT

AECOM Australia Pty Ltd  
 A.B.N 20 093 846 925  
 www.aecom.com

PROJECT

SCALES

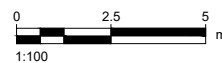
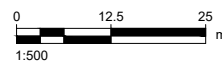

PROJECT NUMBER

SKETCH TITLE

12d Model Working Sketch Only

SKETCH NUMBER

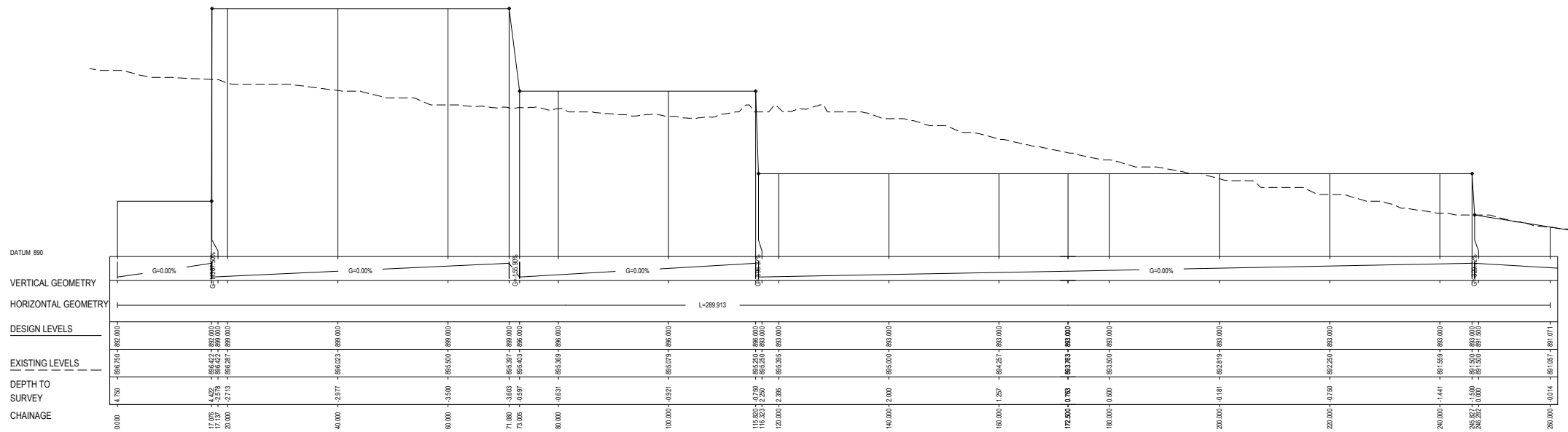

LITHGOW BATTERY STORAGE AREA - TYPICAL SECTION A-A  
 A3 Horizontal scale 1:500  
 A3 Vertical scale 1:100



CONSULTANT

AECOM Australia Pty Ltd  
 A.B.N 20 093 846 925  
 www.aecom.com

PROJECT

SCALES

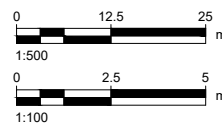

PROJECT NUMBER

SKETCH TITLE

12d Model Working Sketch Only

SKETCH NUMBER