

LEGEND

	EXISTING BUILDINGS NO WORKS REQUIRED
	EXISTING BUILDING REFURBISHMENT WORKS UNDER CONSTRUCTION
	BUILDINGS AND EQUIPMENT UNDER CONSTRUCTION
	NEW PROPOSED BUILDINGS
	EXISTING HARDSTAND AND ROADS
	NEW PROPOSED HARDSTAND AND ROADS
	CHANGES TO ORIGINAL SSD 9601 CLOUDED IN BLUE
	ADDITION WORKS TO ORIGINAL SSD 9601 CLOUDED IN RED



Commercial Industrial Residential Retail Interior Design
 Suite 702, 83 Mount Street, North Sydney NSW 2060
 T 02 9929 9938 F 02 9929 8899
 info@ssearch.com.au www.ssearch.com.au

ISSUE	REV	DESCRIPTION	DATE
C	-	ISSUED FOR SSD 9601 MODIFICATION APPLICATION	04.03.2022
B	1	New entry / exit ramp code amended	17.06.2021
A	1	ISSUED FOR SSD 9601 MODIFICATION APPLICATION	03.03.2021
A	-	New Scrubber equipment layout amended	

ALTERATIONS AND ADDITIONS OF PLANT NO.2

A U S T R A L B R I C K S
 174-181 FERRERS ROAD, HORSLEY PARK NW 2157

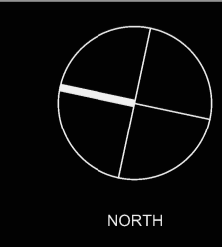

DRAWING TITLE
OVERALL SITE PLAN
 DATE AUG 2018 SCALE 1:2000@A3 1:1000@A1 JOB NO. 18212 DRAWING NO. DA 101A C

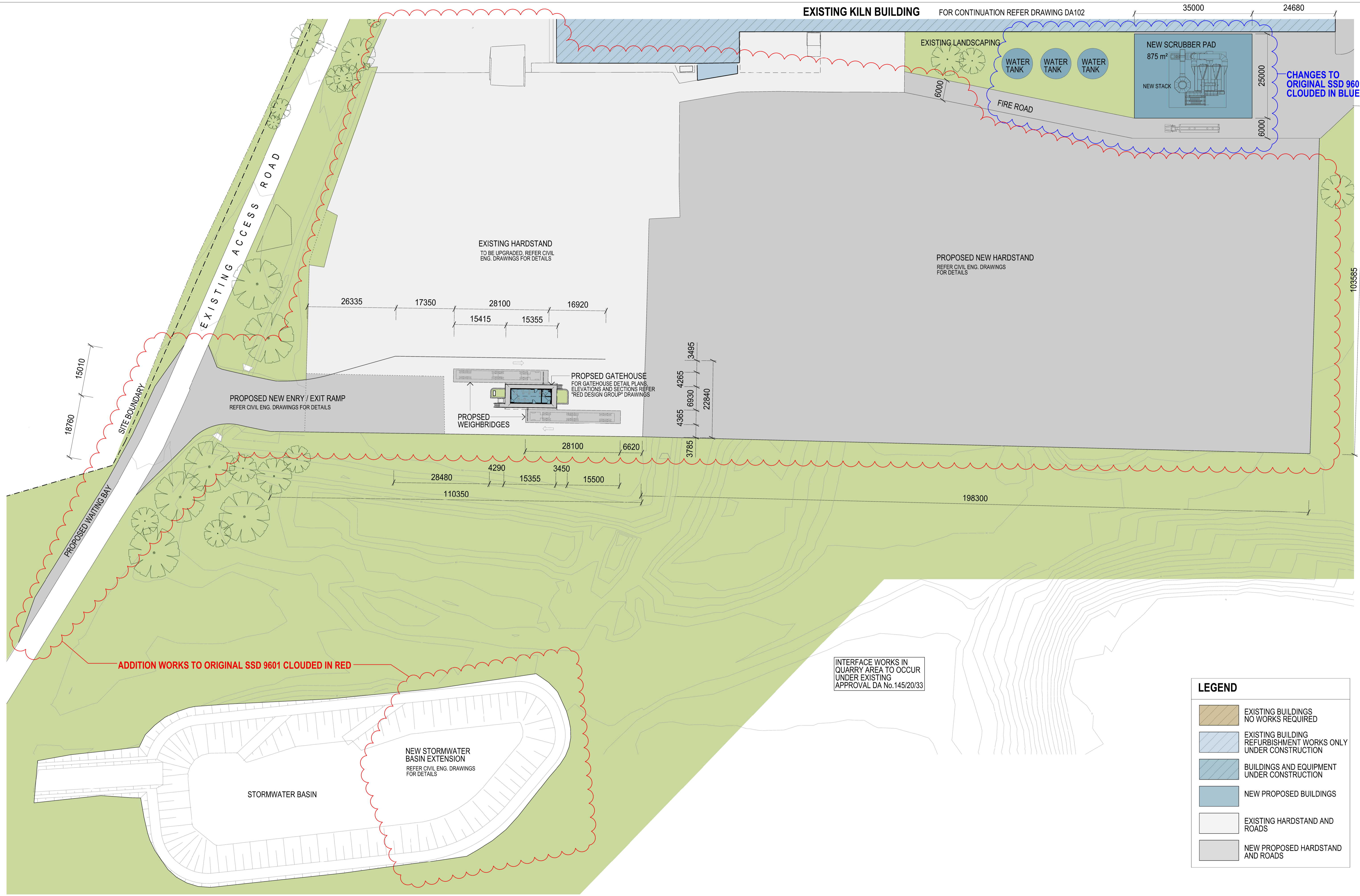

LEGEND

	EXISTING BUILDINGS NO WORKS REQUIRED
	EXISTING BUILDING REFURBISHMENT WORKS ONLY UNDER CONSTRUCTION
	BUILDINGS AND EQUIPMENT UNDER CONSTRUCTION
	NEW PROPOSED BUILDINGS
	EXISTING HARDSTAND AND ROADS
	NEW PROPOSED HARDSTAND AND ROADS

SBA ARCHITECTS

Commercial Industrial Residential Retail Interiors Design

Suite 702, 83 Mount Street, North Sydney NSW 2060

T 02 9929 9938 F 02 9929 8899

info@ssearch.com.au www.ssearch.com.au

ISSUE	REV	DESCRIPTION	DATE
B	1	REISSUED FOR SSD 9601 MODIFICATION APPLICATION	04.03.2022
B	1	New entry / exit ramp scope amended	17.06.2021
B	1	REISSUED FOR SSD 9601 MODIFICATION APPLICATION	17.06.2021
A	1	New Scrubber equipment layout amended	03.03.2021

ALTERATIONS AND ADDITIONS OF PLANT NO. 2

AUSTRAL BRICKS

174-181 FERRERS ROAD, HORSLEY PARK NW 2157

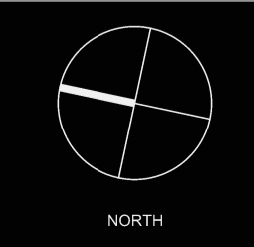

DRAWING TITLE

SITE PLAN SHEET 2

DATE: AUG 2018

SCALE: 1:1000 @A3, 1:500 @A1

JOB NO: 18212

DRAWING NO: DA 102A C