

INTELLECTUAL PROPERTY

COPYRIGHT BVN ARCHITECTURE PTY LIMITED. UNLESS OTHERWISE AGREED IN WRITING ALL RIGHTS TO THIS DOCUMENT ARE SUBJECT TO PAYMENT IN FULL OF ALL BVN CHARGES. THIS DOCUMENT MAY ONLY BE USED FOR THE EXPRESS PURPOSE AND PROJECT FOR WHICH IT HAS BEEN CREATED AND DELIVERED. AS NOTIFIED IN WRITING BY BVN AND THIS DOCUMENT MAY NOT BE OTHERWISE USED OR COPIED. ANY UNAUTHORISED USE OF THIS DOCUMENT IS AT THE USER'S SOLE RISK AND WITHOUT LIMITING BVN'S RIGHTS THE USER RELEASES AND INDEMNIFIES BVN FROM AND AGAINST ALL LOSS SO ARISING.

NOTE

CONTRACTOR TO CHECK AND VERIFY ALL DIMENSIONS ON SITE PRIOR TO COMMENCEMENT OF WORK OR PREPARATION OF SHOP DRAWINGS. DO NOT SCALE THIS DRAWING.

ISSUE	DATE	FOR
1	26/07/21	SSDA Draft
2	24/09/21	SSDA Issue
3	11/10/21	SSDA Issue
4	12/10/21	SSDA Issue
5	01/04/22	Revised SSDA Issue

CONSULTANT

STANTEC
TEL 02 9493 9700
CONSULTANT

TTW
TEL 02 9439 7288
CONSULTANT

PROCLUS ADVISORY

CONSULTANT

WILLOW TREE PLANNING
TEL 02 9929 6974
PROJECT MANAGER

PYMBLE LADIES COLLEGE
TEL 02 9855 7628

CLIENT

PYMBLE LADIES COLLEGE
PROJECT

PYMBLE LADIES COLLEGE
GREY HOUSE PRECINCT

BVN PROJECT NUMBER

2010018
DRAWING KEY

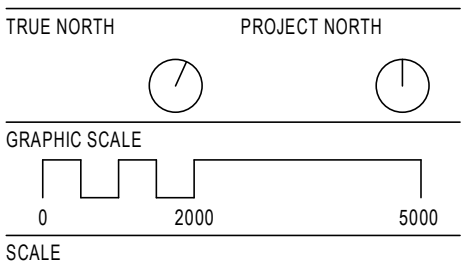

1:1200@A1
STATUS

DESIGN DEVELOPMENT
DRAWING

LOCATION PLAN

AR-DA-A10-AA-10	ISSUE
	5

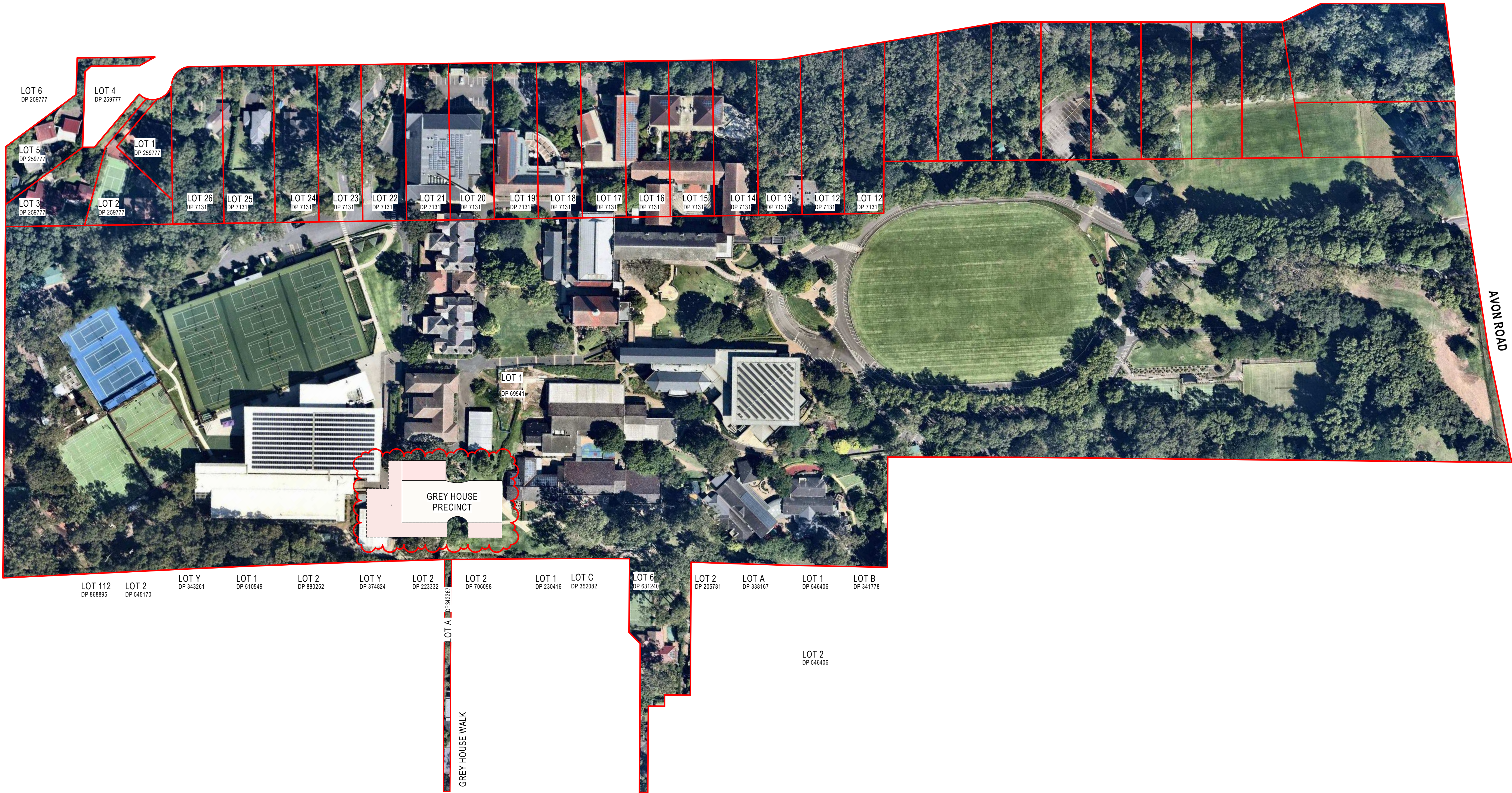

PYMBLE AVENUE