

**Hassell**

# **C4 MIDTOWN**

## **LANDSCAPE ARCHITECTURE DEVELOPMENT APPLICATION DESIGN REPORT**





**Document Control**

| Rev | Date       | Approved By | Description |
|-----|------------|-------------|-------------|
| 01  | 05.08.2021 | GD          | FINAL       |
| 02  | 17.02.2022 | GD          | FINAL       |

**Contents**

**Acknowledgment of Country**

We acknowledge and respect Traditional Owners across Australia as the original custodians of our land and waters, their unique ability to care for country and deep spiritual connection to it. We honour Elders past, present and emerging whose knowledge and wisdom has, and will, ensure the continuation of cultures and traditional practices.



**Hassell**  
 Level 2 Pier 8/9  
 23 Hickson Road  
 Sydney NSW Australia 2000  
 T +61 2 9101 2000  
 E sydney@hassellstudio.com

**Contact**  
 Jon Hazelwood  
 Principal  
 jhazelwood@hassellstudio.com  
 Georgia Darling  
 Associate  
 gdarling@hassellstudio.com

1. **Project introduction**
2. **Connecting people and place**
3. **Landscape concept**
4. **Description of landscape spaces**

**Appendices**

- Appendix A – Development Application Landscape Architectural Drawings**
- Appendix B – Schedule of exterior finishes**
- Appendix C – Planting palettes**

Indicative street view of Main Street

# PROJECT

# INTRODUCTION

**This report supports a Development Application for Lot C4 within Stage 2 of the Midtown Master Plan (SSD8707), a State Significant Development submitted to the Department of Planning and Environment (DPE) pursuant to Part 4 of the Environmental Planning and Assessment Act 1979 (EP&A Act). This proposal is to be read in conjunction with Cox Architecture Design Statement which addresses the architectural proposal.**

## Overview of the proposed development

The proposed Lot C4 Development Application seeks consent for the second stage of detailed works within Midtown, pursuant to the Ivanhoe Estate Master plan under Section 83B of the EP&A Act. The Master plan establishes the planning and development framework against which this Lot C4 Stage 2 Development Application will be assessed.

The Lot C4 development proposes;

- A social tower consisting of 17 storeys of residential floors and 216 social units
- A market tower consisting of 24 stories of residential floors with 268 units
- 4 market 3 storey town houses
- Communal open spaces
- Public open spaces
- Basement car parking

## Lot C4 Landscape Development Application

This development application seeks approval for the landscape works associated with Lot C4.

Key landscape spaces include:

- Publicly accessible Neighbourhood Garden to Main Street
- The Grove communal open space
- Mews public open space
- Shrimptons Creek interface public open space
- Sky Garden market communal open space
- Green roof (inaccessible)
- Private open spaces to ground floor dwellings

# SITE CONTEXT

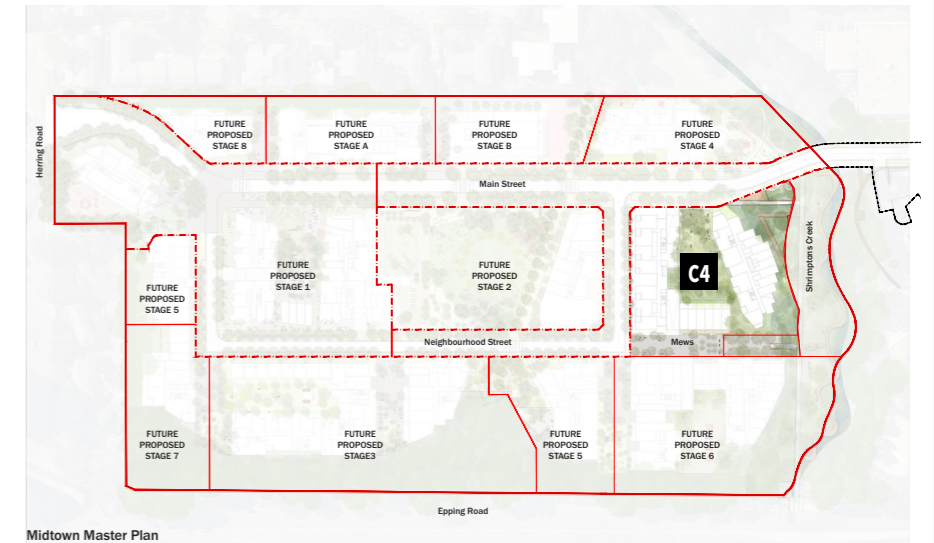

Midtown Master Plan

## Metropolitan context

Midtown is located in the suburb of Macquarie Park within the City of Ryde council in Sydney's north-western suburbs, about 10 kilometres from the Sydney CBD.

Macquarie Park is identified as a Strategic Centre along the Global Economic Corridor under 'A Plan for Growing Sydney' and as a Priority Precinct within the Epping and Macquarie Park Urban Renewal Area. It is an area of significant government investment in transport, infrastructure and education facilities.

## Regional context

Midtown is located within close proximity to Macquarie University Train Station (500 metre walk), Macquarie University, Macquarie Shopping Centre, and Macquarie Park business park.

This strategic position creates an appropriate location for which to maximise the number of people living within close proximity to this great mix of attractors and mass transit.

Due to this strategic location, it has been identified as a priority precinct known as the Macquarie University (Herring Road) Precinct, of which Midtown sits within. This precinct is proposed to deliver up to 5,800 dwellings by 2031 as part of a transformation into a vibrant centre that makes the most of the available transport infrastructure and

proximity to existing jobs, retail and education opportunities.

## Local context

The surrounding urban fabric is currently a mixture of large dispersed commercial buildings, warehouse lots, the sprawling University campus, big box shopping centre, medium to high density residential apartments, and single lot dwelling houses typical of the suburbs of Sydney.

Midtown sits within a changing context planned to experience significant growth to meet the strategic targets set for the precinct.

This diverse and changing context can inform the proposed future uses within the Ivanhoe Estate, and strengthens the need for Ivanhoe to benefit from and stitch into this surrounding fabric.

## Site context

The 8.2 hectare Midtown site is under development as apart of the Midtown Master Plan SSD, which will deliver a vibrant mixed use neighbourhood with buildings arranged to maximise residential amenity outcomes and a diverse open space network creating an inclusive, community oriented public domain.

Midtown Precinct is divided into 15 development blocks, within 4 precincts, that establish the framework for future buildings,

infrastructure and public domain within the Estate.

## Lot C4

The C4 site is located within Precinct C of the Midtown master plan, located on the corner of new Main Street, Neighbourhood Street, Mews and Shrimptons Creek corridor.

This site plays an important role connecting the urban Midtown precinct with to the Shrimptons Creek bushland corridor.

# UNDERSTANDING COUNTRY

**The project site area is located on Wallumedegal country. We acknowledge and respect the Wallumedegal people as the original custodians of the land and water upon which we work. We honour their Elders past, present and emerging whose knowledge and wisdom has, and will, ensure the continuation of cultures and traditional practices.**

## Pre-contact Wallumedegal history

Before European contact, the site area was inhabited by the Wallumedegal clan. The name Wallumedegal (or Wallumattagal) is likely to have been derived from "wallumai", or the snapper fish in Dharug language. This is combined with "matta", a Dharug word used to describe a place, usually on or near water. Taken together this could reference the snapper clan and their totem the 'wallumai'.

Wallumedegal territory is defined by the surrounding rivers. The estuarine Parramatta River forms the border to the south and Lane Cove River defines its extent to the east and north.

Before European contact, Wallumedegal Country was a rich environment of river flats, creeks and mangrove swamps. In addition

to edible plants, fish, shellfish, birds and small game formed the basis of the local Wallumedegal diet. Trade and exchange between clans was commonplace.

## Flora

Endemic to Midtown is both the Sydney Turpentine-Ironbark Forest and the Shale/Sandstone Transition Forest.

The North Ryde region of Sydney was a forested environment with vegetation thought to have been largely composed of the Sydney Turpentine-Ironbark Forest, characterised by a 30m tall open forest and dense understorey (except where burnt by the Wallumedegal people, a land management and food production task performed on a regular basis).

The Shale/ Sandstone Transition

Forest occurred in the narrow band where the gently undulating Cumberland Plain meets the steep slopes of the Sandstone Country.

The coming together of these distinct landscape types means that the species associated with each of the adjacent ecosystems intermingle to form an individual distinct unit. Characteristics are high diversity and unusual species composition. The structure of the community is forest or woodland with an understorey of shrubs and native grasses and herbs. Typical trees are Grey Gum, White Stringybark, Red Mahogany, Grey Ironbark, Broad-leaved Ironbark, and Narrow-leaved Ironbark.

Julie Dawson captures the qualities of the forest landscape "...and the russet and purple hues of maturing crops, with white and pink blooms of budding and flowering trees... with the towering Ironbark, Spotted



Gum, White Gum, Blackbutt and Woollybutt... and the dim outline of mountain ranges blue and hazy in the distance..."

Small stands of this naturally rare community remain, of which a small number can be found in the northern area of the Ryde LGA along Epping Road and near Macquarie University.

## Fauna

Present day Wallumedegal territory is still home to a wide range of wildlife. Although original habitat areas have been heavily reduced, small pockets of reserve remain. Wildlife protection areas exist at Field of Mars Reserve, Terry's Creek Corridor and Kitty's Creek Corridor. Echidnas, swamp wallabies, bandicoots, wrens, owls, possums and water dragons are all found in these areas.

Shrimptons Creek flows through the

project site. There are eight named reserves and parks in the Shrimptons Creek group. In reality these reserves form a fairly contiguous riparian corridor along Shrimptons Creek and most species of fauna evident in this area are likely to utilise multiple reserves within the system.

## Agricultural history

Throughout the nineteenth century the area was farmed, largely by orchardists, market gardens and poultry farms.

Julie Dawson illustrates the agricultural landscape in 'The North Ryde Recorder' (1902), "behind the front vineyard are the loquats and patches of mandarins and oranges, the St Vincent predominating in the former and the St Michael in the latter. The Seville is fairly represented. So far as the Mandarins are

concerned, the pride of place is given the Emperor."

In the 1940s much of the Macquarie Park area was subdivided for suburban development in the period immediately after the Second World War. Midtown was developed into a social housing estate by the Department of Housing in the 1960-80s.

Despite the development of farms, housing, commercial and university land uses over time - the native landscape has not been eradicated all together. Remnant areas of ecosystems are evident at Shrimptons Creek, Field of Mars, Terry's Creek, Brush Farm Park, Darvall Park, Wallumatta Nature Reserve and Kitty's Creek.

## Image references:

1. Brothers Nursery 1920, Epping
2. Sydney Turpentine Ironbark Forest
3. Epping Road 1911
4. Shale Transition Forest
5. Buckingham Falls Shrimptons Creek 1915, Macquarie Park

# 2. CONNECTING PEOPLE AND PLACE

Connecting people and place

## WHERE THE FOREST MEETS THE NEIGHBOURHOOD

Midtown is bordered on two sides by stands of bushland - a protected Sydney Turpentine Ironbark forest along Epping Road and the riparian corridor of Shrimptons Creek.

Set amongst the bushland is the new Midtown neighbourhood. Comprised of active and engaging open spaces and streetscapes.

C4 is where the forest meets the neighbourhood. The landscape design celebrates the blurring of the two typologies - bringing together the organic, informal nature of the bush with the robust regularity of the urban neighbourhood.

The bush is brought up from the creekline, into the new open

spaces and streetscapes while the neighbourhood extends down the new streetscapes.

The character of the two landscapes are expressed in the form, composition material and planting palettes to create a landscape experience that is connected to place.

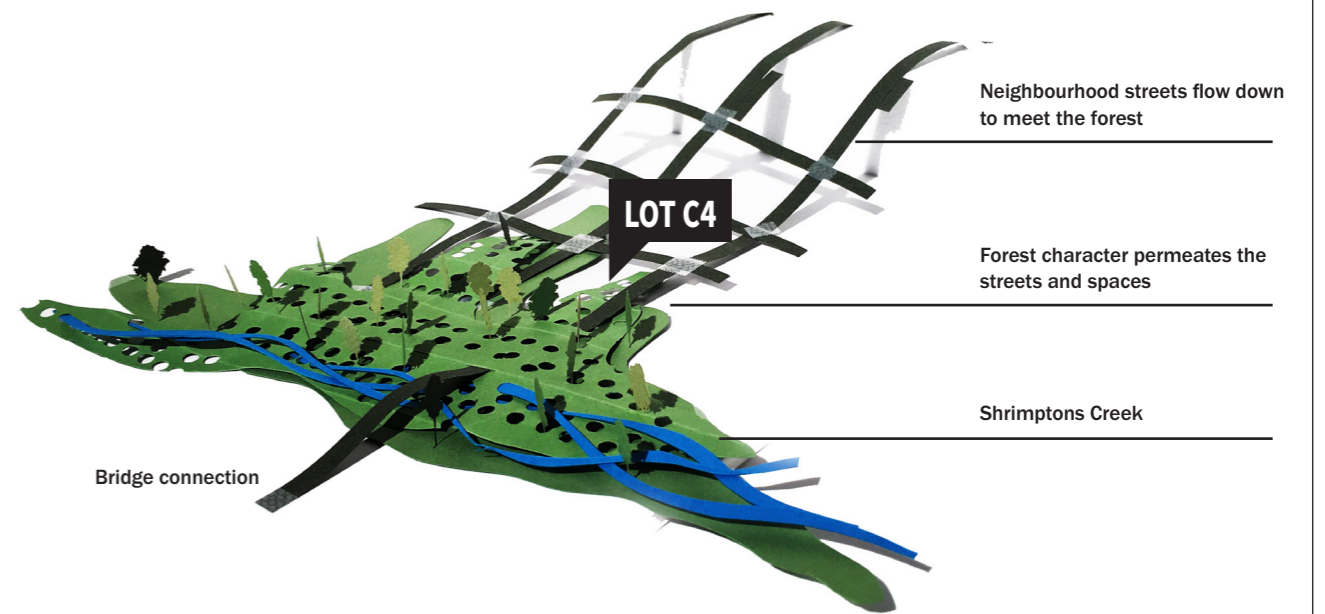

Transitioning from forest to neighbourhood in the texture and colour in materiality and planting

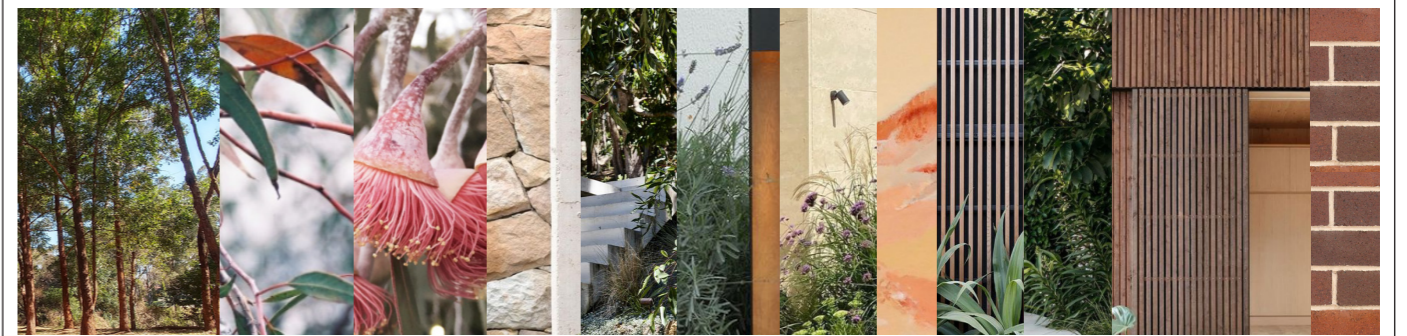

Forest

Neighbourhood

# SHRIMPTONS CREEK PARKLANDS

Protecting, restoring and reconnecting the ecologically and socially significant open space.

Shrimptons Creek and the Shrimptons Creek Parklands are of high importance in the design approach to Midtown. The parklands, comprised of seven parks that sit adjacent to Shrimptons Creek, are significant because they provide a continuous connection through the local government area from north to south. It is a connected recreational and environmental spine that serves the Ryde community.

While the C4 Development Application sits outside the boundaries of the parkland network, our intent is to support the strategic planning and sustainable management framework of the parklands - to conserve the parks natural, cultural and indigenous

resources while promoting public recreation and leisure.

Future stages of the Midtown master plan will include the revitalisation of the parklands corridor.

Our design approach to the interface with Shrimptons Creek Parklands has been informed by relevant planning documents and studies including;

- Shrimptons Creek Parklands Plan of Management (2012)
- Shrimptons Creek Small Bird Habitat Project, Habitat Network
- Greener Places Design Guide Draft (2020), NSW Government Architects

In line with the Greener Places Design Guide, five key strategies have been employed to connect, restore, enhance and create urban habitat within Shrimptons Creek.

In the table below we outline the five key principles and how the Lot C4 design addresses each of these principles.

### Designing with country

Frasers, in conjunction with the Fulcrum Agency, have identified opportunities for Connecting with Country across the master plan.

A range of opportunities for Traditional Custodian and Aboriginal stakeholder engagement have been identified in the Shrimptons Creek Parklands corridor and adjacent developments. Themes or narratives may include vegetation, biodiversity and riparian corridor and water health. These will be included in future development applications.

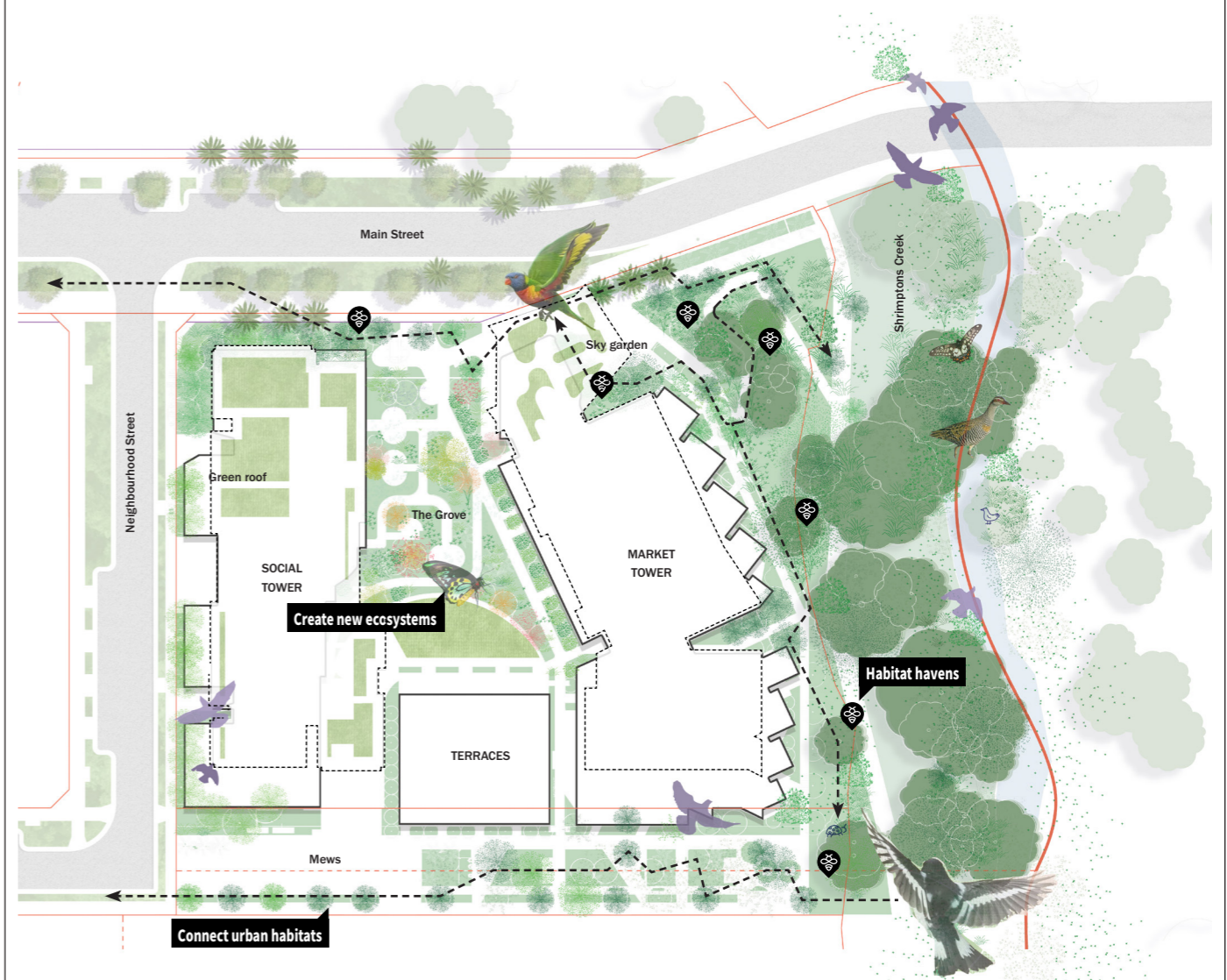

### Five Key Strategies

|   |   |
|---|---|
| 1 Protect and conserve ecological values                                | The landscape proposal for Lot C4 builds upon the existing bushland character of the Turpentine-Ironbark Forest. The bushland character is brought into the design of all the public open spaces.   |
| 2 Restore disturbed ecosystems to enhance ecological value and function | The Shrimptons Creek Parkland corridor is largely disturbed with weed species prominent. Open space within the C4 Lot adjoining Shrimpton's Creek will be restored to support habitat structure and support biodiversity.                                       |
| 3 Create new ecosystems   | New habitat linkages are provided from the parkland into the Midtown site through pollinator-attracting tree and groundcover planting, green walls and green roofs.   |
| 4 Connect people to nature  | Open space within the C4 Lot create opportunities for people to connect with nature while minimising ecological impacts. Amenities include small amphitheatre lookouts, connection to existing shared path network and picnic facilities.                       |
| 5 Connect urban habitats  | Planting within the project aims to improve habitat and habitat connections within the parkland and Midtown. This is achieved by creating 'habitat havens' and tree planting that draws upon the principles of the Shrimptons Creek Small Bird Habitat Project. |

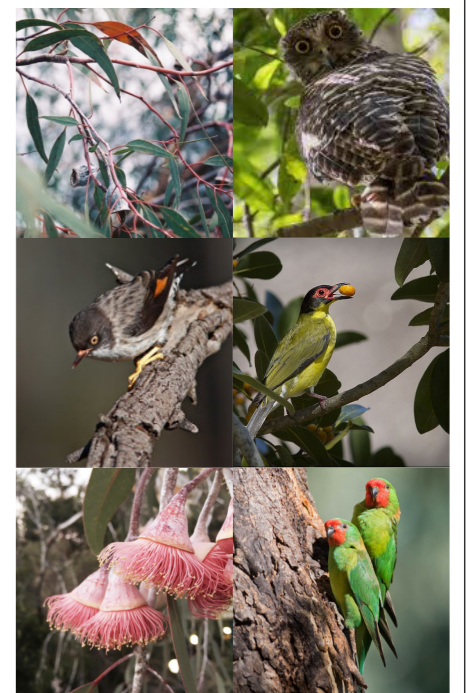

# A VIBRANT OPEN SPACE NETWORK

## Planning for a connected and diverse open space network.

Our vision is for a vibrant mixed used neighbourhood with a diverse open space network for an inclusive community oriented development.

As we plan for future growth and development, access to high quality open space becomes increasingly important. In the master plan process, we reviewed relevant state and local government strategies and plans to understand the planning direction for Macquarie Park and the expected social infrastructure needs of the local community.

The research told us the Midtown is well connected to a diverse open space network. The Shrimptons Creek Parkland serves as an important connector between various open space types.

Studies anticipate the greatest demand for open space for Midtown future populations will be for passive, unstructured open spaces including low impact physical opportunities.

A diversity of open spaces that encourage community interaction, including smaller spaces for conversation based interaction, picnics, barbecues and social gathering will be critical for the diverse population.

These demands are met in the 2.05ha of new public open space within the master plan including village green, forest playground, and improvements to the Shrimpton's Creek Parklands, ecological corridor, and mews streets.

As shown in the 'Midtown diversity of open spaces' diagrams (right) - the C4 lot is well serviced by open spaces. In close proximity to the major, small and incidental open spaces.

Precinct open space map

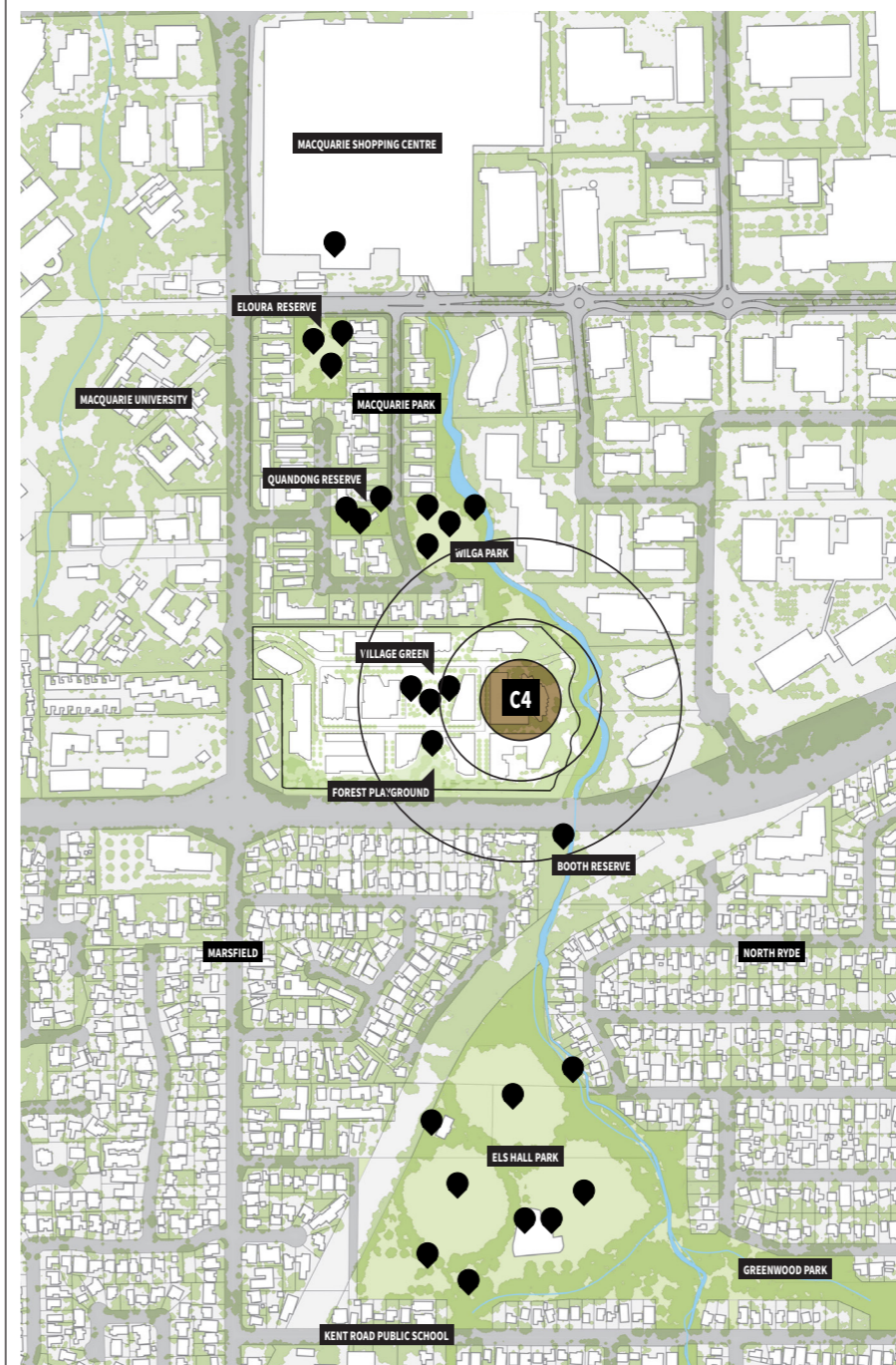

Midtown's diversity of open spaces

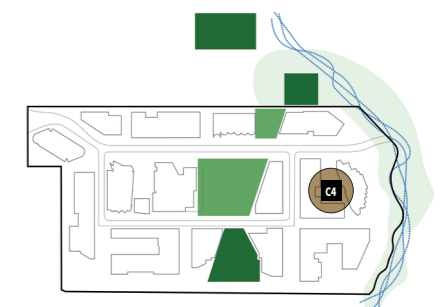

**Primary Open Spaces**  
Active community focused open spaces include the village green, forest playground, school garden and connection through to Wilga Reserve.

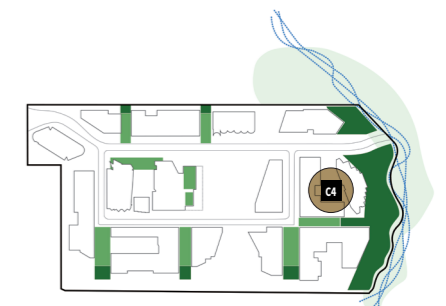

**Small Open Spaces**  
Smaller public open spaces include street neighbourhood gardens - quieter urban settings. At the edges of the development where the shared local streets meet the perimeter bushland, forested urban gardens will formalise these transitions.

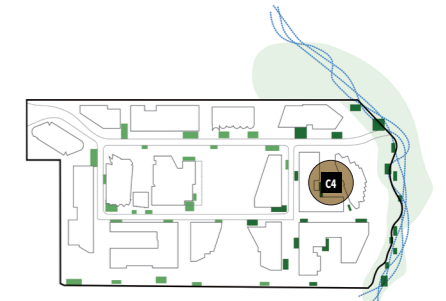

**Incidental Spaces**  
The streets and open spaces of Ivanhoe and along Shrimptons Creek will be furnished with small areas for sitting, meeting and reflecting. Strategically arranged seating and planting will create these quieter small moments in the public landscape.

# 3.

# LANDSCAPE

# CONCEPT

The C4 development connects with the rich landscape setting. The surrounding bushland is drawn from the creekline into Midtown. Set amongst the immersive landscape is a diverse collection of public and private open spaces for residents and the local community. There are places for socialising, physical activity and connection with nature.



# LANDSCAPE FRAMEWORK



## Planting character

The plant palettes varies across the C4 site - changing from forest to neighbourhood character moving away from Shrimptons Creek into Midtown.

Forest planting mixes are inspired by the Sydney Turpentine Ironbark Forest and pollinator attracting species. Neighbourhood planting mixes bring in suitable ornamental species in a garden character,

Where solar access is limited, deciduous trees are nominated to maximise winter sun. Colourful flowering species are also proposed to add depth and vibrancy to these spaces.

Rooftop species are selected for their suitability in exposed conditions.

### Legend

|  |
|--|
| PL1 Neighbourhood Garden                 |
| PL2 Shrimpton's Creek                    |
| PL3 Shrimpton's Creek private open space |
| PL4 Mews                                 |
| PL5 Neighbourhood Street                 |
| PL6 The Grove                            |
| Lawn                                     |
| PL7 Sky Garden                           |
| PL8 Rooftop                              |

## Connections

Legible, safe and accessible connections are designed within the C4 lot. Public links through the Neighbourhood Gardens and Mews are widely proportioned and generally flat to support ease of movement.

Connections from Main Street, through the C4 site to the existing Shrimptons Creek corridor shared path via both stair and accessible ramp.

### Legend

|                                       |
|---------------------------------------|
| Level paths & plaza                   |
| Accessible ramps (MAX 1:14)           |
| Stair, step ramp or amphitheatre      |
| Shrimptons Creek existing shared path |



## Tree Canopy

The design approach to tree planting within the C4 residential site is to utilise both tree canopy and other soft landscaping elements to alleviate key environmental and social issues faced by modern cities including urban heat island, flora and fauna habitat, equitable open space for recreation & well-being as well as soil, water and air quality.

The design provides

- Ground level tree planting both on slab and on deep soil
- Trees retained along Shrimptons Creek where possible
- Small trees to sky garden and rooftop
- Green wall to southern facade
- Green roof in the grove
- Extensive groundcover planting at the ground level, sky garden and rooftop

### Legend

|                            |
|----------------------------|
| Tree canopy (groundplane)  |
| Tree canopy (in deep soil) |
| Existing trees             |



## Access

All the open spaces surrounding C4 are publicly accessible. The Neighbourhood Gardens and Mews street will provide uninterrupted connections for the public to and from Shrimptons Creek. The amenities within these spaces will support the C4, Midtown and surrounding community.

Communal open spaces are provided within the heart of the C4 lot. This open space is separated from public access via fencing at the two main entry points from public open space.

### Legend

|  |
|--|
| Communal open space (publicly accessible)  |
| Communal open space (resident access only) |
| Private open space                         |
| Open space external C4 site                |
| Shrimptons Creek (RE2)                     |

# LANDSCAPE CONCEPT PLAN

**LEGEND**

**NEIGHBOURHOOD GARDEN**

- A** Lobby and Shrimpton's Creek arrival plaza
- B** Public garden gathering zone to Main Street
- C** Public garden gathering zone overlooking Shrimpton's Creek
- D** Garden planting zone

**THE GROVE**

- E** Entry arrival gate
- F** Garden rooms (four person gathering)
- G** Large garden (eight person gathering) rooms and water feature/ bird bath
- H** Pedestrian ramp from lobby to the grove
- I** Mass planted garden beds
- J** Green roof over parking entry

**MEWS**

- K** Trafficable mews to car park entries
- L** 'Backyard room' gathering zone including lawn, plinth seating
- M** Pole top lighting from Neighbourhood Street to Shrimpton's Creek
- N** Plaza and bleacher steps to Shrimpton's Creek
- O** Bicycle parking

**SHRIMPTON'S CREEK INTERFACE**

- P** Stair to Shrimpton's Creek
- Q** Accessible ramp to Shrimpton's Creek
- R** North-south footpath from Mews to Main Street
- S** Local community gathering lawns including bench seating and shade trees
- T** Amphitheatre bleacher seats looking onto creekline
- U** Existing Shrimpton's Creek shared path. No works proposed.



# 4.

# DESCRIPTION OF THE SPACES

## Description of the spaces

# NEIGHBOURHOOD GARDEN

Neighbourhood gardens are discovered off the streets across Midtown. The gardens offer the opportunity to dwell under the shade of a tree while enjoying the activity of the neighbourhood street.



- Vibrant and active
- Community gathering
- Connect with nature

The Neighbourhood Garden will be a vibrant community gathering space - activated by the adjoining Shrimptons Creek Parkland, Main Street and residential lobby entrances.

The C4 neighbourhood garden connects to the Shrimptons Creek corridor, bringing habitat havens from the creekline up into Midtown's public domain.

Garden beds and seating nooks create a series of small rooms for gathering and connection with nature.

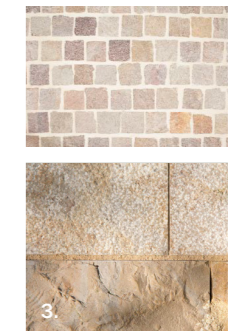

Images:  
1. BBC Television Centre, London. Gillespies  
2. Sky TV Campus, London. Urban  
3. Indicative paving palette  
4. Indicative planting palette



# THE GROVE

The grove, located in the centre of the C4 residential lot, is a place for respite and quiet reflection.

- Tranquil and immersive
- A place for respite
- Garden gatherings
- Connect with seasonal nature

The grove is a place for residents to discover quiet respite in nature. Designed to be enjoyed from within or looking upon from adjoining residential balconies.

Seating nooks surrounded by planting support informal gathering for individuals and small groups.

A palette of colourful, ornamental planting creates a seasonal display of colour that adds depth to the space. Small water features/bird baths will attract small birds.

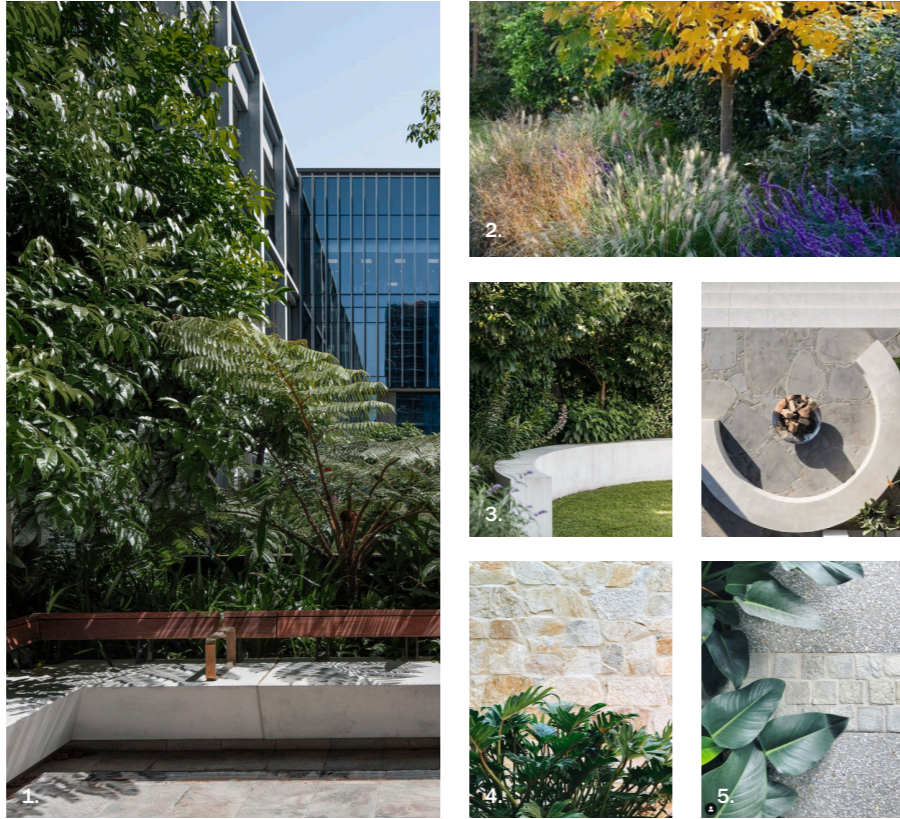

Images:

1. Character image - Herston Quarter, Brisbane. Hassell
2. Planting reference - Haberfield, Sydney. Fieldwork
3. Seating reference - Haberfield, Sydney. Fieldwork
4. Wall finish to green roof
5. Indicative paving materiality



# MEWS

The mews is a linear neighbourhood plaza that services carpark entries while creating an urban attractive community gathering space.

- Functional and attractive
- A place for respite
- Garden gatherings
- Connect with seasonal nature

Located between residential buildings, the mews provide access to basement parking in a shared-zone style condition. Detailed as a flush paved surface, tree planting and street furniture define the edges of the trafficable zone.

Beyond the carparks, within the forest threshold, a series of informal outdoor rooms are set down towards the creekline. Each room includes a raised lawn, seating plinth and open space with vistas out to the creekline.



Images:

1. Hibernian Place, Perth. Hassell
2. Croydon South End High Street, London. Hassell
3. Indicative planting mix. Dangar Smith
4. Indicative mews view.



# MAIN STREET TO MEWS



Key Plan

## Section - Mews to Main Street

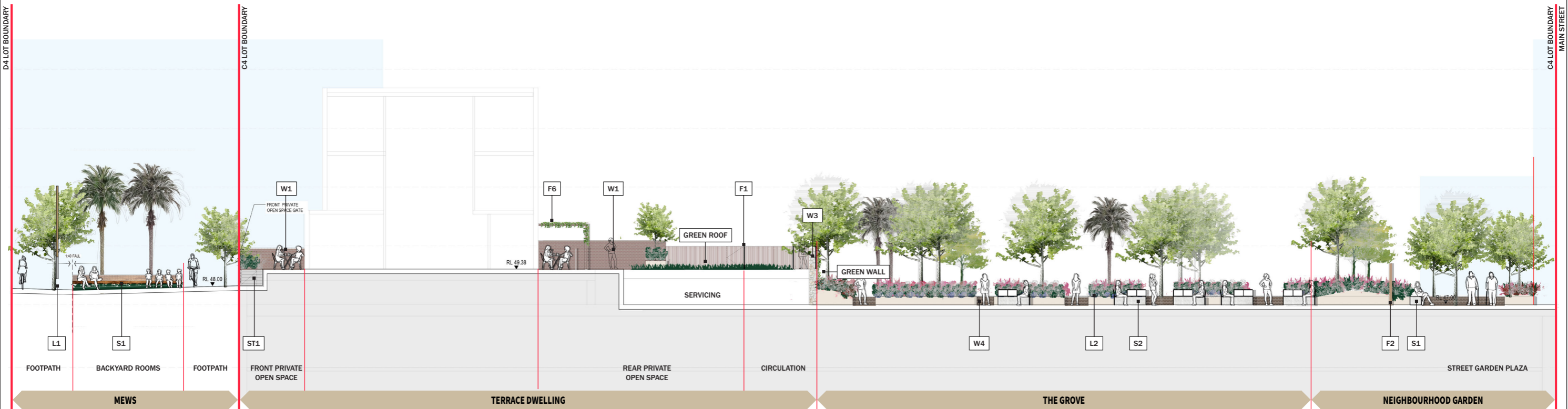

## Material palette

### WALLS & STAIRS



**W1**  
Brick walling to private open spaces to architects detail

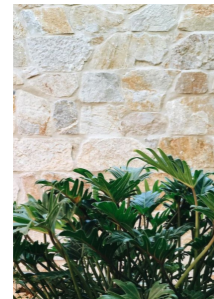

**W3**  
Dry stone walling face-brick  
Colour: Sandstone  
Location: The Grove



**W4**  
Steel garden bed walling  
Colour: Bronze  
Location: The Grove

### FURNITURE & FIXTURES

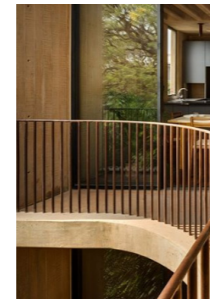

**F1 / F2**  
Private open space palisade fence & Neighbourhood Garden fence to architects detail



**F6**  
Pergola  
Location: Terrace rear private open spaces



**S1**  
Modular seating benches & seats with backrests  
Type: Timber  
Location: Public Domain

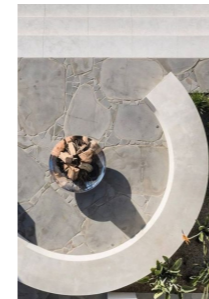

**S2**  
Banquette seating  
Type: Concrete  
Location: The Grove



**L1**  
Lighting  
Type: Pole LED luminaries  
Location: Mews

### SOFTWARES



**L2**  
Lighting  
Type: Garden bollard lights  
Location: The Grove



**Green roof**  
Type: Low-profile planting  
Location: Over loading/ services



**Green wall**  
Type: Vertical trellis  
Location: Over loading

# SHRIMPTONS CREEK PUBLIC OPEN SPACE

The C4 lot landscape proposal supports the sustainable management framework of the parklands — to conserve the parks natural and cultural while promoting public recreation and leisure.



- Local community gathering
- Connection from Midtown to creek
- Ecological restoration
- Habitat connection

The open space between the C4 and the Shrimptons Creek Parklands acts as a threshold between the new neighbourhood and existing riparian zone.

The proposal allows for two points of access from Midtown to the existing creekline and shared path.

There are multiple opportunities for gathering in this public open space including amphitheatre steps and lawns.

Between gathering spaces, native planting is restored to support local biodiversity.



Images:  
 1. Character image - Westbund, Shanghai. Hassell  
 2. Materiality reference - walls, seating & footpaths  
 3. Materiality & planting reference  
 4. Materiality & planting reference



# SKY GARDEN & ROOFTOP

The sky garden and rooftop at C4 provide open space and visual amenity to residents. They support local biodiversity and assist in the amelioration of urban heat island effect.



- Sustainable living - community garden
- Connection to nature
- Garden gatherings
- Connect with seasonal nature

The sky garden is an accessible rooftop which is planted out in a combination of edible and ornamental plant mixes.

Raised garden beds integrate seating and an outdoor kitchen to support outdoor gatherings.

On the rooftop, raised garden beds are positioned in-between services. These beds are planted out with hardy species, suitable to the exposed conditions.



Images:  
 1. Character image - The Deck, Thailand. Shma Designs  
 2. Planting reference - productive garden beds  
 3. Materiality reference - edging details  
 4. Materiality reference - paving detail  
 5. Planting reference character image

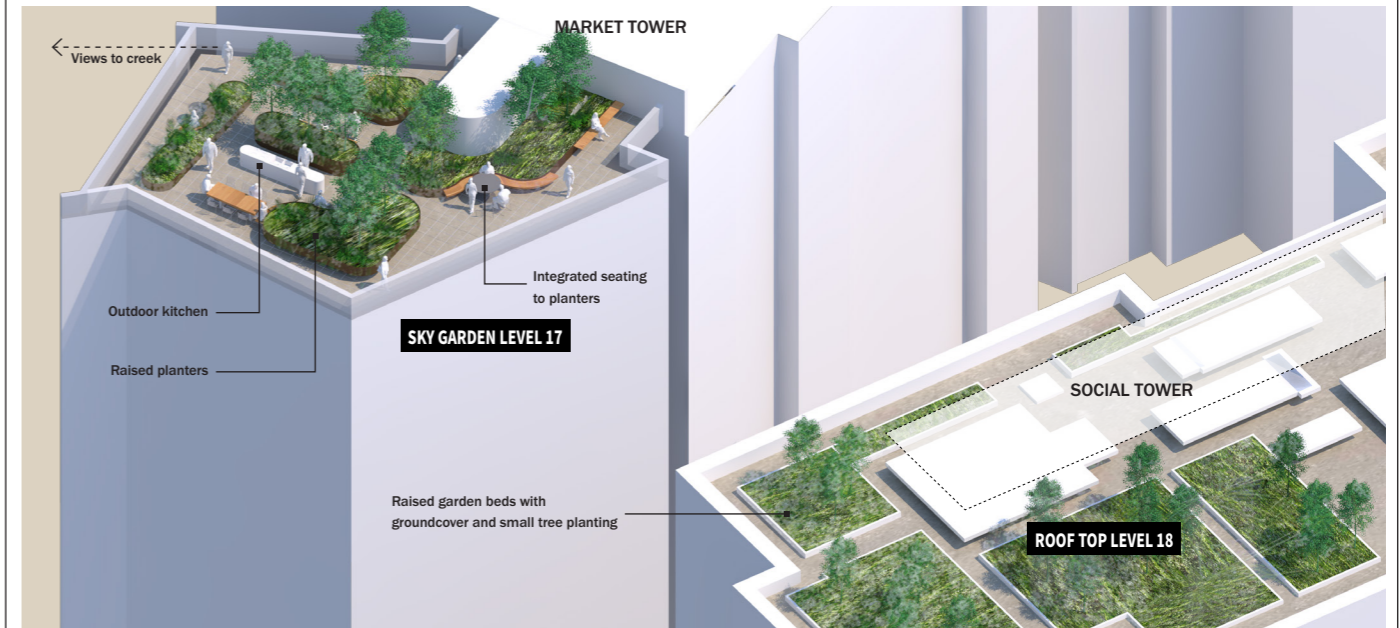

## Studios

**Brisbane**  
36 Warry Street  
Fortitude Valley QLD Australia 4006  
T +61 7 3914 4000  
E brisbane@hassellstudio.com

**Hong Kong**  
22F, 169 Electric Road  
North Point Hong Kong  
T +852 2552 9098  
E hongkong@hassellstudio.com

**London**  
Level 1  
6-14 Underwood Street  
London N1 7JQ United Kingdom  
T +44 20 7490 7669  
E london@hassellstudio.com

**Melbourne**  
61 Little Collins Street  
Melbourne VIC Australia 3000  
T +61 3 8102 3000  
E melbourne@hassellstudio.com

**Perth**  
Level 1  
Commonwealth Bank Building  
242 Murray Street  
Perth WA Australia 6000  
T +61 8 6477 6000  
E perth@hassellstudio.com

**San Francisco**  
650 California Street  
Level 7  
San Francisco CA 94108 United States  
T +1 415 860 7067  
E sanfrancisco@hassellstudio.com

**Shanghai**  
12F base 45 Caoxi North Road  
Xuhui District Shanghai 200030 China  
T +8621 5456 3666  
E shanghai@hassellstudio.com

**Singapore**  
33 Tras Street  
#02-01 078973 Singapore  
T +65 6224 4688  
E singapore@hassellstudio.com

**Sydney**  
Level 2 Pier 8/9  
23 Hickson Road  
Sydney NSW Australia 2000  
T +61 2 9101 2000  
E sydney@hassellstudio.com

# APPENDIX A: DEVELOPMENT APPLICATION DRAWINGS

## Drawing list

| Drawing Number | Title                             |
|----------------|-----------------------------------|
| HSL-C4-1001    | General Arrangement - Groundplane |
| HSL-C4-1801    | General Arrangement - Roof plan   |
| HSL-C4-3001    | Sections                          |
| HSL-C4-3002    | Sections                          |

H

### REVISION

[001, Development Application]  
[002, Development Application]

### DATE

[05-August2021]  
[17-February2022]

### CLIENT

Frasers Property Australia

### PROJECT NAME

Lot C4 Midtown  
Epping Road, Macquarie  
Park

### DRAWING NUMBER

HSL-C4-0001  
Cover sheet

Indicative layout only - not for construction.



**REVISION**

[001, Development Application]  
[002, Development Application]

**DATE**

[05-August2021]  
[17-February2022]

**SCALE**

[1:@250@A1]

**CLIENT**

Frasers Property Australia

**PROJECT NAME**

Lot C4 Midtown  
Epping Road, Macquarie  
Park

**DRAWING NUMBER**

HSL-C4-1001  
General Arrangement -  
Ground

Indicative layout only - not for construction.



| REVISION                       | DATE              | SCALE       | CLIENT                     | PROJECT NAME                                     | DRAWING NUMBER                                    |
|--------------------------------|-------------------|-------------|----------------------------|--|---|
| [001, Development Application] | [05-August2021]   | [1:@250@A1] | Frasers Property Australia | Lot C4 Midtown<br>Epping Road, Macquarie<br>Park | HSL-C4-1002<br>General Arrangement - Roof<br>plan |
| [002, Development Application] | [17-February2022] |             |                            |  |   |

Indicative layout only - not for construction.

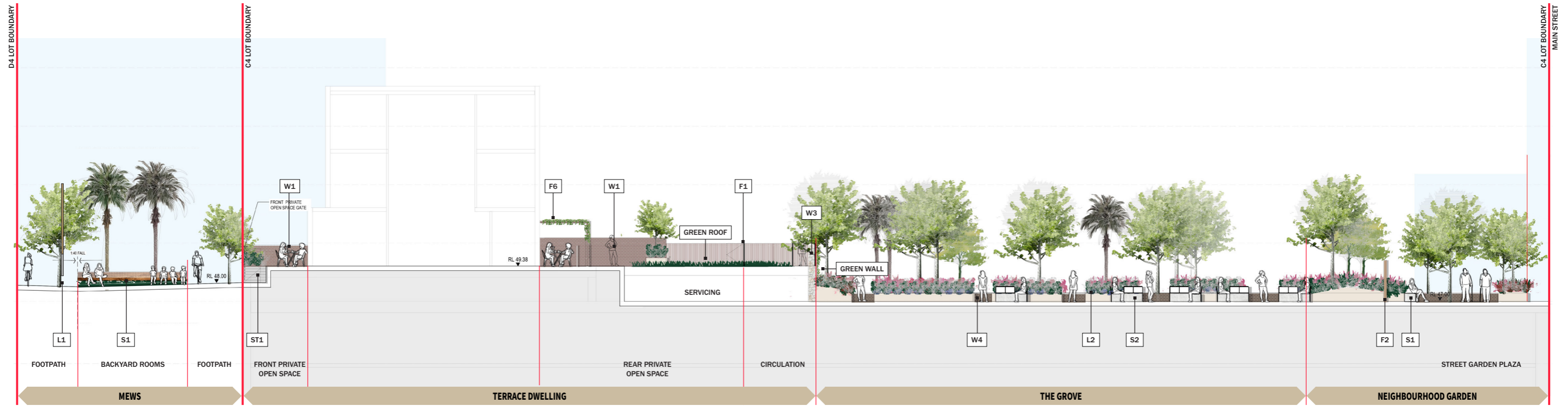

**SECTION AA**  
Mews to Main Street

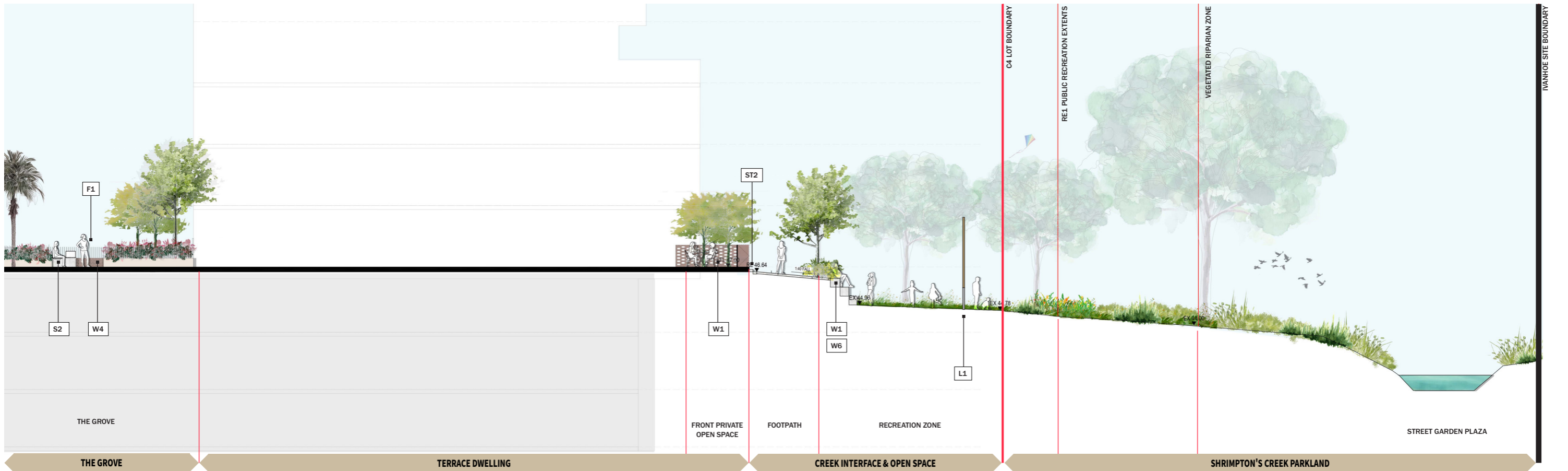

**SECTION AA**  
Mews to Main Street

H



**REVISION**

[001, Development Application]  
[002, Development Application]

**DATE**

[05–August2021]  
[02–February2022]

**SCALE**

[1:@100@A1]

**CLIENT**

Frasers Property Australia

**PROJECT NAME**

Lot C4 Midtown  
Epping Road, Macquarie  
Park

**DRAWING NUMBER**

HSL-C4-3001  
Sections

Indicative layout only - not for construction.

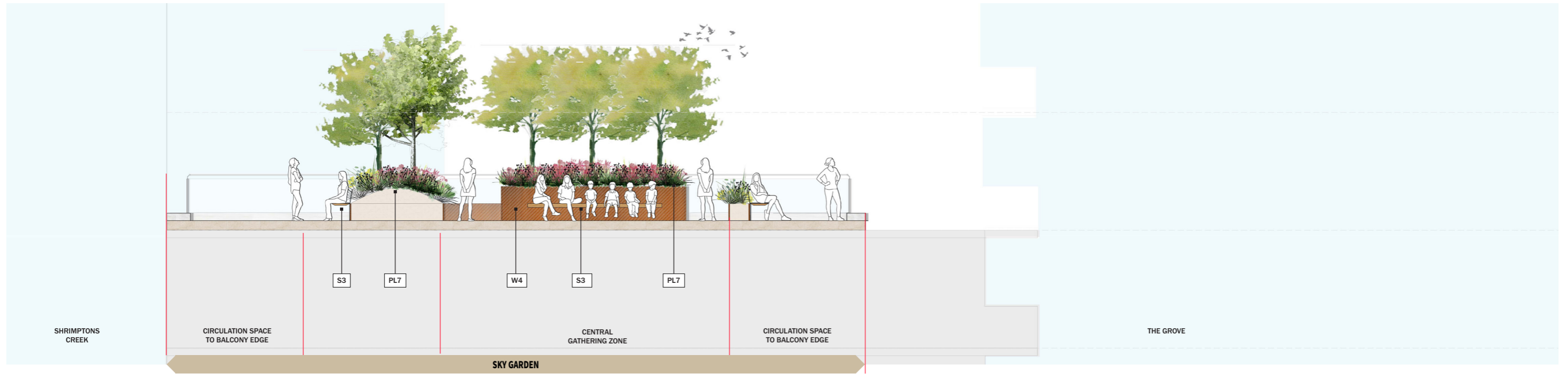

**SECTION CC**  
Sky Garden



**REVISION**

[001, Development Application]  
[002, Development Application]

**DATE**

[05-August2021]  
[17-February2022]

**SCALE**

[1:@50@A1]

**CLIENT**

Frasers Property Australia

**PROJECT NAME**

Lot C4 Midtown  
Epping Road, Macquarie  
Park

**DRAWING NUMBER**

HSL-C4-3002  
Sections

Indicative layout only - not for construction.

**APPENDIX B:**  
**SCHEDULE OF**  
**EXTERIOR FINISHES**

Appendix B: Schedule of exterior finishes

W - WALLS

|   |   |               |
|---|---|---------------|
|  | DESCRIPTION                                   | WALLS         |
|   | MATERIAL                                      | BRICK WALLING |
|   | LOCATION                                      |               |
| DESCRIPTION   | REFER ARCHITECTURAL DOCUMENTATION FOR DETAILS |               |

|   |   |               |
|---|---|---------------|
|  | DESCRIPTION                                   | WALLS         |
|   | MATERIAL                                      | BRICK WALLING |
|   | LOCATION                                      |               |
| DESCRIPTION   | REFER ARCHITECTURAL DOCUMENTATION FOR DETAILS |               |

|   |             |                  |
|---|-------------|------------------|
|  | DESCRIPTION | STONE WALL       |
|   | MATERIAL    | SANDSTONE FACING |
|   | LOCATION    | THE GROVE        |

|   |             |                           |
|---|-------------|---------------------------|
|  | DESCRIPTION | GARDEN BED RETAINING WALL |
|   | MATERIAL    | STEEL BRONZE              |
|   | LOCATION    | THE GROVE AND ROOFTOP     |

|  |             |                    |
|--|-------------|--------------------|
|  | DESCRIPTION | RETAINING WALLS    |
|  | MATERIAL    | BRICK              |
|  | LOCATION    | PRIVATE OPEN SPACE |

|   |             |                            |
|---|-------------|----------------------------|
|  | DESCRIPTION | RETAINING WALLS            |
|   | MATERIAL    | SANDSTONE LANDSCAPING LOGS |
|   | LOCATION    | SHRIMPTONS CREEK           |

ST - STAIRS

|   |             |   |
|---|-------------|---|
|  | DESCRIPTION | STAIR   |
|   | MATERIAL    | CONCRETE STAIR                                |
|   | LOCATION    | THE GROVE                                     |
|   | DESCRIPTION | REFER ARCHITECTURAL DOCUMENTATION FOR DETAILS |

|   |             |   |
|---|-------------|---|
|  | DESCRIPTION | STAIR   |
|   | MATERIAL    | SANDSTONE LOG STAIR                           |
|   | LOCATION    | SHRIMPTONS CREEK                              |
|   | DESCRIPTION | REFER ARCHITECTURAL DOCUMENTATION FOR DETAILS |

PV - PAVEMENTS

|  |             |                                   |
|--|-------------|-----------------------------------|
|  | DESCRIPTION | STREET & PLAZA PAVING             |
|  | MATERIAL    | GRANITE                           |
|  | LOCATION    | NEIGHBOURHOOD GARDENS             |
|  | DESCRIPTION | COLOUR: HONEY JASPER & MOASIC RED |

|  |             |                                     |
|--|-------------|-------------------------------------|
|  | DESCRIPTION | PORPHYRY SET                        |
|  | MATERIAL    | GRANITE                             |
|  | LOCATION    | THE GROVE                           |
|  | DESCRIPTION | BANDS OF SETS IN CONCRETE FOOTPATHS |

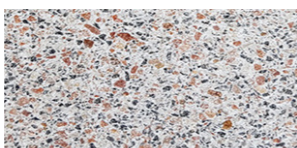
|  |             |   |
|--|-------------|---|
|  | DESCRIPTION | CONCRETE                                      |
|  | MATERIAL    | CONCRETE AND RECYCLED AGGREGATE               |
|  | LOCATION    | THE GROVE                                     |
|  | DESCRIPTION | REFER ARCHITECTURAL DOCUMENTATION FOR DETAILS |

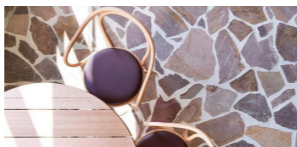
|  |             |   |
|--|-------------|---|
|  | DESCRIPTION | CRAZY PAVING                                  |
|  | MATERIAL    | GRANITE                                       |
|  | LOCATION    | THE GROVE/ SKY GARDEN & ROOFTOP               |
|  | DESCRIPTION | REFER ARCHITECTURAL DOCUMENTATION FOR DETAILS |

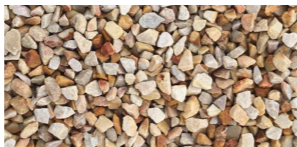
|   |             |   |
|---|-------------|---|
|  | DESCRIPTION | GRAVEL  |
|   | MATERIAL    | 'WILD HONEY'                                  |
|   | LOCATION    | THE GROVE/ SHRIMPTONS CREEK                   |
|   | DESCRIPTION | REFER ARCHITECTURAL DOCUMENTATION FOR DETAILS |

|  |             |  |
|--|-------------|--|
|  | DESCRIPTION | SEGMENTAL PAVERS                       |
|  | MATERIAL    | CONCRETE                               |
|  | LOCATION    | MEWS                                   |
|  | DESCRIPTION | HONED WITH EXPOSED AGGREGATE PERMEABLE |

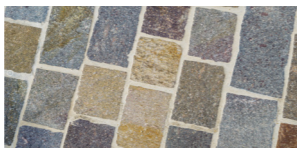
|  |             |   |
|--|-------------|---|
|  | DESCRIPTION | PORPHYRY SET                                  |
|  | MATERIAL    | GRANITE                                       |
|  | LOCATION    | MEWS  |
|  | DESCRIPTION | REFER ARCHITECTURAL DOCUMENTATION FOR DETAILS |

S/F - FURNITURE, FIXTURES & LIGHTING

|   |             |   |
|---|-------------|---|
|  | DESCRIPTION | MODULAR DAYBED STYLE BENCHES                  |
|   | MATERIAL    | TIMBER & STAINLESS STEEL                      |
|   | LOCATION    | MEWS  |
|   | DESCRIPTION | REFER ARCHITECTURAL DOCUMENTATION FOR DETAILS |

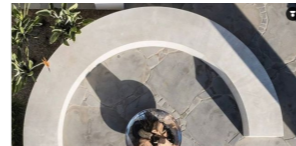
|   |             |   |
|---|-------------|---|
|  | DESCRIPTION | BANQUETTE SEATING                             |
|   | MATERIAL    | CONCRETE                                      |
|   | LOCATION    | THE GROVE & SKY GARDEN                        |
|   | DESCRIPTION | REFER ARCHITECTURAL DOCUMENTATION FOR DETAILS |

|   |             |                               |
|---|-------------|-------------------------------|
|  | DESCRIPTION | BENCH SEAT                    |
|   | MATERIAL    | TIMBER & STAINLESS STEEL      |
|   | LOCATION    | MEWS / NEIGHBOURHOOD GARDENS  |
|   | DESCRIPTION | BRONZE STAINLESS STEEL FINISH |

|   |             |                               |
|---|-------------|-------------------------------|
|  | DESCRIPTION | SINGLE SEAT                   |
|   | MATERIAL    | TIMBER & STAINLESS STEEL      |
|   | LOCATION    | MEWS                          |
|   | DESCRIPTION | BRONZE STAINLESS STEEL FINISH |

|  |             |                               |
|--|-------------|-------------------------------|
|  | DESCRIPTION | BENCH SEAT - PLANTING         |
|  | MATERIAL    | TIMBER & STAINLESS STEEL      |
|  | LOCATION    | MEWS / SHRIMPTONS CREEK       |
|  | DESCRIPTION | BRONZE STAINLESS STEEL FINISH |

|   |             |   |
|---|-------------|---|
|  | DESCRIPTION | PALISADE FENCE                                |
|   | MATERIAL    | CONCRETE                                      |
|   | LOCATION    | PRIVATE/ COMMUNAL OPEN SPACES                 |
|   | DESCRIPTION | REFER ARCHITECTURAL DOCUMENTATION FOR DETAILS |

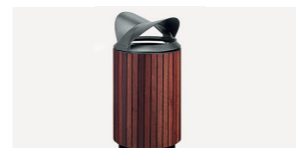
|   |             |   |
|---|-------------|---|
|  | DESCRIPTION | BIN (GENERAL & RECYCLE)                       |
|   | MATERIAL    | STEEL FRAME TIMBER BODY                       |
|   | LOCATION    | PUBLIC DOMAIN                                 |
|   | DESCRIPTION | REFER ARCHITECTURAL DOCUMENTATION FOR DETAILS |

|   |             |                            |
|---|-------------|----------------------------|
|  | DESCRIPTION | TREE GRATE                 |
|   | MATERIAL    | CAST IRON                  |
|   | LOCATION    | MEWS/ NEIGHBOURHOOD GARDEN |
|   | DESCRIPTION | BRONZE FINISH              |

|   |             |   |
|---|-------------|---|
|  | DESCRIPTION | WATER FEATURE/ BIRD BATH                      |
|   | MATERIAL    | COPPER SPUN                                   |
|   | LOCATION    | THE GROVE                                     |
|   | DESCRIPTION | REFER ARCHITECTURAL DOCUMENTATION FOR DETAILS |

S/F - FURNITURE, FIXTURES & LIGHTING

|   |             |   |
|---|-------------|---|
|  | DESCRIPTION | NATIVE BIRD NESTING BOX                       |
|   | MATERIAL    | NATURAL TIMBER                                |
|   | LOCATION    | MEWS/ NEIGHBOURHOOD GARDEN                    |
|   | DESCRIPTION | REFER ARCHITECTURAL DOCUMENTATION FOR DETAILS |

|   |             |   |
|---|-------------|---|
|  | DESCRIPTION | PERGOLA                                       |
|   | MATERIAL    | NATURAL TIMBER/ STEEL                         |
|   | LOCATION    | TERRACE PRIVATE OPEN SPACE                    |
|   | DESCRIPTION | REFER ARCHITECTURAL DOCUMENTATION FOR DETAILS |

|   |             |   |
|---|-------------|---|
|  | DESCRIPTION | BICYCLE PARKING                               |
|   | MATERIAL    | NATURAL TIMBER/ STEEL                         |
|   | LOCATION    | MEWS  |
|   | DESCRIPTION | REFER ARCHITECTURAL DOCUMENTATION FOR DETAILS |

LJ - LIGHTING

|   |             |   |
|---|-------------|---|
|  | DESCRIPTION | IN-DIRECT POLE-TOP LUMINAIRE                  |
|   | MATERIAL    | TIMBER POST                                   |
|   | LOCATION    | MEWS AND SHRIMPTONS CREEK                     |
|   | DESCRIPTION | REFER ARCHITECTURAL DOCUMENTATION FOR DETAILS |

|   |             |   |
|---|-------------|---|
|  | DESCRIPTION | GARDEN LIGHTING                               |
|   | MATERIAL    | -   |
|   | LOCATION    | ALL LANDSCAPE SPACES                          |
|   | DESCRIPTION | REFER ARCHITECTURAL DOCUMENTATION FOR DETAILS |

**APPENDIX C:**

**PLANT PALETTE**

PL1 NEIGHBOURHOOD GARDEN (COMMUNAL OPEN SPACE)

|                                  | Botanic Name                               | Common Name                 | Size (H x W) M  | Native |
|----------------------------------|--|-----------------------------|-----------------|--------|
| Ac im                            | <i>Acacia implexa</i>                      | Hickory Wattle              | 8 x 7m          | ●      |
| Ce gu                            | <i>Ceratopetalum gummiferum</i>            | NSW Christmas Bush          | 10 x 4          | ●      |
| Eu ha                            | <i>Eucalyptus haemastoma</i>               | Scribbly Gum                | 7 x 3m          | ●      |
| Co fi                            | <i>Corymbia ficifolia</i> 'Little Sweetie' | Dwarf Flowering Gum         | 6 x 4           | ●      |
| Ti It                            | <i>Tibouchina</i> 'Lilac Time'             | Tibouchina                  | 2-4 x 1-2m      | ●      |
| <b>SHRUBS &amp; GROUNDCOVERS</b> |  |                             |                 |        |
| Al by                            | Aloe 'Bush Baby Yellow'                    | Aloe Hybrid                 | 0.3 x 0.3       |        |
| An bb                            | <i>Anigozanthos</i> hybrid                 | Kangaroo Paw 'Bush Bonanza' | 0.6 x 0.6       | ●      |
| Co sa                            | <i>Convolvulus sabatius</i>                | Ground Morning Glory        |                 |        |
| Di cb                            | <i>Dianella caerulea</i> 'Cassa Blue'      | Native Flax Lily            | 1 x 1           | ●      |
| Ec ca                            | <i>Echium candicans</i>                    | Pride of Madeira            | 2 x 2           |        |
| Er ka                            | <i>Erigeron karvinskianus</i>              | Seaside Daisy               | 0.3 x 1         |        |
| Er gl                            | <i>Eremophila glabra</i> 'Silver Ball'     | Emu Bush                    | 0.7 x 0.7       | ●      |
| Er ni                            | <i>Eremophila nivea</i>                    | Emu Bush                    | 0.8-2 x 0.5 - 2 | ●      |
| La de                            | <i>Lavandula dentata</i>                   | French Lavender             | 1 x 1.2         |        |
| Lo ta                            | <i>Lomandra tanika</i>                     | Mat Rush                    | 0.5 x 0.6       | ●      |
| Oe li                            | <i>Oenothera lindheimeri</i>               | Butterfly Bush              |                 |        |
| Ph te                            | <i>Phormium tenax</i>                      | New Zealand Flax            | 3 x 1.5         |        |
| Sa is                            | <i>Salvia</i> 'Indigo Spires'              | Sage                        | 1.3 (h)         |        |
| Sa co                            | <i>Sarcococca confusa</i>                  | Sweet Box                   | 1.5 x 1         |        |
| Sc ae                            | <i>Scaevola aemula</i> 'Aussie Crawl'      | Fan Flower                  | 0.4 x 0.4 - 1   | ●      |
| Tu vi                            | <i>Tulbaghia violacea</i>                  | Society Garlic              | 0.5 x 0.5       |        |

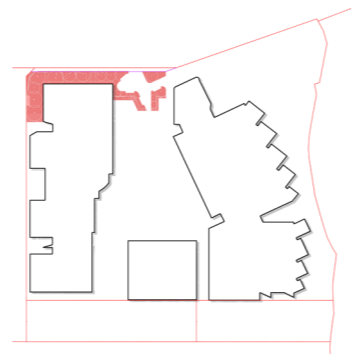

PL2 SHRIMPTONS CREEK (PUBLIC OPEN SPACE)

|       | Botanic Name                             | Common Name              | Size (H x W) M | Native |
|-------|--|--------------------------|----------------|--------|
| Ac ec | <i>Acacia echinula</i>                   | Hedgehog wattle          | 2 x 2          | ●      |
| Ac li | <i>Acacia linifolia</i>                  | Flax Wattle              | 2-5 x 2-4      | ●      |
| Ac lo | <i>Acacia longifolia</i>                 | Sydney Golden Wattle     | 6 x 4          | ●      |
| Ac su | <i>Acacia suaveolens</i>                 | Wild Sweet Wattle        | 2 x 2          | ●      |
| Ac ul | <i>Acacia ulicifolia</i>                 | Juniper Wattle           | 1-2 x 1-2      | ●      |
| Bu sp | <i>Bursaria spinosa</i>                  | Sweet Bursaria           | 1.5-4 x 1.5-3  | ●      |
| Di cb | <i>Dianella caerulea</i> 'Cassa Blue'    | Native Flax Lily         | 1 x 1          | ●      |
| Di lo | <i>Dianella longifolia</i>               | Native Flax Lily         | 1 x 1          | ●      |
| Eu ha | <i>Eucalyptus haemastoma</i>             | Scribbly Gum             | 7 x 3m         | ●      |
| Ei ha | <i>Einadia hastata</i>                   | Berry Saltbush           | 0.5 x 1        |        |
| Gl cl | <i>Glycine clandestina</i>               | Love Creeper             | 0.3-2          | ●      |
| Ha sa | <i>Hakea salicifolia</i>                 | Willow-leaved Hakea      | 4-5 x 3-4      | ●      |
| Ha se | <i>Hakea sericea</i>                     | Silky Hakea              | 4.5 x 3.5      | ●      |
| Ha vi | <i>Hardenbergia violacea</i>             | Meema                    | 0.5 x 2        | ●      |
| Ku am | <i>Kunzea ambigua</i>                    | Tick Bush                | 4 x 1          | ●      |
| La fo | <i>Lambertia formosa</i>                 | Mountain Devil           | 1.5-2 x 1.5-2  | ●      |
| Le po | <i>Leptospermum polygalifolium</i>       | Copper Tea Tree          | 2-3 x 2-3      | ●      |
| Le ju | <i>Leucopogon juniperinus</i>            | Prickly Beard-heath      | 1 x 1          | ●      |
| Lo lo | <i>Lomandra longifolia</i>               | Spiny Headed Mat Rush    | 0.6 x 0.4      | ●      |
| Me li | <i>Melaleuca lineariifolia</i>           | Snow in Summer           | 10 x 4         | ●      |
| Me no | <i>Melaleuca nodosa</i>                  | Prickly-leaved Paperbark | 3 x 2          | ●      |
| Mi st | <i>Microlaena stipoides</i> var. Griffin | Griffin Weeping Grass    | 0.15           | ●      |
| Oz di | <i>Ozothamnus diosmifolius</i>           | Rice Flower              | 1.5-2 x 1-1.2  | ●      |
| Pl fo | <i>Platylobium formosum</i>              | Handsome flat-pea        | 1-2 x 1-2      | ●      |
| Pl la | <i>Platysace lanceolata</i>              | Edna Walling Flower Girl | 0.3 x 0.4      | ●      |
| Wo pu | <i>Woolsia pungens</i>                   | Snow Wreath              | 0.6-1 x 0.3-5  | ●      |
| Zi sm | <i>Zieria smithii</i>                    | Sandfly Bush             | 2 x 2          | ●      |

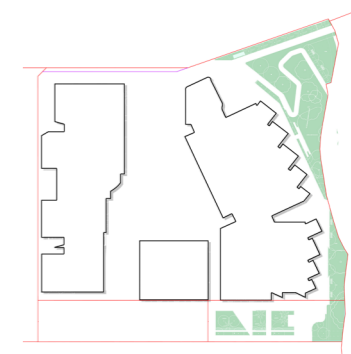

This species list has been generated with reference to 'Shrimptons Creek small bird habitat progress report, Bev Debrincal, International Environmental Weed Foundation trading as Habitat Network. The Shrimptons Creek small bird habitat project was conceived in November 2011 along with the plan to establish The Habitat community native plant nursery and community food garden at Santa Rosa Park at the head of Shrimptons Creek.

PL3- SHRIMPTONS CREEK PRIVATE OPEN SPACE

|                                  | Botanic Name                        | Common Name          | Size (H x W) M | Native |
|----------------------------------|-------------------------------------|----------------------|----------------|--------|
| <b>TREES</b>                     |                                     |                      |                |        |
| Ca vi                            | Callistemon viminalis               | Weeping Bottlebrush  | 5 - 8 x 3-4    | ●      |
| Co fi                            | Corymbia ficifolia 'Little Sweetie' | Dwarf Flowering Gum  | 6 x 4          | ●      |
| Ac lo                            | Acacia longifolia                   | Sydney Golden Wattle | 6 x 4          | ●      |
| Ti It                            | Tibouchina 'Lilac Time'             | Tibouchina           | 2-4 x 1-2m     | ●      |
| <b>SHRUBS &amp; GROUNDCOVERS</b> |                                     |                      |                |        |
| Ac co                            | Acacia cognata 'Limelight'          | River Wattle         | 0.5 x 1        | ●      |
| An av                            | Anigozanthos 'Amber Velvet'         | Kangaroo Paw         | 0.5 x 0.4      | ●      |
| Br mu                            | Brachycome multifida                | Native Daisy         | 0.4 x 0.4      | ●      |
| Gl cl                            | Glycine clandestina                 | Love Creeper         | 0.3-2          | ●      |
| Gr ga                            | Grevillea gaudichaudii              | Grevillea            | 0.2 x 1-3      | ●      |
| Le vd                            | Leptospermum 'Vertical Drop'        | Tea Tree             | 0.4 x 1        | ●      |
| Ha vi                            | Hardenbergia violacea               | Meema                | 0.5 x 2        | ●      |
| My pa                            | Myoporum parvifolium                | Creeping Boobiella   | 0.1 x 0.1      | ●      |
| Sc fa                            | Scaevola 'Fandango White Wonder'    | Fan Flower           | 0.2 x 0.5 - 2  | ●      |
| Wa sm                            | Wahlenbergia 'Sky Mist'             | Native Bluebell      | 0.4 x 0.5      | ●      |

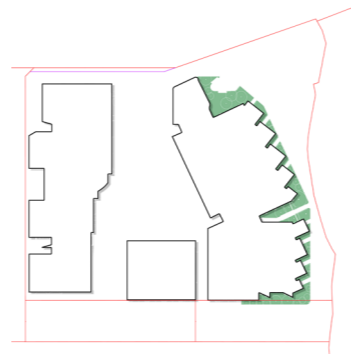

PL4 THE MEWS (PUBLIC OPEN SPACE)

|                     | Botanic Name                        | Common Name         | Size (H x W) M        | Native |
|---------------------|-------------------------------------|---------------------|-----------------------|--------|
| Ac im               | Acacia implexa                      | Hickory Wattle      | 8 x 7m                | ●      |
| Eu ha               | Eucalyptus haemastoma               | Scribbly Gum        | 7 x 3m                | ●      |
| Co fi               | Corymbia ficifolia 'Little Sweetie' | Dwarf Flowering Gum | 6 x 4                 | ●      |
| Ho fo               | Howea forsteriana                   | Kentia Palm         | 18                    |        |
| Li au               | Livistona australis                 | Cabbage Tree Palm   | 20                    |        |
| Eu sa               | Eucalyptus saligna                  | Sydney Blue Gum     | 30 x 10               | ●      |
| <b>GROUNDCOVERS</b> |                                     |                     |                       |        |
| Al nu               | Alpinia nutans                      | Dwarf Cardamon      | 1 x 1                 |        |
| As el               | Aspidistra elatior                  | Cast-iron Plant     | 1 x 1                 |        |
| As au               | Asplenium australasicum             | Birds Nest Fern     | 0.5 - 1.5 x 0.5 x 1.5 |        |
| Ci an               | Cissus antarctica                   | Kangaroo Vine       |                       |        |
| Ha vi               | Hardenbergia violacea               | False Sarsparilla   |                       | ●      |
| He gl               | Helmholtzia glaberrima              | Stream Lily         | 1-2 x 1-2             | ●      |
| Lo ta               | Lomandra 'Tankia'                   | Mat Tussock Grass   | 1 x 1                 | ●      |
| My pa               | Myoporum parvifolium                | Creeping Boobiella  | 0.1 x 0.1             | ●      |
| Ph ir               | Philodendron 'Imperial Red'         | Philodendron        | 1.2 x 1.2             |        |
| Pi pl               | Plectranthus 'Plepalila'            | Mona Lavendar       | 0.8 x 0.6             |        |
| Sc ae               | Scaevola aemula 'Aussie Crawl'      | Fan Flower          | 0.4 x 0.4 - 1         | ●      |

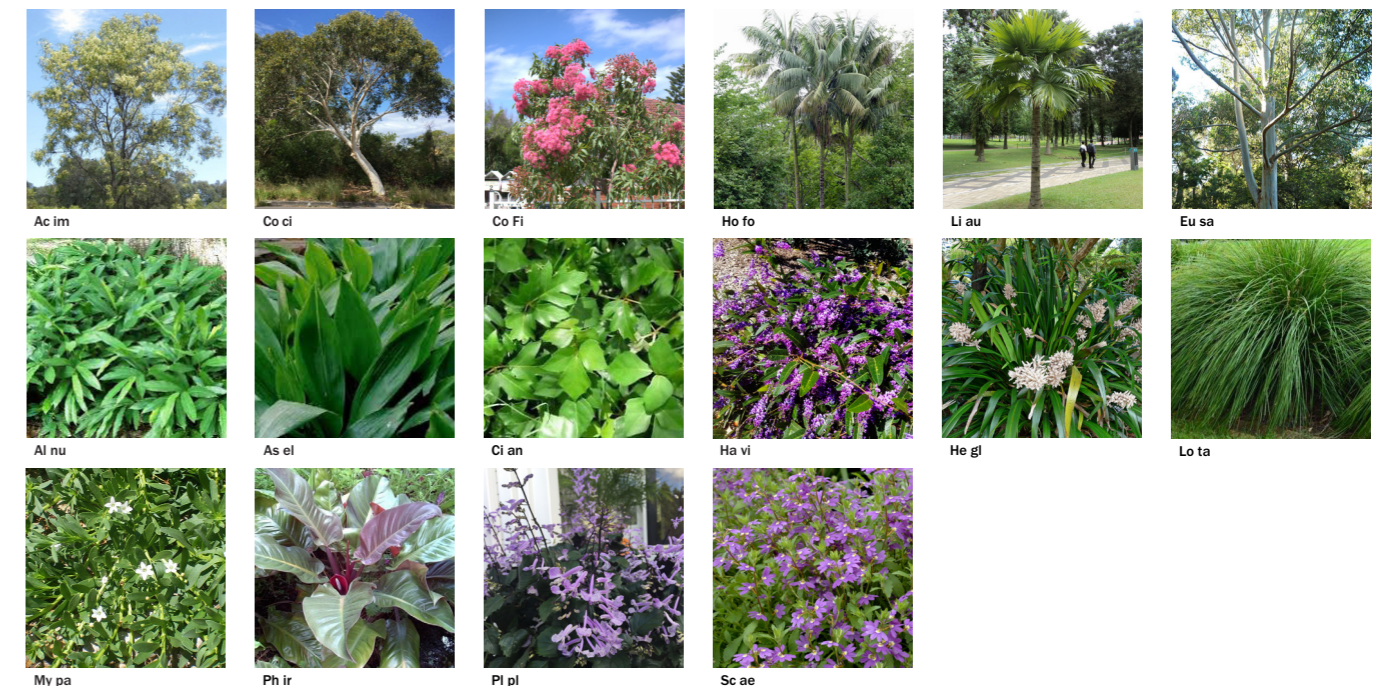
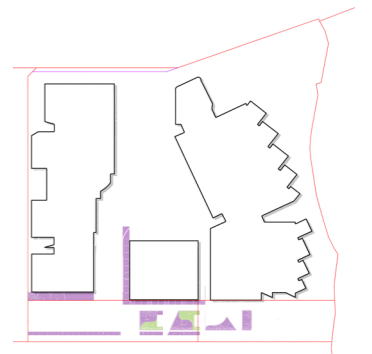

Appendix C: Planting schedules

PL5 NEIGHBOURHOOD STREET (PUBLIC OPEN SPACE)

|                                  | Botanic Name                          | Common Name           | Size (H x W) M | Native |
|----------------------------------|---------------------------------------|-----------------------|----------------|--------|
| <b>TREES</b>                     |                                       |                       |                |        |
| El re                            | Elaeocarpus reticulatus 'Prima Donna' | Blueberry Ash         | 8 x 3-5        | ●      |
| Wa fl                            | Waterhousia floribunda 'Amaroo'       | Weeping Lily Pilly    | 8 x 5          | ●      |
| <b>SHRUBS &amp; GROUNDCOVERS</b> |                                       |                       |                |        |
| Li mu                            | Liriope muscari 'Amethyst'            | Lilyturf              | 0.4 x 0.4      |        |
| Lo lo                            | Lomandra longifolia 'Verday'          | Spiny Headed Mat Rush | 0.6 x 0.4      | ●      |
| Pr pe                            | Pratia pedunculata                    | Pratia                | 0.2 x 0.5 -1   | ●      |
| Tr as                            | Trachelospermum asiaticum 'Flat Mat'  | Chinese Star Jasmine  | 0.4 x 0.4      |        |
| Tu vi                            | Tulbaghia violacea                    | Society Garlic        | 0.5 x 0.5      |        |

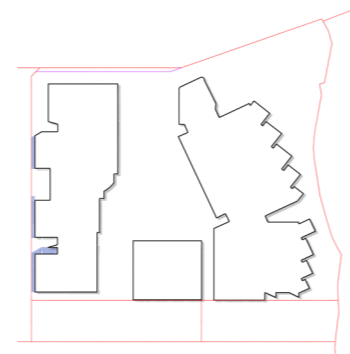

PL6 THE GROVE (COMMUNAL OPEN SPACE)

|                                  | Botanic Name                       | Common Name           | Size (H x W) M  | Native |
|----------------------------------|------------------------------------|-----------------------|-----------------|--------|
| An co                            | Angophora costata                  | Smooth-barked Apple   | 20 x 12         | ●      |
| Ca sa                            | Camellia sasanqua 'Pure Silk'      | Camellia              | 6 x 4           |        |
| Fr ax                            | Franklinia axillaris               | Fried Egg Plant       | 5 x 3           |        |
| Ho fo                            | Howea forsteriana                  | Kentia Palm           | 18              | ●      |
| Li au                            | Livistona australis                | Cabbage Tree Palm     | 20              | ●      |
| Ma td                            | Mangnolia 'Teddy Bear'             | Magnolia              | 3 x 6           |        |
| <b>SHRUBS &amp; GROUNDCOVERS</b> |                                    |                       |                 |        |
| Aj re                            | Ajuga reptans Blue                 | Blue Bugle            | 0.2 x 0.4       |        |
| Ar ci                            | Arthropodium cirratum              | New Zealand Rock Lily | 0.6 x 1         |        |
| As el                            | Aspidistra elatior                 | Cast-iron Plant       | 1 x 1           |        |
| Cl mi                            | Clivia miniata                     | Clivia                | 0.5 x 0.6       |        |
| Co Bl                            | Corydalis hybrid 'Blue Line'       | Corydalis Blue Line   | 0.4 x 0.6       |        |
| Ci an                            | Cissus antarctica                  | Kangaroo Vine         |                 | ●      |
| Da di                            | Dampiera diversifolia              | Kangaroo Lobelia      | 0.3 x 1         | ●      |
| Ga ra                            | Gardenia radicans                  | Rock Gardenia         | 0.6 x 0.6 - 0.9 |        |
| He gl                            | Helmholtzia glaberrima             | Stream Lily           | 1.2 x 1.2       | ●      |
| Ja pa                            | Jacobinia pauciflora 'Firefly'     | Jacobina              | 1 x 1           |        |
| Lo ta                            | Lomandra 'Tankia'                  | Mat Tussock Grass     | 1 x 1           | ●      |
| Ph ir                            | Philodendron 'Imperial Red'        | Philodendron          | 1.2 x 1.2       |        |
| Po la                            | Poa labillardierei                 | Tussock Grass         | 1 x 1           | ●      |
| Ha vi                            | Hardenbergia violacea              | Purple Coral Pea      | 3 x 2           | ●      |
| Pl pl                            | Plectranthus 'Piepallia'           | Mona Lavendar         | 0.8 x 0.6       |        |
| Sc ae                            | Scaevola aemula 'Aussie Crawl'     | Fan Flower            | 0.4 x 0.4 - 1   | ●      |
| Sp pl                            | Spathoglottis plicata 'Snow Angel' | Garden Orchid         | 0.6 (h)         | ●      |
| Tr ja                            | Trachospermum jasminoides          | Star Jasmine          | 0.5 (h)         | ●      |

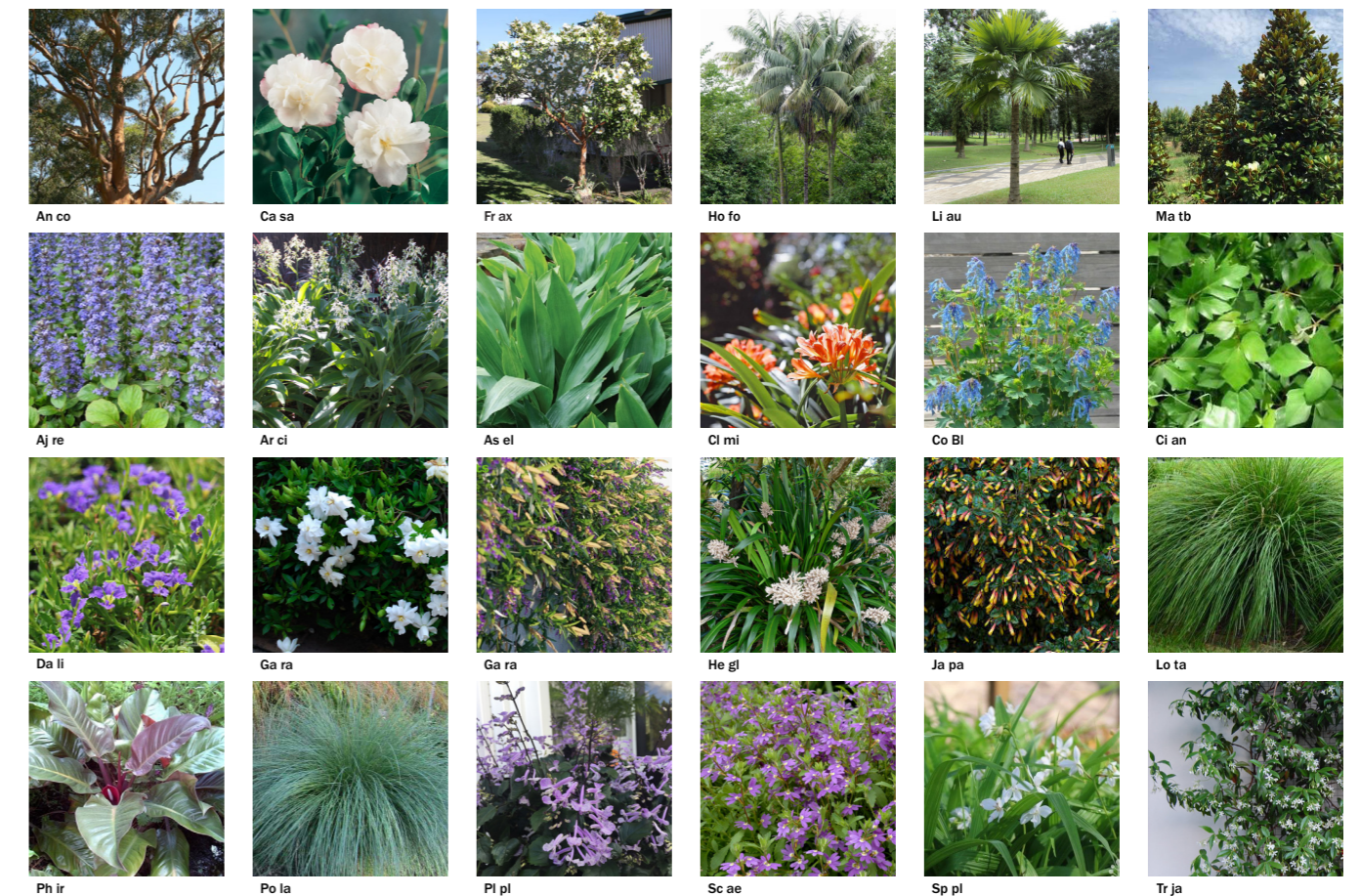
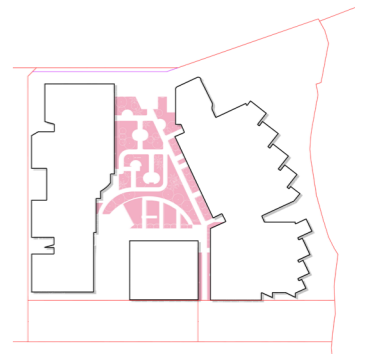

Appendix C: Planting schedules

PL7 - SKY GARDEN (COMMUNAL OPEN SPACE ON ROOFTOP)

|                                  | Botanic Name                     | Common Name          | Size (H x W) M | Native |
|----------------------------------|----------------------------------|----------------------|----------------|--------|
| <b>TREES</b>                     |                                  |                      |                |        |
| Ca vi                            | Callistemon viminalis            | Weeping Bottlebrush  | 5 - 8 x 3-4    | ●      |
| Ba in                            | Banksia integrifolia             | Coast Banksia        | 4 x 4          | ●      |
| Ol eu                            | Olea europaea                    | Olive                | 4 x 4          |        |
| <b>SHRUBS &amp; GROUNDCOVERS</b> |                                  |                      |                |        |
| Ac co                            | Acacia cognata 'Limelight'       | River Wattle         | 0.5 x 1        | ●      |
| An av                            | Anigozanthos 'Amber Velvet'      | Kangaroo Paw         | 0.5 x 0.4      | ●      |
| Br mu                            | Brachyscome multifida            | Native Daisy         | 0.4 x 0.4      | ●      |
| Ca ds                            | Carissa 'Desert Star'            | Natal Plumb          |                |        |
| co cn                            | Convolvulus cneorum              | Silverbush           | 0.6 x 0.6      |        |
| Fe gl                            | Festuca glauca                   | Blue Fescue          | 0.5 x 0.5      |        |
| Le vd                            | Leptospermum 'Vertical Drop'     | Tea Tree             | 0.4 x 1        |        |
| My pa                            | Myoporum parvifolium             | Creeping Boobialla   | 0.1 x 0.1      | ●      |
| Sc fa                            | Scaevola 'Fandango White Wonder' | Fan Flower           | 0.2 x 0.5 - 2  | ●      |
| Tr gl                            | Tradescantia 'Green Leaf'        | Purple Wandering Jew | 0.2 x 2        |        |
| Wa sm                            | Wahlenbergia 'Sky Mist'          | Native Bluebell      | 0.4 x 0.5      | ●      |



Ca vi Ba in Ol eu



Ac co An av Br mu Ca ds



Co cn Fe gl Le vd

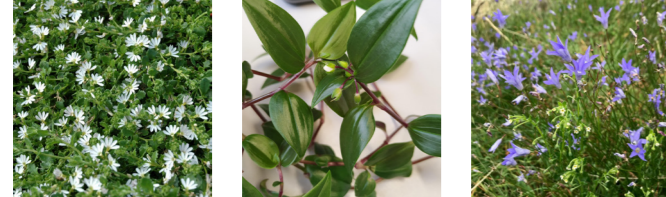

PL8 - ROOFTOP (COMMUNAL OPEN SPACE ON ROOFTOP)

|                                  | Botanic Name                          | Common Name                 | Size (H x W) M | Native |
|----------------------------------|---------------------------------------|-----------------------------|----------------|--------|
| <b>TREES</b>                     |                                       |                             |                |        |
| Ca vi                            | Callistemon viminalis                 | Weeping Bottlebrush         | 5 - 8 x 3-4    | ●      |
| Ba in                            | Banksia integrifolia                  | Coast Banksia               | 4 x 4          | ●      |
| Ol eu                            | Olea europaea                         | Olive                       | 4 x 4          |        |
| <b>SHRUBS &amp; GROUNDCOVERS</b> |                                       |                             |                |        |
| Au ra                            | Austrostipa ramosissima               | Native Princess Spear Grass | 1 x 1          | ●      |
| Lo kb                            | Lomandra hystrix 'Katie Bells'        | Spiny Head Mat Rush         | 1.5 x 1.5      | ●      |
| Lo kd                            | Lomandra longifolia 'Katrinus Deluxe' | Spiny Head Mat Rush         | 0.7 x 0.7      | ●      |
| Im ya                            | Imperata cylindrica 'Yalba'           | Cogon Grass                 | 0.7 x 1        | ●      |
| Op ja                            | Ophiopogon japonicus                  | Dwarf Turf Lily             | 0.3 x 0.3      |        |



Ca vi Ba in Ol eu



Au ra Lo kb Lo kd Im ya



Op ja