

LANDSCAPE CONCEPT DESIGN PLAN

GROUND FLOOR

- LEGEND:**
- 1 Main Arrival
 - 2 Amphitheatre Seating
 - 3 Central Courtyard
 - 4 Running Track
 - 5 Sports Courts
 - 6 First Nations Productive Garden
 - 7 Bicycle + Scooter Stands / Parking
 - 8 Table Tennis
 - 9 Ecological Planting Corridor
 - 10 Community Arrival
 - 11 COLA Break Out Area
 - 12 Northern Access
 - 13 Seating Bench
 - 14 Multi Purpose Sports Field
 - 15 Planting Buffer
 - 16 Services
 - 17 Indicative Street Tree Planting

1:500 @ A2
0 5 10 15 20 25

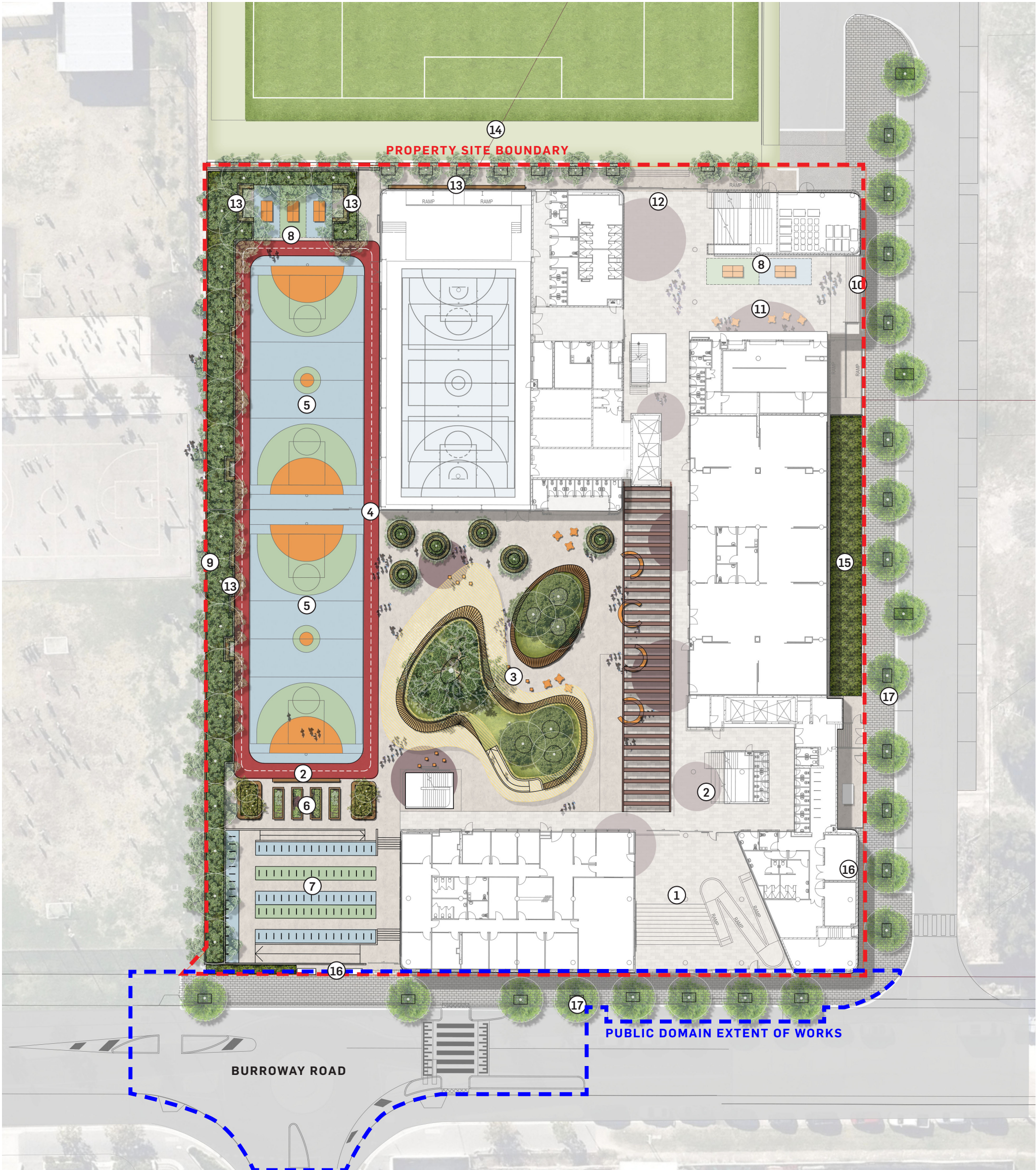

STREET TREES STRATEGY

EXERT FROM DRAFT CITY OF PARRAMATTA WENTWORTH POINT PUBLIC DOMAIN GUIDELINES (JULY 2019)

CENTRES STRATEGIES
FUTURE URBAN VILLAGES

Figure 4.64 Wentworth Point Urban Village - Street Tree Strategy

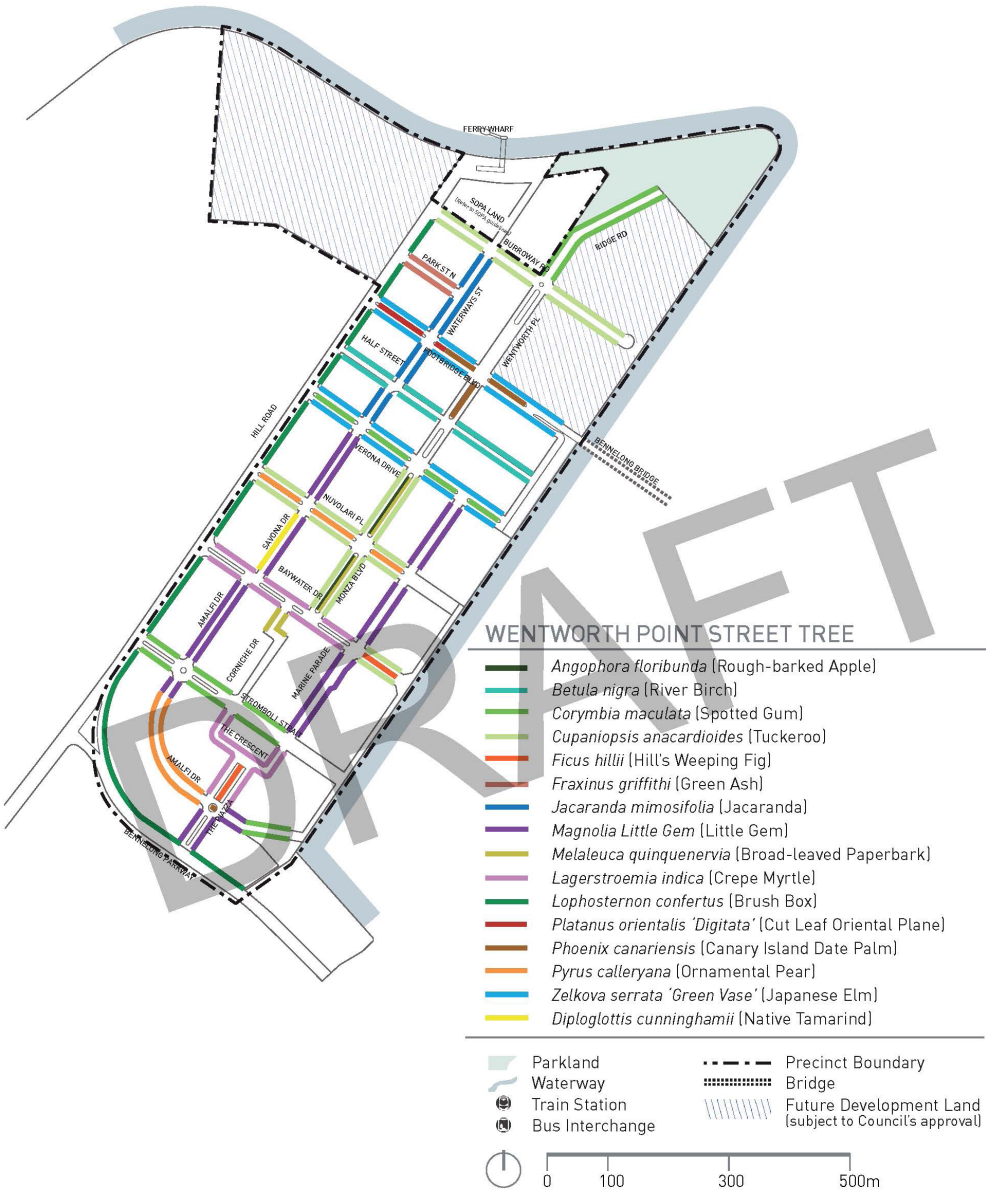

BURROWAY ROAD



CUPANIOPSIS ANACARDIOIDES

PROPOSED EASTERN ROAD



CUPANIOPSIS ANACARDIOIDES



CORYMBIA MACULATA

PUBLIC DOMAIN PAVEMENT STRATEGY

EXERT FROM DRAFT CITY OF PARRAMATTA WENTWORTH POINT PUBLIC DOMAIN GUIDELINES (JULY 2019)

CENTRES STRATEGIES
FUTURE URBAN VILLAGES

Figure 4.61 Wentworth Point Urban Village - Paving Strategy

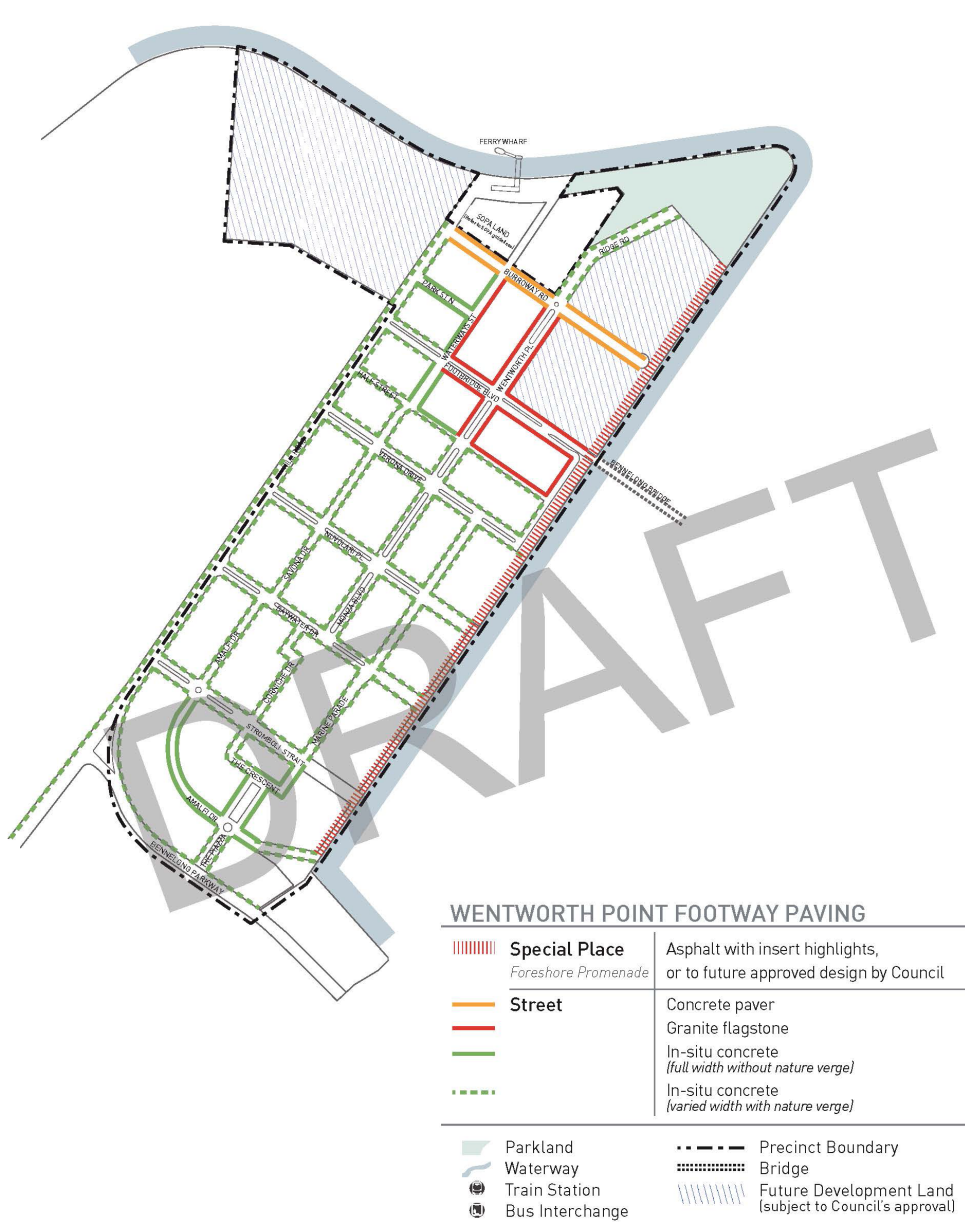

BURROWAY ROAD + PROPOSED EASTERN ROAD

Figure 4.63 Wentworth Point Urban Village - Paving Material Palette

| | Use | Material |
|-----------------|---|---|
| Street Footpath | Main body - use of concrete pavers for consistency of appearance, high quality finish and durability. | |
| Concrete Paver | Use of smaller unit size concrete paver on vehicle crossing, kerb ramp to match the footpath treatment. | |
| | | Main body Supplier: Pabbcrete Product: P16, T16, T20, T22, T24 Size: 600x300mm (main body) 600x300x60mm (edge) Finish: torred (main body), shotblast (edge) |
| | | Vehicle crossing Supplier: Pabbcrete Product: P16, T16, T20, T22, T24 Size: 150x750x60mm Finish: torred |
| | | Kerb ramp Supplier: Pabbcrete Product: P16, T16, T20, T22, T24 Size: 150x750x60mm Finish: shotblast |



LANDSCAPE OVERALL SITE PLAN

KEY PLAN



- LEGEND:**
- Existing Zebra Crossing
 - Existing Raised Shared Zone
 - Proposed Raised Zebra Crossing

