

PO BOX 3222,  
 REDFERN NSW 2016  
 Ph: 02 8065 1156  
 Fax: 02 8065 1297  
 Email: survey@daw-walton.com.au

REVISION: 7  
 DATED: 23-11-2020

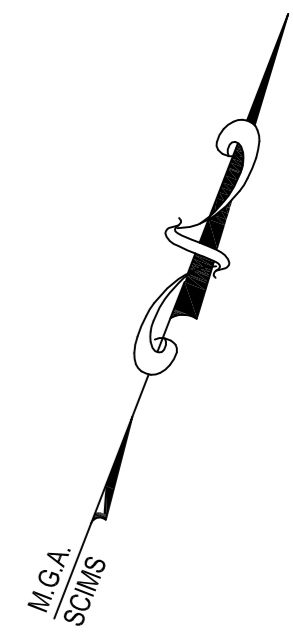

DRAFT STRATUM SUBDIVISION PLAN  
 PREPARED FROM ARCHITECTURAL PLANS BY TURNER ARCHITECTS,  
 PROJECT No: 18095, ISSUE: 03, DATED: 28-04-2020

**SURVEYOR**  
 NAME: JOHN WALTON  
 DATE OF SURVEY:  
 REFERENCE: 4900-19DP293

PLAN OF: SUBDIVISION OF  
 LOT 293 IN DP1213279

LGA: BLACKTOWN  
 LOCALITY: ROUSE HILL  
 Reduction Ratio: 1 : 500  
 Lengths are in metres

REGISTERED:

**DP**

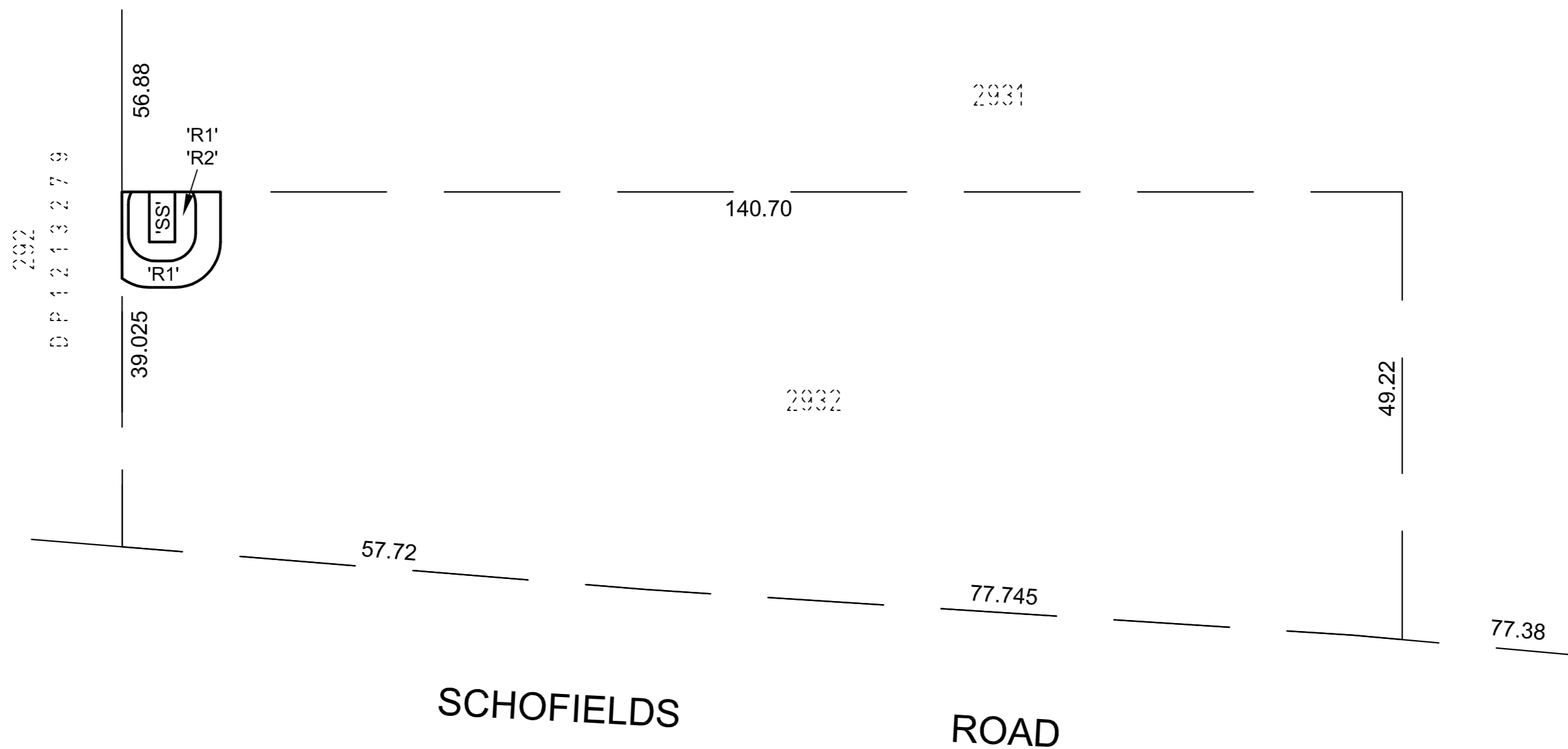

'SS' DENOTES EASEMENT FOR PADMOUNT SUBSTATION, 2.75 WIDE  
 'R1' DENOTES RESTRICTION ON THE USE OF LAND  
 'R2' DENOTES RESTRICTION ON THE USE OF LAND



PO BOX 3222,  
 REDFERN NSW 2016  
 Ph: 02 8065 1156  
 Fax: 02 8065 1297  
 Email: survey@daw-walton.com.au

REVISION: 1  
 DATED: 09-12-2020

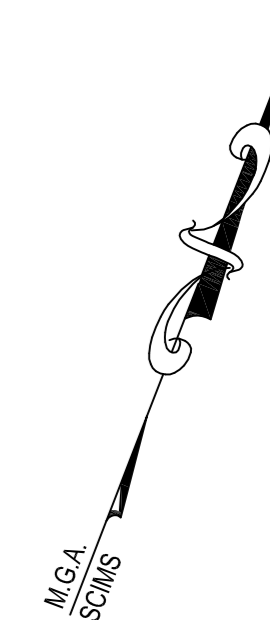

DRAFT STRATUM SUBDIVISION PLAN  
 PREPARED FROM ARCHITECTURAL PLANS BY TURNER ARCHITECTS,  
 PROJECT No: 18095, ISSUE: 04, DATED: 19-11-2020

**SURVEYOR**  
 NAME: JOHN WALTON  
 DATE OF SURVEY:  
 REFERENCE: 4900-19DP2932

PLAN OF: EASEMENTS OVER LOT 2932  
 IN DP

LGA: BLACKTOWN  
 LOCALITY: ROUSE HILL  
 Reduction Ratio: 1 : 500  
 Lengths are in metres

REGISTERED:

DP

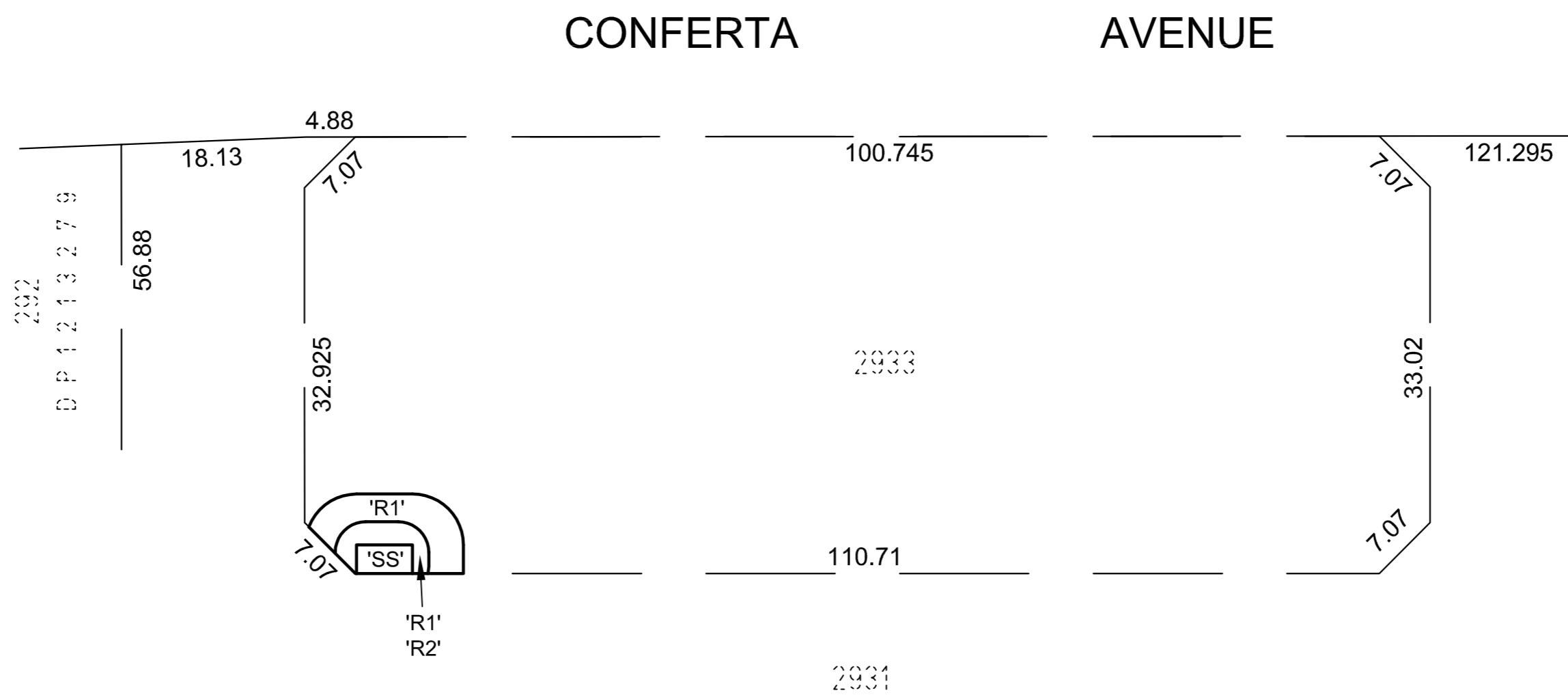

'SS' DENOTES EASEMENT FOR PADMOUNT SUBSTATION, 2.75 WIDE  
 'R1' DENOTES RESTRICTION ON THE USE OF LAND  
 'R2' DENOTES RESTRICTION ON THE USE OF LAND

<p><b>daw &amp; walton</b> PTY LTD          CONSULTING SURVEYORS          ABN 65 120 413 372</p>	PO BOX 3222, REDFERN NSW 2016 Ph: 02 8065 1156 Fax: 02 8065 1297 Email: survey@daw-walton.com.au
	REVISION: 1 DATED: 09-12-2020

DRAFT STRATUM SUBDIVISION PLAN PREPARED FROM ARCHITECTURAL PLANS BY TURNER ARCHITECTS, PROJECT No: 18095, ISSUE: 04, DATED: 19-11-2020	SURVEYOR NAME: JOHN WALTON DATE OF SURVEY: REFERENCE: 4900-19DP2933	PLAN OF: EASEMENTS OVER LOT 2933 IN DP	LGA: BLACKTOWN LOCALITY: ROUSE HILL Reduction Ratio: 1 : 500 Lengths are in metres	REGISTERED:	DP
--	--	---	---	-------------	----