

Trinity 'Triangle' pin fixed to brickwork.  
Colour: Trinity Green  
LED backlit

Trinity 'Crest' pin fixed to brickwork.  
Colour: Trinity Green and white

Trinity 'Banner' pin fixed to brickwork.  
Colour: Trinity Green and white  
LED backlit

Trinity Grammar School letters  
individually pin fixed to facade  
on both sides.  
LED backlit

01 Western Facade Signage  
Scale: 1:50



Precedent: Existing pin fixed signage facing Prospect Road

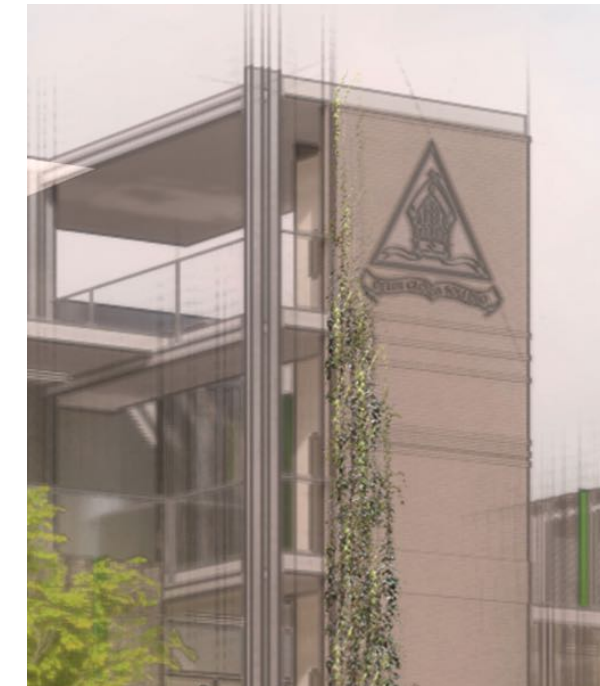

Proposed Signage Render



Proposed Signage Lighting Effect