

9am
Summer Dec 22

- Proposed Shadow
- Existing Shadow
- Improved area

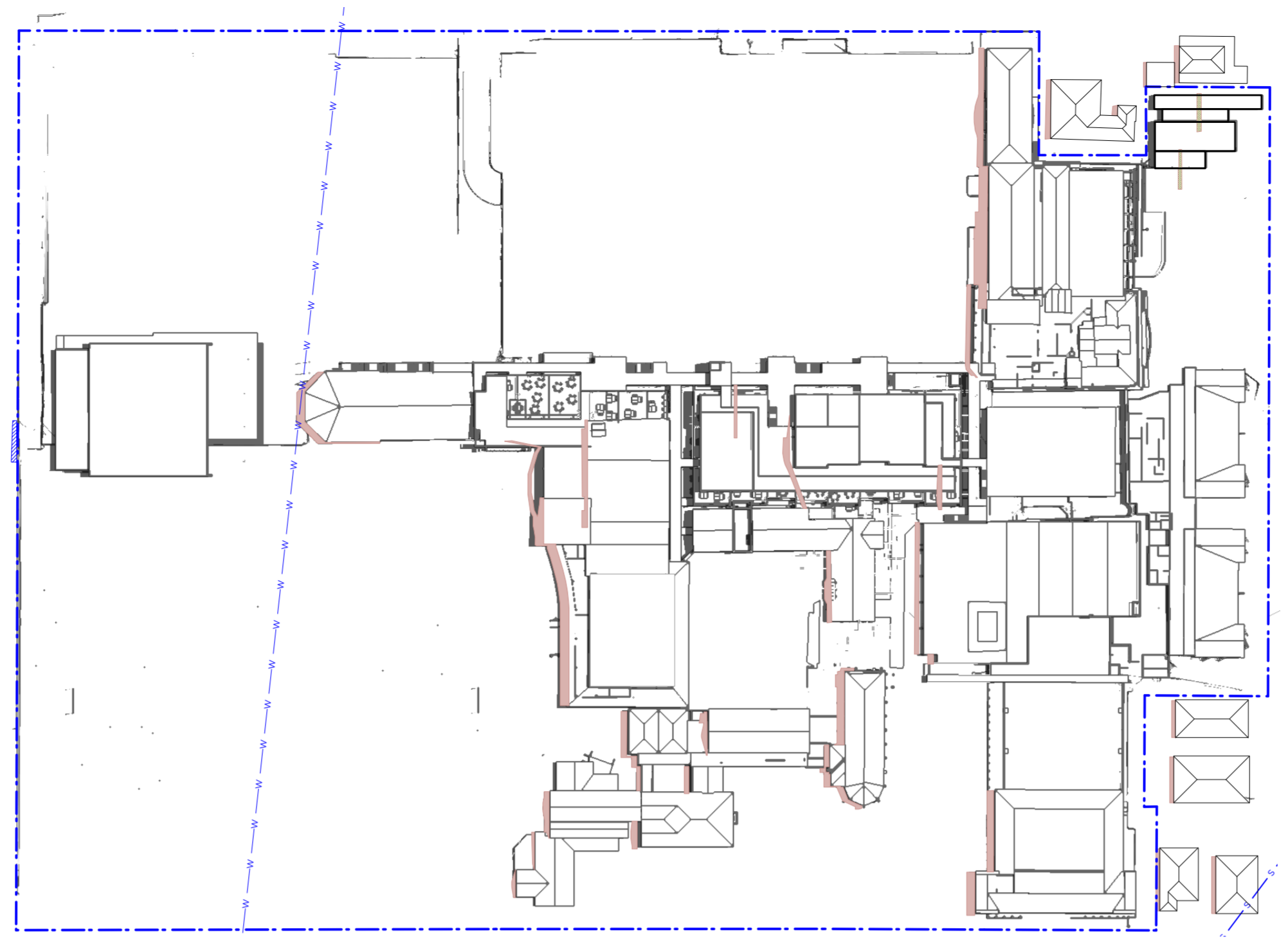

12pm
Summer Dec 22

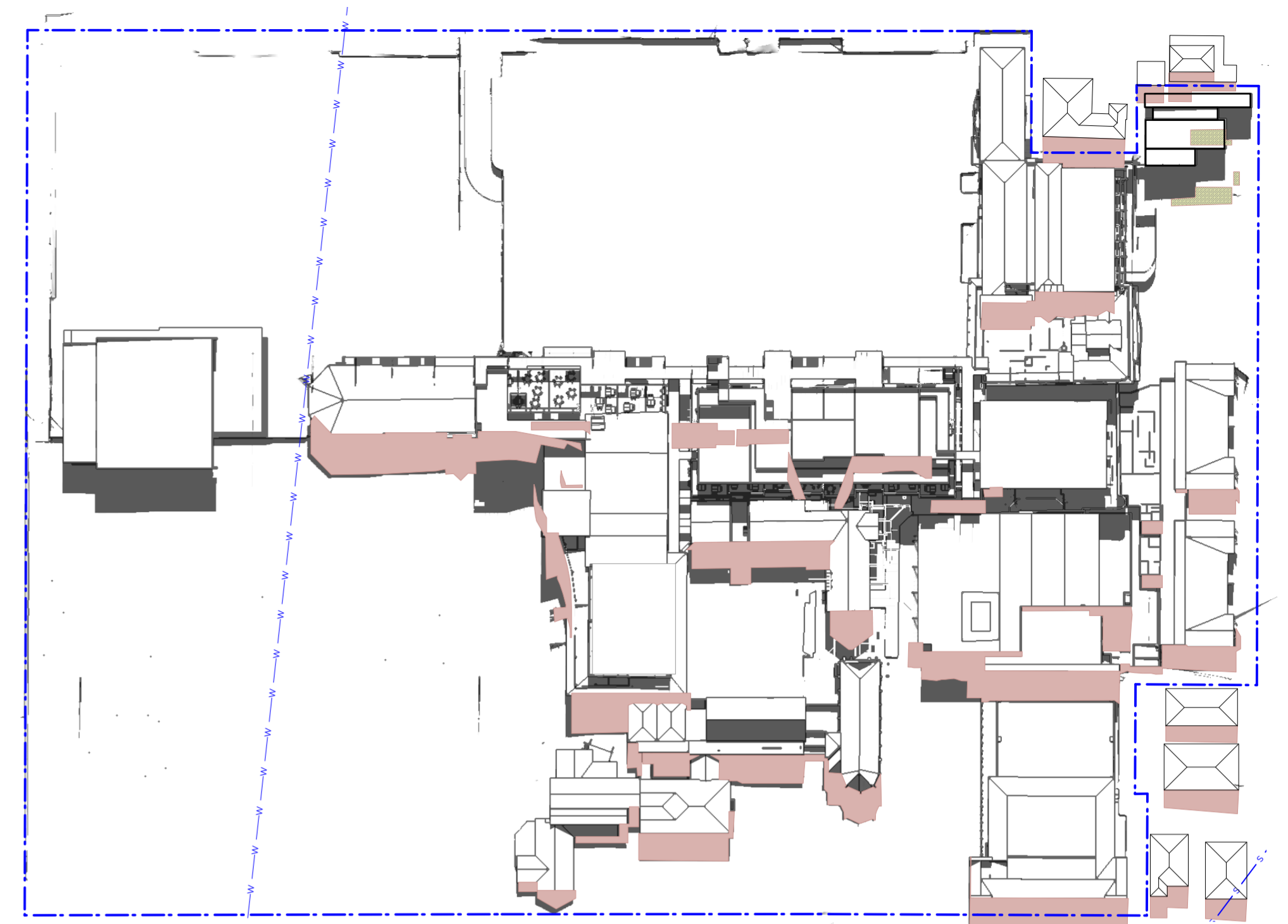

3pm
Summer Dec 22

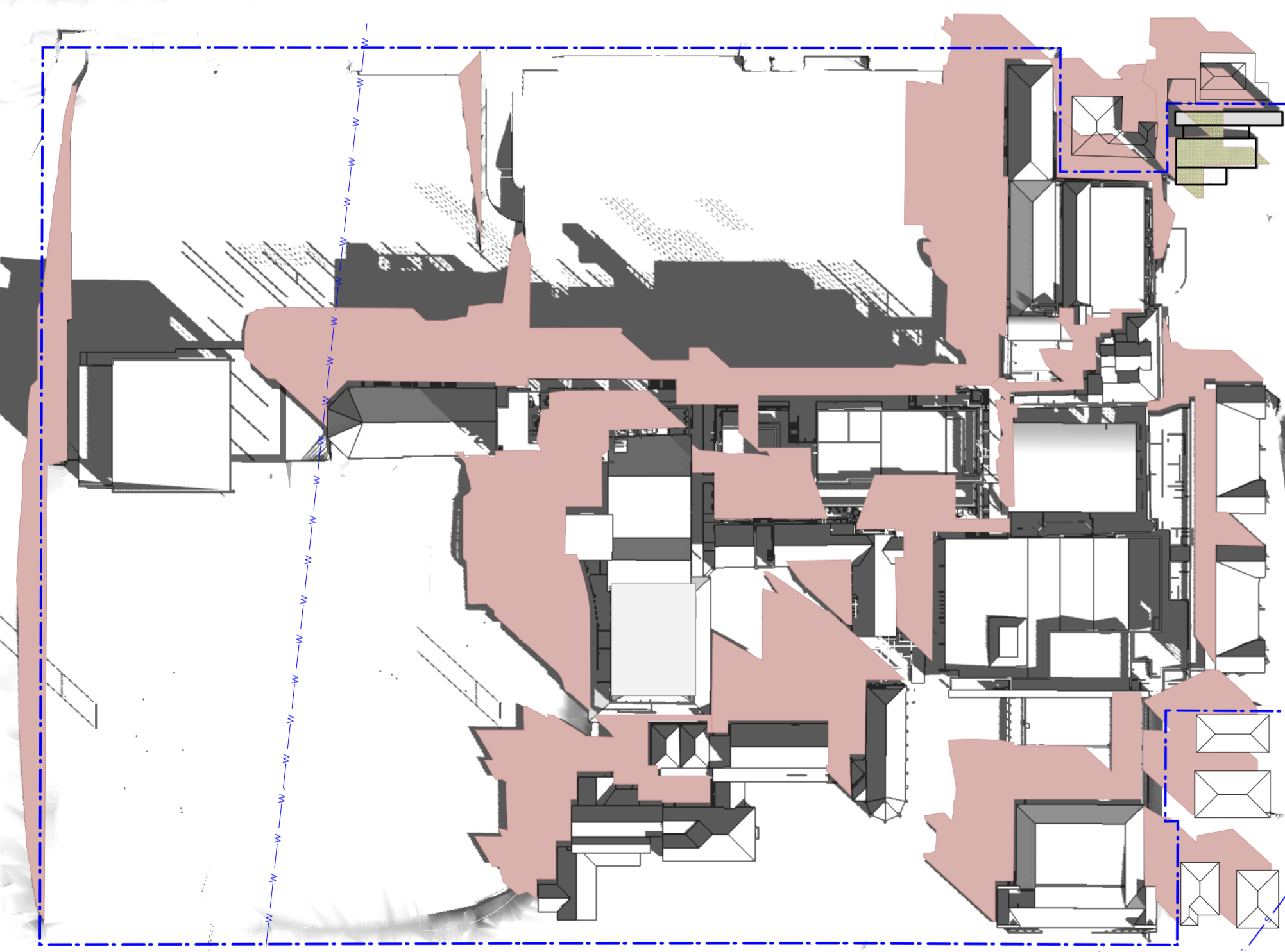

9am
Winter June 21

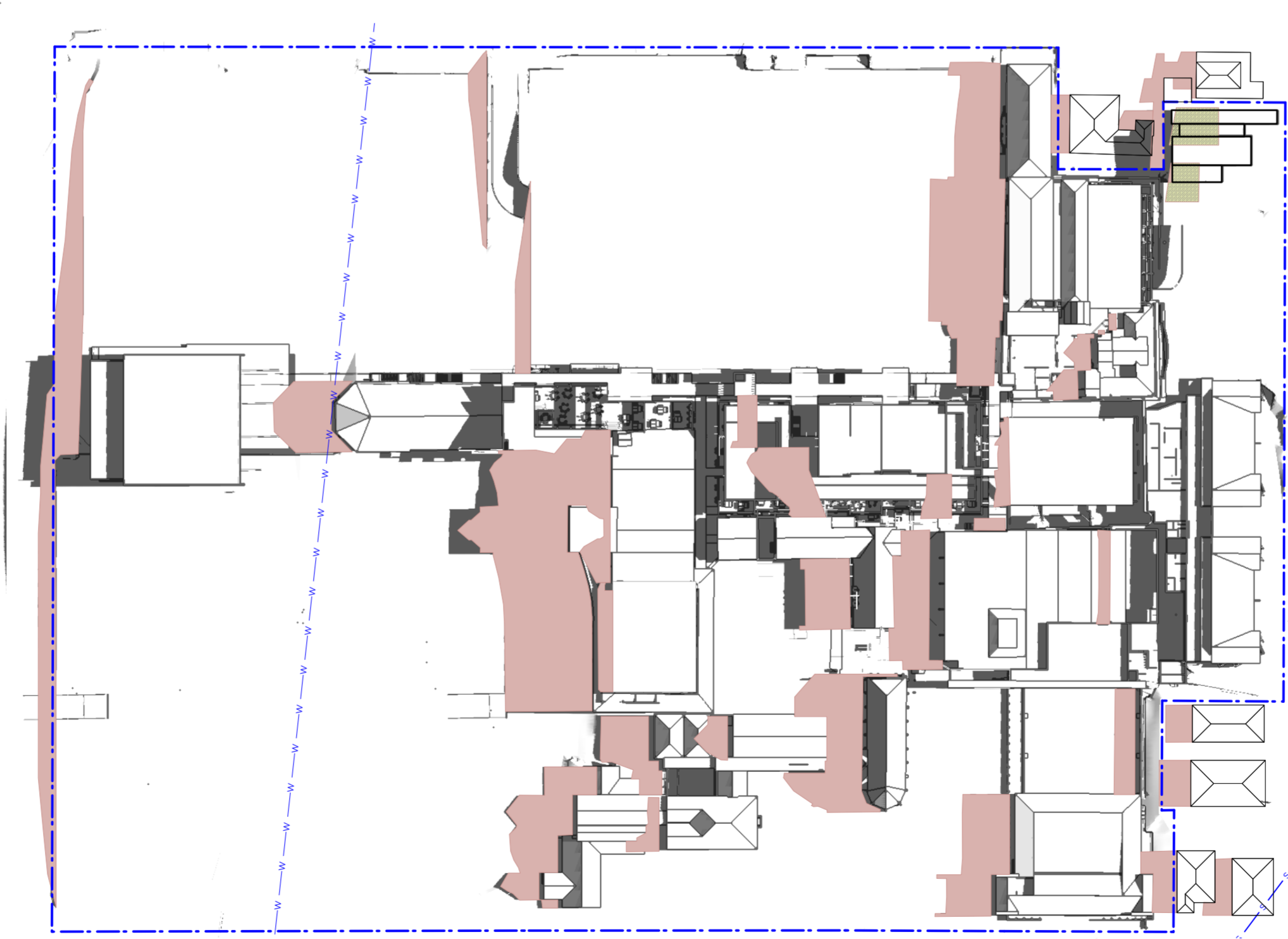

12pm
Winter June 21

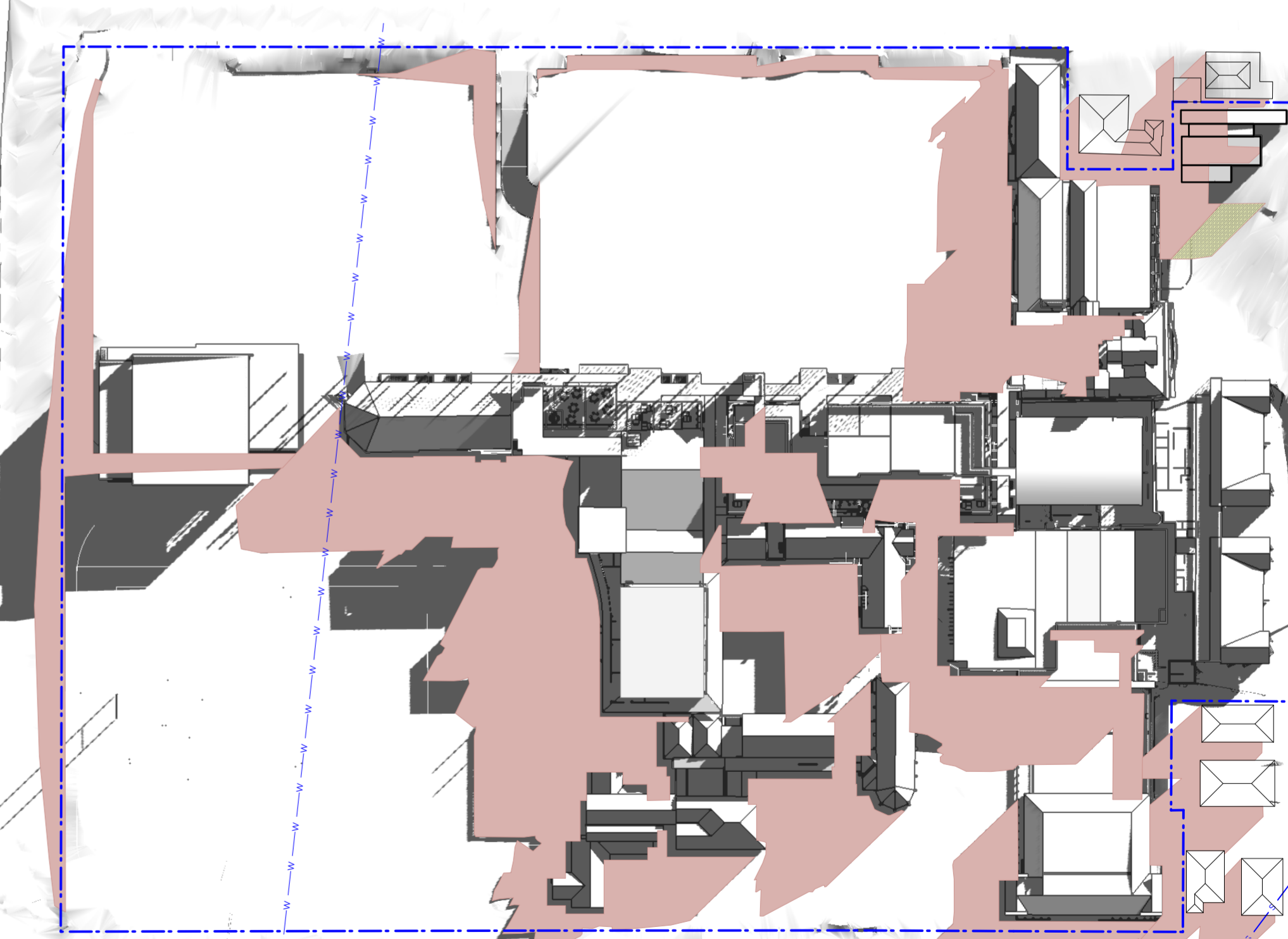

3pm
Winter June 21

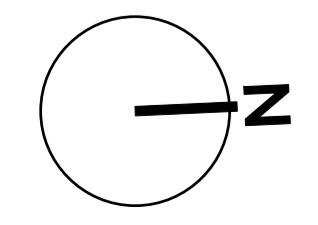

| ISSUE | DATE | REVISION |
|-------|--------|-------------------------|
| B | 3/8/20 | Shadow diagrams updated |
| A | 3/2/20 | SSDA Submission |

| | |
|---|------------------------------|
| <small>DO NOT SCALE FROM DRAWING. USE FIGURED DIMENSIONS ONLY. CHECK ALL DIMENSIONS ON SITE BEFORE MANUFACTURE OR CONSTRUCTION.</small> | |
| PROJECT | TGS Renewal Project |
| CLIENT | Trinity Grammar School |
| DWG # | DA030 |
| DATE | Feb 2020 |
| CLIENT REF & CONTACT | 119 Prospect Rd, Summer Hill |
| SCALE | 1:500 @ A1 |
| DRAWN | KC |
| REVISION | SC |
| PROJECT # | 2808 |
| DWG # | DA030 |
| REVISION | B |

PMDL ARCHITECTURE INTERIORS MASTERPLANNING

pmdl.com.au

PMDL ARCHITECTURE + DESIGN INC (LIMITED)
PMDL ARCHITECTURE + DESIGN PTY LTD ABN 56 002 961 317
NSW NOMINATED ARCHITECTS: ANDREW PENDER 537 DAVID MORRIS 5865 VICKI VAN DUJK 9476