

VIEW FROM THE PRIMARY SCHOOL HANDBALL COURTS



HIGH SCHOOL ARRIVAL



CENTRAL TERRACE LANDSCAPE PLAN



PRIMARY SCHOOL DETAIL NORTH



GROUND LEVEL

PRIMARY SCHOOL AND HIGH SCHOOL ARRIVAL

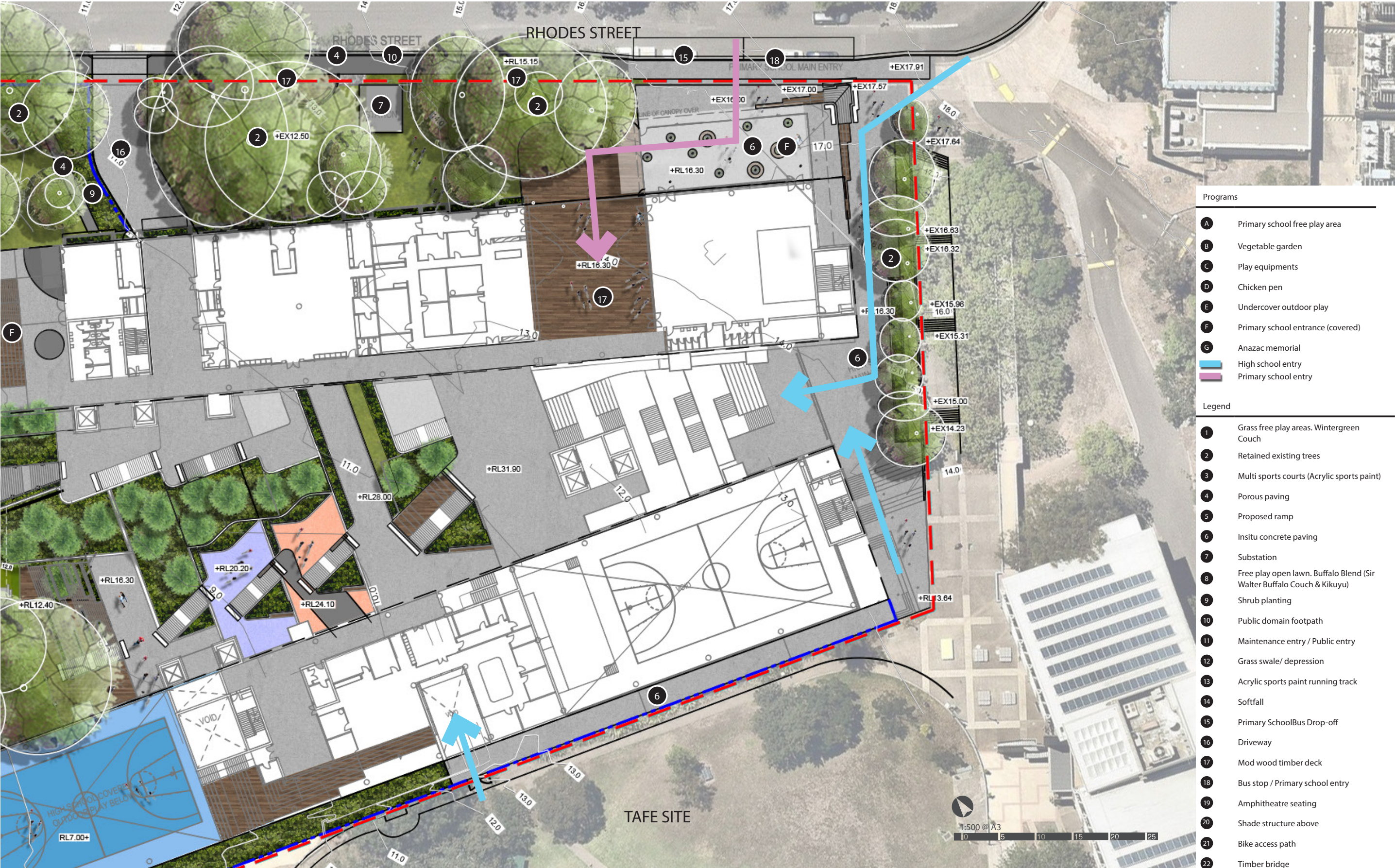

GROUND LEVEL

HIGH SCHOOL DETAIL SOUTH



HIGH SCHOOL DETAIL NORTH



Programs	
A	High school free play area
B	Undercover outdoor play
C	High school amphitheatre
Legend	
1	Grass free play areas. Wintergreen Couch
2	Retained existing trees
3	Multi sports courts (Acrylic sports paint)
4	Multi sports courts (Astro turf)
5	Proposed ramp
6	In situ concrete paving
7	Sport storage
8	Free play open lawn. Buffalo Blend (Sir Walter Buffalo Couch & Kikuyu)
9	Shrub planting
10	Amphitheatre seating
11	Pedestrian access
12	Grass swale/ depression
13	Acrylic sports paint running track
14	Shade structure above
15	Terrace seating
16	Timber decking amphitheatre
17	Timber bridge
18	Resin bound gravel

PART B

LANDSCAPE COMPONENTS &
MATERIALS



2.0 KIT OF PARTS

PLAY

A range of free play and structured play spaces are provided at both primary and high schools. Multiple opportunities are explored for tactile play spaces that connect children with the existing established landscape setting.



Vanke Cloud City, Guangzhou - Lab D+H

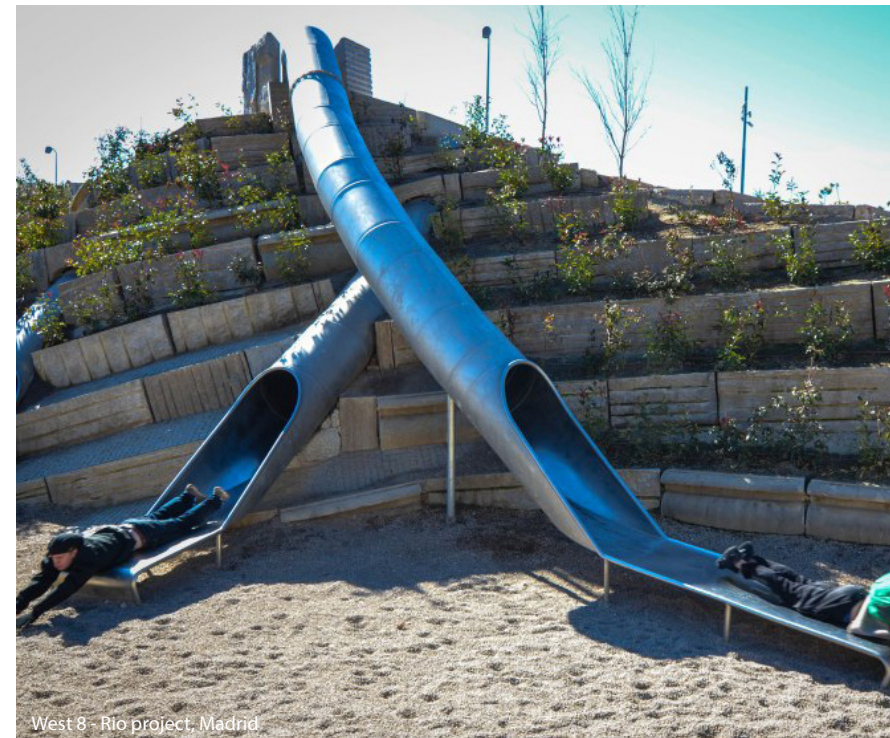

West 8 - Rio project, Madrid



Barangaroo Early Learning Centre - Aspect Studios



West 8 - Rio project, Madrid



Anzac Park - Tyrrell Studio



Israel Museum, Jerusalem - Yaac Peled



West 8 - Rio project, Madrid



Parramatta Riverside Playground - Hassell

OUTDOOR LEARNING

We have maximise outdoor learning opportunities through a range of typologies which include:

- Covered outdoor spaces integrated with the built form;
- Covered outdoor pavilions within the playgrounds;
- Informal outdoor learning seating nodes integrated within the existing landscape setting;
- Provide multiple connections with the natural environment;
- Expressed and celebrated the existing ecological and environmental systems on the site and explored new opportunities to engage with the landscape.

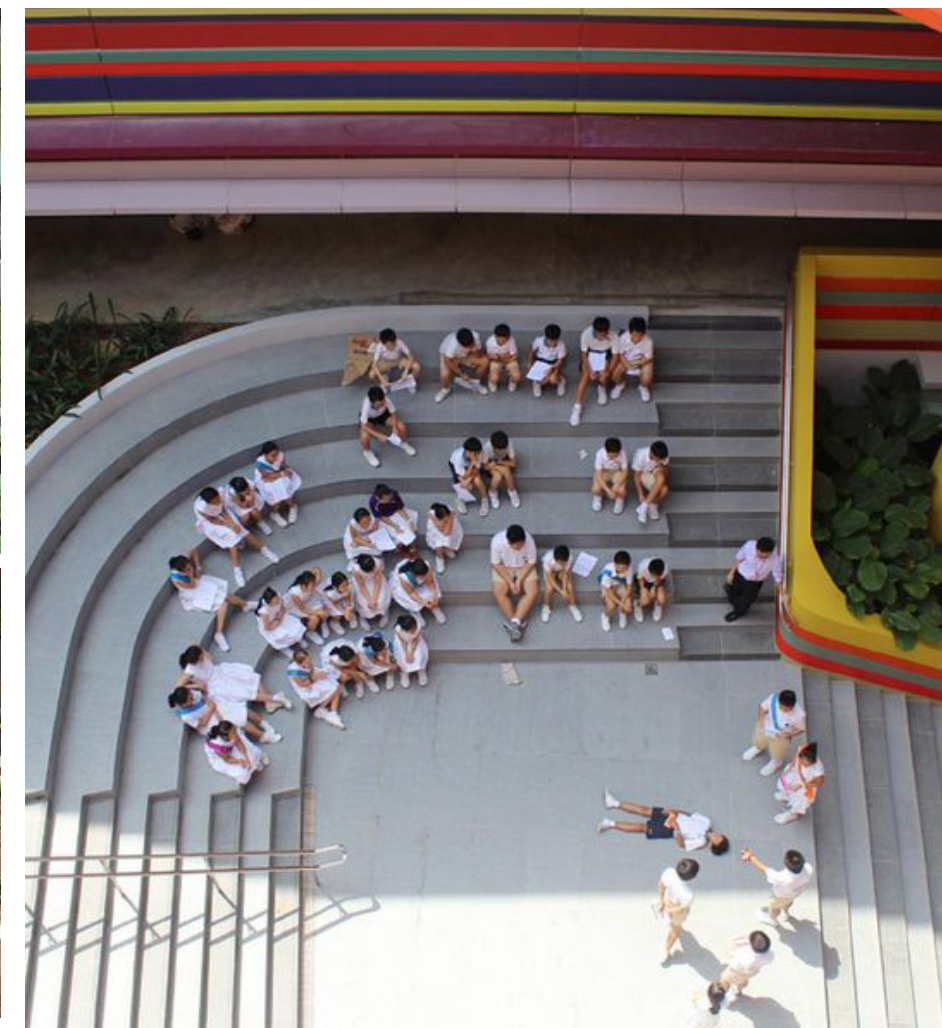

FURNITURE

The primary and high schools will have site specific furniture which includes sculptural seating elements to the rooftop terraces, integrated landscape seating (amphitheatre, low retaining walls, grandstand seating), raised seating platforms, outdoor tables and chairs, moveable furniture such as bean bags and deck chairs.

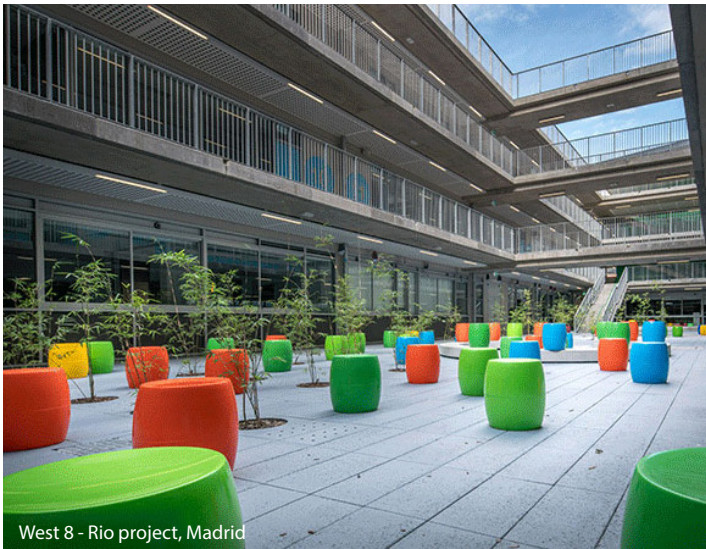
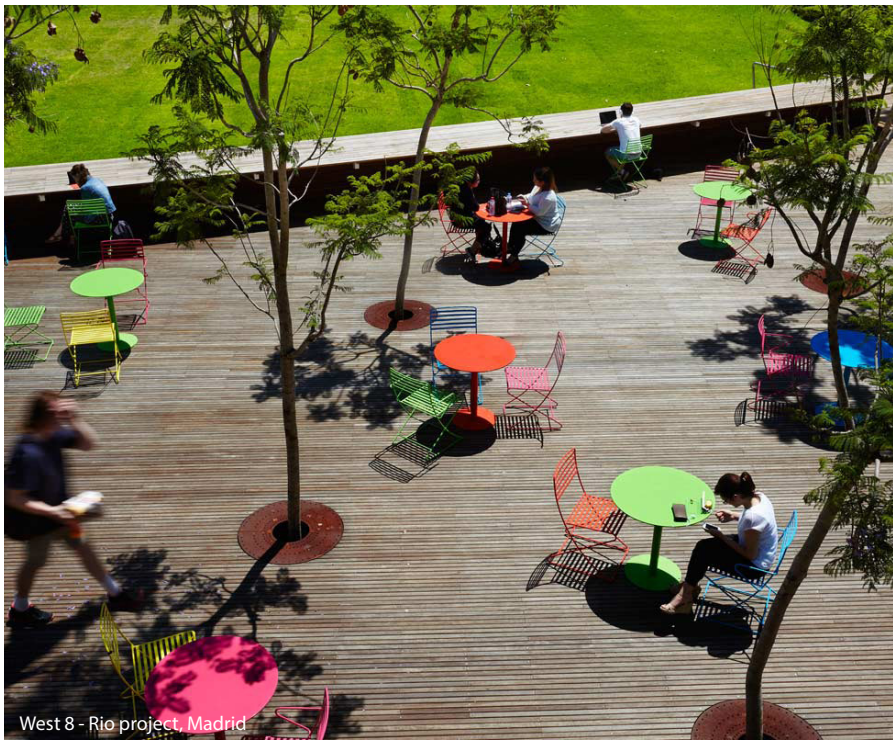

ART & INTERPRETATION

UAP are delivering the Public Art Strategy and Implementation Plan which will support the innovative design of the new vertical and integrated school. A thoughtfully curated public art program will ensure the delivery of art and design that engages with and speaks to the diverse range of families and students attending the college. Public art will create engaging modes of story-telling which captivate and inspire, creating unexpected moments of fun, delight and learning throughout the college grounds.

UAP brings an intimate understanding of how to deliver public art for education environment having previously worked with the Australian National University, University of Sydney, La Trobe University, Queensland University of Technology amongst others in Australia and overseas

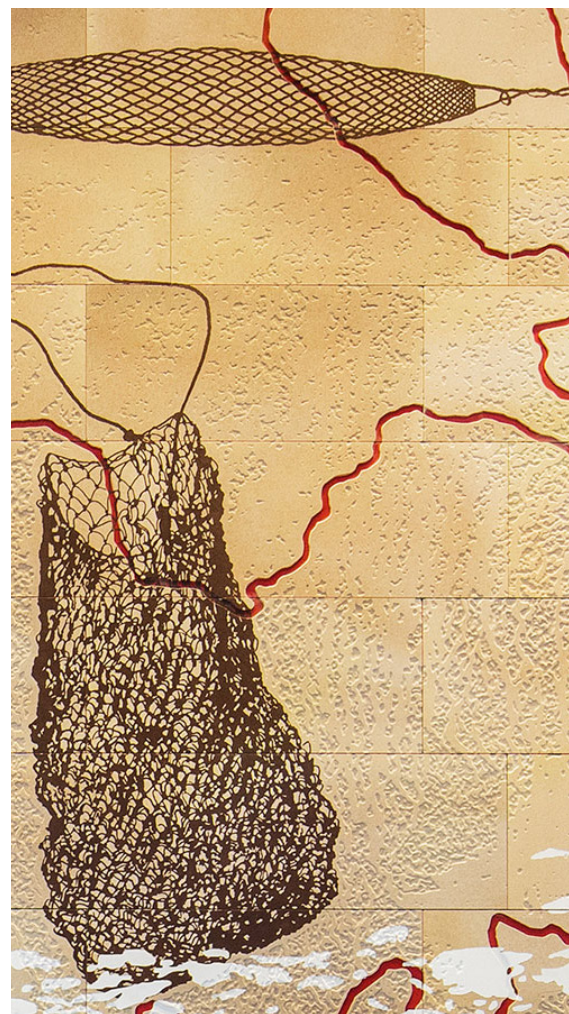
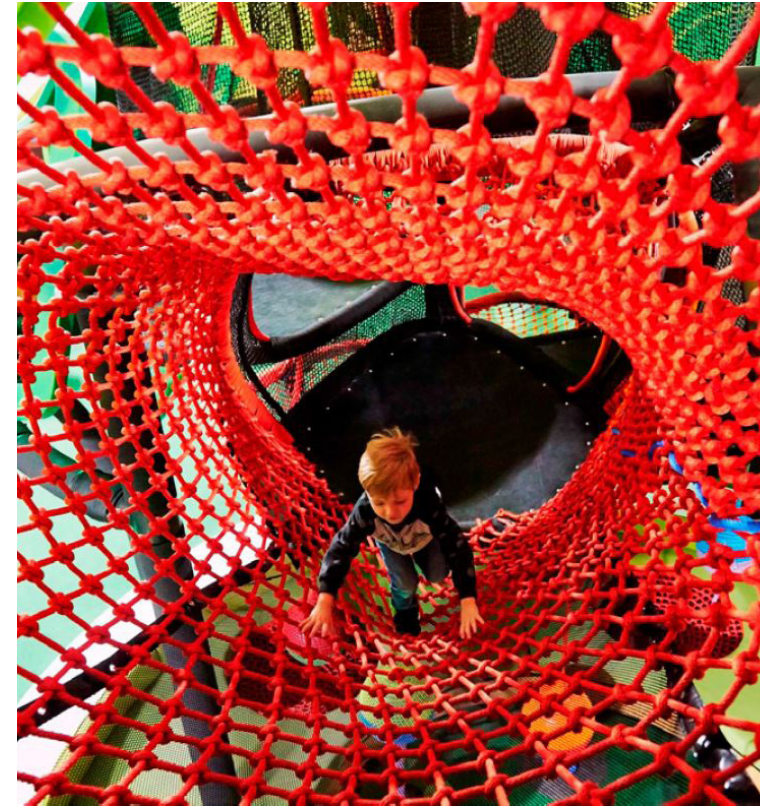

MATERIALITY

Materials and finishes have been selected based on their texture, form and aesthetic appeal.

Paving will consist of contrasting finishes, textures and materials (timber, stone, brick and concrete) providing a seamless connections throughout the site.

Scale of pavers will respond to Primary and Secondary schools

Will comply with the Department of Education's Facilities Standards and Guidelines.



Cranbrook prep school - ASPECT Studios

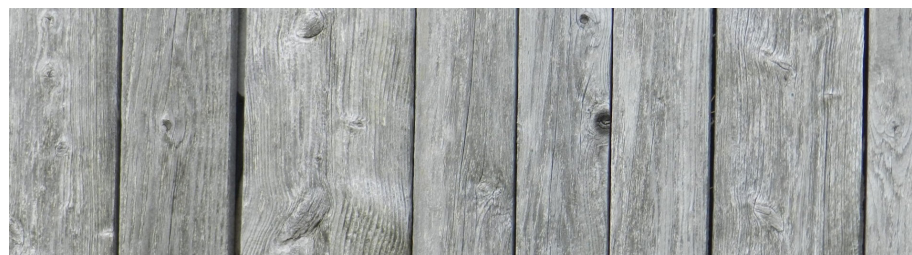

Cranbrook prep school - ASPECT Studios

LIGHTING

All external areas will be designed to meet relevant Australian Lighting Standards. Integrated landscape lighting is proposed to all the landscape elements. Lighting will be provided to meet all Australian standards and Green Star energy efficiency requirements. Feature lights will highlight distinguished interest areas & landscape elements.

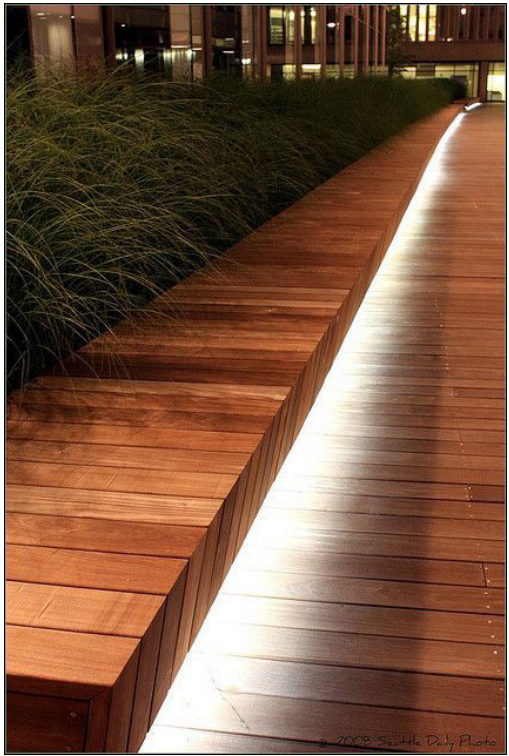

PLANTING

Plants have been chosen for their contrasting form foliage and colour, promoting a diversity of trees and understory planting. Responding to the existing native planting in and around the site, as well as the context and climatic conditions.

Water Sensitive Urban Design (WSUD) principles have been realized into the landscape design in a way that celebrates a sustainable water cycle. Where possible storm water runoff will be directed to the lawn and garden beds. All soft landscape zones on structure will be detailed to have subsurface drainage.

Irrigation will be provided to all soft landscape areas and will be specified within the tender package.

Irrigation of roof gardens is intended to collect the surface water runoff from all roof areas to irrigate lower level terrace gardens.

Plant selection will be carefully chosen for a child friendly environment taking into consideration:

- Children with allergies
- Bee attracting species to be located above head height and away from play areas
- Mosquito repellent species



FENCING

The vision for Meadowbank Schools is to foster permeability of the physical environment to encourage movement and connections. This includes visual connections from the street and from primary to high school.

The overarching principles for the Precinct Plan's fencing strategy are:

- Minimise the visual impact of fences/barriers on the streets;
- Ensure an open and transparent design response and
- Be unobtrusive

Generally vertical bar railings, powder coated black with planting is preferred.

Low Visual Impact will be achieved by:

- Eliminating fencing where possible
- Integrating 'HaHa' style walls
- Using planting & landform in conjunction with fencing to reduce visibility of fencing
- Combine walls + balustrade to reduce extent of fencing
- Integrate planting into fencing e.g. vines/climbers on low fences.

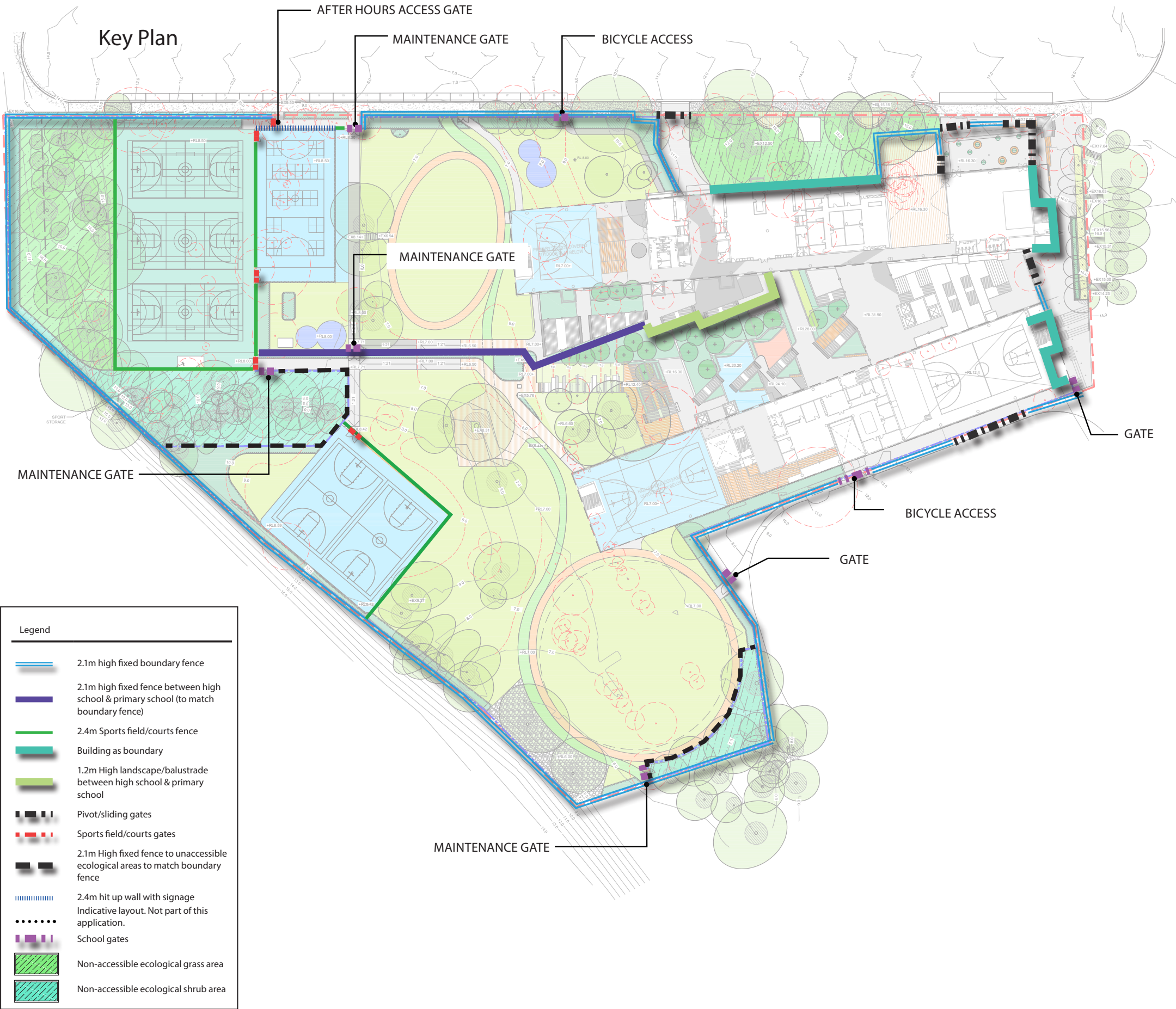



2.1m High fixed fence with planting to boundary

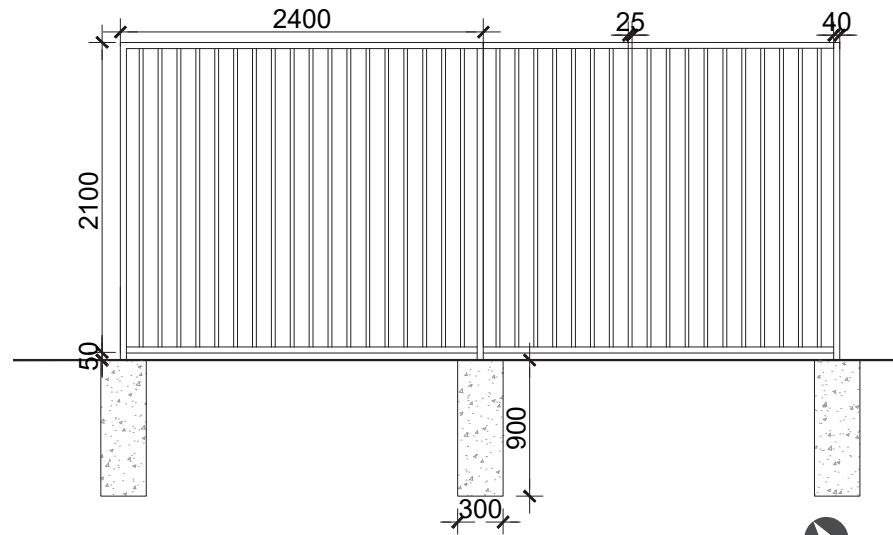

1:50 @ A3



2.4m Sports field / court fence

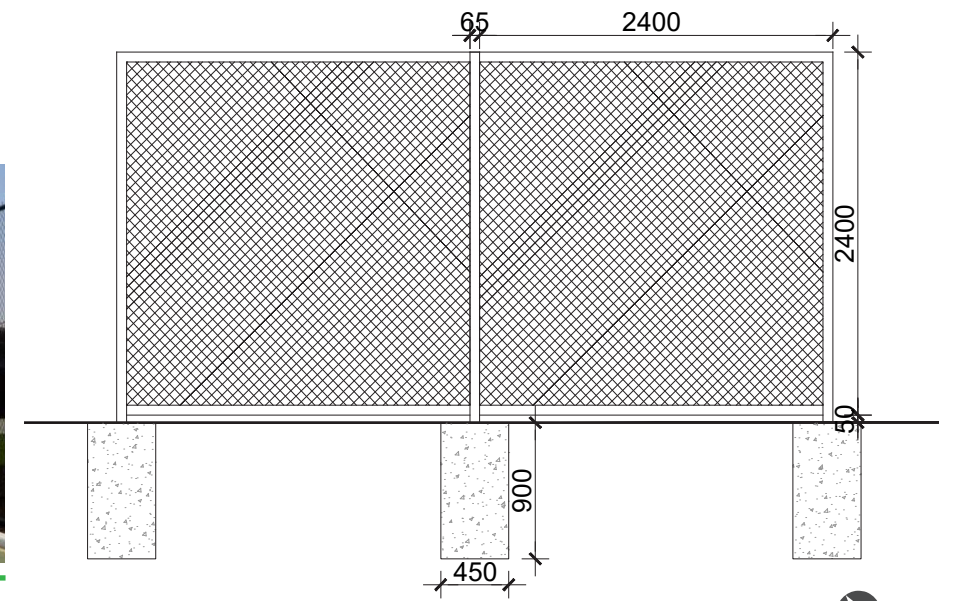

1:50 @ A3



1.2 m Landscape/balustrade between high school & primary school

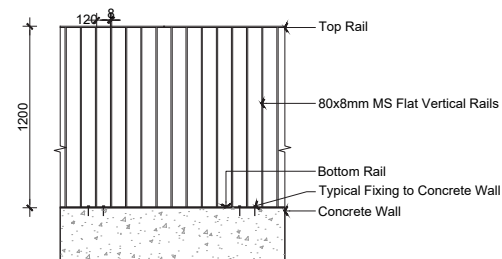

1:50 @ A3



Pivot/ Sliding Gates



2.4m hit-up wall with Signage (from court side)



2.1m High Fixed Fence on hob wall separating schools

