

WOODLAND RIDGE POULTRY PTY LTD
52 SINCLAIR STREET, GOULBURN

PROPOSED PROCESSING FACILITY - CIVIL WORKS



SIX Maps © 2019

LOCALITY PLAN

DRAWING SHEETS	
180054.CIV01	LOCALITY PLAN & DRAWING LIST
180054.CIV02	OVERALL PLAN
180054.CIV03-1	STORMWATER MANAGEMENT PLAN - STAGE 1
180054.CIV04-1	STORMWATER MANAGEMENT PLAN - STAGE 1
180054.CIV05-1	STORMWATER MANAGEMENT PLAN - STAGE 1
180054.CIV06-1	STORMWATER MANAGEMENT PLAN - STAGE 1
180054.CIV07-1	EROSION & SEDIMENT CONTROL PLAN - STAGE 1
180054.CIV08-1	EROSION & SEDIMENT CONTROL PLAN - STAGE 1
180054.CIV09-1	EROSION & SEDIMENT CONTROL PLAN - STAGE 1
180054.CIV10-1	EROSION & SEDIMENT CONTROL PLAN - STAGE 1
180054.CIV03-2	STORMWATER MANAGEMENT PLAN - STAGE 2
180054.CIV04-2	STORMWATER MANAGEMENT PLAN - STAGE 2
180054.CIV05-2	STORMWATER MANAGEMENT PLAN - STAGE 2
180054.CIV06-2	STORMWATER MANAGEMENT PLAN - STAGE 2
180054.CIV07-2	EROSION & SEDIMENT CONTROL PLAN - STAGE 2
180054.CIV08-2	EROSION & SEDIMENT CONTROL PLAN - STAGE 2
180054.CIV09-2	EROSION & SEDIMENT CONTROL PLAN - STAGE 2
180054.CIV10-2	EROSION & SEDIMENT CONTROL PLAN - STAGE 2
180054.CIV11	SOIL & WATER MANAGEMENT NOTES
180054.CIV12	EROSION & SEDIMENT CONTROL DETAILS
180054.CIV13	CUT/FILL PLAN
180054.CIV14	CUT/FILL PLAN
180054.CIV15	CUT/FILL PLAN
180054.CIV16	CUT/FILL PLAN

REVISIONS							This drawing is <u>not</u> approved for construction unless signed.			<div><div>PO BOX 4105 Kotara East 2305</div><div>0402 915 549</div><div>ABN 64 625 755 482</div></div> <div></div>	LOCALITY PLAN PROPOSED PROCESSING FACILITY 52 SINCLAIR STREET, GOULBURN WOODLAND RIDGE POULTRY PTY LTD	DRAWING STATUS		SHEET SIZE
							NOT FOR CONSTRUCTION					A1		
							PROJECT REF No.	DRAWING No.				REVISION		
							180054	CIV01				E		
												SCALE		
												-		
REV	DATE	DRN	CHK	APP	DRAWING STATUS		COPYRIGHT - This drawing and the information provided shall remain the property of DRB Consulting Engineers Pty Ltd (DRB) and may not be used, copied or reproduced, in whole or part, for any purpose other than that for which it was supplied without the prior consent of DRB.							
E	27.11.19	R.F.	M.M.	M.M.	DRAWING SHEET LIST ADDED		Mathew McNamara BEing (Civil) Hons MIE (Aust)							
D	14.06.19	R.F.	M.M.	M.M.	RE-ISSUED FOR DA									
C	04.04.19	R.F.	M.M.	M.M.	ISSUED FOR DA									
B	20.03.19	R.F.	M.M.	M.M.	DRAFT DA									
A	20.02.19	R.F.	M.M.	M.M.	ISSUED FOR COORDINATION									E

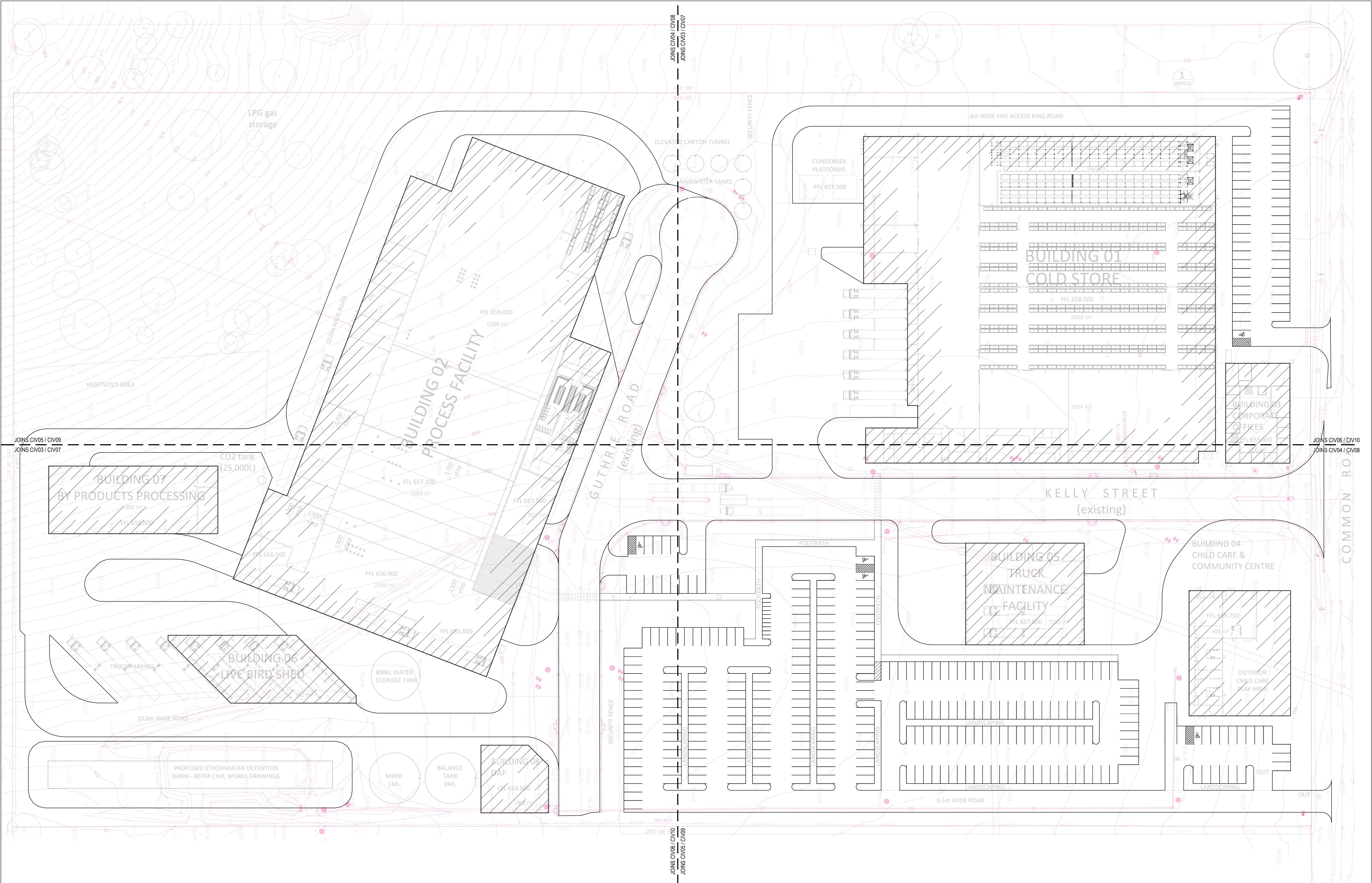

REV	DATE	DRN	CHK	APP	DRAWING STATUS	

This drawing is **not** approved for construction unless signed.

Mathew McLennan
BEing (Civil) Hons MIE (Aust)

COPYRIGHT - This drawing and the information provided shall remain the property of DRB Consulting Engineers Pty Ltd (DRB) and may not be used, copied or reproduced, in whole or part, for any purpose other than that for which it was supplied without the prior consent of DRB.

North

PO BOX 4105 Kotara East 2305
0402 915 549
ABN 64 625 755 482

DRB CONSULTING ENGINEERS

PROPOSED LAYOUT PLAN
PROPOSED PROCESSING FACILITY
52 SINCLAIR STREET,
GOULBURN
WOODLAND RIDGE POULTRY PTY LTD

DRAWING STATUS		SHEET SIZE
NOT FOR CONSTRUCTION		A1
PROJECT REF No.		SCALE
180054	DRAWING No.	1:2000
	CIV02	REVISION
		E

JOINS CIV04 / CIV08
JOINS CIV03 / CIV07

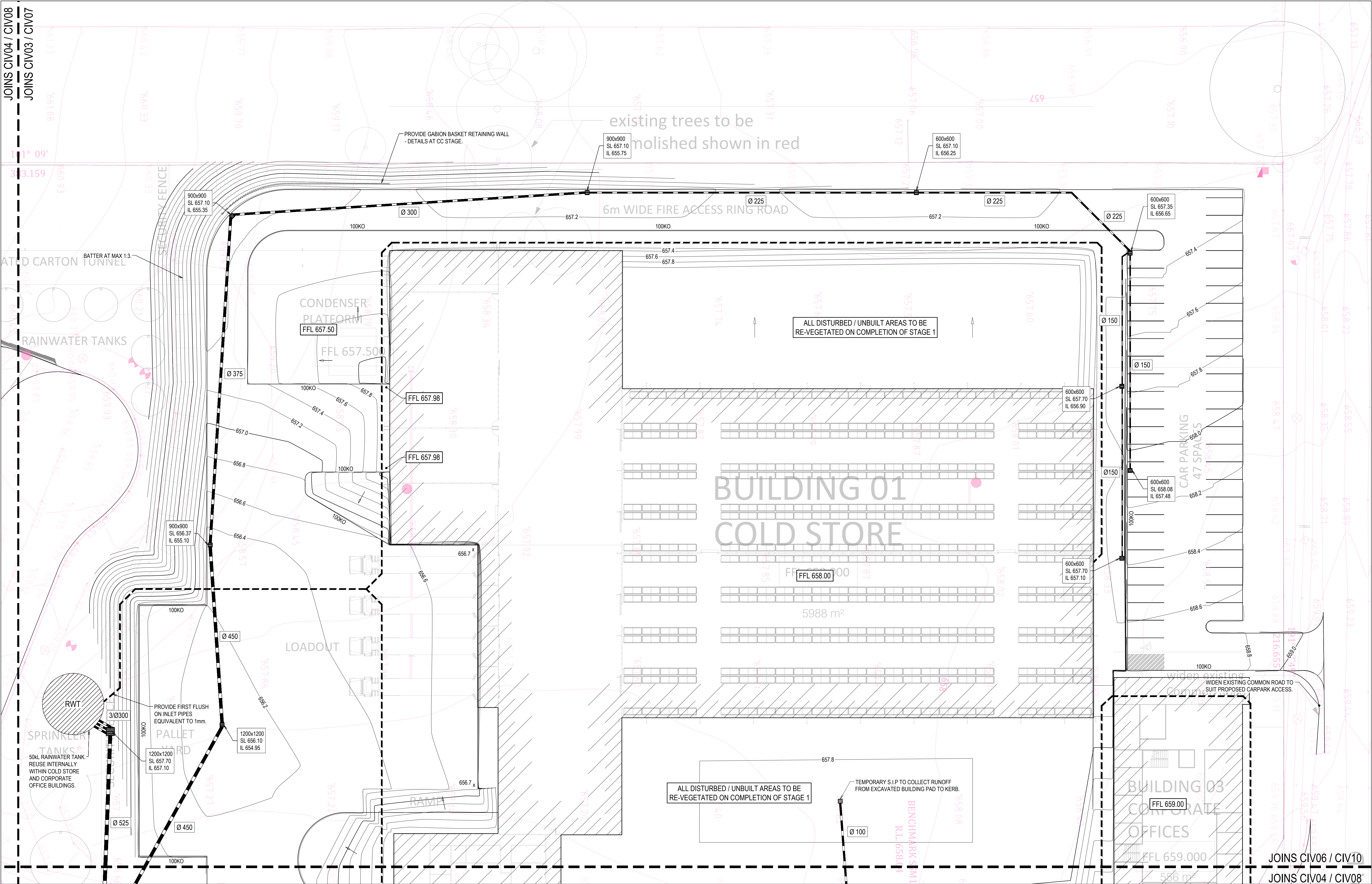

REVISIONS					
REV	DATE	DRN	CHK	APP	DRAWING STATUS
A	27.11.19	R.F.	M.M.	M.M.	ISSUED FOR DA

This drawing is not approved for construction unless signed.

Mathew McLennan
BEing (Civil) Hons MIE (Aust)

COPYRIGHT - This drawing and the information provided shall remain the property of DRB Consulting Engineers Pty Ltd (DRB) and may not be used, copied or reproduced, in whole or part, for any purpose other than that for which it was supplied without the prior consent of DRB.

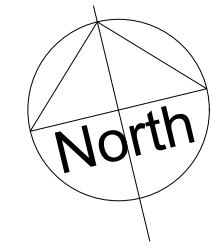

PO BOX 4105 Kotara East 2305
0402 915 549
ABN 64 625 755 482

STORMWATER MANAGEMENT PLAN
PROPOSED PROCESSING FACILITY
52 SINCLAIR STREET,
GOULBURN
WOODLAND RIDGE POULTRY PTY LTD

DRAWING STATUS		SHEET SIZE
NOT FOR CONSTRUCTION		A1
PROJECT REF No.		SCALE
180054		1:250
DRAWING No.		REVISION
CIV04-1		A

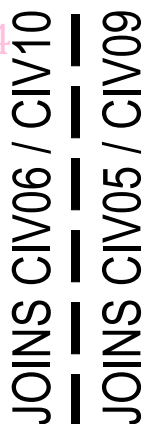

This drawing is not approved for construction unless signed.

Mathew McNamara
BEng (Civl) Hons MIE (Aust)

COPYRIGHT - This drawing and the information provided shall remain the property of DRB Consulting Engineers Pty Ltd (DRB) and may not be used, copied or reproduced, in whole or part, for any purpose other than that for which it was supplied without the prior consent of DRB.



DRAWING STATUS		SHEET SIZE
NOT FOR CONSTRUCTION		A1
		SCALE
		1:250
PROJECT REF No.	DRAWING No.	REVISION
180054	CIV05-1	A

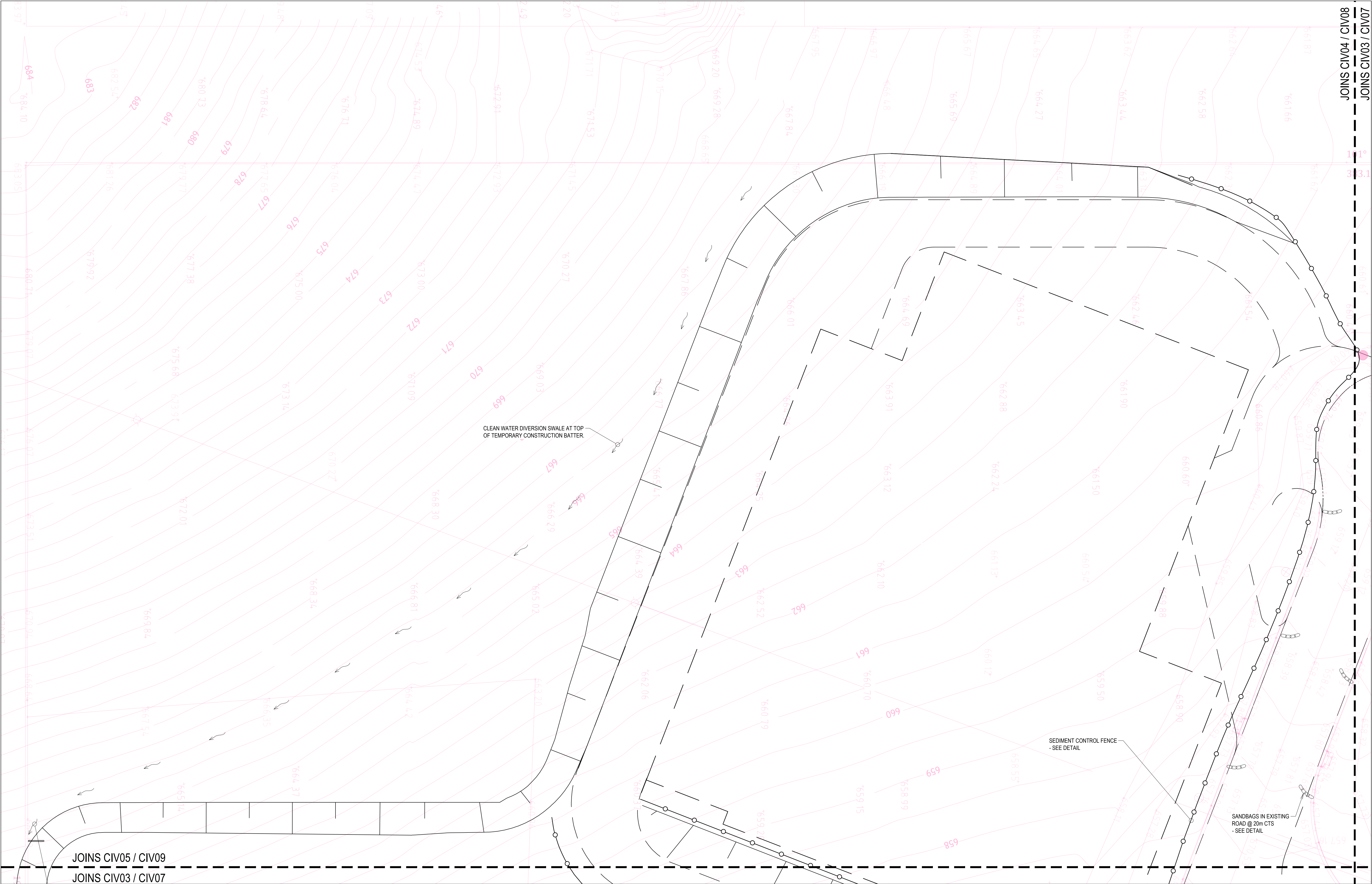

JOINS CIV04 / CIV08
JOINS CIV03 / CIV07

JOINS CIV05 / CIV09
JOINS CIV03 / CIV07

REV	DATE	DRN	CHK	APP	DRAWING STATUS
A	27.11.19	R.F.	M.M.	M.M.	ISSUED FOR DA

This drawing is not approved for construction unless signed.

Mathew McLennan
BEing (Civil) Hons MIE (Aust)

COPYRIGHT - This drawing and the information provided shall remain the property of DRB Consulting Engineers Pty Ltd (DRB) and may not be used, copied or reproduced, in whole or part, for any purpose other than that for which it was supplied without the prior consent of DRB.

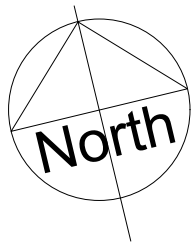

PO BOX 4105 Kotara East 2305
0402 915 549
ABN 64 625 755 482



CONSULTING ENGINEERS

EROSION & SEDIMENT CONTROL PLAN
PROPOSED PROCESSING FACILITY
52 SINCLAIR STREET,
GOULBURN
WOODLAND RIDGE POULTRY PTY LTD

DRAWING STATUS	
NOT FOR CONSTRUCTION	
PROJECT REF No.	DRAWING No.
180054	ESD07-1

SHEET SIZE
A1
SCALE
1:250
REVISION
A

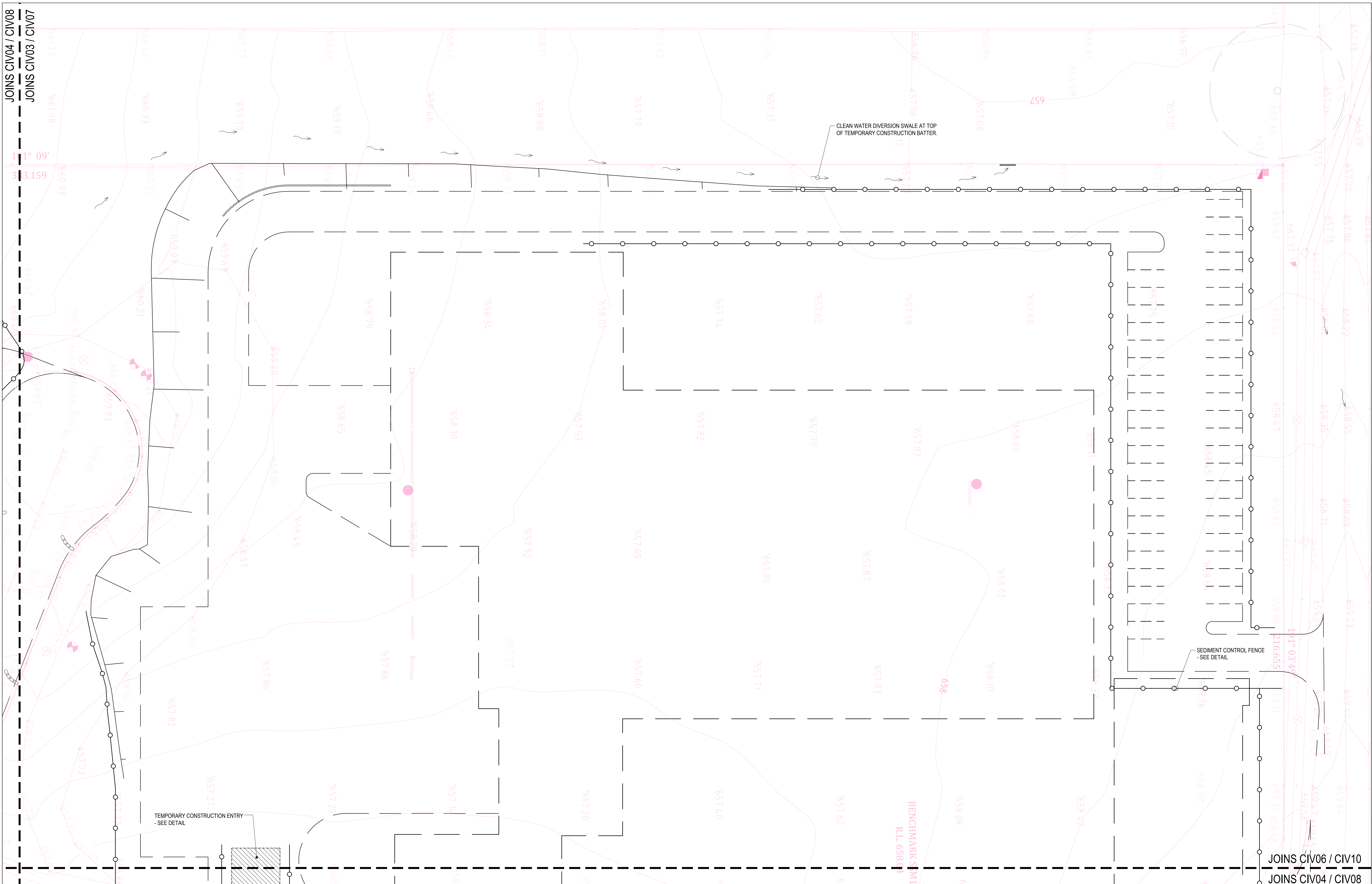

REVISIONS																																																																																																																																																																																																																																																																																																																																																																																																																																																																																																																																																																																																																																																																																																																																																																																																																																																																																																																																																																																																																																																																																																																																																																																																																																																																																																																																																																																																																																								
-----------	--	--	--	--	--	--	--	--	--	--	--	--	--	--	--	--	--	--	--	--	--	--	--	--	--	--	--	--	--	--	--	--	--	--	--	--	--	--	--	--	--	--	--	--	--	--	--	--	--	--	--	--	--	--	--	--	--	--	--	--	--	--	--	--	--	--	--	--	--	--	--	--	--	--	--	--	--	--	--	--	--	--	--	--	--	--	--	--	--	--	--	--	--	--	--	--	--	--	--	--	--	--	--	--	--	--	--	--	--	--	--	--	--	--	--	--	--	--	--	--	--	--	--	--	--	--	--	--	--	--	--	--	--	--	--	--	--	--	--	--	--	--	--	--	--	--	--	--	--	--	--	--	--	--	--	--	--	--	--	--	--	--	--	--	--	--	--	--	--	--	--	--	--	--	--	--	--	--	--	--	--	--	--	--	--	--	--	--	--	--	--	--	--	--	--	--	--	--	--	--	--	--	--	--	--	--	--	--	--	--	--	--	--	--	--	--	--	--	--	--	--	--	--	--	--	--	--	--	--	--	--	--	--	--	--	--	--	--	--	--	--	--	--	--	--	--	--	--	--	--	--	--	--	--	--	--	--	--	--	--	--	--	--	--	--	--	--	--	--	--	--	--	--	--	--	--	--	--	--	--	--	--	--	--	--	--	--	--	--	--	--	--	--	--	--	--	--	--	--	--	--	--	--	--	--	--	--	--	--	--	--	--	--	--	--	--	--	--	--	--	--	--	--	--	--	--	--	--	--	--	--	--	--	--	--	--	--	--	--	--	--	--	--	--	--	--	--	--	--	--	--	--	--	--	--	--	--	--	--	--	--	--	--	--	--	--	--	--	--	--	--	--	--	--	--	--	--	--	--	--	--	--	--	--	--	--	--	--	--	--	--	--	--	--	--	--	--	--	--	--	--	--	--	--	--	--	--	--	--	--	--	--	--	--	--	--	--	--	--	--	--	--	--	--	--	--	--	--	--	--	--	--	--	--	--	--	--	--	--	--	--	--	--	--	--	--	--	--	--	--	--	--	--	--	--	--	--	--	--	--	--	--	--	--	--	--	--	--	--	--	--	--	--	--	--	--	--	--	--	--	--	--	--	--	--	--	--	--	--	--	--	--	--	--	--	--	--	--	--	--	--	--	--	--	--	--	--	--	--	--	--	--	--	--	--	--	--	--	--	--	--	--	--	--	--	--	--	--	--	--	--	--	--	--	--	--	--	--	--	--	--	--	--	--	--	--	--	--	--	--	--	--	--	--	--	--	--	--	--	--	--	--	--	--	--	--	--	--	--	--	--	--	--	--	--	--	--	--	--	--	--	--	--	--	--	--	--	--	--	--	--	--	--	--	--	--	--	--	--	--	--	--	--	--	--	--	--	--	--	--	--	--	--	--	--	--	--	--	--	--	--	--	--	--	--	--	--	--	--	--	--	--	--	--	--	--	--	--	--	--	--	--	--	--	--	--	--	--	--	--	--	--	--	--	--	--	--	--	--	--	--	--	--	--	--	--	--	--	--	--	--	--	--	--	--	--	--	--	--	--	--	--	--	--	--	--	--	--	--	--	--	--	--	--	--	--	--	--	--	--	--	--	--	--	--	--	--	--	--	--	--	--	--	--	--	--	--	--	--	--	--	--	--	--	--	--	--	--	--	--	--	--	--	--	--	--	--	--	--	--	--	--	--	--	--	--	--	--	--	--	--	--	--	--	--	--	--	--	--	--	--	--	--	--	--	--	--	--	--	--	--	--	--	--	--	--	--	--	--	--	--	--	--	--	--	--	--	--	--	--	--	--	--	--	--	--	--	--	--	--	--	--	--	--	--	--	--	--	--	--	--	--	--	--	--	--	--	--	--	--	--	--	--	--	--	--	--	--	--	--	--	--	--	--	--	--	--	--	--	--	--	--	--	--	--	--	--	--	--	--	--	--	--	--	--	--	--	--	--	--	--	--	--	--	--	--	--	--	--	--	--	--	--	--	--	--	--	--	--	--	--	--	--	--	--	--	--	--	--	--	--	--	--	--	--	--	--	--	--	--	--	--	--	--	--	--	--	--	--	--	--	--	--	--	--	--	--	--	--	--	--	--	--	--	--	--	--	--	--	--	--	--	--	--	--	--	--	--	--	--	--	--	--	--	--	--	--	--	--	--	--	--	--	--	--	--	--	--	--	--	--	--	--	--	--	--	--	--	--	--	--	--	--	--	--	--	--	--	--	--	--	--	--	--	--	--	--	--	--	--	--	--	--	--	--	--	--	--	--	--	--	--	--	--	--	--	--	--	--	--	--	--	--	--	--	--	--	--	--	--	--	--	--	--	--	--	--	--	--	--	--	--	--	--	--	--	--	--	--	--	--	--	--	--	--	--	--	--	--	--	--	--	--	--	--	--	--	--	--	--	--	--	--	--	--	--	--	--	--	--	--	--	--	--	--	--	--	--	--	--	--	--	--	--	--	--	--	--	--	--	--	--	--	--	--	--	--	--	--	--	--	--	--	--	--	--	--	--	--	--	--	--	--	--	--	--	--	--	--	--	--	--	--	--	--	--	--	--	--	--	--	--	--	--	--	--	--	--	--	--	--	--	--	--	--	--	--	--	--	--	--	--	--	--	--	--	--	--	--	--	--	--	--	--	--	--	--	--	--	--	--	--	--	--	--	--	--	--	--	--	--	--	--	--	--	--	--	--	--	--	--	--	--	--	--	--	--	--	--	--	--	--	--	--	--	--	--	--	--	--	--	--	--	--	--	--	--	--	--	--	--	--	--	--	--	--	--	--	--	--	--	--	--	--	--	--	--	--	--	--	--	--	--	--	--	--	--	--	--	--	--	--	--	--	--	--	--	--	--	--	--	--	--	--	--	--	--	--	--	--	--	--	--	--	--	--	--	--	--	--	--	--	--	--	--	--	--	--	--	--	--	--	--	--	--	--	--	--	--	--	--	--	--	--	--	--	--	--	--	--	--	--	--	--	--	--	--	--	--	--	--	--	--	--	--	--	--	--	--	--	--	--	--	--	--	--	--	--	--	--	--	--	--	--	--	--	--	--	--	--	--	--	--	--	--	--	--	--	--	--	--	--	--	--	--	--	--	--	--	--	--	--	--	--	--	--	--	--	--	--	--	--	--	--

JOINS CIV03 / CIV07

PROVIDE LEVEL SPREADER AT BOUNDARY
TO ENCOURAGE SHEET FLOW.

✓ PROVIDE SANDBAGS AT 20m CTS IN DRAINAGE CHANNEL UNTIL ADEQUATELY REVEGETATED.

TEMPORARY CONSTRUCTION ENTRY
- SEE DETAIL

SEDIMENT CONTROL FENCE
- SEE DETAIL

SANDBAGS IN EXISTING
ROAD @ 20m CTS
- SEE DETAIL

RL 651.10

TOP OF BANK
652.90

PROPOSED DAM TO BE CONSTRUCTED PRIOR TO SITE STRIPPING
OUTLETS TO BE BLOCKED WITH WEIR RL 652.90.
DAM TO BE USED AS SEDIMENT BASIN DURING CONSTRUCTION.
DETAILS PROVIDED AT CC STAGE.
- REFER REPORT FOR CALCULATIONS.

This drawing is not approved for construction unless signed.

Mathew McNamara
BEng (Civil) Hons MIE (Aust)

COPYRIGHT - This drawing and the information provided shall remain the property of DRB Consulting Engineers Pty Ltd (DRB) and may not be used, copied or reproduced, in whole or part, for any purpose other than that for which it was supplied without the prior consent of DRB.

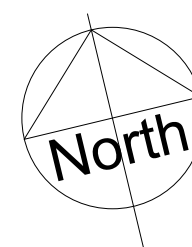

PO BOX 4105 Kotara East 2305
0402 915 549
ABN 64 625 755 482



EROSION & SEDIMENT CONTROL PLAN
PROPOSED PROCESSING FACILITY
52 SINCLAIR STREET,
GOULBURN
WOODLAND RIDGE POULTRY PTY LTD

DRAWING STATUS	
1	1
2	2
3	3
4	4
5	5
6	6
7	7
8	8
9	9
10	10
11	11
12	12
13	13
14	14
15	15
16	16
17	17
18	18
19	19
20	20
21	21
22	22
23	23
24	24
25	25
26	26
27	27
28	28
29	29
30	30
31	31
32	32
33	33
34	34
35	35
36	36
37	37
38	38
39	39
40	40
41	41
42	42
43	43
44	44
45	45
46	46
47	47
48	48
49	49
50	50
51	51
52	52
53	53
54	54
55	55
56	56
57	57
58	58
59	59
60	60
61	61
62	62
63	63
64	64
65	65
66	66
67	67
68	68
69	69
70	70
71	71
72	72
73	73
74	74
75	75
76	76
77	77
78	78
79	79
80	80
81	81
82	82
83	83
84	84
85	85
86	86
87	87
88	88
89	89
90	90
91	91
92	92
93	93
94	94
95	95
96	96
97	97
98	98
99	99
100	100

NOT FOR CONSTRUCTION

PROJECT REF No.
180054

DRAWING No.	CIV09-1
-------------	---------

SHEET SIZE

A1

SCALE

REVISION	
A	

REVISIONS						
	A	28.11.19	R.F.	M.M.	M.M.	ISSUED FOR DA
	REV	DATE	DRN	CHK	APP	DRAWING STATUS

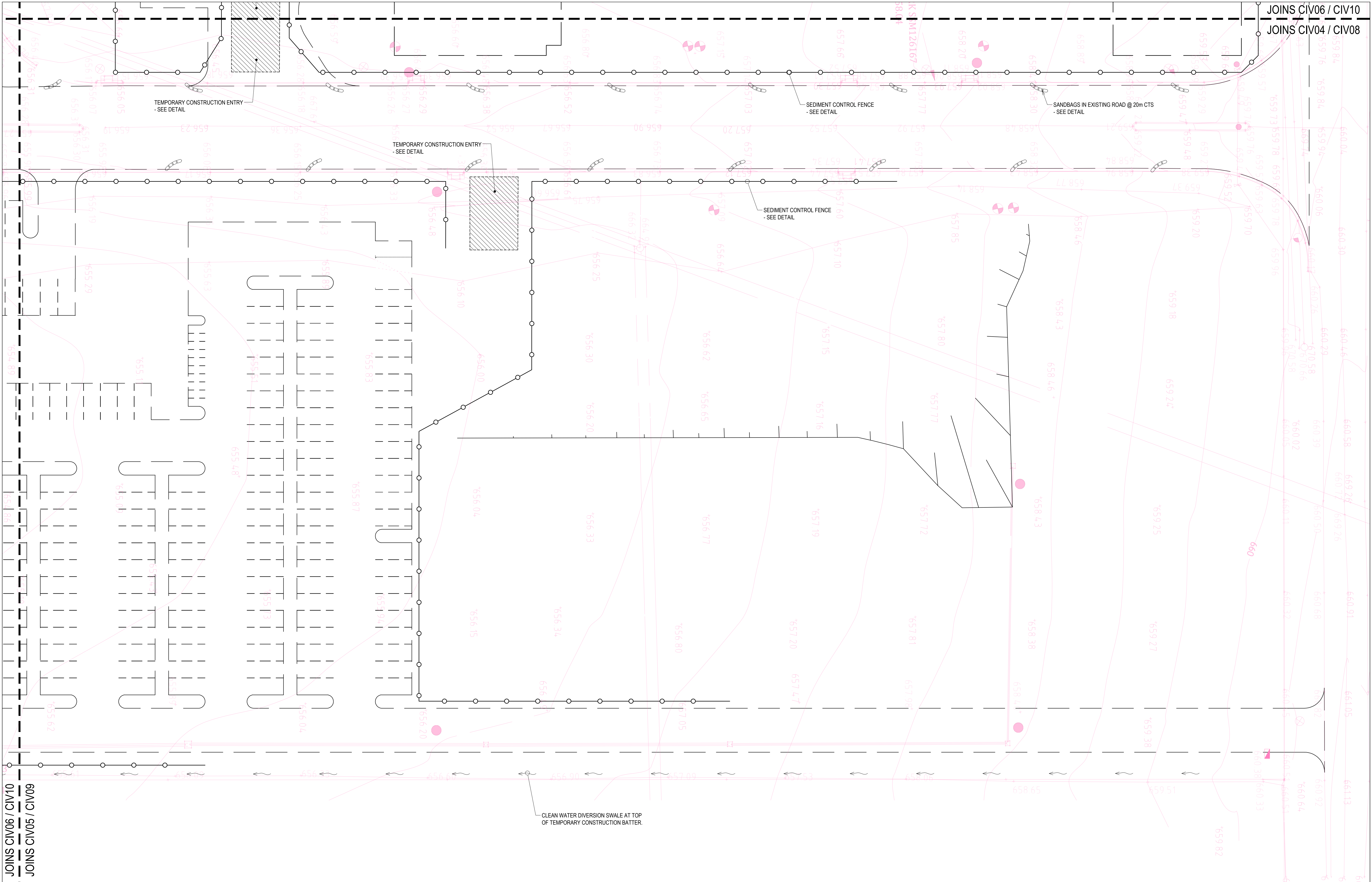

JOINS CIV06 / CIV10
JOINS CIV05 / CIV09

REVISIONS					
REV	DATE	DRN	CHK	APP	DRAWING STATUS
A	27.11.19	R.F.	M.M.	M.M.	ISSUED FOR DA

This drawing is **not** approved for construction unless signed.

Mathew McLennan
BEing (Civil) Hons MIE (Aust)

COPYRIGHT - This drawing and the information provided shall remain the property of DRB Consulting Engineers Pty Ltd (DRB) and may not be used, copied or reproduced, in whole or part, for any purpose other than that for which it was supplied without the prior consent of DRB.

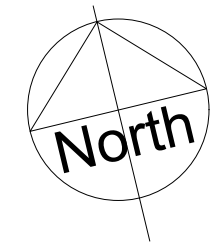

PO BOX 4105 Kotara East 2305
0402 915 549
ABN 64 625 755 482

DRB CONSULTING ENGINEERS

EROSION & SEDIMENT CONTROL PLAN
PROPOSED PROCESSING FACILITY
52 SINCLAIR STREET,
GOULBURN
WOODLAND RIDGE POULTRY PTY LTD

DRAWING STATUS		SHEET SIZE
NOT FOR CONSTRUCTION		A1
PROJECT REF No. 180054		SCALE 1:250
DRAWING No. CIV10-1		REVISION A

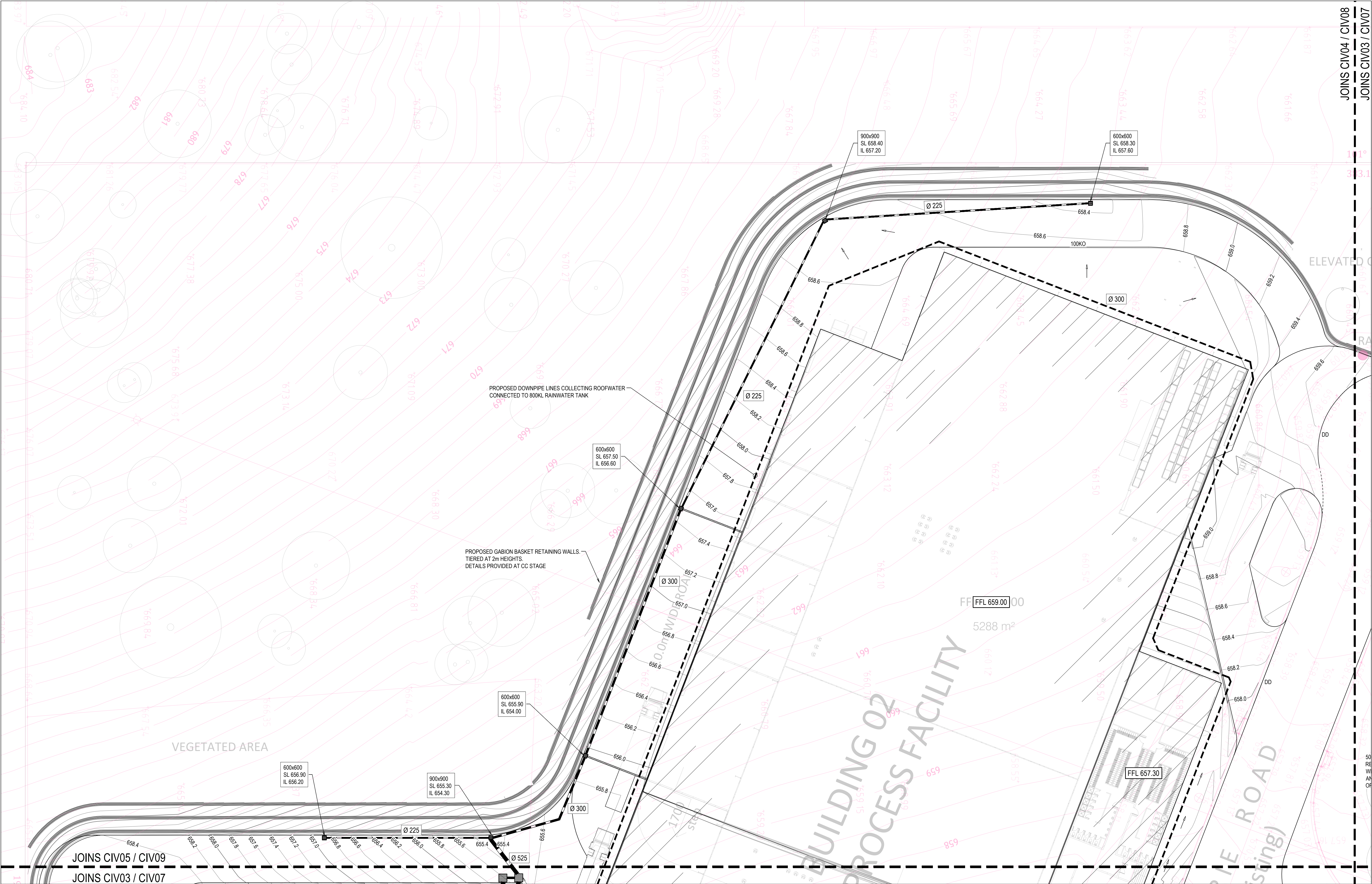

REV	DATE	DRN	CHK	APP	DRAWING STATUS
A	27.11.19	R.F.	M.M.	M.M.	ISSUED FOR DA

This drawing is not approved for construction unless signed.

Mathew McNamara
BEing (Civil) Hons MIE (Aust)

COPYRIGHT - This drawing and the information provided shall remain the property of DRB Consulting Engineers Pty Ltd (DRB) and may not be used, copied or reproduced, in whole or part, for any purpose other than that for which it was supplied without the prior consent of DRB.

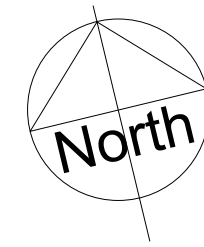

PO BOX 4105 Kotara East 2305
0402 915 549
ABN 64 625 755 482

STORMWATER MANAGEMENT PLAN
PROPOSED PROCESSING FACILITY
52 SINCLAIR STREET,
GOULBURN
WOODLAND RIDGE POULTRY PTY LTD

DRAWING STATUS		SHEET SIZE
NOT FOR CONSTRUCTION		A1
PROJECT REF No.		SCALE
180054		1:250
DRAWING No.		REVISION
CIV03-2		A

JOINS CIV04 / CIV08
JOINS CIV03 / CIV07

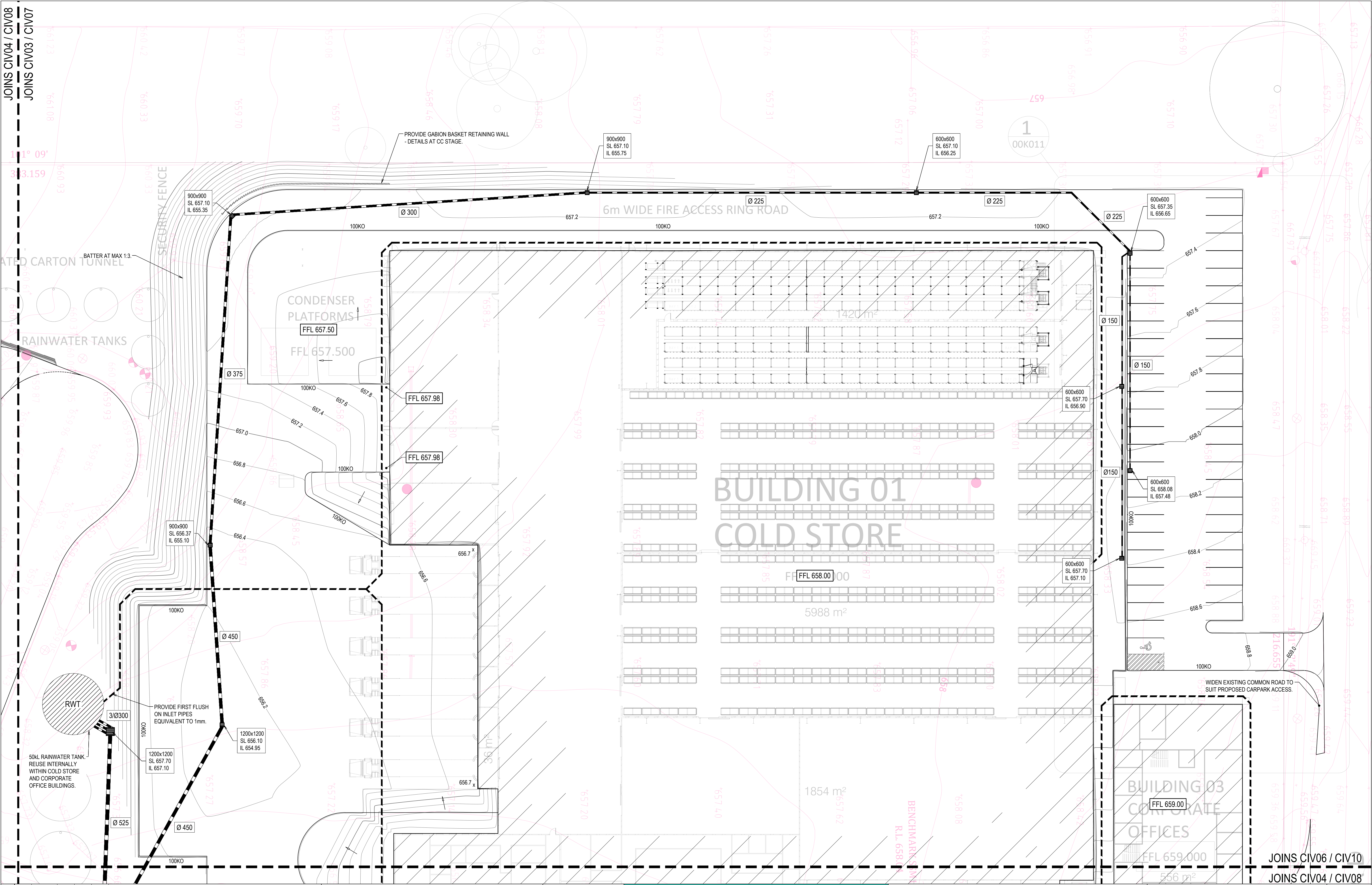

REVISIONS					
REV	DATE	DRN	CHK	APP	DRAWING STATUS
A	27.11.19	R.F.	M.M.	M.M.	ISSUED FOR COORDINATION

This drawing is not approved for construction unless signed.

Mathew McNamara
BEing (Civil) Hons MIE (Aust)

COPYRIGHT - This drawing and the information provided shall remain the property of DRB Consulting Engineers Pty Ltd (DRB) and may not be used, copied or reproduced, in whole or part, for any purpose other than that for which it was supplied without the prior consent of DRB.

PO BOX 4105 Kotara East 2305
0402 915 549
ABN 64 625 755 482

STORMWATER MANAGEMENT PLAN
PROPOSED PROCESSING FACILITY
52 SINCLAIR STREET,
GOULBURN
WOODLAND RIDGE POULTRY PTY LTD

DRAWING STATUS
NOT FOR CONSTRUCTION

PROJECT REF No.
180054

DRAWING No.
CIV04-2

SHEET SIZE
A1

SCALE
1:250

REVISION
A

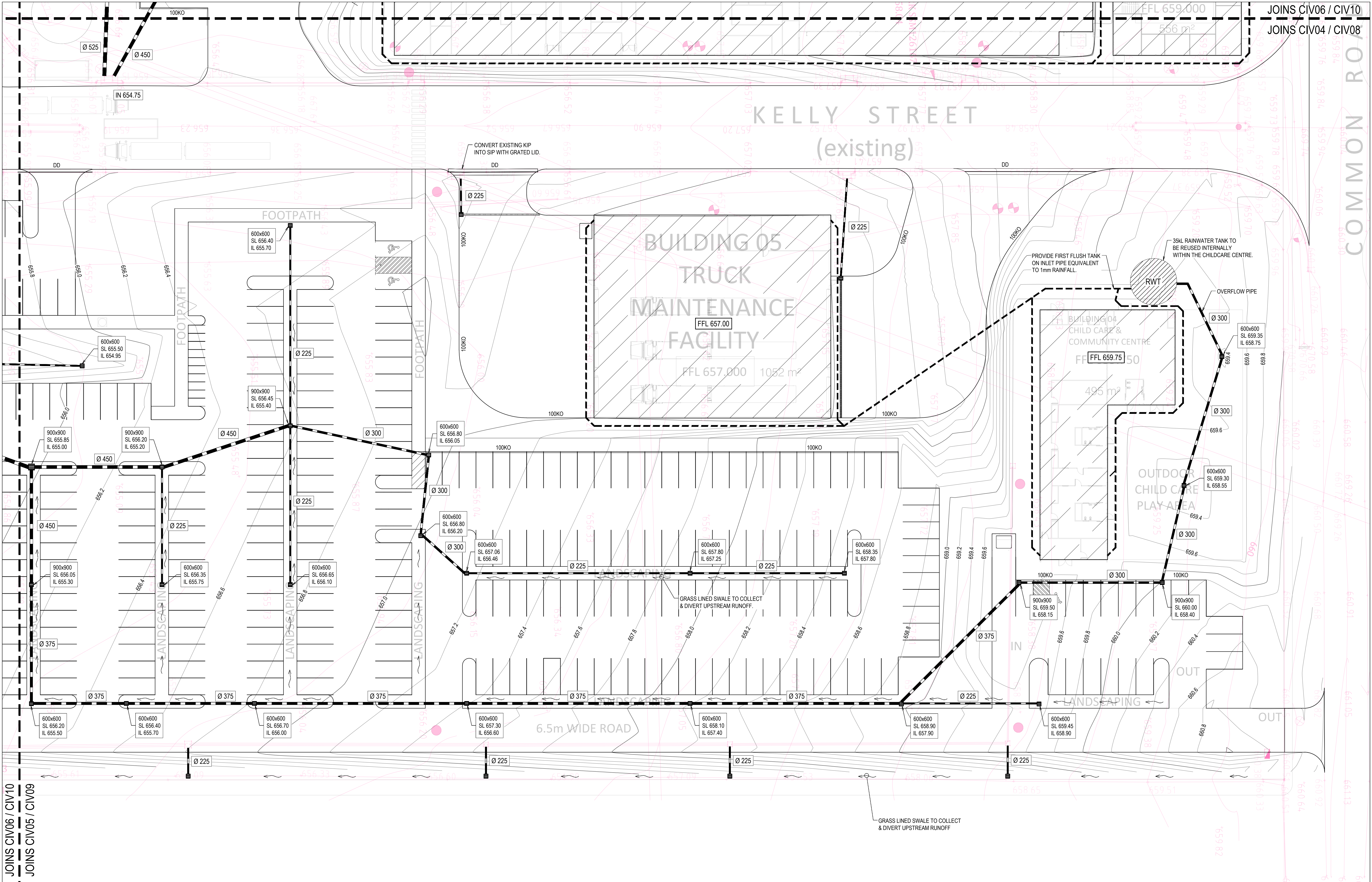

JOINS CIV06 / CIV10
JOINS CIV05 / CIV09

REV	REVISIONS					DRAWING STATUS
	DATE	DRN	CHK	APP		
A	27.11.19	R.F.	M.M.	M.M.	ISSUED FOR DA	

This drawing is not approved for construction unless signed.

Mathew McNamara
BEing (Civil) Hons MIE (Aust)

COPYRIGHT - This drawing and the information provided shall remain the property of DRB Consulting Engineers Pty Ltd (DRB) and may not be used, copied or reproduced, in whole or part, for any purpose other than that for which it was supplied without the prior consent of DRB.

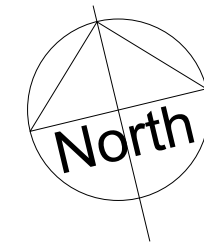

PO BOX 4105 Kotara East 2305
0402 915 549
ABN 64 625 755 482

DRB CONSULTING ENGINEERS

STORMWATER MANAGEMENT PLAN
PROPOSED PROCESSING FACILITY
52 SINCLAIR STREET,
GOULBURN
WOODLAND RIDGE POULTRY PTY LTD

DRAWING STATUS		SHEET SIZE
NOT FOR CONSTRUCTION		A1
		SCALE
		1:250
PROJECT REF No.	DRAWING No.	REVISION
180054	CIV06-2	A

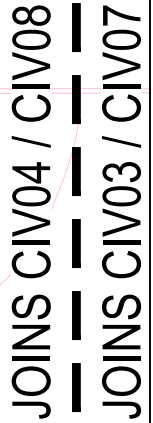

This drawing is not approved for construction unless signed.

Mathew McNamara
BEng (Civl) Hons MIE (Aust)

COPYRIGHT - This drawing and the information provided shall remain the property of DRB Consulting Engineers Pty Ltd (DRB) and may not be used, copied or reproduced, in whole or part, for any purpose other than that for which it was supplied without the prior consent of DRB.

Mathew McNamara
BEng (Civil) Hons MIE (Aust)



**CONSULTING
ENGINEERS**

DRAWING STATUS

DRAWING No.

SHEET SIZE

A1

SCALE
1:250

REVISION

JOINS CIV04 / CIV08
JOINS CIV03 / CIV07

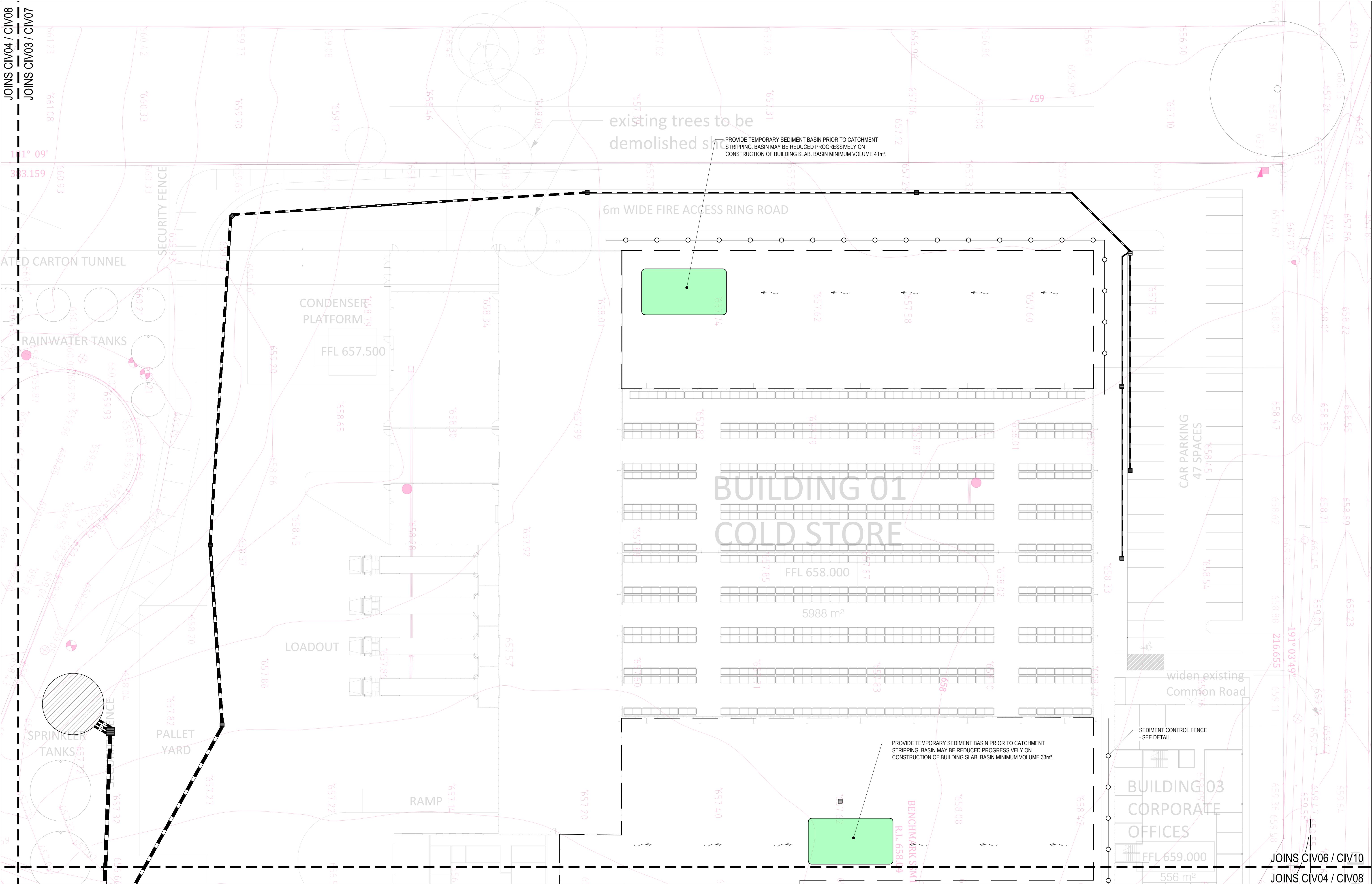

REVISIONS					
REV	DATE	DRN	CHK	APP	DRAWING STATUS
A	27.11.19	R.F.	M.M.	M.M.	ISSUED FOR DA

This drawing is not approved for construction unless signed.

Mathew McLennan
BEing (Civil) Hons MIE (Aust)

COPYRIGHT - This drawing and the information provided shall remain the property of DRB Consulting Engineers Pty Ltd (DRB) and may not be used, copied or reproduced, in whole or part, for any purpose other than that for which it was supplied without the prior consent of DRB.

PO BOX 4105 Kotara East 2305
0402 915 549
ABN 64 625 755 482

EROSION & SEDIMENT CONTROL PLAN
PROPOSED PROCESSING FACILITY
52 SINCLAIR STREET,
GOULBURN
WOODLAND RIDGE POULTRY PTY LTD

DRAWING STATUS		SHEET SIZE	
NOT FOR CONSTRUCTION		A1	
PROJECT REF No. 180054		SCALE 1:250	
DRAWING No. CIV08-2		REVISION A	

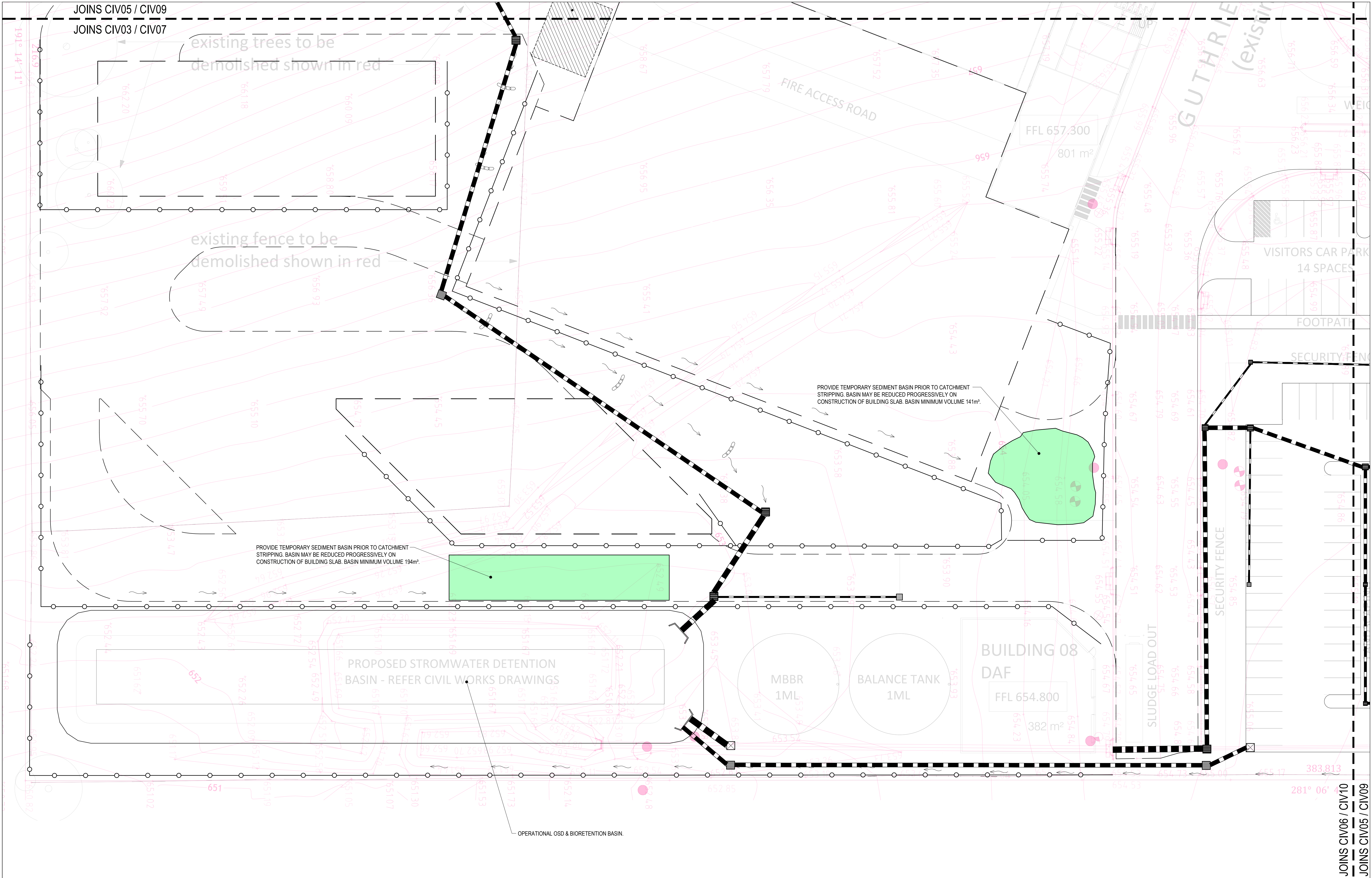

REV	REVISIONS					DRAWING STATUS
	DATE	DRN	CHK	APP		
A	27.11.19	R.F.	M.M.	M.M.	ISSUED FOR DA	

This drawing is not approved for construction unless signed.

Mathew McNamara
BEing (Civil) Hons MIE (Aust)

COPYRIGHT - This drawing and the information provided shall remain the property of DRB Consulting Engineers Pty Ltd (DRB) and may not be used, copied or reproduced, in whole or part, for any purpose other than that for which it was supplied without the prior consent of DRB.

PO BOX 4105 Kotara East 2305
0402 915 549
ABN 64 625 755 482

EROSION & SEDIMENT CONTROL PLAN
PROPOSED PROCESSING FACILITY
52 SINCLAIR STREET,
GOULBURN
WOODLAND RIDGE POULTRY PTY LTD

DRAWING STATUS		SHEET SIZE
NOT FOR CONSTRUCTION		A1
		SCALE 1:250
PROJECT REF No. 180054	DRAWING No. CIV09-2	REVISION A

SOIL AND WATER MANAGEMENT NOTES:

GENERAL

1.

ESCP REFERS TO EROSION AND SEDIMENT CONTROL PLAN OR A SOIL AND WATER MANAGEMENT PLAN (SWMP).
2.

ESC REFERS TO EROSION AND SEDIMENT CONTROL.
3.

SEDIMENT, INCLUDES, BUT IS NOT LIMITED TO, CLAY, SILT, SAND, GRAVEL, SOIL, MUD, CEMENT, AND CERAMIC WASTE.
4.

ANY REFERENCE TO THE BLUE BOOK REFERS TO MANAGING URBAN STORMWATER - SOILS AND CONSTRUCTION. LANDCOM, 2004.
5.

ANY REFERENCE TO THE IECA WHITE BOOKS (2008) REFERS TO IECA 2008. BEST PRACTICE EROSION AND SEDIMENT CONTROL. BOOKS 1-6.INTERNATIONAL EROSION CONTROL ASSOCIATION (AUSTRALASIA). PICTON NSW.
6.

ANY MATERIAL DEPOSITED IN ANY CONSERVATION AREA FROM WORKS ASSOCIATED WITH THE DEVELOPMENT SHALL BE REMOVED IMMEDIATELY BY MEASURES INVOLVING MINIMAL GROUND AND/OR VEGETATION DISTURBANCE AND NO MACHINERY, OR FOLLOWING DIRECTIONS BY COUNCIL AND/OR WITHIN A TIMEFRAME ADVISED BY COUNCIL.

THE ESCP

7.

THE ESCP AND ITS ASSOCIATED ESC MEASURES SHALL BE CONSTANTLY MONITORED, REVIEWED, AND MODIFIED AS REQUIRED TO CORRECT DEFICIENCIES. COUNCIL HAS THE RIGHT TO DIRECT CHANGES IF, IN ITS OPINION, THE MEASURES THAT ARE PROPOSED OR HAVE BEEN INSTALLED ARE INADEQUATE TO PREVENT POLLUTION.
8.

PRIOR TO ANY ACTIVITIES ONSITE, THE RESPONSIBLE PERSON(S) IS TO BE NOMINATED. THE RESPONSIBLE PERSON(S) SHALL BE RESPONSIBLE FOR THE ESC MEASURES ONSITE. THE NAME, ADDRESS AND 24 HOUR CONTACT DETAILS OF THE PERSON(S) SHALL BE PROVIDED TO COUNCIL IN WRITING. COUNCIL SHALL BE ADVISED WITHIN 48 HOURS OF ANY CHANGES TO THE RESPONSIBLE PERSON(S), OR THEIR CONTACT DETAILS, IN WRITING.
9.

AT LEAST 14 DAYS BEFORE THE NATURAL SURFACE IS DISTURBED IN ANY NEW STAGE, THE CONTRACTOR SHALL SUBMIT TO THE CERTIFIER, A PLAN SHOWING ESC MEASURES FOR THAT STAGE. THE DEGREE OF DESIGN DETAIL SHALL BE BASED ON THE DISTURBED AREA.
10.

AT ANY TIME DURING CONSTRUCTION, THE ESC MEASURES ONSITE SHALL BE APPROPRIATE FOR THE AREA OF DISTURBANCE AND ITS CHARACTERISTICS INCLUDING SOILS (IN ACCORDANCE WITH THOSE REQUIRED FOR THE SITE AS PER DCP).
11.

THE IMPLEMENTATION OF THE ESCP SHALL BE SUPERVISED BY PERSONNEL WITH APPROPRIATE QUALIFICATIONS AND/OR EXPERIENCE IN ESC ON CONSTRUCTION SITES.
12.

THE APPROVED ESCP SHALL BE AVAILABLE ON-SITE FOR INSPECTION BY COUNCIL OFFICERS WHILE WORK ACTIVITIES ARE OCCURRING.
13.

THE APPROVED ESCP SHALL BE UP TO DATE AND SHOW A TIMELINE OF INSTALLATION, MAINTENANCE AND REMOVAL OF ESC MEASURES.
14.

ALL ESC MEASURES SHALL BE APPROPRIATE FOR THE SEDIMENT TYPE(S) OF THE SOILS ONSITE, IN ACCORDANCE WITH THE BLUE BOOK, IECA WHITE BOOKS OR OTHER CURRENT RECOGNISED INDUSTRY STANDARD FOR ESC FOR AUSTRALIAN CONDITIONS.
15.

ADEQUATE SITE DATA, INCLUDING SOIL DATA FROM A NATA APPROVED LABORATORY, SHALL BE OBTAINED TO ALLOW THE PREPARATION OF AN APPROPRIATE ESCP, AND ALLOW THE SELECTION, DESIGN AND SPECIFICATION OF REQUIRED ESC MEASURES.
16.

ALL WORKS SHALL BE CARRIED OUT IN ACCORDANCE WITH THE APPROVED ESCP (AS AMENDED FROM TIME TO TIME) UNLESS CIRCUMSTANCES ARISE WHERE:
- a)

COMPLIANCE WITH THE ESCP WOULD INCREASE THE POTENTIAL FOR ENVIRONMENTAL HARM; OR
- b)

CIRCUMSTANCES CHANGE DURING CONSTRUCTION AND THOSE CIRCUMSTANCES COULD NOT HAVE BEEN FORESEEN; OR
- c)

COUNCIL DETERMINES THAT UNACCEPTABLE OFF-SITE SEDIMENTATION IS OCCURRING AS A RESULT OF A LAND-DISTURBING ACTIVITY. IN EITHER CASE, THE PERSON(S) RESPONSIBLE MAY BE REQUIRED TO TAKE ADDITIONAL, OR ALTERNATIVE PROTECTIVE ACTION, AND/OR UNDERTAKE REASONABLE RESTORATION WORKS WITHIN THE TIMEFRAME SPECIFIED BY THE COUNCIL.
17.

ADDITIONAL ESC MEASURES SHALL BE IMPLEMENTED, AND A REVISED ESCP SUBMITTED FOR APPROVAL TO THE CERTIFIER (WITHIN FIVE BUSINESS DAYS OF ANY SUCH AMENDMENTS) IN THE EVENT THAT:
- a)

THERE IS A HIGH PROBABILITY THAT SERIOUS OR MATERIAL ENVIRONMENTAL HARM MAY OCCUR AS A RESULT OF SEDIMENT LEAVING THE SITE; OR
- b)

THE IMPLEMENTED WORKS FAIL TO ACHIEVE COUNCIL'S WATER QUALITY OBJECTIVES SPECIFIED IN THESE CONDITIONS; OR
- c)

SITE CONDITIONS SIGNIFICANTLY CHANGE; OR
- d)

SITE INSPECTIONS INDICATE THAT THE IMPLEMENTED WORKS ARE FAILING TO ACHIEVE THE 'OBJECTIVE' OF THE ESCP.
18.

A COPY OF ANY AMENDED ESCP SHALL BE FORWARDED TO AN APPROPRIATE COUNCIL OFFICER, WITHIN FIVE BUSINESS DAYS OF ANY SUCH AMENDMENTS.

SITE ESTABLISHMENT INCLUDING CLEARING AND MULCHING

19.

NO LAND CLEARING SHALL BE UNDERTAKEN UNLESS PRECEDED BY THE INSTALLATION OF ADEQUATE DRAINAGE AND SEDIMENT CONTROL MEASURES, UNLESS SUCH CLEARING IS REQUIRED FOR THE PURPOSE OF INSTALLING SUCH MEASURES, IN WHICH CASE, ONLY THE MINIMUM CLEARING REQUIRED TO INSTALL SUCH MEASURES SHALL OCCUR.
20.

BULK TREE CLEARING AND GRUBBING OF THE SITE SHALL BE IMMEDIATELY FOLLOWED BY SPECIFIED TEMPORARY EROSION CONTROL MEASURES (E.G. TEMPORARY GRASSING OR MULCHING) PRIOR TO COMMENCEMENT OF EACH STAGE OF CONSTRUCTION WORKS.
21.

TREES AND VEGETATION CLEARED FROM THE SITE SHALL BE MULCHED ONSITE WITHIN 7 DAYS OF CLEARING.
22.

APPROPRIATE MEASURES SHALL BE UNDERTAKEN TO CONTROL ANY DUST ORIGINATING DUE TO THE MULCHING OF VEGETATION ONSITE.
23.

ALL OFFICE FACILITIES AND OPERATIONAL ACTIVITIES SHALL BE LOCATED SUCH THAT ANY EFFLUENT, INCLUDING WASH-DOWN WATER, CAN BE TOTALLY CONTAINED AND TREATED WITHIN THE SITE.
24.

ALL REASONABLE AND PRACTICABLE MEASURES SHALL BE TAKEN TO ENSURE STORMWATER RUNOFF FROM ACCESS ROADS AND STABILISED ENTRY/EXIT SYSTEMS, DRAINS TO AN APPROPRIATE SEDIMENT CONTROL DEVICE.
25.

SITE EXIT POINTS SHALL BE APPROPRIATELY MANAGED TO MINIMISE THE RISK OF SEDIMENT BEING TRACKED ONTO SEALED, PUBLIC ROADWAYS.
26.

STORMWATER RUNOFF FROM ACCESS ROADS AND STABILISED ENTRY/EXIT POINTS SHALL DRAIN TO AN APPROPRIATE SEDIMENT CONTROL DEVICE.
27.

THE APPLICANT SHALL ENSURE AN ADEQUATE SUPPLY OF ESC, AND APPROPRIATE POLLUTION CLEAN-UP MATERIALS ARE AVAILABLE ON-SITE AT ALL TIMES.
28.

ALL TEMPORARY EARTH BANKS, FLOW DIVERSION SYSTEMS, AND SEDIMENT BASIN EMBANKMENTS SHALL BE MACHINE-COMPACTED, SEEDED AND MULCHED WITHIN TEN (10) DAYS OF FORMATION FOR THE PURPOSE OF ESTABLISHING A VEGETATIVE COVER, OR LINED APPROPRIATELY.
29.

SEDIMENT DEPOSITED OFF SITE AS A RESULT OF ON-SITE ACTIVITIES SHALL BE COLLECTED AND THE AREA CLEANED/REHABILITATED AS SOON AS REASONABLE AND PRACTICABLE.
30.

CONCRETE WASTE AND CHEMICAL PRODUCTS, INCLUDING PETROLEUM AND OIL-BASED PRODUCTS, SHALL BE PREVENTED FROM ENTERING ANY INTERNAL OR EXTERNAL WATER BODY, OR ANY EXTERNAL DRAINAGE SYSTEM, EXCLUDING THOSE ON-SITE WATER BODIES SPECIFICALLY DESIGNED TO CONTAIN AND/OR TREAT SUCH MATERIAL. APPROPRIATE MEASURES SHALL BE INSTALLED TO TRAP THESE MATERIALS ONSITE.
31.

BRICK, TILE OR MASONRY CUTTING SHALL BE CARRIED OUT ON A PERVIOUS SURFACE (E.G. GRASS OR OPEN SOIL) AND IN SUCH A MANNER THAT ANY RESULTING SEDIMENT-LADEN RUNOFF IS PREVENTED FROM DISCHARGING INTO A GUTTER, DRAIN OR WATER. APPROPRIATE MEASURES SHALL BE INSTALLED TO TRAP THESE MATERIALS ONSITE.
32.

NEWLY SEALED HARD-STAND AREAS (E.G. ROADS, DRIVEWAYS AND CAR PARKS) SHALL BE SWEEP THOROUGHLY AS SOON AS PRACTICABLE AFTER SEALING/SURFACING TO MINIMISE THE RISK OF COMPONENTS OF THE SURFACING COMPOUND ENTERING STORMWATER DRAINS.
33.

STOCKPILES OF ERODIBLE MATERIAL SHALL BE PROVIDED WITH AN APPROPRIATE PROTECTIVE COVER (SYNTHETIC OR ORGANIC) IF THE MATERIALS ARE LIKELY TO BE STOCKPILED FOR MORE THAN 10 DAYS.
34.

STOCKPILES, TEMPORARY OR PERMANENT, SHALL NOT BE LOCATED IN AREAS IDENTIFIED AS NO-GO ZONES (INCLUDING, BUT NOT LIMITED TO, RESTRICTED ACCESS AREAS, BUFFER ZONES, OR AREAS OF NON-DISTURBANCE) ON THE ESCP.
35.

NO MORE THAN 150M OF A STORMWATER, SEWER LINE OR OTHER SERVICE TRENCH SHALL TO BE OPEN AT ANY ONE TIME.
36.

SITE SPOIL SHALL BE LAWFULLY DISPOSED OF IN A MANNER THAT DOES NOT RESULT IN ONGOING SOIL EROSION OR ENVIRONMENTAL HARM.
37.

WHEREVER REASONABLE AND PRACTICABLE, STORMWATER RUNOFF ENTERING THE SITE FROM EXTERNAL AREAS, AND NON-SEDIMENT LADEN (CLEAN) STORMWATER RUNOFF ENTERING A WORK AREA OR AREA OF SOIL DISTURBANCE, SHALL BE DIVERTED AROUND OR THROUGH THAT AREA IN A MANNER THAT MINIMISES SOIL EROSION AND THE CONTAMINATION OF THAT WATER FOR ALL DISCHARGES UP TO THE SPECIFIED DESIGN STORM DISCHARGE.

SITE MANAGEMENT INCLUDING DUST

38.

PRIORITY SHALL BE GIVEN TO THE PREVENTION, OR AT LEAST THE MINIMISATION, OF SOIL EROSION, RATHER THAN THE TRAPPING OF DISPLACED SEDIMENT. SUCH A CLAUSE SHALL NOT REDUCE THE RESPONSIBILITY TO APPLY AND MAINTAIN, AT ALL TIMES, ALL NECESSARY ESC MEASURES.
39.

MEASURES USED TO CONTROL WIND EROSION SHALL BE APPROPRIATE FOR THE LOCATION AND PREVENT SOIL EROSION AT ALL TIMES, INCLUDING WORKING HOURS, OUT OF HOURS, WEEKENDS, PUBLIC HOLIDAYS, AND DURING ANY OTHER SHUTDOWN PERIODS.
40.

THE APPLICATION OF LIQUID OR CHEMICAL-BASED DUST SUPPRESSION MEASURES SHALL ENSURE THAT SEDIMENT-LADEN RUNOFF RESULTING FROM SUCH MEASURES DOES NOT CREATE A TRAFFIC OR ENVIRONMENTAL HAZARD.
41.

ALL CUT AND FILL EARTH BATTERS LESS THAN 3M IN ELEVATION SHALL BE TOPSOILED, AND GRASS SEEDED/HYDROMULCHED WITHIN 10 DAYS OF COMPLETION OF GRADING IN CONSULTATION WITH COUNCIL.
42.

ONCE CUT/FILL OPERATIONS HAVE BEEN FINALISED IN A SECTION, ALL DISTURBED AREAS THAT ARE NOT BEING WORKED ON SHALL BE STABILISED IN ACCORDANCE WITH TIME LINES IN THE BLUE BOOK.
43.

ALL REASONABLE AND PRACTICABLE MEASURES SHALL BE TAKEN TO PREVENT, OR AT LEAST MINIMISE, THE RELEASE OF SEDIMENT FROM THE SITE.
44.

SUITABLE ALL-WEATHER MAINTENANCE ACCESS SHALL BE PROVIDED TO ALL SEDIMENT CONTROL DEVICES.
45.

SEDIMENT CONTROL DEVICES, OTHER THAN SEDIMENT BASINS, SHALL BE DE-SILTED AND MADE FULLY OPERATIONAL AS SOON AS REASONABLE AND PRACTICABLE AFTER A SEDIMENT-PRODUCING EVENT, WHETHER NATURAL OR ARTIFICIAL, IF THE DEVICE'S SEDIMENT RETENTION CAPACITY FALLS BELOW 75% OF ITS DESIGN RETENTION CAPACITY.
46.

ALL EROSION AND SEDIMENT CONTROL MEASURES, INCLUDING DRAINAGE CONTROL MEASURES, SHALL BE MAINTAINED IN PROPER WORKING ORDER AT ALL TIMES DURING THEIR OPERATIONAL LIVES.
47.

WASHING/FLUSHING OF SEALED ROADWAYS SHALL ONLY OCCUR WHERE SWEEPING HAS FAILED TO REMOVE SUFFICIENT SEDIMENT AND THERE IS A COMPELLING NEED TO REMOVE THE REMAINING SEDIMENT (E.G. FOR SAFETY REASONS). IN SUCH CIRCUMSTANCES, ALL REASONABLE AND PRACTICABLE SEDIMENT CONTROL MEASURES SHALL BE USED TO PREVENT, OR AT LEAST MINIMISE, THE RELEASE OF SEDIMENT INTO RECEIVING WATERS. ONLY THOSE MEASURES THAT WILL NOT CAUSE SAFETY AND PROPERTY FLOODING ISSUES SHALL BE EMPLOYED. SEDIMENT REMOVED FROM ROADWAYS SHALL BE DISPOSED OF IN A LAWFUL MANNER THAT DOES NOT CAUSE ONGOING SOIL EROSION OR ENVIRONMENTAL HARM.
48.

SEDIMENT REMOVED FROM SEDIMENT TRAPS AND PLACES OF SEDIMENT DEPOSITION SHALL BE DISPOSED OF IN A LAWFUL MANNER THAT DOES NOT CAUSE ONGOING SOIL EROSION OR ENVIRONMENTAL HARM.

SEDIMENT BASINS - INSTALLATION, MAINTENANCE AND REMOVAL INCLUDING SEDIMENT TRAPS

49.

AS-CONSTRUCTED PLANS SHALL BE PREPARED FOR ALL CONSTRUCTED SEDIMENT BASINS AND ASSOCIATED EMERGENCY SPILLWAYS. SUCH PLANS SHALL VERIFY THE BASIN'S DIMENSIONS, LEVELS AND VOLUMES COMPLY WITH THE APPROVED DESIGN DRAWINGS. THESE PLANS MAY BE REQUESTED BY THE CERTIFIER OR COUNCIL.
50.

SEDIMENT BASINS SHALL BE CONSTRUCTED AND FULLY OPERATIONAL PRIOR TO ANY OTHER SOIL DISTURBANCE IN THEIR CATCHMENT.
51.

INSTALL AN INTERNAL GATED VALVE, OR SIMILAR, IN ANY OUTLET PIPE ONCE PIPES INSTALLED, OR INSTALL A SACRIFICIAL PIPE FROM BASIN THROUGH WALL TO EXTERNAL OUTLET POINT. THE VALVE SHALL BE CONNECTED TO A RISER MADE FROM SLOTTED PIPE IN THE BASIN. THE VALVE MAY BE OPENED ONCE CAPTURED WATER MEETS WATER QUALITY REQUIREMENTS. THE FINAL SETUP FOR TEMPORARY INTERNAL OUTLET STRUCTURES TO BE CONFIRMED PRIOR TO CONSTRUCTION WITH COUNCIL. THIS SETUP WILL ENABLE DISCHARGE OF TREATED WATER FROM SITE WITHOUT NEED FOR PUMPING.
52.

A SEDIMENT STORAGE LEVEL MARKER POST SHALL BE WITH A CROSS MEMBER SET JUST BELOW THE TOP OF THE SEDIMENT STORAGE ZONE (AS SPECIFIED ON THE APPROVED ESCP). AT LEAST A 75MM WIDE POST SHALL BE FIRMLY SET INTO THE BASIN FLOOR.
53.

THE SITE MANAGER SHALL OBTAIN THE RELEVANT APPROVALS FROM THE RELEVANT ORGANISATIONS TO DISCHARGE TREATED WATER FROM ANY EXISTING BASINS. ORGANISATIONS MAY INCLUDE, BUT NOT BE LIMITED TO, HUNTER WATER, AND COUNCIL.
54.

WHERE MORE THAN ONE STAGE IS TO BE DEVELOPED AT ONE TIME, OR BEFORE THE PRECEDING STAGE IS COMPLETE, THE SEDIMENT BASIN(S) FOR THESE STAGES SHALL HAVE SUFFICIENT CAPACITY TO CATER FOR ALL AREA DIRECTED TO THE BASIN(S).
55.

PRIOR TO ANY FORECAST WEATHER EVENT LIKELY TO RESULT IN RUNOFF, ANY BASINS/TRAPS SHALL BE DEWATERED TO PROVIDE SUFFICIENT CAPACITY TO CAPTURE SEDIMENT LADEN WATER FROM THE SITE.
56.

SUFFICIENT QUANTITIES OF CHEMICALS/AGENTS TO TREAT CAPTURED WATER SHALL BE PLACED SUCH THAT WATER ENTERING THE BASIN MIXES WITH THE CHEMICALS/AGENTS AND IS CARRIED INTO THE BASIN TO SPEED UP CLARIFICATION.
57.

ANY BASIN SHALL BE DEWATERED WITHIN THE 5-DAY RAINFALL DEPTH USED TO CALCULATE THE CAPACITY OF THE BASIN, AFTER A RAINFALL EVENT.
58.

SUFFICIENT QUANTITIES OF CHEMICALS/AGENTS TO TREAT TURBID WATER SHALL BE SECURELY STORED ON-SITE TO PROVIDE FOR AT LEAST THREE COMPLETE TREATMENTS OF ALL BASINS REQUIRING CHEMICAL/TREATMENT ONSITE.
59.

PRIOR TO THE CONTROLLED DISCHARGE (E.G. DE-WATERING ACTIVITIES) FROM EXCAVATIONS AND/OR SEDIMENT BASINS, THE FOLLOWING WATER QUALITY OBJECTIVES SHALL BE ACHIEVED:
- a)

TOTAL SUSPENDED SOLIDS (TSS) TO A MAXIMUM 50MG/L;
- b)

WATER PH BETWEEN 6.5 AND 7.5, UNLESS OTHERWISE REQUIRED BY THE COUNCIL;
- c)

TURBIDITY (MEASURED IN NTUS) TO A MAXIMUM OF 25 NTU); AND
- d)

EC LEVELS NO GREATER THAN BACKGROUND LEVELS (<350 μ S/cm);
- e)

DISSOLVED OXYGEN LEVELS 90 - 110%;
- f)

TOTAL PHOSPHOROUS (TP) 20 mg/L;
- g)

TOTAL NITROGEN (TN) 250 mg/L;
- h)

VISUAL AMENITY - REFER TO WATER MANAGEMENT PLAN 180054/REV C.
60.

THE DEVELOPMENT APPROVAL MAY REQUIRE TESTING OF ADDITIONAL WATER QUALITY ELEMENTS PRIOR TO DISCHARGE. E.G. HEAVY METALS.
61.

A SAMPLE OF THE RELEASED TREATED WATER SHALL BE KEPT ONSITE IN A CLEAR CONTAINER WITH THE SAMPLE DATE RECORDED ON IT.
62.

WATER QUALITY SAMPLES SHALL BE TAKEN AT A DEPTH NO LESS THAN 200MM BELOW THE WATER SURFACE OF THE BASIN.
63.

NO ALUMINIUM BASED PRODUCTS MAY BE USED TREAT CAPTURED WATER ONSITE WITHOUT THE PRIOR WRITTEN PERMISSION FROM AN APPROPRIATE COUNCIL OFFICER. THE APPLICANT SHALL HAVE A DEMONSTRATED ABILITY TO USE SUCH PRODUCTS CORRECTLY AND WITHOUT ENVIRONMENTAL HARM PRIOR TO ANY APPROVAL.
64.

THE CHEMICAL/AGENT USED IN TYPE D BASINS TO TREAT CAPTURED WATER CAPTURED IN THE BASIN SHALL BE APPLIED IN CONCENTRATIONS SUFFICIENT TO ACHIEVE COUNCIL'S WATER QUALITY OBJECTIVES WITHIN THE 5-DAY RAINFALL DEPTH USED TO CALCULATE THE CAPACITY OF THE BASIN, AFTER A RAINFALL EVENT.
65.

ALL MANUFACTURERS' INSTRUCTIONS SHALL BE FOLLOWED FOR ANY CHEMICALS/AGENTS USED ONSITE, EXCEPT WHERE APPROVED BY THE RESPONSIBLE PERSON OR AN APPROPRIATE COUNCIL OFFICER.
66.

THE APPLICANT SHALL ENSURE THAT ON EACH OCCASION A TYPE D BASIN WAS NOT DE-WATERED PRIOR TO BEING SURCHARGED BY A FOLLOWING RAINFALL EVENT, A REPORT IS PRESENTED TO AN APPROPRIATE COUNCIL OFFICER WITHIN 5 DAYS IDENTIFYING THE CIRCUMSTANCES AND PROPOSED AMENDMENTS, IF ANY, TO THE BASIN'S OPERATING PROCEDURES.
67.

SETTLED SEDIMENT SHALL BE REMOVED AS SOON AS REASONABLE AND PRACTICABLE FROM ANY SEDIMENT BASIN IF:
- a)

IT IS ANTICIPATED THAT THE NEXT STORM EVENT IS LIKELY TO CAUSE SEDIMENT TO SETTLE ABOVE THE BASIN'S SEDIMENT STORAGE ZONE; OR
- b)

THE ELEVATION OF SETTLED SEDIMENT IS ABOVE THE TOP OF THE BASIN'S SEDIMENT STORAGE ZONE; OR
- c)

THE ELEVATION OF SETTLED SEDIMENT IS ABOVE THE BASIN'S SEDIMENT MARKER LINE.
68.

SCOUR PROTECTION MEASURES PLACED ON SEDIMENT BASIN EMERGENCY SPILLWAYS SHALL APPROPRIATELY PROTECT THE SPILLWAY CHUTE AND ITS SIDE BATTERS FROM SCOUR, AND SHALL EXTEND A MINIMUM OF 3M BEYOND THE DOWNSTREAM TOE OF THE BASIN'S EMBANKMENT.
69.

SUITABLE ALL-WEATHER MAINTENANCE ACCESS SHALL BE PROVIDED TO ALL SEDIMENT CONTROL DEVICES.
70.

MATERIALS, WHETHER LIQUID OR SOLID, REMOVED FROM ANY ESC MEASURES DURING MAINTENANCE OR DECOMMISSIONING, SHALL BE DISPOSED OF IN A MANNER THAT DOES NOT CAUSE ONGOING SOIL EROSION OR ENVIRONMENTAL HARM.
71.

ALL SEDIMENT BASINS SHALL REMAIN FULLY OPERATIONAL AT ALL TIMES UNTIL THE BASIN'S DESIGN CATCHMENT ACHIEVES 70% GROUND COVER OR SURFACE STABILISATION ACCEPTABLE TO COUNCIL.
72.

THE ESC MEASURES INSTALLED DURING THE DECOMMISSIONING AND REHABILITATION OF A SEDIMENT BASIN SHALL COMPLY WITH SAME STANDARDS SPECIFIED FOR THE NORMAL CONSTRUCTION WORKS.
73.

A SEDIMENT BASIN SHALL NOT BE DECOMMISSIONED UNTIL ALL UP-SLOPE SITE STABILISATION MEASURES HAVE BEEN IMPLEMENTED AND ARE APPROPRIATELY WORKING TO CONTROL SOIL EROSION AND SEDIMENT RUNOFF.
74.

IMMEDIATELY PRIOR TO THE CONSTRUCTION OF THE PERMANENT STORMWATER TREATMENT DEVICE, APPROPRIATE FLOW BYPASS CONDITIONS SHALL BE ESTABLISHED TO PREVENT SEDIMENT-LADEN WATER ENTERING THE DEVICE.

REVEGETATION/STABILISATION

75.

TEMPORARY STABILISATION MAY BE ATTAINED USING VEGETATION, NON RETWETTABLE SOIL POLYMERS, OR PNEUMATICALLY APPLIED EROSION CONTROLS.
76.

ALL CUT AND FILL EARTH BATTERS LESS THAN 3M IN ELEVATION SHALL BE TOPSOILED, AND GRASS SEEDED/HYDROMULCHED WITHIN 10 DAYS OF COMPLETION OF GRADING IN CONSULTATION WITH COUNCIL.
77.

ONCE CUT/FILL OPERATIONS HAVE BEEN FINALISED IN A SECTION, ALL DISTURBED AREAS THAT ARE NOT BEING WORKED ON SHALL BE STABILISED IN ACCORDANCE WITH TIME LINES IN THE BLUE BOOK.
78.

THE LMCC SEED MIX SHALL BE USED UNLESS STATED ON THE ESCP/SWMP.
79.

THE PH LEVEL OF TOPSOIL SHALL BE APPROPRIATE TO ENABLE ESTABLISHMENT AND GROWTH OF SPECIFIED VEGETATION PRIOR TO INITIATING THE ESTABLISHMENT OF VEGETATION.
80.

NON RETWETTABLE BINDER SHALL BE USED IN ALL HYDROMULCH/HYDROSEED/POLYMER MIXES ON SLOPES OR WORKS ADJACENT TO A WATER COURSE.
81.

SOIL AMELIORANTS SHALL BE ADDED TO THE SOIL IN ACCORDANCE WITH AN APPROVED LANDSCAPE PLAN, VEGETATION MANAGEMENT PLAN, AND/OR SOIL ANALYSIS.
82.

SURFACE SOIL DENSITY, COMPACTION AND SURFACE ROUGHNESS SHALL BE ADJUSTED PRIOR TO SEEDING/PLANTING IN ACCORDANCE WITH AN APPROVED LANDSCAPE PLAN, VEGETATION MANAGEMENT PLAN, AND/OR SOIL ANALYSIS.
83.

PROCEDURES FOR INITIATING A SITE SHUTDOWN, WHETHER PROGRAMMED OR UN-PROGRAMMED, SHALL INCORPORATE REVEGETATION OF ALL SOIL DISTURBANCES UNLESS OTHERWISE APPROVED BY COUNCIL. THE STABILISATION WORKS SHALL NOT RELY UPON THE LONGEVITY OF NON-VEGETATED EROSION CONTROL BLANKETS, OR TEMPORARY SOIL BINDERS.

SITE MONITORING AND MAINTENANCE

84.

THE APPLICANT SHALL ENSURE THAT APPROPRIATE PROCEDURES AND SUITABLY QUALIFIED PERSONNEL ARE ENGAGED TO PLAN AND CONDUCT SITE INSPECTIONS AND WATER QUALITY MONITORING THROUGHOUT THE CONSTRUCTION AND MAINTENANCE PHASE.
85.

ALL ESC MEASURES SHALL BE INSPECTED AND ANY MAINTENANCE UNDERTAKEN IMMEDIATELY:
- a)

AT LEAST DAILY (WHEN WORK IS OCCURRING ON-SITE); AND
- b)

AT LEAST WEEKLY (WHEN WORK IS NOT OCCURRING ON-SITE); AND
- c)

WITHIN 24HRS OF EXPECTED RAINFALL; AND
- d)

WITHIN 18HRS OF A RAINFALL EVENT THAT CAUSES RUNOFF ON THE SITE.
86.

WRITTEN RECORDS SHALL BE KEPT ONSITE OF ESC MONITORING AND MAINTENANCE ACTIVITIES CONDUCTED DURING THE CONSTRUCTION AND MAINTENANCE PERIODS, AND BE AVAILABLE TO COUNCIL OFFICERS ON REQUEST.
87.

ALL ENVIRONMENTALLY RELEVANT INCIDENTS SHALL BE RECORDED IN A FIELD LOG THAT SHALL REMAIN ACCESSIBLE TO ALL RELEVANT REGULATORY AUTHORITIES.
88.

ALL WATER QUALITY DATA, INCLUDING DATES OF RAINFALL, DATES OF TESTING, TESTING RESULTS AND DATES OF WATER RELEASE, SHALL BE KEPT IN AN ON-SITE REGISTER. THE REGISTER IS TO BE MAINTAINED UP TO DATE FOR THE DURATION OF THE APPROVED WORKS AND BE AVAILABLE ON-SITE FOR INSPECTION BY [INSERT NAME OF REGULATORY AUTHORITY] ON REQUEST.
89.

AT NOMINATED INSTREAM WATER MONITORING SITES, A MINIMUM OF 3 WATER SAMPLES SHALL BE TAKEN AND ANALYSED, AND THE AVERAGE RESULT USED TO DETERMINE QUALITY.

INSTREAM WORKS

90.

ALL INSTREAM WORKS (INCLUDING IN OR ADJACENT TO WATERCOURSES NATURAL OR MANMADE, FLOWING OR NOT) SHALL BE CARRIED OUT IN ACCORDANCE WITH THE IECA WHITE BOOKS.

REVISIONS							This drawing is <u>not</u> approved for construction unless signed.	<div>PO BOX 4105 Kotara East 2305</div> <div>0402 915 549</div> <div>ABN 64 625 755 482</div> <div><div><div></div></div><div>CONSULTING ENGINEERS</div></div>	STORMWATER MANAGEMENT PLAN PROPOSED PROCESSING FACILITY 52 SINCLAIR STREET, GOULBURN WOODLAND RIDGE POULTRY PTY LTD	DRAWING STATUS		SHEET SIZE
	E	27.11.19	R.F.	M.M.	M.M.	RE-ISSUED FOR DA				NOT FOR CONSTRUCTION		A1
	D	14.06.19	R.F.	M.M.	M.M.	RE-ISSUED FOR DA				SCALE		-
	C	04.04.19	R.F.	M.M.	M.M.	ISSUED FOR DA				PROJECT REF No.	DRAWING No.	REVISION
	B	20.03.19	R.F.	M.M.	M.M.	DRAFT DA						
	A	20.02.19	R.F.	M.M.	M.M.	ISSUED FOR COORDINATION						
	REV	DATE	DRN	CHK	APP	DRAWING STATUS						
COPYRIGHT - This drawing and the information provided shall remain the property of DRB Consulting Engineers Pty Ltd (DRB) and may not be used, copied or reproduced, in whole or part, for any purpose other than that for which it was supplied without the prior consent of DRB.												

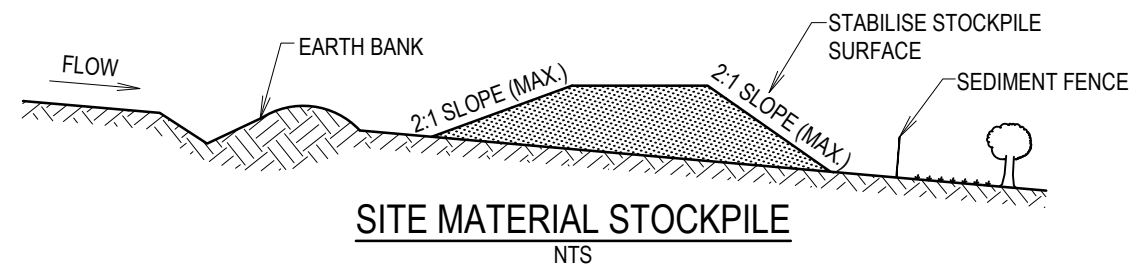
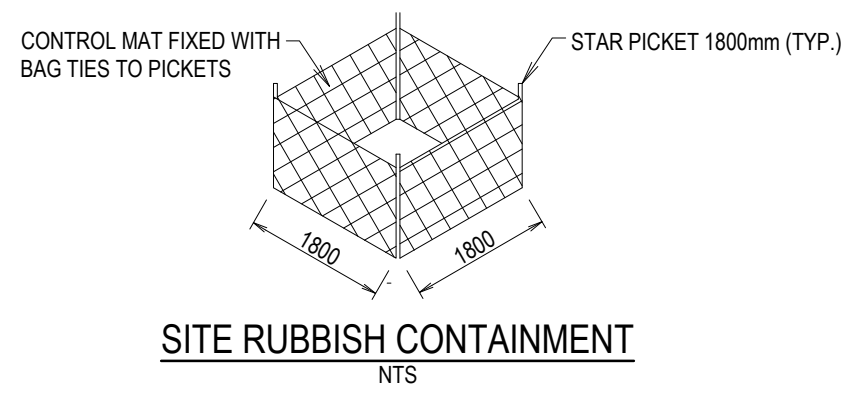
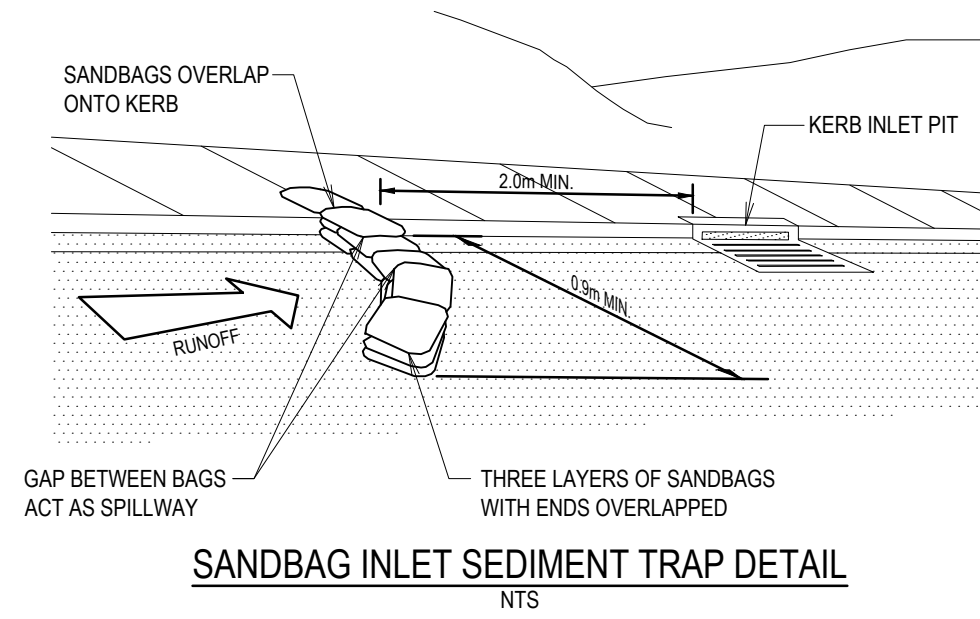

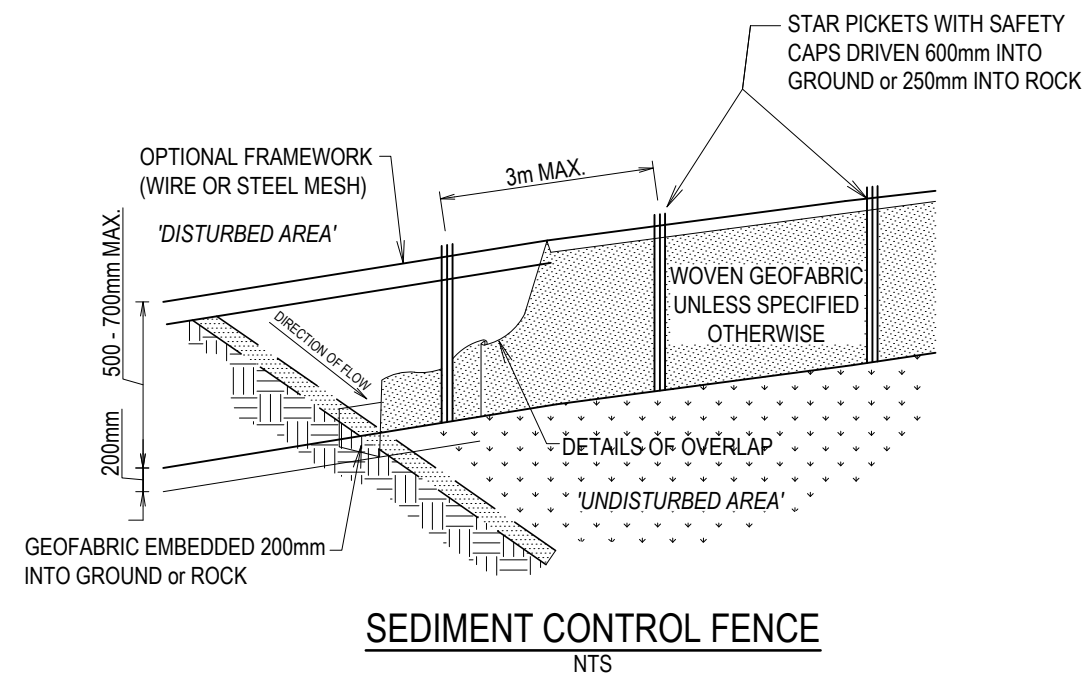

- CONSTRUCTION NOTES:**
1. LOCATE STOCKPILE AT LEAST 5 METRES FROM EXISTING VEGETATION, CONCENTRATED WATER FLOWS, ROADS AND HAZARD AREAS.
 2. CONSTRUCT ON THE CONTOUR AS A LOW, FLAT, ELONGATED MOUND.
 3. WHERE THERE IS SUFFICIENT AREA, TOPSOIL STOCKPILES SHALL BE LESS THAN 2 METRES IN HEIGHT.
 4. CONSTRUCT CATCH DRAIN ON THE UPSLOPE SIDE TO DIVERT RUN OFF AROUND THE STOCKPILE AND A SEDIMENT FENCE 1 TO 2 METRES DOWNSLOPE OF STOCKPILE.

NOTE : TOPSOIL MATERIAL TO BE APPROVED BY PRINCIPAL DURING BULK EARTHWORKS

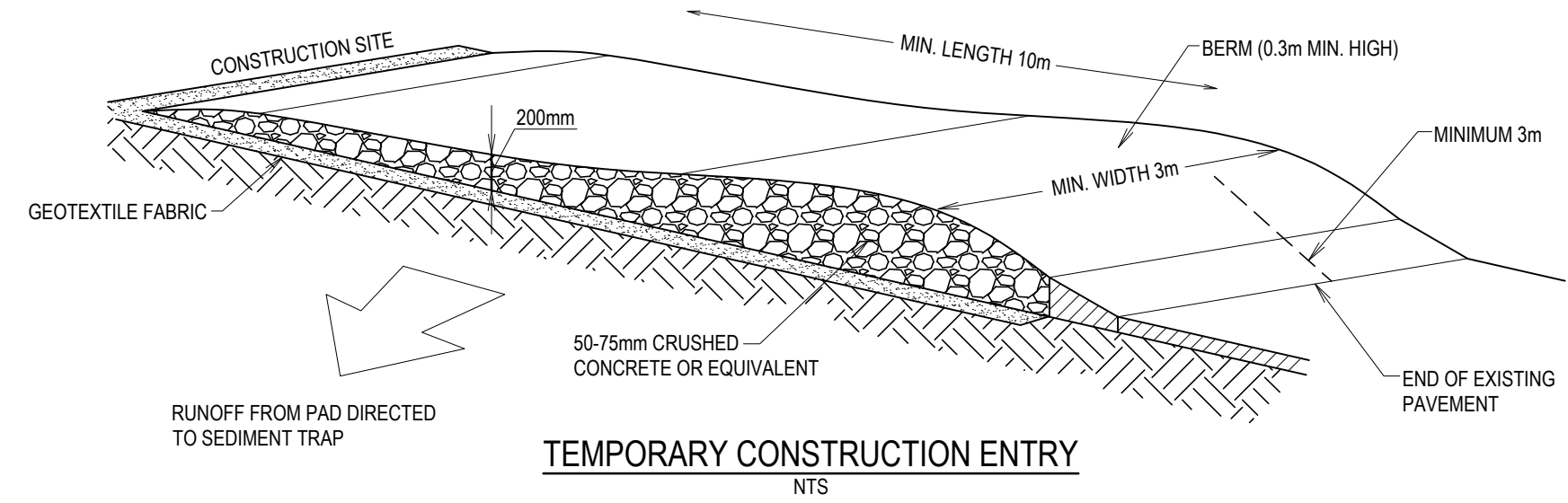

- NOTES:**
1. THE SEDIMENTATION & EROSION CONTROL DETAILS SHOWN ON THE PLANS MUST BE MAINTAINED AT ALL TIMES UNTIL CONSTRUCTION HAS MADE THEM REDUNDANT.
 2. WHEN STOCKPILES OR BALES ARE SHOWN, AND REQUIRE TEMPORARY REMOVAL FOR CONSTRUCTION, THEY MUST BE REINSTITED PRIOR TO CONCLUSION OF THE DAY'S WORK.
 3. THE BUILDER WILL APPOINT AN OFFICER/SUPERVISOR TO BE RESPONSIBLE FOR ENSURING MAINTENANCE & REINSTATEMENT OF CONTROLS. THE OFFICER MUST BE FAMILIAR WITH THE REQUIREMENTS OF THE NSW LANDCOM 'MANAGING URBAN STORMWATER - SOILS & CONSTRUCTION' (2004).



REVISIONS										This drawing is <u>not</u> approved for construction unless signed.	<div>PO BOX 4105 Kotara East 2305 0402 915 549 ABN 64 625 755 482</div> <div></div>	EROSION & SEDIMENT CONTROL DETAILS PROPOSED PROCESSING FACILITY 52 SINCLAIR STREET, GOULBURN WOODLAND RIDGE POULTRY PTY LTD	DRAWING STATUS		SHEET SIZE	
														A1		
														SCALE		
														NTS		
														REVISION		
														B		
B	04.04.19	R.F.	M.M.	M.M.	ISSUED FOR DA					Mathew McNamara BEng (Civil) Hons MIE (Aust)			PROJECT REF No.	DRAWING No.		
A	20.03.19	R.F.	M.M.	M.M.	DRAFT DA					COPYRIGHT - This drawing and the information provided shall remain the property of DRB Consulting Engineers Pty Ltd (DRB) and may not be used, copied or reproduced, in whole or part, for any purpose other than that for which it was supplied without the prior consent of DRB.			180054	CIV12	B	
REV	DATE	DRN	CHK	APP	DRAWING STATUS											

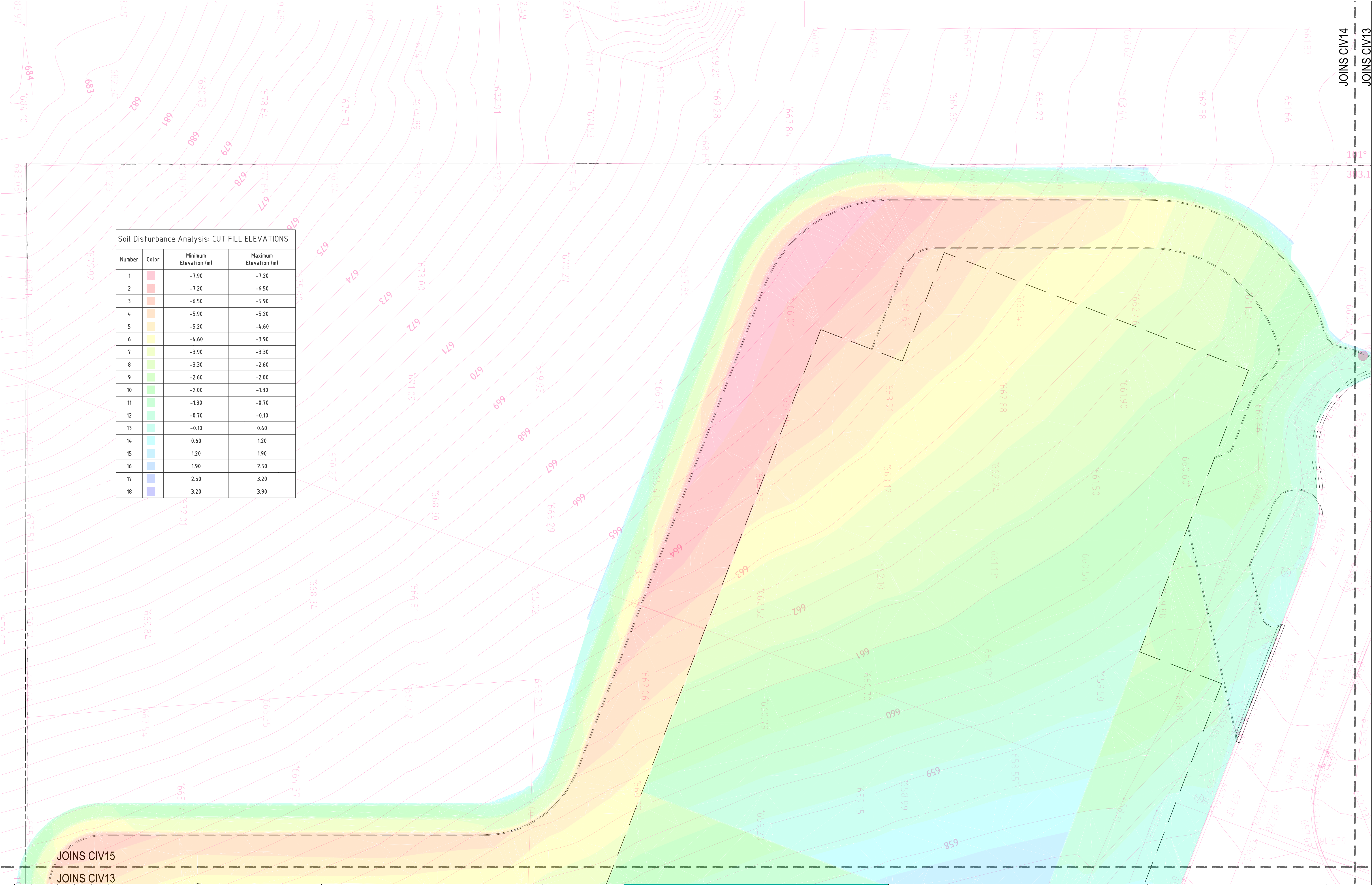

REV	DATE	DRN	CHK	APP	DRAWING STATUS
B	27.11.19	R.F.	M.M.	M.M.	RE-ISSUED DA
A	12.08.19	R.F.	M.M.	M.M.	ISSUED DA

This drawing is not approved for construction unless signed.

Mathew McNamara
BEing (Civil) Hons MIE (Aust)

COPYRIGHT - This drawing and the information provided shall remain the property of DRB Consulting Engineers Pty Ltd (DRB) and may not be used, copied or reproduced, in whole or part, for any purpose other than that for which it was supplied without the prior consent of DRB.

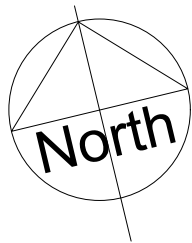

PO BOX 4105 Kotara East 2305

0402 915 549

ABN 64 625 755 482

CONSULTING
ENGINEERS

STORMWATER MANAGEMENT PLAN
PROPOSED PROCESSING FACILITY
52 SINCLAIR STREET,
GOULBURN
WOODLAND RIDGE POULTRY PTY LTD

DRAWING STATUS		SHEET SIZE
NOT FOR CONSTRUCTION		A1
		SCALE 1:250
PROJECT REF No. 180054	DRAWING No. CIV13	REVISION B

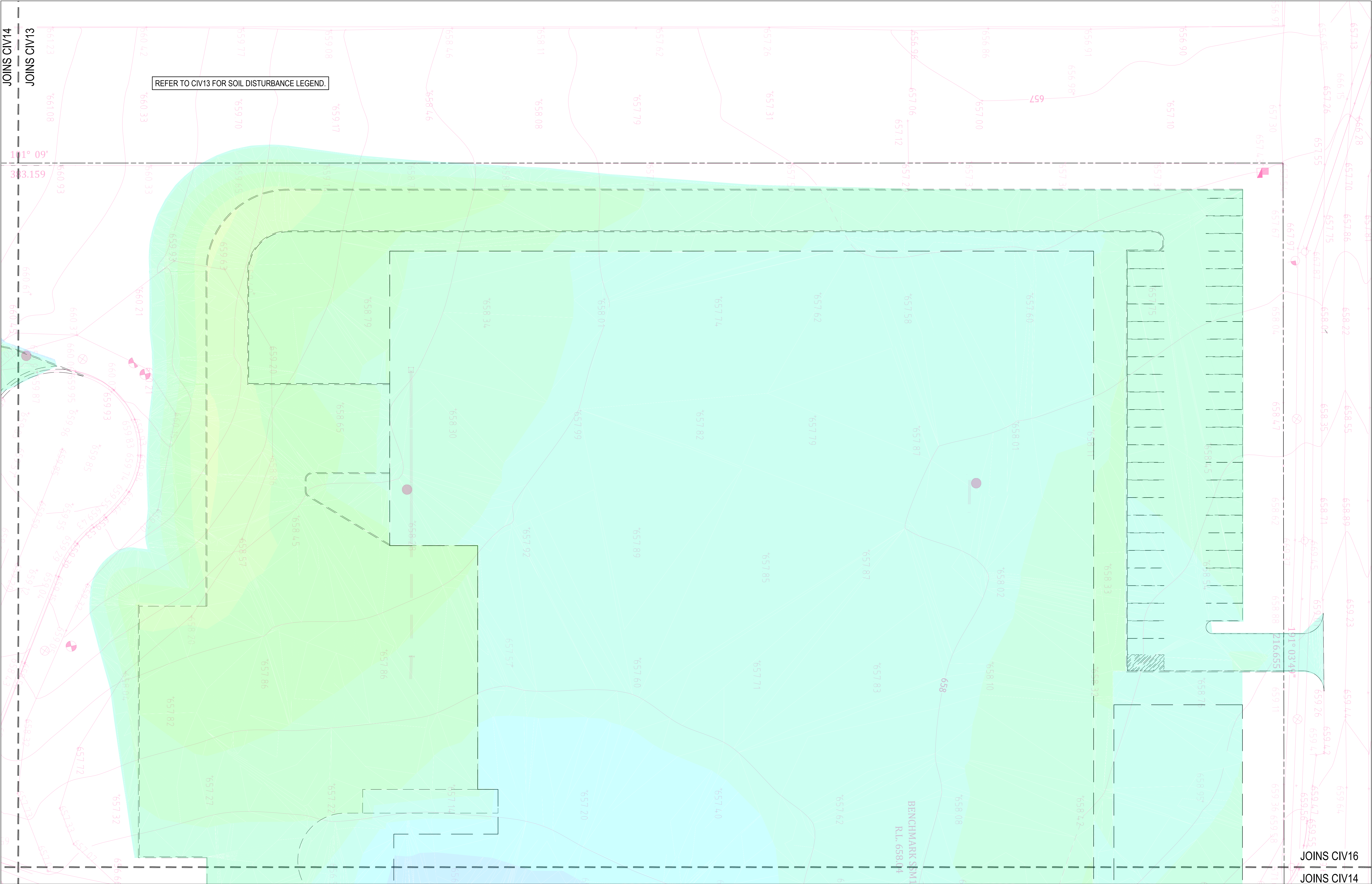

REV	DATE	DRN	CHK	APP	DRAWING STATUS
B	27.11.19	R.F.	M.M.	M.M.	RE-ISSUED FOR DA
A	12.08.19	R.F.	M.M.	M.M.	ISSUED FOR DA

This drawing is **not** approved for construction unless signed.

Mathew McLennan
BEing (Civil) Hons MIE (Aust)

Copyright

- This drawing and the information provided shall remain the property of DRB Consulting Engineers Pty Ltd (DRB) and may not be used, copied or reproduced, in whole or part, for any purpose other than that for which it was supplied without the prior consent of DRB.

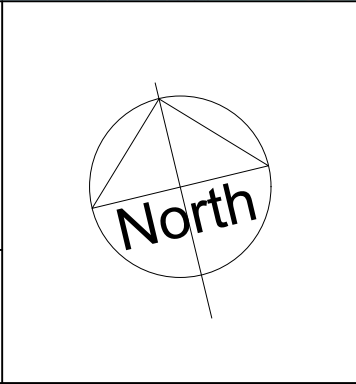

PO BOX 4105 Kotara East 2305
0402 915 549
ABN 64 625 755 482

DRB

CONSULTING ENGINEERS

STORMWATER MANAGEMENT PLAN
PROPOSED PROCESSING FACILITY
52 SINCLAIR STREET,
GOULBURN
WOODLAND RIDGE POULTRY PTY LTD

DRAWING STATUS		SHEET SIZE
NOT FOR CONSTRUCTION		A1
PROJECT REF No.		SCALE
180054		1:250
DRAWING No.		REVISION
CIV14		B

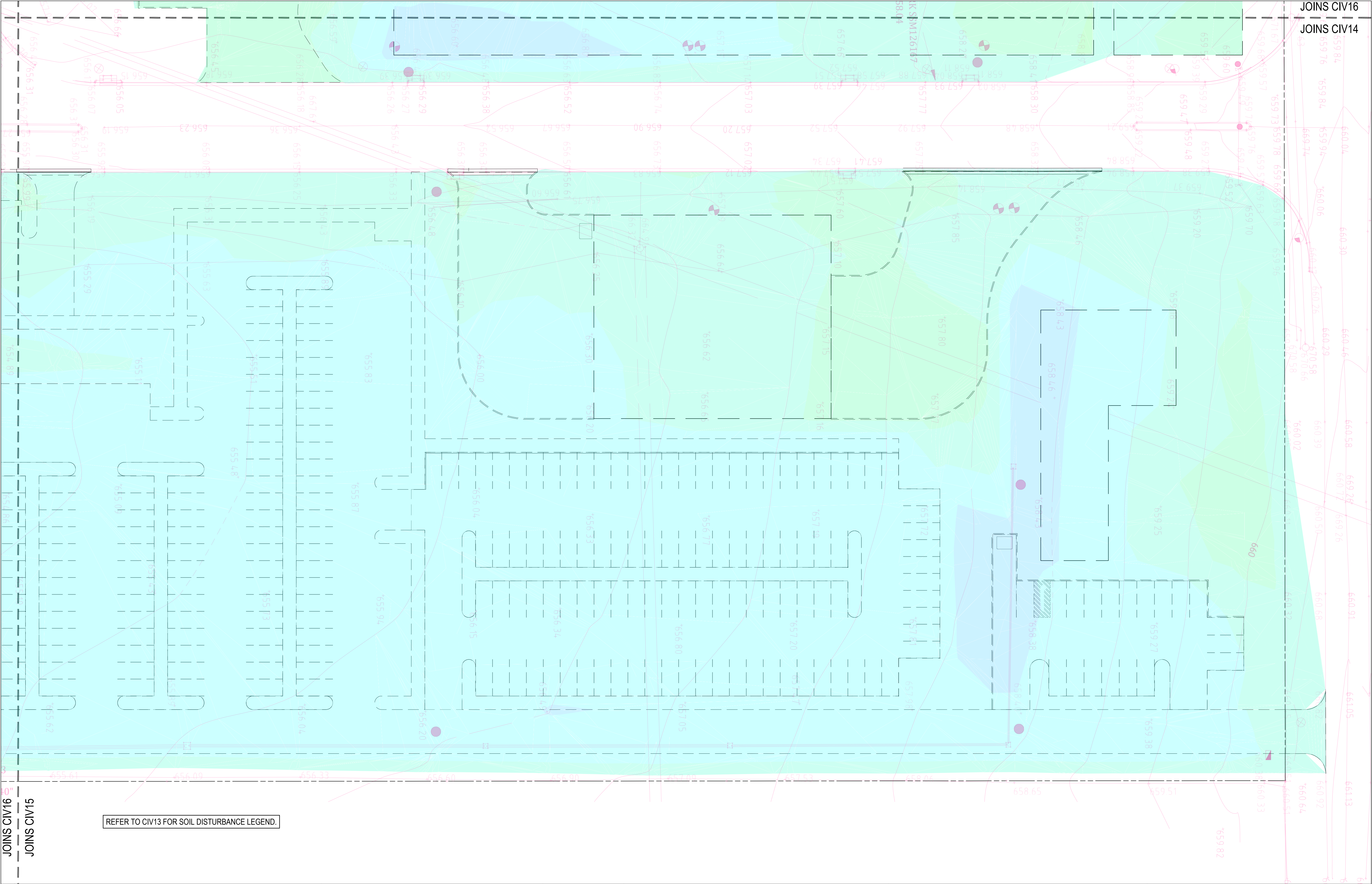

JOINS CIV16
JOINS CIV15

JOINS CIV16
JOINS CIV14

REFER TO CIV13 FOR SOIL DISTURBANCE LEGEND.

REVISIONS					
B	27.11.19	R.F.	M.M.	M.M.	RE-ISSUED FOR DA
A	12.08.19	R.F.	M.M.	M.M.	ISSUED FOR DA
REV	DATE	DRN	CHK	APP	DRAWING STATUS

This drawing is **not** approved for construction unless signed.

Mathew McLennan
BEing (Civil) Hons MIE (Aust)

North

COPYRIGHT - This drawing and the information provided shall remain the property of DRB Consulting Engineers Pty Ltd (DRB) and may not be used, copied or reproduced, in whole or part, for any purpose other than that for which it was supplied without the prior consent of DRB.

PO BOX 4105 Kotara East 2305
0402 915 549
ABN 64 625 755 482



STORMWATER MANAGEMENT PLAN
PROPOSED PROCESSING FACILITY
52 SINCLAIR STREET,
GOULBURN
WOODLAND RIDGE POULTRY PTY LTD

DRAWING STATUS		SHEET SIZE
NOT FOR CONSTRUCTION		A1
		SCALE 1:250
PROJECT REF No. 180054	DRAWING No. CIV16	REVISION B