

15 October 2019

Ms Alice Zheng
Design Manager, Randwick Campus Redevelopment, Building
Level 14, Tower Three, International Towers Sydney
Exchange Place, 300 Barangaroo Avenue,
BARANGAROO NSW 2000

AVIATION SSDA UPDATE INTEGRATED ASB (IASB) ADDITION V1.4

Dear Alice,

We note the review of the following core scope of elements of the IASB additions:

- UNSW Eastern Extension (Base Building Only)
- Associated modifications within the ASB
- Lowering of Hospital Road
- Landscaping

Following on from the adjusted building scope to include the UNSW considerations, given that the height of the building has not changed and therefore the existing PANS-OPS and OLS approvals remain extant, there is no requirement to engage with the airport and regulatory authorities on this issue. The flight path considerations for SSD 9113 (dated 6th June 2018) remain unchanged.

The GDA94 coordinates of the HLS reference point are:

Easting: 337062.15

Northing: 6245526.54

The MGA94 Coordinates for the building roof area are attached at Annexes A and B.

AviPro has maintained contact with the following organisations concerning crane and main building timings:

Department of Infrastructure, Regional Development and Cities (DIRD)

Civil Aviation Safety Authority (CASA)

Air Services Australia (ASA)

Sydney Airport (SACL)

Sincerely,

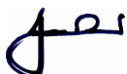
A handwritten signature in blue ink, appearing to read "Steve Graham".

Steve Graham

Managing Director

Tel: 0401 520048

E: s.graham@avipro.com.au

Annexes A & B: Randwick Acute Services Building Roof Plan Coordinates

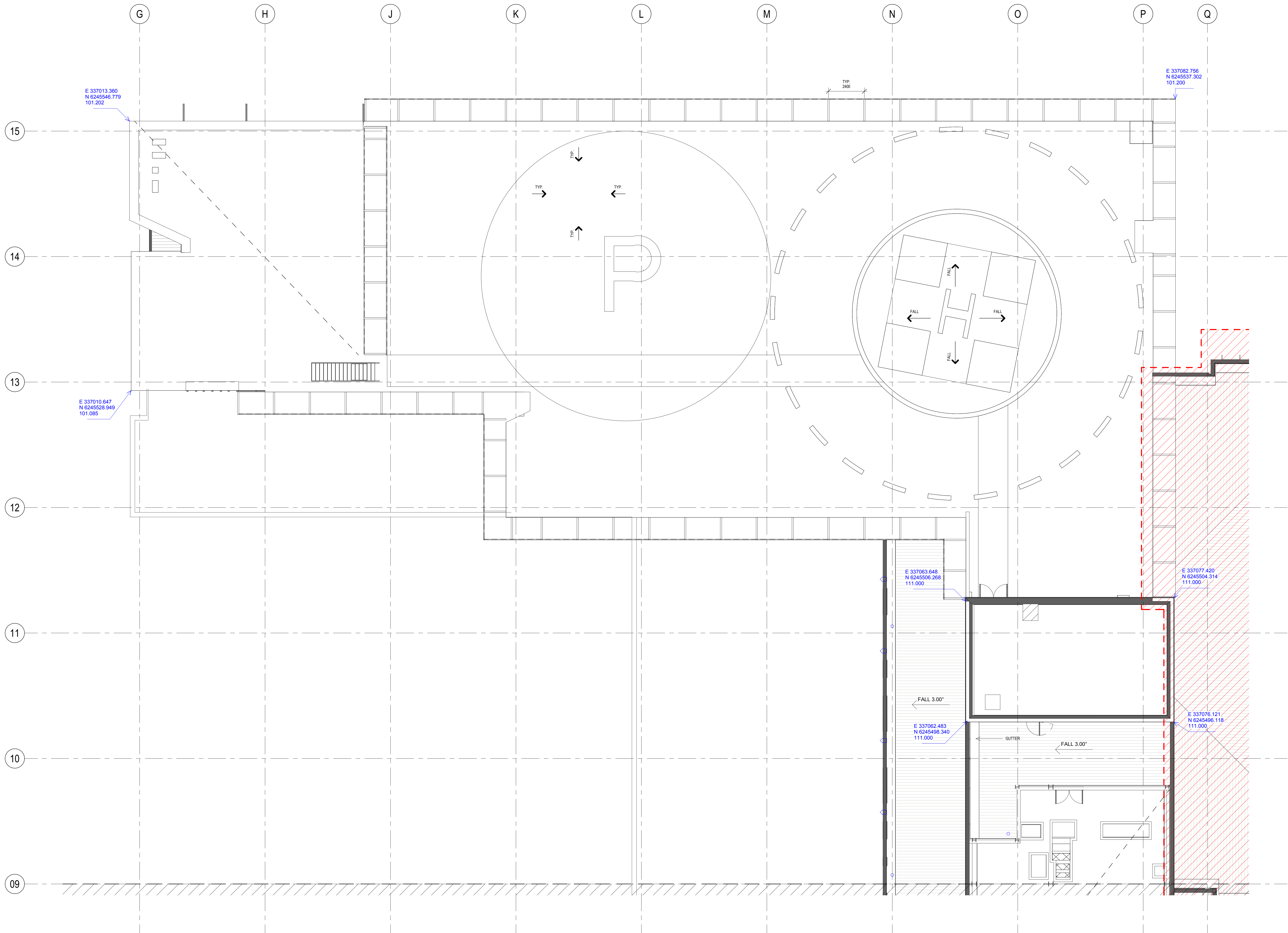

INTELLECTUAL PROPERTY

COPYRIGHT BY BN ARCHITECTURE PTY LIMITED. UNLESS OTHERWISE AGREED IN WRITING, ALL RIGHTS TO THIS DOCUMENT ARE SUBJECT TO PAYMENT IN FULL OF ALL BN CHARGES; THIS DOCUMENT MAY ONLY BE USED FOR THE EXPRESS PURPOSE AND PROJECT FOR WHICH IT HAS BEEN CREATED AND DELIVERED, AS NOTIFIED IN WRITING BY BN; AND THIS DOCUMENT MAY NOT BE OTHERWISE USED, OR COPIED ANY UNAUTHORISED USE OF THIS DOCUMENT IS AT THE USER'S SOLE RISK AND WITHOUT LIMITING BN'S RIGHTS TO THE USER RELEASES AND INDEMNIFIES BN FROM AND AGAINST ALL LOSSES ARISING

NOTE
CONTRACTOR TO CHECK AND VERIFY ALL DIMENSIONS ON SITE PRIOR
TO COMMENCEMENT OF WORK OR PREPARATION OF SHOP DRAWINGS
DO NOT SCALE THIS DRAWING

ISSUE	DATE	FOR
A	14/10/2019	FOR INFORMATION

CLIENT



CONSTRUCTION MANAGER

The Lend Lease logo is a stylized, abstract shape composed of several overlapping triangles in shades of green and yellow. The word "lendlease" is written in a white, lowercase, sans-serif font across the center of the logo.

PROJECT
RANDWICK CAMPUS
REDEVELOPMENT
BARKER ST
RANDWICK NSW 2031
AUSTRALIA
RVN PROJECT NUMBER

s1606008

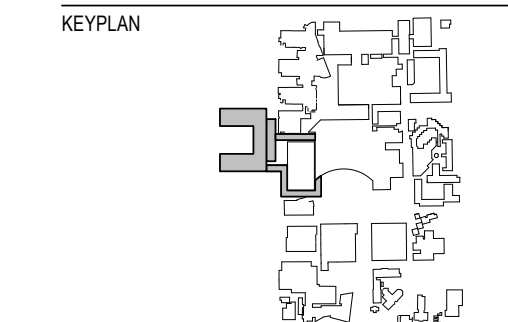

1:1008B1 DO NOT SCALE

STATUS

CONTRACT DOCUMENTATION
DRAWING

SKETCH ROOF PLAN - ZONE
2

RCR-BVN-ARC-SK-42-00002	ISSUE A
-------------------------	------------