



Bocce court



Rooftop leisure area



Rooftop infinity pool



Corten steel in landscape



Rock swimming pool



Rooftop seating area



Corten steel vegetable garden



Putting green



Dining pods



Cantilever timber bench



Low seating wall with timber capping



Dynamic lightweight concrete bench



Rock elements in naturalistic landscape



Dynamic lightweight concrete pots + bench seats



Oversized lightweight GRC pots



Rev:	Revision note:	Date:	Dwn by:
E	FOR DA APPROVAL	14.02.20	JZ
F	FOR DA APPROVAL	20.02.20	JZ
G	AMENDMENTS FOR DA APPROVAL	22.06.20	PG/JZ
H	AMENDMENTS FOR DA APPROVAL	17.07.20	PG/JZ
I	AMENDMENTS FOR DA APPROVAL	06.08.20	PG/JZ
J	AMENDMENTS FOR DA APPROVAL	07.08.20	PG/JZ
K	AMENDMENTS FOR DA APPROVAL	21.08.20	JZ
L	AMENDMENTS FOR DA APPROVAL	14.09.20	PG
M	AMENDMENTS FOR DA APPROVAL	15.10.20	JG/JZ
N	AMENDMENTS FOR DA APPROVAL	11.02.21	JZ
O	AMENDMENTS FOR DA APPROVAL	27.05.21	PG/JZ



Trees



Backhousia myrtifolia



Banksia integrifolia



Eucalyptus leucoxyloides



Ficus obliqua



Glochidion ferdinandi



Livistona australis



Melaleuca styphelioides

Shrubs > 3m



Grevillea 'Moonlight'



Syzygium 'Blaze'



Syzygium cascade



Acmena smithii "Minor"



Correa reflexa



Cyroress diffusus



Dianella caerulea



Doryanthes palmeri



Eremophila nivea



Santolina chamaecyparissus

Shrubs < 3m

Groundcovers



Macrozamia communis



Westringia fruticosa 'Grey Box'



Carpobrotus rossii 'Native Pigface'



Casuarina glauca 'Freefall'



Ficinia nodosa



Juncus patens



Lomandra longifolia 'Nyalla'



Pittosporum tobria 'Miss Muffet'



Scaevola albida 'White Carpet'

10-19 Master Plant Schedule by distinctive									
Code	Genus	species	Hybrids/Cultivars	Common Name	Pot Size	Height	Width	Spacing	Qty
Trees									
Ba my	Backhousia	myrtifolia		Grey Myrtle	75L	3	3	As Shown	2
Ba in	Banksia	integrifolia		Coastal Banksia	100L	12	8	As Shown	14
Br ru	Brachychiton	rupestris		Queensland Bottle Tree	100L	5	3	As Shown	4
Cu an	Cupaniopsis	anacardioides		Tuckeroo	100L	10	8	As Shown	12
El eu	Elaeocarpus	eumundii		Quondong	75L	8	5	As Shown	7
Eu Ro	Eucalyptus	leucoxydon	'Rosea'	Red Flowering Yellow Gum	75L	12	6	As Shown	2
Fi ob	Ficus	obliqua		Small Leaved Fig	75L	40	40	As Shown	2
Gl fe	Glochidion	fernandii		Cheese Tree	75L	7	5	As Shown	16
Li au	Livistona	australis		Cabbage Tree Palm	4m clear trunk	20	4	As Shown	28
Me st	Melaleuca	stpheloides		Paperback	75L	5	5	As Shown	2
To ci	Toona	ciliata		Australian Red Cedar	75L	20	10	As Shown	8
Tr Lu	Tristaniopsis	laurina	'Luscious'	Luscious Water Gum	75L	10	5	As Shown	21
Shrubs									
Ac Mi	Acmena	smithii	'Minor'	Lillypilly	200mm	3	2	As Shown	255
As BN	Asplenium	australasicum	'Birds Nest'	Birds Nest Fern	300mm	1.5	2	As Shown	26
Be yu	Beschomeria	yuccoides		Mexican Lily	200mm	1	1.5	As Shown	170
Bl nu	Blechnum	nudum		Fishbone Waterfern	140mm	1	1	As Shown	355
Co re	Correa	reflexa		Native Fuchsia	200mm	2	2	As Shown	79
Di LJ	Dianella	caerulea	'Little Jess'	Little JessParoo Lily	140mm	0.4	0.4	5/m2	1769
Do as	Doodia	aspera		Prickly Rasp Fern	200mm	0.4	0.4	4/m2	394
Do ex	Doryanthes	excelsa		Gynea Lilly	45L	2	1.5	As shown	144
Do pa	Doryanthes	palmeri		Gynea Lily	45L	2.5	3	As shown	15
Er ni	Eremophila	nivea		Silky Eremophila	140mm	1.5	1.5	As shown	15
Gr ML	Grevillea		'Moon Light'	MoonLight Grevillea	200mm	5	2	As Shown	9
Ma co	Macrozamia	communis		Burrawang	300mm	2	2	As Shown	6
Ph Xa	Philodendron		'Xanadu'	Xanadu	200mm	0.8	0.8	3/m3	211
Rh SM	Rhaphiolepis	indica	'Snow Maiden'	Snow Maiden Indian Hawthorn	200mm	0.8	0.8	As Shown	151
Sa ch	Santolina	chamaecyparis	'Clipped Ball'	Cotton Lavender	200mm	0.6	0.6	As Shown	24
Sy Bl	Syzygium	australe	'Blaze'	Blaze Lilly Pilly	200mm	1.5	1.25	As shown	201
Sy Ca	Syzygium	australe	Cascade'	Lilly Pilly	200mm	3	2	As Shown	64
We fr	Westringia	fruticosa	'Grey Box'	Coastal Rosemary	200mm	0.4	0.4	300mm centres	1890
Groundcovers									
Ca ro	Carpobrotus	rossii		Pigface	200mm	0.4	3	2/m2	1162
Ca FF	Casuarina	glauca	'Free Fall'	Prostrate Sheoak	200mm	0.6	3	2/m²	2108
Ci an	Cissus	antarctica		Kangaroo Vine	200mm	3	5	As shown	277
Fi no	Ficinia	nodosa		Knobby Clubrush	200mm	0.6	0.4	5/m2	1553
He pe	Helichrysum	petiolare	'Licorice'	Licorice plant	200mm	0.5	1	2/m2	1638
Ju us	Juncus	patens		Tussock Rush	200mm	1	1	2/m2	740
Lo Ny	Lomandra	longifolia	'Nyalla'	Blue Lomandra	200mm	0.8	0.8	4/m2	194
Lo Ta	Lomandra	longifolia	'Tanika'	Dwarf Lomandra	200mm	0.6	0.5	5/m2	516
Pi MM	Pittosporum	tobira	'Miss Muffet'	Dwarf Pittosporum	200mm	1	1.5	As shown	0
Sc WC	Scaevola	albida	'White Carpet'	Fan Flower	200mm	0.1	1.5m	3/m2	922
Se se	Senecio	serpens		Blue Chalk Sticks	200mm	0.2	0.5	5/m2	3084

NOTE: Proposed planting species have been carefully considered and selected that are native/ local indigenous species. This is in order to reflect the local landscape characteristic of Gosford area and Rumbalara bushland.

PROTECTION OF EXISTING TREES

Existing trees are to be protected and maintained during the course of construction. The contractor is to abide by council regulations relating to any trees nominated in DA approval, which will require all on-site trees to be provided with a 1800mm high fully supported chainmesh to minimise disturbance to existing ground conditions within the canopy drip line for the duration of construction works. "Tree Protection Zone" is to be attached to the protective fence.

GARDEN BEDS

Cultivate to a depth of 300mm so that soil can be worked freely. Apply gypsum at manufacturer's rates to add in de-compaction of site and breakdown of clay colloids. Spread premium blend garden bed mix to a depth of 300mm, when settled. Back filling shall be tapered progressively to match existing soil compaction, to avoid later subsidence. Mound all garden beds to centre. Allow for depth of mulch to finished levels when installing soil mix. Refer to Garden Bed Preparation Detail.

PLANTS

All plants which have been declared, pursuant to section 7 & 8 of the Noxious Weed Act 1993, to be Noxious Weeds within the area of Central Coast Council shall be removed on site and replaced with appropriate indigenous or native species.

All labels are to remain on plants and delivery receipts or copies of plant purchases, stating the species, amount, and container sizes of plants, shall be made available to Council's Construction Services or Private Certifier to facilitate certification that the landscape plan and conditions of consent have been implemented.

LAWN AREAS

Cultivate to a depth of 150mm, so that soil can be worked freely. Apply Gypsum at manufacturer's rates to add in de-compaction of site and breakdown of clay colloids. Spread 100mm layer of sandy loam topsoil blend. Rake over to form a smooth, even surface ready for lawn installation. New turf to all areas to be Soft leaf buffalo. Lay with staggered and close-butted joints along contours, to prepared surface. Water immediately, top dress once established.

Refer to Turf detail & Turf on podium detail

MULCH

Mulch shall be ANL 'Forest Blend' or similar, which is best suited to the plant type and clients needs. Variation from this can only be made with consultation with the project manager. Mulch shall be free of soil, weed growth or any other foreign matter. Spread mulch evenly to a depth of 75mm over all garden beds. Rake over mulch surface to create an even finish.

GRAVEL

Gravel to be placed in designated areas as shown on plan. Install ANL Deco Gold at 100mm Maximum depth. Rake surface evenly to spread gravel.

IRRIGATION DESIGN & INSTALLATION

Description: Fully Automated Irrigation system

Product: To be approved prior to installation
Turf: automated pop up irrigation system
Garden Beds: automated drip irrigation system

Performance: Ability to effectively irrigate nominated areas.

Location: To all Turf, planter box, and Garden Bed areas

Installation: Contractor to supply detailed Irrigation plan and specification for approval by Superintendent before commencement of irrigation works

Install to Irrigation consultant and Manufacturers details
Ensure electrical source is available at location provided by builder for operation of automatic system

Supplier: Specialist subcontractor (to be nominated)

DESIGN & INSTALLATION

The work is to be provided by an experienced, reputable and approved Landscape Irrigation Contractor. The Contractor shall be responsible for determining connection, electrical and potable water supply from external points of the building, as provided by the building contractor. Provision of zones with additional stations for future additions as required to be provided by contractor. Minimum 1 additional station per zone. Refer to the superintendent for instruction. Irrigation Contractor to shed. Remote control option to be provided. Valve Boxes to be located in garden beds.

The Communal open space areas and all planter boxes on slab must be provided with water-efficient irrigation system, connected to a pump and the rainwater tank, to enable effective landscape maintenance.

Programming:

Irrigation design to ensure system is programmed on staged cycles to ensure loading capacity is not exceeded for the specified pumps and hydraulic design. Refer to engineer's design and specification for details. The contractor / designer must co-ordinate with the engineer.

MATRIX 1 - MASSED PLANTING TO SHADE AREA - RATIO 1:1:1							
Code	Genus	Species	Hybrids/Cultivars	Common name	Pot size	Spacing	Percentage
Bl nu	Blechnum	nudum	-	Fishbone Waterfern	200mm	2/m2	33.33%
Do as	Doodia	aspera	-	Prickly Rasp Fern	200mm	4/m2	33.33%
Lo Ta	Lomandra	longifolia	'Tanika'	Dwarf Lomandra	200mm	5/m2	33.33%
MATRIX 2 - MASSED PLANTING - RATIO 1:1:1:1							
Code	Genus	Species	Hybrids/Cultivars	Common name	Pot size	Spacing	Percentage
Ca FF	Casuarina	glauca	'Free Fall'	Prostrate Sheoak	200mm	2/m2	25%
Fi no	Ficinia	nodosa	-	Knobby Clubrush	200mm	5/m2	25%
Ju us	Juncus	patens	-	Tussock Rush	200mm	2/m2	25%
Lo Ny	Lomandra	longifolia	'Nyalla'	Blue Lomandra	200mm	4/m2	25%
MATRIX 3 - MASSED PLANTING - RATIO 1:1:1:1							
Code	Genus	Species	Hybrids/Cultivars	Common name	Pot size	Spacing	Percentage
Ca FF	Casuarina	glauca	'Free Fall'	Prostrate Sheoak	200mm	2/m2	25%
Ca ro	Carpobrotus	rossii	-	Pigface	200mm	2/m2	25%
We fr	Westringia	fruticosa	'Grey Box'	Coastal Rosemary	200mm	2/m2	25%
Sc WC	Scaevola	albida	'White Carpet'	Fan Flower	200mm	3/m2	25%
MATRIX 4 - MASSED PLANTING - RATIO 1:1:1:1							
Code	Genus	Species	Hybrids/Cultivars	Common name	Pot size	Spacing	Percentage
Ca FF	Casuarina	glauca	'Free Fall'	Prostrate Sheoak	200mm	2/m2	25%
He pe	Helichrysum	petiolare	'Licorice'	Licorice plant	200mm	2/m2	25%
We fr	Westringia	fruticosa	'Grey Box'	Coastal Rosemary	200mm	2/m2	25%
Se se	Senecio	serpens	-	Blue Chalk Sticks	200mm	5/m2	25%
MATRIX 5 - MASSED PLANTING - RATIO 1:1:1:1							
Code	Genus	Species	Hybrids/Cultivars	Common name	Pot size	Spacing	Percentage
Di LJ	Dianella	caerulea	'Little Jess'	Little JessParoo Lily	200mm	5/m2	25%
Fi no	Ficinia	nodosa	-	Knobby Clubrush	200mm	5/m2	25%
Ju us	Juncus	patens	-	Tussock Rush	200mm	2/m2	25%
Ca ro	Carpobrotus	rossii	-	Pigface	200mm	2/m2	25%
MATRIX 6 (PLANTERS - SUN) - MASSED PLANTING - RATIO 1:1:1:1							
Code	Genus	Species	Hybrids/Cultivars	Common name	Pot size	Spacing	Percentage
He pe	Helichrysum	petiolare	'Licorice'	Licorice Plant	200mm	2/m2	20%
We fr	Westringia	fruticosa	'Grey Box'	Coastal Rosemary	200mm	2/m2	20%
Ju us	Juncus	patens	-	Tussock Rush	200mm	2/m2	20%
Se se	Senecio	serpens	-	Blue Chalk Sticks	200mm	5/m2	20%
Ca ro	Carpobrotus	rossii	-	Pigface	200mm	2/m2	20%
MATRIX 7 (PLANTERS - SHADE) - MASSED PLANTING - RATIO 1:1:1:1							
Code	Genus	Species	Hybrids/Cultivars	Common name	Pot size	Spacing	Percentage
We fr	Westringia	fruticosa	'Grey Box'	Coastal Rosemary	200mm	2/m2	20%
He pe	Helichrysum	petiolare	'Licorice'	Licorice Plant	200mm	2/m2	20%
Ca FF	Casuarina	glauca	'Free Fall'	Prostrate SheOak	200mm	1/m2	20%
Di LJ	Dianella	caerulea	'Little Jess'	Little Jess Paroo Lily	200mm	5/m2	20%
Sc WC	Scaevola	albida	'White Carpet'	Fan Flower	200mm	3/m2	20%

Taps:

To be connected to proposed stormwater harvesting storage tanks, or town water mains as indicated on the engineers plans

Conduits:

All conduits are the responsibility of the Builder. Conduits are to be placed in the locations as required in accordance with future installation of irrigation control lines to the irrigation designer's details. Ensure that these conduits are supplied with a draw cord and remain clearly marked throughout construction.

Approvals

Obtain all necessary approvals from relevant authorities. The Landscape Contractor is also responsible for complying with the requirements of all authorities connected with the works.

Standards and Authorities

All workmanship and materials must conform to the relevant Australian Standards and all Water Board requirements.

Co-ordination of Services

The Landscape Contractor shall be responsible for the co-ordination of the irrigation systems with other services throughout the site.

Bore connection and rainwater tank connections to be confirmed and coordinated. Connection to above ground water tanks to be incorporated.

Guarantees and Warranties

Relating to the installation and products are to be handed to the Superintendent on completion of the works.

Programming:

Works as Executed Drawing
Provide complete dimension drawings, based on the approved design plan, of the entire irrigation system as executed, clearly indicating the type and location of all irrigation fixtures. Hand the WAE Drawings to the Superintendent upon completion of the works.

COMPLETION AND MAINTENANCE

Upon completion, the Landscape Contractor is to run through system to ensure system is operating correctly and instruct the client's representative in the correct operation and maintenance of the system. All instructions are to be typed. Manuals, warranties, and a minimum of two programs, summer and winter to be provided to the Landscape Architect and the client's representative at the time of completion. The Landscape Contractor is to maintain the correct operation of the system for a minimum of 12 weeks after completion

MAINTENANCE SCHEDULE

The consolidation program shall include, but not limited to, the following items:

Routine Maintenance. Provide routine maintenance for a period of six months after practical completion. Program to include but not limited to plant establishment, watering, mowing, fertilising, weeding, staking, pruning, mulching, pest and disease control and generally maintaining the site in a neat and tidy condition.

Watering: Watering of plants and turf should be done in conjunction with current Sydney Water watering restrictions.

Fertilising: Apply an appropriate lawn fertiliser, at manufacturer's rates, after 6 weeks of installation. Ensure fertiliser is adequately watered and evenly dispersed for healthy even lawn growth.

Mulch of garden beds must adhere to Australian Standard AS4454.

Lawns. Repair lawns in all failed areas.

Disease and Pest Control. If pathological disease or insect pests appear, they are to be controlled using organic methods or pest and disease control. Failing this, chemical sprays may be used, at manufacturer's rates, with prior consent of client.

Replacement. Defects including any dead or unhealthy plant must be replaced or treated within 3 weeks. Missing, dead or unhealthy plants are to be replaced with plants of similar size and quality and identical species/variety, unless a substitution has been approved by Council.

Any Pruning must be carried out to meet Australian Standards AS4373 'Pruning of Amenity Trees' and shall comply with Councils Tree Preservation Order.

Making Good. The contractor shall make good erosion of soil or subsidence which may occur, at no contract variation.

distinctive Living Design

Landscape & Interior Architecture - Design - Consultancy

114 Argyle Street,

Camden NSW 2570

T +61 2 4655 1881

admin@distinctive.net.au

www.distinctive.net.au

Distinctive Gardens & Interior T/A Distinctive Living Design

Rev.	Revision note:	Date:	Dwn by:
E	FOR DA APPROVAL	14.02.20	IJ
F	FOR DA APPROVAL	20.02.20	IJ
G	AMENDMENTS FOR DA APPROVAL	22.06.20	PG/IJ
H	AMENDMENTS FOR DA APPROVAL	17.07.20	PG/IJ
I	AMENDMENTS FOR DA APPROVAL	06.08.20	PG/IJ
J	AMENDMENTS FOR DA APPROVAL	07.08.20	PG/IJ
K	AMENDMENTS FOR DA APPROVAL	21.08.20	IJ
L	AMENDMENTS FOR DA APPROVAL	14.09.20	PG
M	AMENDMENTS FOR DA APPROVAL	19.10.20	JG/IJ
N	AMENDMENTS FOR DA APPROVAL	11.02.21	IJ
O	AMENDMENTS FOR DA APPROVAL	27.05.21	PG/IJ



Project Title:
John Whiteway Drive JWD Development Gosford

Project Address:
89 John Whiteway Drive, Gosford

Drawing Title:
PLANT SCHEDULE, NOTES

Location of all services is to be carried out by all contractors prior to commencement of works. Please Detail-Before-You-Dig Ph: 1 100. Refer plans by Architects, Engineers & Surveyors for other working drawings. Information on Distinctive plans is for reference & co-ordination only. This drawings are to be read in conjunction with prepared specifications & details. It is the responsibility of the contractor to notify Distinctive of any contradiction within the plans & receive appropriate direction prior to construction works. Final layout is to be determined on the site and at the direction of the site supervisor. Plans are copyright to Distinctive Gardens & Interior Pty Ltd.

Scale @ A1/A3:
NTS

Client:
JWD Developments Pty Ltd

Drawing Date:
27.05.21

Drawn/Checked
JG/IJ/PG/GW/MS/DB

Drawing

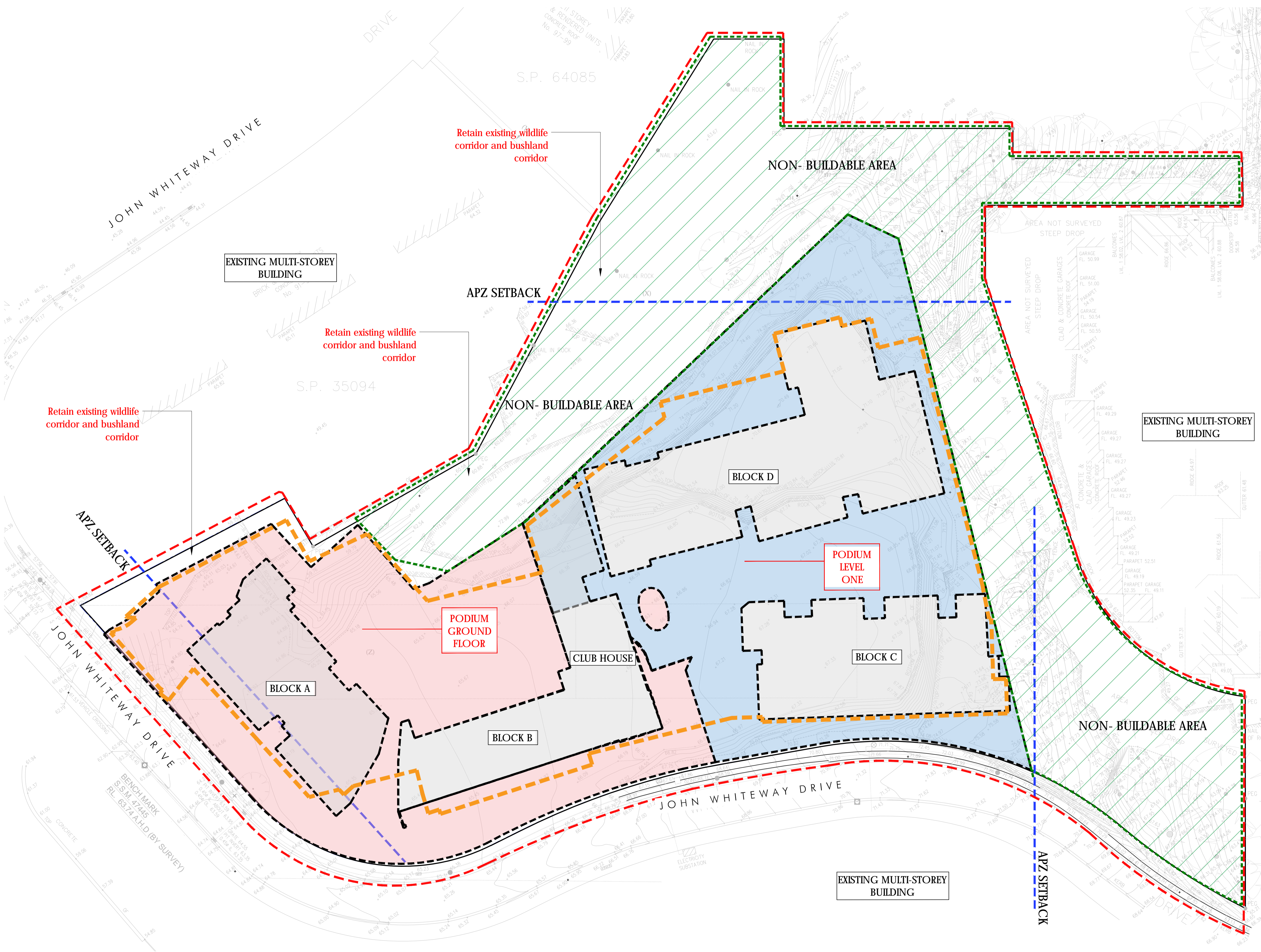

- KEY**
- GROUND FLOOR - LOWER PODIUM
REFER SHEET DIRECTORY
 - LEVEL ONE - UPPER PODIUM
REFER SHEET DIRECTORY
 - BLOCK A LEVEL 4 - ROOFTOP
REFER SHEET DIRECTORY
 - BLOCK C LEVEL 8 - ROOFTOP
REFER SHEET DIRECTORY
 - BLOCK D LEVEL 10 - ROOFTOP
REFER SHEET DIRECTORY
 - EXTENT OF WORKS
 - EXTENT OF PODIUM
 - APZ SETBACK
 - NON-BUILDABLE ZONE

distinctive Living Design
 Landscape & Interior Architecture - Design - Consultancy
 114 Argyle Street,
 Camden NSW 2570
 T +61 2 4655 1881
 admin@distinctive.net.au
 www.distinctive.net.au
 Distinctive Gardens & Interior T/A distinctive Living Design

Rev.	Revision note:	Date:	Dwn by:
E	FOR DA APPROVAL	14.02.20	IJ
F	FOR DA APPROVAL	20.02.20	IJ
G	AMENDMENTS FOR DA APPROVAL	22.06.20	PG/IJ
H	AMENDMENTS FOR DA APPROVAL	17.07.20	PG/IJ
I	AMENDMENTS FOR DA APPROVAL	06.08.20	PG/IJ
J	AMENDMENTS FOR DA APPROVAL	07.08.20	PG/IJ
K	AMENDMENTS FOR DA APPROVAL	21.08.20	IJ
L	AMENDMENTS FOR DA APPROVAL	14.09.20	PG
M	AMENDMENTS FOR DA APPROVAL	19.10.20	JG/IJ
N	AMENDMENTS FOR DA APPROVAL	11.02.21	IJ
O	AMENDMENTS FOR DA APPROVAL	27.05.21	PG/IJ

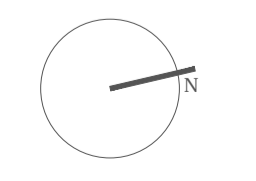

This document has been validated by Mark Santangelo
 Registered Landscape Architect (QLD), BArch, Dip Hort
 Verified by Dean Boone
 DIRECTOR

Project Title:
John Whiteway Drive JWD Development Gosford
 Project Address:
89 John Whiteway Drive, Gosford
 Drawing Title:
DIRECTORY PLAN
 Location of all services is to be carried out by all contractors prior to commencement of works. Please Refer-You-Dig Ph: 1 800 100 100. Refer plans by Architects, Engineers & Surveyors for other working drawings. Information on Distinctive plans is for reference & coordination only. This drawings are to be read in conjunction with prepared specifications & details. It is the responsibility of the contractor to notify Distinctive of any contradiction within the plans & receive appropriate direction prior to construction works. Final layout is to be determined on the spot at the direction of the site supervisor. Plans are copyright to Distinctive Gardens & Interior Pty Ltd.

Scale @ A1/A3: **1:400/ 1:800** Client: **JWD Developments Pty Ltd**
 Drawing Date: **27.05.21** Drawn/Checked: **JG/IJ/PG/GW/MS/DB** Drawing Status: **DA**
 Project Number: **10-19** Drawing Number: **10-19.13** Issue: **0**



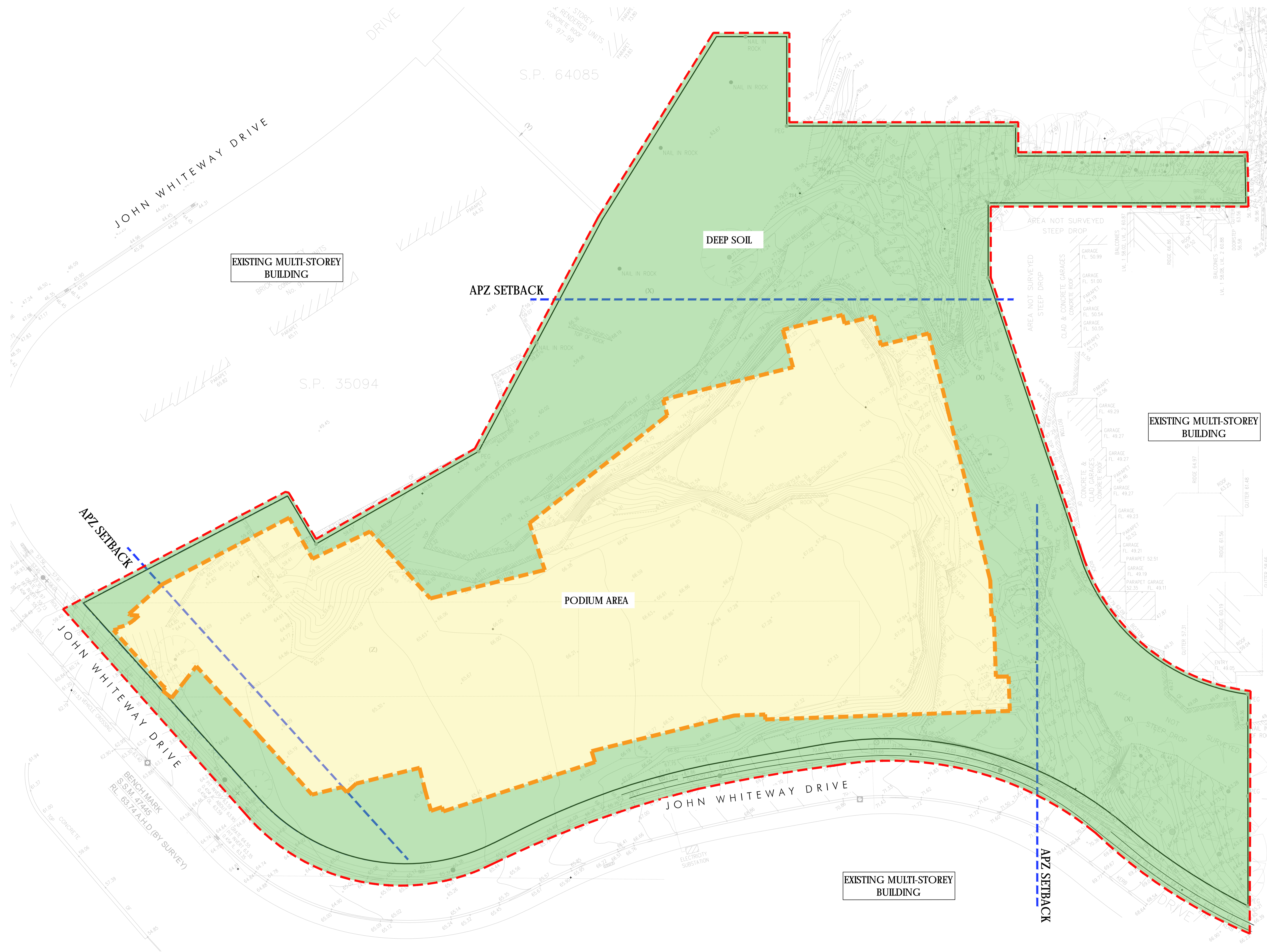

KEY

- PODIUM AREA
- DEEP SOIL ZONE
- EXTENT OF WORKS
- EXTENT OF PODIUM
- APZ SETBACK

DEEP SOIL PERCENTAGE CALCULATION

Total site area:	22315 m2
Total deep soil area:	11959 m2
Deep soil percentage:	53.5%

distinctive Living Design
 Landscape & Interior Architecture - Design - Consultancy
 114 Argyle Street,
 Camden NSW 2570
 T +61 2 4655 1881
 admin@distinctive.net.au
 www.distinctive.net.au
 Distinctive Gardens & Interiors T/A distinctive Living Design

Rev.	Revision note:	Date:	Dwn by:
E	FOR DA APPROVAL	14.02.20	IJ
F	FOR DA APPROVAL	20.02.20	IJ
G	AMENDMENTS FOR DA APPROVAL	22.06.20	PG/IJ
H	AMENDMENTS FOR DA APPROVAL	17.07.20	PG/IJ
I	AMENDMENTS FOR DA APPROVAL	06.08.20	PG/IJ
J	AMENDMENTS FOR DA APPROVAL	07.08.20	PG/IJ
K	AMENDMENTS FOR DA APPROVAL	21.08.20	IJ
L	AMENDMENTS FOR DA APPROVAL	14.09.20	PG
M	AMENDMENTS FOR DA APPROVAL	19.10.20	JG/IJ
N	AMENDMENTS FOR DA APPROVAL	11.02.21	IJ
O	AMENDMENTS FOR DA APPROVAL	27.05.21	PG/IJ

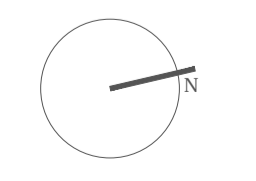

This document has been validated by Mark Santangelo
 Registered Landscape Architect (QLD, WA, NSW, VIC)
 Verified by Dean Boone
 DIRECTOR

Project Title:
John Whiteway Drive JWD Development Gosford
 Project Address:
89 John Whiteway Drive, Gosford
 Drawing Title:
SITE DEEP SOIL PLAN
 Location of all services is to be carried out by all contractors prior to commencement of works. Please refer to the relevant drawings for details. It is the responsibility of the contractor to verify the location of all services on site and to ensure that they are correctly located. This drawing is to be read in conjunction with prepared specifications & details. It is the responsibility of the contractor to notify Distinctive of any contradiction within the plans & receive appropriate direction prior to construction works. Final layout is to be determined on the spot at the direction of the site supervisor. Plans are copyright to Distinctive Gardens & Interiors Pty Ltd.

Scale @ A1/A3: **1:400/ 1:800**
 Client: **JWD Developments Pty Ltd**
 Drawing Date: **27.05.21**
 Drawn/Checked: **JG/IJ/PG/GW/MS/DB**
 Drawing Status: **DA**
 Project Number: **10-19**
 Drawing Number: **10-19.14**
 Issue: **0**





LEGEND

- - - EXENT OF SITE
- - - EXTENT OF PROPOSED DEVELOPMENT SITE
- TREES TO BE REMOVED WITHIN DEVELOPMENT SITE CANOPY COVERAGE
- PROPOSED TREES WITHIN DEVELOPMENT SITE CANOPY COVERAGE

DAP COMMENT ADDRESSED:
Biodiversity
 The Department requests that the proposal be reviewed and revised to retain more of these trees and an appropriate tree planting strategy be provided, to compensate the necessary loss of trees.

Rev:	Revision note:	Date:	Dwn by:
E	FOR DA APPROVAL	14.02.20	IJZ
F	FOR DA APPROVAL	20.02.20	IJZ
G	AMENDMENTS FOR DA APPROVAL	22.06.20	PG/IJZ
H	AMENDMENTS FOR DA APPROVAL	17.07.20	PG/IJZ
I	AMENDMENTS FOR DA APPROVAL	06.08.20	PG/IJZ
J	AMENDMENTS FOR DA APPROVAL	07.08.20	PG/IJZ
K	AMENDMENTS FOR DA APPROVAL	21.08.20	IJZ
L	AMENDMENTS FOR DA APPROVAL	14.09.20	PG
M	AMENDMENTS FOR DA APPROVAL	18.10.20	JG/IJZ
N	AMENDMENTS FOR DA APPROVAL	11.02.21	IJZ
O	AMENDMENTS FOR DA APPROVAL	27.05.21	PG/IJZ

