

Heritage Interpretation

Courtyard Paving

Reinstating the Carriageways

The existing courtyards at the Lands Buildings are currently filled with ad-hoc additions to the existing building throughout the years of occupation. This includes the amenity blocks, lift core and plant spaces that have cluttered the original Carriageway for the Lands Building.

One of the key strategies to the revitalisation of the Lands Building is to remove these elements and reinstate this historic Carriageway and provide daylight and functional space to the public.

The original amenity blocks will be reinterpreted within the new paving pattern of the proposed courtyards, referencing their historic configuration alongside the carriageway.

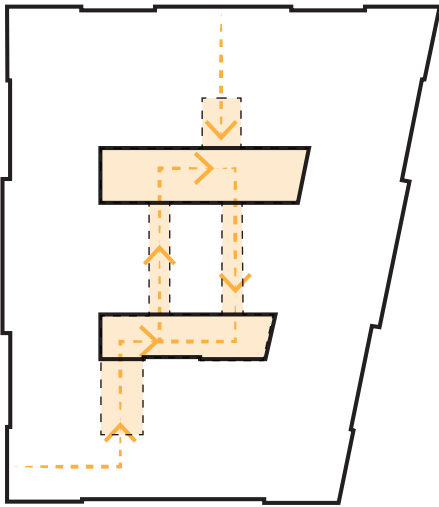

Existing Courtyard condition showing amenity blocks and lift cores in courtyards



Proposed interpretation strategy with amenity block interpreted in new paving

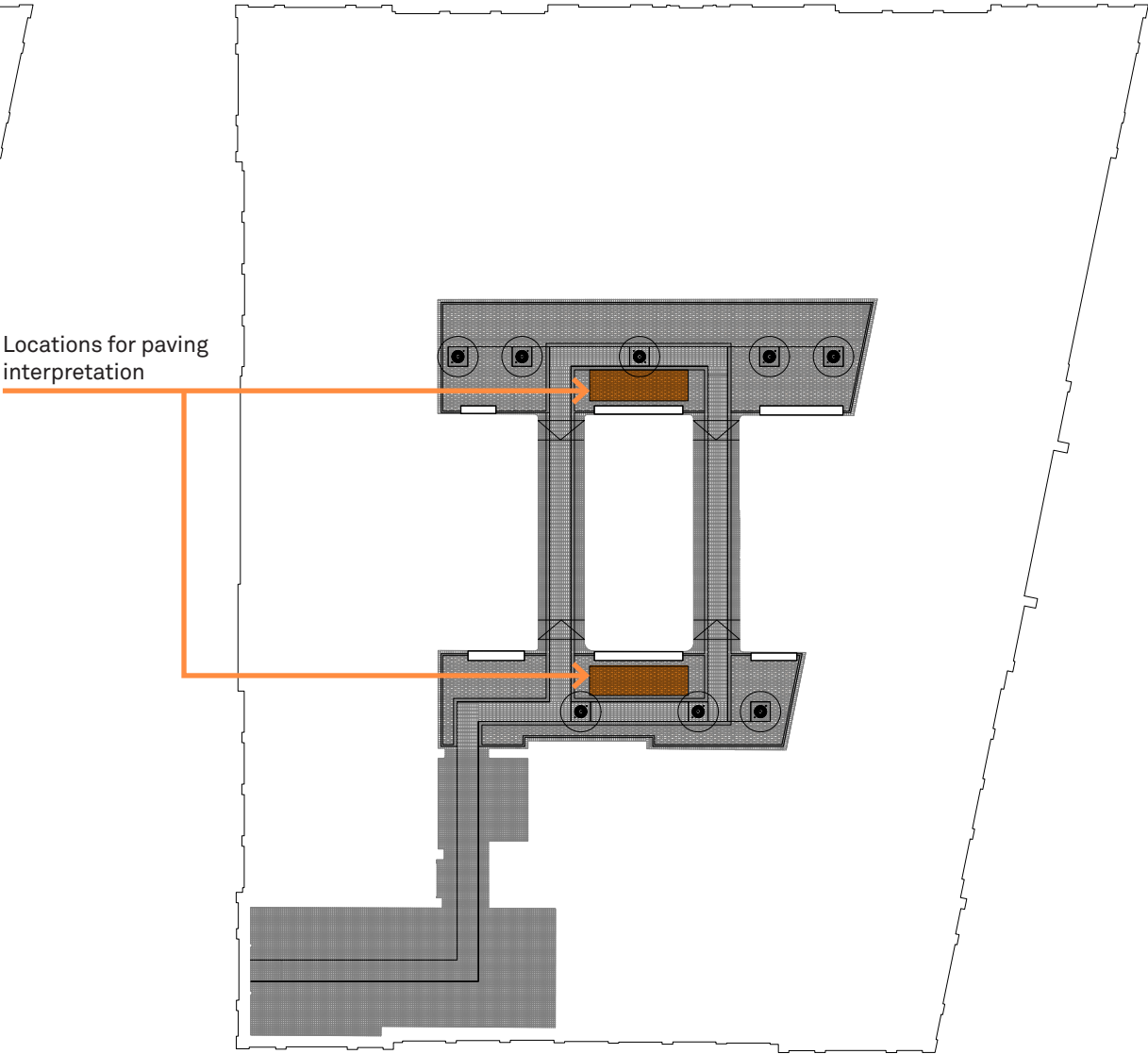

Heritage Interpretation
Courtyard Gantries

Revitalising the Courtyard Elevations

With the removal of the amenity blocks in the North and South Courtyards, portions of the redundant gantries used to access the external amenities are proposed to be retained. Some of the existing fabric is in poor structural condition, as referred to in the GAO CMP.

The revised design retains a portion of each gantry adjacent to the lift cores on Ground, Level 1 and Level 2, using the best original fabric, and allows these elements to be interpreted in their original positions.

Existing gantries crossing the windows to the stair cores are removed to optimise natural light and views into stair wells, as well as exposing the central Strong Room elaborate steel shutters to the courtyard below.

Partial Gantries to be retained for both North and South Courtyards adjacent to lift cores on GF, 1F and 2F (shown in orange).

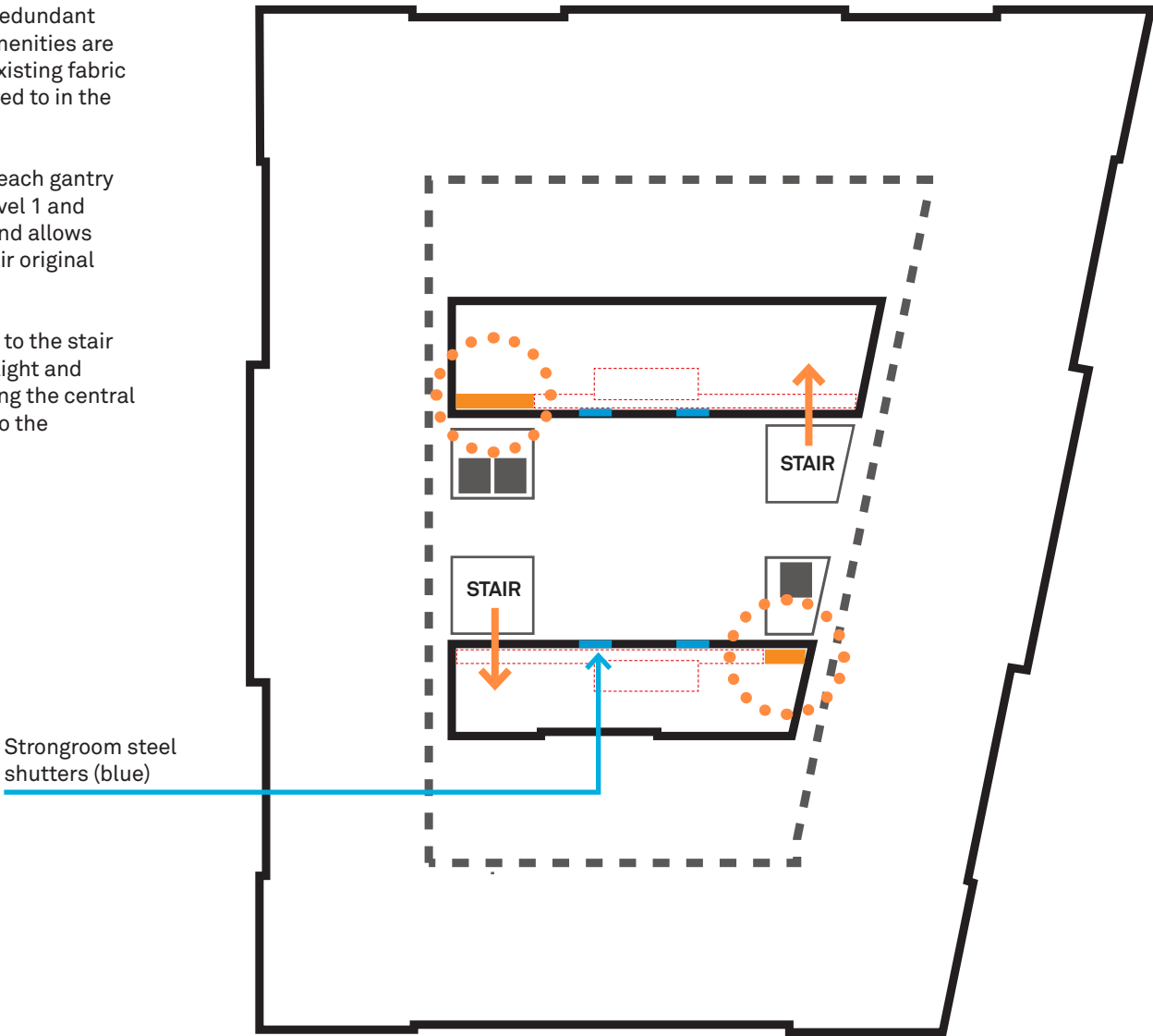

Retained gantries axonometric

Showing retained gantry balustrades, brackets and floor grates. Further Structural assessment to be undertaken in subsequent phases.

