

SEE INSET
SITE MAP

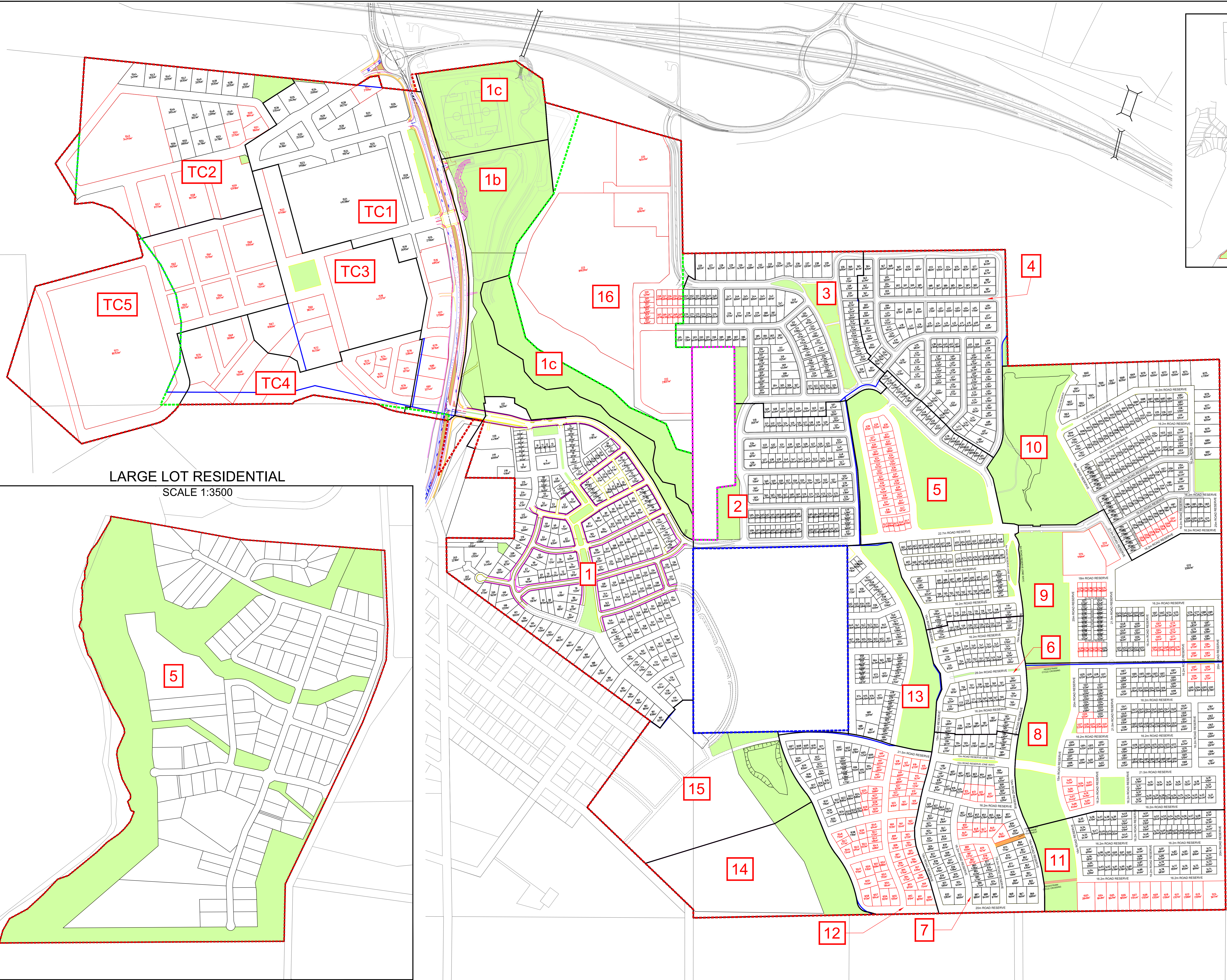

LARGE LOT RESIDENTIAL
SCALE 1:3500

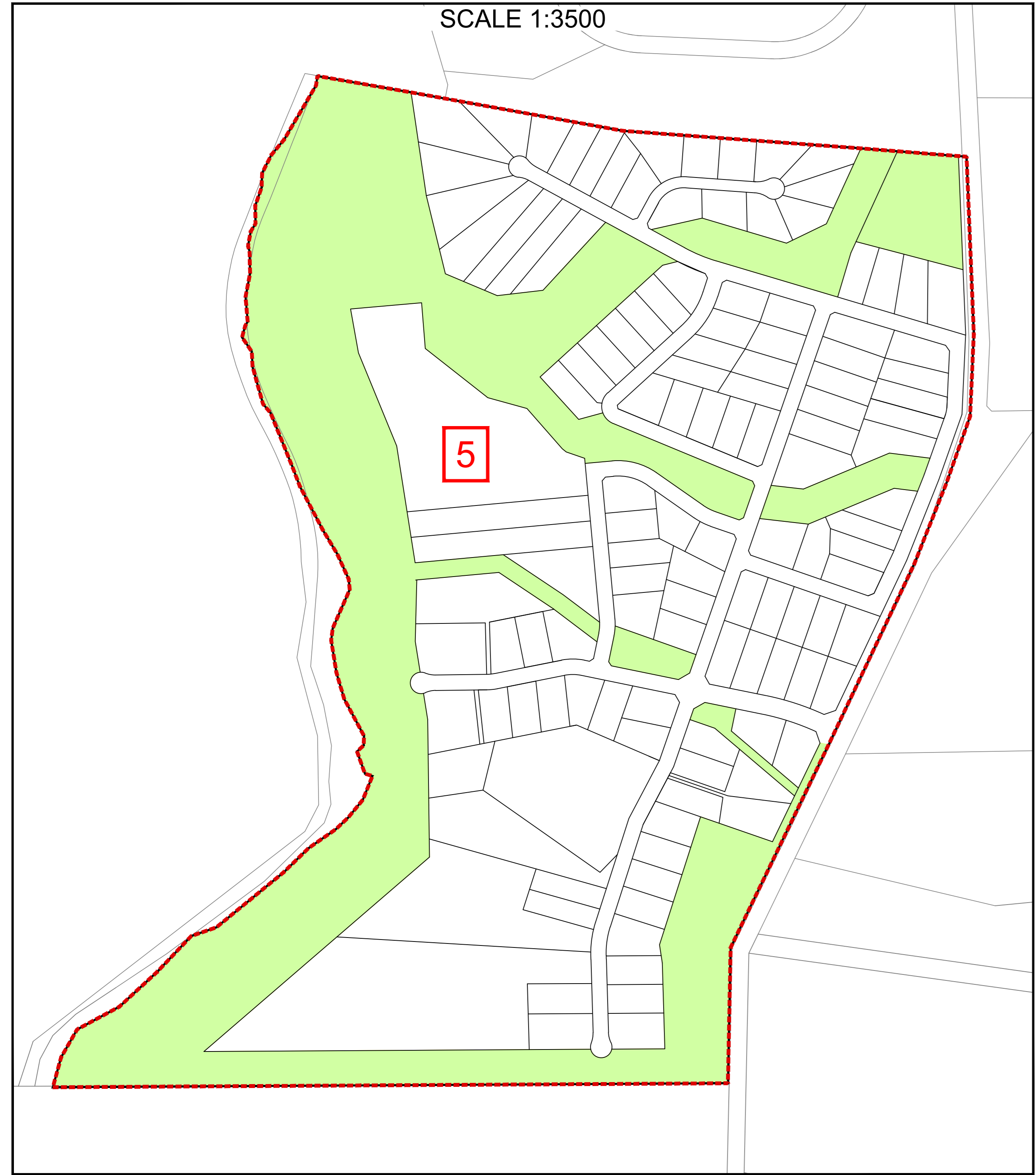

- LEGEND**
- 1 SUB-STAGE NUMBER
 - SUB-STAGE BOUNDARY
 - - - STAGE 1 BOUNDARY
 - · - · - MOD 10 REV 8 STAGE 1 BOUNDARY
 - · - · - LOT 351 BOUNDARY
 - · - · - LOT 34 BOUNDARY
 - INDICATES MOD 10 REV 8 SUB-STAGE BOUNDARY CHANGED IN MOD 9
 - INDICATES MOD 9 BOUNDARY AS CHANGED FROM MOD 10 REV. 8

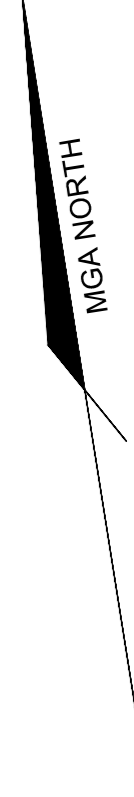
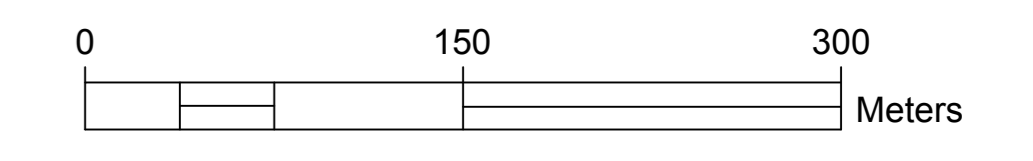

ISSUE	DATE	PURPOSE	ISSUE	DATE	PURPOSE
(4)	27/10/2017	AMEND BACKGROUND EXISTING/PROPOSED BOUNDARIES	(10)	29/06/2018	VARIOUS CHANGES PER MARKUPS FROM GLENN SENT 28/06/2018
(5)	21/11/2017	AMEND VIEWPORT, BACKGROUND & BDY TC, ADD LOTS & GREENSPACE SUBSTAGES 7-13	(11)	20/07/2018	VARIOUS CHANGES PER MARKUPS FROM GLENN SENT BETWEEN 02 - 18/07/2018
(6)	22/11/2017	ADD LOTS SUBSTG 3-4 & RET VILL, AMEND BACKGND, AMEND/ADD STG1 & SUB STG16 BDY	(12)	22/08/2018	AMEND STAGES 6, 13 & 20, AMEND ROADS & HATCH, AMEND PROJECT BOUNDARY
(7)	13/12/2017	ADD LOTS/AMEND BACKGND, TC/STG9, AMEND STAGE 1 & SUB-STAGE BOUNDARIES TC	(13)	23/08/2018	ADD SITE MAP & INSET FOR LARGE LOT RESIDENTIAL, ADD BASIN WEST OF TC
(8)	12/02/2018	AMEND LOT 1451 IN TC1	(14)	30/08/2018	AMEND ROAD WIDTHS & LOTS IN TOWN CENTRE
(9)	26/06/2018	VARIOUS CHANGES PER MARKUPS FROM GLENN SENT 22/06/2018	(15)	30/05/2019	REMOVAL OF STAGE 138

**PRELIMINARY REVIEW
NOT FOR CONSTRUCTION**

THIS IS A COLOUR DRAWING AND SHOULD NOT BE REPRODUCED IN BLACK AND WHITE

COPYRIGHT © Daly-Smith PTY LTD ABN 61 081 228 880

THE DRAWING IS PREPARED SOLELY FOR THE USE OF THE CONTRACTUAL CUSTOMER OF Daly-Smith PTY LTD AND Daly-Smith PTY LTD ASSUMES NO LIABILITY TO ANY OTHER PARTY FOR ANY REPRESENTATIONS CONTAINED IN THIS DRAWING.

CLIENT: **Huntlee**

SCALE: 1:3000

SHEET SIZE: A0

DRAWN BY: RB

CHECKED BY: ADM

PROJECT: **HUNTEE STAGE 1 - DEVELOPMENT AREA WINE COUNTRY DRIVE, HUNTEE**

CLIENT: **HUNTEE PTY.LTD.**

DRAWING TITLE: 20406-1 TO 3000 (MOD9) AS CHANGED FROM MOD 10 REV. 8

PROJECT: **HUNTEE STAGE 1 - DEVELOPMENT AREA WINE COUNTRY DRIVE, HUNTEE**

CLIENT: **HUNTEE PTY.LTD.**

DALY.SMITH
EXPERIENCE YOU CAN TRUST

3168 Newcastle Street, Monroeville NSW 2264
4/9 Lambton Road, Broadmeadow NSW 2320
T: (02) 4973 2746 F: (02) 4970 5366
E: mail@daly-smith.com.au
DALYSMITH.COM.AU

DALY.SMITH JOB No (Rev): **20406(15)**

SHEET NO: 1 OF 1