

Our Ref: 19465

30 April 2021

Kambala School
c/o Carmichael Tompkins Property Group
Level 14, Aurora Place, 88 Phillip Street
Sydney, NSW, 2000

Attention: Mr Sufian Supa'at

Dear Sufian,

**RE: KAMBALA SCHOOL SPORTS PRECINCT
TRAFFIC RESPONSE TO SUBMISSIONS #2**

Background

A SSDA was submitted for the proposed Kambala School Sports Precinct development. A number of submissions have been received from Authorities. The Transport Planning Partnership (TPPP) has responded to each of the traffic and parking related comments in a letter dated 23 February 2021.

Following this response, Woollahra Municipal Council (Council) has issued an additional Request for Information (RFI) to address outstanding queries. The traffic related queries are as follows.

- *'Kambala School Sports Precinct Traffic Response to Submissions' indicates that "new motorcycle spaces can be provided at the existing vehicle garage at Fernbank cottage". The location of these proposed motorcycle spaces are to be shown in an updated Architectural package.*
- *The location of the proposed shuttle bus drop off and pick up areas along Bayview Hill Road should be clearly identified on the set of Architectural plans that have been provided.*

The architectural plans have been revised in response to the above comments are provided in **Attachment One**. In addition, TPPP has responded to the above comments in the following.

Motorcycle Parking Spaces

The DCP requires one motorcycle spaces per ten car space. There are no increases to car parking as part of the proposed development. The motorcycle parking requirement is considered to be zero.

However, following advice from Council, five motorcycle parking spaces has been provided along the existing driveway at Fernbank Cottage at 1 Bayview Hill Road. It is understood that this driveway will not be used for car access in the future.

The motorcycle spaces are 1.2m wide and 2.5m long, which accords with the requirements of AS2890.1. Manoeuvring area around each space has been ensured with a 2m wide driveway and 2.5m wide aisle width between spaces.

Shuttle Bus Service

Kambala currently own two shuttle buses that seat 15 persons and are parked within the Fernbank Boarding site at 3 Bayview Hill Road.

Kambala is to provide two shuttle bus services for staff, one in the morning and one in the afternoon. If required, Kambala has capacity to increase the number of services noting that there are multiple buses. The provision of services would be based on demand.

As part of the proposed development, it is proposed to use these buses to transport staff between Kambala and Edgecliff Railway Station. Staff would be collected and dropped off from the existing loading dock at the ground floor car park off Tivoli Avenue.

The loading dock accommodates two 8.8m long bays, which is of sufficient length to accommodate Kambala's shuttle bus, which is 6.2m long, and ensure sufficient room for loading and off-loading of staff.

We trust the above is to your satisfaction. Should you have any queries regarding the above or require further information, please do not hesitate to contact the undersigned on 8437 7800.

Yours sincerely,

A handwritten signature in black ink, appearing to read 'Ken Hollyoak', is positioned above the printed name and title.

Ken Hollyoak
Director

Encl. Attachment One - Architectural Plans

Attachment One

Architectural Plans

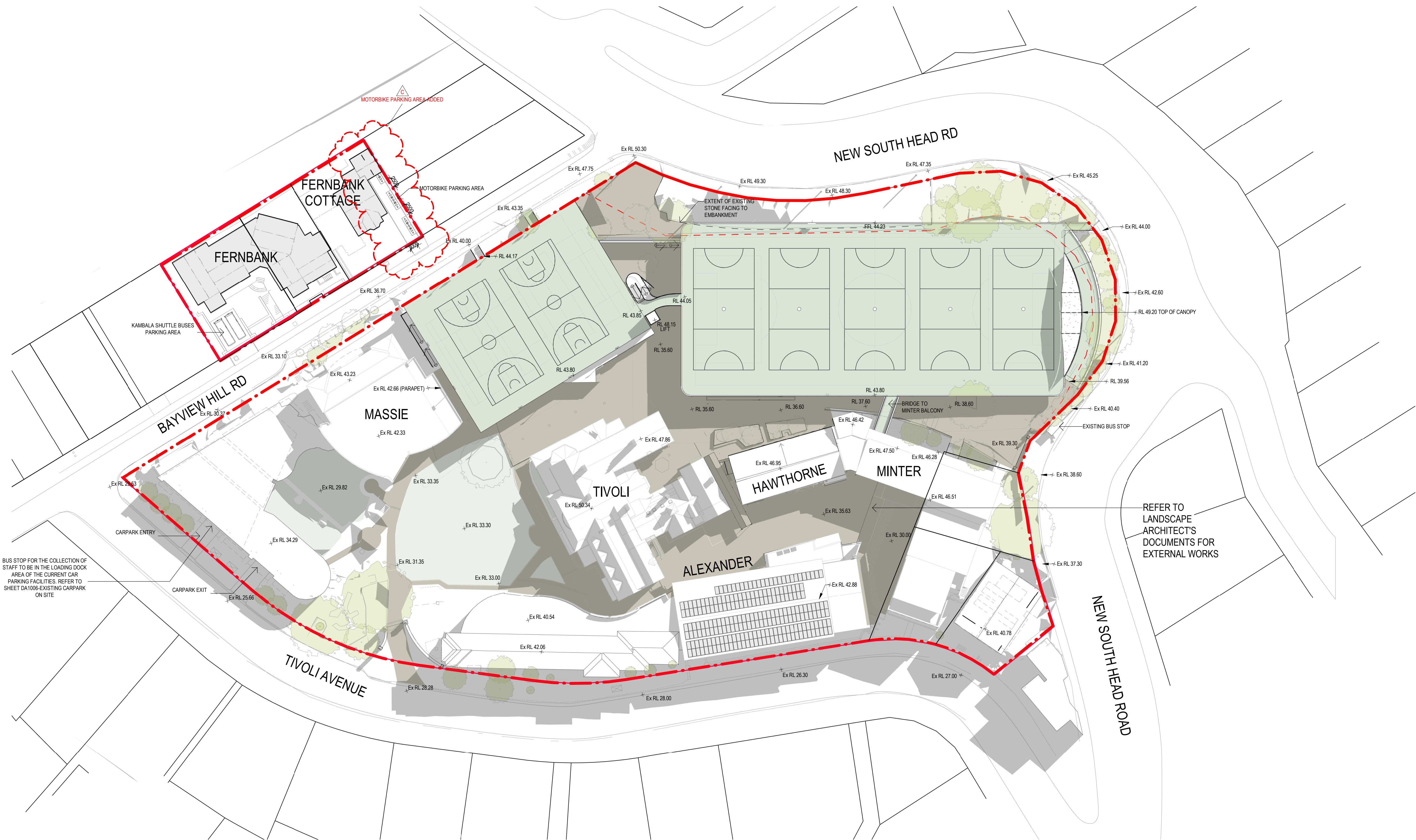

Revisions No.	Date	Description	Ver	App'd
1	09/06/2020	ISSUED TO CONSULTANTS FOR UPDATE		
A	21/07/2020	FOR SSDA		
B	23/04/2021	ISSUED FOR SSDA		
C	29/04/2021	ISSUED FOR SSDA		

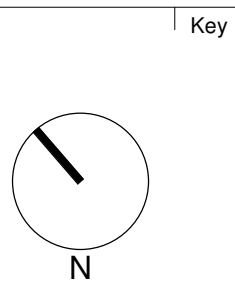

Client
KAMBALA SCHOOL



Architect

AJ+C
ALLEN JACK+COTTER

79 Myrtle Street Chippendale NSW 2008 AUSTRALIA
ph +61 2 9311 8222 fx +61 2 9311 8200
ABN 53 003 782 250

Project
KAMBALA SPORT, WELL-BEING AND SENIOR LEARNING PRECINCT

794 NEW SOUTH HEAD ROAD
ROSE BAY NSW 2029

Proj. No. 18049

Drawing Title
PROPOSED CAMPUS PLAN

Project Status
NOT FOR CONSTRUCTION

Scale
1 : 500 @B1

Drawing No.
DA1005

Issue
C

