

DATUM : X-Y (MGA) 96°02'00" - 217-607 DP1173162 & SURVEY

SURVEYING & SPATIAL INFORMATION REGULATION 2012 (CLAUSE 35(1)(b))							
MARKS	MGA CO-ORDINATES		CL	ORD	METHOD	ORIGIN	ACCURACY
	EASTING	NORTHING					
SSH 144455	244449.16	6031627.62	U	U	Cadastral Traverse	DP1173162	50mm
SSH 144455	244476.41	6031444.76	U	U	Cadastral Traverse	DP1173162	50mm
SSH 171292	244605.21	6031730.21	U	U	Cadastral Traverse	DP1173162	50mm
SSH 171293	244555.79	6031514.35	U	U	Cadastral Traverse	DP1173162	50mm
SSH 172993	244695.23	6031798.38	U	U	Cadastral Traverse	DP1173162	50mm
SSH 172999	244721.70	6031767.33	U	U	Cadastral Traverse	DP1173162	50mm
ZONE 56 COMBINED SCALE FACTOR 1.003397 SOURCE SCMS 21ST OCTOBER 2014							

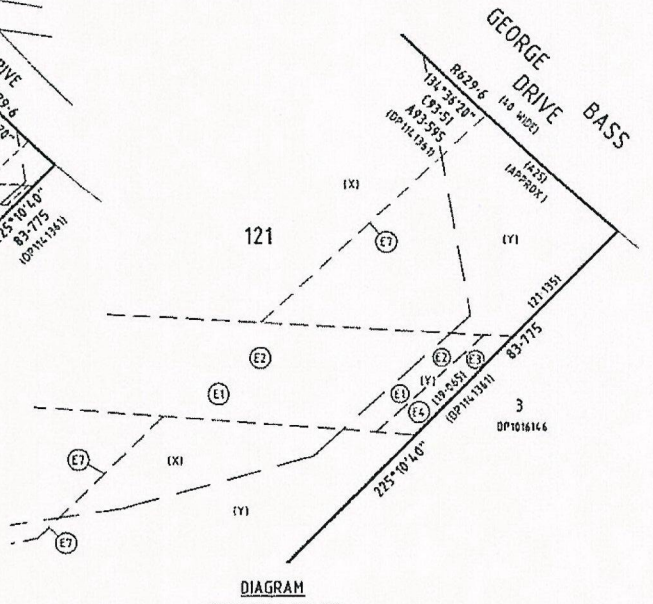
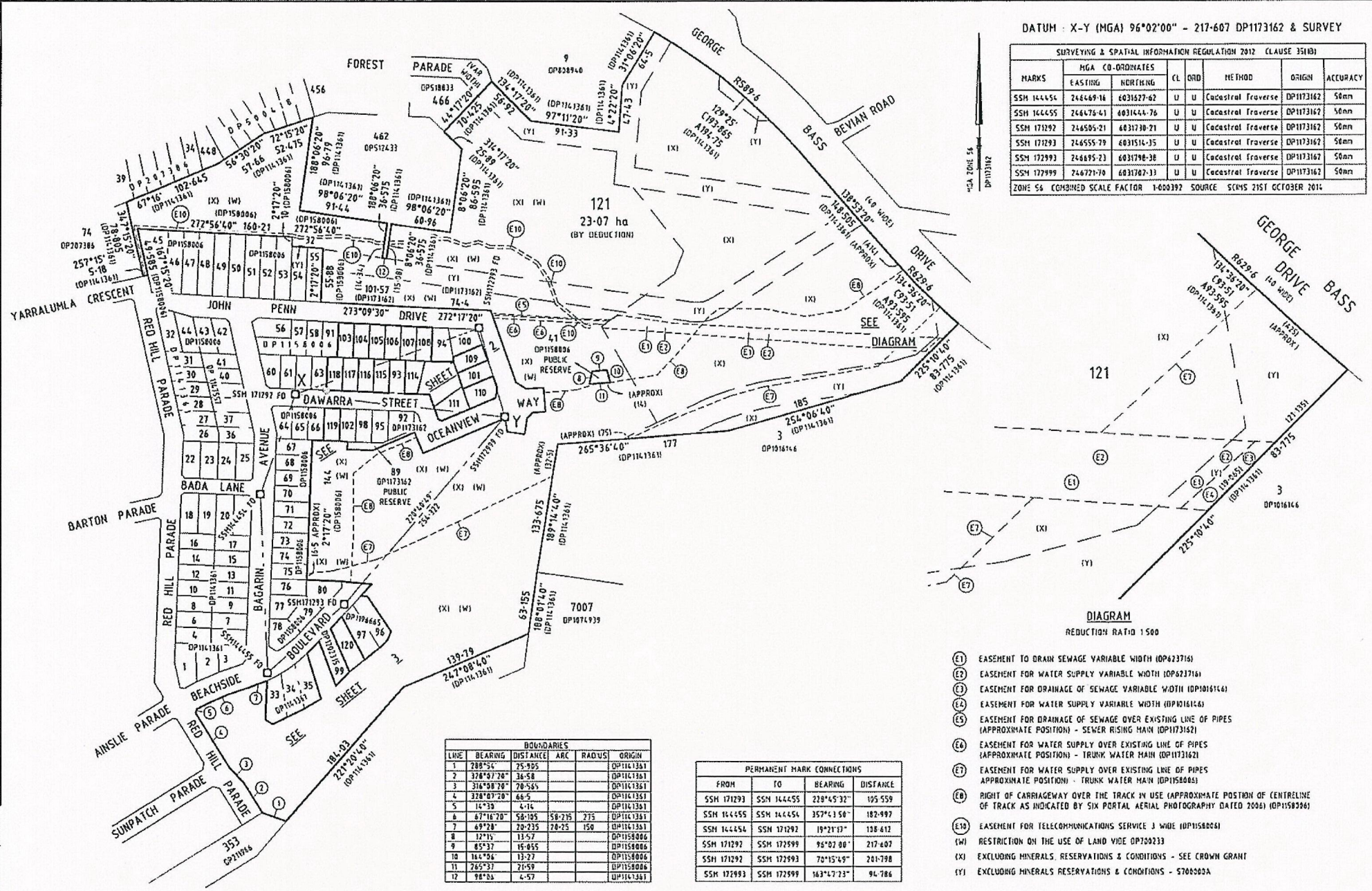

DIAGRAM
REDUCTION RATIO 1:500

- (E1) EASEMENT TO DRAIN SEWAGE VARIABLE WIDTH (DP423716)
- (E2) EASEMENT FOR WATER SUPPLY VARIABLE WIDTH (DP623716)
- (E3) EASEMENT FOR DRAINAGE OF SEWAGE VARIABLE WIDTH (DP101614)
- (E4) EASEMENT FOR WATER SUPPLY VARIABLE WIDTH (DP101614)
- (E5) EASEMENT FOR DRAINAGE OF SEWAGE OVER EXISTING LINE OF PIPES (APPROXIMATE POSITION) - SEWER RISING MAIN (DP1173162)
- (E6) EASEMENT FOR WATER SUPPLY OVER EXISTING LINE OF PIPES (APPROXIMATE POSITION) - TRUNK WATER MAIN (DP1173162)
- (E7) EASEMENT FOR WATER SUPPLY OVER EXISTING LINE OF PIPES (APPROXIMATE POSITION) - TRUNK WATER MAIN (DP158006)
- (E8) RIGHT OF CARRIAGEWAY OVER THE TRACK IN USE (APPROXIMATE POSITION OF TRACK AS INDICATED BY SIX PORTAL AERIAL PHOTOGRAPHY DATED 2006) (DP158006)
- (E10) EASEMENT FOR TELECOMMUNICATIONS SERVICE 3 WIDE (DP158006)
- (W) RESTRICTION ON THE USE OF LAND VIDE DP120233
- (X) EXCLUDING MINERALS, RESERVATIONS & CONDITIONS - SEE CROWN GRANT
- (Y) EXCLUDING MINERALS RESERVATIONS & CONDITIONS - 5768502A

LINE	BEARING	DISTANCE	ARC	RADIUS	ORIGIN
1	288°55'	25.905			DP1141361
2	378°07'28"	36.58			DP1141361
3	316°08'28"	70.565			DP1141361
4	378°07'28"	66.5			DP1141361
5	14°39'	4.16			DP1141361
6	87°16'20"	58.195	58.215	275	DP1141361
7	69°28'	20.235	28.25	150	DP1141361
8	12°15'	13.57			DP158006
9	85°37'	16.855			DP158006
10	164°06'	13.27			DP158006
11	265°37'	21.59			DP158006
12	98°56'	4.57			DP1141361

FROM	TO	BEARING	DISTANCE
SSH 171293	SSH 144455	228°45'32"	195.559
SSH 144455	SSH 144455	357°43'50"	182.997
SSH 144455	SSH 171292	192°11'37"	138.412
SSH 171292	SSH 172999	95°02'00"	217.407
SSH 171292	SSH 172993	70°15'49"	201.798
SSH 172999	SSH 172999	163°47'32"	94.786

Surveyor: Jason R Hay
Date of Survey: 5/12/2014
Surveyor's Ref: 142463SV10
POLICY 3' EXEMPTION

PLAN OF SUBDIVISION OF LOT 103 IN
DP1204745

LGA: EUROBODALLA
Locality: TOMAKIN
Subdivision No: 4125
Lengths are in metres
Reduction Ratio 1:2500

Registered:
29.4.2015

DP1207878

Reg: R467411 / Doc: DP 1207878 P / Rev: 30-Apr-2015 / Sts: SC.OK / Pxt: 01-May-2015 12:29 / Pgs: ALL / Seq: 1 of 6 / Ref: Barlings Beach - / Src: T

ANNEXURE 1

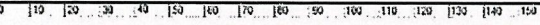

BOUNDARIES ARE UNFENCED EXCEPT AS SHOWN

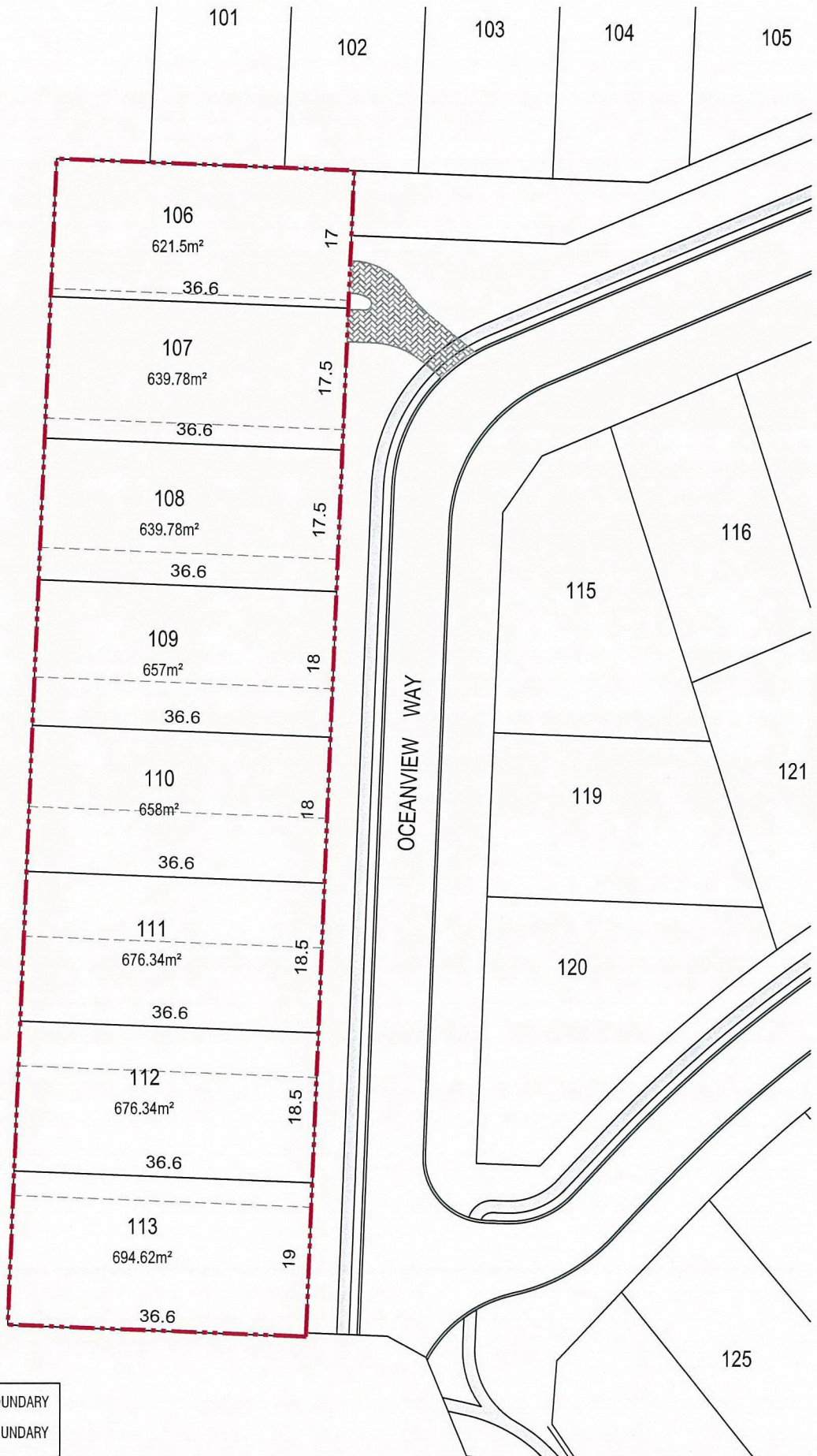

—	PROPOSED BOUNDARY
- - -	APPROVED BOUNDARY



Walker Corporation Pty Ltd
 15/160 Collins Street, Melbourne, VIC 3000
 Telephone: (03) 9211 3000, Fax: (03) 9211 3001
 www.walker.com.au

Issue	Date	Amendment
A	25.06.15	ISSUE

Project Title
BARLINGS BEACH

Drawing Title
**BOUNDARY ADJUSTMENTS
 LOTS 106-113**

Drawn	Checked	Date
SL		25/06/2015
Scale	1:500 @ A3	June 2015
Drawn by no.	BB-106-113	A

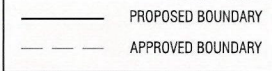
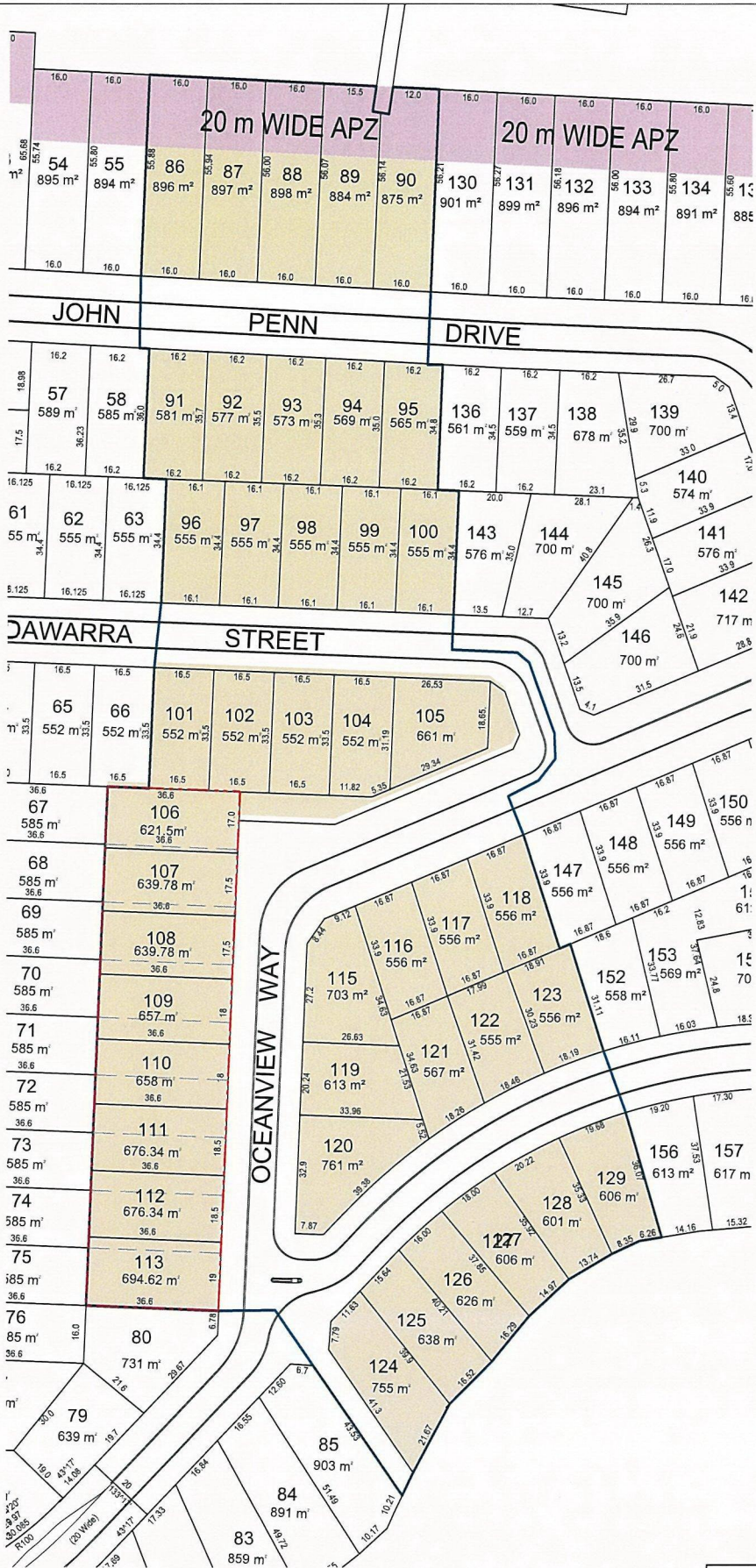

LEGEND

20 m WIDE APZ

Drawn	Scale	Date	Drawing No.
SL	1:1250 @ A3	14.08.15	BB-01 A

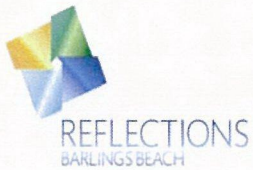

BARLINGS BEACH
REVISED SUBDIVISION - STAGE 3

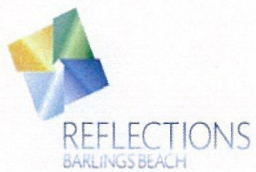
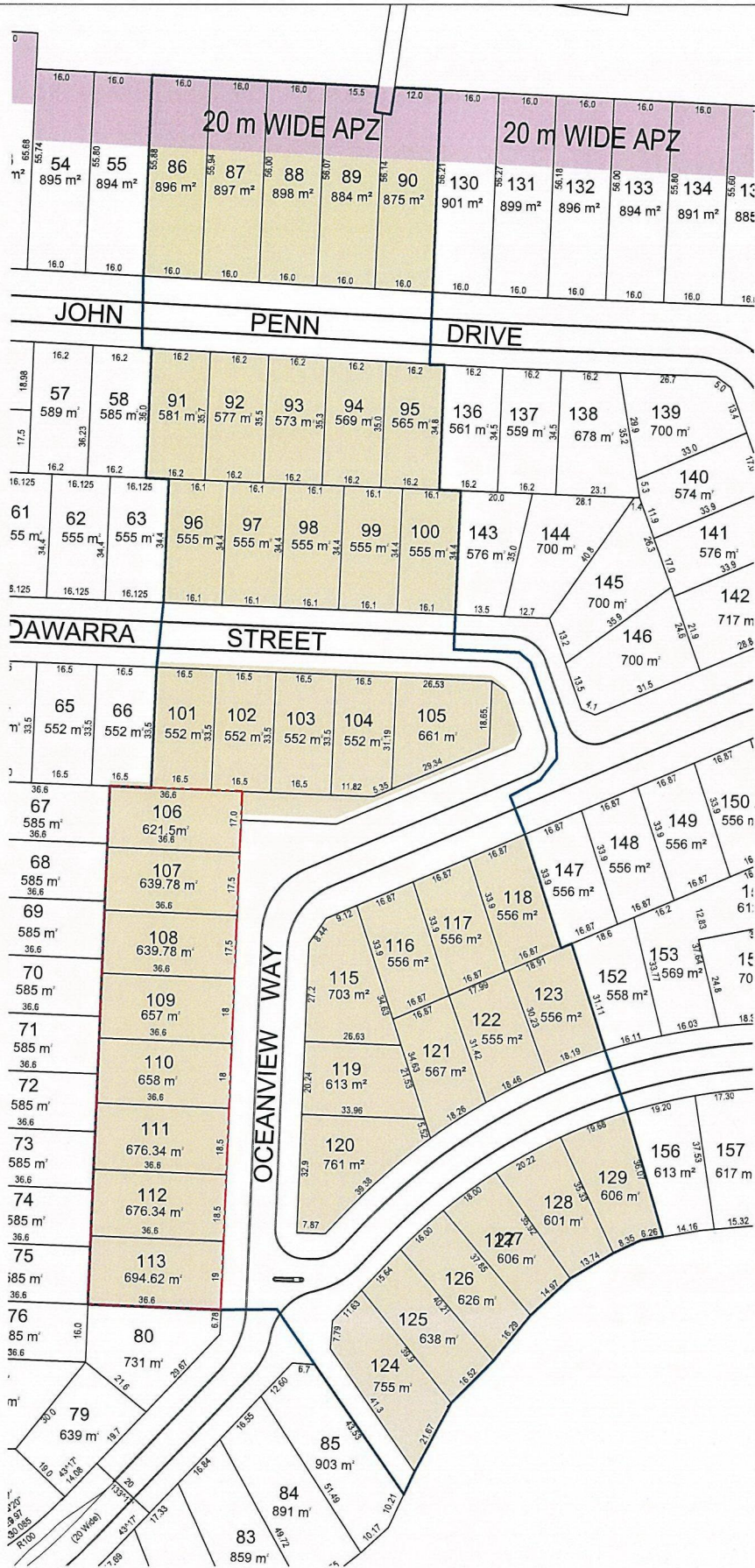

BARLINGS BEACH REVISED SUBDIVISION - STAGE 3

LEGEND
 20 m WIDE APZ

Drawn	Scale	Date	Drawing No.
SL	1:1250 @ A3	14.08.15	BB-02 A